



## Customer Service Bulletin Commercial Business Group

### Workman<sup>®</sup> 3000/4000 Series

<u>Model/Serial Range:</u>	<u>Model Numbers:</u>	<u>Serial Numbers:</u>
	07200 / 07200TC	30101-21099999
	07202 / 07202TC	80101-21099999
	07205 / 07205TC	30101-21099999
	07206 / 7206TC	50101-69999
	07215 / 07215TC / 07216	50101-21099999
	07220 / 07222	80101-21099999
	07230 / 07231 / 07232	90101-21099999

#### Subject: Auxiliary Power Unit (APU) Bearing Failures

Improper assembly when replacing the Bearings (251-82) and the Spacer (87-2750) can cause early failure of the APU Shaft Bearings and Spacer. Spacer (87-2750) should be inspected for correct length to ensure intended bearing support. Refer to the Installation Instructions below for correct assembly procedure and part specification data.

### INSTALLATION INSTRUCTIONS

1. Inspect the APU Support Bracket inside diameter bearing land and the APU Driveshaft for damage/burrs. Repair the Bracket if damage is noted in the land area. If replacement is needed, contact Toro Commercial Service for the APU Support Bracket welded assembly.
2. Insert Bearing (251-82) into the front side (pulley side) of the APU Support Bracket by pushing on the **outer** race of the Bearing into the Bracket with a steady pressure. Continue this press until the Bearing outer race contacts the land of the Bracket opening.
3. Check the length of Spacer (87-2750) to be 1.884 in. - 1.994 in. (47.85 mm - 50.65 mm). Any Spacer found outside this specification should be discarded and replaced.
4. Place the Spacer into the APU Support Bracket cavity against the Bearing installed in Step 2.
5. Press the engine side bearing by pushing on the inner and outer race of the bearing **with equal force** until it contacts Spacer (87-2750).

Note: If excessive pressure is applied after contact with spacer, bearing may be damaged.

6. Align the Spacer with the Bearing inner race openings and insert APU Driveshaft (87-2740-03). Install Pulley (87-3370-03), Woodruff Key (3257-7), Washer (3256-8), and Lock Nut (3296-15). Tighten to 115 ±15 in-lbs (13 ±0.57 Nm) to complete assembly.

#### **WARNING:**

Do not use an impact wrench to tighten Nut to APU Driveshaft.

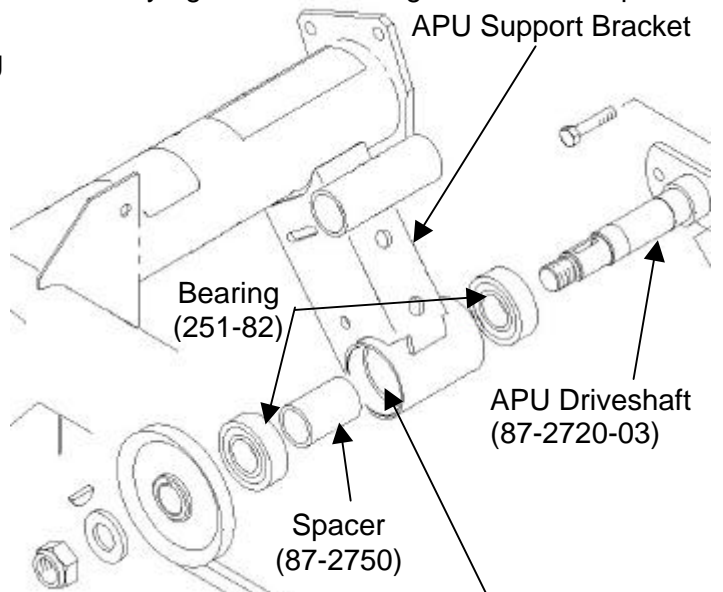

APU Support Bracket Bearing Land  
(Pulley side shown, also on engine side)