



GrandStand® Mowers

Model No. All GrandStand Mowers

Form No. 3397-773 Rev B

Setup Instructions

Setup

Loose Parts

Use the chart below to verify that all parts have been shipped.

Procedure	Description	Qty.	Use
1	No parts required	–	Check the tire pressure.
2	No parts required	–	Prepare the grass deflector.
3	No parts required	–	Check the engine-oil level.
4	No parts required	–	Add fuel to the machine.
5	No parts required	–	Check the hydraulic oil level.
6	No parts required	–	Install the battery cables.
7	No parts required	–	Charge the battery.
8	No parts required	–	Check the machine before delivery to the customer (all machines).
9	Operator's Manual Engine owner's manual Registration card Key	1 1 1 2	Deliver the machine to the customer.



1

Checking the Tire Pressure

No Parts Required

Procedure

Pressure: 83 to 97 kPa (12 to 14 psi)

Note: The front caster wheel is a semi-pneumatic tire and does not need to be checked.

Check the air pressure in the drive tires.

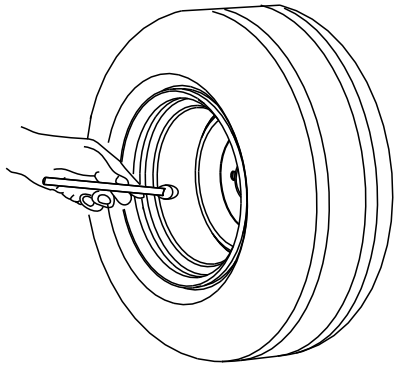

G001055

Figure 1

2

Preparing the Grass Deflector

No Parts Required

Procedure

Install the spring for the grass deflector; refer to Replacing the Grass Deflector in the *Operator's Manual*.

3

Checking the Engine-Oil Level

No Parts Required

Procedure

Before you start the engine and use the machine, check the oil level in the engine crankcase; refer to Servicing the Engine-Oil Level in the *Operator's Manual*.

4

Adding Fuel to the Machine

No Parts Required

Procedure

Add fuel to the machine before starting it. Refer to your *Operator's Manual* for the correct fuel and procedure.

Note: Ensure that the fuel-shutoff valve is open before attempting to start the engine.

5

Checking the Hydraulic-Fluid Level

No Parts Required

Procedure

Before you start the engine and use the machine, check the hydraulic-fluid level in the tank; refer to Checking the Hydraulic-Fluid Level in the *Operator's Manual*.

6

Installing the Battery Cables

No Parts Required

Procedure

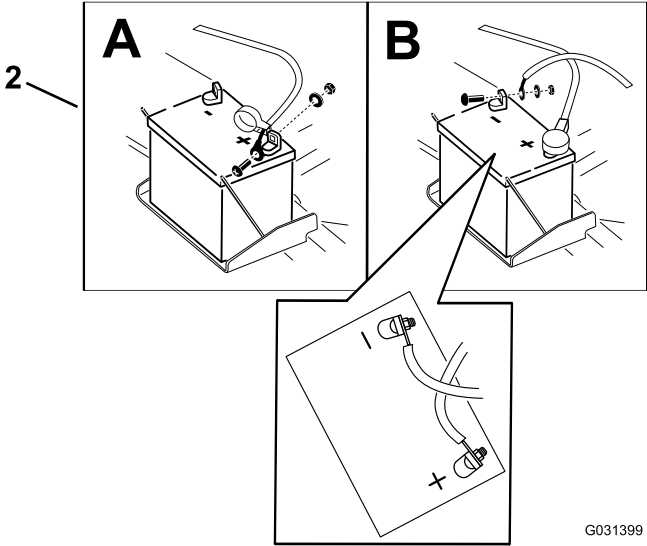
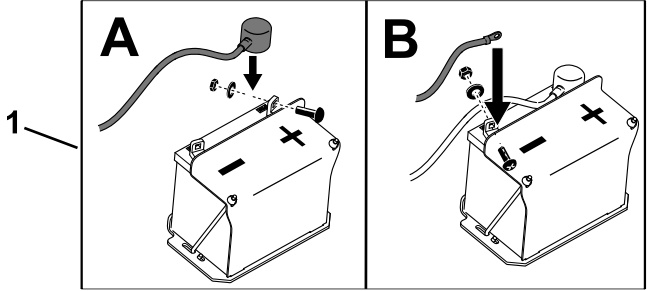

Figure 2

G031399

1. Install the cables for 122, 132, and 152 cm (48, 52, and 60 inch) machines.
2. Install the cables for 91 and 102 cm (36 and 40 inch) machines.

7

Charging the Battery

No Parts Required

Procedure

⚠ WARNING

Charging the battery produces gasses that can explode and cause serious injury.

- Keep cigarettes, sparks, and flames away from the battery.
- Make sure that the ignition switch is off.
- Ventilate when charging or using the battery in an enclosed space.

Important: Do not run the machine with the battery disconnected; electrical damage may occur to the engine.

Charge the battery. Refer to the *Operator's Manual* for instructions.

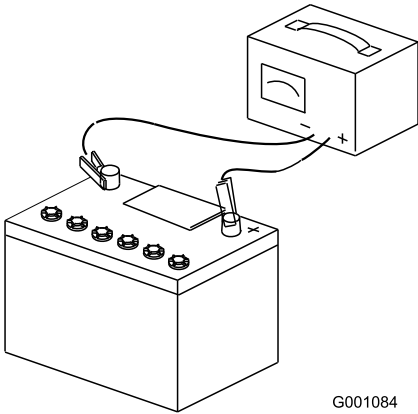

Figure 3

G001084

8

Checking the Machine Before Delivery to the Customer (all machines)

No Parts Required

Procedure

Before delivering the machine to the customer, ensure that you perform or have performed the procedures listed in the following table and initial each when finished. Refer to the *Operator's Manual* for instructions on performing these procedures.

Initial	Check Procedure
	Check the tire pressure.
	Check the level of the machine.
	Check the engine-oil level.
	Check the hydraulic-fluid level.
	Check the adjustment of the parking brake.
	Ensure that the machine tracks correctly; refer to the <i>Operator's Manual</i> for the adjustment procedure.
	Check the safety-interlock system; refer to the <i>Operator's Manual</i> .
	Ensure that the PTO works.
	Check all fasteners that you installed to ensure that they are tight.

When you finish setting up the machine, sign and date in the space provided below:

Signature: _____ Date: _____

9

Delivering the Machine to the Customer

Parts needed for this procedure:

1	<i>Operator's Manual</i>
1	<i>Engine owner's manual</i>
1	Registration card
2	Key

Procedure

At delivery, fill in the model and serial number, complete the items listed in the following table, and initial each when finished.

Model No. _____ Serial No. _____

Dealer Initial	Customer Initial	Check Procedure
		Show the customer where the following features are located and how they function: <ul style="list-style-type: none"> • Fuel-tank cap • Oil-fill cap/Oil dipstick • Spark plug(s) • Engine-oil filter • Engine-oil drain • Fuel gauge, valve, filter, and hose • Air filter • Hydraulic-bypass valves(if applicable) • Hydraulic-fluid reservoir (if applicable) • Hydraulic filter (if applicable) • Battery • Ignition switch • Throttle lever • Choke (if applicable) • Power-takeoff switch (PTO) • Motion-control levers • Parking brake • Mower height-of-cut • Mower deck-flow baffle
		Refer to the <i>Operator's Manual</i> to point out safety procedures, operation, and maintenance procedures.
		Review the warranty statement as shown in the <i>Operator's Manual</i> .
		Describe the post sale service procedures for your store.
		Assist the customer in filling out and mailing the registration card or register online at www.Toro.com
		Make sure that the customer receives the <i>Operator's Manual</i> , <i>Engine Owner's Manual</i> , and <i>Set Up Instructions</i> .
		Make sure that the customer knows the <i>Parts Catalog</i> and operator-training materials are available at www.Toro.com .
		Assist the customer in loading the machine.

Note: When you, the dealer representative, have finished delivering the machine to the customer, sign and date in the space provided below and keep a copy of this page for dealer records. Also, the dealer must remind the customer to use a full-width trailer ramp to load the machine.

Signature: _____ **Date:** _____

Signature: _____ **Date:** _____

Notes:



Count on it.