



Glass Windshield Kit

Groundsmaster® 4300 or Reelmaster® 5010 Series Traction Unit with ROPS Extension Kit

Model No. 31330

Installation Instructions

⚠ WARNING

CALIFORNIA

Proposition 65 Warning

This product contains a chemical or chemicals known to the State of California to cause cancer, birth defects, or reproductive harm.

Loose Parts

Use the chart below to verify that all parts have been shipped.

Description	Qty.	Use
Thick flange bushing	8	Install the kit.
Upper windshield	1	
Lower windshield	1	
Shoulder screw	8	
Flange nut	8	
Backup washer	8	
Thin flange bushing	8	

Installation

1. Move the machine to a level surface, shut off the engine, engage the parking brake, and remove the key from the ignition switch.
2. Position the lower windshield and align the mounting holes ([Figure 1](#)).



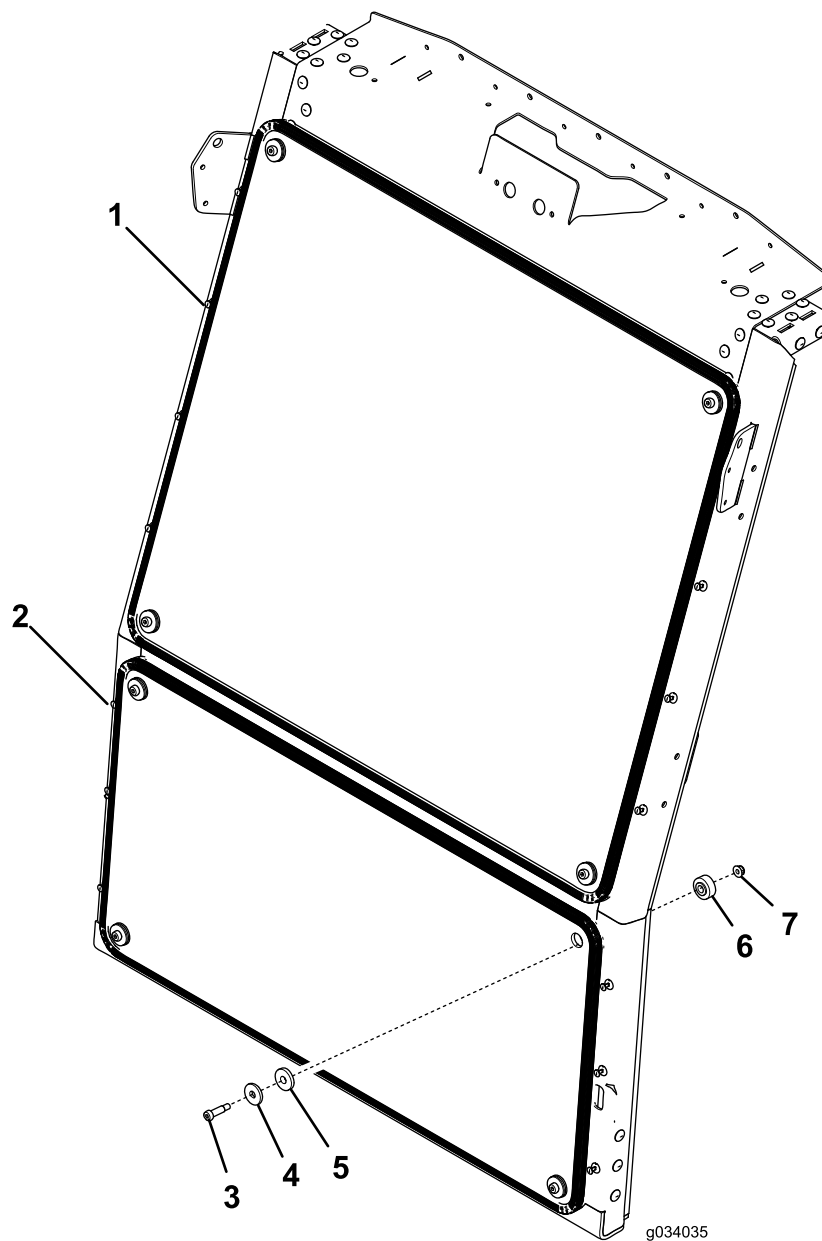

Figure 1

- | | | |
|---------------------|-------------------------|---------------|
| 1. Upper windshield | 4. Backup washer | 7. Flange nut |
| 2. Lower windshield | 5. Thin flange bushing | |
| 3. Shoulder screw | 6. Thick flange bushing | |

-
3. Secure the lower windshield to the frame with the fasteners as shown in [Figure 1](#).
 4. Position the upper windshield and align the mounting holes ([Figure 1](#)).

Important: Ensure that the seam of the bulb seal is on the lower edge of the upper and lower windshields.

5. Secure the upper windshield to the frame with the fasteners as shown in [Figure 1](#).