



## Cab Kit

2015 and After Groundsmaster® 4500/4700-D or Reelmaster®  
7000-D Traction Unit

Model No. 30901—Serial No. 316000001 and Up

## Operator's Manual

# Safety

### ⚠ WARNING

#### CALIFORNIA Proposition 65 Warning

This product contains a chemical or chemicals known to the State of California to cause cancer, birth defects, or reproductive harm.

This product complies with all relevant European directives. For details, please see the Declaration of Incorporation (DOI) at the back of this publication.

## Safety and Instructional Decals



Safety decals and instructions are easily visible to the operator and are located near any area of potential danger. Replace any decal that is damaged or lost.

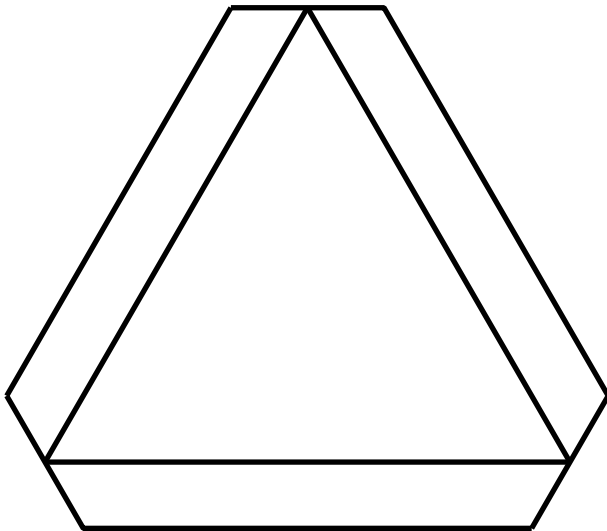

120-0250

1. Slow-moving vehicle

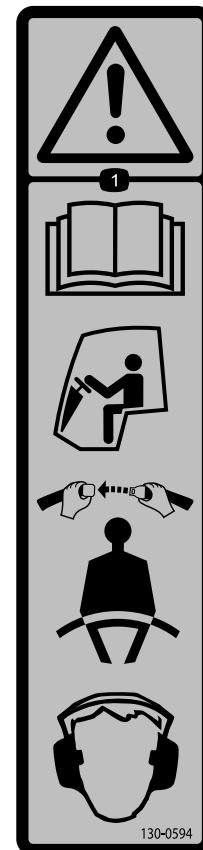

130-0594

1. Warning—read the *Operator's Manual*; when sitting in the cab, always wear a seat belt; wear hearing protection.



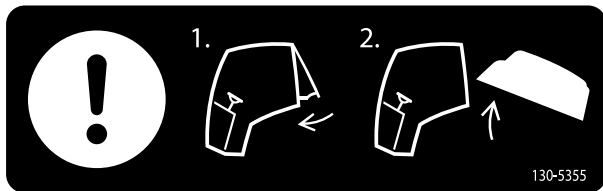

**130-5355**

1. Close the rear window.
2. Raise the hood.

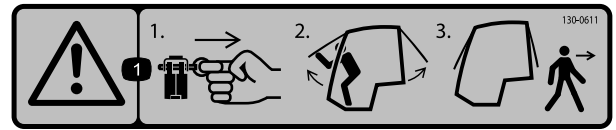

**130-0611**

1. Warning—1) Remove the pin; 2) Raise the doors; 3) Exit the cab.

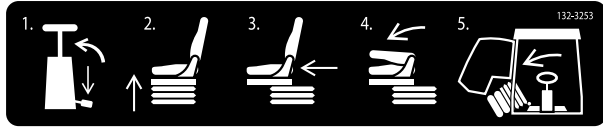

**132-3253**

1. Move the steering column to the forward position.
2. Raise the seat to maximum height.
3. Move the seat forward.
4. Lower the seat back.
5. Tilt the seat sideways.

# Setup

## Loose Parts

Use the chart below to verify that all parts have been shipped.

| Procedure | Description   | Qty.   | Use  |
|-----------|---|--|--|
| <b>1</b>  | No parts required   | —  | Prepare the machine before you install the cab unit. |
| <b>2</b>  | Left, front mount<br>Right, front mount<br>Left, rear mount<br>Right, rear mount<br>Rubber isolator   | 1<br>1<br>1<br>1<br>4                          | Prepare the cab mounting hardware.                   |
| <b>3</b>  | Left, front foam seal<br>Center, front foam seal<br>Right, front foam seal<br>Left foam seal<br>Right foam seal<br>Left tank foam<br>Right tank foam<br>Left, rear foam seal<br>Right, rear foam seal<br>Rear foam seal | 1<br>1<br>1<br>1<br>1<br>1<br>1<br>1<br>1<br>1 | Apply the foam seals to the mount and frame.         |
| <b>4</b>  | Safety decal  | 1  | Apply the safety decal to the rear window.           |

| Procedure | Description                     | Qty. | Use                                  |
|-----------|---------------------------------|------|--------------------------------------|
| <b>5</b>  | Left, front mount               | 1    | Install the mounts to the machine.   |
|           | Right, front mount              | 1    |                                      |
|           | Bolt (3/8 x 1 inch)             | 7    |                                      |
|           | Flange nut (3/8 inch)           | 5    |                                      |
|           | Locknut (3/8 inch)              | 2    |                                      |
|           | Left, rear mount                | 1    |                                      |
|           | Right, rear mount               | 1    |                                      |
| <b>6</b>  | Cab                             | 1    | Install the cab unit to the machine. |
|           | Bolt (1/2 x 3-1/4 inch)         | 4    |                                      |
|           | Washer (2-1/4 inches)           | 4    |                                      |
|           | Washer (1-3/8 inches)           | 2    |                                      |
|           | Locknut (1/2 inch)              | 4    |                                      |
| <b>7</b>  | Left, rear panel assembly       | 1    | Install the panels and floor.        |
|           | Right, rear panel assembly      | 1    |                                      |
|           | Bolt (1/4 x 3/4 inch)           | 6    |                                      |
|           | Clip nut                        | 4    |                                      |
|           | Flange nut (1/4 inch)           | 2    |                                      |
|           | Upholstery panel                | 1    |                                      |
|           | Insulation blanket              | 1    |                                      |
|           | Floor tread                     | 1    |                                      |
| <b>8</b>  | Washer tank                     | 1    | Install the washer tank and mount.   |
|           | Tank mount                      | 1    |                                      |
|           | Tank plate                      | 1    |                                      |
|           | Carriage bolt (5/16 x 3/4 inch) | 4    |                                      |
|           | Flange nut (5/16 inch)          | 4    |                                      |
|           | Swell latch                     | 1    |                                      |
|           | Swell-latch bushing             | 1    |                                      |
|           | Swell-latch nut                 | 1    |                                      |
|           | R-Clamp                         | 1    |                                      |
| <b>9</b>  | Fitting (3/8 NPT x 0.625 barb)  | 2    | Install the hoses.                   |
|           | Hose clamp                      | 2    |                                      |
|           | Right-angle fitting (3/4 inch)  | 1    |                                      |
|           | Right-angle fitting (7/8 inch)  | 1    |                                      |
|           | R-Clamp                         | 2    |                                      |
| <b>10</b> | Cable tie                       | 5    | Connect the wire harness.            |
| <b>11</b> | No parts required               | —    | Complete the installation.           |

# 1

## Preparing the Machine

### No Parts Required

### Positioning the Machine

1. Clear a location in your workspace under the hoist system.

**Note:** Verify that your hoist system is capable of safely supporting the cab unit over the machine during the installation.

2. Move the machine underneath the hoist, shut off the engine, and remove the key from the ignition switch.
3. Chock the wheels to prevent the machine from moving during the installation.
4. Remove the battery; refer to the *Operator's Manual*.

### Removing the ROPS Top Bolts

**Important:** Use an assistant to support the ROPS when you remove the bolts securing it to the machine.

1. Remove and retain the bolt securing the storage compartment located on the left side of the machine ([Figure 1](#)).

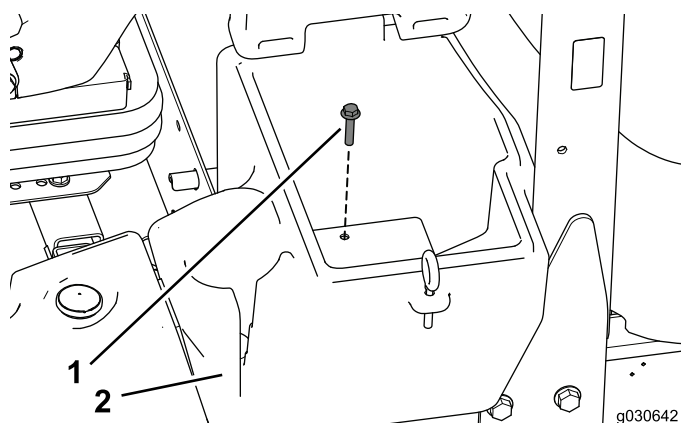

Figure 1

1. Bolt
2. Storage compartment

2. Remove and retain the storage compartment.
3. Remove and retain the 2 bolts, reinforcement plate, and 2 flange nuts securing the ROPS to the top of the frame ([Figure 2](#)).

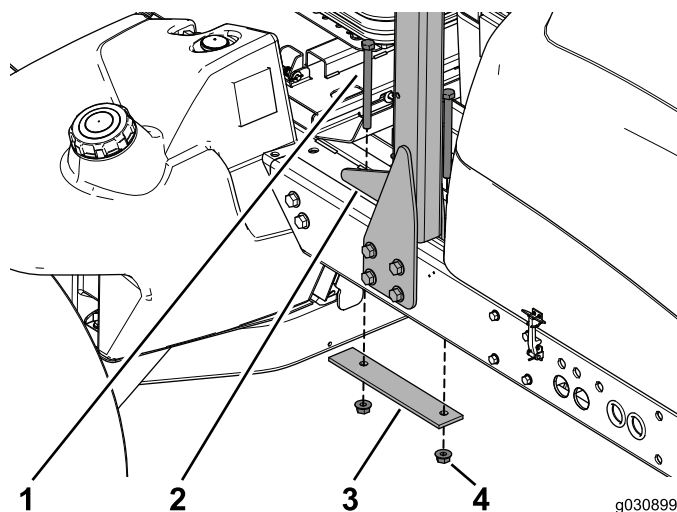

Figure 2

1. Bolt
2. ROPS
3. Reinforcement plate
4. Flange nut

4. Remove and retain the screw securing the wire-harness plate and the bolt securing the battery compartment ([Figure 3](#)).

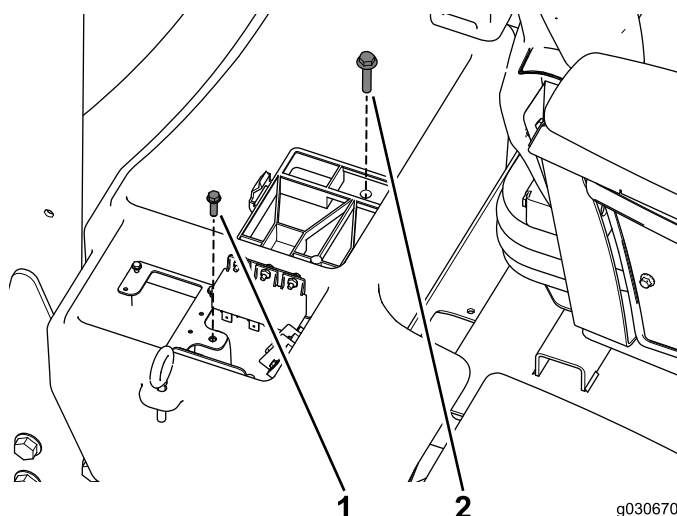
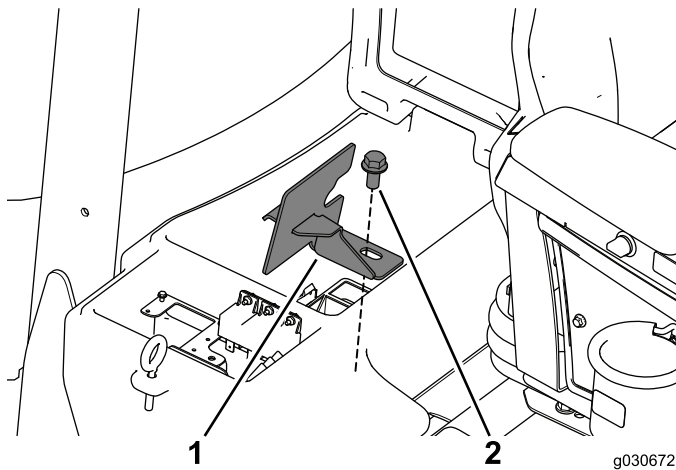

Figure 3

1. Screw
2. Bolt

5. Remove and retain the bolt and the battery-compartment clamp ([Figure 4](#)).



**Figure 4**

1. Battery-compartment clamp
2. Bolt

6. Arrange the wire-harness plate and battery compartment to allow you to remove the 2 bolts, reinforcement plate, and 2 flange nuts that secure the ROPS to the top of the frame (Figure 5). Set them aside.

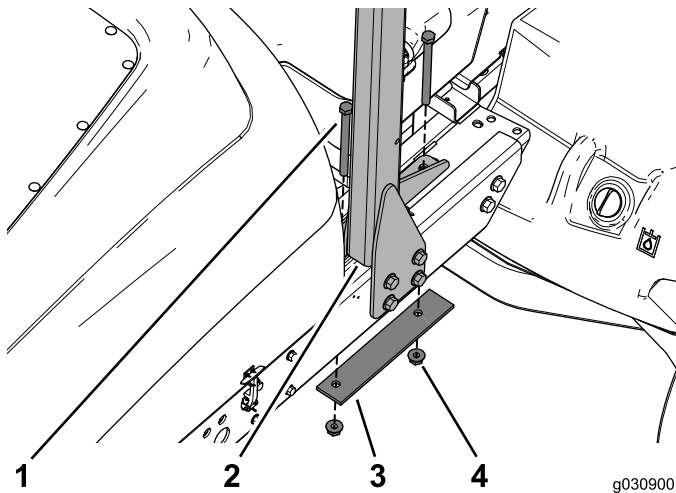

**Figure 5**

1. Bolt
2. ROPS
3. Reinforcement plate
4. Flange nut

## Removing the ROPS

**Important:** Use an assistant to support the ROPS when you remove the bolts securing it to the machine.

1. Remove and retain the bolts securing the ROPS to the left side of the machine (Figure 6).

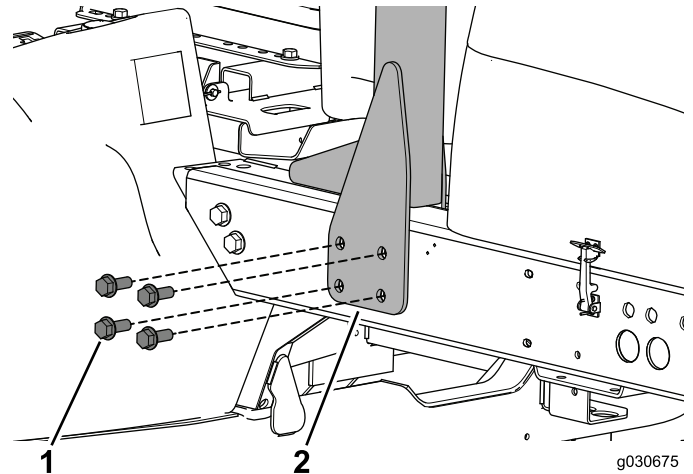

**Figure 6**

1. Bolts
2. ROPS

2. Use an assistant to help you remove the ROPS from the machine.
3. Store the ROPS.

# 2

## Preparing the Cab Mounts

Parts needed for this procedure:

|   |                    |
|---|--------------------|
| 1 | Left, front mount  |
| 1 | Right, front mount |
| 1 | Left, rear mount   |
| 1 | Right, rear mount  |
| 4 | Rubber isolator    |

### Preparing the Front Mount

Press a rubber isolator into each hole in the front mounts (Figure 7).

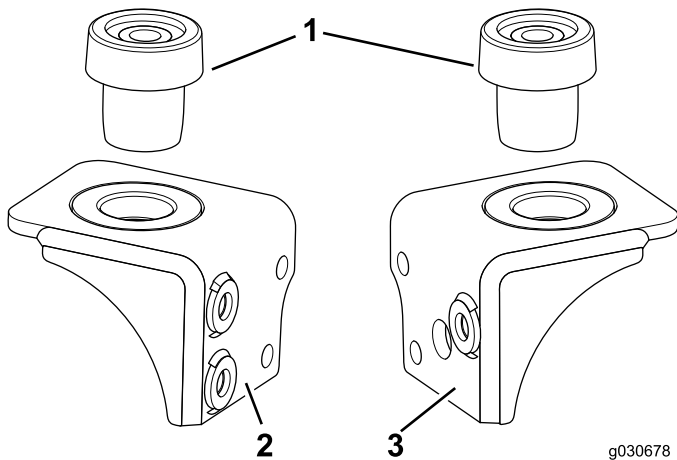

Figure 7

1. Rubber isolators
2. Left, front mount
3. Right, front mount

**Note:** Use soapy water and a mallet to assist with inserting the rubber isolators into the holes.

## Drilling the Front Mount Holes

Follow this procedure only if necessary.

Locate and drill 2 holes (13/32 inch diameter) for the right, front mount as shown in Figure 8.

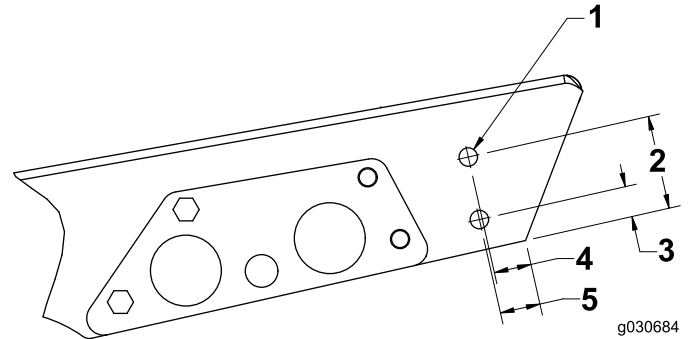

Figure 8

1. Hole (13/32 inch diameter)
2. 52 mm (2.07 inches)
3. 17 mm (0.67 inch)
4. 21 mm (0.83 inch)
5. 23 mm (0.89 inch)

### Preparing the Rear Mounts

1. Press a rubber isolator into the hole of the left, rear mount on the cab frame (Figure 9).

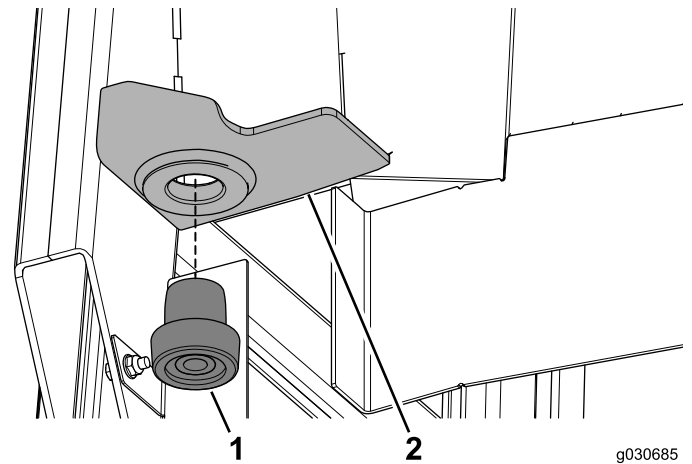

Figure 9

1. Rubber isolator
2. Left, rear mount

2. Press a rubber isolator into the hole of the right, rear mount on the cab frame (Figure 10).

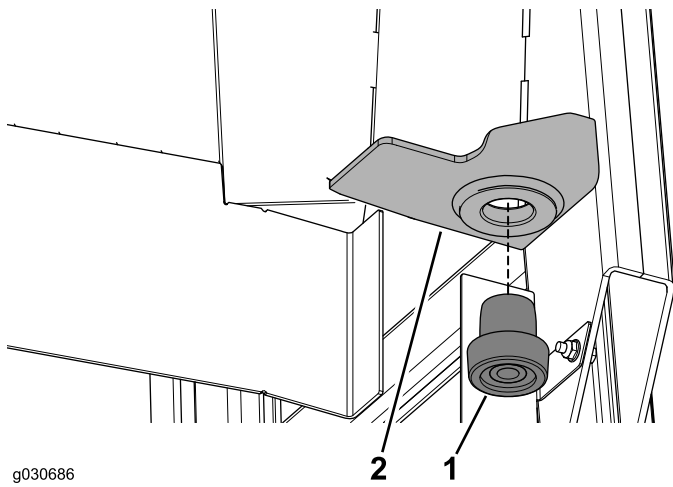

Figure 10

1. Rubber isolator
2. Right, rear mount

**Note:** Use soapy water and a mallet to assist with inserting the rubber isolator into the hole.

# 3

## Applying the Foam Seals

### Parts needed for this procedure:

|   |                         |
|---|-------------------------|
| 1 | Left, front foam seal   |
| 1 | Center, front foam seal |
| 1 | Right, front foam seal  |
| 1 | Left foam seal          |
| 1 | Right foam seal         |
| 1 | Left tank foam          |
| 1 | Right tank foam         |
| 1 | Left, rear foam seal    |
| 1 | Right, rear foam seal   |
| 1 | Rear foam seal          |

## Applying the Front Foam Seals

Apply the center, front foam seal and then the left, front and right, front foam seals approximately 3 mm (1/8 inch) from the edge on the front of the cab unit (Figure 11).

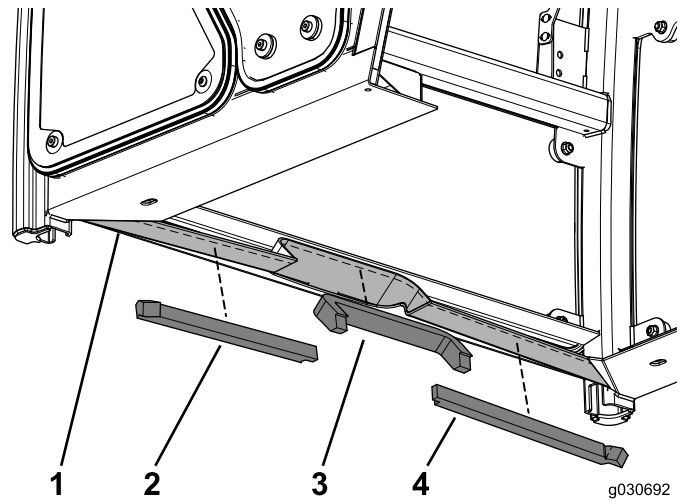

Figure 11

1. Application area
2. Left, front foam seal
3. Center, front foam seal
4. Right, front foam seal

**Note:** Install the ends of the foam seals to interlock and create a solid seal.

## Applying the Side Foam Seals

1. Apply the left foam seal approximately 3 mm (1/8 inch) from the edge on the front, left section of the cab unit (Figure 12).

**Note:** Install the ends of the foam seals to interlock and create a solid seal.

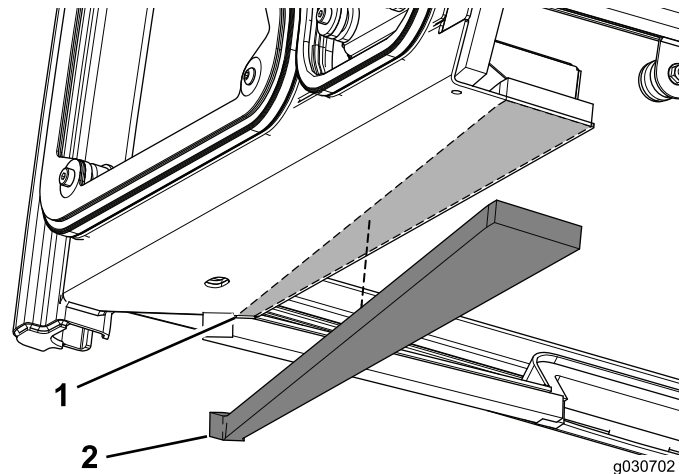

Figure 12

1. Application area
2. Left foam seal

2. Apply the right foam seal approximately 3 mm (1/8 inch) from the edge on the right, front section of the cab unit.

**Note:** Install the ends of the foam seals to interlock and create a solid seal.

- Remove the paper backing from the double-faced tape on both sides of the cab unit (Figure 13).

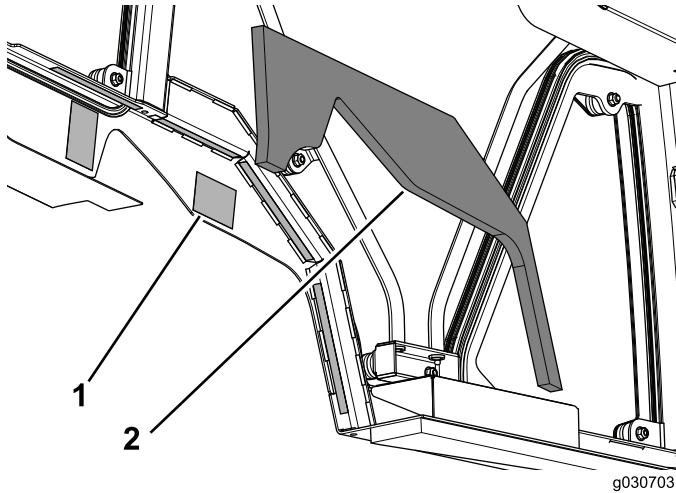

**Figure 13**

- Double-faced tape
- Left tank foam

- Apply the left tank foam to the cab unit (Figure 13).
- Apply the right tank foam to the cab unit.

## Applying the Rear Foam Seals

- Remove the paper backing from the double-faced tape at the back of the cab unit (Figure 14).

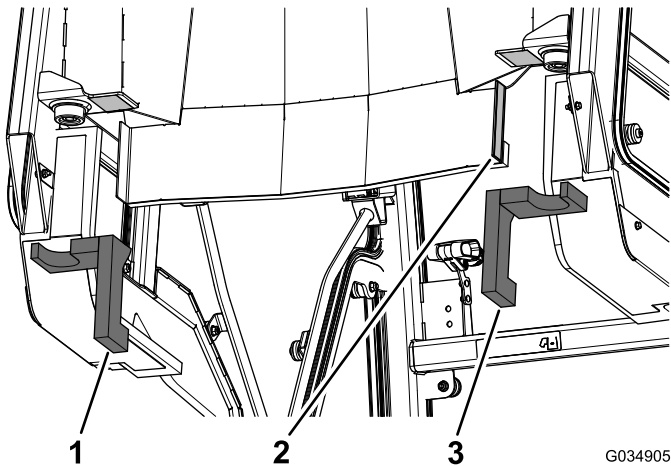

**Figure 14**

- Left, rear foam seal
- Double-faced tape
- Right, rear t foam seal

- Apply the left, rear and right, rear foam seals to the cab unit (Figure 14).
- Apply the rear foam seal to the back of the cab unit (Figure 15).

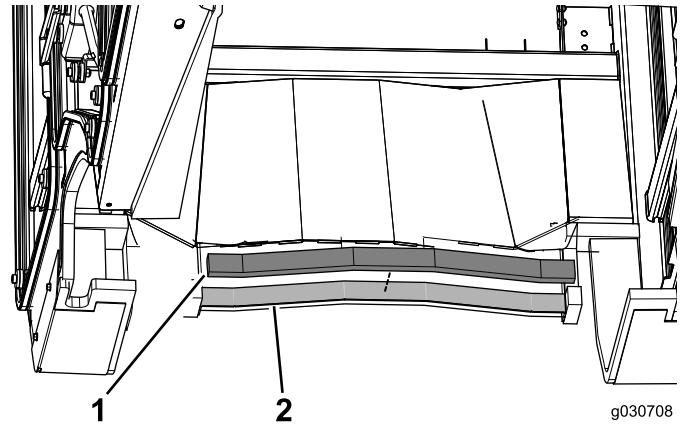

**Figure 15**

- Rear foam seal
- Application area

# 4

## Applying the Safety Decal

### Parts needed for this procedure:

- |   |              |
|---|--------------|
| 1 | Safety decal |
|---|--------------|

### Procedure

Follow this procedure only if required by your local road regulations.

Apply the safety decal to the rear window as shown in Figure 16.

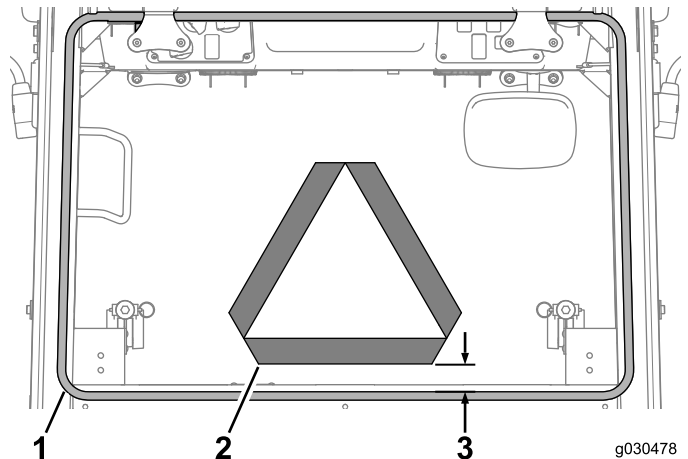

**Figure 16**

- Window seal
- Safety decal
- 25 mm (1 inches)



# 5

## Installing the Cab Mounts

### Parts needed for this procedure:

|   |                       |
|---|-----------------------|
| 1 | Left, front mount     |
| 1 | Right, front mount    |
| 7 | Bolt (3/8 x 1 inch)   |
| 5 | Flange nut (3/8 inch) |
| 2 | Locknut (3/8 inch)    |
| 1 | Left, rear mount      |
| 1 | Right, rear mount     |

### Installing the Left Front Mount

1. Remove the existing hardware and use the 3 bolts (3/8 x 1 inch) and flange nuts to secure the mount to the machine (Figure 17).

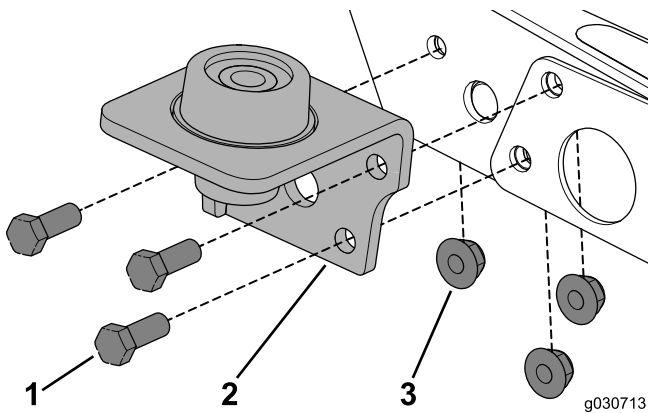

Figure 17

1. Bolt (3/8 x 1 inch)
2. Left mount
3. Flange nut (3/8 inch)

2. Torque the bolts and nuts to 37 to 45 N·m (27 to 33 ft-lb).

### Installing the Right Front Mount

1. Remove the existing hardware and use the 4 bolts (3/8 x 1 inch) 2 flange nuts, and 2 locknuts to secure the mount to the machine (Figure 18).

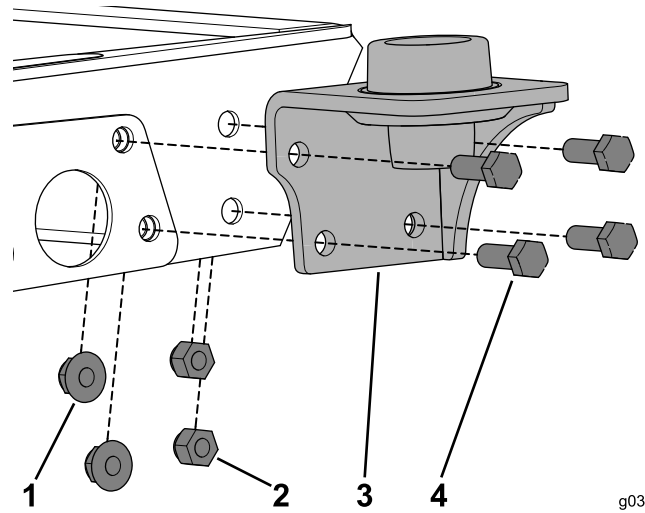

Figure 18

1. Flange nut (3/8 inch)
2. Locknut
3. Left mount
4. Bolt (3/8 x 1 inch)

2. Torque the bolts and nuts to 37 to 45 N·m (27 to 33 ft-lb).

### Installing the Left Rear Mount

1. Use the hardware that you removed with the ROPS to secure the rear mount to the frame (Figure 19).

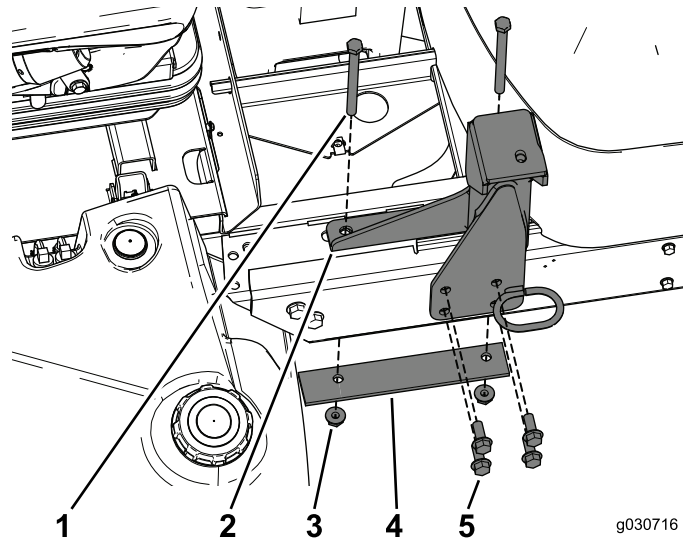

Figure 19

1. Bolt (1/2 x 6 inches)
2. Left mount
3. Flange nut
4. Reinforcement plate
5. Bolt (1/2 x 1-1/4 inches)

2. Torque the bolts (1/2 x 6 inches) and nuts to 91 to 113 N·m (67 to 83 ft-lb).
3. Torque the bolts (1/2 x 1-1/4 inches) to 91 to 113 N·m (67 to 83 ft-lb).

## Installing the Right Rear Mount

1. Use the hardware that you removed with the ROPS to secure the rear mount to the frame ([Figure 20](#)).

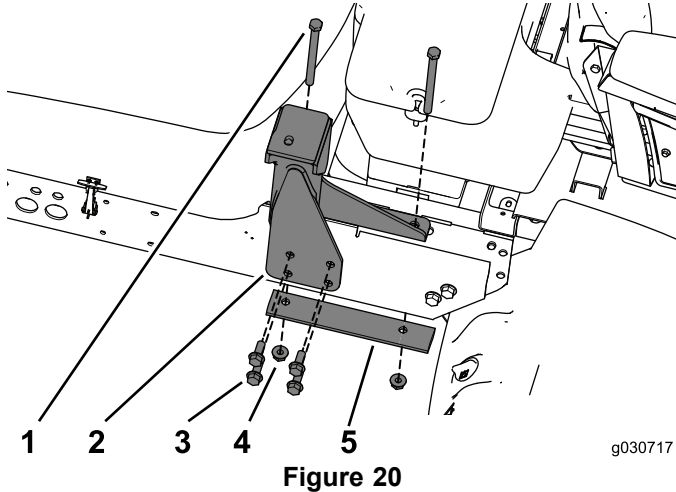

1. Bolt (1/2 x 1-1/4 inches)
2. Right mount
3. Bolt (1/2 x 6 inches)
4. Flange nut
5. Reinforcement plate

2. Torque the bolts (1/2 x 6 inches) and nuts to 91 to 113 N·m (67 to 83 ft-lb).
3. Torque the bolts (1/2 x 1-1/4 inches) to 91 to 113 N·m (67 to 83 ft-lb).
4. Use the bolt (5/16 x 1-1/2 inches) to secure the storage compartment to the machine ([Figure 21](#)).

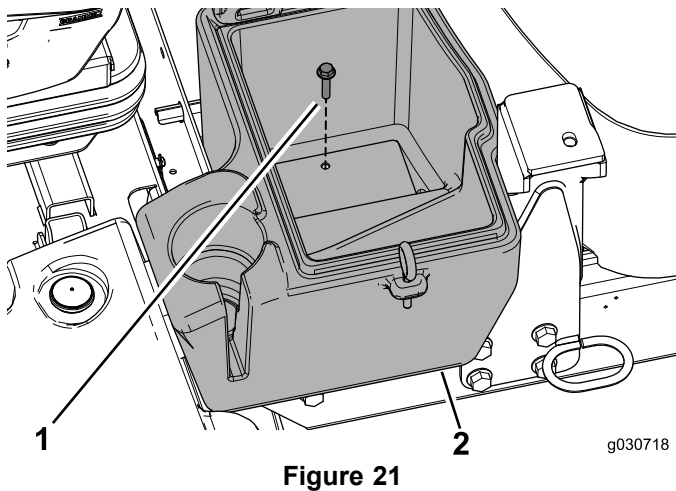

1. Bolt (5/16 x 1-1/2 inches)
2. Storage compartment

5. Use the screw to secure the wiring harness plate to the machine and use the bolt (1/2 x 1 inch) to secure the battery-compartment clamp and the battery compartment to the machine ([Figure 22](#)).

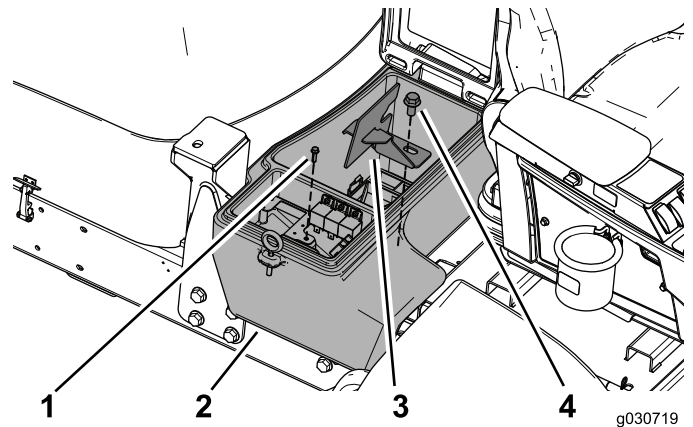

Figure 22

1. Screw
2. Battery compartment
3. Battery-compartment clamp
4. Bolt (1/2 x 1 inch)

6. Install the battery; refer to the *Operator's Manual*.

## Installing the Wire Harness and Preparing the Cab for Installation

Route the wire harness from underneath the machine up to the battery box as shown in [Figure 23](#).

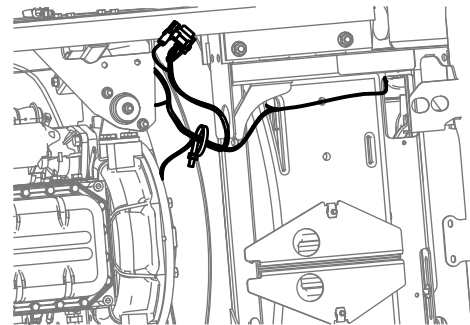

Figure 23

Install the wire harness as shown in [Figure 24](#).

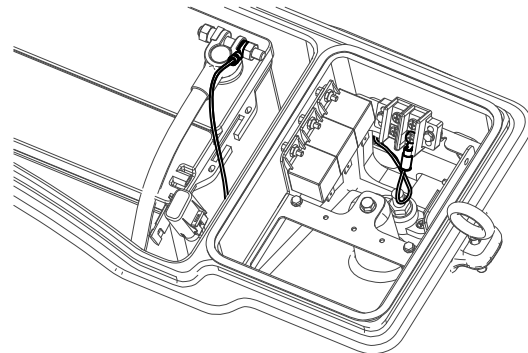
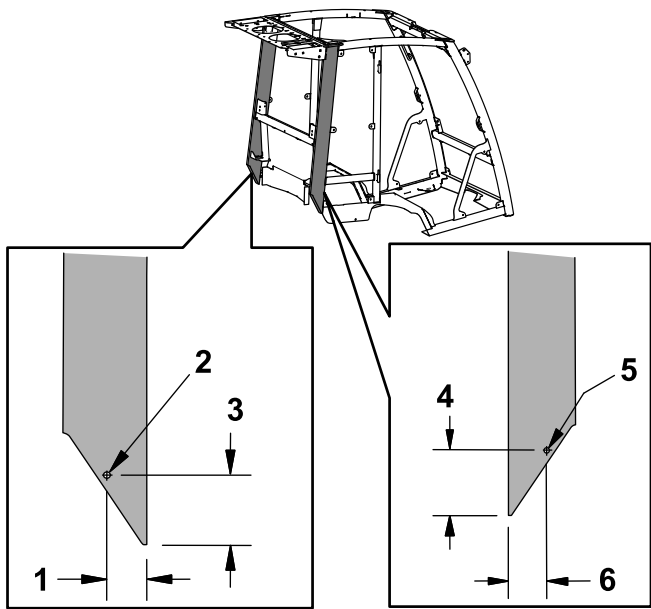

Figure 24

Use the measurements in [Figure 25](#) and drill holes into the cab.



**Figure 25**

- |                              |                              |
|------------------------------|------------------------------|
| 1. 1.93 inches               | 4. 3.87 inches               |
| 2. Hole (0.31 inch diameter) | 5. Hole (0.31 inch diameter) |
| 3. 3.36 inches               | 6. 2.29 inches               |

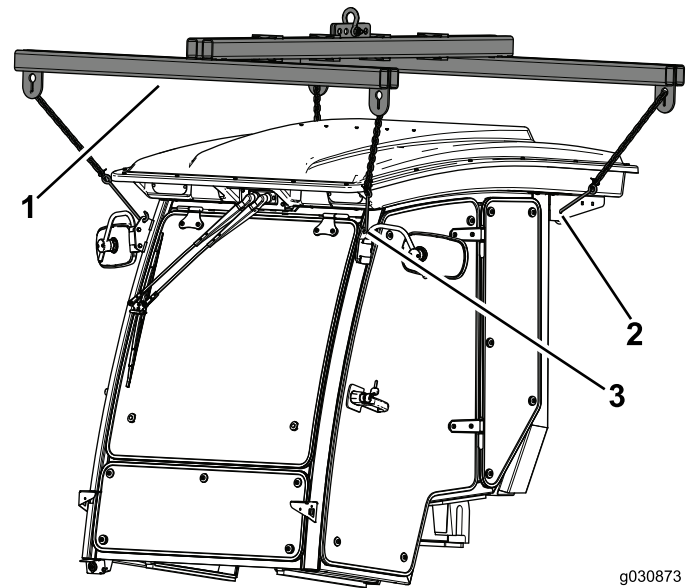

**Figure 26**

- |                     |                    |
|---------------------|--------------------|
| 1. Hoist bar        | 3. Rear lift point |
| 2. Front lift point |                    |

- Lower the cab to the machine, aligning the 4 bolt holes on the mounts.
- Use a bolt (1/2 x 3-1/4 inch), washer (2-1/4 inches), and locknut (1/2 inch) to secure the cab to the rear mounts on the machine (Figure 27).

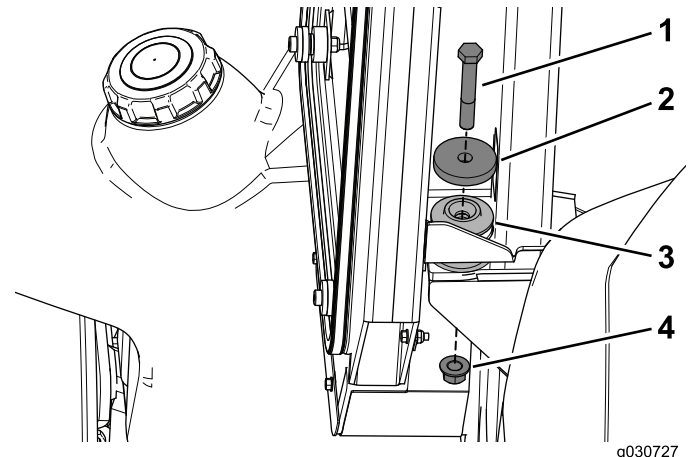

**Figure 27**

- |                            |
|----------------------------|
| 1. Bolt (1/2 x 3-1/4 inch) |
| 2. Washer (2-1/4 inches)   |
| 3. Rear mount              |
| 4. Locknut (1/2 inch)      |
- Torque the bolt (1/2 x 3-1/4 inch) and locknut (1/2 inch) to 129 to 156 N·m (95 to 115 ft-lb).

**Note:** Ensure that there is a small amount of slack in the lifting tool to allow the cab to settle onto the machine.

# 6

## Installing the Cab Unit to the Machine

### Parts needed for this procedure:

|   |                         |
|---|-------------------------|
| 1 | Cab                     |
| 4 | Bolt (1/2 x 3-1/4 inch) |
| 4 | Washer (2-1/4 inches)   |
| 2 | Washer (1-3/8 inches)   |
| 4 | Locknut (1/2 inch)      |

### Procedure

- Disconnect the negative (-) battery cable from the battery of the machine.
- Use the 4 lift points to support the cab above the machine (Figure 26).

**Note:** Ensure that the lifting tool does not contact the cab roof or headliner when supporting the cab.

6. Use a bolt (1/2 x 3-1/4 inch), washer (1-3/8 inches), washer (2-1/4 inches), and locknut (1/2 inch) to secure the cab to the front mounts on the machine (Figure 28).

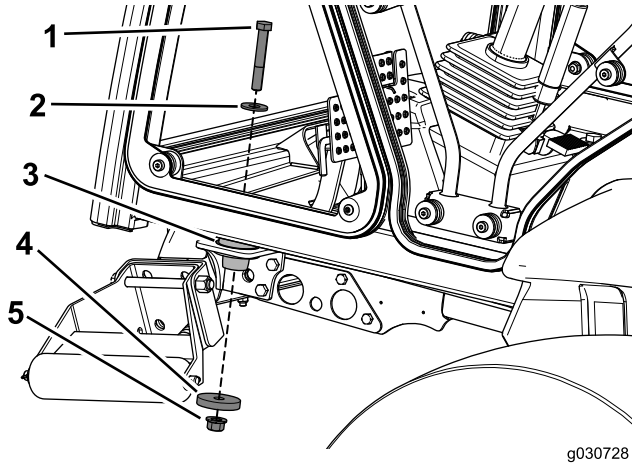

**Figure 28**

1. Bolt (1/2 x 3-1/4 inch)
  2. Washer (1-3/8 inches)
  3. Front mount
  4. Washer (2-1/4 inches)
  5. Locknut (1/2 inch)
- 
7. Torque the bolt (1/2 x 3-1/4 inch) and locknut (1/2 inch) to 129 to 156 N·m (95 to 115 ft-lb) and disconnect the lifting tool from the cab.

# 7

## Installing the Panels and Flooring

### Parts needed for this procedure:

|   |                            |
|---|----------------------------|
| 1 | Left, rear panel assembly  |
| 1 | Right, rear panel assembly |
| 6 | Bolt (1/4 x 3/4 inch)      |
| 4 | Clip nut                   |
| 2 | Flange nut (1/4 inch)      |
| 1 | Upholstery panel           |
| 1 | Insulation blanket         |
| 1 | Floor tread                |

### Installing Rear Panel Assembly

1. Install the 2 clip nuts onto the cab frame (Figure 29).

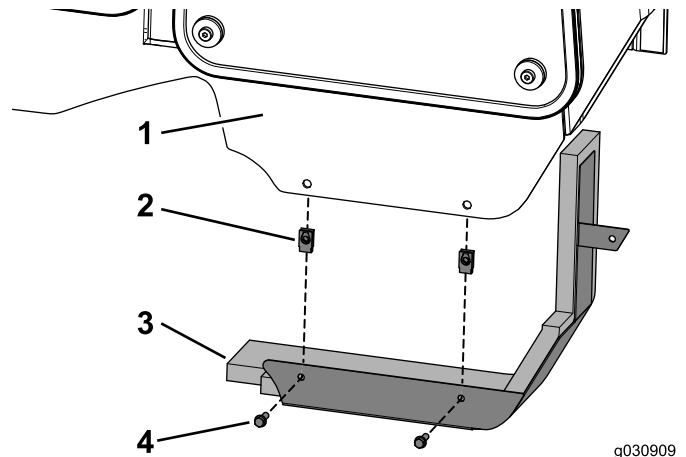

**Figure 29**

1. Cab frame
  2. Clip nut
  3. Left, rear panel assembly
  4. Bolt (1/4 x 3/4 inch)
- 
2. Secure the panel assembly to the cab using the 2 bolts (1/4 x 3/4 inch) as shown in Figure 29.
  3. Use 1 bolt (1/4 x 3/4 inch) and 1 flange nut (1/4 inch) to complete the installation of the panel assembly (Figure 30).

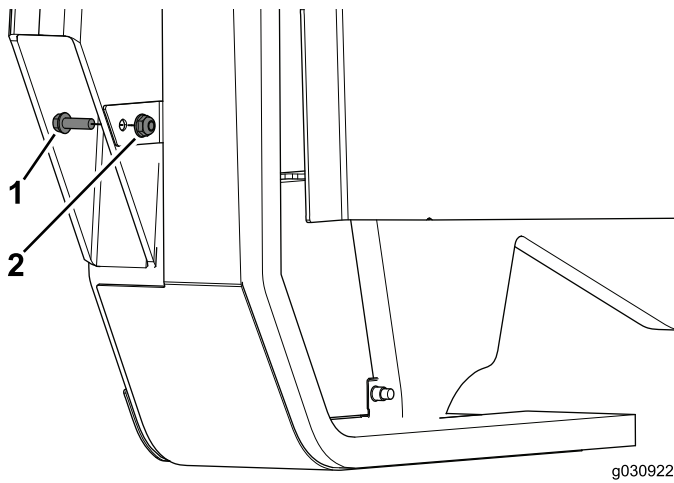

**Figure 30**

1. Bolt (1/4 x 3/4 inch)
2. Flange nut

4. Torque the bolts and nut to 1,017 to 1,243 N·cm (90 to 110 in-lb).
5. Repeat the previous steps to the right side of the cab.

## Installing the Back Panel

1. Ensure the installation area is clean.
2. Align the upholstery panel with the center of the back panel inside cab to verify its fit and placement ([Figure 31](#)).

**Note:** Remember or mark where the corner of the upholstery panel begins when it is centered across the back panel of the cab.

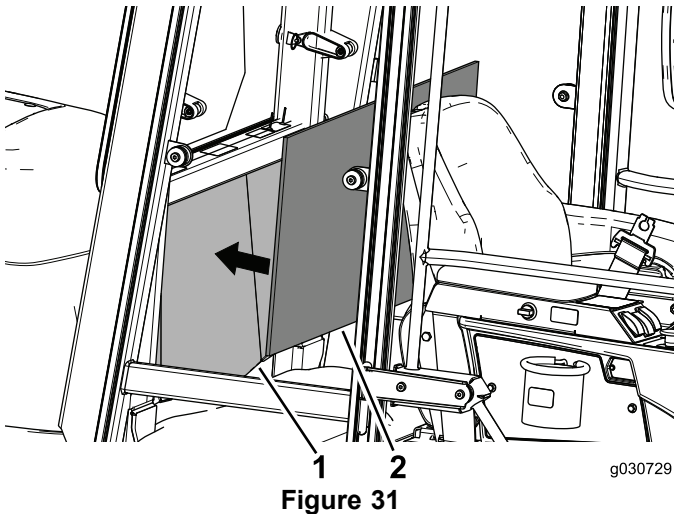

**Figure 31**

1. Cab
2. Upholstery panel

3. Remove 1 section of the backing to expose the adhesive.
4. Start with the upper corner of the upholstery panel and adhere it to the back of the cab so that it is centered once it is completely installed.

5. Adhere the panel, 1 section at a time, from one end to the other, until the upholstery panel is completely applied.

## Installing the Insulation Blanket

1. Remove the insulation blanket from the shipping tube.

**Note:** Do not unroll the insulation blanket until it is in position.

2. Position the blanket across the storage compartments behind the operators seat.
3. Tuck in the edges of the blanket around the operators seat as you unroll it toward the front of the machine.
4. Remove the backing from the adhesive on the hook and loop strips at the end of the blanket.

**Note:** Ensure the surface where the adhesive backed hook and loop strip adheres to the platform is clean.

5. Adhere the hook and loop strips firmly to the platform.

## Installing the Floor Tread

1. Ensure that the installation area is clean.
2. Install the floor tread onto the platform inside the cab.

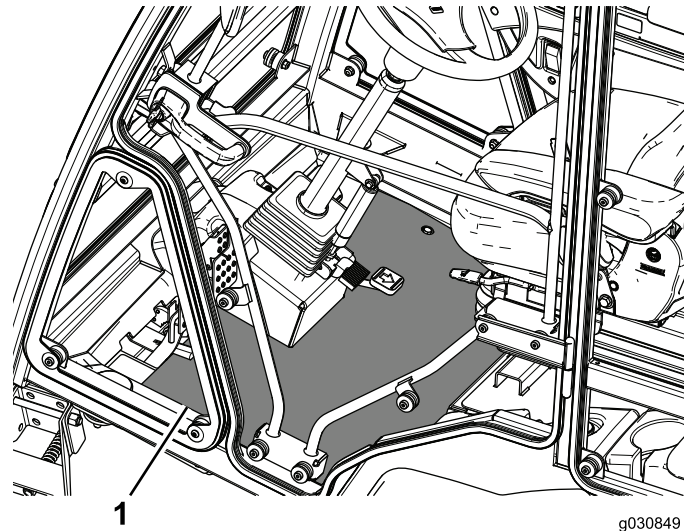

**Figure 32**

1. Floor tread

3. Ensure that the bolt heads on the platform are aligned with the cutouts in the floor tread.



# 8

## Installing the Washer Tank

Parts needed for this procedure:

|   |                                 |
|---|---------------------------------|
| 1 | Washer tank                     |
| 1 | Tank mount                      |
| 1 | Tank plate                      |
| 4 | Carriage bolt (5/16 x 3/4 inch) |
| 4 | Flange nut (5/16 inch)          |
| 1 | Swell latch                     |
| 1 | Swell-latch bushing             |
| 1 | Swell-latch nut                 |
| 1 | R-Clamp                         |

### Installing the Washer Tank and Mount

1. Use 2 carriage bolts (5/16 x 3/4 inch) and 2 flange nuts (5/16 inch) to secure the tank plate to the coolant-bottle support ([Figure 33](#))

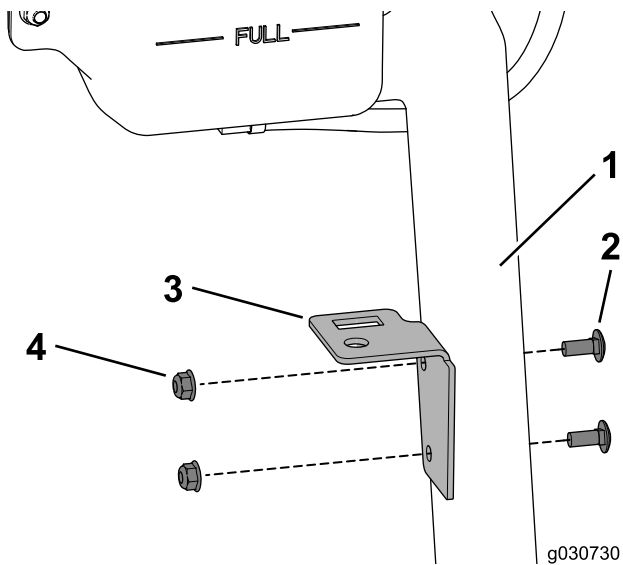

Figure 33

1. Coolant-bottle support
2. Carriage bolt (5/16 x 3/4 inch)
3. Tank plate
4. Flange nut (5/16 inch)

2. Torque the bolt and nut to 1,978 to 2,542 N·cm (175 to 225 in-lb).
3. Use 2 carriage bolts (5/16 x 3/4 inch) and 2 flange nuts (5/16 inch) to secure the washer bottle and R-clamp to the tank mount ([Figure 34](#)).

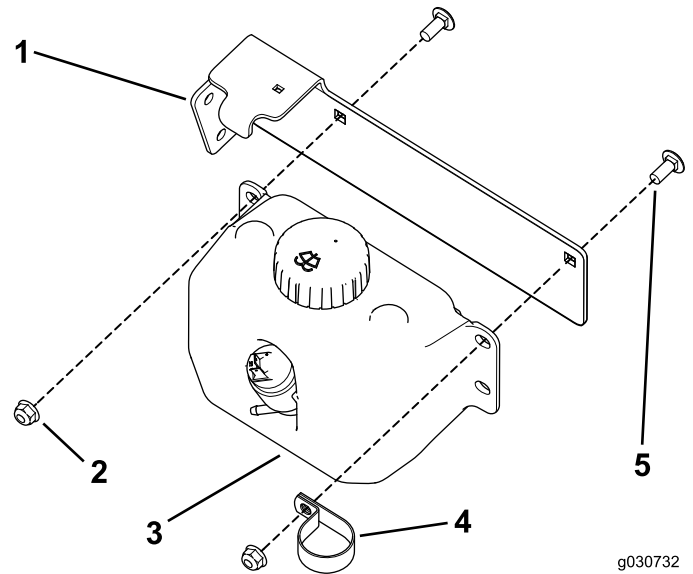

Figure 34

1. Tank mount
2. Flange nut (5/16 inch)
3. Washer bottle
4. R-clamp
5. Carriage bolt (5/16 x 3/4 inch)

4. Install the swell-latch assembly to the tank mount ([Figure 35](#)).

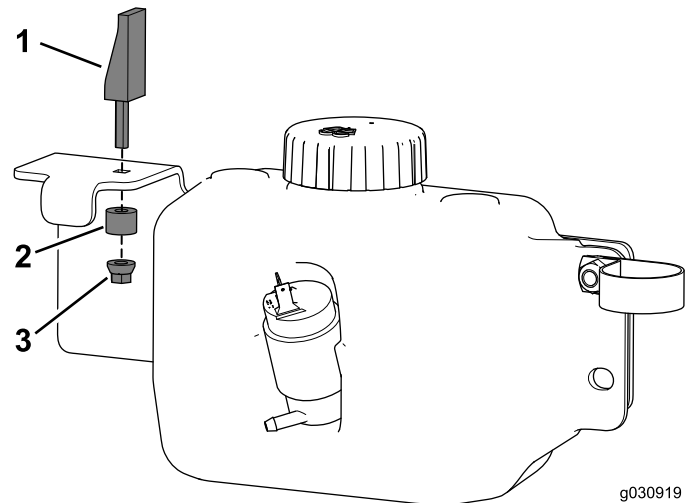
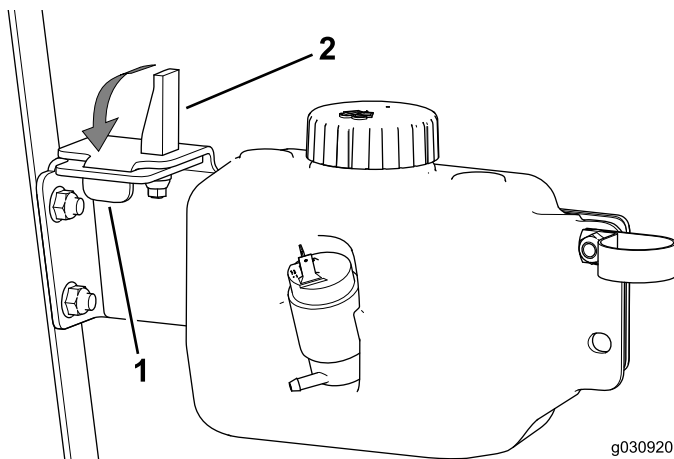

Figure 35

1. Swell latch
2. Swell-latch bushing
3. Swell-latch nut

5. Insert the tab into the slot and the swell-latch bushing into the hole in the tank plate ([Figure 36](#)).



**Figure 36**

6. Flip the swell-latch lever down (Figure 36).

**Note:** The swell latch should hold the tank mount firmly to the tank plate. Adjust the nut to change the pressure applied by the swell latch.

## 9

### Connecting the Hoses

#### Parts needed for this procedure:

|   |                                |
|---|--------------------------------|
| 2 | Fitting (3/8 NPT x 0.625 barb) |
| 2 | Hose clamp                     |
| 1 | Right-angle fitting (3/4 inch) |
| 1 | Right-angle fitting (7/8 inch) |
| 2 | R-Clamp                        |

#### Connecting the Heater Hoses

1. Apply sealant to the fitting (3/8 NPT x 0.625 barb); skipping the first thread.
2. Remove the heater supply and return hose plugs from the engine and install the fittings (3/8 NPT x 0.625 barb) as shown in Figure 37.

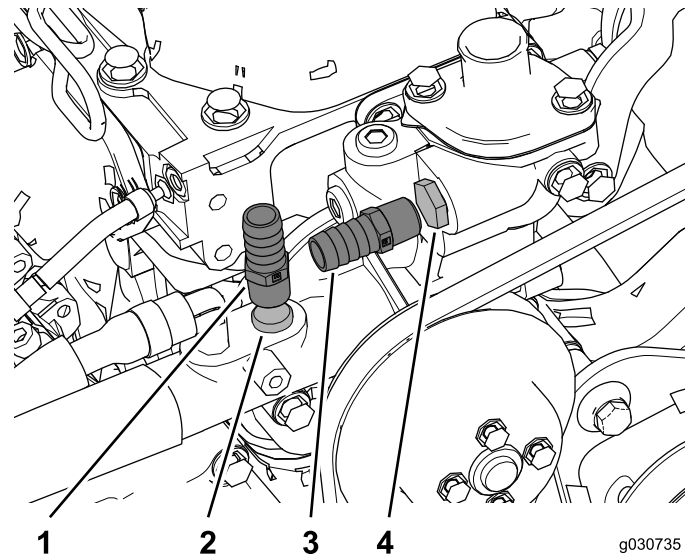

**Figure 37**

1. Fitting (3/8 NPT x 0.625 barb)
2. Return hose plug
3. Fitting (3/8 NPT x 0.625 barb)
4. Supply hose plug

3. Tighten the fittings (3/8 NPT x 0.625 barb) 2 to 3 turns past finger-tight.
4. Route the hoses for the heater and the drain hose through the hose ring on the rear cab mount (Figure 38).

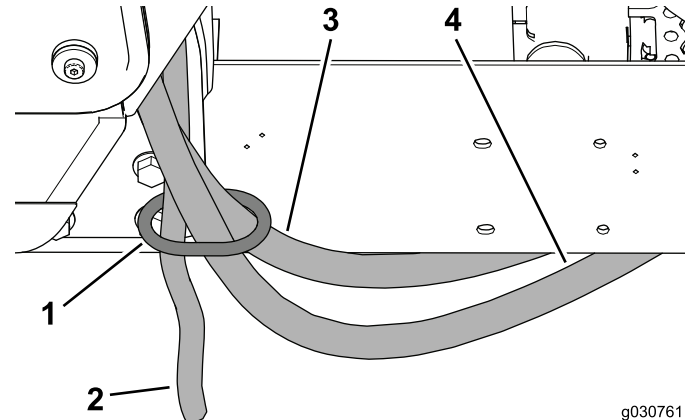
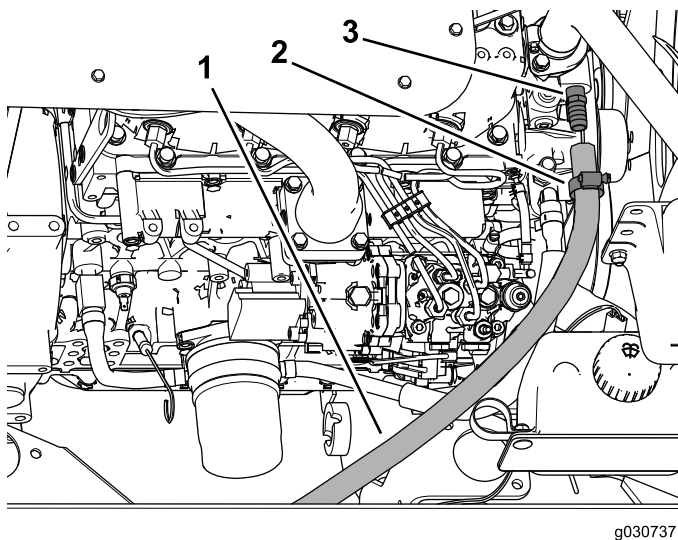

**Figure 38**

1. Hose ring
2. Drain hose
3. Heater hose
4. Drain hose

5. Slide the hose clamp over the supply hose and then insert the hose over the fitting (3/8 NPT x 0.625 barb) as shown in Figure 39.

**Note:** The supply hose is designated by a red plug at 1 end of the assembly. Remove the plug before installing the hose.

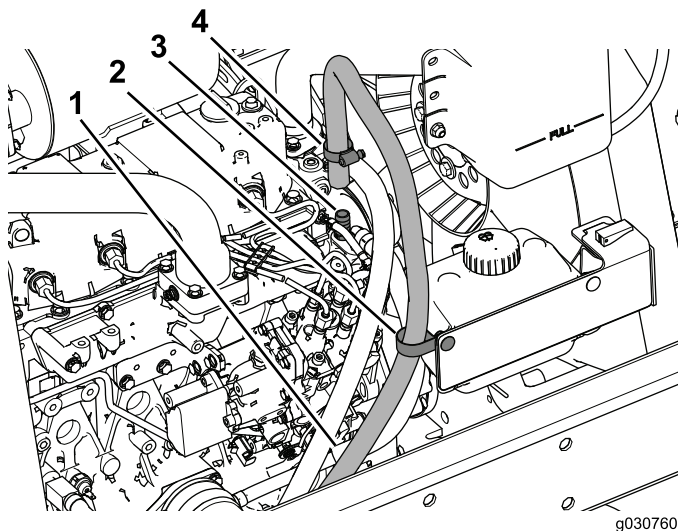

**Figure 39**

1. Heater-supply hose
2. Hose-clamp
3. Barb fitting

6. Slide the hose-clamp over the return hose and then insert the hose over the fitting (3/8 NPT x 0.625 barb) as shown in [Figure 40](#).

**Note:** The return hose is designated by a green plug at 1 end of the assembly. Remove the plug before installing the hose.

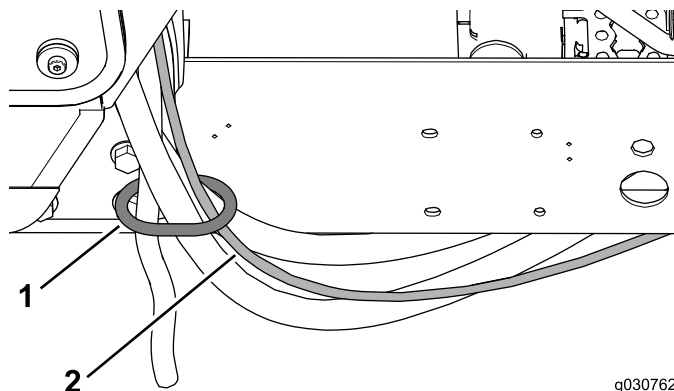

**Figure 40**

1. Heater-return hose
2. R-clamp
3. Barb fitting
4. Hose clamp

## Connecting the Washer Hose

1. Route the washer hose through the hose ring on the rear cab mount ([Figure 41](#)).



**Figure 41**

1. Hose ring
2. Washer hose

2. Route the washer hose through the R-clamp and connect it to the washer bottle ([Figure 42](#)).

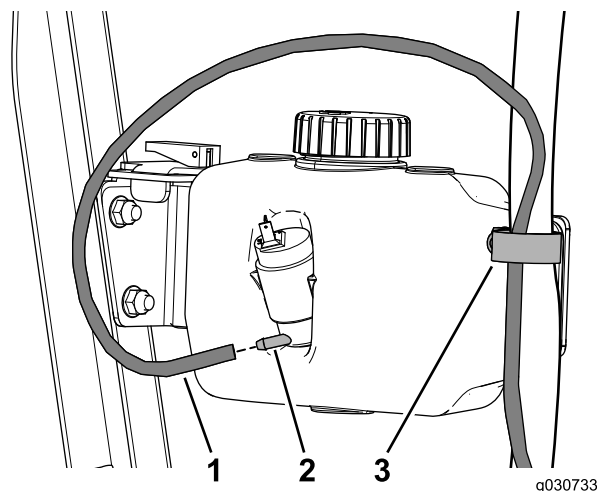

**Figure 42**

1. Washer hose
2. Bottle connection
3. R-clamp

## Installing the Air-Conditioner Fittings

**Note:** Thoroughly lubricate the O-ring before installing the fittings.

1. Install the right-angle fitting (7/8 inch) and O-ring (size 8) to the low-pressure or suction port on the air-conditioning pump ([Figure 43](#)).



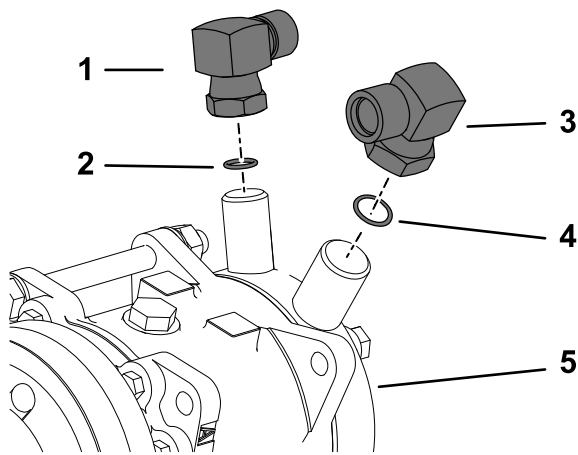

**Figure 43**

g032993

1. Right-angle fitting (3/4 inch)
2. O-ring (size 8)
3. Right-angle fitting (7/8 inch)
4. O-ring (size 10)
5. Air-conditioning pump

2. Torque the fitting to 34 to 47 N·m (25 to 35 ft-lb)
3. Install the right-angle fitting (3/4 inch) and O-ring (size 10) to the high-pressure or discharge port on the air-conditioning pump (Figure 43).
4. Torque the fitting to 34 to 47 N·m (25 to 35 ft-lb)

## Connecting the Air-Conditioning Hoses

1. Connect the air-conditioning low-pressure hose (7/8 inch) from the cab unit to the right-angle fitting (7/8 inch) as shown in Figure 44.

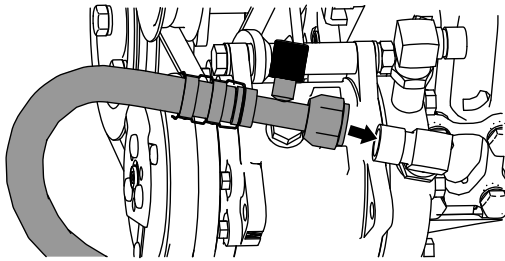

**Figure 44**

g033197

2. Torque the fitting to 34 to 47 N·m (25 to 35 ft-lb)
3. Connect the air-conditioning high-pressure hose (3/4 inch) from the cab to the right-angle fitting (3/4 inch) as shown in Figure 45.

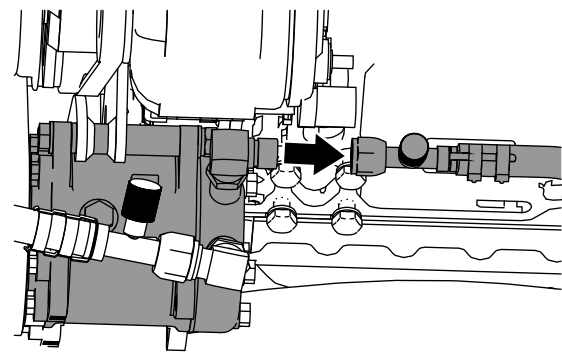

g033198

**Figure 45**

4. Torque the fitting to 34 to 47 N·m (25 to 35 ft-lb)
5. Install 1 R-clamp around each air-conditioning hose and use the 2 existing bolts to secure them to the machine frame (Figure 46).

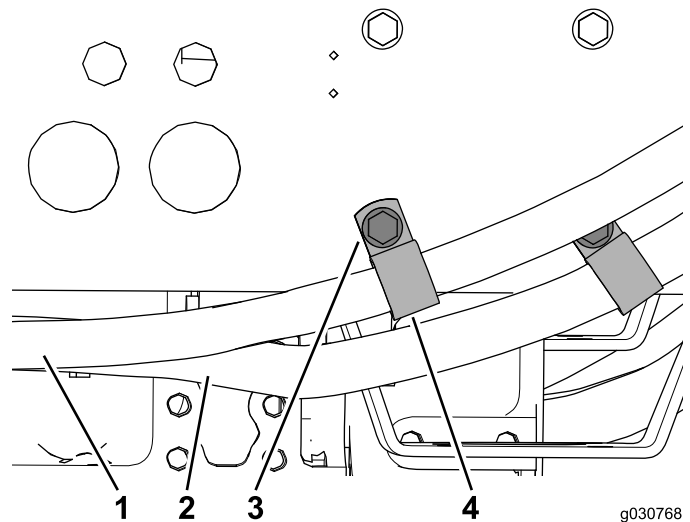

g030768

**Figure 46**

1. High-pressure hose
2. Low-pressure hose
3. Bolt (5/16 x 1 inch)
4. R-clamp

# 10

## Connecting the Wire Harness

Parts needed for this procedure:

|   |           |
|---|-----------|
| 5 | Cable tie |
|---|-----------|

### Procedure

1. Connect the wire harness from the cab to the wire harness on the right side of the machine (Figure 47).

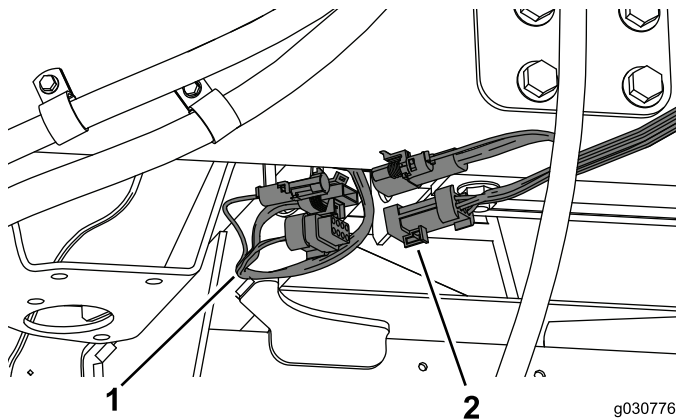

Figure 47

1. Wire harness from the machine
2. Wire harness from the cab

2. Connect the cab power connector to the connector on the right side of the machine (Figure 48).

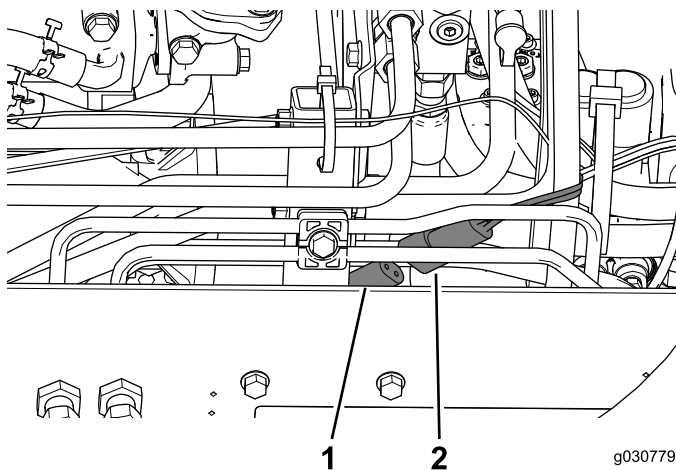

Figure 48

1. Connector from the machine
2. Connector from the cab

3. Connect the wire from the air-conditioner compressor to the bullet connector on the wire harness (Figure 49).

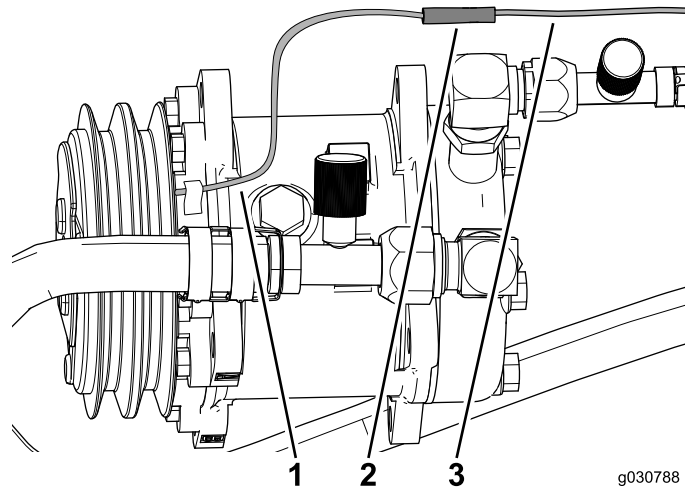

Figure 49

1. Compressor wire
2. Bullet connector
3. Wire harness

4. Route the wire harness for the washer bottle through the R-clamp and connect it to the bottle (Figure 50).

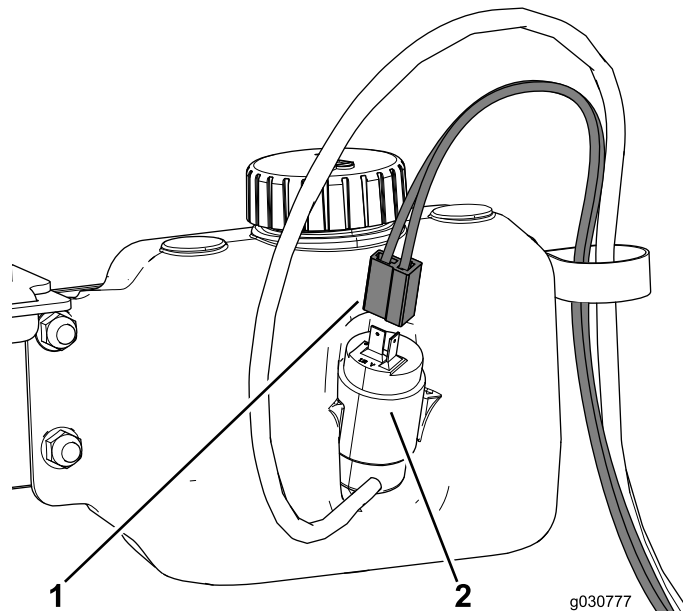

Figure 50

1. Wire harness connector
2. Washer bottle connection

5. Use cable ties to secure the wire harness to the hydraulic hoses and hard lines at the locations shown in Figure 51 and Figure 52.

# 11

## Completing the Installation

### No Parts Required

### Procedure

1. Top off the coolant to the machine; refer to the *Service Manual*
2. Check for leaks.
3. Check for parts that interfere with moving parts and make any corrections before operating the machine.
4. Check the operation of all controls before operating the machine.
5. Use an assistant to adjust the rearview and side mirrors before operating the machine.
6. Remove the chocks from the wheels.
7. Connect the negative (-) battery cable to the battery.
8. Add fluid to the washer bottle.
9. Have a certified service technician charge the AC system:
  - 3 oz of PAG 46 oil
  - 55 oz of R134A freon

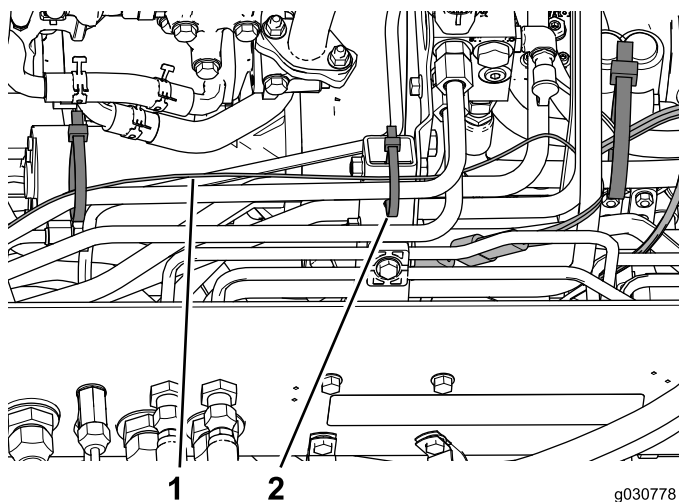

**Figure 51**

1. Wire harness
2. Cable tie

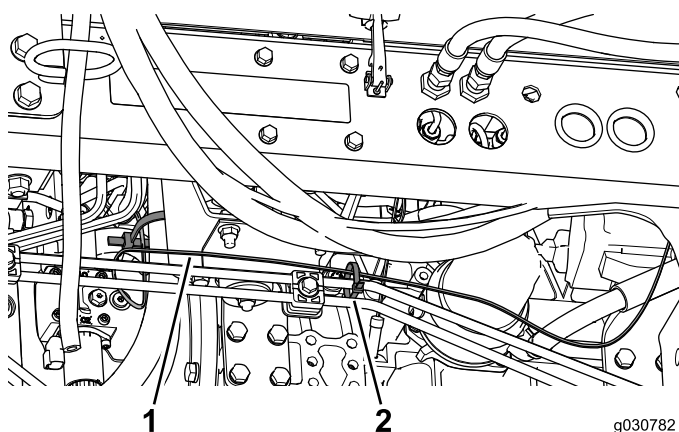

**Figure 52**

1. Wire harness
2. Cable tie

**Important:** Do not secure the wire harness to hot or moving parts.

# Product Overview

## Controls

### Cab Controls

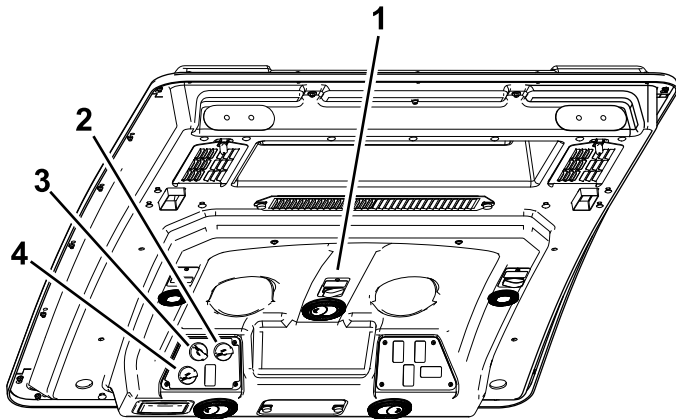

Figure 53

- |                            |                              |
|----------------------------|------------------------------|
| 1. Windshield-wiper switch | 3. Fan control               |
| 2. Temperature control     | 4. Air-recirculation control |

### Windshield-Wiper Switch

Use this switch to turn the windshield wipers on or off (Figure 53).

### Temperature Control

Rotate the temperature control knob to regulate the air temperature in the cab (Figure 53).

### Fan Control

Rotate the fan control knob to regulate the speed of the fan (Figure 53).

### Air Recirculation Control

Sets the cab to either recirculate the air in the cabin or to draw air into the cabin from outside (Figure 53).

- Set it to recirculate the air when using the air-conditioning.
- Set it to draw air in when using the heater or fan.

## Windshield Latch

Lift up the latches to open the windshield (Figure 54). Press the latch in to lock windshield to the open position. Pull out and down on the latch to close and secure the windshield.

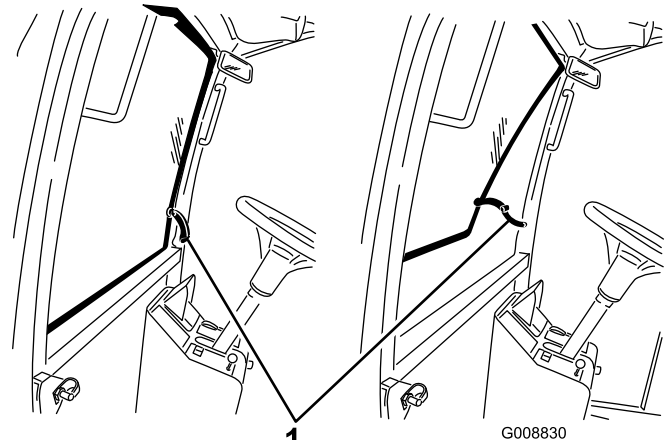

Figure 54

1. Windshield latch

## Rear-Window Latch

Lift up on the latches to open the rear window. Pull the latch up and out to lock the window in the open position. Pull the latch out and down to close and secure the window (Figure 54).

**Important:** Close the rear window before you open the hood to prevent any damage.

# Maintenance

## Recommended Maintenance Schedule(s)

| Maintenance Service Interval | Maintenance Procedure   |
|------------------------------|---|
| After the first 250 hours    | <ul style="list-style-type: none"><li>• Clean the cab air filters (replace them if they are torn or excessively dirty)</li></ul>                |
| Every 250 hours              | <ul style="list-style-type: none"><li>• Clean the air-conditioning assembly (more frequently in extremely dusty or dirty conditions).</li></ul> |

## Cleaning

### ⚠ CAUTION

If you leave the key in the ignition switch, someone could accidentally start the engine and seriously injure you or other bystanders.

Remove the key from the ignition before you do any maintenance.

## Cleaning the Cab

**Important:** Use care around the cab seals and lights (Figure 55). If you are using a pressure washer, keep the washer wand at least 0.6 m (2 ft) away from the machine. Do not use the pressure washer directly on the cab seals and lights or under the rear overhang.

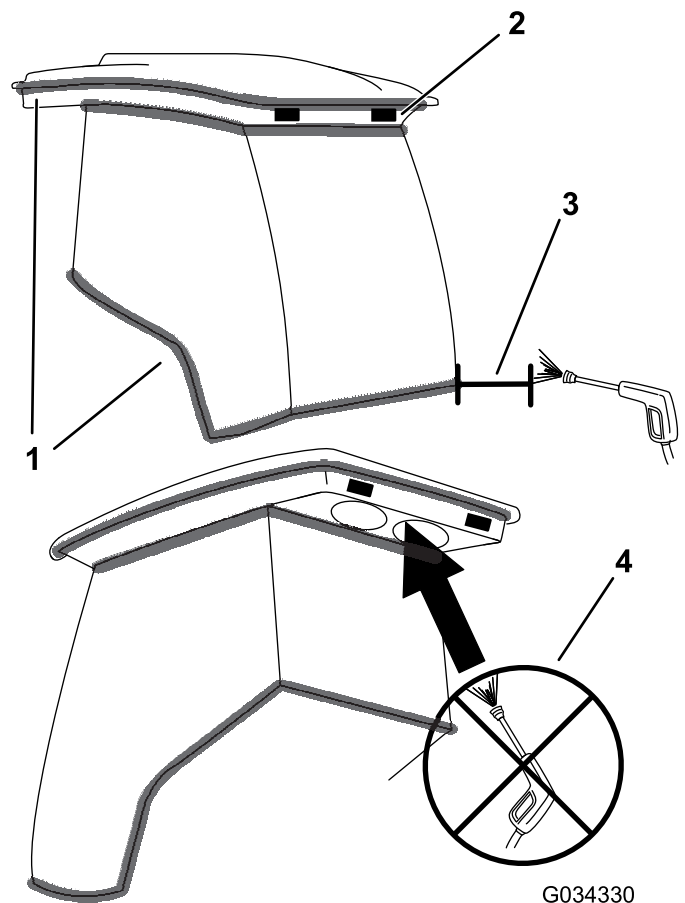

Figure 55

1. Seal
2. Light
3. Keep wand 0.6 m (2 ft) away.
4. Do not pressure-wash under the rear overhang.

# Cleaning the Air Filters

**Service Interval:** After the first 250 hours (replace them if they are torn or excessively dirty)

1. Remove the thumb screws and the grates from both the in-cab and rear cab air filters (Figure 56 and Figure 57).

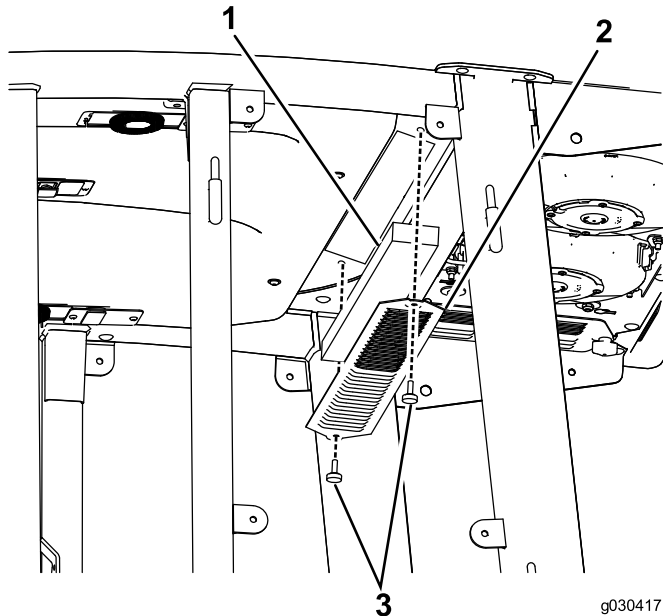

**Figure 56**

1. Filter
2. Grate
3. Thumb screw

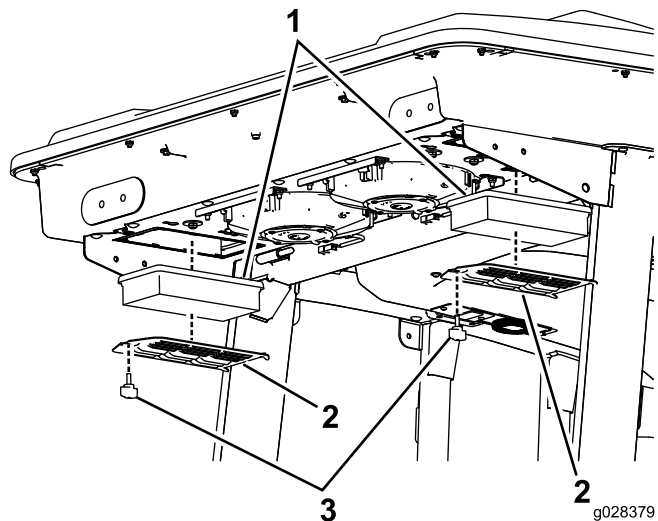

**Figure 57**

1. Filter
2. Grate
3. Thumb screw

2. Clean the filters by blowing clean, oil free, compressed air through them.

**Important:** If either filter has a hole, tear, or other damage, replace it.

3. Install the filters and grate, securing them with the thumb screws.

# Cleaning the Air-Conditioning Assembly

**Service Interval:** Every 250 hours (more frequently in extremely dusty or dirty conditions).

1. Stop the engine and remove the key.
2. Disconnect the wire for each fan (Figure 58).

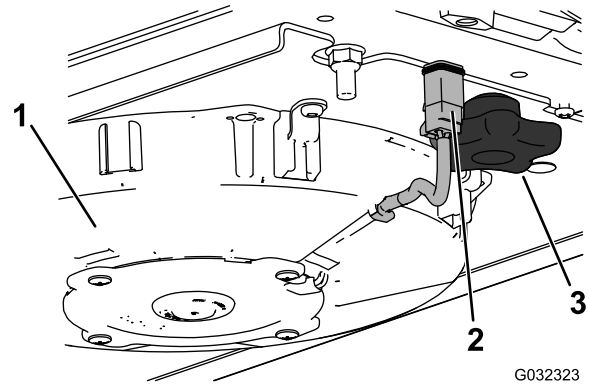

**Figure 58**  
Right fan shown

1. Fan
2. Wire
3. Knob

3. Remove the 2 knobs and remove the fan assembly (Figure 58).
4. Open the 4 latches on the air-conditioning assembly and remove the screen (Figure 59).

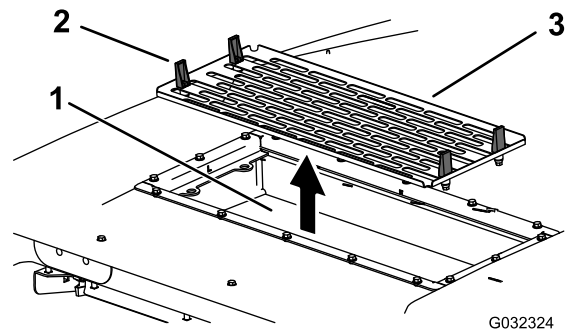
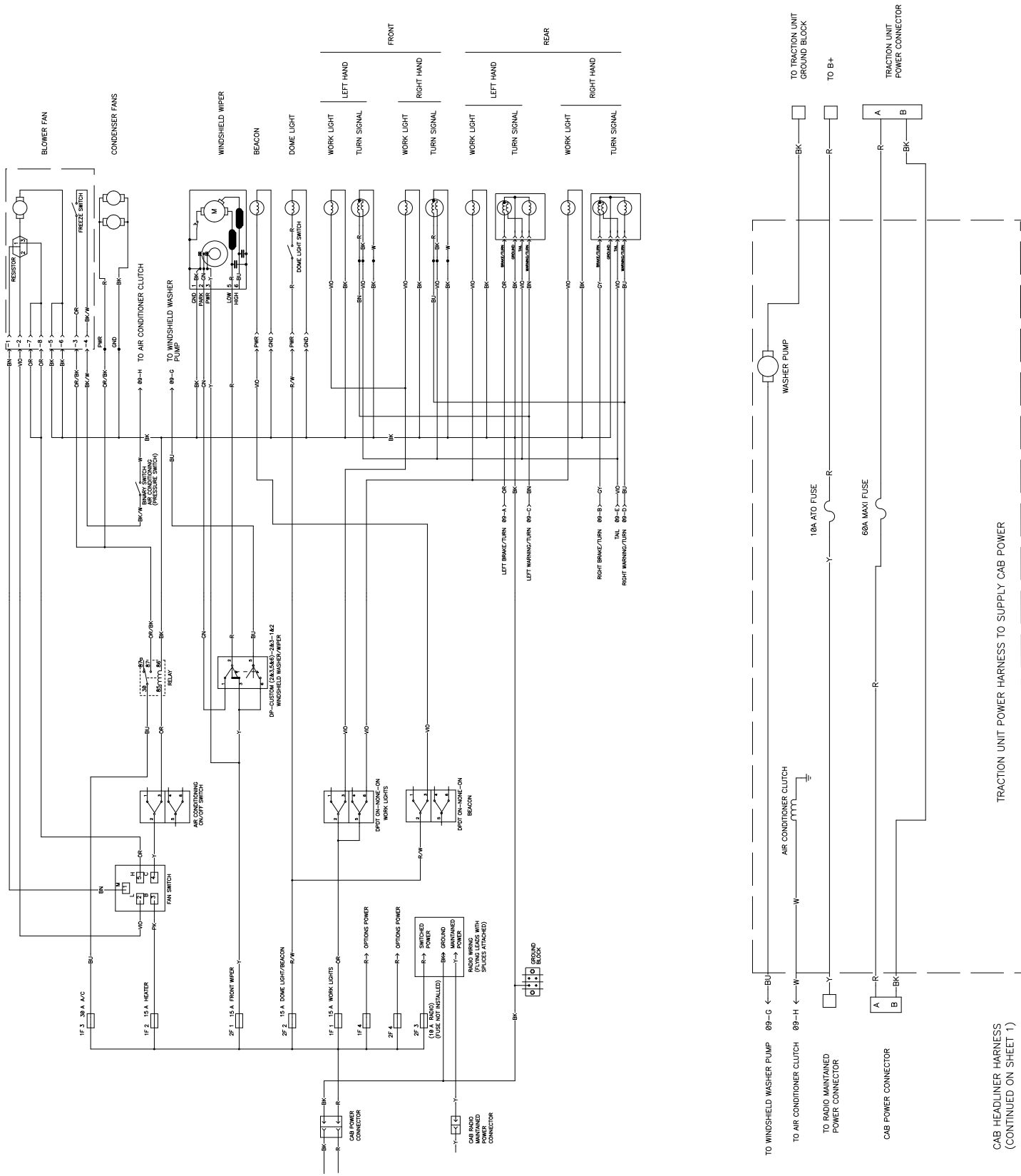

**Figure 59**

1. Air-conditioning coil
2. Latch
3. Air-conditioning screen

5. Remove the air filters (see Figure 57).
6. Clean the air-conditioning assembly.
7. Install the air filters, screen, and fan assembly (Figure 57, Figure 59, and Figure 58).
8. Connect the wire for each fan (Figure 58).

# Schematics



Electrical Schematic (Rev. A)

**Notes:**



**Notes:**

**Notes:**

# Declaration of Incorporation

| Model No. | Serial No.       | Product Description   | Invoice Description | General Description | Directive                  |
|-----------|------------------|---|---------------------|---------------------|----------------------------|
| 30901     | 316000001 and Up | Cab Kit, 2015 and After<br>Groundsmaster 4500/4700-D<br>or Reelmaster 7000-D<br>Traction Unit | CAB-GM4500/4700     | Utility Vehicle     | 2006/42/EC,<br>2004/108/EC |

Relevant technical documentation has been compiled as required per Part B of Annex VII of 2006/42/EC.

We will undertake to transmit, in response to requests by national authorities, relevant information on this partly completed machinery. The method of transmission shall be electronic transmittal.

This machinery shall not be put into service until incorporated into approved Toro models as indicated on the associated Declaration of Conformity and in accordance with all instructions, whereby it can be declared in conformity with all relevant Directives.

Certified:



David Klis  
Sr. Engineering Manager  
8111 Lyndale Ave. South  
Bloomington, MN 55420, USA  
February 8, 2016

EU Technical Contact:

Marcel Dutrieux  
Manager European Product Integrity  
Toro Europe NV  
Nijverheidsstraat 5  
2260 Oevel  
Belgium

Tel. +32 16 386 659



## The Toro Warranty

### A Two-Year Limited Warranty

#### Conditions and Products Covered

The Toro Company and its affiliate, Toro Warranty Company, pursuant to an agreement between them, jointly warrant your Toro Commercial product ("Product") to be free from defects in materials or workmanship for two years or 1500 operational hours\*, whichever occurs first. This warranty is applicable to all products with the exception of Aerators (refer to separate warranty statements for these products). Where a warrantable condition exists, we will repair the Product at no cost to you including diagnostics, labor, parts, and transportation. This warranty begins on the date the Product is delivered to the original retail purchaser.

\* Product equipped with an hour meter.

#### Instructions for Obtaining Warranty Service

You are responsible for notifying the Commercial Products Distributor or Authorized Commercial Products Dealer from whom you purchased the Product as soon as you believe a warrantable condition exists. If you need help locating a Commercial Products Distributor or Authorized Dealer, or if you have questions regarding your warranty rights or responsibilities, you may contact us at:

Toro Commercial Products Service Department  
Toro Warranty Company  
8111 Lyndale Avenue South  
Bloomington, MN 55420-1196  
  
952-888-8801 or 800-952-2740  
E-mail: commercial.warranty@toro.com

#### Owner Responsibilities

As the Product owner, you are responsible for required maintenance and adjustments stated in your *Operator's Manual*. Failure to perform required maintenance and adjustments can be grounds for disallowing a warranty claim.

#### Items and Conditions Not Covered

Not all product failures or malfunctions that occur during the warranty period are defects in materials or workmanship. This warranty does not cover the following:

- Product failures which result from the use of non-Toro replacement parts, or from installation and use of add-on, or modified non-Toro branded accessories and products. A separate warranty may be provided by the manufacturer of these items.
- Product failures which result from failure to perform recommended maintenance and/or adjustments. Failure to properly maintain your Toro product per the Recommended Maintenance listed in the *Operator's Manual* can result in claims for warranty being denied.
- Product failures which result from operating the Product in an abusive, negligent, or reckless manner.
- Parts subject to consumption through use unless found to be defective. Examples of parts which are consumed, or used up, during normal Product operation include, but are not limited to, brake pads and linings, clutch linings, blades, reels, rollers and bearings (sealed or greasable), bed knives, spark plugs, castor wheels and bearings, tires, filters, belts, and certain sprayer components such as diaphragms, nozzles, and check valves, etc.
- Failures caused by outside influence. Conditions considered to be outside influence include, but are not limited to, weather, storage practices, contamination, use of unapproved fuels, coolants, lubricants, additives, fertilizers, water, or chemicals, etc.
- Failure or performance issues due to the use of fuels (e.g. gasoline, diesel, or biodiesel) that do not conform to their respective industry standards.

- Normal noise, vibration, wear and tear, and deterioration.
- Normal "wear and tear" includes, but is not limited to, damage to seats due to wear or abrasion, worn painted surfaces, scratched decals or windows, etc.

#### Parts

Parts scheduled for replacement as required maintenance are warranted for the period of time up to the scheduled replacement time for that part. Parts replaced under this warranty are covered for the duration of the original product warranty and become the property of Toro. Toro will make the final decision whether to repair any existing part or assembly or replace it. Toro may use remanufactured parts for warranty repairs.

#### Deep Cycle and Lithium-Ion Battery Warranty:

Deep cycle and Lithium-Ion batteries have a specified total number of kilowatt-hours they can deliver during their lifetime. Operating, recharging, and maintenance techniques can extend or reduce total battery life. As the batteries in this product are consumed, the amount of useful work between charging intervals will slowly decrease until the battery is completely worn out. Replacement of worn out batteries, due to normal consumption, is the responsibility of the product owner. Battery replacement may be required during the normal product warranty period at owner's expense. Note: (Lithium-Ion battery only): A Lithium-Ion battery has a part only prorated warranty beginning year 3 through year 5 based on the time in service and kilowatt hours used. Refer to the *Operator's Manual* for additional information.

#### Maintenance is at Owner's Expense

Engine tune-up, lubrication, cleaning and polishing, replacement of filters, coolant, and completing recommended maintenance are some of the normal services Toro products require that are at the owner's expense.

#### General Conditions

Repair by an Authorized Toro Distributor or Dealer is your sole remedy under this warranty.

**Neither The Toro Company nor Toro Warranty Company is liable for indirect, incidental or consequential damages in connection with the use of the Toro Products covered by this warranty, including any cost or expense of providing substitute equipment or service during reasonable periods of malfunction or non-use pending completion of repairs under this warranty. Except for the Emissions warranty referenced below, if applicable, there is no other express warranty. All implied warranties of merchantability and fitness for use are limited to the duration of this express warranty.**

Some states do not allow exclusions of incidental or consequential damages, or limitations on how long an implied warranty lasts, so the above exclusions and limitations may not apply to you. This warranty gives you specific legal rights, and you may also have other rights which vary from state to state.

#### Note regarding engine warranty:

The Emissions Control System on your Product may be covered by a separate warranty meeting requirements established by the U.S. Environmental Protection Agency (EPA) and/or the California Air Resources Board (CARB). The hour limitations set forth above do not apply to the Emissions Control System Warranty. Refer to the Engine Emission Control Warranty Statement supplied with your product or contained in the engine manufacturer's documentation for details.

#### Countries Other than the United States or Canada

Customers who have purchased Toro products exported from the United States or Canada should contact their Toro Distributor (Dealer) to obtain guarantee policies for your country, province, or state. If for any reason you are dissatisfied with your Distributor's service or have difficulty obtaining guarantee information, contact the Toro importer.