



Weight Bracket Kit

Groundsmaster® 7200 Series Mower with Polar Trac® Cab

Model No. 132-8170

Model No. 132-8174

Installation Instructions

Installation

Loose Parts

Use the chart below to verify that all parts have been shipped.

Procedure	Description	Qty.	Use
1	Left weight bracket	1	Install the weight bracket for a Toro cab.
	Right weight bracket	1	
	Weight lock	2	
	Flange nut (3/8 inch)	4	
	Carriage bolt (1/2 x 1-1/2 inches)	5	
	Locknut (1/2 inch)	5	
2	Left weight bracket	1	Install the weight brackets.
	Right weight bracket	1	
	Weight lock	2	
	Flange nut (3/8 inch)	4	
	Carriage bolt (1/2 x 3 inches)	2	
	Carriage bolt (1/2 x 3-1/2 inches)	2	
	Locknut (1/2 inch)	4	
	Washer	2	

⚠ WARNING

CALIFORNIA Proposition 65 Warning

This product contains a chemical or chemicals known to the State of California to cause cancer, birth defects, or reproductive harm.



1

Installing the Weight Brackets for Polar Track Cab

2015 and After Cabs

Parts needed for this procedure:

1	Left weight bracket
1	Right weight bracket
2	Weight lock
4	Flange nut (3/8 inch)
5	Carriage bolt (1/2 x 1-1/2 inches)
5	Locknut (1/2 inch)

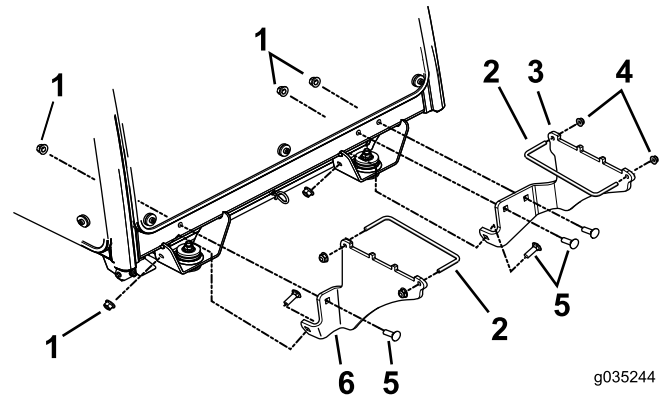

Figure 2

- | | |
|-------------------------|---------------------------------------|
| 1. Locknut (1/2 inch) | 4. Flange nut (3/8 inch) |
| 2. Weight lock | 5. Carriage bolt (1/2 x 1-1/2 inches) |
| 3. Right weight bracket | 6. Left weight bracket |

Procedure

1. Mark the location and drill the holes into the cab as shown in [Figure 1](#).

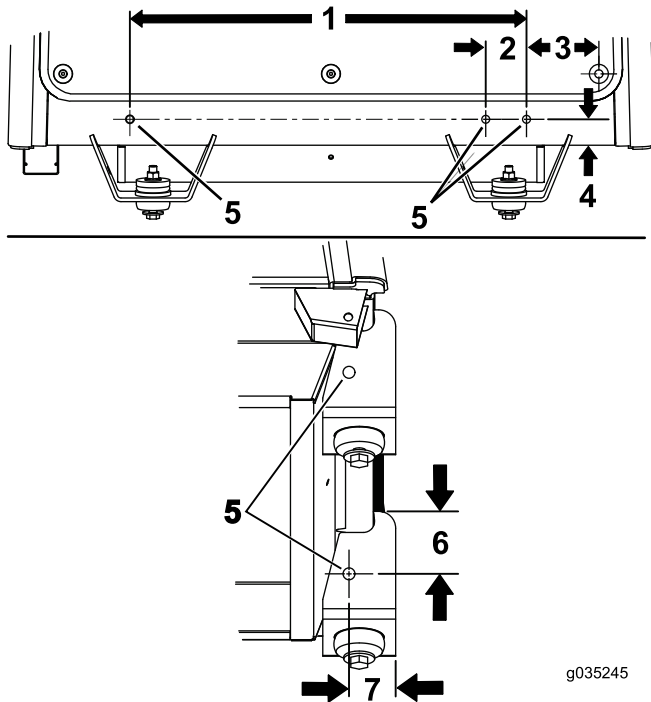

Figure 1

- | | |
|--------------------------|---|
| 1. 68 cm (26-3/4 inches) | 5. Mark and drill 17/32 inch holes here |
| 2. 70 mm (2-3/4 inches) | 6. 71 mm (21/64 inches) |
| 3. 124 mm (4-7/8 inches) | 7. 53 mm (19/64 inches) |
| 4. 44 mm (1-3/4 inches) | |

2. Install the weight brackets as shown in [Figure 2](#).

2

Installing the Weight Brackets for Polar Track Cab

2014 and Before Cabs

Parts needed for this procedure:

1	Left weight bracket
1	Right weight bracket
2	Weight lock
4	Flange nut (3/8 inch)
2	Carriage bolt (1/2 x 3 inches)
2	Carriage bolt (1/2 x 3-1/2 inches)
4	Locknut (1/2 inch)
2	Washer

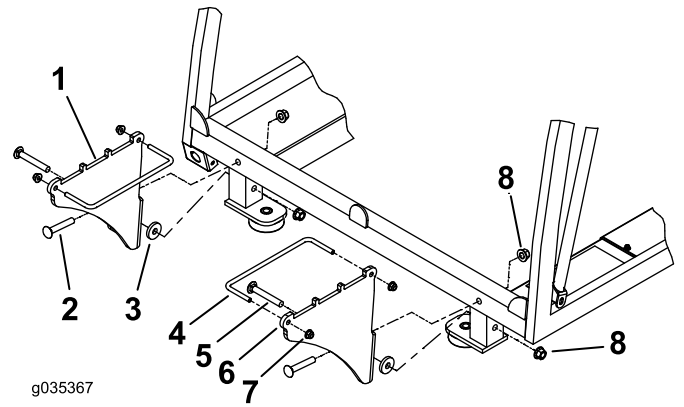

Figure 4

- | | |
|-----------------------------------|---------------------------------------|
| 1. Left weight bracket | 5. Carriage bolt (1/2 x 3-1/2 inches) |
| 2. Carriage bolt (1/2 x 3 inches) | 6. Right weight bracket |
| 3. Washer | 7. Flange nut (3/8 inch) |
| 4. Weight lock | 8. Locknut (1/2 inch) |

Procedure

1. Mark the location and drill the holes into the cab as shown in [Figure 3](#).

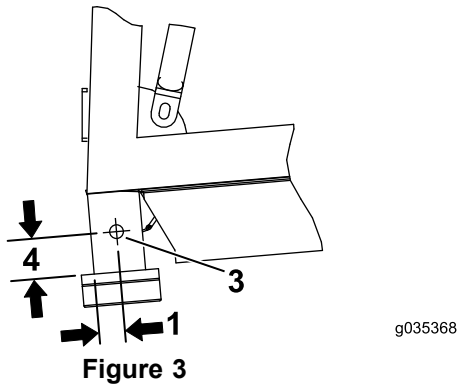
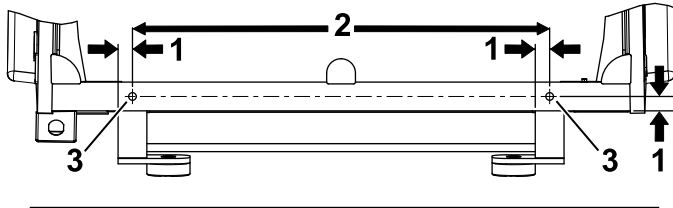

Figure 3

- | | |
|----------------------|---|
| 1. 25 mm (1 inch) | 3. Mark and drill 17/32 inch holes here |
| 2. 74 cm (29 inches) | 4. 40 mm (1-9/16 inches) |

2. Install the weight brackets as shown in [Figure 4](#).



Count on it.