



LED Work Light Kit

Workman® MD or HD Series Utility Vehicle

Model No. 133-0554

Installation Instructions

⚠ WARNING

CALIFORNIA Proposition 65 Warning

This product contains a chemical or chemicals known to the State of California to cause cancer, birth defects, or reproductive harm.

Safety

Safety and Instructional Decals



Safety decals and instructions are easily visible to the operator and are located near any area of potential danger. Replace any decal that is damaged or lost.



107-8008

1. Work light—rear 2. Work lights—front



107-8011

1. Work-light fuse—15 A



Installation

Loose Parts

Use the chart below to verify that all parts have been shipped.

Procedure	Description	Qty.	Use
1	No parts required	–	Prepare the machine.
2	Wire harness Cable tie	1 8	Route the wire harness.
3	LED work light Light channel Work-light bracket Spring washer Hex-head bolt (5/16 x 3/4 inch) Locknut (5/16 inch) Light-channel-mount bracket Hex-head bolt (1/4 x 2-3/4 inches) Flat washer (1/4 inch) Flange nut (1/4 inch)	3 2 1 6 4 4 4 4 4 4	Install the LED work lights.
4	Rocker switch Work-light decal	1 1	Install the rocker switch.
5	Fuse (15 A) Fuse decal	1 1	Connect the wire harness to the ground-block terminal and install the fuse.
6	No parts required	–	Connect the battery.
7	No parts required	–	Test the LED work lights.

1

Preparing the Machine

No Parts Required

Procedure

1. Park the machine on a level surface, set the parking brake, shut off the engine, and remove the key.
2. Disconnect the negative battery cable; refer to your *Operator's Manual*.
3. Open the hood.

2

Routing the Wire Harness

Parts needed for this procedure:

1	Wire harness
8	Cable tie

For MD Utility Vehicles

Route the wire harness as shown in [Figure 1](#) and secure the wire harness to the machine with cable ties as necessary.

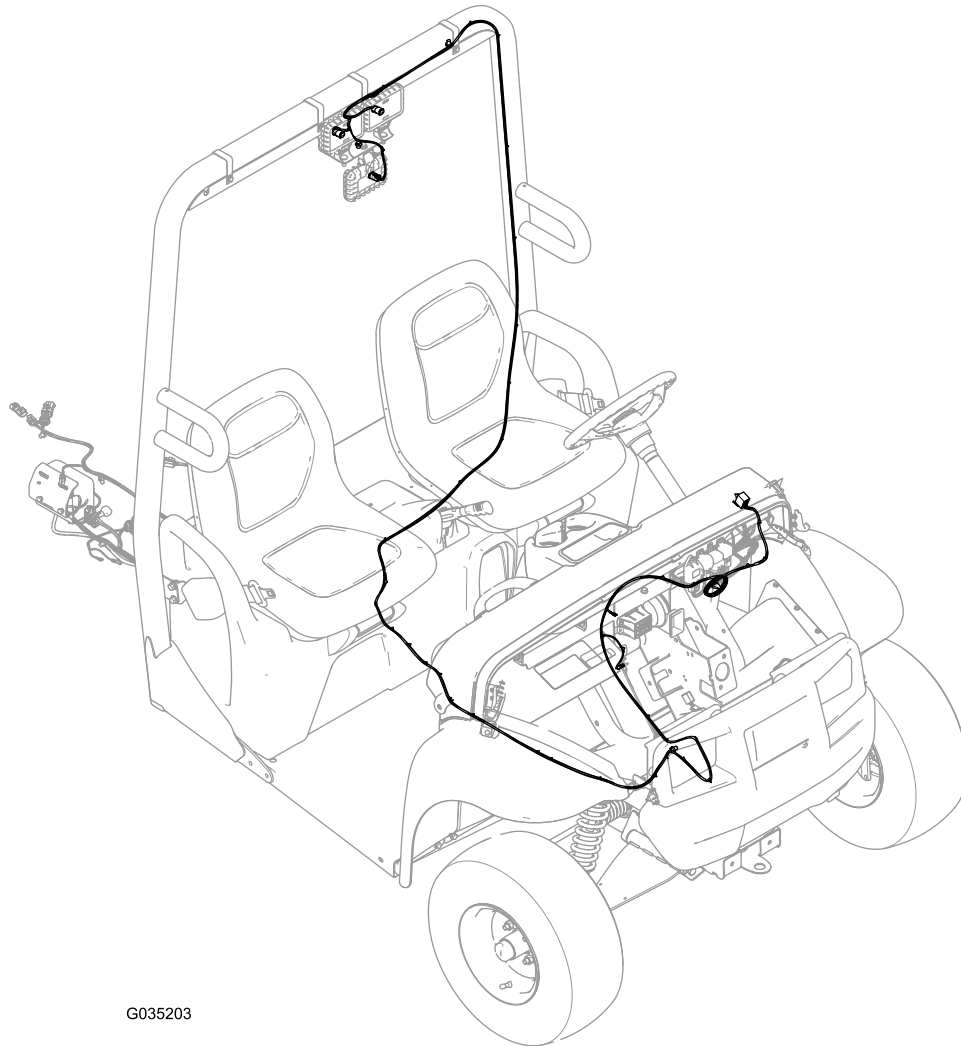

G035203

Figure 1

For HD Utility Vehicles

Route the wire harness as shown in [Figure 2](#) and secure the wire harness to the machine with cable ties as necessary.

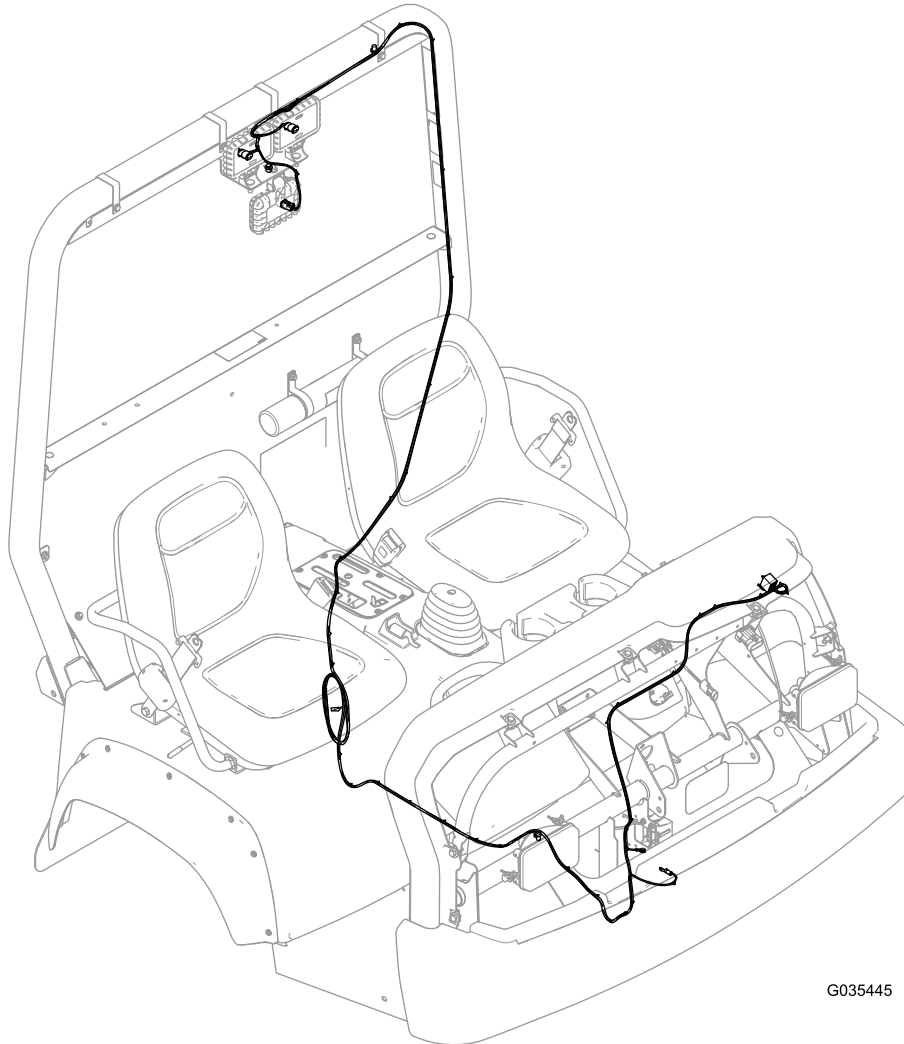

G035445

Figure 2

3

Installing the LED Work Lights

Parts needed for this procedure:

3	LED work light
2	Light channel
1	Work-light bracket
6	Spring washer
4	Hex-head bolt (5/16 x 3/4 inch)
4	Locknut (5/16 inch)
4	Light-channel-mount bracket
4	Hex-head bolt (1/4 x 2-3/4 inches)
4	Flat washer (1/4 inch)
4	Flange nut (1/4 inch)

Procedure

1. Install the work-light bracket to the 2 light channels with the 4 hex-head bolts (5/16 x 3/4 inch) and 4 locknuts (5/16 inch) as shown in [Figure 3](#).

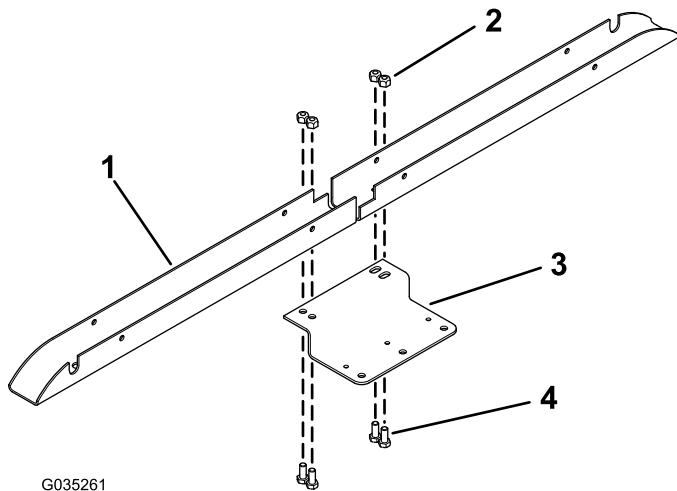

Figure 3

1. Light channel
2. Locknut (5/16 inch)
3. Work-light bracket
4. Hex-head bolt (5/16 x 3/4 inch)

2. Secure the 2 light channels to the ROPS with the 4 light-channel-mount brackets, 4 hex-head bolts (1/4 x 2-3/4 inches), 4 flat washers (1/4 inch), and 4 flange nuts (1/4 inch) as shown in [Figure 4](#).

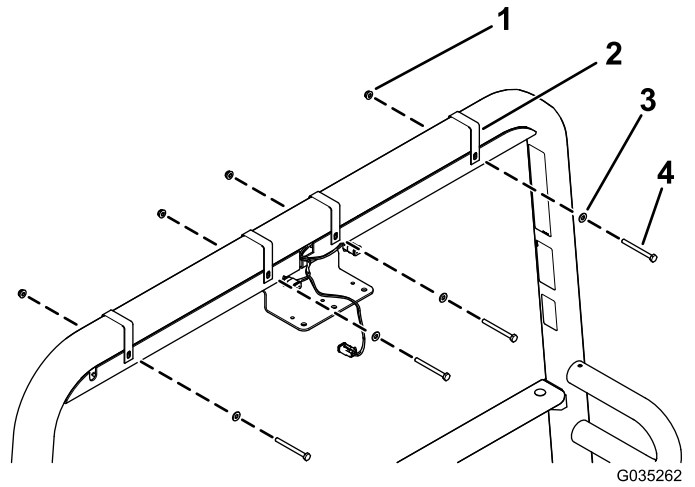

Figure 4

1. Flange nut (1/4 inch)
2. Light-channel-mount bracket
3. Flat washer (1/4 inch)
4. Hex-head bolt (1/4 x 2-3/4 inches)

3. Install the 3 LED work lights to the work-light bracket with the 3 flange nuts (already installed on the LED work lights) and the 6 spring washers ([Figure 5](#)).

Note: Ensure that each spring washer is positioned so that the convex side faces the flange nut as shown in [Figure 5](#).

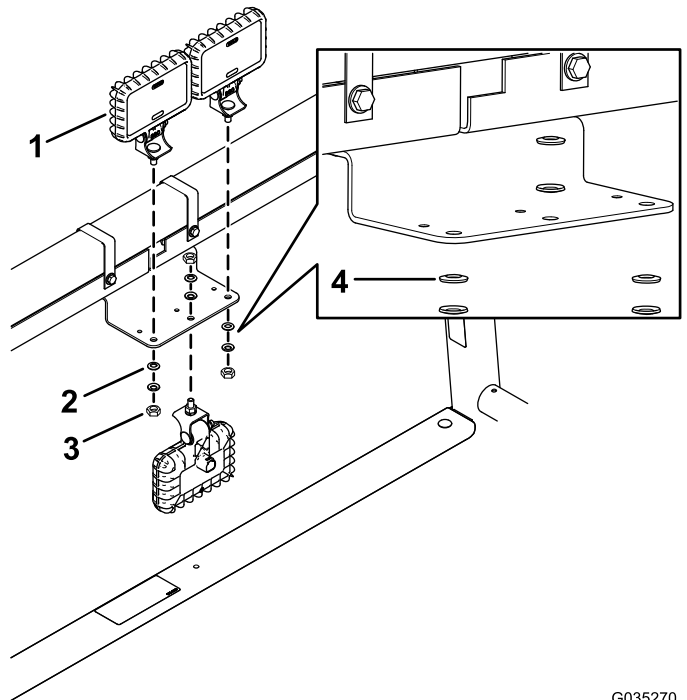

Figure 5

1. LED work light
2. Spring washer
3. Flange nut
4. Note the orientation of the spring washers.

4. Connect the 3 wire-harness connectors to the 3 openings in the 3 LED work lights ([Figure 6](#)).

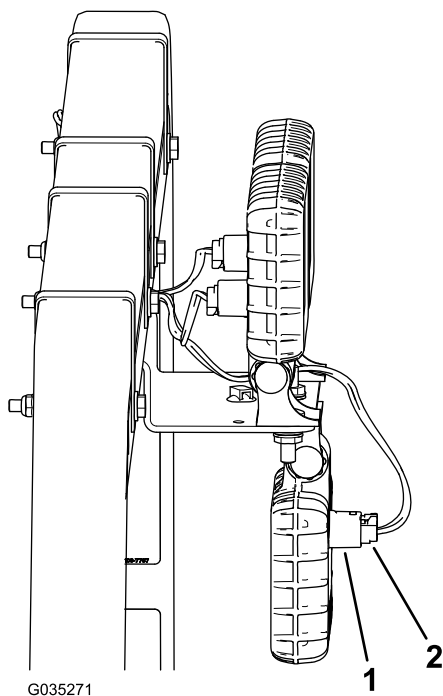

Figure 6

1. Opening in the LED work light
2. Wire-harness connector

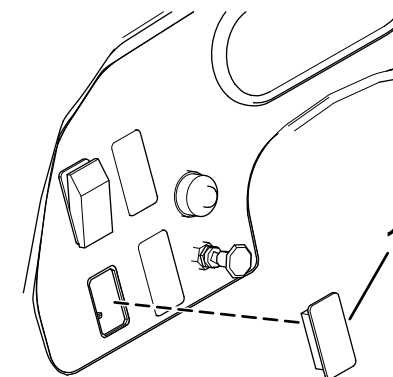
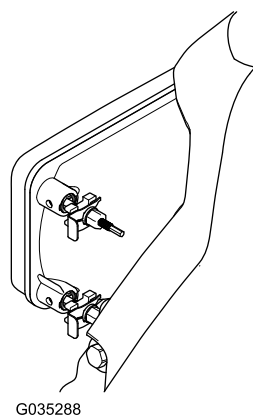

Figure 7

1. Plastic plug

2. Insert the rocker switch into the opening and apply the work-light decal to the left of the rocker switch ([Figure 8](#)).

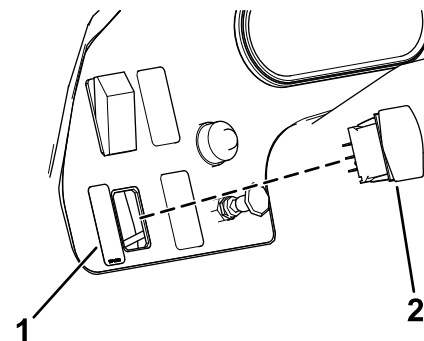
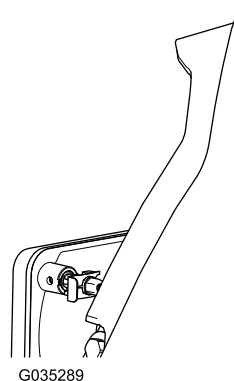

Figure 8

1. Work-light decal
2. Rocker switch

3. Connect the female connector attached to the wire harness to the rocker-switch blades ([Figure 9](#)).

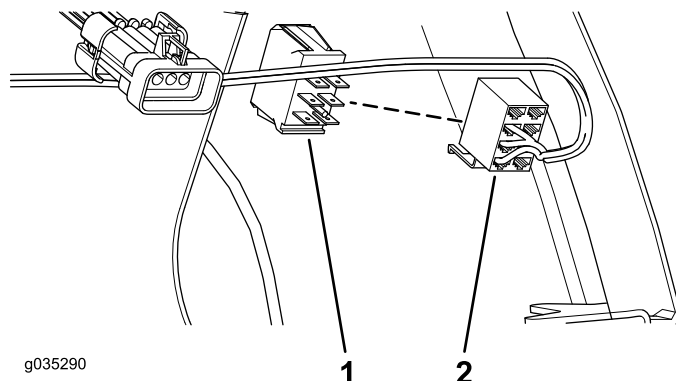

Figure 9

1. Rocker-switch blades
2. Female connector

4

Installing the Rocker Switch

Parts needed for this procedure:

1	Rocker switch
1	Work-light decal

Procedure

1. Remove the plastic plug from the left side of the dash ([Figure 7](#)).

5

Connecting the Wire Harness to the Ground-Block Terminal and Installing the Fuse

Parts needed for this procedure:

1	Fuse (15 A)
1	Fuse decal

Procedure

1. Insert the fuse (15 A) into the fuse block and apply the fuse decal beneath the fuse block (Figure 10 or Figure 11).

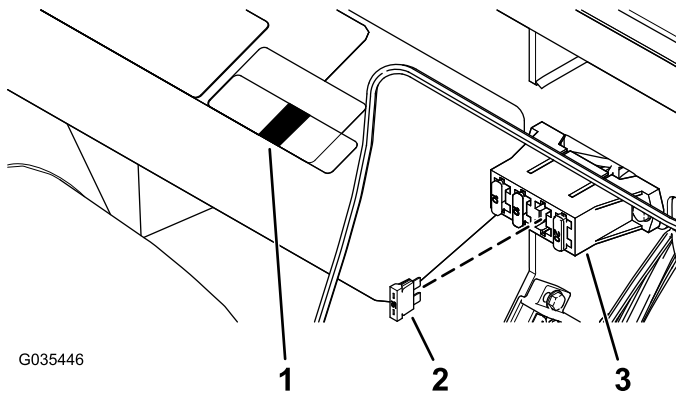

Figure 10
MD Model Shown

1. Fuse decal
2. Fuse (15 A)
3. Fuse block

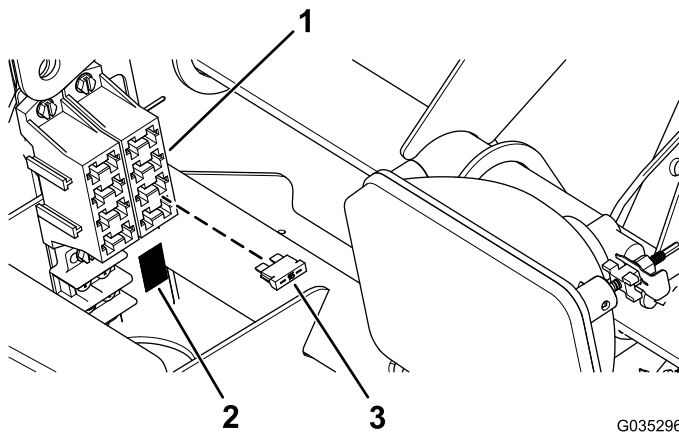

Figure 11
HD Model Shown

1. Fuse block
2. Fuse decal
3. Fuse (15 A)

2. Connect the wire-harness-terminal ring to the ground-block terminal (Figure 12 or Figure 13).

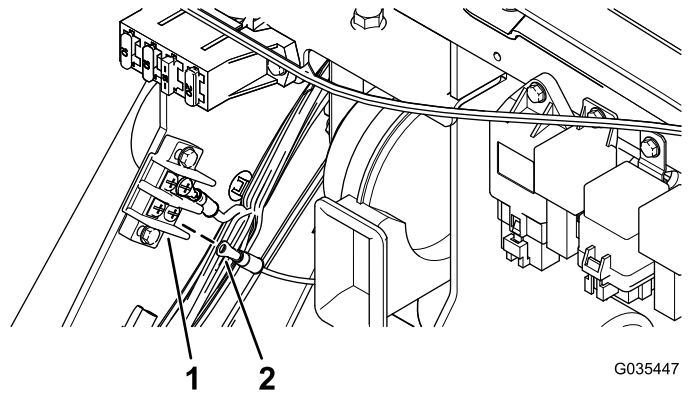

Figure 12
MD Model Shown

1. Ground-block terminal
2. Wire-harness-terminal ring

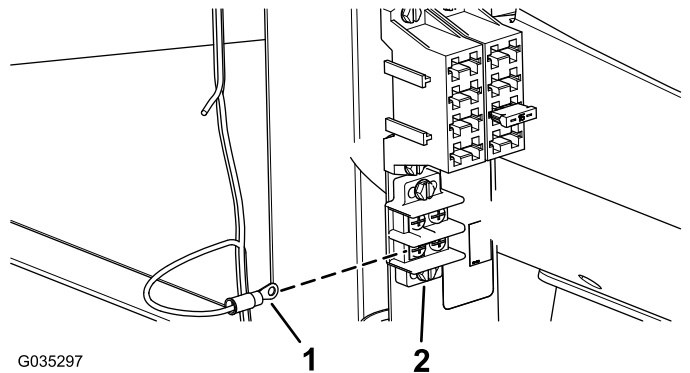

Figure 13
HD Model Shown

1. Wire-harness-terminal ring
2. Ground-block terminal

6

Connecting the Battery

No Parts Required

Procedure

Connect the negative battery cable; refer to your *Operator's Manual*.

7

Testing the LED Work Lights

No Parts Required

Procedure

Push the rocker switch up to turn the front LED work lights to the ON position.

Push the rocker switch down to turn the rear LED work lights to the ON position.

Push the rocker switch to the middle position to turn the LED work lights to the OFF position.