

TORO®

Blade Sharpening Kit

LT-F3000 Heavy-Duty Triple Turf Flail Mower

Model No. 111-9684

Installation Instructions

⚠ WARNING

CALIFORNIA Proposition 65 Warning

This product contains a chemical or chemicals known to the State of California to cause cancer, birth defects, or reproductive harm.

Note: The center cutting unit requires removal for sharpening unless an overhead lift is available.

1. Park the machine on a level surface and engage the parking brake.
2. Raise and secure the cutting units with the transport latches.
3. Shut off the engine and remove the key from the ignition switch.
4. If necessary, remove the center cutting unit.
5. Remove the cast weight from the cutting unit.
6. Lock the rotor into place by fitting the rotor lock with the existing fasteners (Figure 1).

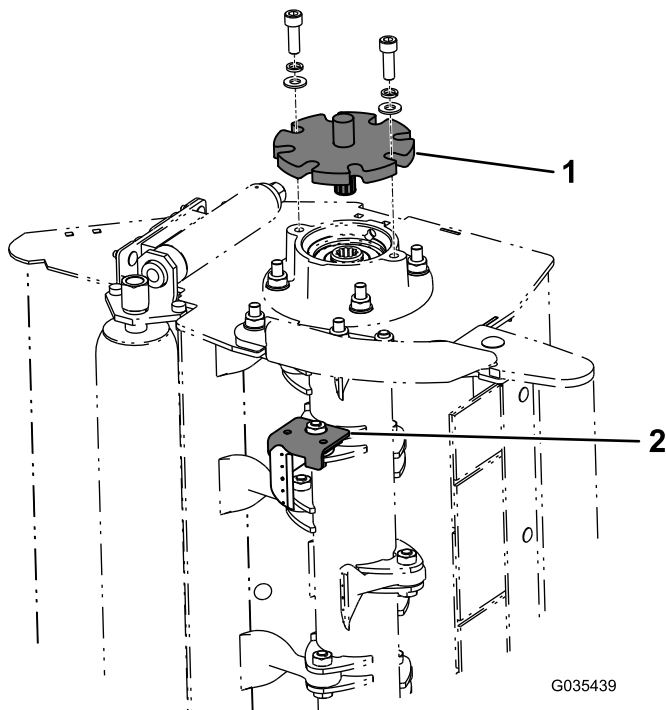

Figure 1

1. Rotor lock
2. Blade retainer bracket

7. Attach the blade retainer bracket on top of the lug and the blade (Figure 1).
8. Clamp the bracket using locking pliers (Figure 2).

Note: The blade edge should be facing you.

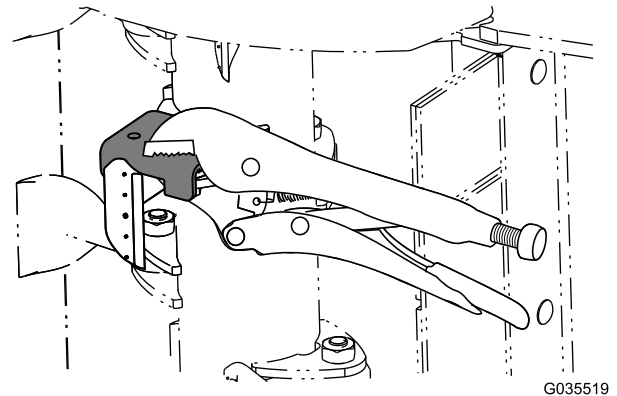

Figure 2

9. Use an angle grinder to sharpen the blade.

⚠ WARNING

Using a grinder in an unsafe manner could cause serious personal injury or property damage.

Ensure that the person sharpening the blades has been adequately trained in how to safely use a hand-held grinder.

Gently sharpen the angled edge on the back of the flail blade using a small angle grinder. While grinding the blade, keep the cutting edge perfectly horizontal and the angled surface flat to the ground (Figure 3). Do not grind the front face of the flail blade. Use the grinder gently so the flail does not get hot; otherwise, the steel will lose its hardness. Keep a new blade as a reference and refer to it when grinding. **Never sharpen the**



blades past the wear line that is indicated by the 5 dots (**Figure 3**). Ensure that all the flail blades are sharpened equally to maintain the balance of each rotor.

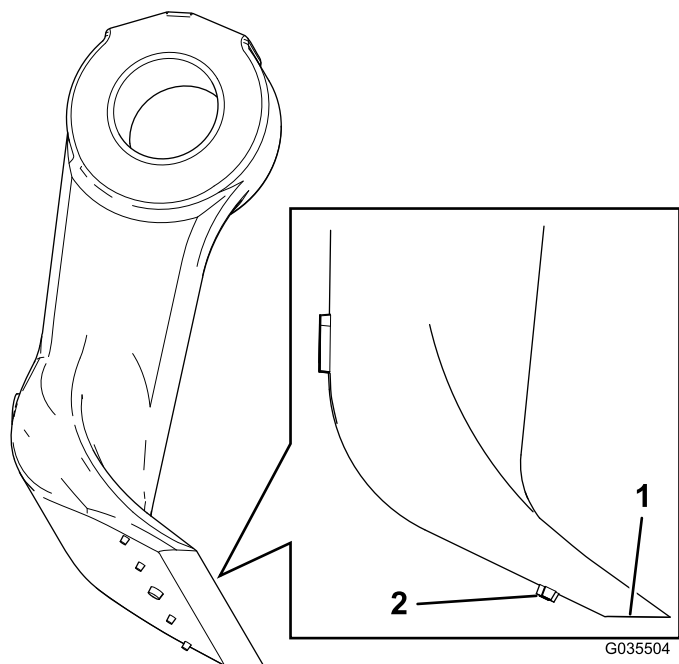

Figure 3

1. Surface to grind 2. Wear indicators

10. Repeat the procedure with the other blades.