



Walk Spreader Mounting Kit Workman® GTX Series Utility Vehicle

Model No. 07029

Installation Instructions

Safety

⚠ WARNING

CALIFORNIA

Proposition 65 Warning

This product contains a chemical or chemicals known to the State of California to cause cancer, birth defects, or reproductive harm.

Safety and Instructional Decals



Safety decals and instructions are easily visible to the operator and are located near any area of potential danger. Replace any decal that is damaged or lost.

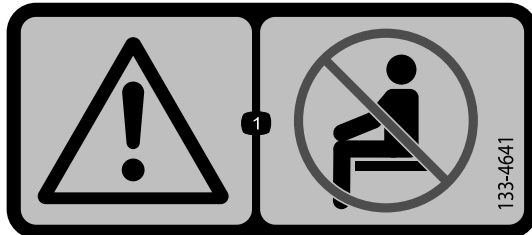

133-4641

1. Warning—no riders on the attachment.



133-7202

1. Attention—read the *Operator's Manual*; do not carry more than 45 kg (100 lb).



Installation

Loose Parts

Use the chart below to verify that all parts have been shipped.

Description	Qty.	Use
No parts required	—	Prepare the machine.
Spreader-mount frame Snap pin Clip bushing Spreader-pivot shaft Left spreader ramp Right spreader ramp Flange-head screw (5/16 x 1-1/2 inches) Flange nut (5/16 inch) Clevis pin Hairpin cotter	1 2 2 1 1 1 4 4 1 1	Install the walk-spreader mount (for machines with a plastic cargo bed).
No parts required	—	Install the walk-spreader mount (for machines with a steel cargo bed).
No parts required	—	Install the walk-spreader mount (for machine with or without the Brush Guard Kit installed).

Important: The total load capacity when this kit is installed is 45 kg (100 lb). When installing the spreader, verify that the weight of the spreader loaded with seed or fertilizer does not exceed 45 kg (100 lb), or damage may occur.

Important: After installing the spreader mount to the machine, the length of the front or rear of the machine extends. Ensure that there is always adequate clearance when operating the machine with the spreader mount installed. If installed on the front of the machine, use caution when approaching hills, as the extension of the front of the machine makes it more likely to damage turf.

Preparing the Machine

1. Move the machine to a level surface (box A of [Figure 1](#)).
2. Engage the parking brake (box B of [Figure 1](#)).
3. Shut off the engine (box C of [Figure 1](#)).
4. Remove the key from the ignition (box D of [Figure 1](#)).

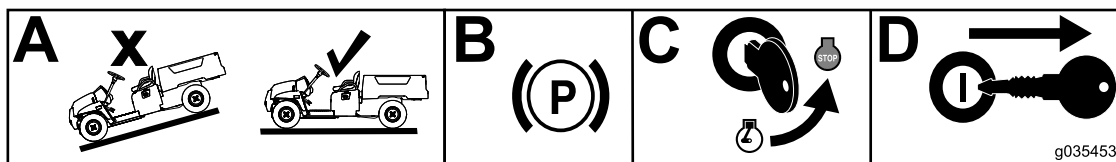

Figure 1

Installing the Walk-Spreader Mount to the Rear of the Machine

For Machines with a Plastic Cargo Bed

1. Install the 2 clip bushings to the spreader-mount frame (Figure 2).

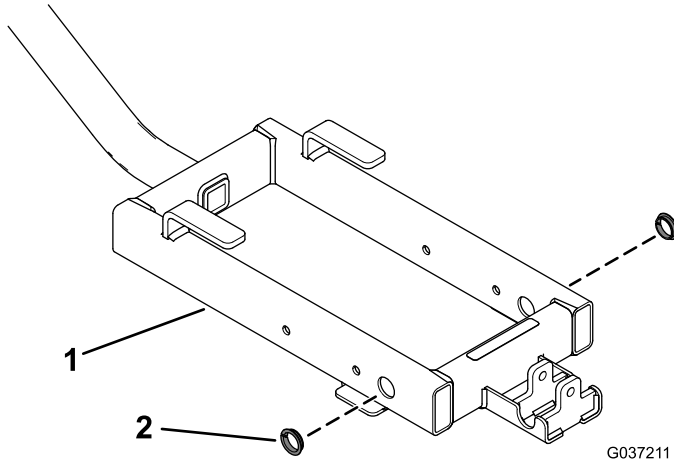

Figure 2

1. Spreader-mount frame
2. Clip bushing

2. Slide the spreader-pivot shaft through the spreader-mount frame and clip bushings (Figure 3).

Note: Ensure that the holes on the spreader-pivot shaft face upward.

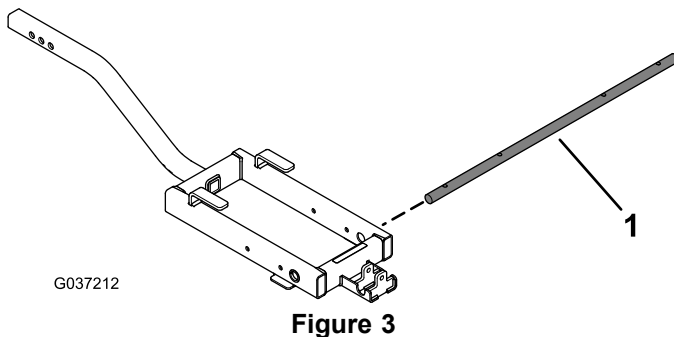

Figure 3

1. Spreader-pivot shaft

3. Slide the left and right spreader ramps onto the spreader-pivot shaft (Figure 4).

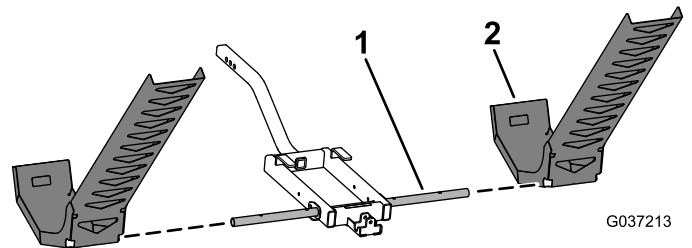

Figure 4

1. Spreader-pivot shaft
2. Spreader ramp

4. Align the holes on the spreader-pivot shaft with the holes on the left and right spreader ramps, and secure them using the 4 flange-head screws (5/16 x 1-1/2 inches) and 4 flange nuts (5/16 inch) as shown in Figure 5.

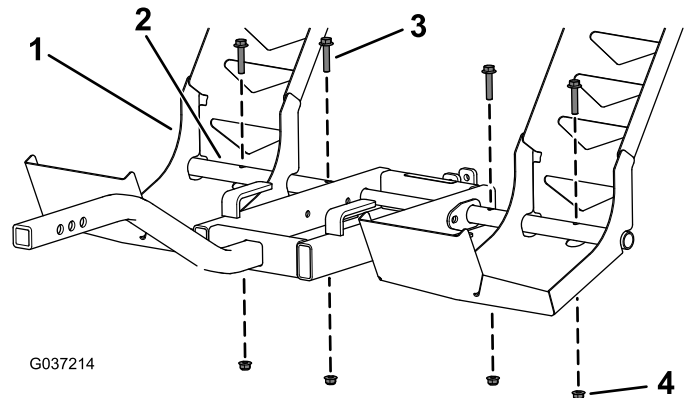

Figure 5

1. Spreader ramp
2. Spreader-pivot shaft
3. Flange-head screw (5/16 x 1-1/2 inches)
4. Flange nut (5/16 inch)

5. Loosen the "T" handle on the receiver tube (Figure 6).

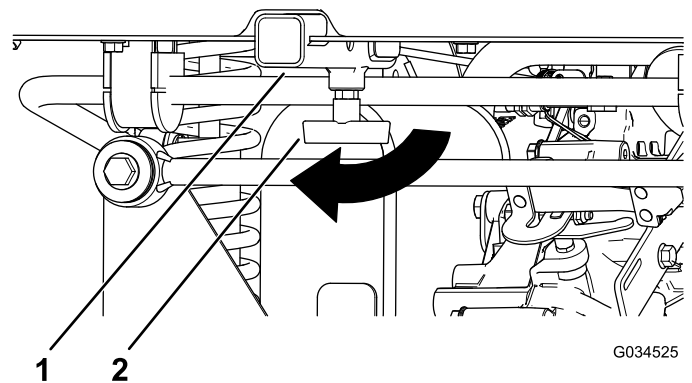

Figure 6

1. Receiver tube
2. "T" handle

6. Insert the assembled spreader mount into the machine receiver tube (Figure 7).

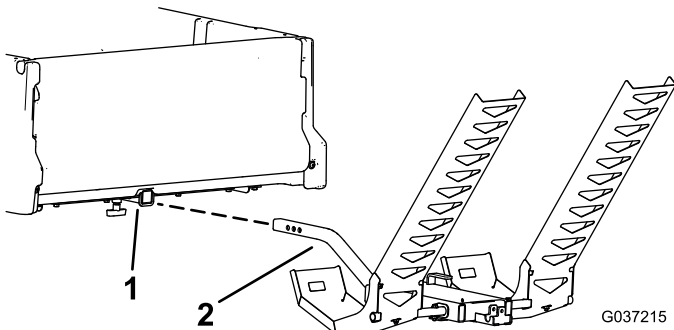

Figure 7

1. Receiver tube
2. Assembled spreader mount

7. Secure the assembled spreader mount to the receiver tube using the clevis pin and hairpin cotter (Figure 8).

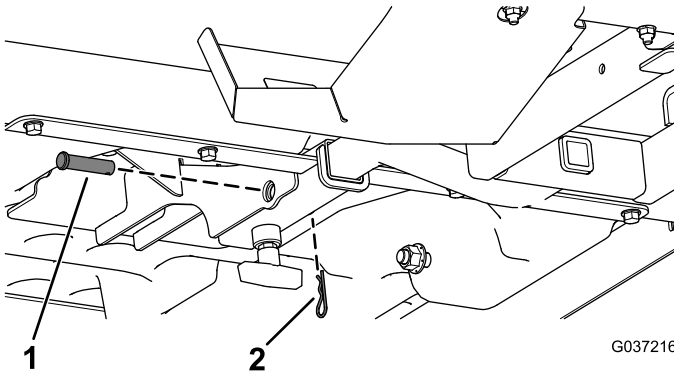

Figure 8

1. Clevis pin
2. Hairpin cotter

8. Tighten the “T” handle on the receiver tube (Figure 9).

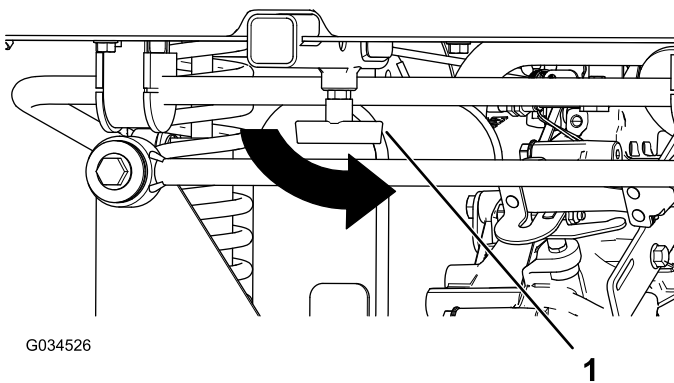

Figure 9

1. “T” handle

Important: If you use the spreader mount while in transport mode *without the spreader installed*, secure the spreader-ramp assembly using the 2 snap pins as shown in Figure 10.

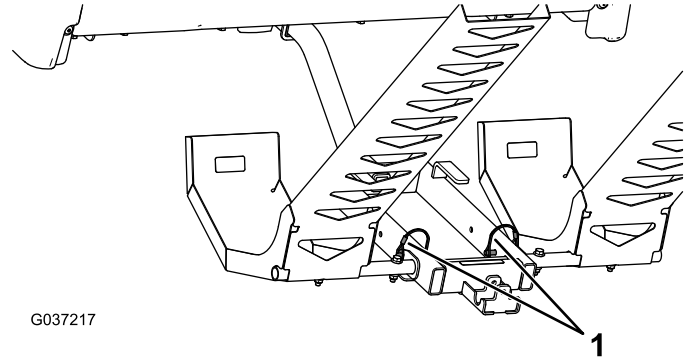

Figure 10

1. Snap pins

Installing the Walk-Spreader Mount to the Rear of the Machine

For Machines with a Steel Cargo Bed

Repeat steps 1 through 8 of [Installing the Walk-Spreader Mount to the Rear of the Machine](#) (page 3).

When you complete installation on the rear of a machine with a steel cargo bed, the Walk Spreader Mounting Kit appears as follows:

Steel Cargo Bed Installation—[Figure 11](#)

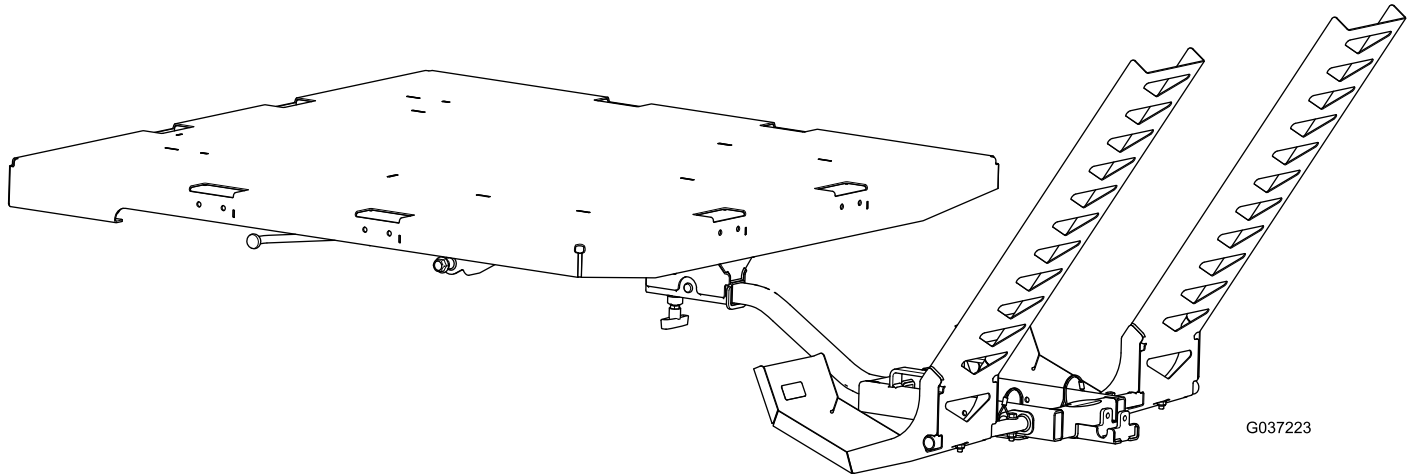

Figure 11

Installing the Walk-Spreader Mount to the Front of the Machine

For Machines With or Without the Brush Guard Kit Installed

Repeat steps 1 through 8 of [Installing the Walk-Spreader Mount to the Rear of the Machine](#) (page 3).

When you complete installation on the front of a machine with or without the Brush Guard Kit installed, the Walk Spreader Mounting Kit appears as follows:

With Brush Guard Kit Installation—[Figure 12](#)

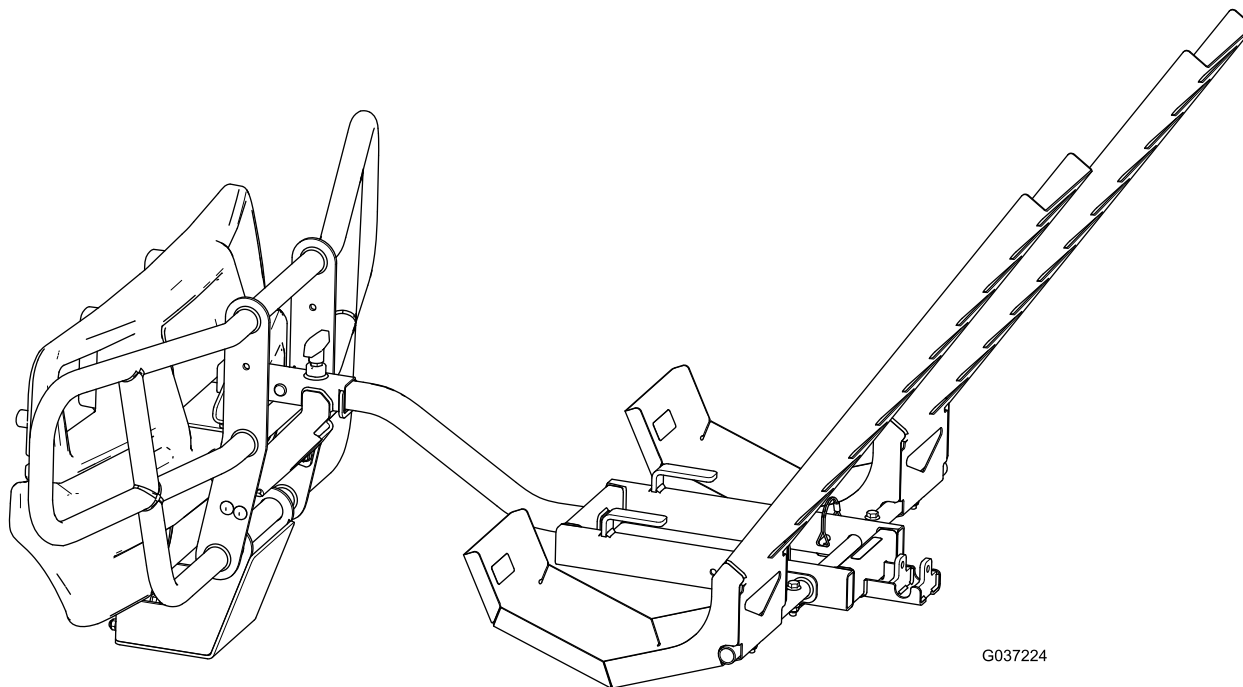

Figure 12

Without Brush Guard Kit Installation—[Figure 13](#)

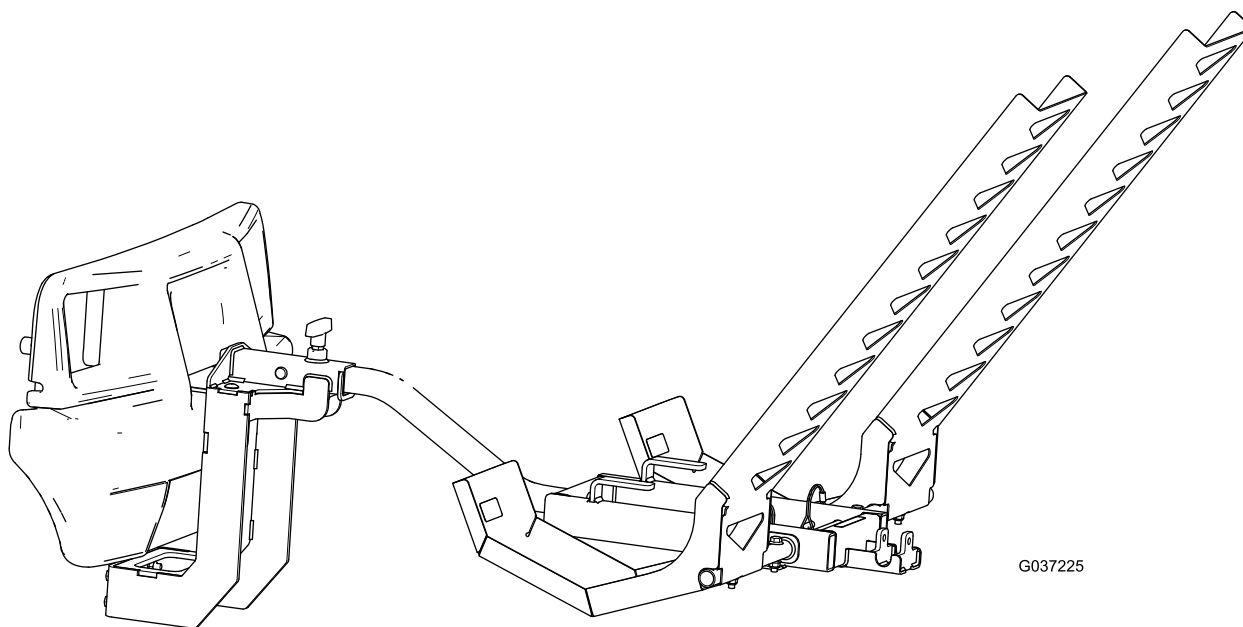
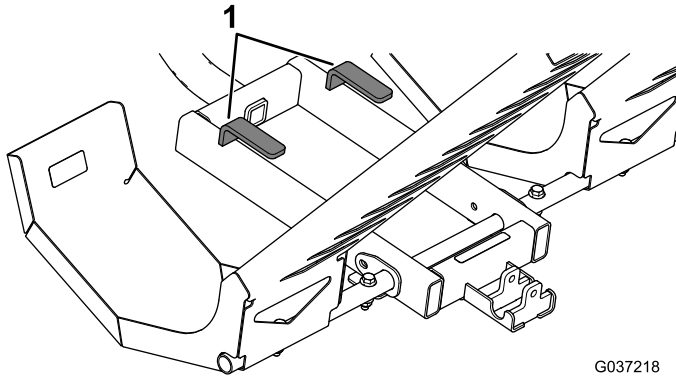

Figure 13

Operation

Installing a Spreader onto the Walk-Spreader Mount

1. Walk the spreader up the spreader ramps.
2. Engage the spreader axles using the axle holders (Figure 14).



G037218

Figure 14

1. Axle holders

-
3. Align the kickstand on the spreader between the kickstand-retention tabs on the spreader-mount frame (Figure 15).
 4. Secure the spreader to the spreader-mount frame using a snap pin (Figure 15).

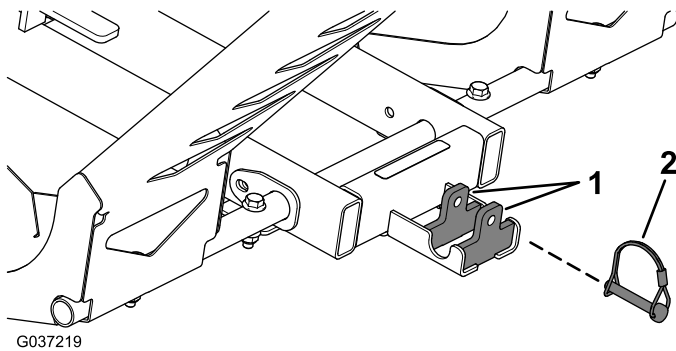

G037219

Figure 15

1. Kickstand-retention tabs
2. Snap pin



Count on it.