



Potential Interference with Cutting Unit Pitch Arms and Roll Frame

Product: Greensmaster Flex 1820/2120

February 26, 2016

Affected Units:

Greensmaster Flex 1820/2120

Models:

04044

04045

Serial Numbers:

316000101-316999999

316000101-316999999

Subject: Potential Interference with Cutting Unit Pitch Arms and Roll Frame.

**Bulletin Type &
Status**

Product Issue: Final Release

Situation:

Important Information

When installing 2015 or older, or some early 2016 Flex 1800/1820/2100/2120 cutting units on MY 2016 Flex 1820/2120 traction units, the roll frame bolts may interfere with the cutting unit pitch arm tabs. This interference will be apparent when securing the cutting units to the roll frame. See Figures 1 and 2 for specific information about where the potential interference points exist.

Correction:

Modify the older style pitch arms to gain clearance for the new roll frame bolts on the 2016 traction unit.

**Action
Required:**

Fix as Fail

Mount the cutting unit and inspect for interference. If interference exists, remove cutting unit pitch arm material by grinding a 45-degree chamfer (2.28 mm/.090 inch) to both pitch arm tabs around the head of the fastener as shown in Figures 1 and 2. This will allow adequate clearance around the fastener to allow the fastener head to sit flush against the pitch arm tab and properly secure the cutting unit to the traction unit.

Safety Awareness: Follow reasonable and customary safety precautions

Attachments: See Figures 1, 2, 3, and 4

Parts: None

Warranty N/A

Claim Type: N/A

SRT Code: N/A

Situation:

When installing specified early 2016 or 2015 and earlier Flex 1800/1820/2100/2120 cutting units on MY 2016 Flex 1820/2120 traction units, the roll frame bolts may interfere with the cutting unit pitch arm tabs. This interference will be apparent when securing the cutting units to the roll frame. See Figures 1 and 2 for specific information about where the potential interference points exist.

Instructions:

Mount the cutting unit and inspect for interference. If interference exists, remove cutting unit pitch arm material by grinding a 45-degree chamfer (2.28 mm/.090 inch) to both pitch arm tabs around the head of the fastener as shown in Figures 1 through 4. This will allow adequate clearance around the fastener to allow the fastener head to sit flush against the pitch arm tab and properly secure the cutting unit to the traction unit. Once modifications are complete and clearance exists between the bolt head and the pitch arm assembly, cover the chamfered area with Toro red touch up paint as required.

See Figures 1 through 4 below.

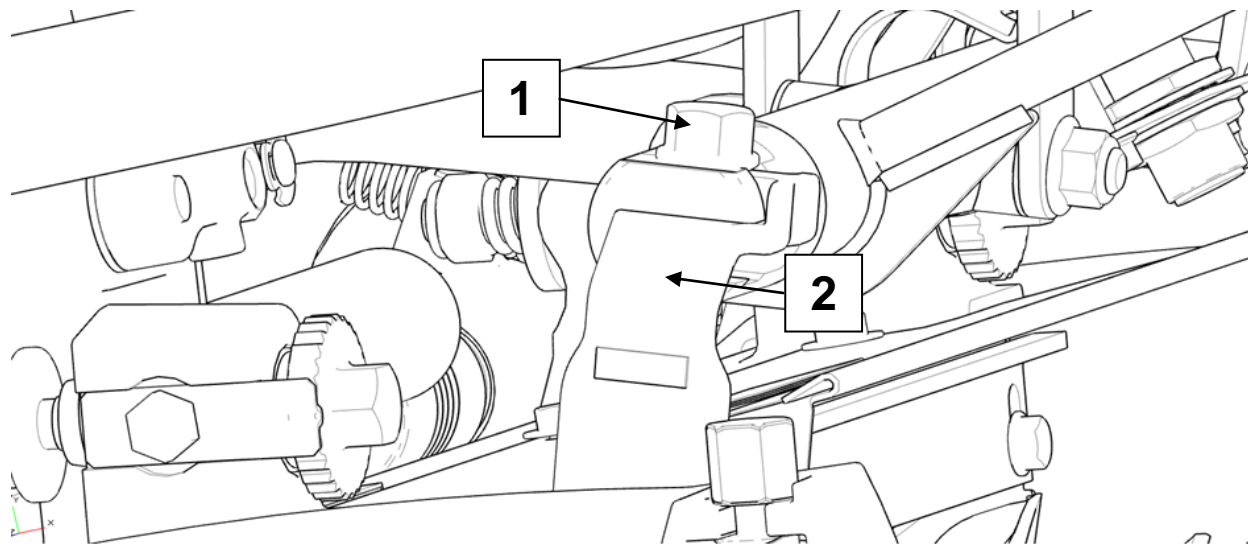

Figure 1

1. Roll frame bolt head
2. Pitch arm assembly (R/H side)

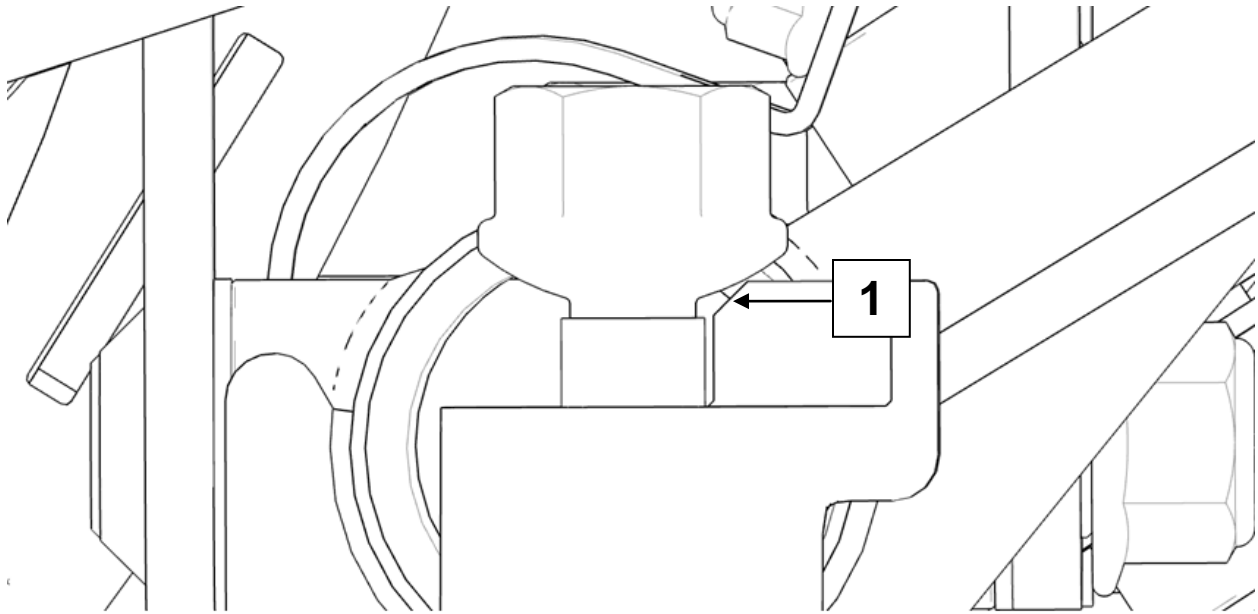

Figure 2

1. Side view with 45-degree chamfer

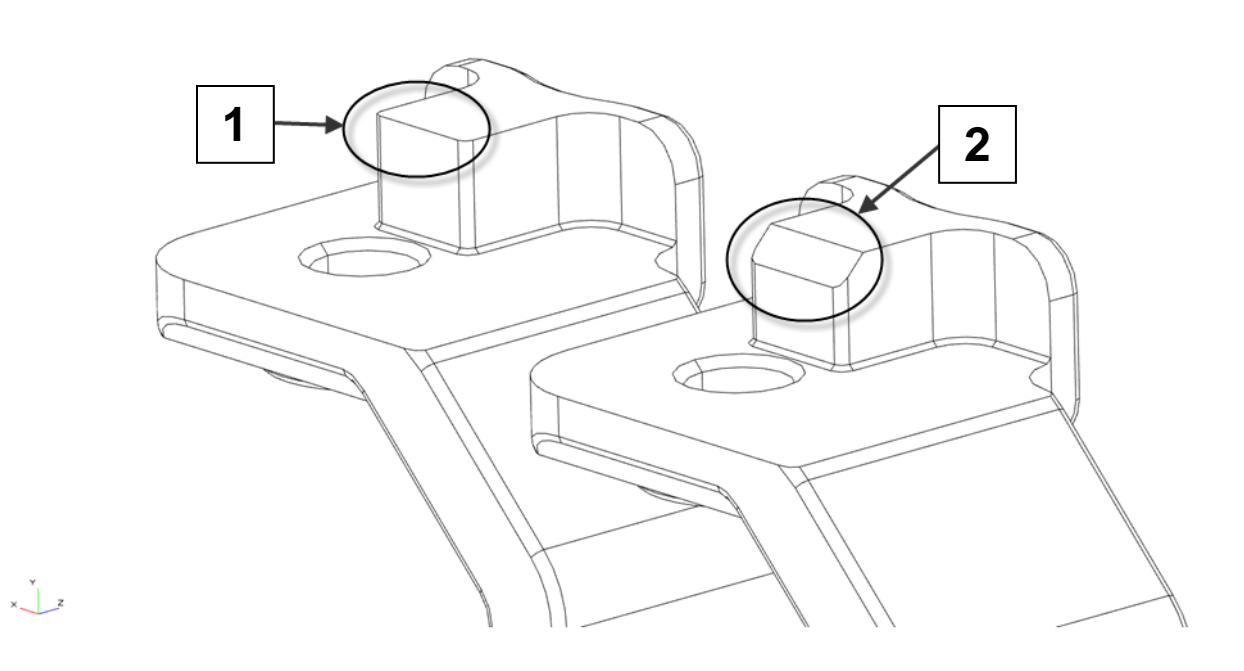

Figure 3

1. Early 2016, 2015 and earlier cutting unit and pitch arm assembly
2. Current 2016 cutting unit pitch arm assembly

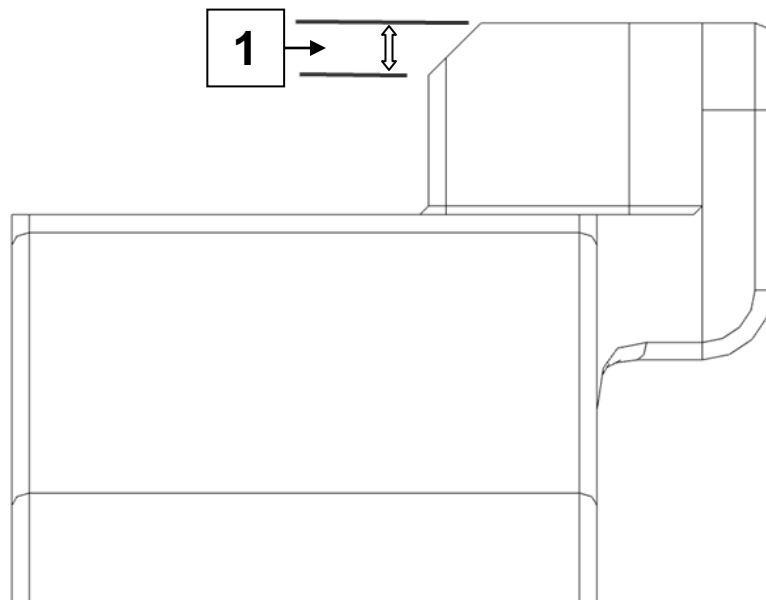

Figure 4

1. Measure 2.28 mm (.090 inch) in 2 places and chamfer to 45 degrees