



Wire Harness Kit

Workman® HDX-D 4-Wheel Drive Utility Vehicle with Bed

Model No. 132-6774

Installation Instructions

⚠ WARNING

CALIFORNIA Proposition 65 Warning

This product contains a chemical or chemicals known to the State of California to cause cancer, birth defects, or reproductive harm.

Installation

Loose Parts

Use the chart below to verify that all parts have been shipped.

Procedure	Description	Qty.	Use
1	No parts required	–	Disconnect the battery.
2	No parts required	–	Remove the hood.
3	Shift lever	1	Install the shift lever.
4	Ball-switch bracket Ball switch Jam nut (9/16 inch) Carriage bolt (5/16 x 1 inch) Locknut (5/16 inch)	1 1 1 2 2	Install and adjust the ball switch.
5	Wire harness Cable tie	1 10	Route the wire harness.
6	Relay Delay timer Hex-head screw (1/4 x 5/8 inch)	3 1 3	Install the relays and delay timer.
7	Clutch switch Clutch-switch bracket Pop rivet Flat washer (3/16 inch) Bolt (3/8 x 3/4 inch) Nut (3/8 inch) Clutch extension wire harness	1 1 2 2 2 2 1	Install the clutch switch.
8	No parts required	–	Install the hood.
9	No parts required	–	Connect the battery.



1

Disconnecting the Battery

No Parts Required

Procedure

1. Park the machine on a level surface, set the parking brake, raise the bed, install the bed support on the lift cylinder, shut off the engine, and remove the key from the ignition.

⚠ WARNING

A raised bed full of material without the proper safety support rod may lower unexpectedly. Working under an unsupported raised bed may cause injury to you or others.

- Before servicing or making adjustments to the machine, shut off the engine, set the parking brake, and remove the key from the ignition switch.
 - Remove any load material from the bed or other attachment and insert the safety support on a fully extended cylinder rod before working under a raised bed.
2. Remove the battery cover.
 3. Disconnect the negative battery cable from the battery; refer to your *Operator's Manual*.

2

Removing the Hood

No Parts Required

Procedure

1. While grasping the hood in the headlight openings, lift up the hood to release the lower mounting tabs from the frame slots (Figure 1).

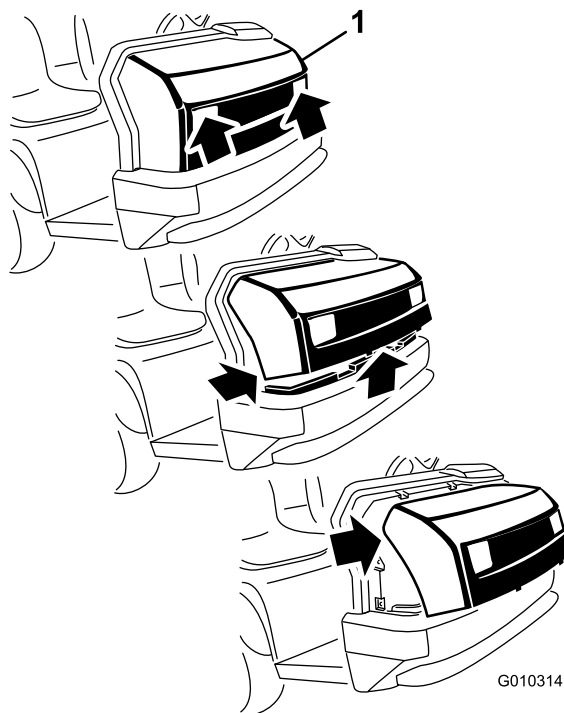

Figure 1

1. Hood
-
2. Pivot the bottom of the hood upward until the top mounting tabs can be pulled from the frame slots (Figure 1).
- Note:** Pivot the hood only far enough to access the wire connectors for the headlights and disconnect them before removing the hood.
3. Pivot the top of the hood forward and unplug the wire connectors from the headlights (Figure 1).
 4. Remove the hood.

3

Installing the Shift Lever

Parts needed for this procedure:

1	Shift lever
---	-------------

Procedure

1. Locate the first-gear-reverse lever and remove the existing locknut (M10), hairpin cotter, clevis pin, and lever.

Note: Retain the locknut (M10), clevis pin, and hairpin cotter for the next step.

2. Install the shift lever with the previously removed locknut (M10), clevis pin, and hairpin cotter (Figure 2).

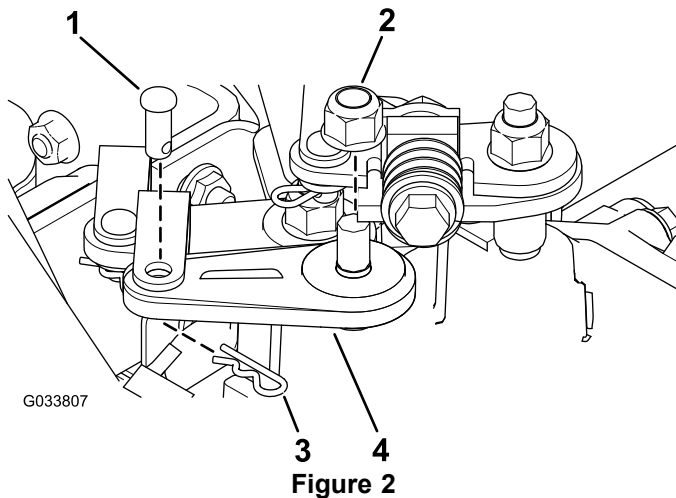

- | | |
|------------------|-------------------|
| 1. Clevis pin | 3. Hairpin cotter |
| 2. Locknut (M10) | 4. Shift lever |

3. Torque the locknut (M10) to 2,599 to 2,712 N·cm (230 to 240 in-lb).

4

Installing and Adjusting the Ball Switch

Parts needed for this procedure:

1	Ball-switch bracket
1	Ball switch
1	Jam nut (9/16 inch)
2	Carriage bolt (5/16 x 1 inch)
2	Locknut (5/16 inch)

Procedure

1. Move the shift lever to the NEUTRAL position.
2. Install the ball switch to the ball-switch bracket with the jam nut (9/16 inch) as shown in Figure 3.

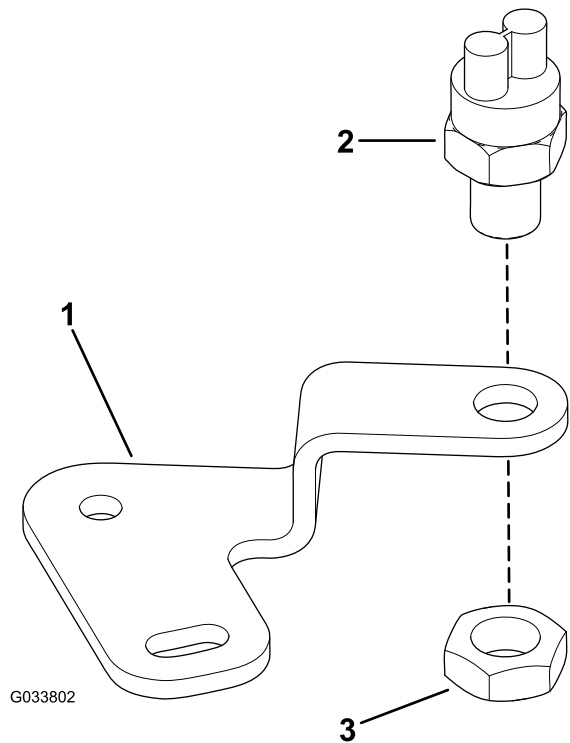

Figure 3

- | | |
|------------------------|------------------------|
| 1. Ball-switch bracket | 3. Jam nut (9/16 inch) |
| 2. Ball switch | |

3. Install the ball-switch bracket to the muffler frame with the 2 carriage bolts (5/16 x 1 inch) and 2 locknuts (5/16 inch) as shown in Figure 4.

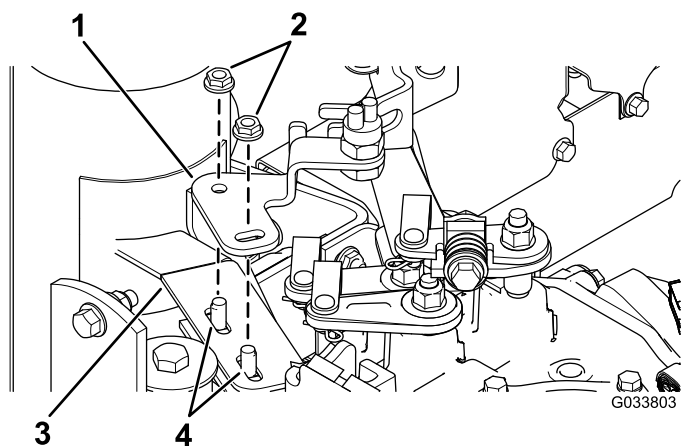

Figure 4

- | | |
|-------------------------|-----------------------------------|
| 1. Ball-switch bracket | 3. Muffler frame |
| 2. Locknuts (5/16 inch) | 4. Carriage bolts (5/16 x 1 inch) |

- Adjust the depth of the ball switch to 1.52 mm (0.06 inch) clearance between the bump of the shift lever and the face of the ball switch (Figure 5).
- Install a continuity-reading device (VOM or test light) across the ball-switch terminals.
- Shift the vehicle between the FIRST gear and REVERSE positions.

Note: The ball switch only has continuity momentarily when switching from neutral to reverse.

- Ensure that the ball switch is in front of the bump on the shift lever (Figure 5).

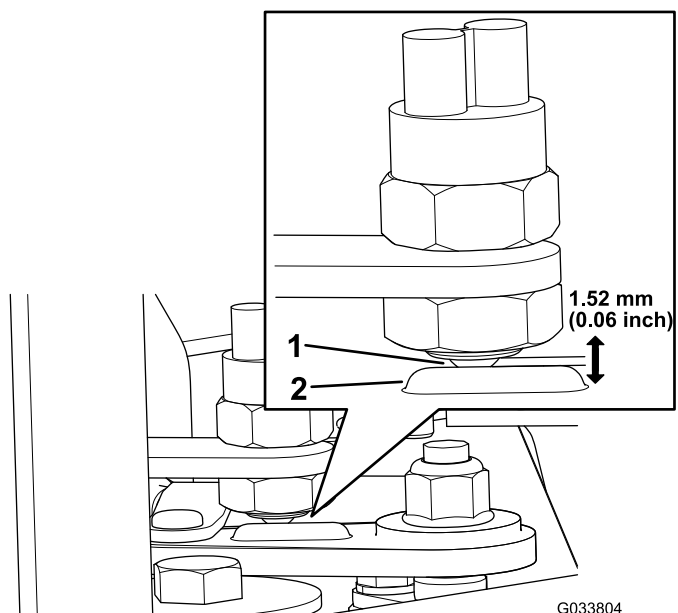

Figure 5

- | | |
|--|----------------------------|
| 1. Ball-switch location—note that the ball switch is in front of the bump. | 2. Bump on the shift lever |
|--|----------------------------|

5

Routing the Wire Harness

Parts needed for this procedure:

1	Wire harness
10	Cable tie

Procedure

Note: If you have the Differential Interrupter Kit installed on your machine, bypass the upper clutch switch.

1. Route the end of the wire harness labeled “reverse switch” between the front of the vehicle through the wire-bulkhead opening under the operator platform, and back to driver’s side frame rail to the top of the transmission assembly ([Figure 6](#)).

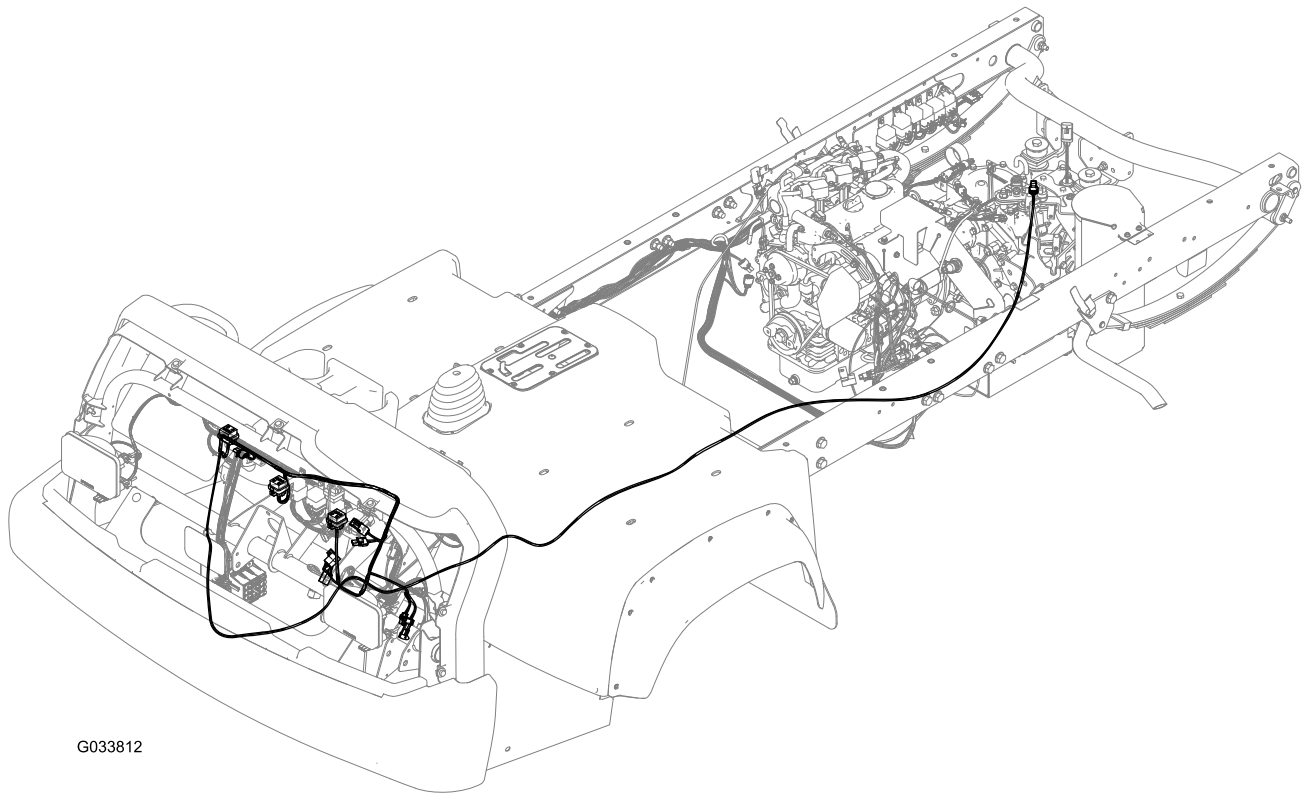

Figure 6
Overview of Routing the Wire Harness

-
2. Secure the wire harness to the machine with the cable ties as needed.

Important: Do not secure the wire harness near a moving part or parts that become hot, as this may damage the wire harness.

3. Plug in the brake connector, 4WD-bypass connector, and the clutch connector into the new wire harness ([Figure 6](#)).

Important: The connectors on the machine harness need to be unplugged, plugged into the kit harness, then the connectors on the kit harness need to be plugged in where the machine connectors were unplugged.

6

Installing the Relays and Delay Timer

Parts needed for this procedure:

3	Relay
1	Delay timer
3	Hex-head screw (1/4 x 5/8 inch)

Procedure

1. Install the 3 relays into the control-panel frame with the 3 hex-head screws (1/4 x 5/8 inch) as shown in [Figure 7](#).

Note: There are holes available in the rear of the control-panel frame where you can install the relays. If there is already another attachment installed, you may choose any 3 holes in the control-panel frame to install the relays.

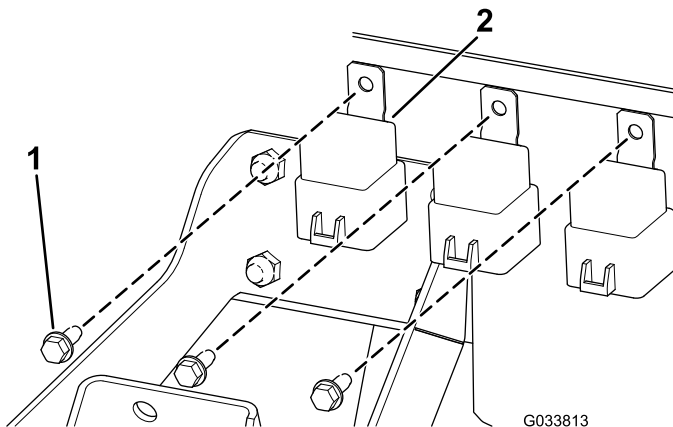

Figure 7

1. Hex-head screw (1/4 x 5/8 inch)
2. Relay

2. Connect the wire-harness connectors into the 3 relays ([Figure 8](#)).

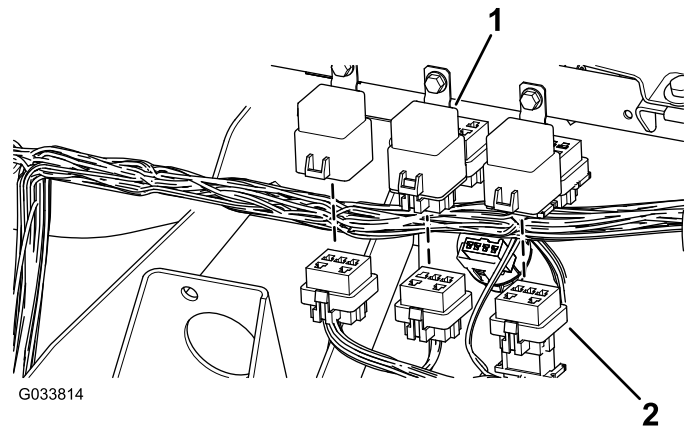

Figure 8

1. Relay
2. Wire-harness connector

3. Connect the wire-harness connector labeled “one second delay timer” into the delay timer ([Figure 9](#)).

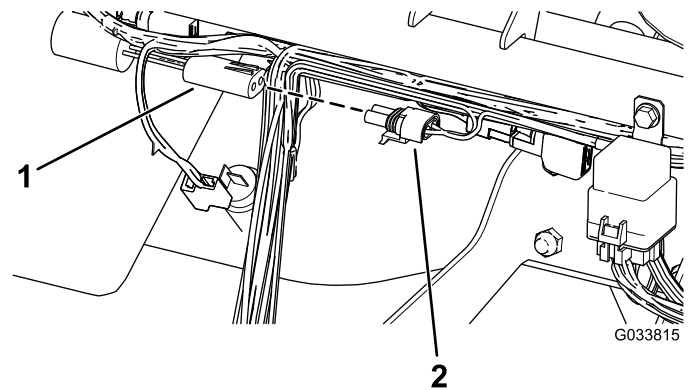

Figure 9

1. Delay timer
2. Wire-harness connector

4. Secure the wire harness to the control-panel frame with cable ties.

7

Installing the Clutch Switch

Parts needed for this procedure:

1	Clutch switch
1	Clutch-switch bracket
2	Pop rivet
2	Flat washer (3/16 inch)
2	Bolt (3/8 x 3/4 inch)
2	Nut (3/8 inch)
1	Clutch extension wire harness

Procedure

1. Install the clutch switch to the clutch-switch bracket with the 2 pop rivets and 2 flat washers (3/16 inch) as shown in [Figure 10](#).

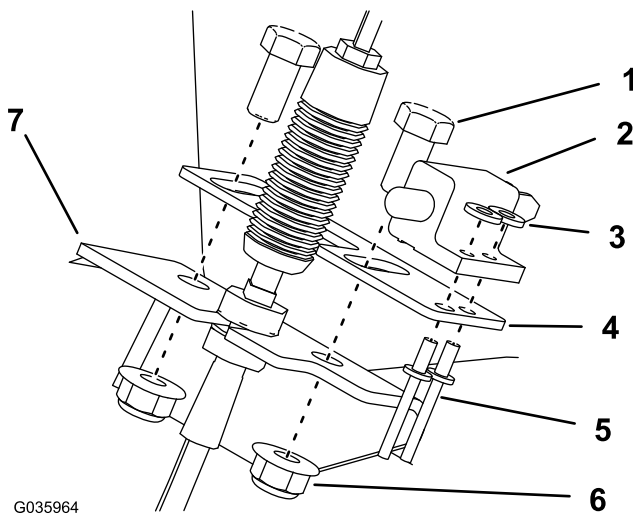

Figure 10

1. Bolt (3/8 x 3/4 inch)
2. Clutch switch
3. Flat washer
4. Clutch-switch bracket
5. Pop rivet
6. Nut (3/8 inch)
7. Clutch-cable bracket

2. Install the clutch switch and clutch-switch bracket to the clutch-cable bracket with the 2 bolts (3/8 x 3/4 inch) and 2 nuts (3/8 inch) as shown in [Figure 10](#).

Note: Ensure that when you fully press the clutch pedal, the clutch switch presses and the clutch-switch bracket does not interfere with the clutch pedal.

3. Disconnect the wire harness from the clutch switch.
4. Plug the machine wire harness into the clutch extension wire harness ([Figure 11](#)).

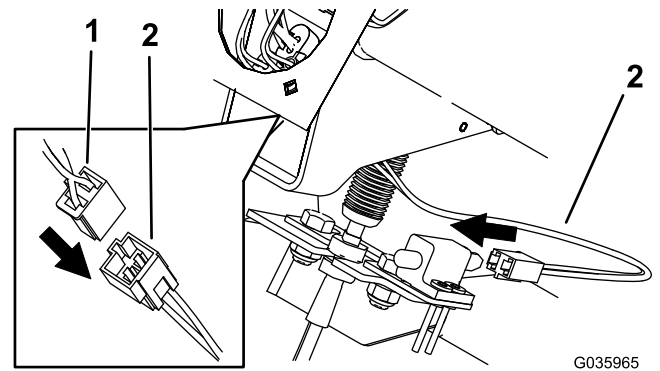

Figure 11

1. Machine wire harness
2. Clutch extension wire harness

5. Plug the clutch extension wire harness into the clutch switch ([Figure 11](#)).
6. Ensure that the clutch switch activates when you press the clutch pedal using a digital volt-ohm meter.

Note: There should not be any continuity when you fully press the clutch pedal. There should be continuity only when the clutch pedal lifts off the clutch switch.

8

Installing the Hood

No Parts Required

Procedure

1. Connect the lights.
2. Insert the top mounting tabs into the frame slots.
3. Insert the lower mounting tabs into the frame slots.
4. Ensure that the hood is fully engaged in the top, sides, and bottom grooves.

9

Connecting the Battery

No Parts Required

Procedure

1. Connect the negative battery cable; refer to your *Operator's Manual*.
2. Install the battery cover.



Count on it.