



# Instrument Board Service Kit

## Groundsmaster® 580-D Traction Unit

Model No. 132-1320

### Installation Instructions

#### ⚠ WARNING

##### CALIFORNIA Proposition 65 Warning

This product contains a chemical or chemicals known to the State of California to cause cancer, birth defects, or reproductive harm.

**Note:** Determine the left and right sides of the machine from the normal operating position.

This kit fits Groundsmaster® models 30580, 30581, 30582, and 30583.

## Installation

### Loose Parts

Use the chart below to verify that all parts have been shipped.

Procedure	Description	Qty.	Use
<b>1</b>	No parts required	–	Prepare the machine to install the kit.
<b>2</b>	Gauge plate Switch Decal Screw (6-32 x 1/2 inch) Locknut (6-32) Connector bracket Screw (10-24 x 3/4 inch) Locknut (10-24) Relay Screw (#10 x 1/2 inch) Bridge rectifier	1 2 1 2 2 1 6 7 1 1 4	Install the kit.
<b>3</b>	Gauge panel wire harness	1	Route the wire harness.
<b>4</b>	No parts required	–	Complete the installation.



# 1

## Preparing to Install the Kit

### No Parts Required

### Procedure

**Note:** Retain all parts that you remove from the instrument board for later use.

1. Move the machine to a level surface, shut off the engine, engage the parking brake, and remove the key from the ignition switch.
2. Disconnect the battery wires from the battery posts.

**Important:** Disconnect the negative cable from the battery post before disconnecting the positive cable.

3. Remove the 4 bolts and 4 washers securing the instrument board to the machine (Figure 1).
4. Slightly lift up the board, disconnect the main wire harness from the board, and remove the instrument board (Figure 1).

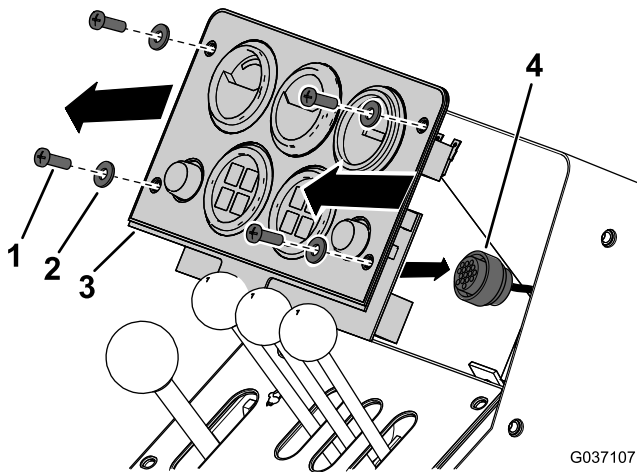

**Figure 1**

- |               |                      |
|---------------|----------------------|
| 1. Bolt (4)   | 3. Instrument board  |
| 2. Washer (4) | 4. Main wire harness |

9. Disconnect the 2 hour meter connectors from the hour meter and then remove the hour meter (Figure 2).
10. Remove the 8 light sockets from the warning light gauges (Figure 2).

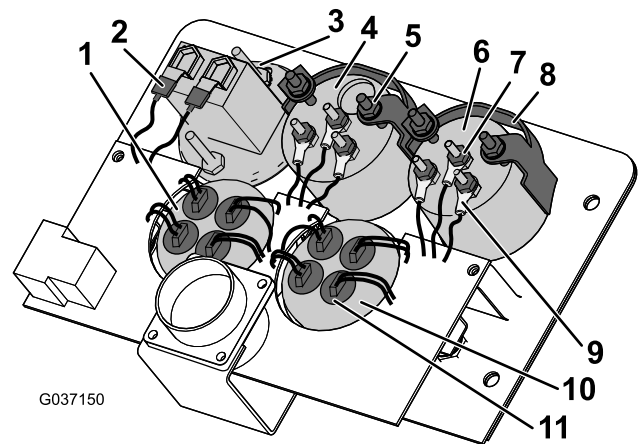

**Figure 2**

- |                             |                              |
|-----------------------------|------------------------------|
| 1. Warning light gauge      | 7. Eyelet connector nuts (6) |
| 2. Hour meter connector (2) | 8. Gauge bracket (2)         |
| 3. Hour meter               | 9. Eyelet connectors (6)     |
| 4. Fuel gauge               | 10. Warning light gauge      |
| 5. Gauge bracket nut (4)    | 11. Light sockets (8)        |
| 6. Temperature gauge        |                              |

11. Loosen the gauge clamps and slide out the warning light gauges and clamps.

5. Unscrew the 2 red buttons from the front of the instrument board.
6. Remove the 4 connector nuts and 4 washers from the gauge brackets and remove the brackets (Figure 2).
7. Remove the 6 eyelet connector nuts and then remove the eyelet connectors from the temperature gauge and fuel gauge (Figure 2).
8. Remove the temperature gauge and fuel gauge (Figure 2).

# 2

## Installing the Kit

### Parts needed for this procedure:

1	Gauge plate
2	Switch
1	Decal
2	Screw (6-32 x 1/2 inch)
2	Locknut (6-32)
1	Connector bracket
6	Screw (10-24 x 3/4 inch)
7	Locknut (10-24)
1	Relay
1	Screw (#10 x 1/2 inch)
4	Bridge rectifier

### Procedure

1. Install the 2 switches to the panel and screw on the red buttons as shown in [Figure 3](#).

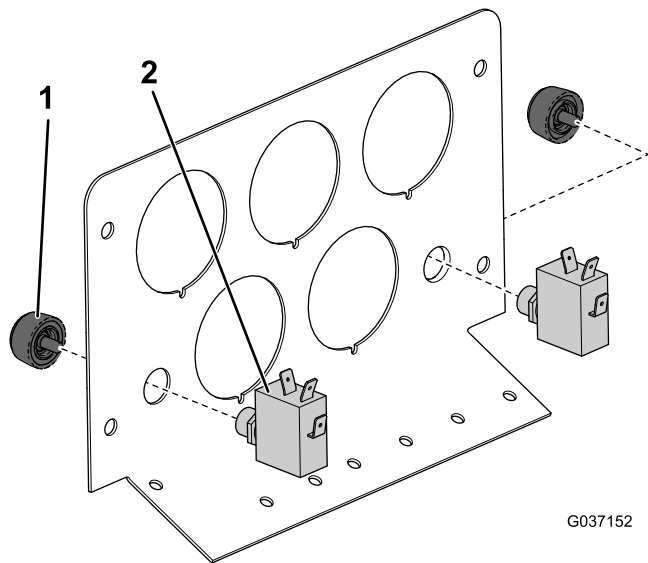
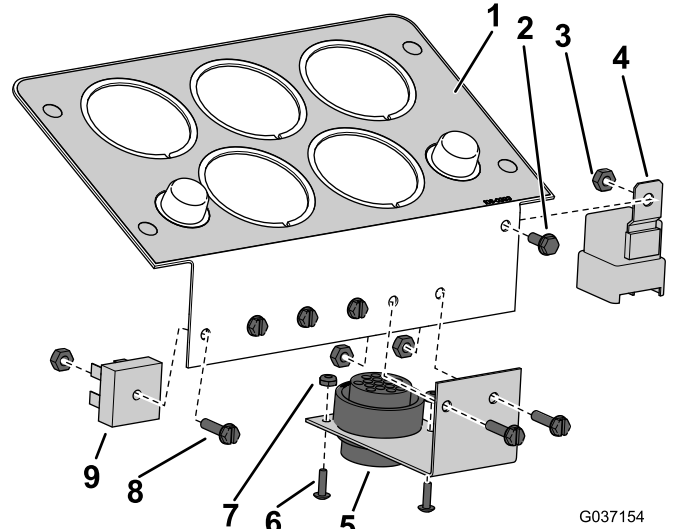

**Figure 3**

1. Red button
2. Switch

2. Install the decal onto the front of the plate ([Figure 4](#)).
3. Install the round connector on the harness onto the connector bracket with 2 bolts (6-32 x 1/2 inch) and 2 locknuts (6-32) as shown in [Figure 4](#).
4. Install the connector bracket onto the gauge plate with 2 bolts (10-24 x 3/4 inch) and 2 locknuts (10-24) as shown in [Figure 4](#).

5. Install the relay onto the gauge plate with a bolt (#10 x 1/2 inch) and a locknut (10-24) as shown in [Figure 4](#).
6. Install the 4 bridge rectifiers onto the gauge plate with 4 bolts (10-24 x 3/4 inch) and 4 locknuts (10-24) as shown in [Figure 4](#).



**Figure 4**

1. Decal
2. Bolt (#10 x 1/2 inch)
3. Locknut (10-24)
4. Relay
5. Round connector (on the wire harness)
6. Bolt (6-32 x 1/2 inch)
7. Locknut (6-32)
8. Bolt (10-24 x 3/4 inch)
9. Bridge rectifier

7. Install the temperature gauge and fuel gauge onto the plate with the 2 gauge brackets, 4 connector nuts, and 4 washers.
8. Install the hour meter onto the plate.
9. Install the 2 warning light gauges onto the plate with the gauge clamps and corresponding hardware.

# 3

## Routing the Wire Harness

### Parts needed for this procedure:

1	Gauge panel wire harness
---	--------------------------

### Procedure

Install the wire harness; refer to

**Note:** Refer to [Figure 5](#) and [Schematics \(page 6\)](#) for the following steps:

1. Attach the 4 switch connectors to the switches.
2. Attach the 2 hour meter connectors to the hour meter.
3. Attach the 6 eyelet connectors to the fuel gauge and temperature gauge.
4. Attach the 8 light sockets to the warning light gauges.
5. Plug the relay connector into the relay.
6. Plug the 16 bridge rectifier connectors into the 4 bridge rectifiers.
7. Plug the main wire harness into the main harness connector.

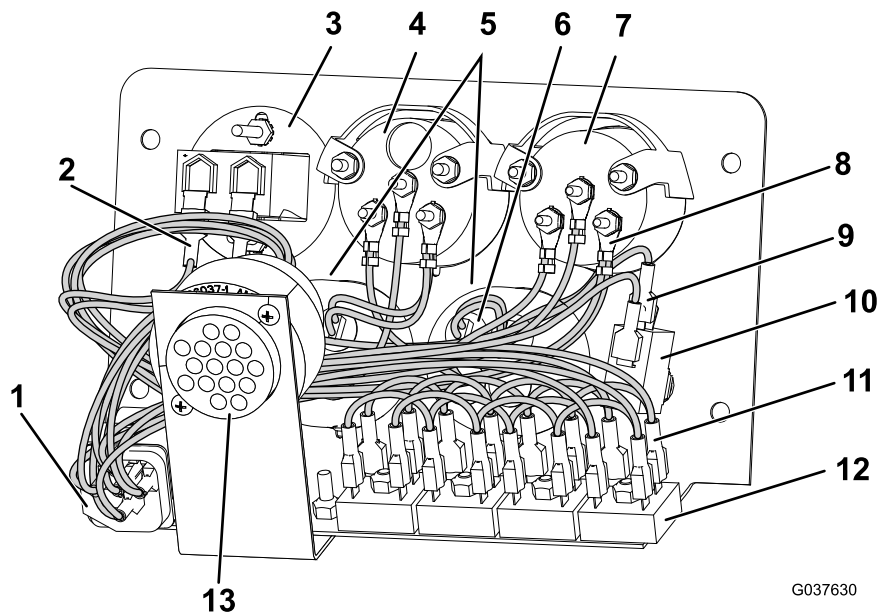

G037630

**Figure 5**  
Wire Harness Final View

- |                             |                           |                              |                            |
|-----------------------------|---------------------------|------------------------------|----------------------------|
| 1. Relay connector          | 5. Warning light gage (2) | 9. Switch connector (4)      | 13. Main harness connector |
| 2. Hour meter connector (2) | 6. Light sockets (8)      | 10. Switch (2)               |                            |
| 3. Hour meter               | 7. Temperature gauge      | 11. Rectifier connector (16) |                            |
| 4. Fuel gauge               | 8. Eyelet connector (6)   | 12. Bridge rectifier (4)     |                            |

# 4

## Completing the Installation

**No Parts Required**

### Procedure

1. Install the plate onto the machine with the 4 screws previously removed.
2. Connect the battery cables.

**Note:** Connect the positive cable before connecting the negative cable.

## Schematics

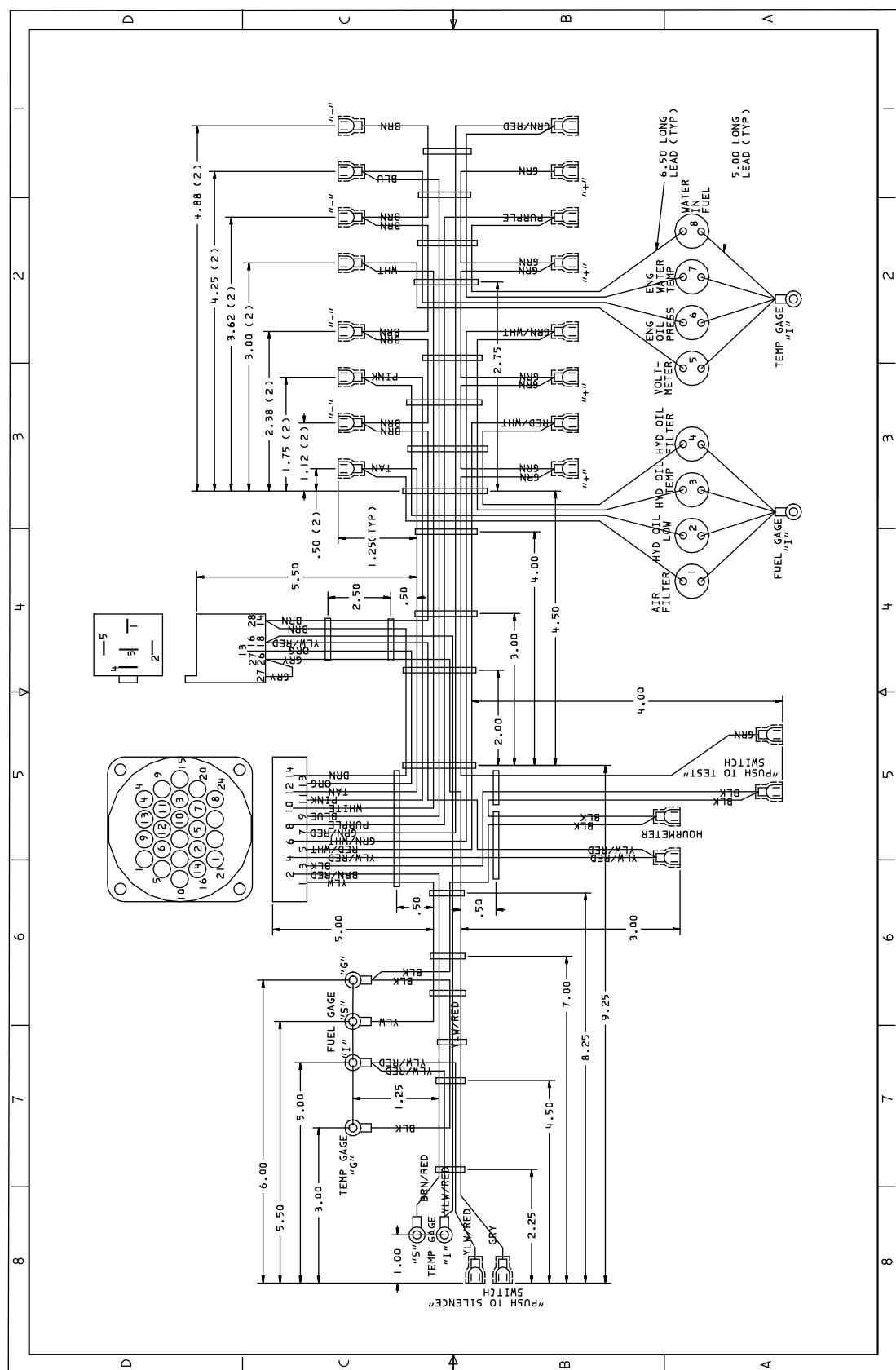

## Electrical Schematic (Rev. A)

G037132

**Notes:**



**Count on it.**