



# Hose Reel Mounting Kit

## Workman® GTX Series Utility Vehicle

Model No. 07027

### Installation Instructions

#### ⚠ WARNING

##### CALIFORNIA Proposition 65 Warning

This product contains a chemical or chemicals known to the State of California to cause cancer, birth defects, or reproductive harm.

## Safety

### Safety and Instructional Decals



Safety decals and instructions are easily visible to the operator and are located near any area of potential danger. Replace any decal that is damaged or lost.



133-7202

1. Attention—read the *Operator's Manual*; do not carry more than 45 kg (100 lb).

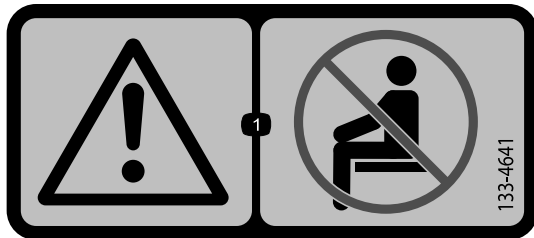

133-4641

1. Warning—do not carry any passengers.



# Installation

## Loose Parts

Use the chart below to verify that all parts have been shipped.

Procedure	Description	Qty.	Use
<b>1</b>	No parts required	–	Prepare the machine.
<b>2</b>	Hose-reel mount Tube mount Hex-head screw (1/2 x 2-1/4 inches) Locknut (1/2 inch) Clevis pin (1/2 x 2 inches) Hairpin cotter	1 1 1 1 1 1	Install the hose-reel mount.

The hose-reel mount is designed to fit aftermarket hose reels with mounting patterns of either 40 x 23 cm (15-3/4 x 9 inches) or 39 x 25 cm (15-7/16 x 10 inches).

Toro recommends the following aftermarket hose reels:

- Reelcraft—CA33112L
- Cox—1125-5-100

**Important:** The total load capacity when this kit is installed is 45 kg (100 lb). When installing the hose reel, verify that the hose length, when full of water, does not exceed 45 kg (100 lb), or damage may occur.

**Important:** After installing the hose-reel mount to the machine, the length of the front or rear of the machine extends, making it more likely to hit other objects.

Ensure that there is always adequate clearance when operating the machine with the hose-reel mount installed.

### **⚠ WARNING**

Lifting the hose-reel mount with the hose reel installed alone may result in injury.

When lifting the hose-reel mount with the hose reel installed, ensure that you have 2 people to install it to the machine.

# 1

## Preparing the Machine

### No Parts Required

### Procedure

Park the machine on a level surface, set the parking brake, shut off the engine, and remove the key.

# 2

## Installing the Hose-Reel Mount

Parts needed for this procedure:

1	Hose-reel mount
1	Tube mount
1	Hex-head screw (1/2 x 2-1/4 inches)
1	Locknut (1/2 inch)
1	Clevis pin (1/2 x 2 inches)
1	Hairpin cotter

### Installing the Hose-Reel Mount to the Front of the Machine

For Machines with the Front Hitch Kit with a Brush Guard Installed

1. Insert the tube mount into the hose-reel mount until the holes in the tube mount align with the farthest holes in the hose-reel mount (Figure 1).

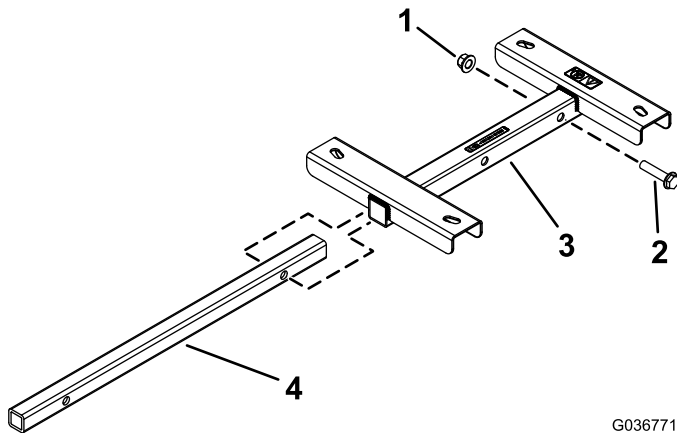

Figure 1

1. Locknut (1/2 inch)
2. Hex-head screw (1/2 x 2-1/4 inches)
3. Hose-reel mount
4. Tube mount

2. Secure the tube mount to the hose-reel mount with the hex-head screw (1/2 x 2-1/4 inches) and the locknut (1/2 inch) as shown in Figure 1.
3. Loosen the "T" handle on the front hitch attachment (Figure 2).

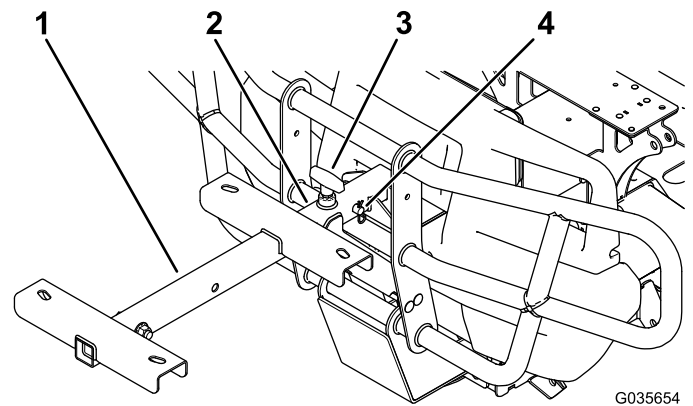

Figure 2

1. Tube mount
  2. Front hitch attachment
  3. "T" handle
  4. Clevis pin (1/2 x 2 inches) and hairpin cotter
4. Insert the tube mount into the front hitch attachment and secure it with the clevis pin (1/2 x 2 inches) and hairpin cotter (Figure 2).
  5. Tighten the "T" handle on the front hitch attachment (Figure 2).

### Installing the Hose-Reel Mount to the Front of the Machine

For Machines with the Front Hitch Kit without a Brush Guard Installed

1. Insert the tube mount into the hose-reel mount until the holes in the tube mount align with the farthest holes in the hose-reel mount (Figure 1).
2. Secure the tube mount to the hose-reel mount with the hex-head screw (1/2 x 2-1/4 inches) and the locknut (1/2 inch) as shown in Figure 1.
3. Loosen the "T" handle on the front hitch attachment (Figure 3).

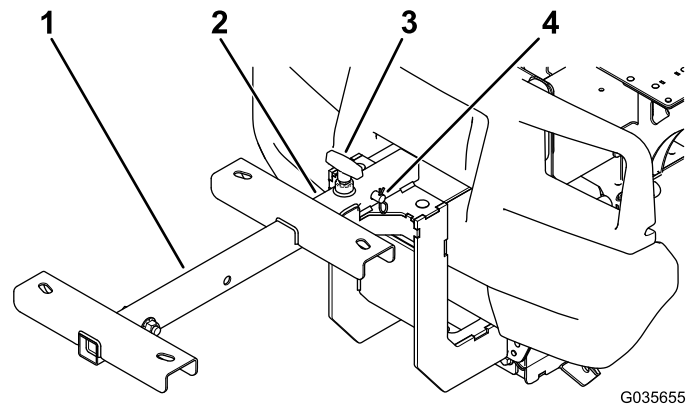

Figure 3

1. Tube mount
2. Front hitch attachment
3. "T" handle
4. Clevis pin (1/2 x 2 inches) and hairpin cotter

4. Insert the tube mount into the front hitch attachment and secure it with the clevis pin (1/2 x 2 inches) and hairpin cotter (Figure 3).
5. Tighten the "T" handle on the front hitch attachment (Figure 3).

## Installing the Hose-Reel Mount to the Rear of the Machine

1. Insert the tube mount into the hose-reel mount until the holes in the tube mount align with the front holes in the hose-reel mount (Figure 4).

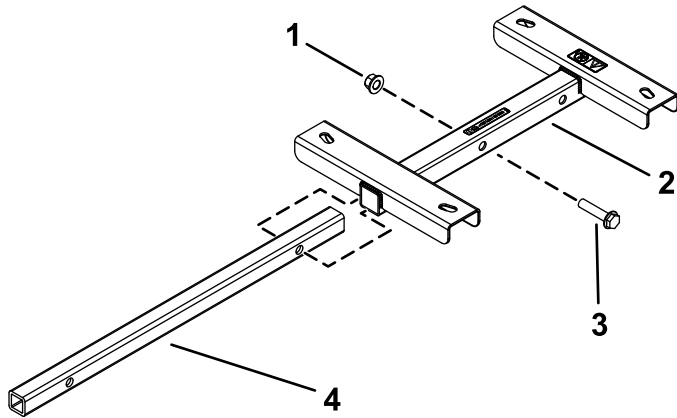

**Figure 4**

- |                       |  |
|-----------------------|--|
| 1. Locknut (1/2 inch) | 3. Hex-head screw (1/2 x 2-1/4 inches) |
| 2. Hose-reel mount    | 4. Tube mount                          |

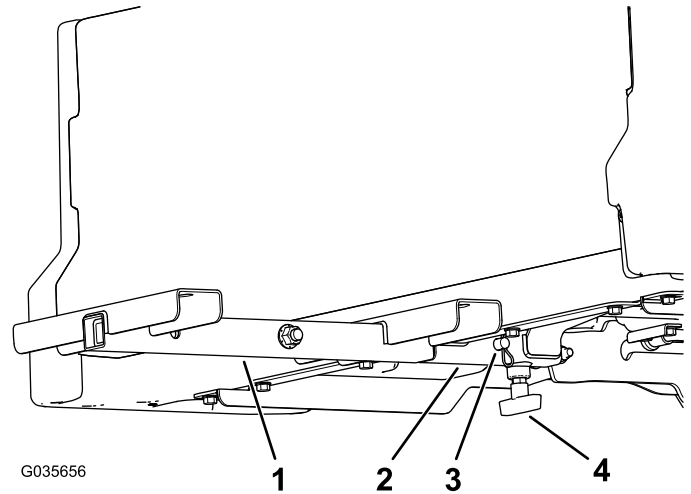

**Figure 5**

- |                       |   |
|-----------------------|---|
| 1. Tube mount         | 3. Clevis pin (1/2 x 2 inches) and hairpin cotter |
| 2. Cargo bed receiver | 4. "T" handle                                     |
- 
4. Insert the tube mount into the cargo bed receiver and secure it with the clevis pin (1/2 x 2 inches) and hairpin cotter (Figure 5).
  5. Tighten the "T" handle on the cargo bed receiver (Figure 5).

2. Secure the tube mount to the hose-reel mount with the hex-head screw (1/2 x 2-1/4 inches) and the locknut (1/2 inch) as shown in Figure 4.
3. Loosen the "T" handle on the cargo bed receiver (Figure 5).