



Drag Mat Carrier System

Sand Pro®/Infield Pro® 3040 and 5040 Traction Unit

Model No. 08756—Serial No. 260000001 and Up

Installation Instructions

⚠ WARNING

CALIFORNIA Proposition 65 Warning

This product contains a chemical or chemicals known to the State of California to cause cancer, birth defects, or reproductive harm.

Introduction

Read this information carefully to learn how to operate and maintain your product properly and to avoid injury and product damage. You are responsible for operating the product properly and safely.

You may contact Toro directly at www.Toro.com for product and accessory information, help finding a dealer, or to register your product.

Whenever you need service, genuine Toro parts, or additional information, contact an Authorized Service Dealer or Toro Customer Service and have the model and serial numbers of your product ready. Figure 1 identifies the location of the model and serial numbers on the product. Write the numbers in the space provided.

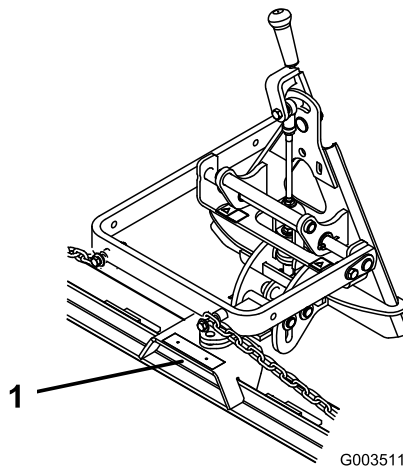

Figure 1

1. Model and serial number location

Model No. _____

Serial No. _____

This manual identifies potential hazards and has safety messages identified by the safety-alert symbol (Figure 2), which signals a hazard that may cause serious injury or death if you do not follow the recommended precautions.



Figure 2

1. Safety-alert symbol

This manual uses 2 words to highlight information.

Important calls attention to special mechanical information and **Note** emphasizes general information worthy of special attention.

Contents

Introduction	1
Safety	3
Safety and Instructional Decals	3
Setup	3
1 Assembling the Drag Mat Carrier	4
2 Installing a Mat	5
3 Mounting the Drag Mat Carrier to the Traction Unit	6
4 Adjusting the Link Assembly	7
5 Reading the Documentation and Storing the Loose Parts	7
Product Overview	8
Operation	8
Restraining the Side-to-Side Pivot	8



Using the Drag Mat Carrier.....	9
Adjusting the Transport Position	9
Removing the Drag-Mat-Carrier System	9
Maintenance	10
Inspecting and Cleaning the Drag-Mat Carrier and Traction Unit	10
Greasing the Attachment Adapter.....	10

Safety

Safety and Instructional Decals



Safety decals and instructions are easily visible to the operator and are located near any area of potential danger. Replace any decal that is damaged or lost.



106-5517

1. Warning—do not touch the hot surface.

Installation

Loose Parts

Use the chart below to verify that all parts have been shipped.

Procedure	Description	Qty.	Use
1	Drag-mat-carrier assembly Attachment-adapter assembly Shoulder bolt Washer (0.531 x 1.063 inch) Washer (0.469 x 0.922 inch) Locknut (7/16 inch) Bolt (3/8 x 2-1/2 inches) Washer (3/8 x 7/8 inch) Spacer Locknut (3/8 inch) Shackle Clevis pin (3/8 x 1-1/2 inches) Cotter pin	1 1 1 1 3 1 2 4 2 2 2 2 2	Assemble the drag mat carrier.
2	Steel mat (not included in this kit, order separately) Coconut-fiber mat (not included in this kit, order separately) Mat retainer Bolt (3/8 x 1 inch) Flange nut (3/8 inch)	1 1 11 11 11	Install a mat.
3	No parts required	—	Mount the drag mat carrier to the traction unit.
4	No parts required	—	Adjust the link assembly.

Procedure	Description	Qty.	Use
5	Operator's Manual	1	Read the documentation and store the loose parts.
	Parts Catalog	1	
	Clevis pin	1	
	Washer (0.469 x 0.922 inch)	1	
	Hairpin cotter	1	

1

Assembling the Drag Mat Carrier

Parts needed for this procedure:

1	Drag-mat-carrier assembly
1	Attachment-adapter assembly
1	Shoulder bolt
1	Washer (0.531 x 1.063 inch)
3	Washer (0.469 x 0.922 inch)
1	Locknut (7/16 inch)
2	Bolt (3/8 x 2-1/2 inches)
4	Washer (3/8 x 7/8 inch)
2	Spacer
2	Locknut (3/8 inch)
2	Shackle
2	Clevis pin (3/8 x 1-1/2 inches)
2	Cotter pin

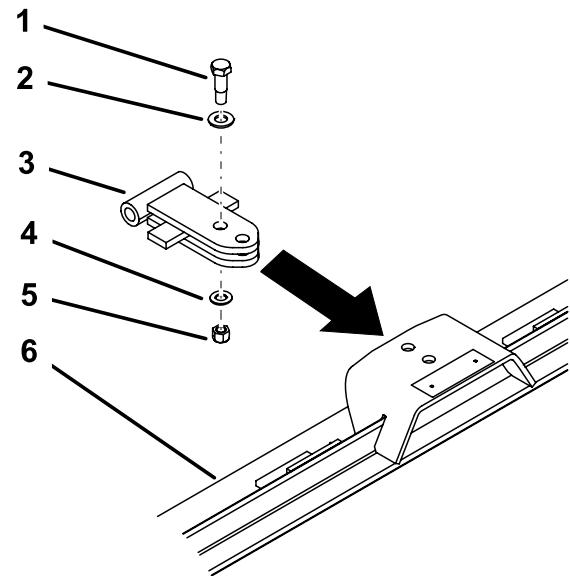

G037616

Figure 3

- | | |
|--------------------------------|--------------------------------|
| 1. Shoulder bolt | 4. Washer (0.469 x 0.922 inch) |
| 2. Washer (0.531 x 1.063 inch) | 5. Locknut (7/16 inch) |
| 3. Pivot assembly | 6. Drag-mat carrier |

Procedure

1. Secure the pivot assembly on the attachment adapter to the drag-mat carrier with a shoulder bolt, washer (0.531 x 1.063 inch), washer (0.469 x 0.922 inch) and locknut (7/16 inch) as shown in [Figure 3](#).

2. Secure the top link of each chain to the back of the lift arm using a bolt (3/8 x 2-1/2 inches), 2 washers (3/8 x 7/8 inch), a spacer, and a locknut (3/8 inch); refer to [Figure 4](#).

2

Installing a Mat

Parts needed for this procedure:

1	Steel mat (not included in this kit, order separately)
1	Coconut-fiber mat (not included in this kit, order separately)
11	Mat retainer
11	Bolt (3/8 x 1 inch)
11	Flange nut (3/8 inch)

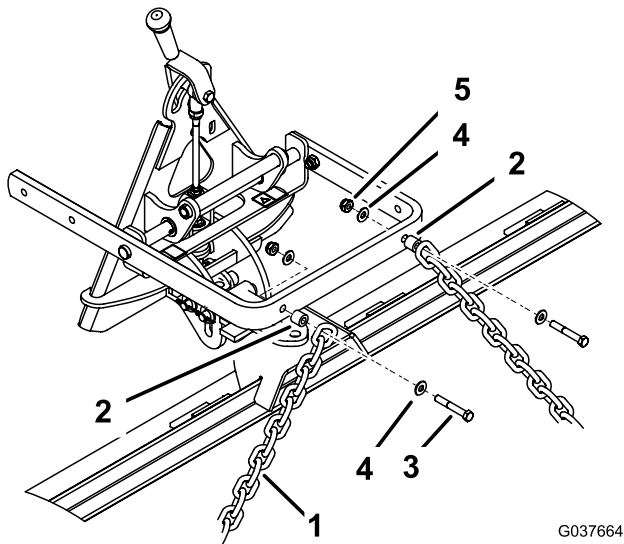

Figure 4

1. Chain
2. Spacer
3. Bolt (3/8 x 2-1/2 inches)
4. Washer (3/8 x 7/8 inch)
5. Locknut (3/8 inch)

3. Thread a shackle through the bottom link of each chain on the lift arm (Figure 5).

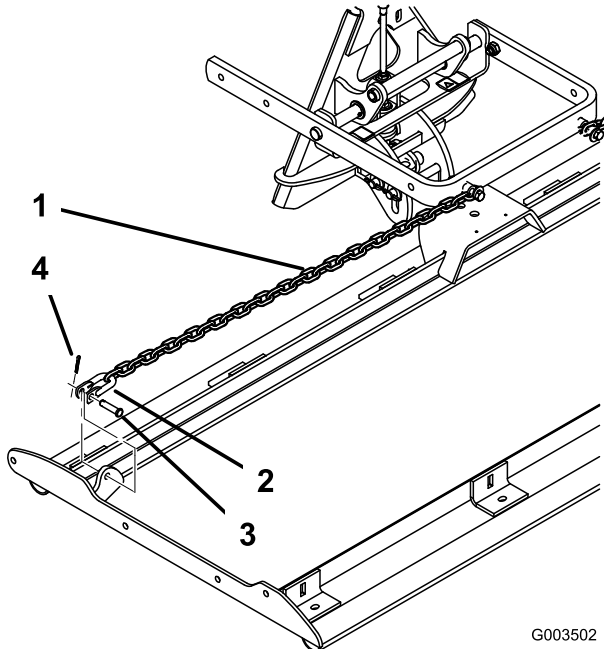

Figure 5

1. Chain
2. Shackle
3. Clevis pin (3/8 x 1-1/2 inches)
4. Cotter pin

4. Secure each shackle to the drag-mat-carrier assembly as illustrated in Figure 5 using a clevis pin (3/8 x 1-1/2 inches) and a cotter pin.

Note: For proper operation of the attachment, the chains must be slack when the drag mat is in the lowered (operating) position.

Procedure

1. Line up 1 edge of the mat with the rear edge of the carrier.

Important: If you are installing the steel mat, position the mat so that the tabs along the outside edge face rearward when the installation is complete. This orientation prevents the tabs from bending and other subsequent damage from occurring.

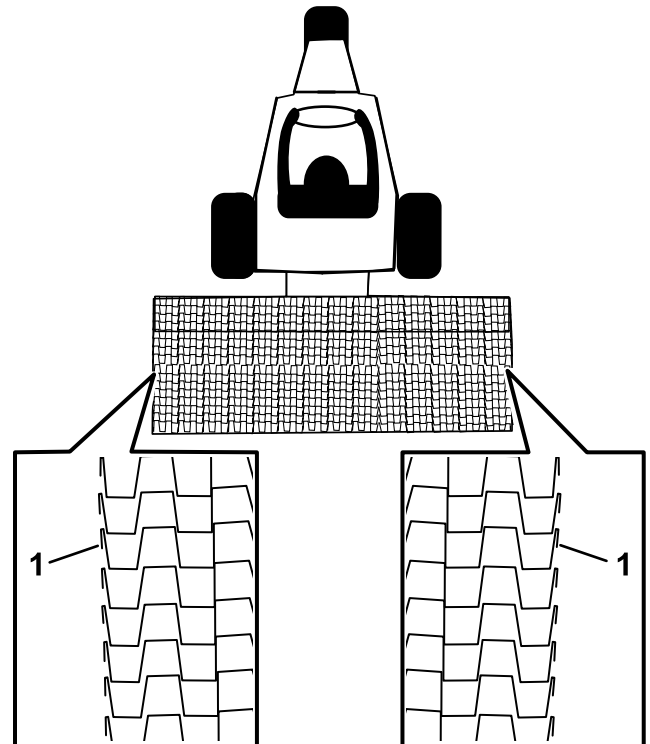

Figure 6

1. Tabs facing rearward

2. If you are installing the coconut-fiber mat, drill a hole (3/8 inch) in the mat at each clamp location, using the mat retainer as a template (Figure 7).

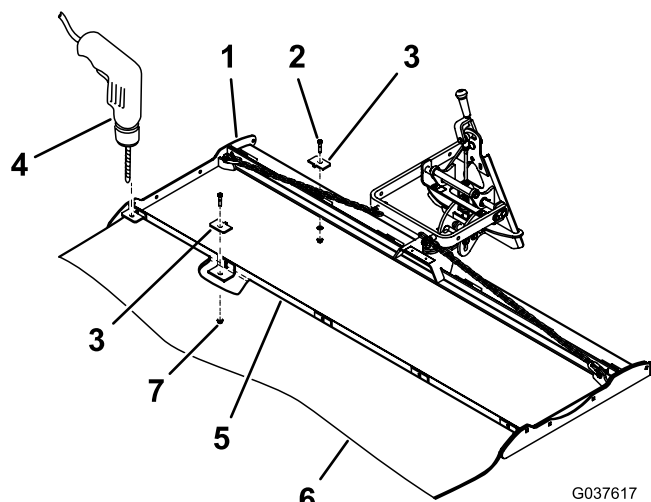

Figure 7

- | | |
|----------------------------------|---|
| 1. Drag-mat carrier | 5. Align the edge of the mat to the rear edge of the carrier. |
| 2. Bolt—3/8 x 1 inch (11) | 6. Coconut-fiber mat |
| 3. Mat retainer (11) | 7. Flange nut—3/8 inch (11) |
| 4. Drill a hole (3/8 inch) here. | |

3. For either mat, secure the edge of the mat to the drag mat carrier as shown in Figure 7, using 5 bolts (3/8 x 1 inch), mat retainers, and flange nuts (3/8 inch).
4. Wrap the mat under the drag mat carrier and repeat steps 1 through 3 for the front edge of the carrier using the remaining mounting hardware.
5. If you will be using the drag mat carrier on a golf green, remove the skid located on each side of the carrier frame (Figure 8).

Note: Using the steel mat is not recommended on golf greens.

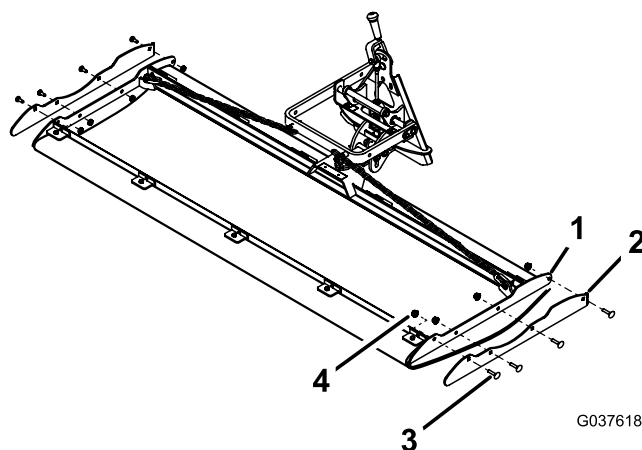

Figure 8

- | | |
|--------------------------|---------|
| 1. Drag-mat carrier side | 3. Bolt |
| 2. Skid | 4. Nut |

3

Mounting the Drag Mat Carrier to the Traction Unit

No Parts Required

Procedure

1. Remove any attachment from the rear of the machine.
2. Lower the traction-unit adapter. Back the traction unit into position in front of the attachment adapter.

Note: Make sure that the locking lever is pivoted to the left (unlocked position) as viewed from the rear of the machine.

3. Slide the attachment adapter onto the adapter on the traction unit.

Note: Position the long leg of the lift-arm assembly under the rear frame of the traction unit (Figure 9).

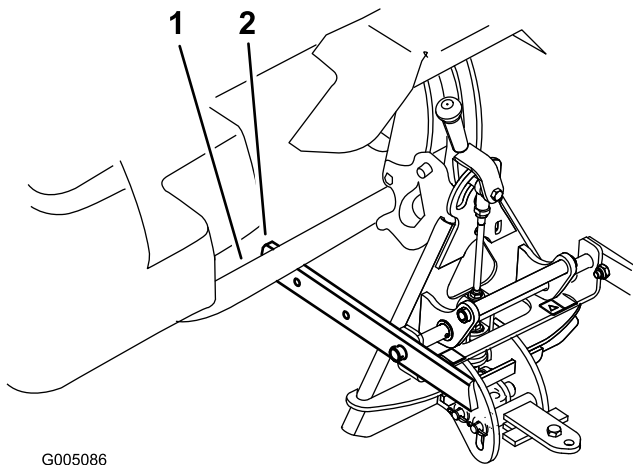

Figure 9

1. Rear frame of the traction unit
 2. Long leg of the lift-arm assembly
-
4. Pivot the locking lever to the right to lock the adapters together.

4

Adjusting the Link Assembly

No Parts Required

Procedure

1. With the drag mat mounted and secured on the traction unit, measure the gap between the top washer and the spacer in the link assembly on the attachment adapter as shown in [Figure 10](#).

The gap between the washer and the shoulder should be 1.5 mm to 2.0 mm (0.060 to 0.080 inch); refer to [Figure 10](#).

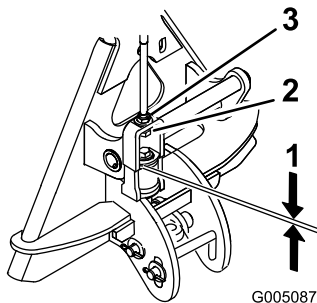

Figure 10

1. 1.5 mm to 2.0 mm (0.060 to 0.080 inch)
2. Adjustment nut
3. Jam nut

2. If the gap is not correct, loosen the jam nut and tighten or loosen the adjustment nut on the link assembly as needed to change the gap ([Figure 10](#)).

5

Reading the Documentation and Storing the Loose Parts

Parts needed for this procedure:

1	<i>Operator's Manual</i>
1	<i>Parts Catalog</i>
1	Clevis pin
1	Washer (0.469 x 0.922 inch)
1	Hairpin cotter

Procedure

1. Read the documentation.
2. Store the documentation in a safe place.
3. Store any loose parts for use when securing the side-to-side pivot.

Product Overview

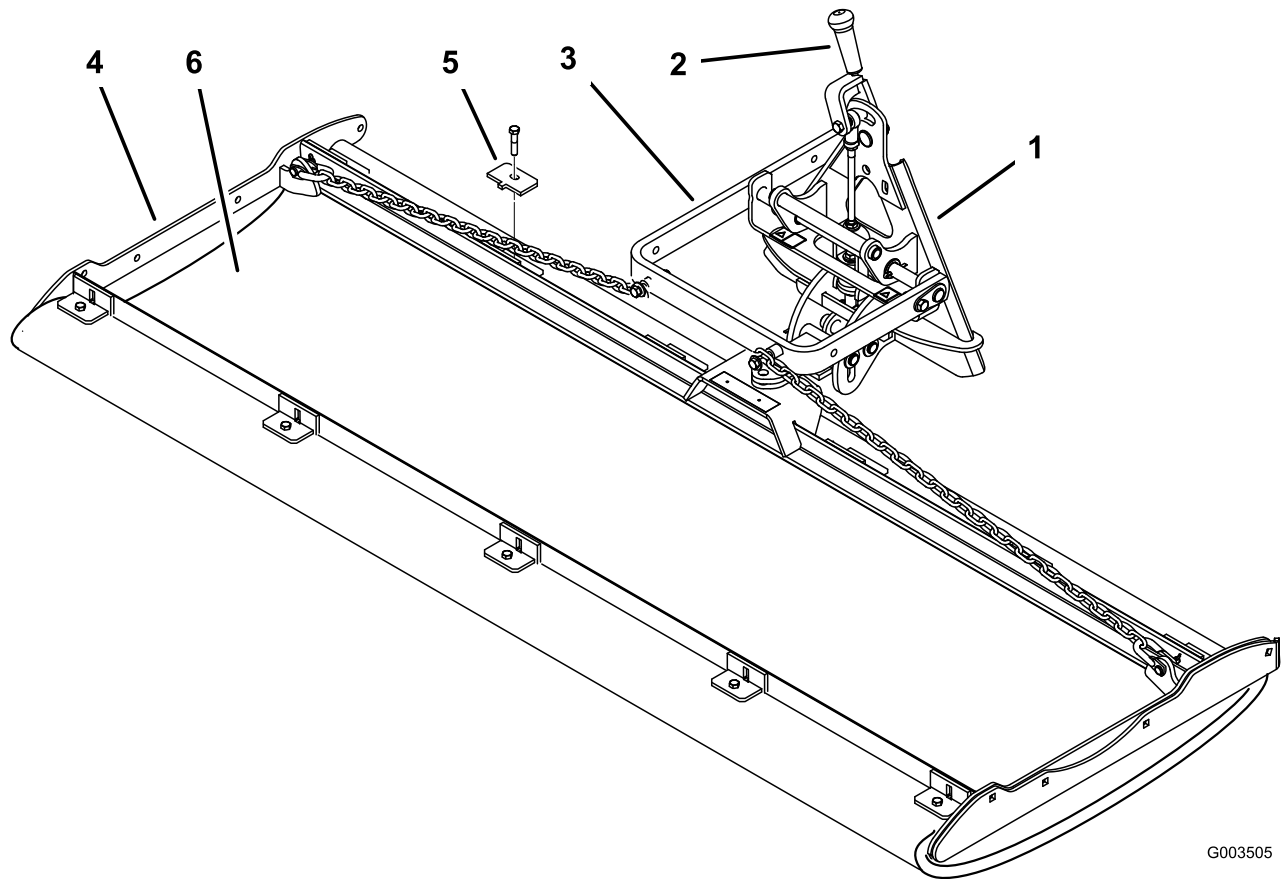

G003505

Figure 11

- | | |
|-----------------------|---------------------|
| 1. Attachment adapter | 4. Drag-mat carrier |
| 2. Locking lever | 5. Mat retainer |
| 3. Lift arm | 6. Drag mat |

Operation

Restraining the Side-to-Side Pivot

As installed, the drag-mat carrier pivots side to side when you turn corners to better follow the traction unit and protect the edges of the drag mat. To follow a line or straight edges, install a clevis pin, washer, and hairpin cotter through the pivot assembly as shown in [Figure 12](#).

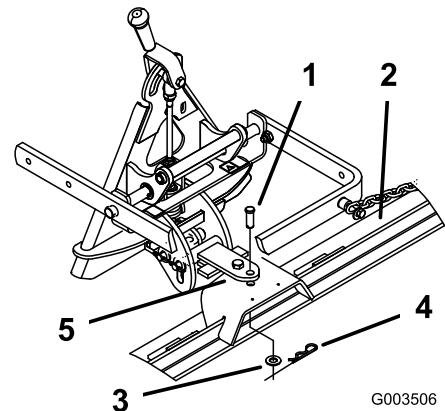

G003506

Figure 12

- | | |
|---------------------|-------------------|
| 1. Clevis pin | 4. Hairpin cotter |
| 2. Drag-mat carrier | 5. Pivot assembly |
| 3. Washer | |

Note: Using this restrained position for operation other than a straight line is not recommended. The pin should only be installed to follow lines or straight edges. In most conditions,

you will not need it. The excess skidding of the drag mat can cause cosmetic damage to the edges.

Using the Drag Mat Carrier

The drag-mat carrier is designed to have the traction unit adapter in the lowest position while in use. When lowered, the pivot assembly should be approximately in the center of the slot (Figure 13).

Note: Do not use the coconut-fiber mat in heavy, wet conditions. The mat will fill up with material and not work properly.

Note: Using the steel mat is not recommended on golf greens.

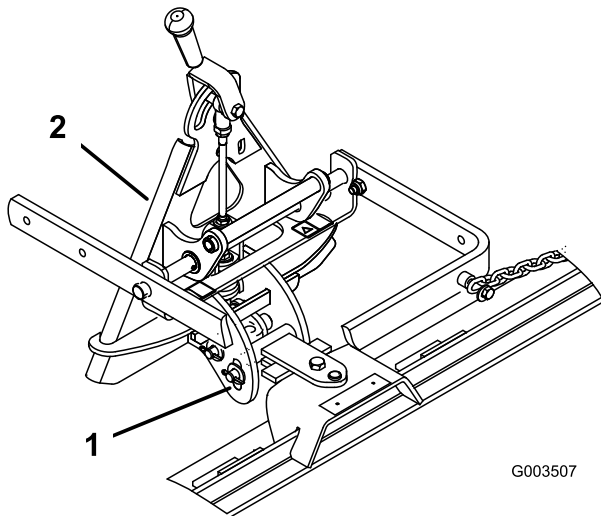

Figure 13

1. Slot
2. Attachment adapter

Adjusting the Transport Position

Complete the following procedure to increase the height of the drag-mat carrier when transporting:

1. Lower the drag-mat carrier as low as possible.
2. Disconnect the chains from the lift arms and connect them in a different link.

Note: To ensure proper operation of the drag-mat carrier, return the chains must to the original slack position before beginning operation.

Removing the Drag-Mat-Carrier System

1. Pivot the locking lever to the left (Figure 14).
2. Lower the traction-unit adapter.
3. Grab the handle lift and tilt the attachment back onto the attachment (Figure 14).

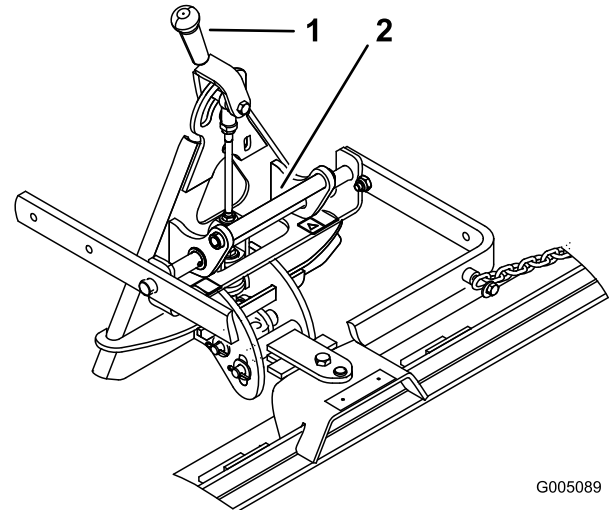

Figure 14

1. Locking lever
2. Handle

Note: If the attachment adapter becomes stuck to the traction-unit adapter, insert a pry bar/screwdriver into the pry slot to disengage the parts (Figure 15).

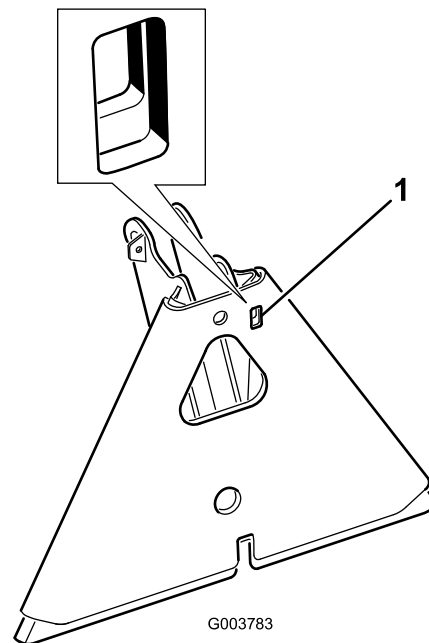

Figure 15

1. Pry slot

Maintenance

Inspecting and Cleaning the Drag-Mat Carrier and Traction Unit

When you finish operating the machine, clean the it thoroughly. Wash off the machine after each use. If you clean the machine frequently (before the material has a chance to cake), you can clean it with a stream of water from a hose with the nozzle removed. A high-pressure stream could drive the material into wear areas where it could act as a grinding compound.

Greasing the Attachment Adapter

If the locking lever on the attachment adapter does not pivot freely and easily, apply a light coat of grease to the area shown in [Figure 16](#).

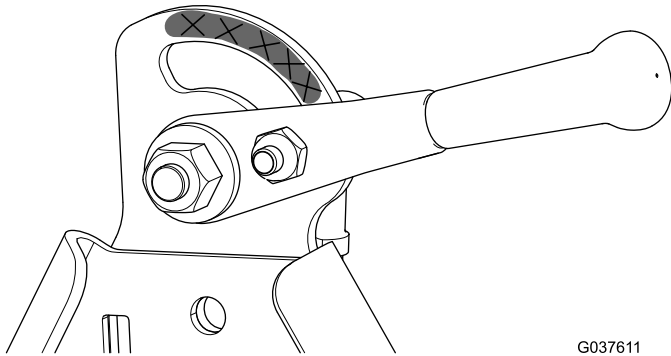

Figure 16

G037611

European Privacy Notice

The Information Toro Collects

Toro Warranty Company (Toro) respects your privacy. In order to process your warranty claim and contact you in the event of a product recall, we ask you to share certain personal information with us, either directly or through your local Toro company or dealer.

The Toro warranty system is hosted on servers located within the United States where privacy law may not provide the same protection as applies in your country.

BY SHARING YOUR PERSONAL INFORMATION WITH US, YOU ARE CONSENTING TO THE PROCESSING OF YOUR PERSONAL INFORMATION AS DESCRIBED IN THIS PRIVACY NOTICE.

The Way Toro Uses Information

Toro may use your personal information to process warranty claims, to contact you in the event of a product recall and for any other purpose which we tell you about. Toro may share your information with Toro's affiliates, dealers or other business partners in connection with any of these activities. We will not sell your personal information to any other company. We reserve the right to disclose personal information in order to comply with applicable laws and with requests by the appropriate authorities, to operate our systems properly or for our own protection or that of other users.

Retention of your Personal Information

We will keep your personal information as long as we need it for the purposes for which it was originally collected or for other legitimate purposes (such as regulatory compliance), or as required by applicable law.

Toro's Commitment to Security of Your Personal Information

We take reasonable precautions in order to protect the security of your personal information. We also take steps to maintain the accuracy and current status of personal information.

Access and Correction of your Personal Information

If you would like to review or correct your personal information, please contact us by email at legal@toro.com.

Australian Consumer Law

Australian customers will find details relating to the Australian Consumer Law either inside the box or at your local Toro Dealer.



The Toro Warranty

A Two-Year Limited Warranty

Conditions and Products Covered

The Toro Company and its affiliate, Toro Warranty Company, pursuant to an agreement between them, jointly warrant your Toro Commercial product ("Product") to be free from defects in materials or workmanship for two years or 1500 operational hours*, whichever occurs first. This warranty is applicable to all products with the exception of Aerators (refer to separate warranty statements for these products). Where a warrantable condition exists, we will repair the Product at no cost to you including diagnostics, labor, parts, and transportation. This warranty begins on the date the Product is delivered to the original retail purchaser.

* Product equipped with an hour meter.

Instructions for Obtaining Warranty Service

You are responsible for notifying the Commercial Products Distributor or Authorized Commercial Products Dealer from whom you purchased the Product as soon as you believe a warrantable condition exists. If you need help locating a Commercial Products Distributor or Authorized Dealer, or if you have questions regarding your warranty rights or responsibilities, you may contact us at:

Toro Commercial Products Service Department
Toro Warranty Company
8111 Lyndale Avenue South
Bloomington, MN 55420-1196

952-888-8801 or 800-952-2740
E-mail: commercial.warranty@toro.com

Owner Responsibilities

As the Product owner, you are responsible for required maintenance and adjustments stated in your *Operator's Manual*. Failure to perform required maintenance and adjustments can be grounds for disallowing a warranty claim.

Items and Conditions Not Covered

Not all product failures or malfunctions that occur during the warranty period are defects in materials or workmanship. This warranty does not cover the following:

- Product failures which result from the use of non-Toro replacement parts, or from installation and use of add-on, or modified non-Toro branded accessories and products. A separate warranty may be provided by the manufacturer of these items.
- Product failures which result from failure to perform recommended maintenance and/or adjustments. Failure to properly maintain your Toro product per the Recommended Maintenance listed in the *Operator's Manual* can result in claims for warranty being denied.
- Product failures which result from operating the Product in an abusive, negligent, or reckless manner.
- Parts subject to consumption through use unless found to be defective. Examples of parts which are consumed, or used up, during normal Product operation include, but are not limited to, brake pads and linings, clutch linings, blades, reels, rollers and bearings (sealed or greasable), bed knives, spark plugs, castor wheels and bearings, tires, filters, belts, and certain sprayer components such as diaphragms, nozzles, and check valves, etc.
- Failures caused by outside influence. Conditions considered to be outside influence include, but are not limited to, weather, storage practices, contamination, use of unapproved fuels, coolants, lubricants, additives, fertilizers, water, or chemicals, etc.
- Failure or performance issues due to the use of fuels (e.g. gasoline, diesel, or biodiesel) that do not conform to their respective industry standards.

- Normal noise, vibration, wear and tear, and deterioration.
- Normal "wear and tear" includes, but is not limited to, damage to seats due to wear or abrasion, worn painted surfaces, scratched decals or windows, etc.

Parts

Parts scheduled for replacement as required maintenance are warranted for the period of time up to the scheduled replacement time for that part. Parts replaced under this warranty are covered for the duration of the original product warranty and become the property of Toro. Toro will make the final decision whether to repair any existing part or assembly or replace it. Toro may use remanufactured parts for warranty repairs.

Deep Cycle and Lithium-Ion Battery Warranty:

Deep cycle and Lithium-Ion batteries have a specified total number of kilowatt-hours they can deliver during their lifetime. Operating, recharging, and maintenance techniques can extend or reduce total battery life. As the batteries in this product are consumed, the amount of useful work between charging intervals will slowly decrease until the battery is completely worn out. Replacement of worn out batteries, due to normal consumption, is the responsibility of the product owner. Battery replacement may be required during the normal product warranty period at owner's expense. Note: (Lithium-Ion battery only): A Lithium-Ion battery has a part only prorated warranty beginning year 3 through year 5 based on the time in service and kilowatt hours used. Refer to the *Operator's Manual* for additional information.

Maintenance is at Owner's Expense

Engine tune-up, lubrication, cleaning and polishing, replacement of filters, coolant, and completing recommended maintenance are some of the normal services Toro products require that are at the owner's expense.

General Conditions

Repair by an Authorized Toro Distributor or Dealer is your sole remedy under this warranty.

Neither The Toro Company nor Toro Warranty Company is liable for indirect, incidental or consequential damages in connection with the use of the Toro Products covered by this warranty, including any cost or expense of providing substitute equipment or service during reasonable periods of malfunction or non-use pending completion of repairs under this warranty. Except for the Emissions warranty referenced below, if applicable, there is no other express warranty. All implied warranties of merchantability and fitness for use are limited to the duration of this express warranty.

Some states do not allow exclusions of incidental or consequential damages, or limitations on how long an implied warranty lasts, so the above exclusions and limitations may not apply to you. This warranty gives you specific legal rights, and you may also have other rights which vary from state to state.

Note regarding engine warranty:

The Emissions Control System on your Product may be covered by a separate warranty meeting requirements established by the U.S. Environmental Protection Agency (EPA) and/or the California Air Resources Board (CARB). The hour limitations set forth above do not apply to the Emissions Control System Warranty. Refer to the Engine Emission Control Warranty Statement supplied with your product or contained in the engine manufacturer's documentation for details.

Countries Other than the United States or Canada

Customers who have purchased Toro products exported from the United States or Canada should contact their Toro Distributor (Dealer) to obtain guarantee policies for your country, province, or state. If for any reason you are dissatisfied with your Distributor's service or have difficulty obtaining guarantee information, contact the Toro importer.