



# Pneumatic Seat Suspension Kit

## Groundsmaster® Traction Units

Model No. 30313

### Installation Instructions

#### ⚠ WARNING

##### CALIFORNIA Proposition 65 Warning

This product contains a chemical or chemicals known to the State of California to cause cancer, birth defects, or reproductive harm.

**Note:** For Groundsmaster 4500 and 4700 traction units, this kit fits on only models 30856 and 30868, model years 2006 through 2008.

## Installation

### Loose Parts

Use the chart below to verify that all parts have been shipped.

Procedure	Description	Qty.	Use
<b>2</b>	Suspension assembly	1	Install the seat and suspension assembly.
	Lower bracket	2	
	Bolt—8 x 12 mm (Groundsmaster 3280 and 3320 models only)	4	
	Bolt (5/16 x 3/4 inch)	8	
	Nut (5/16 inch)	4	
	Seat (sold separately)	1	
	Left seat bracket (Groundsmaster 3280 and 3320 models only)	1	
	Right seat bracket (Groundsmaster 3280 and 3320 models only)	1	
	Left adjuster	1	
	Right adjuster	1	
	Nut	4	
	Cap	4	
	Washer (Groundsmaster 4500 and 4700 models only)	4	
<b>3</b>	Short wire harness (Groundsmaster 3280 and 3320 models only)	1	Route the wire harness
	Long wire harness (Groundsmaster 4500 and 4700 models only)	1	
	Fuse	1	
<b>4</b>	No parts required	—	Complete the installation.



# 1

## Preparing the Machine

### No Parts Required

### Procedure

1. Park the machine on a level surface.
2. Engage the parking brake.
3. Shut off the engine and remove the key.
4. Remove the negative battery cable from the battery.

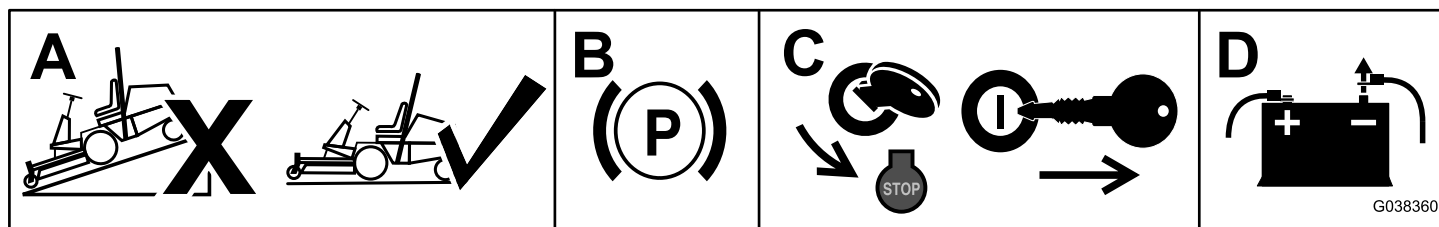

G038360

# 2

## Installing the Seat and Suspension Assembly

### Parts needed for this procedure:

1	Suspension assembly
2	Lower bracket
4	Bolt—8 x 12 mm (Groundsmaster 3280 and 3320 models only)
8	Bolt (5/16 x 3/4 inch)
4	Nut (5/16 inch)
1	Seat (sold seperately)
1	Left seat bracket (Groundsmaster 3280 and 3320 models only)
1	Right seat bracket (Groundsmaster 3280 and 3320 models only)
1	Left adjuster
1	Right adjuster
4	Nut
4	Cap
4	Washer (Groundsmaster 4500 and 4700 models only)

### Groundsmaster 3280 and 3320 Models

**Note:** You must install the Auxiliary Power Unit Kit on the machine before installing this kit.

1. Remove the 4 bolts and nuts securing the seat-mounting plate to the machine and remove the manual tube (Figure 2).

**Note:** Do not remove the plate. When necessary, prop up the plate 1 side at a time when you mount components so that you maintain the position of the seat-switch wire harness.

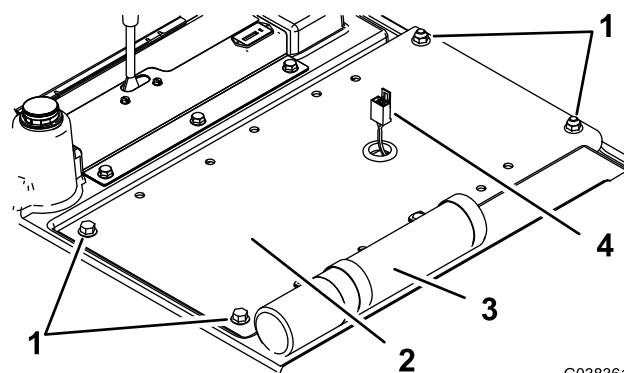

G038361

Figure 2

1. Bolt and nut
2. Seat-mounting plate
3. Manual tube
4. Seat-switch wire harness

2. Install the lower brackets to the suspension assembly using 4 bolts (8 x 12 mm) as shown in [Figure 3](#).

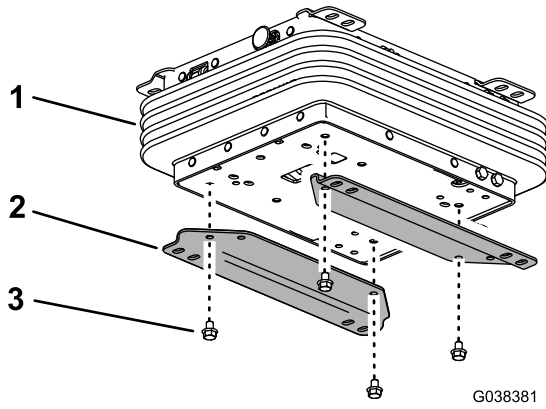

**Figure 3**

- |                        |                     |
|------------------------|---------------------|
| 1. Suspension assembly | 3. Bolt (8 x 12 mm) |
| 2. Lower bracket       |                     |

3. Loosely install the suspension assembly to the seat-mounting plate using 4 bolts (5/16 x 3/4 inch) and 4 nuts (5/16 inch) as shown in [Figure 4](#).

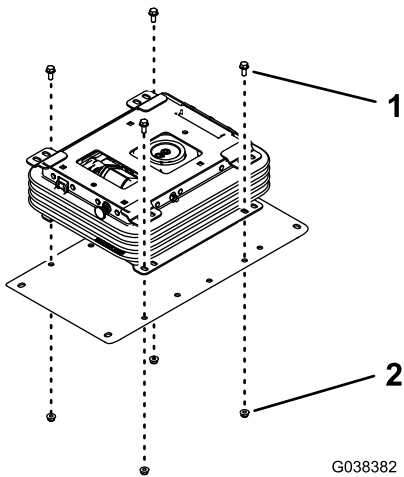
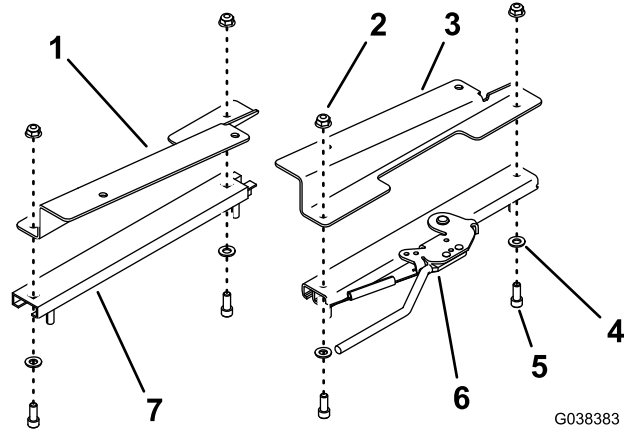

**Figure 4**

- |                           |                    |
|---------------------------|--------------------|
| 1. Bolt (5/16 x 3/4 inch) | 2. Nut (5/16 inch) |
|---------------------------|--------------------|

4. Connect the seat-switch wire harness to the suspension assembly connector.

5. Install the left and right seat brackets to the left and right adjusters using 4 hex-socket bolts (5/16 x 3/4 inch), 4 flat washers, and 4 nuts (5/16 inch) as shown in [Figure 5](#).



**Figure 5**

- |                       |                           |
|-----------------------|---------------------------|
| 1. Right seat bracket | 5. Bolt (5/16 x 3/4 inch) |
| 2. Nut (5/16 inch)    | 6. Left adjuster          |
| 3. Left seat bracket  | 7. Right adjuster         |
| 4. Washer             |                           |

6. Install the seat to the seat brackets using 4 bolts (5/16 x 3/4 inch) as shown in [Figure 6](#).

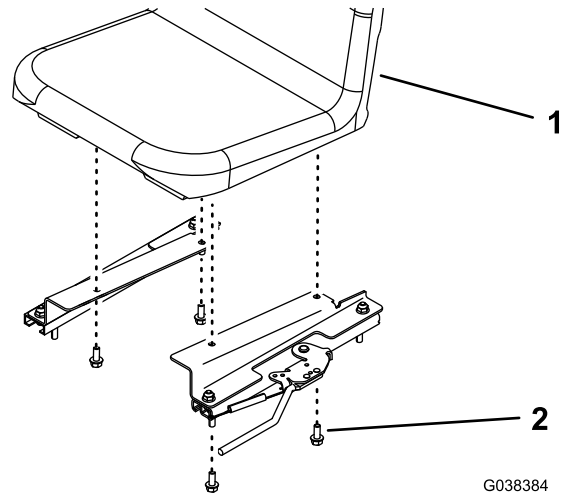

**Figure 6**

- |         |                           |
|---------|---------------------------|
| 1. Seat | 2. Bolt (5/16 x 3/4 inch) |
|---------|---------------------------|

7. Install the seat adjusters and the manual tube to the suspension assembly using 4 nuts and 4 caps (Figure 7).

**Note:** Install the manual tube under the suspension-assembly tabs.

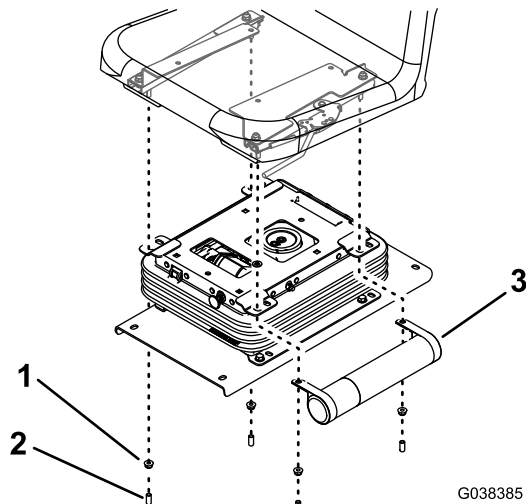

Figure 7

1. Nut  
2. Cap  
3. Manual tube

Groundsmaster 4500 and 4700 Models

1. Unlatch and raise the seat base.  
2. Mount the lower brackets to the suspension assembly using 4 bolts (8 x 12 mm) as shown in Figure 3.  
3. Mount the lower brackets to the seat base (Figure 4).  
4. Mount the left and right adjusters to the seat using 4 bolts (5/16 x 3/4 inch) as shown in Figure 8.

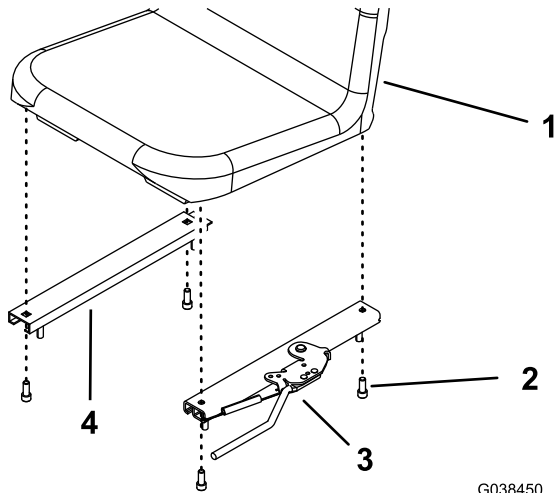

Figure 8

1. Seat  
2. Bolt  
3. Left adjuster  
4. Right adjuster

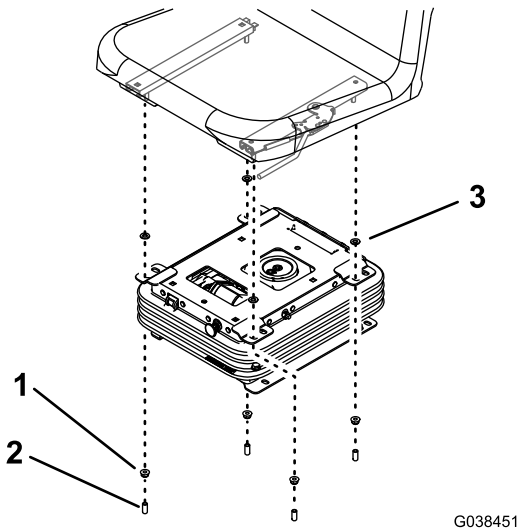

Figure 9

1. Nut  
2. Cap  
3. Washer

3

Routing the Wire Harness

Parts needed for this procedure:

1	Short wire harness (Groundsmaster 3280 and 3320 models only)
1	Long wire harness (Groundsmaster 4500 and 4700 models only)
1	Fuse

Procedure

**Note:** Use the short wire harness for Groundsmaster 3280 and 3320 models; use the long wire harness for Groundsmaster 4500 and 4700 models.

1. For Groundsmaster 3280 and 3320 models, remove the 4 thumbscrews securing the control panel and set the control panel to the side (Figure 10).

For Groundsmaster 4500 and 4700 models, unlatch and open the control panel behind the seat (Figure 11).

5. Mount the seat adjusters to the suspension assembly using 4 washers, 4 nuts, and 4 caps (Figure 9).

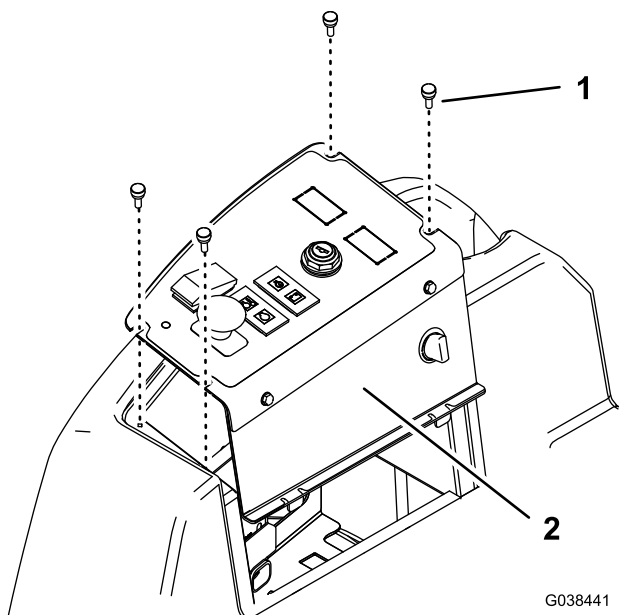

**Figure 10**

Groundmaster 3280 and 3320 Models

1. Thumbscrew      2. Control panel

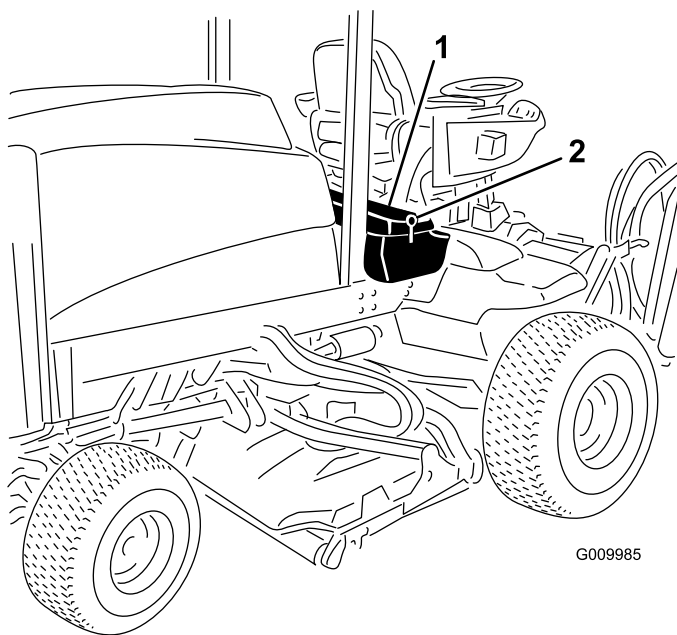
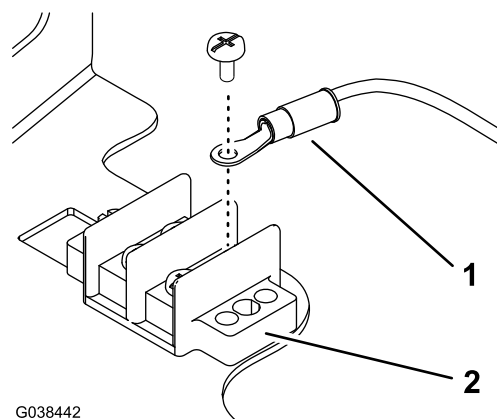

**Figure 11**

Groundmaster 4500 and 4700 Models

1. Control panel      2. Latch

2. Mount the ring terminal of the wire harness to the ground terminal block (Figure 12).



**Figure 12**

1. Ring terminal      2. Ground terminal block

3. Plug the spade terminal into 1 of the red, open leads from the fuse block (Figure 13).

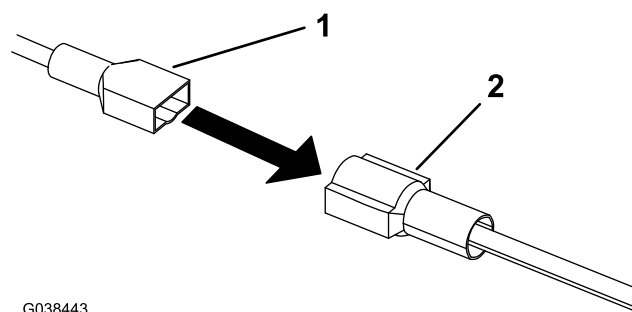

**Figure 13**

1. Spade terminal      2. Fuse-block lead

4. Insert the fuse into an empty slot in the fuse block (Figure 14).

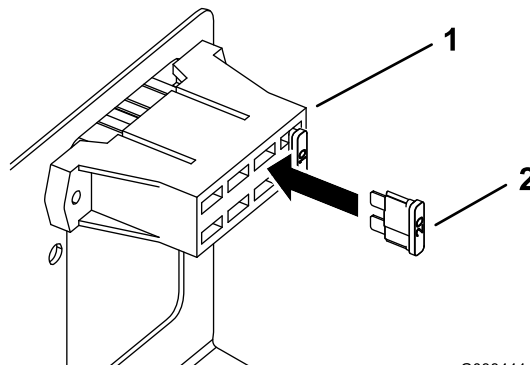

**Figure 14**

1. Fuse block      2. Fuse

5. For Groundmaster 3280 and 3320 models, route the wire harness out the rear of the control panel to the seat-switch wire harness under the seat plate. Connect the wire harness to the seat-switch wire harness.
6. For Groundmaster 4500 and 4700 models, connect the wire harness to the suspension-assembly connector.

# 4

## Completing the Installation

### No Parts Required

### Procedure

1. Slide the seat completely forward and rearward to ensure proper orientation and that the wiring harness and connectors are not pinched and do not contact any moving parts.
2. Tighten the bolts securing the assembly to the seat-mount plate.
3. For Groundsmaster 3280 and 3320 models, secure the seat-mount plate to the machine using the bolts and nuts that you removed previously and secure the control panel using the thumbscrews (Figure 10).

## Operation

### Using the Seat-Adjustment Knobs

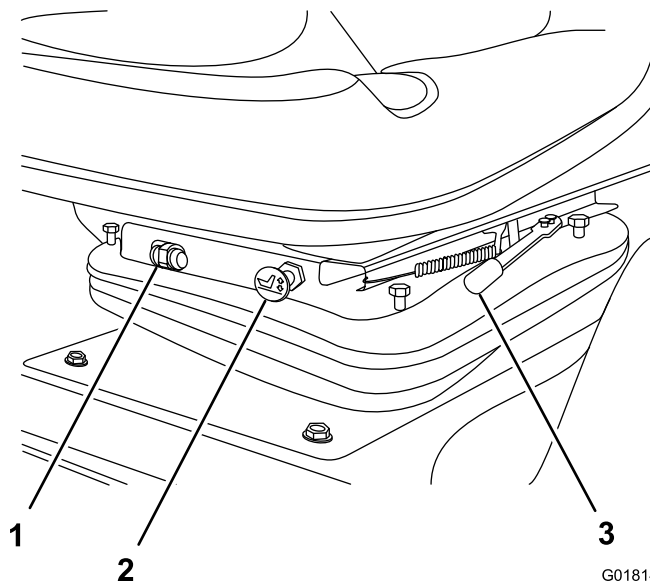

Figure 15

G018148

- |                      |                    |
|----------------------|--------------------|
| 1. Weight gauge      | 3. Adjusting lever |
| 2. Air-control valve |                    |

- Weight gauge—use the gauge to determine when the seat suspension is adjusted to the weight of the operator.
- Air-control valve—push in the control valve to inflate the suspension assembly; pull out the control to deflate the suspension assembly.
- Adjusting lever—move the lever and adjust the seat forward and rearward.

**Notes:**



**Count on it.**