



High Lift Collection, Parking Stand Kit, and Carrier Frame

Groundsmaster® 360 4-Wheel Drive Multi-Purpose Machine

Model No. 30818

Model No. 30866—Serial No. 315000001 and Up

Model No. 30869—Serial No. 315000001 and Up

Installation Instructions

Important: For machines with a Kubota engine, kit 30801 must be installed on the machine. For machines with a Yanmar engine, kit 30898 must be installed on the machine.

⚠ WARNING

CALIFORNIA Proposition 65 Warning

This product contains a chemical or chemicals known to the State of California to cause cancer, birth defects, or reproductive harm.

This product complies with all relevant European directives. For details, please see the Declaration of Incorporation (DOI) at the back of this publication.

Safety

Safety and Instructional Decals



Safety decals and instructions are easily visible to the operator and are located near any area of potential danger. Replace any decal that is damaged or lost.

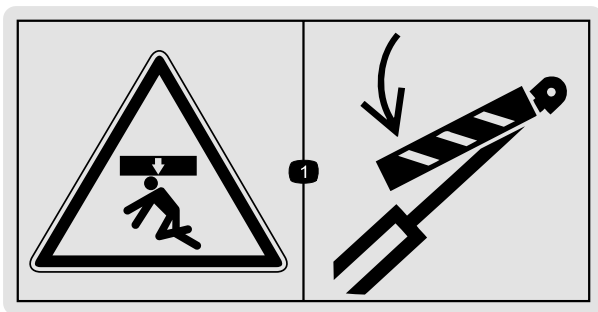

132-4868

1. Crushing hazard—secure the cylinder locks.

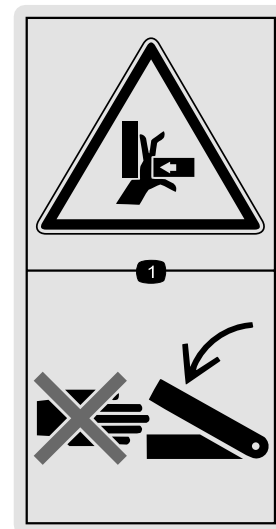

132-4867

1. Crushing hazard—keep away from actuating parts.



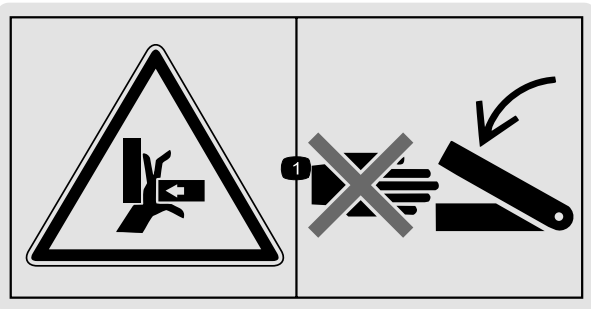

132-4866

1. Crushing hazard—keep away from actuating parts.

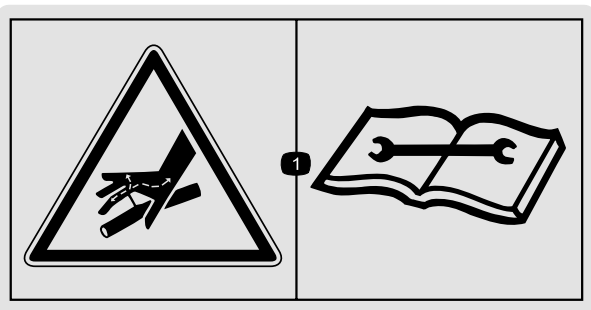

132-4865

1. Puncture hazard of hand; fluid under pressure—read the *Operator's Manual* before servicing or performing maintenance.

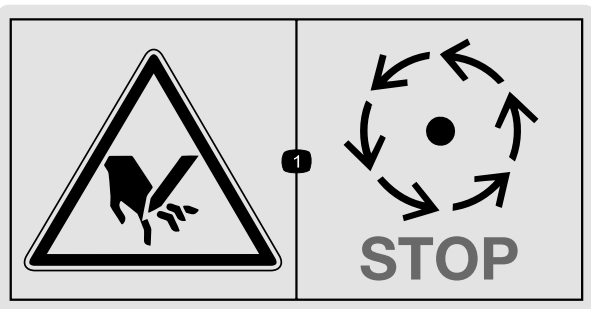

132-4864

1. Cutting hazard—wait until all components have stopped moving before servicing the machine.

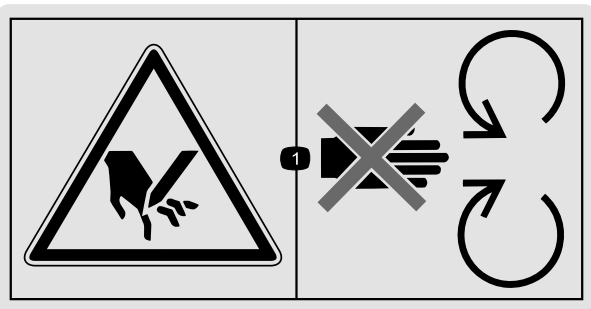

132-4863

1. Cutting hazard—keep away from moving parts.

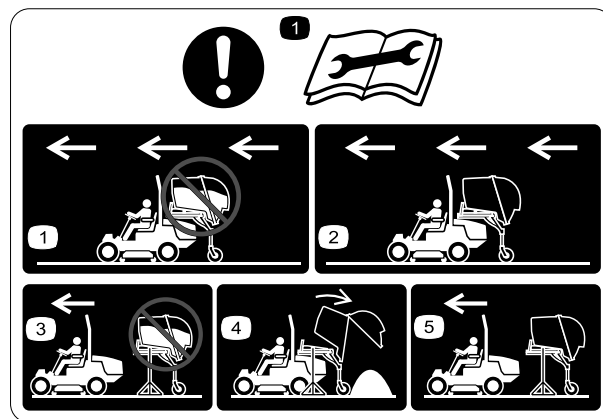

132-4862

1. Attention—read the *Operator's Manual* before performing maintenance; do not transport the vehicle with a full hopper.
2. Only transport the vehicle when the hopper is almost empty.
3. Do not remove the collection system when the hopper is full.
4. Empty the contents of the hopper before storing the collection system.
5. Disengage the vehicle only when the hopper is empty.

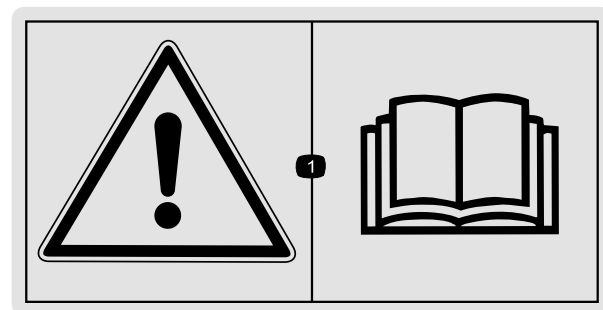

132-4861

1. Warning—read the *Operator's Manual*.

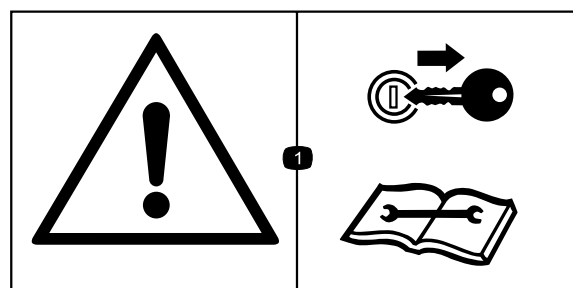

132-4860

1. Warning—remove the key from the ignition and read the *Operator's Manual* before performing maintenance.

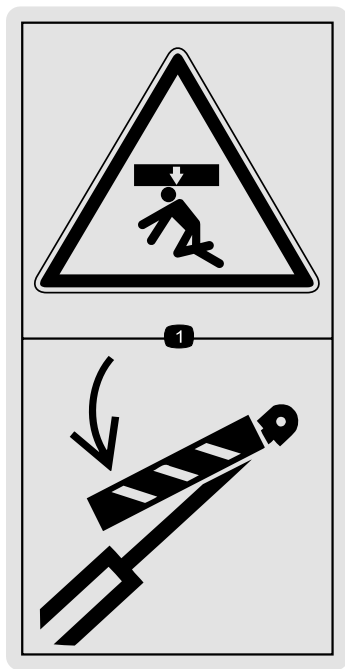

132-4859

1. Crushing hazard—secure the cylinder locks.

Installation

Installing the Carrier Frame Kit

Installing the Bumpers

1. Move the machine to a level surface, engage the parking brake, shut off the engine, and remove the key from the ignition.
2. Loosen the jam nut on the adjusting bolt on the end of a bumper and lower the adjusting bolt as far as it can go ([Figure 1](#)).
3. Install the bumper to the machine frame using a large bolt, washer, and nut from the bumper assembly; do not tighten the fasteners ([Figure 1](#)).

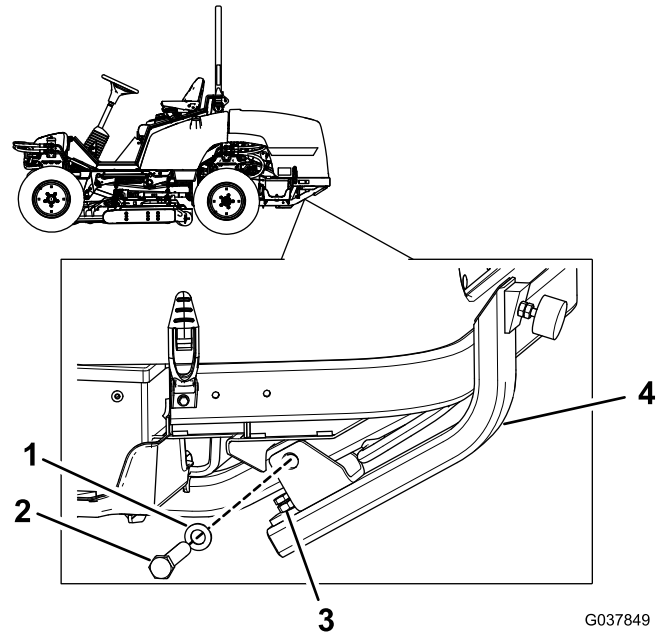

Figure 1

G037849

- | | |
|-------------------------------|--------------------------------|
| 1. Large bolt (nut not shown) | 3. Adjustment bolt and jam nut |
| 2. Washer | 4. Bumper |

4. Adjust the bumper so that it is parallel with the frame, raise the adjustment bolt until it contacts the frame, and secure it with the jam nut ([Figure 2](#)).

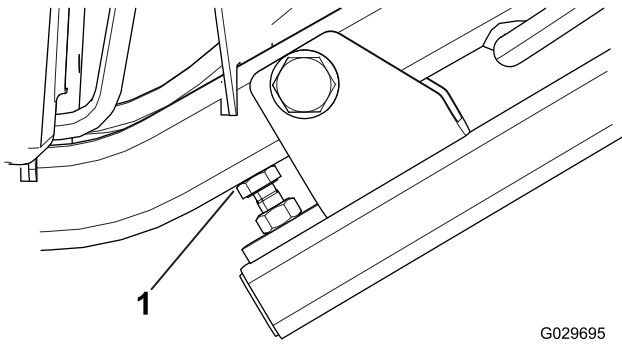

Figure 2

G029695

1. Adjustment bolt against the frame

5. Tighten the bolt and nut securing the bumper to the frame.
6. Repeat this procedure for the other bumper on the other side of the machine.

Assembling the Carrier Frame

1. Block the castor-wheel assembly in an upright position using jack stands under the carrier-frame crossbar (Figure 3).

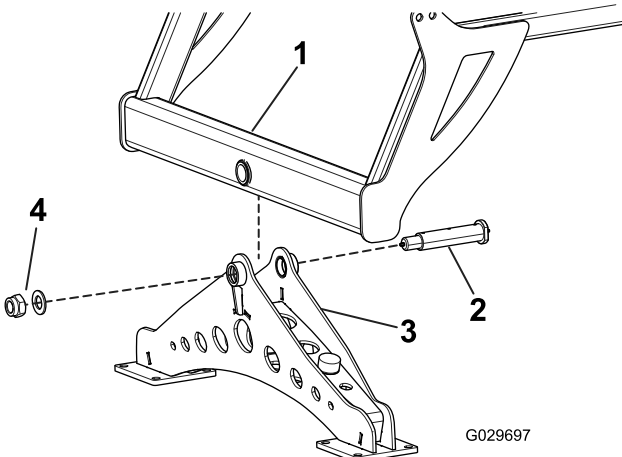

Figure 3

G029697

- | | |
|---------------------------|---|
| 1. Carrier-frame crossbar | 3. Castor-wheel assembly (wheels not shown) |
| 2. Pivot pin | 4. Locknut and washer |

2. Lower the carrier-frame crossbar into the top of the wheel assembly and secure it with a pivot pin, washer, and locknut (Figure 3).
3. Pump No. 2 lithium grease into the fittings on each end of the pin until grease starts to come out of the bearings.

Installing the Carrier Frame

1. Raise the roll bar on the machine and install a pin to secure it on only 1 side of the roll bar.
2. On the other side of the roll bar, install a bolt and nut supplied in the kit into the holes instead of the pin (Figure 4).

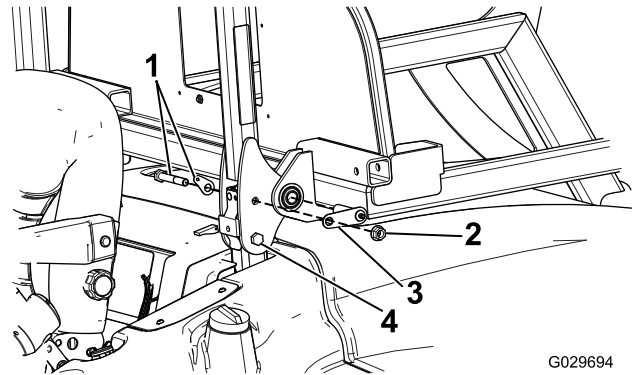

Figure 4

G029694

- | | |
|---------------------------------|--|
| 1. Pivot bolt and tabbed washer | 3. Tabbed pin |
| 2. Nut | 4. Bolt replacing the removable roll bar pin |

3. On the left side of the machine, loosen the clamp on the vent-line hose and slide the hose down the metal tube (Figure 8). Tighten the clamp.

Note: This allows you to install the carrier frame without it contacting the hose.

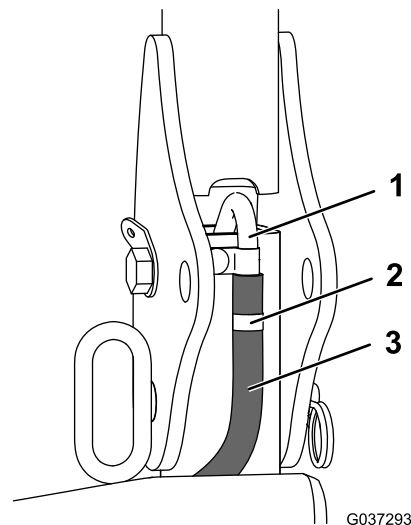

Figure 5

G037293

- | | |
|---------------|---------|
| 1. Metal tube | 3. Hose |
| 2. Clamp | |

4. Remove the pivot bolt, tabbed washer, and nut from the roll bar; install the tabbed washer and pivot bolt from the inside of the bar, but do not install the nut yet (Figure 4).

5. Move the carrier frame up to the roll bar bracket and secure it using a tabbed pin through the rear hole in the bracket (Figure 4).
- Note:** Place the tab over the end of the pivot bolt.
6. Secure the pivot bolt and tabbed pin using the nut you removed previously (Figure 4).
 7. Remove the pin from the other side of the roll bar and repeat this procedure to secure the other side of the carrier frame to the machine.

Figure 6 illustrates the correctly installed carrier frame.

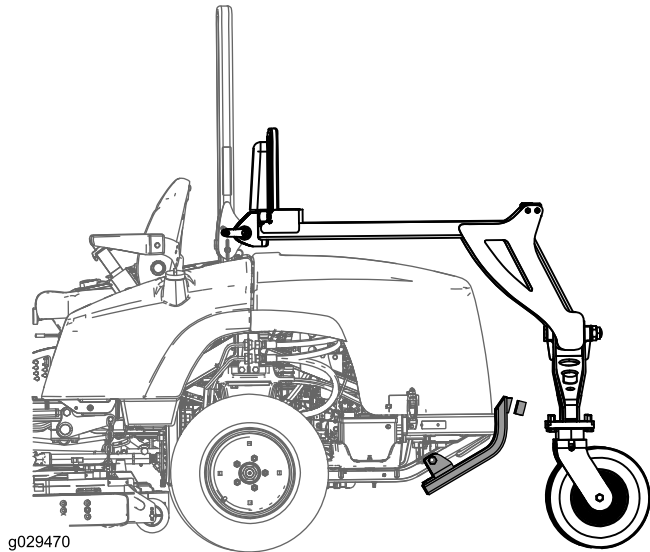

Figure 6

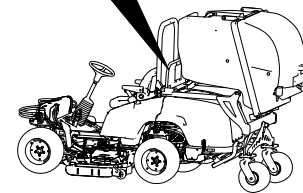
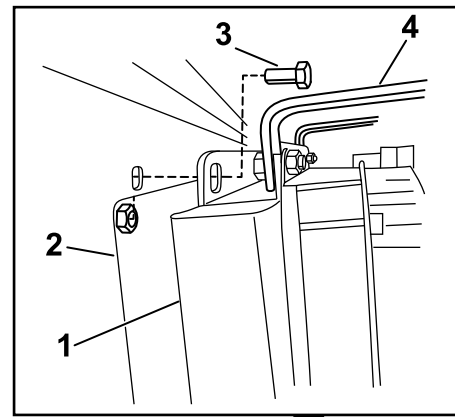

Figure 7

- | | |
|---------------------------------------|--|
| 1. Opening in the carrier-frame plate | 3. Bolt (4 required) |
| 2. Cooler | 4. Shipping brackets (2), remove and discard |

3. Remove the fasteners securing the shipping brackets to the top of the cooler and discard them (Figure 7).
4. Slide the high-lift-collection assembly forward so that the tabs on the front of the cooler are flush with the plate on the carrier frame (Figure 7) and the tabs in the steel frame of the high-lift-collection assembly sit inside the holes on the carrier frame as shown in Figure 8.

Installing the High-Lift-Collection Kit

Installing the High-Lift-Collection Assembly

1. Secure and lift the high-lift-collection assembly using a hoist. Ensure that the straps you use to hoist it only contact the steel frame under the hopper.

Important: Do not lift the grass collector by the plastic hopper or you will damage it.

2. Slowly lower the high-lift-collection assembly onto the frame and slide it forward until the cooler assembly on the front of the hopper is about 2.5 cm (1 inch) from the plate on the carrier frame (Figure 7).

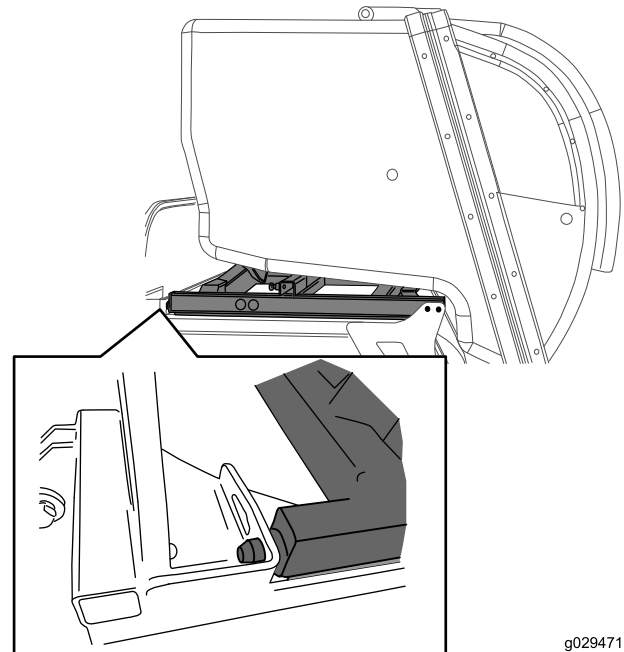

Figure 8

- Secure the tabs on the cooler assembly to the carrier-frame plate using 4 bolts and nuts, 2 above and 2 below the assembly (Figure 7).
- Secure the high-lift-collection assembly to the rear of the carrier frame using 4 bolts, 2 on each side of the assembly (Figure 9).

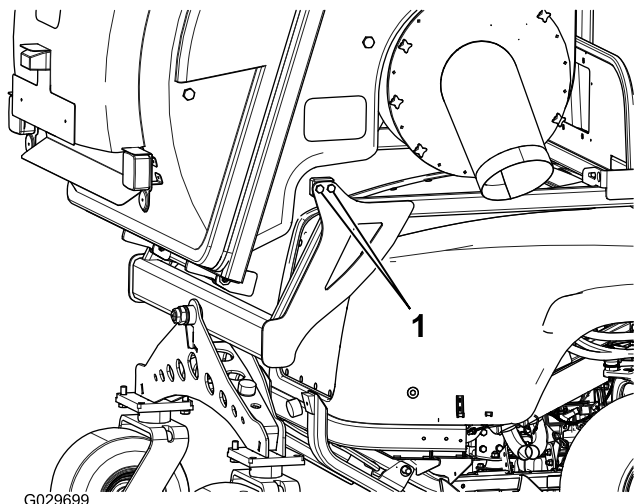

Figure 9

- Bolts

Connecting the Hydraulic Hoses and Wire Harness

- Route the hydraulic hose and wire harness bundle down to the fittings you installed previously with Kit Model 30801 or 30898 (Figure 10).

Note: For machines with a Yanmar engine, route the bundle under the carrier frame and between the guide plate and bumper.

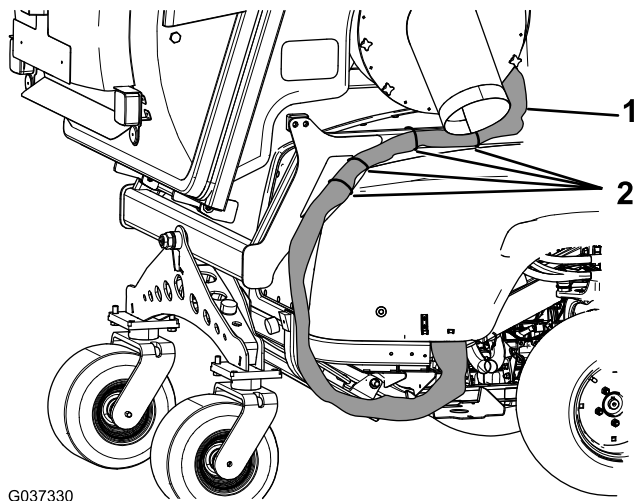

Figure 10

Machines with a Kubota engine

- Hose and wire harness bundle
- Cable ties

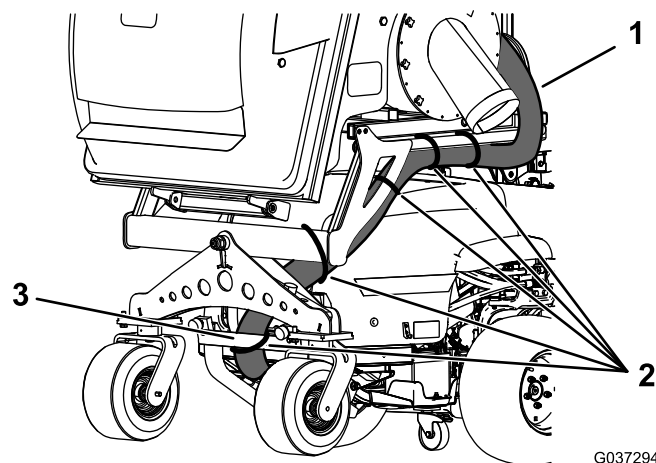

Figure 11

Machines with a Yanmar engine

- Hose and wire harness bundle
- Cable ties
- Guide plate

- Connect the hoses and wire harness to the appropriate fittings and connector, ensuring that the hoses are not hanging on top of the cable or pulling on it.
- Secure the bundle to the carrier frame with 4 cable ties in the locations shown in Figure 10.
- Move the collection system up and down through its range of motion to ensure that the bundle does not tighten or pull on anything.

Installing the Grass Chute

Note: The grass chute is shipped inside the hopper.

- Install the turbine fan cover over the fan using knobs and bolts (Figure 12).

Note: Ensure that you orient the port on the cover at the 5 o'clock position.

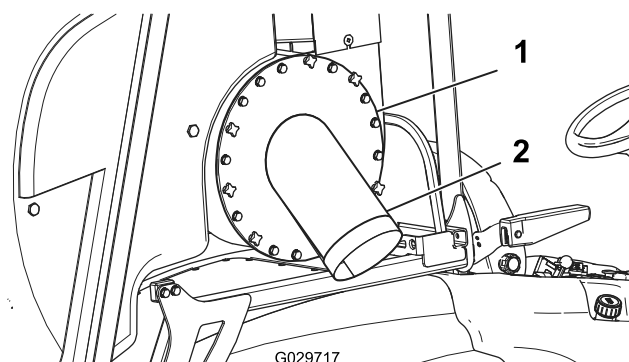

Figure 12

- Turbine fan cover
- Port

- Remove the rubber discharge chute, fasteners, and spring from the mower; retain them for future use.

3. Install the deck adapter over the opening in the mower, securing it with the pin assembly and nut as shown in [Figure 13](#).

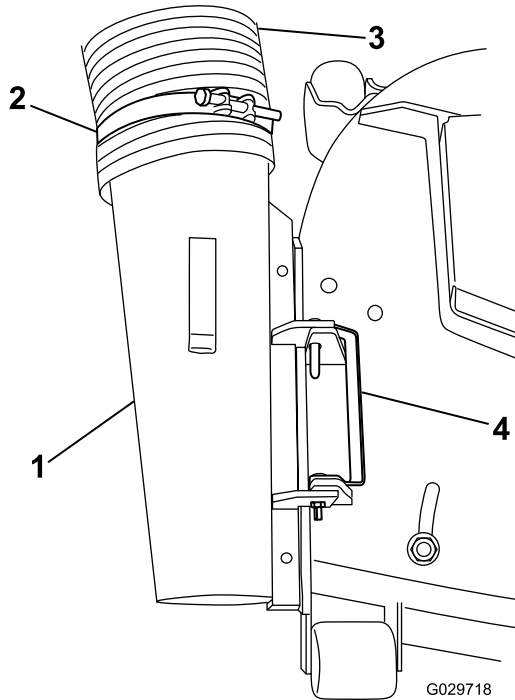

Figure 13

- | | |
|-----------------|---------------------|
| 1. Deck adapter | 3. Grass-chute hose |
| 2. Hose clamp | 4. Pin assembly |

4. Slide a large hose clamp over each end of the grass-chute hose ([Figure 13](#)).
5. Slide 1 end of the hose over the port on the end of the deck adapter and tighten the hose clamp to secure it ([Figure 13](#)).
6. Slide the other end over the port on the turbine fan cover ([Figure 12](#)) and tighten the hose clamp to secure it.

Operation

Using the Parking Stand

1. Park the machine on level, firm ground.

Note: If you need to park on soft ground, place a block of wood under the parking stand.

2. Slide the bar on the parking stand into the hole on the frame and secure it with a bolt ([Figure 14](#)).

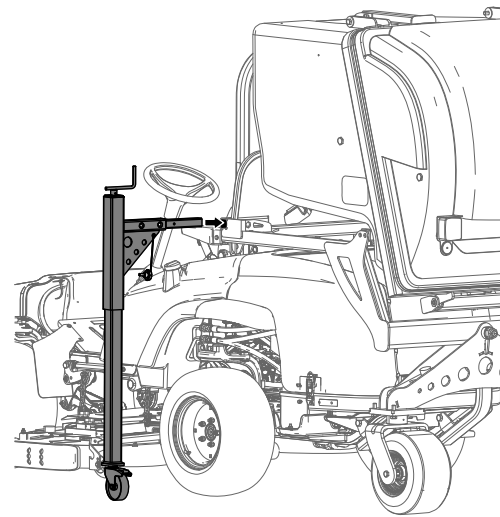

Figure 14

3. Remove the nut and pin assembly securing the deck adapter to the mower and remove the adapter ([Figure 13](#)); install the original, rubber discharge chute.

⚠ WARNING

The cutting unit can throw rocks, sticks, and other debris severely injuring bystanders.

Never run the cutting unit without the discharge chute or grass collector.

4. Lift the hopper to remove the weight from the tabbed pins in the roll bar.
5. Remove the nut and tabbed pins from each side of the roll bar ([Figure 4](#)).
6. Install the nuts onto the bolts securing the roll bar.

Operating the High-Lift Collection

1. With the door closed and hopper lowered, decrease the engine speed.

Note: Ensure that the cutting unit is off.

2. Engage the PTO switch to start the fan.

Note: If the fan does not engage, make sure that the hopper is all the way down.

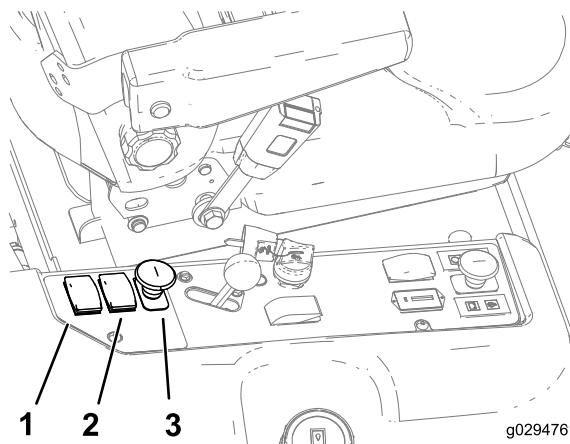

Figure 15

1. Door switch
2. Lift switch
3. PTO switch

3. Slowly increase engine speed and start the cutting unit.
4. After you have finished collecting grass, stop the cutting unit then turn off the fan.

Important: Ensure that the cutting unit is off before turning off the fan.

Note: If you lift the hopper or open the door while the fan is operating, it automatically shuts down.

5. Back the machine up to the collection receptacle.

Important: Only empty the hopper with the machine parked on firm, level ground.

6. Push the lift switch to raise the hopper (Figure 15).
7. Push the door switch to open the door on the hopper (Figure 15).
8. Close the door and return the hopper to the operating position.

Note: Do not drive the machine with the hopper raised or the hopper door open.

Maintenance

Install the cylinder locks over the hopper cylinders when performing maintenance with the hopper raised (Figure 16).

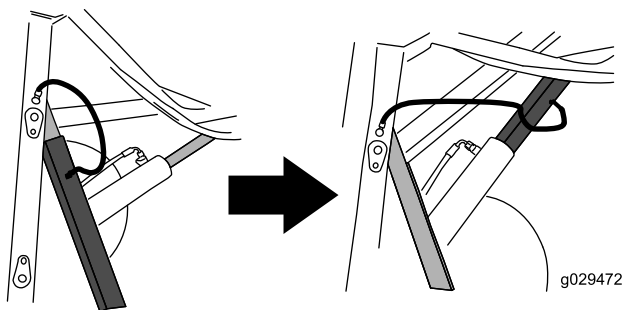

Figure 16

⚠ WARNING

The hopper may lower when in the raised position, crushing anyone under it.

Install the cylinder locks before performing maintenance that requires the hopper to be in the raised position.

Greasing the Machine

1. Lower the hopper and shut off the engine of the machine.
2. Locate and clean the grease fittings with a rag.

Note: There are arrow decals to notate the grease fittings.

3. Connect a grease gun to each fitting and pump grease into the fittings until grease begins to ooze out of the bearings.
4. Wipe up any excess grease.

Adjusting the Sequence Valve

If the hopper door does not completely open or if the hopper does not tilt to dump or tilts too slowly, adjust the sequence valve as follows:

Note: Adjusting this valve increases the dump/tilt speed.

1. Remove the cap of the valve (Figure 17).

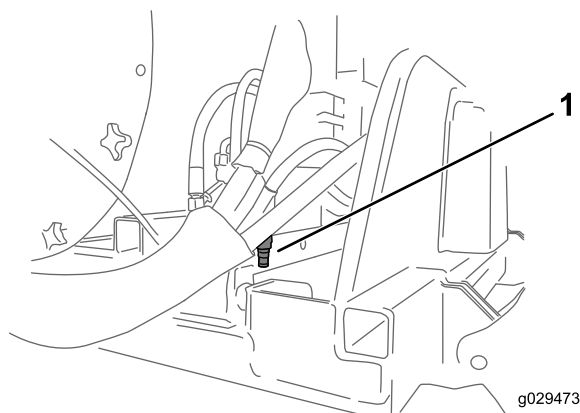

Figure 17

1. Adjustment valve
2. Loosen the locknut on the adjusting screw of the valve.
3. Adjust the pressure.
- Note:** Loosening the bolt increases the pressure.
4. Tighten the locknut
5. Secure the cap onto the hydraulic valve.

Adjusting the Closing Force

1. Lift the hopper and open the hopper door.
2. Put the lowering safeguard in place (Figure 16).
3. Remove both cylinders on the rod-side end.
4. Loosen the locknuts on the cylinder rods.
5. Adjust the length as needed.
6. Tighten the locknuts.
7. Install the cylinders.
8. Close the hopper door.

Adjusting the Seal between the Blow-In Port and the Hopper

To adjust how tightly the collection hopper rests on the fan outlet, you can change the following settings:

- The length of the top link
- The length of the hopper support (rubber bumper)
- The position of the fan outlet

Adjusting the Length of the Top Link

1. Lower the hopper half-way and secure it with suitable supports.
2. Tighten the bolt of the top link on the hopper side. Ensure that the hopper does not tip over.
3. Loosen the locknuts on the upper link and adjust the length of the top link. For example, turn it 1 turn.
4. Tighten the counter nut and remount the bolt from the top link.
5. Lift and lower the hopper again to check whether it seals when it rests on the fan outlet.

Adjusting the Length of the Hopper Support

1. Raise the hopper.
2. Install the cylinder lock to secure the hopper against unintended lowering (Figure 16).
3. Remove the locknut on the rubber bumper.

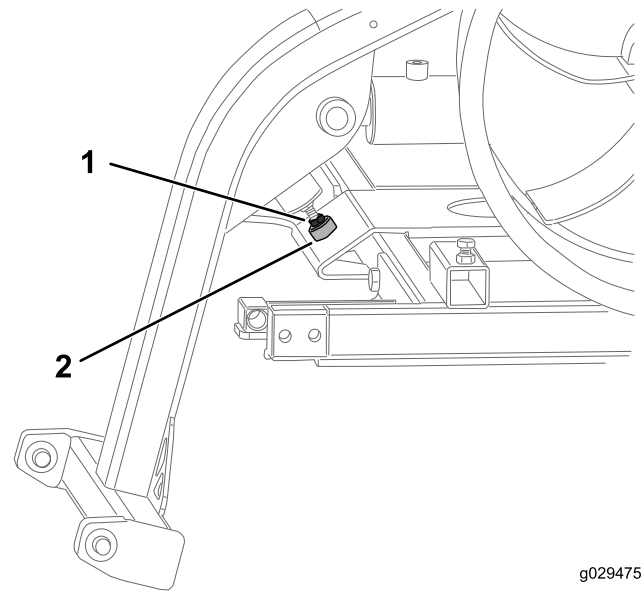

g029475

Figure 18

- | | |
|------------|------------------|
| 1. Locknut | 2. Rubber bumper |
|------------|------------------|

4. Adjust the rubber bumper so that the hopper seals tightly on the fan outlet.
5. Fasten the locknuts.
6. Remove the cylinder lock.
7. Lower the hopper.
8. Ensure that the hopper seals tightly on the fan outlet; repeat this procedure if it does not.

Adjusting the Position of the Fan Outlet

1. Raise the hopper.
2. Install the cylinder lock to secure the hopper against unintended lowering (Figure 16).
3. Remove the 4 nuts on the fan outlet.
4. Align the upper closing surface so that it is parallel to the container hopper surface. The lateral air gap between the blow-in port and support frame in the hopper should be approximately the same size left and right.
5. Install the 4 nuts.

Removing and Installing the Turbine Fan

Removing the Fan

1. Remove the turbine fan cover (Figure 12).
2. Remove the central fastening bolt of the fan (Figure 19).

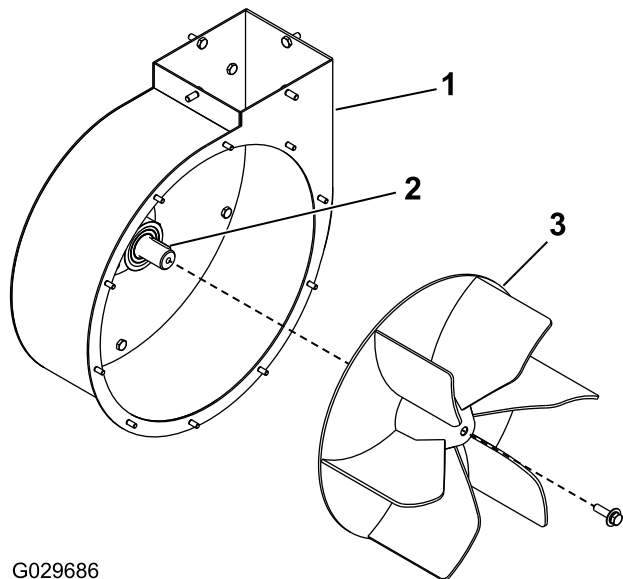

Figure 19

- | | |
|-------------------------|--------|
| 1. Turbine housing | 3. Fan |
| 2. Drive shaft with key | |

3. Use a bolt (M16 x 80; not included) to press the blade off the drive shaft.

Note: Keep the key in a safe place.

4. Bring the blade to an Authorized Service Dealer to have it balanced.

Installing the Fan

1. Insert the key into the key groove in the drive shaft (Figure 19) and use a hex bolt (M12 x 100) to press the blade into the drive shaft.
2. Remove the hex bolt and install the central fastening bolt (M12 x 45) and torque it to 125 N·m (92 ft-lb).
3. Install the turbine fan cover (Figure 12).

Troubleshooting

Problem	Possible Cause	Corrective Action
The suction port is blocked.	1. The machine is being driven too fast for the given conditions.	1. Operate the machine at a slower pace.
The suction hose or pressure channel is clogged.	1. Grass or debris has accumulated in the hose.	1. Clean out the hose.
The suction capacity is poor.	1. The exhaust grill or filter is dirty. 2. The engine speed of the machine is too low. 3. One or more belts are loose.	1. Clean the exhaust grill and filter. 2. Operate the machine at a higher engine speed. 3. Check the tension of the belt and tighten it if necessary. (Note: There is a double belt on the hopper driving the fan and a single belt under the hood of the machine driving the pump.)
There is a strong vibration when the blower is running.	1. The fan blades are out of balance.	1. Contact your Toro Distributor.
The fan turns off while operating the machine.	1. The hopper is open. 2. The hydraulics are over heated. 3. The fan belt is loose or broken. 4. The pump belt is loose or broken.	1. Ensure that the hopper is closed all the way. 2. Allow the machine to cool down and resolve the heating issue; refer to your Toro Distributor. 3. Contact your Toro Distributor. 4. Contact your Toro Distributor.
The hydraulic quick-disconnect fittings are difficult to remove or connect.	1. Some quick-disconnect fittings are difficult to remove or connect.	1. Rotate the sleeve of the fitting until the key lines up with the marking to allow the fitting to release.

Notes:

Notes:

Declaration of Incorporation

The Toro Company, 8111 Lyndale Avenue South, Bloomington, MN, USA declares that the following unit(s) conform(s) to the directives listed, when installed in accordance with the accompanying instructions onto certain Toro models as indicated on the relevant Declarations of Conformity.

Model No.	Serial No.	Product Description	Invoice Description	General Description	Directive
30866	315000001 and Up	High-lift Collection Kit	HIGH-LIFT COLLECTION - GM360	Grass Collector Attachment	2006/42/EC, EN 349, EN ISO 12100, ISO 5395
30818	and Up	Parking Stand Kit	PARKING STAND KIT-GM360 HIGH-LIFT COLL	Parking Stand Attachment	2006/42/EC, , ISO 16154, FZO
30869	315000001 and Up	Carrier Frame Kit	CARRIER FRAME ASM - GM360	Carrier Frame Attachment	2006/42/EC, ISO 4254

Relevant technical documentation has been compiled as required per Part B of Annex VII of 2006/42/EC.

We will undertake to transmit, in response to requests by national authorities, relevant information on this partly completed machinery. The method of transmission shall be electronic transmittal.

This machinery shall not be put into service until incorporated into approved Toro models as indicated on the associated Declaration of Conformity and in accordance with all instructions, whereby it can be declared in conformity with all relevant Directives.

Certified:



David Klis
Sr. Engineering Manager
8111 Lyndale Ave. South
Bloomington, MN 55420, USA
April 1, 2015

EU Technical Contact:

Marc Vermeiren
Toro Europe NV
B-2260 Oevel-Westerloo
Belgium

Tel. 0032 14 562960
Fax 0032 14 581911

International Distributor List

Distributor:	Country:	Phone Number:	Distributor:	Country:	Phone Number:
Agrolanc Kft	Hungary	36 27 539 640	Maquiver S.A.	Colombia	57 1 236 4079
Balama Prima Engineering Equip.	Hong Kong	852 2155 2163	Maruyama Mfg. Co. Inc.	Japan	81 3 3252 2285
B-Ray Corporation	Korea	82 32 551 2076	Mountfield a.s.	Czech Republic	420 255 704 220
Casco Sales Company	Puerto Rico	787 788 8383	Mountfield a.s.	Slovakia	420 255 704 220
Ceres S.A.	Costa Rica	506 239 1138	Munditol S.A.	Argentina	54 11 4 821 9999
CSSC Turf Equipment (pvt) Ltd.	Sri Lanka	94 11 2746100	Norma Garden	Russia	7 495 411 61 20
Cyril Johnston & Co.	Northern Ireland	44 2890 813 121	Oslinger Turf Equipment SA	Ecuador	593 4 239 6970
Cyril Johnston & Co.	Republic of Ireland	44 2890 813 121	Oy Hako Ground and Garden Ab	Finland	358 987 00733
Equiver	Mexico	52 55 539 95444	Parkland Products Ltd.	New Zealand	64 3 34 93760
Femco S.A.	Guatemala	502 442 3277	Perfetto	Poland	48 61 8 208 416
ForGarder OU	Estonia	372 384 6060	Pratoverde SRL.	Italy	39 049 9128 128
G.Y.K. Company Ltd.	Japan	81 726 325 861	Prochaska & Cie	Austria	43 1 278 5100
Geomechaniki of Athens	Greece	30 10 935 0054	RT Cohen 2004 Ltd.	Israel	972 986 17979
Golf international Turizm	Turkey	90 216 336 5993	Riversa	Spain	34 9 52 83 7500
Guandong Golden Star	China	86 20 876 51338	Lely Turfcare	Denmark	45 66 109 200
Hako Ground and Garden	Sweden	46 35 10 0000	Solvart S.A.S.	France	33 1 30 81 77 00
Hako Ground and Garden	Norway	47 22 90 7760	Spypros Stavrinides Limited	Cyprus	357 22 434131
Hayter Limited (U.K.)	United Kingdom	44 1279 723 444	Surge Systems India Limited	India	91 1 292299901
Hydroturf Int. Co Dubai	United Arab Emirates	97 14 347 9479	T-Markt Logistics Ltd.	Hungary	36 26 525 500
Hydroturf Egypt LLC	Egypt	202 519 4308	Toro Australia	Australia	61 3 9580 7355
Irrimac	Portugal	351 21 238 8260	Toro Europe NV	Belgium	32 14 562 960
Irrigation Products Int'l Pvt Ltd.	India	0091 44 2449 4387	Valtech	Morocco	212 5 3766 3636
Jean Heybroek b.v.	Netherlands	31 30 639 4611	Victus Emak	Poland	48 61 823 8369

European Privacy Notice

The Information Toro Collects

Toro Warranty Company (Toro) respects your privacy. In order to process your warranty claim and contact you in the event of a product recall, we ask you to share certain personal information with us, either directly or through your local Toro company or dealer.

The Toro warranty system is hosted on servers located within the United States where privacy law may not provide the same protection as applies in your country.

BY SHARING YOUR PERSONAL INFORMATION WITH US, YOU ARE CONSENTING TO THE PROCESSING OF YOUR PERSONAL INFORMATION AS DESCRIBED IN THIS PRIVACY NOTICE.

The Way Toro Uses Information

Toro may use your personal information to process warranty claims, to contact you in the event of a product recall and for any other purpose which we tell you about. Toro may share your information with Toro's affiliates, dealers or other business partners in connection with any of these activities. We will not sell your personal information to any other company. We reserve the right to disclose personal information in order to comply with applicable laws and with requests by the appropriate authorities, to operate our systems properly or for our own protection or that of other users.

Retention of your Personal Information

We will keep your personal information as long as we need it for the purposes for which it was originally collected or for other legitimate purposes (such as regulatory compliance), or as required by applicable law.

Toro's Commitment to Security of Your Personal Information

We take reasonable precautions in order to protect the security of your personal information. We also take steps to maintain the accuracy and current status of personal information.

Access and Correction of your Personal Information

If you would like to review or correct your personal information, please contact us by email at legal@toro.com.

Australian Consumer Law

Australian customers will find details relating to the Australian Consumer Law either inside the box or at your local Toro Dealer.



Toro General Commercial Product Warranty

A Two-Year Limited Warranty

Conditions and Products Covered

The Toro Company and its affiliate, Toro Warranty Company, pursuant to an agreement between them, jointly warrant your Toro Commercial product ("Product") to be free from defects in materials or workmanship for two years or 1500 operational hours*, whichever occurs first. This warranty is applicable to all products with the exception of Aerators (refer to separate warranty statements for these products). Where a warrantable condition exists, we will repair the Product at no cost to you including diagnostics, labor, parts, and transportation. This warranty begins on the date the Product is delivered to the original retail purchaser.

* Product equipped with an hour meter.

Instructions for Obtaining Warranty Service

You are responsible for notifying the Commercial Products Distributor or Authorized Commercial Products Dealer from whom you purchased the Product as soon as you believe a warrantable condition exists. If you need help locating a Commercial Products Distributor or Authorized Dealer, or if you have questions regarding your warranty rights or responsibilities, you may contact us at:

Toro Commercial Products Service Department
Toro Warranty Company
8111 Lyndale Avenue South
Bloomington, MN 55420-1196

952-888-8801 or 800-952-2740
E-mail: commercial.warranty@toro.com

Owner Responsibilities

As the Product owner, you are responsible for required maintenance and adjustments stated in your *Operator's Manual*. Failure to perform required maintenance and adjustments can be grounds for disallowing a warranty claim.

Items and Conditions Not Covered

Not all product failures or malfunctions that occur during the warranty period are defects in materials or workmanship. This warranty does not cover the following:

- Product failures which result from the use of non-Toro replacement parts, or from installation and use of add-on, or modified non-Toro branded accessories and products. A separate warranty may be provided by the manufacturer of these items.
- Product failures which result from failure to perform recommended maintenance and/or adjustments. Failure to properly maintain your Toro product per the Recommended Maintenance listed in the *Operator's Manual* can result in claims for warranty being denied.
- Product failures which result from operating the Product in an abusive, negligent, or reckless manner.
- Parts subject to consumption through use unless found to be defective. Examples of parts which are consumed, or used up, during normal Product operation include, but are not limited to, brake pads and linings, clutch linings, blades, reels, rollers and bearings (sealed or greasable), bed knives, spark plugs, castor wheels and bearings, tires, filters, belts, and certain sprayer components such as diaphragms, nozzles, and check valves, etc.
- Failures caused by outside influence. Conditions considered to be outside influence include, but are not limited to, weather, storage practices, contamination, use of unapproved fuels, coolants, lubricants, additives, fertilizers, water, or chemicals, etc.
- Failure or performance issues due to the use of fuels (e.g. gasoline, diesel, or biodiesel) that do not conform to their respective industry standards.

- Normal noise, vibration, wear and tear, and deterioration.
- Normal "wear and tear" includes, but is not limited to, damage to seats due to wear or abrasion, worn painted surfaces, scratched decals or windows, etc.

Parts

Parts scheduled for replacement as required maintenance are warranted for the period of time up to the scheduled replacement time for that part. Parts replaced under this warranty are covered for the duration of the original product warranty and become the property of Toro. Toro will make the final decision whether to repair any existing part or assembly or replace it. Toro may use remanufactured parts for warranty repairs.

Deep Cycle and Lithium-Ion Battery Warranty:

Deep cycle and Lithium-Ion batteries have a specified total number of kilowatt-hours they can deliver during their lifetime. Operating, recharging, and maintenance techniques can extend or reduce total battery life. As the batteries in this product are consumed, the amount of useful work between charging intervals will slowly decrease until the battery is completely worn out. Replacement of worn out batteries, due to normal consumption, is the responsibility of the product owner. Battery replacement may be required during the normal product warranty period at owner's expense. Note: (Lithium-Ion battery only): A Lithium-Ion battery has a part only prorated warranty beginning year 3 through year 5 based on the time in service and kilowatt hours used. Refer to the *Operator's Manual* for additional information.

Maintenance is at Owner's Expense

Engine tune-up, lubrication, cleaning and polishing, replacement of filters, coolant, and completing recommended maintenance are some of the normal services Toro products require that are at the owner's expense.

General Conditions

Repair by an Authorized Toro Distributor or Dealer is your sole remedy under this warranty.

Neither The Toro Company nor Toro Warranty Company is liable for indirect, incidental or consequential damages in connection with the use of the Toro Products covered by this warranty, including any cost or expense of providing substitute equipment or service during reasonable periods of malfunction or non-use pending completion of repairs under this warranty. Except for the Emissions warranty referenced below, if applicable, there is no other express warranty. All implied warranties of merchantability and fitness for use are limited to the duration of this express warranty.

Some states do not allow exclusions of incidental or consequential damages, or limitations on how long an implied warranty lasts, so the above exclusions and limitations may not apply to you. This warranty gives you specific legal rights, and you may also have other rights which vary from state to state.

Note regarding engine warranty:

The Emissions Control System on your Product may be covered by a separate warranty meeting requirements established by the U.S. Environmental Protection Agency (EPA) and/or the California Air Resources Board (CARB). The hour limitations set forth above do not apply to the Emissions Control System Warranty. Refer to the Engine Emission Control Warranty Statement supplied with your product or contained in the engine manufacturer's documentation for details.

Countries Other than the United States or Canada

Customers who have purchased Toro products exported from the United States or Canada should contact their Toro Distributor (Dealer) to obtain guarantee policies for your country, province, or state. If for any reason you are dissatisfied with your Distributor's service or have difficulty obtaining guarantee information, contact the Toro importer.