



# Door Kit

Workman® GTX Utility Vehicle with Cab

Model No. 07150

Form No. 3403-942 Rev B

## Installation Instructions

### ⚠ WARNING

#### CALIFORNIA Proposition 65 Warning

This product contains a chemical or chemicals known to the State of California to cause cancer, birth defects, or reproductive harm.

### Parts

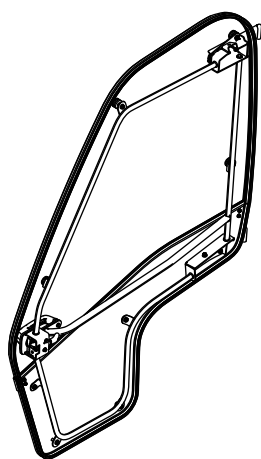

1x

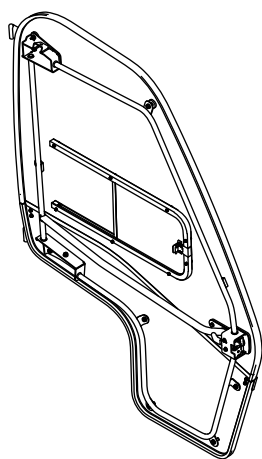

1x

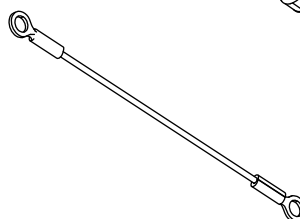

2x

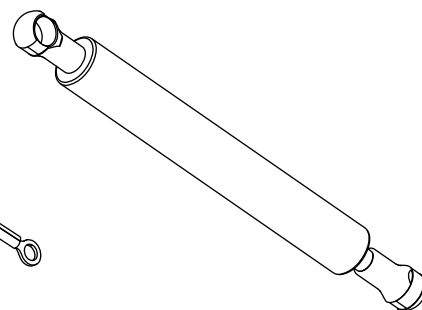

2x

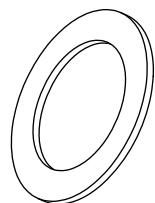

8x

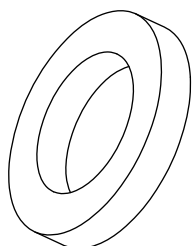

4x

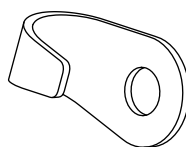

2x

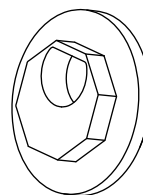

2x

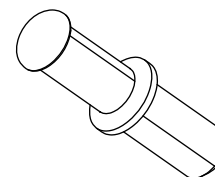

2x

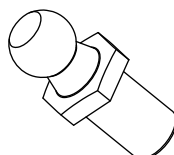

2x



6x

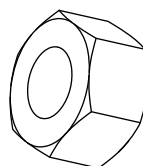

2x

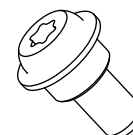

4x



# Preparing the Machine

1. Park the machine on a level surface.
2. Engage the parking brake.
3. Shut off the engine.
4. Remove the key from the ignition.

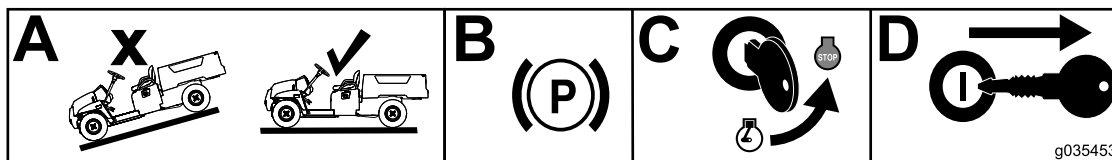

Figure 1

# Installing the Door Kit

1. Secure the door straps and springs to the doors as shown in [Figure 2](#).

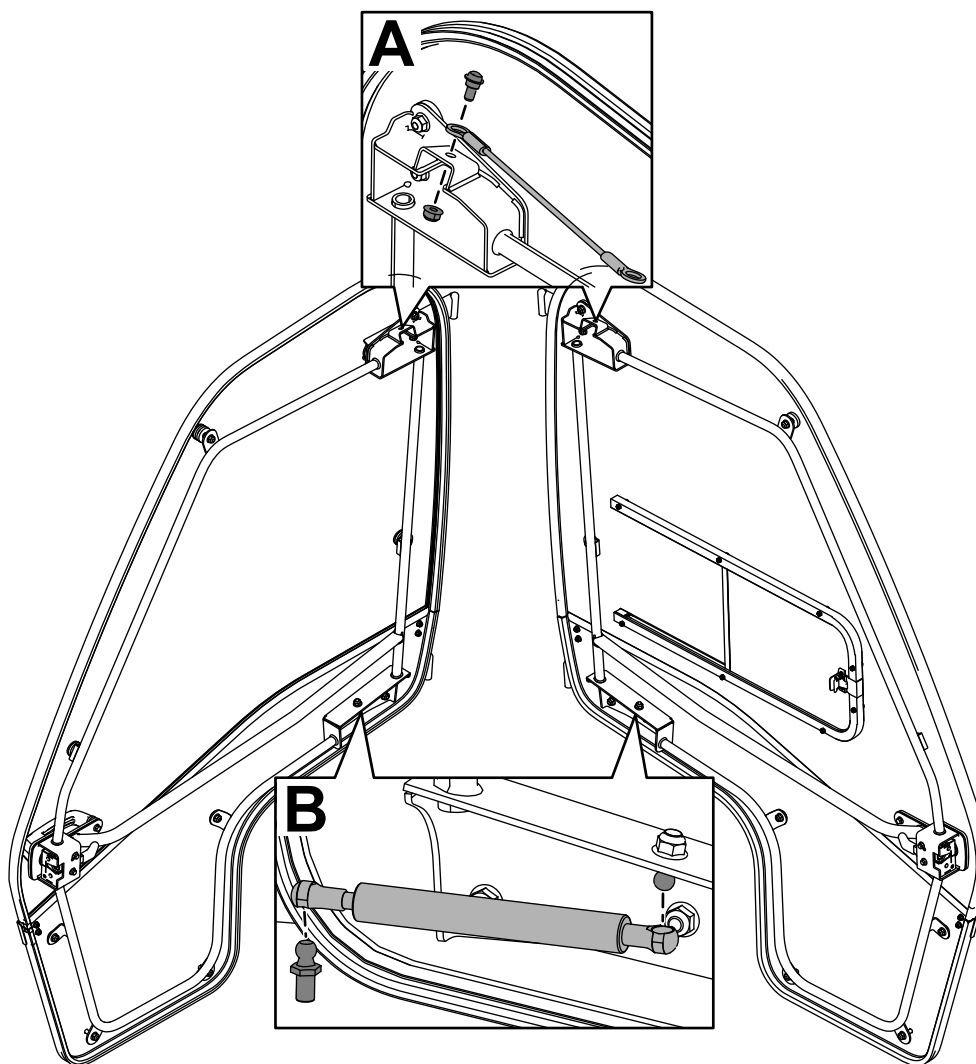
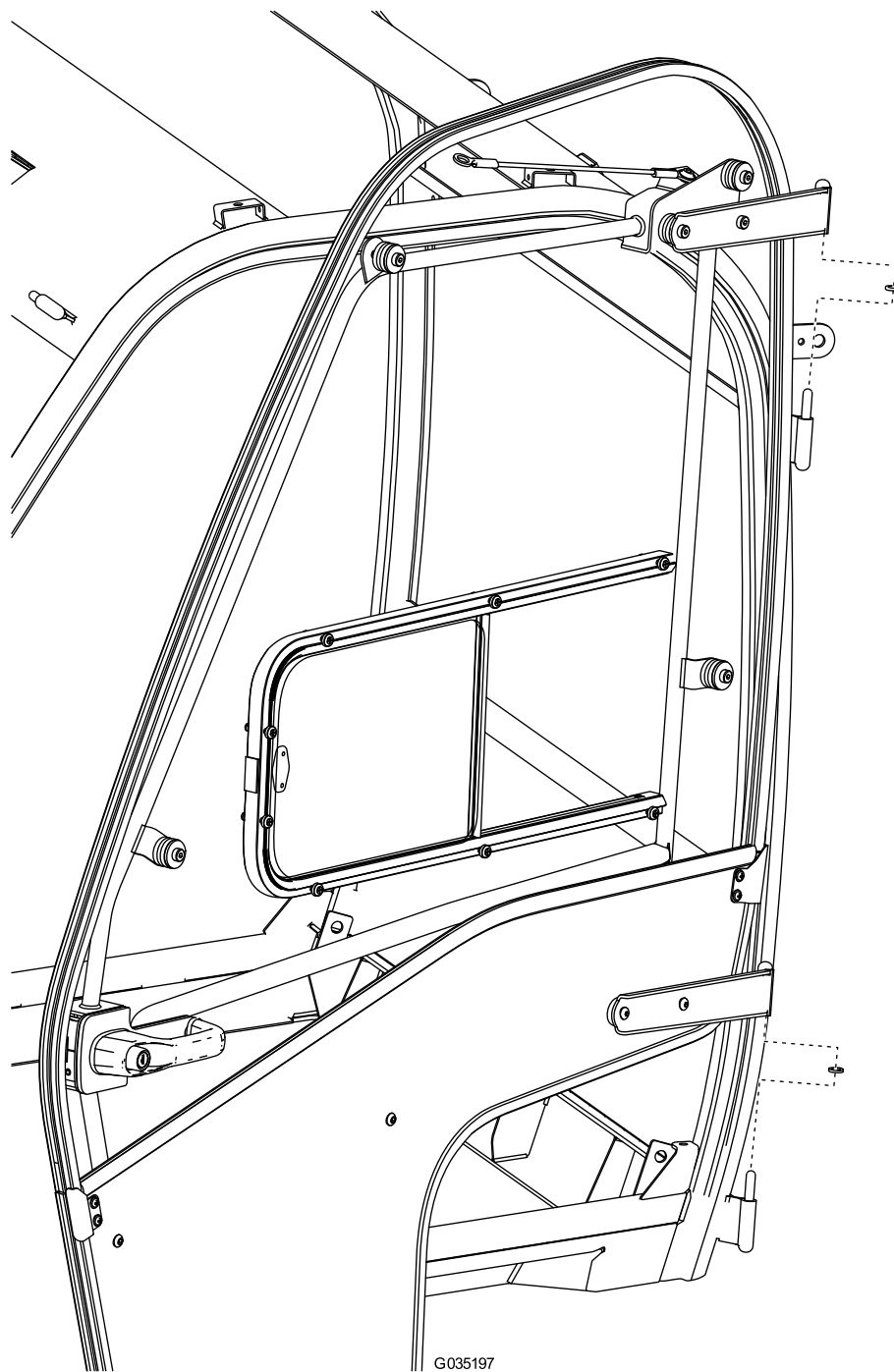

Figure 2

2. Place a brass washer on each of the 4 hinge posts and then carefully drop the doors into place as shown in [Figure 3](#).



**Figure 3**

3. Secure the door straps and springs to the frame as shown in [Figure 4](#).

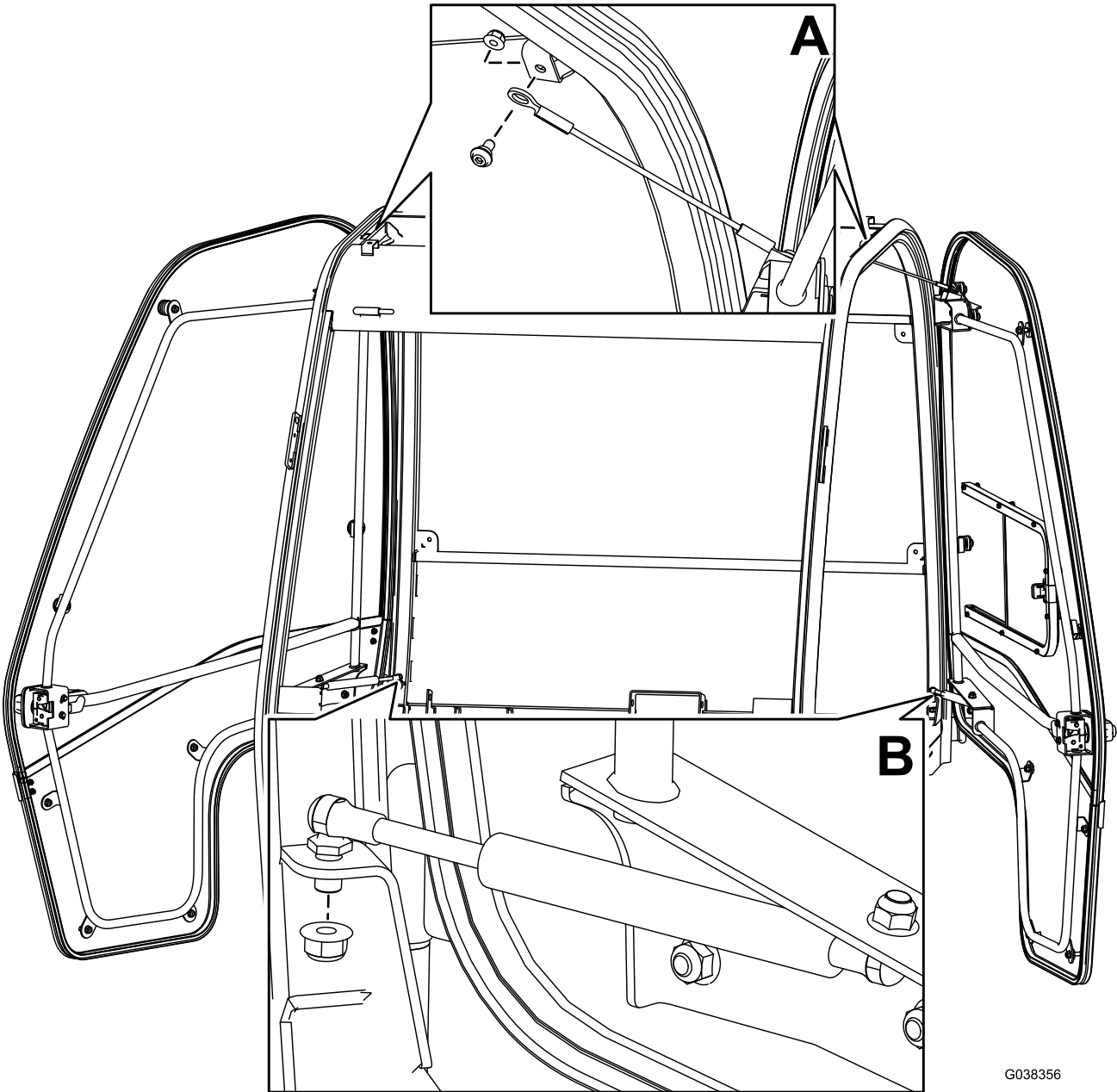

Figure 4

- Note:** If the doors do not latch properly, adjust the assembly or install the extra shims until they do.



**Notes:**

**Notes:**



**Count on it.**