



Kit porta

Veicolo polifunzionale Workman® GTX con cabina

N° del modello 07150

Istruzioni di installazione

⚠ AVVERTENZA

CALIFORNIA

Avvertenza norma "Proposition 65"

Il presente prodotto contiene una o più sostanze chimiche che nello Stato della California sono considerate cancerogene e causa di anomalie congenite o di altre problematiche della riproduzione.

Parti

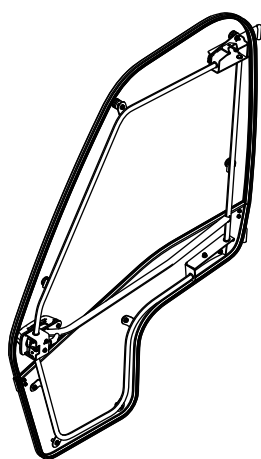

1x

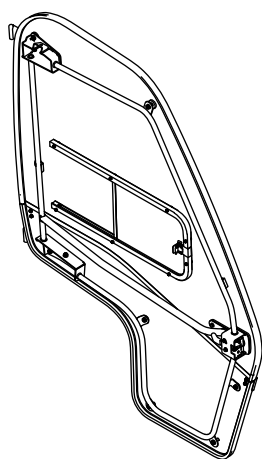

1x

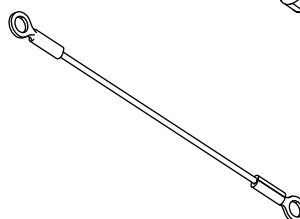

2x

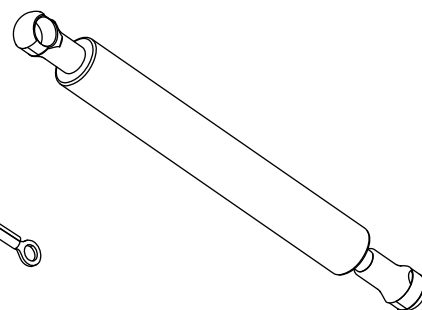

2x

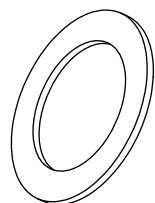

8x

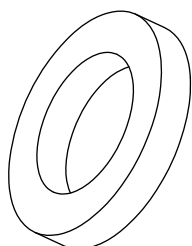

4x

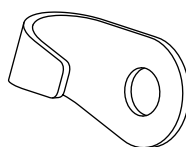

2x

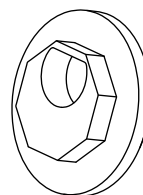

2x

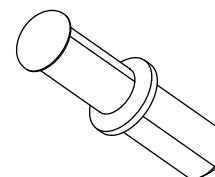

2x

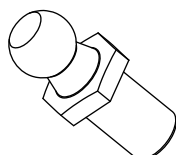

2x

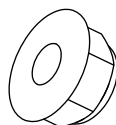

6x

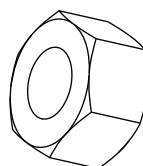

2x

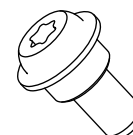

4x



Preparazione della macchina.

1. Parcheggiate la macchina su terreno pianeggiante.
2. Inserite il freno di stazionamento.
3. Spegnete il motore.
4. Togliete la chiave di accensione.



Figura 1

g035453

Montaggio del kit porta

1. Fissate le cinghie e le molle alle porte come illustrato in [Figura 2](#).

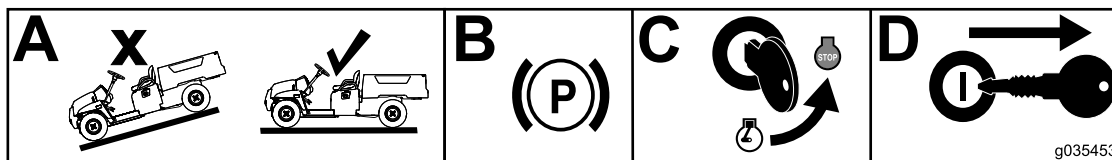

Figura 2

g038355

2. Posizionate una rondella di ottone su ciascuno dei 4 montanti delle cerniere e poi fate calare con cautela le porte in posizione, come illustrato nella [Figura 3](#).

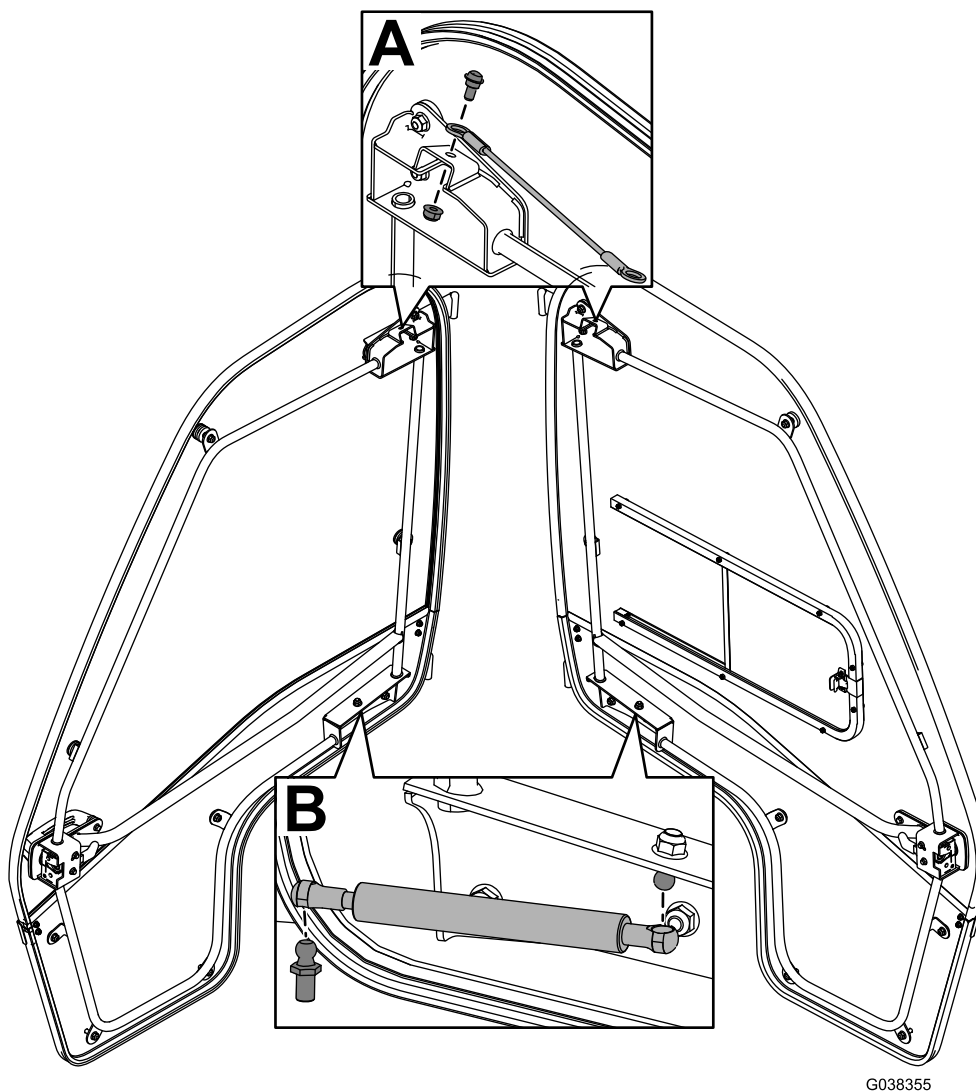
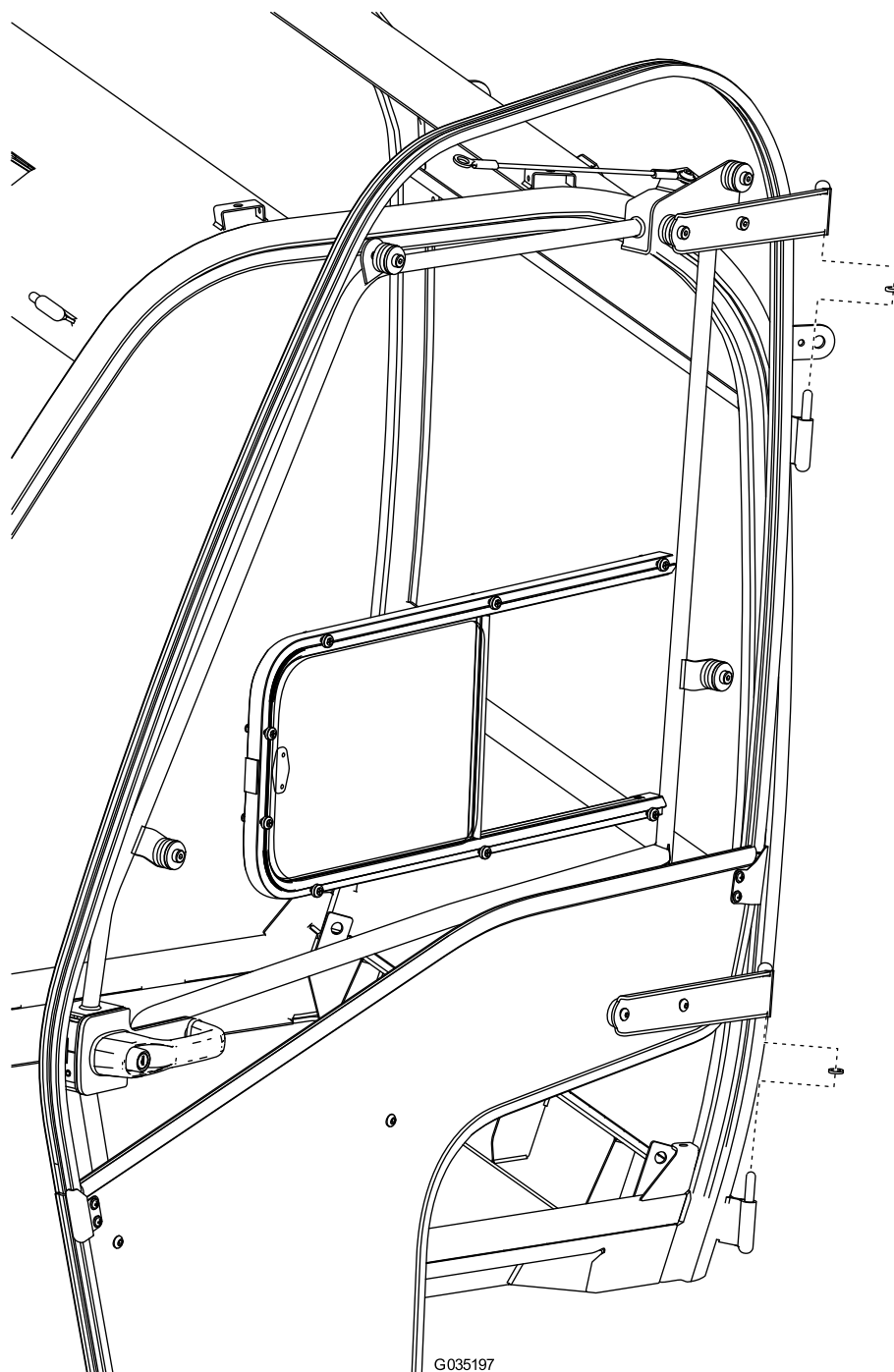

G035197

Figura 3

g035197

3. Fissate le cinghie e le molle al telaio come illustrato in [Figura 4](#).



Figura 4

4. Montate i chiavistelli come illustrato in [Figura 5](#).

Nota: Qualora i chiavistelli non si chiudessero correttamente, regolate il montaggio o aggiungete gli spessori supplementari finché necessario.

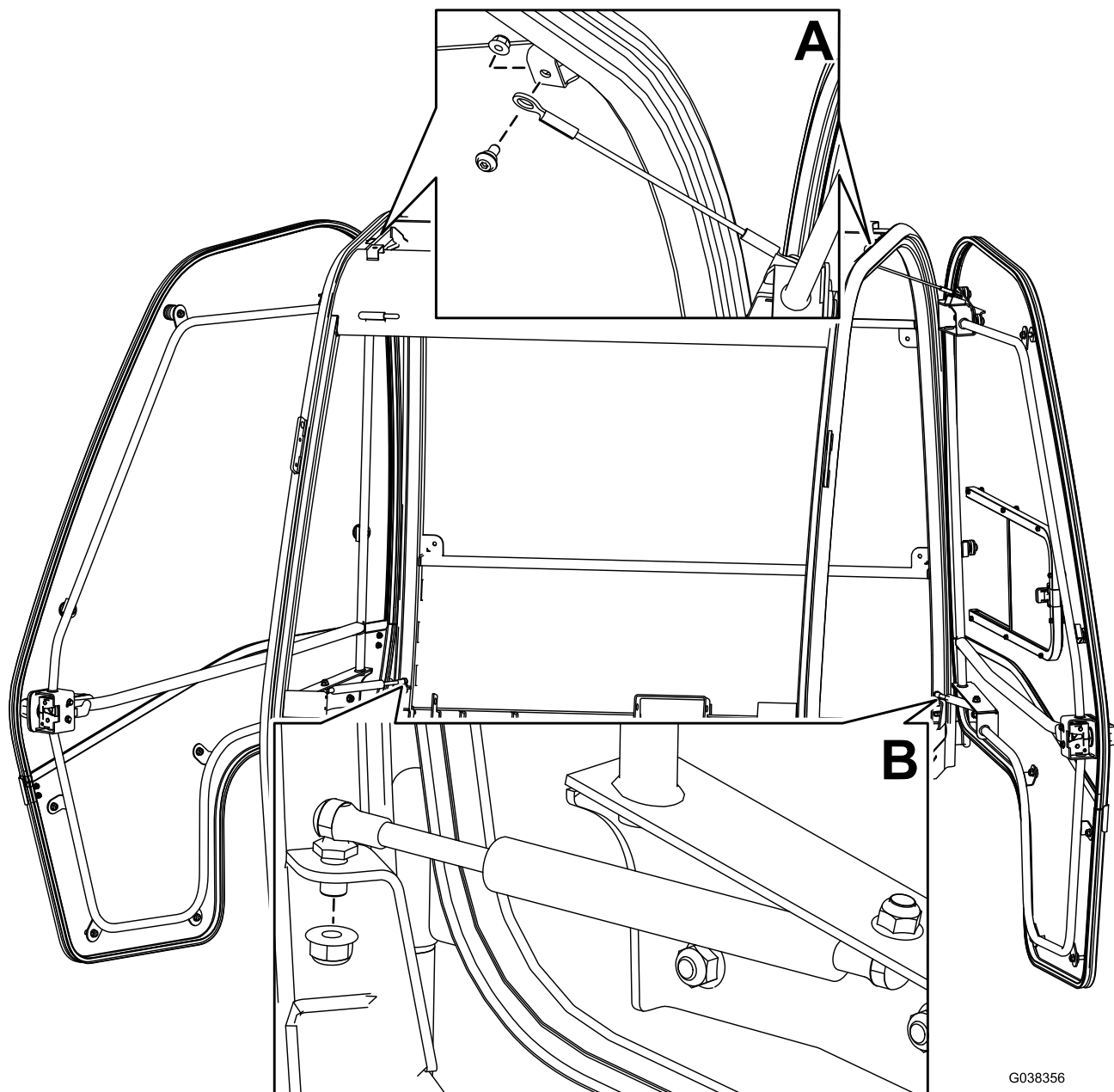
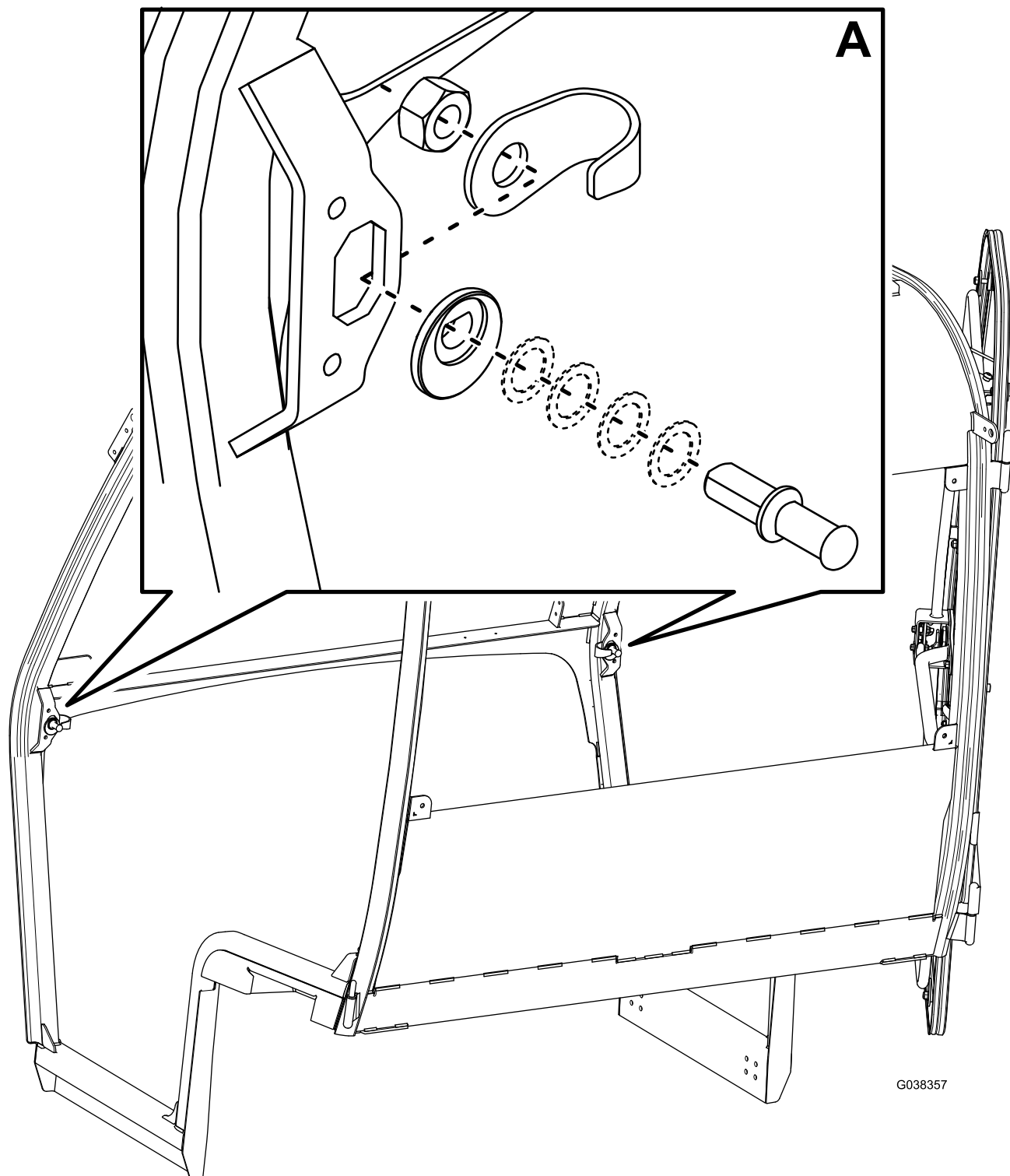

G038357

Figura 5

g038357

Note:

Note:



Count on it.