

ROPS Pin Kit

TITAN® HD Riding Mower

Model No. 136-1683

Installation Instructions

Installation

Loose Parts

Use the chart below to verify that all parts have been shipped.

Description	Qty.	Use
Pin assembly	2	Install the pin.
Flat washer	2	
Bolt	2	

⚠ WARNING

CALIFORNIA Proposition 65 Warning

This product contains a chemical or chemicals known to the State of California to cause cancer, birth defects, or reproductive harm.

Installing the Pin

1. Park the machine on a level surface, shut off the engine, set the parking brake, and remove the key from the ignition switch.
2. Drill out the 2 existing holes in the roll bar with a #19 or a 11/64 inch drill bit ([Figure 1](#)).

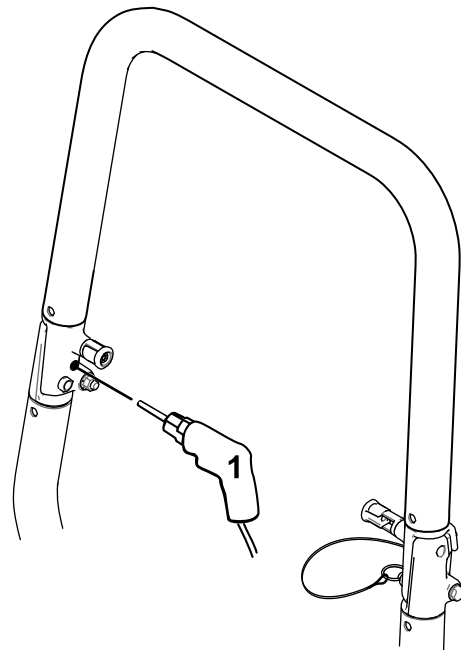

g186040

Figure 1

1. Drill out the hole with a #19 or a 11/64 inch drill bit.



3. Install the flat washer onto the bolt and through the lanyard loop [Figure 2](#).
4. Install the bolt and lanyard [Figure 2](#).

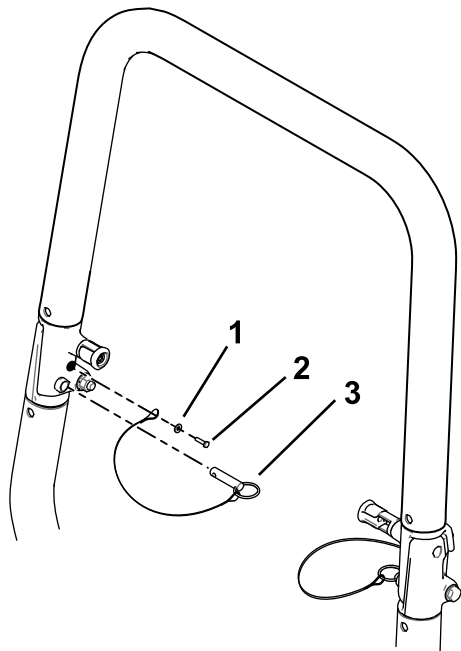

g186041

Figure 2

- | | |
|----------------|-----------------|
| 1. Flat washer | 3. Pin assembly |
| 2. Bolt | |
-