



# Steel Flat Bed Kit

## Workman® GTX Series Utility Vehicle

Model No. 07148

### Installation Instructions

#### ⚠ WARNING

##### CALIFORNIA Proposition 65 Warning

This product contains a chemical or chemicals known to the State of California to cause cancer, birth defects, or reproductive harm.

## Installation

### Loose Parts

Use the chart below to verify that all parts have been shipped.

Description	Qty.	Use
No parts required	—	Prepare the machine.
No parts required	—	Remove the plastic cargo bed.
Steel cargo bed	1	Install the steel cargo bed.
Flange-head screw (5/16 x 3/4 inch)	3	
Prop rod U bracket	1	
Prop rod	1	
Flange-head screw (1/2 x 4-1/2 inches)	2	
Locknut (1/2 inch)	2	
T handle	1	
No parts required	—	Install stake sides to the steel flat bed (optional).

## Preparing the Machine

1. Park the machine on a level surface.
2. Engage the parking brake.
3. Shut off the engine and remove the key from the key switch.

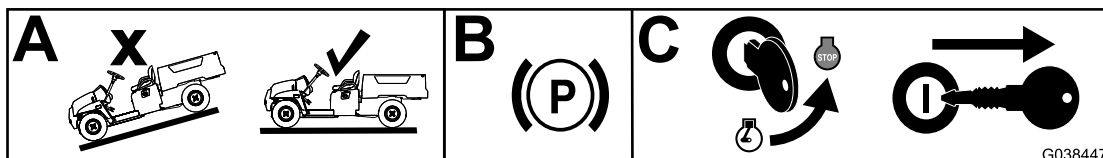

Figure 1



# Removing the Plastic Cargo Bed

1. Using an overhead hoist, raise the plastic cargo bed.
2. Remove the 3 flange-head screws (5/16 x 3/4 inch) and prop rod U bracket from the prop rod (Figure 2).

**Note:** Retain the hardware if you want to install the plastic cargo bed in the future.

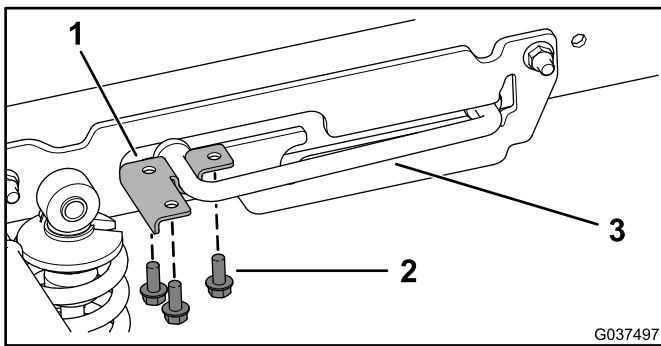
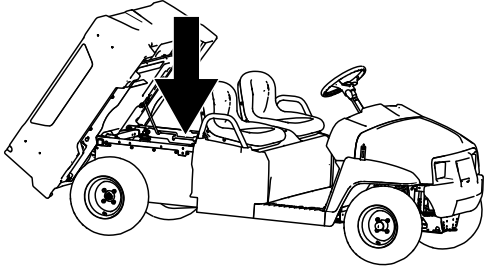

**Figure 2**

1. Prop rod U bracket
2. Flange-head screw (5/16 x 3/4 inch)
3. Prop rod

3. Slide the prop rod forward out of the detent slot and remove the prop rod (Figure 3).

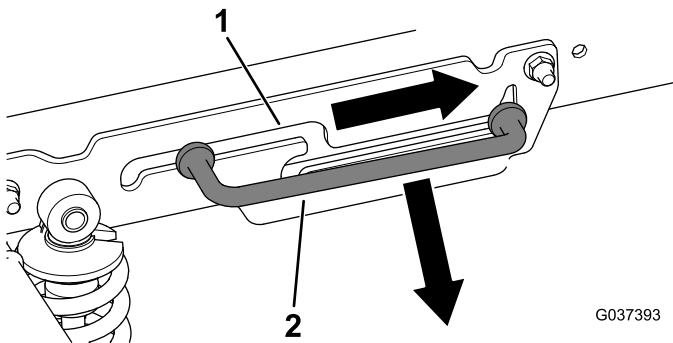
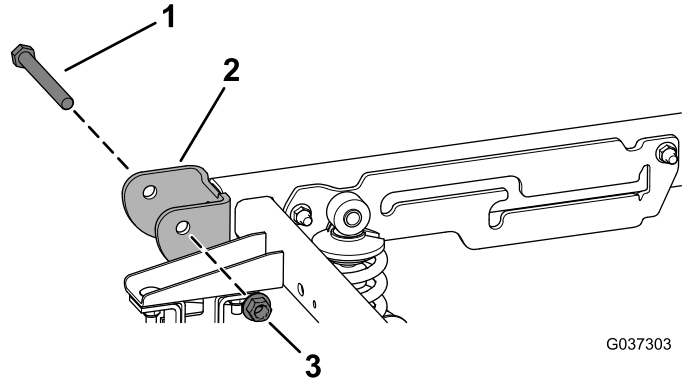

**Figure 3**

1. Detent slot
2. Prop rod

4. Using an overhead hoist, lower the cargo bed.
5. Remove the 2 pivot bolts (1/2 x 4-1/2 inches) and 2 locknuts (1/2 inch) from the pivot bracket located at the rear of the machine (Figure 4).

**Note:** Retain the hardware if you want to install the plastic cargo bed in the future.



**Figure 4**

1. Pivot bolt (1/2 x 4-1/2 inches)
2. Pivot bracket
3. Locknut (1/2 inch)

6. Release the cargo-bed lever and raise the cargo bed using an overhead hoist.

# Installing the Steel Cargo Bed

1. Remove the 3 flange-head screws (5/16 x 3/4 inch), prop rod U bracket, and prop rod from the bottom of the steel cargo bed (Figure 5).

**Important: Retain the hardware.**

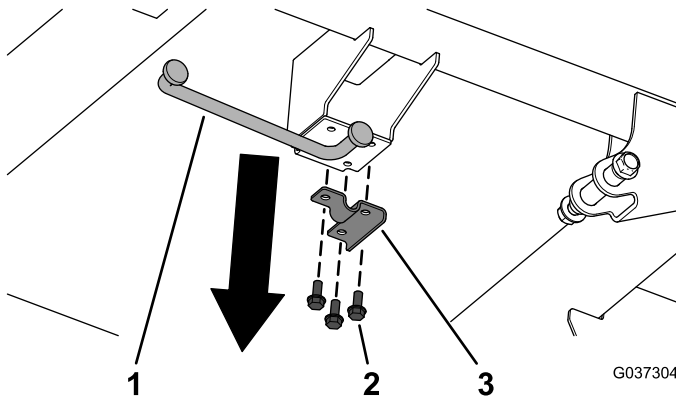

**Figure 5**

1. Prop rod
2. Flange-head screw (5/16 x 3/4 inch)
3. Prop rod U bracket

2. Using an overhead hoist, lower the steel cargo bed onto the machine.
3. Align the steel cargo bed with the holes at the rear of the machine where the 2 pivot bolts (1/2 x 4-1/2 inches) and 2 locknuts (1/2 inch) were previously removed.
4. Install the 2 flange-head screws (1/2 x 4-1/2 inches) through the pivot bracket and secure them with the 2 locknuts (1/2 inch) as shown in Figure 6.

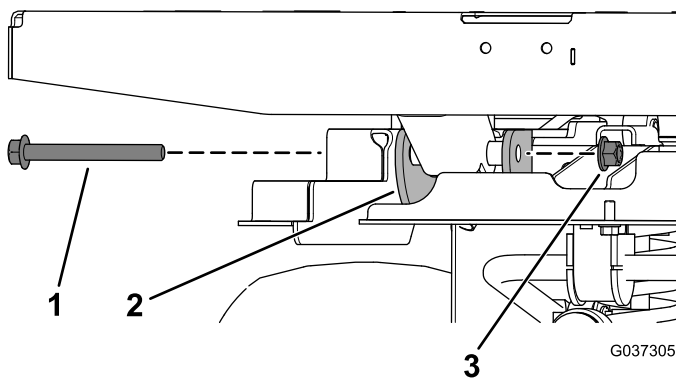

**Figure 6**

1. Flange-head screw (1/2 x 4-1/2 inches)
2. Pivot bracket
3. Locknut (1/2 inch)

5. Release the cargo-bed lever and raise the cargo bed using an overhead hoist.
6. Slide the short end of the prop rod into the detent slot (Figure 7).

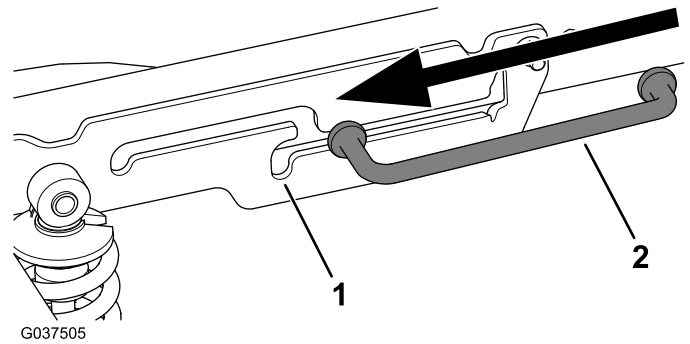

**Figure 7**

1. Detent slot
2. Prop rod

7. Install the prop rod U bracket and prop rod to the steel cargo bed using the 3 flange-head screws (5/16 x 3/4 inch) as shown in Figure 8.

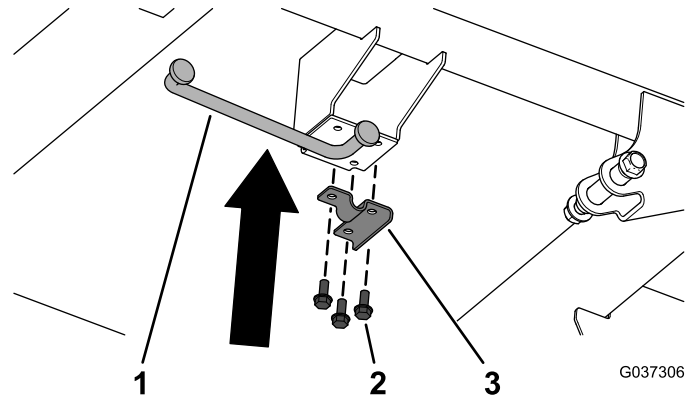

**Figure 8**

1. Prop rod
2. Flange-head screw (5/16 x 3/4 inch)
3. Prop rod U bracket

8. Install the T handle onto the button-head screw (Figure 9).

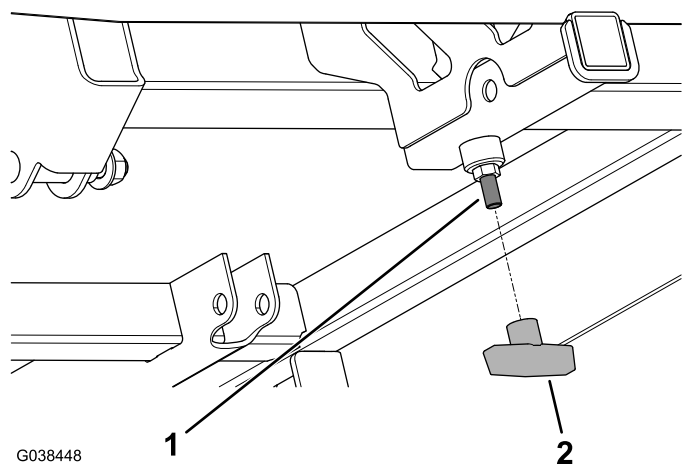

**Figure 9**

1. Button-head screw      2. T handle

9. Tighten the jam nut (3/8 inch) fully against the T handle (Figure 10).

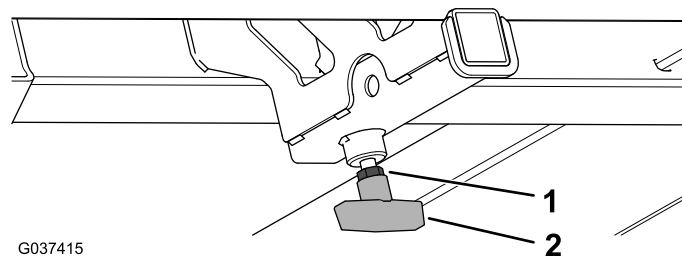

**Figure 10**

1. Jam nut (3/8 inch)      2. T handle

# Installing Stake Sides

## Optional

To install the **optional** stake sides, you need the following measurements and quantities of wood:

Wood Dimensions	Total Length of Each Board	Quantity Needed
38 x 89 mm (2 x 4 inch)	36 cm (14 inches)	8
29 x 140 mm (5/4 x 6 inch)	117 cm (46 inches)	8

You also need the following hardware:

Hardware	Use	Quantity Needed
Button-head bolt (5/16-18 x 3 inches)	Mounting the 29 x 140 mm (5/4 x 6 inch) boards to the 38 x 89 mm (2 x 4 inch) boards	32
Button-head bolt (5/16-18 x 2-1/2 inches)	Mounting the 38 x 89 mm (2 x 4 inch) boards to the bed	16
Flanged nyloc nut (5/16-18 inch)	Securing the hardware	48

Your structure should appear as follows:

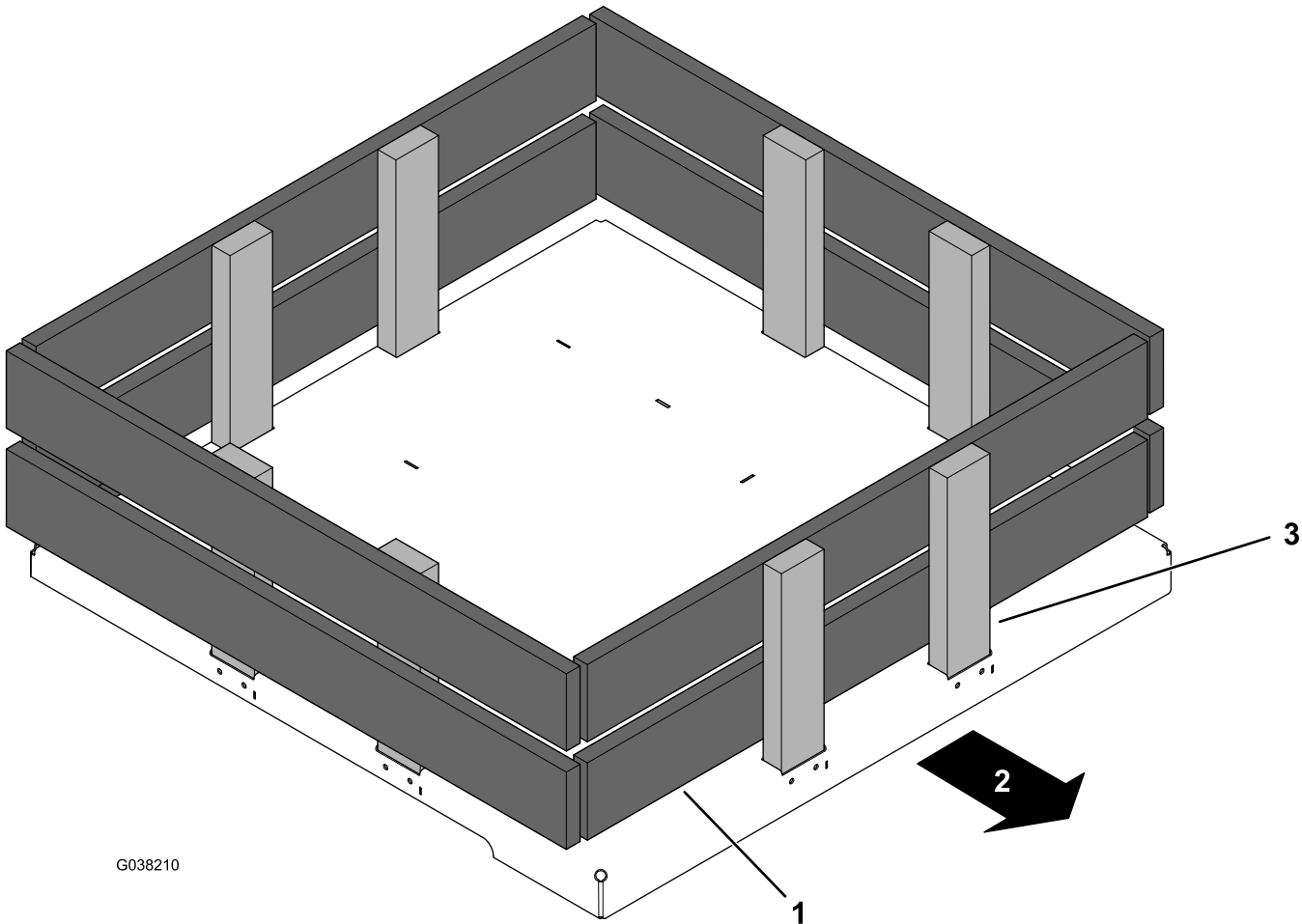

Figure 11

1. 29 x 140 mm (5/4 x 6 inch) board
2. Front of the structure—ensure that the boards are oriented as shown.
3. 38 x 89 mm (2 x 4 inch) board

**Notes:**

**Notes:**

# Declaration of Incorporation

Model No.	Serial No.	Product Description	Invoice Description	General Description	Directive
07148	None and Up	Steel Cargo Bed Kit, Workman GTX Series Utility Vehicle	STEEL CARGO BED KIT [WORKMAN]	Utility Vehicle	2006/42/EC, 2004/108/EC

Relevant technical documentation has been compiled as required per Part B of Annex VII of 2006/42/EC.

We will undertake to transmit, in response to requests by national authorities, relevant information on this partly completed machinery. The method of transmission shall be electronic transmittal.

This machinery shall not be put into service until incorporated into approved Toro models as indicated on the associated Declaration of Conformity and in accordance with all instructions, whereby it can be declared in conformity with all relevant Directives.

Certified:



David Klis  
Sr. Engineering Manager  
8111 Lyndale Ave. South  
Bloomington, MN 55420, USA  
August 11, 2016

EU Technical Contact:

Marc Vermeiren  
Toro Europe NV  
B-2260 Oevel-Westerloo  
Belgium

Tel. 0032 14 562960  
Fax 0032 14 581911