



Operator Fan and Interior Roof Kit

Groundsmaster® or Reelmaster® Traction Unit with 2 Post ROPS Extension

Model No. 132-3435

Installation Instructions

Installation

Loose Parts

Use the chart below to verify that all parts have been shipped.

Procedure	Description	Qty.	Use
1	No parts required	–	Prepare the machine.
2	Ceiling plate Ceiling foam	1 1	Attach the foam to the ceiling.
3	Fan Fan bracket Mounting bracket Fan grill Bolt (1/4 x 1 inch) Nut (1/4 inch) Screw (#8 x 3/8 inch) Resistor pack Ceiling plate	1 1 1 1 4 4 2 1 1	Install the fan.
4	Rivet	10	Install the ceiling assembly to the machine.

⚠ WARNING

CALIFORNIA Proposition 65 Warning

This product contains a chemical or chemicals known to the State of California to cause cancer, birth defects, or reproductive harm.



1

Preparing the Machine

No Parts Required

Procedure

1. Park the machine on a level surface.
2. Shut off the engine, set the parking brake, and remove the key from the ignition switch.

2

Attaching the Foam to the Ceiling

Parts needed for this procedure:

1	Ceiling plate
1	Ceiling foam

Procedure

1. Remove the protective backing from the ceiling foam.
2. Attach the ceiling foam to the ceiling plate, lining up the fan hole and bolt holes (Figure 1).

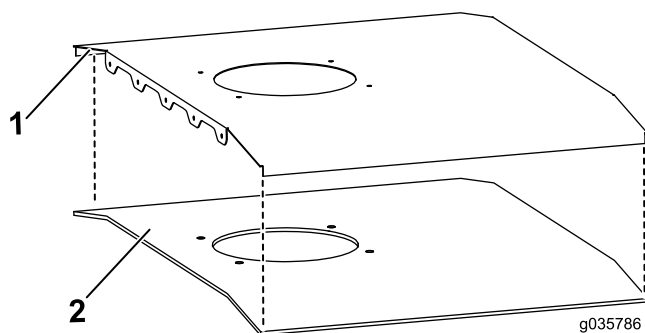

Figure 1

1. Ceiling plate
2. Ceiling foam

3

Installing the Fan

Parts needed for this procedure:

1	Fan
1	Fan bracket
1	Mounting bracket
1	Fan grill
4	Bolt (1/4 x 1 inch)
4	Nut (1/4 inch)
2	Screw (#8 x 3/8 inch)
1	Resistor pack
1	Ceiling plate

Procedure

1. Use the 2 screws (#8 x 3/8 inch) to secure the resistor pack to the fan mounting (Figure 2).

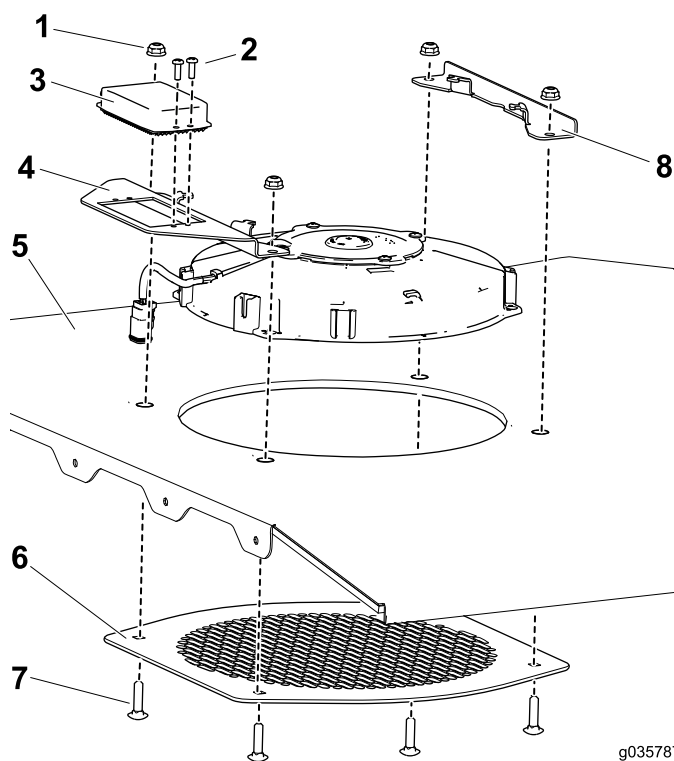

Figure 2

1. Nut (1/4 inch)
2. Screw (#8 x 3/8 inch)
3. Resistor pack
4. Mounting bracket
5. Ceiling plate
6. Fan grill
7. Bolt (1/4 x 1 inch)
8. Fan bracket

2. Use the 4 bolts (1/4 x 1 inch) and 4 nuts to secure the fan, fan grill, fan bracket, and mounting bracket to the ceiling plate (Figure 2).
3. Connect the wire harness to the resistor pack (Figure 3).

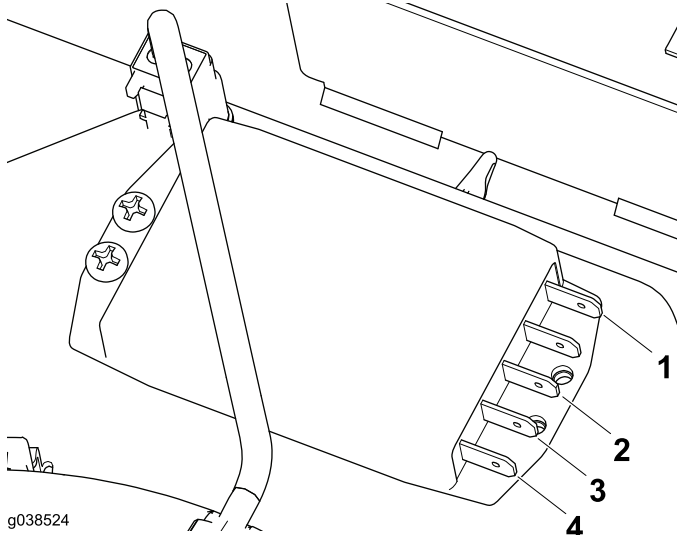

Figure 3

- | | |
|------------------------|-------------------------|
| 1. Ground (pink) | 3. Medium speed (brown) |
| 2. High speed (orange) | 4. Low speed (violet) |

4

Installing the Ceiling Assembly to the Machine

Parts needed for this procedure:

10	Rivet
----	-------

Procedure

1. Remove the roof.
2. Place the ceiling assembly on the machine, lining up the rivet holes in the ceiling assembly with the rivet holes on the machine (Figure 4).

Note: The fan should face the rear of the machine.

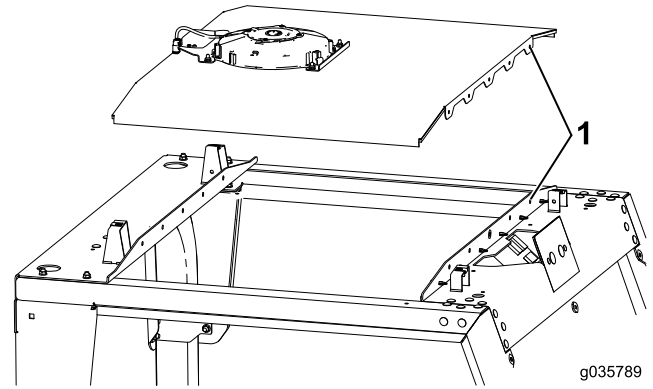

Figure 4

1. Rivet holes

3. Secure the ceiling assembly in place using 10 rivets (Figure 5).

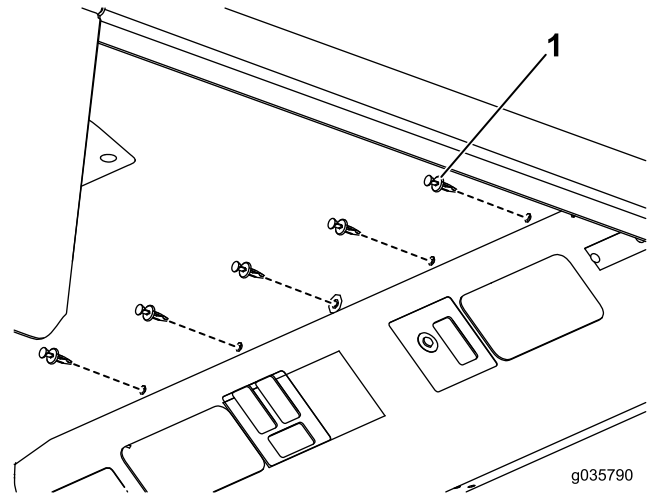

Figure 5

Forward rivets shown

1. Rivet

4. Install the roof.
5. Plug the fan into the wire harness.



Count on it.