



MODEL NO. 07301—60001 & UP
MODEL NO. 07321—60001 & UP

Installation Instructions

2/3- & Full-Size Flat Bed

For the Workman 3000 Series

INSTALL THE RADIATOR COVER (Required with Full-Size Flat Bed only)

IMPORTANT: Before installing a full-size flat bed to a vehicle, a radiator cover (included with the full-size flat bed) must be installed to prevent sand, dirt, etc., spilling over the front of the bed and entering the radiator.

1. Remove the capscrew securing the top left corner of the radiator to the vehicle frame (as viewed from the driver's position on the seat).
2. Mount the left-hand cover bracket to the frame with (2) 5/16-18 x 5/8" capscrews and locknuts (supplied with the kit).
3. Repeat steps 1 and 2 on the right-top side of the radiator.
4. Insert a swell latch into each mounting hole of the radiator cover as shown in figure 1. Secure latches to each side with a rubber grommet and plastic nut.
5. Install the radiator cover onto the new brackets and secure latches.

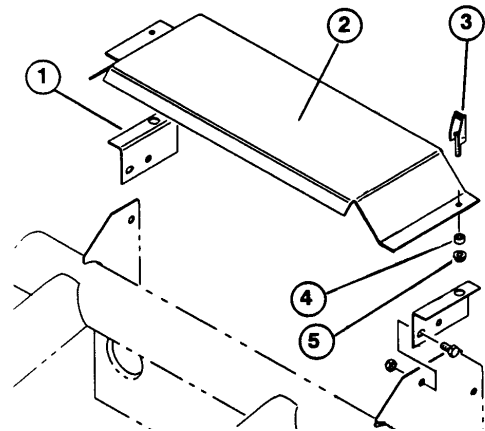

Figure 1

1. Left cover bracket
2. Radiator cover
3. Swell latch
4. Rubber grommet
5. Plastic nut

INSTALL REAR PIVOT PLATES & BOX SPACERS (Required only on Workman 3300-D)

WARNING: Lowering the bed on a Workman 3300-D will crush the fuel injector lines and cause serious damage to the engine unless the higher rear pivot plates and spacers (included with the Workman 3300-D) have been installed.

1. Remove the clevis pins and lynch pins installed to the bed pivot plates for shipping (Fig. 2).
2. Remove the capscrews and locknuts securing the rear pivot plates to the right and left bed frame channels (Fig. 3).
3. Loosely assemble the higher rear pivot plates together with a pivot tube, 3/8-16 x 3-3/4" capscrew and locknut, using

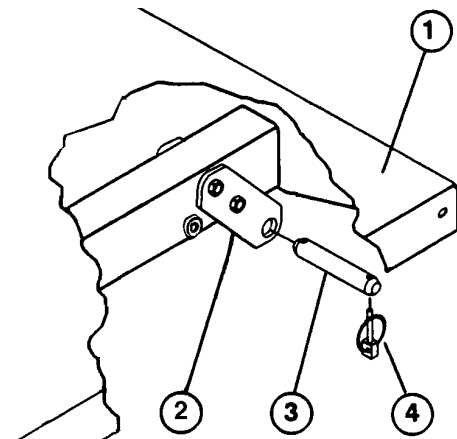

Figure 2

1. Left rear corner of bed
2. Pivot plate
3. Clevis pin
4. Lynch pin

the holes shown in figure 4.

4. Mount each set of rear pivot plates to the right and left bed frame channels with the capscrews and locknuts previously removed. Position the brackets on the full bed as shown in figure 4, and for the 2/3 bed as shown in figure 5.
5. Remove the machine screws and locknuts securing the (2) spacer blocks and shims to the front underside of the bed (Fig. 6).
6. Remount the spacer blocks and new box spacers to the underside of the bed with the new, longer machine screws and locknuts (Fig. 7).

INSTALLING THE FULL-SIZE FLAT BED

NOTE: If the bed sides will be installed on the flat bed, it is easier to install them before the bed is installed on the vehicle.

NOTE: On a Workman 3000 with a full flat bed, assure rear pivot plates are bolted to the bed frame/channel so that lower end angles to the rear (Fig. 4).

1. Remove the clevis pins and lynch pins installed to the bed pivot brackets for shipping.
2. Assure the lift cylinders are fully retracted.

CAUTION: The full bed weighs approximately 78 kg, so do not try to install or remove it by yourself. Get two or three other people to help you.

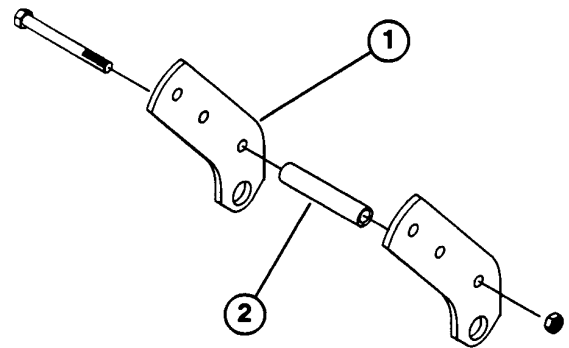

Figure 3

1. Higher pivot brackets
2. Pivot tube

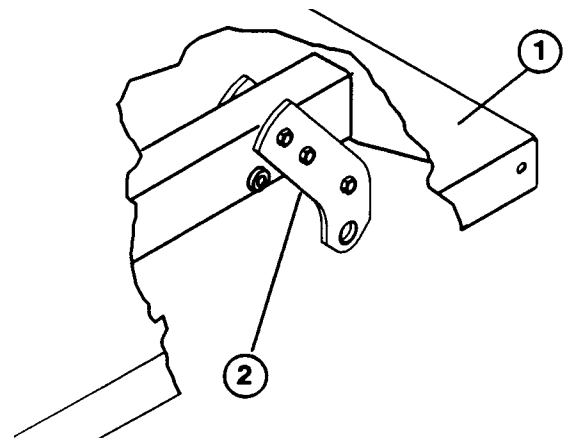

Figure 4

1. Left-rear corner of bed
2. Higher pivot bracket

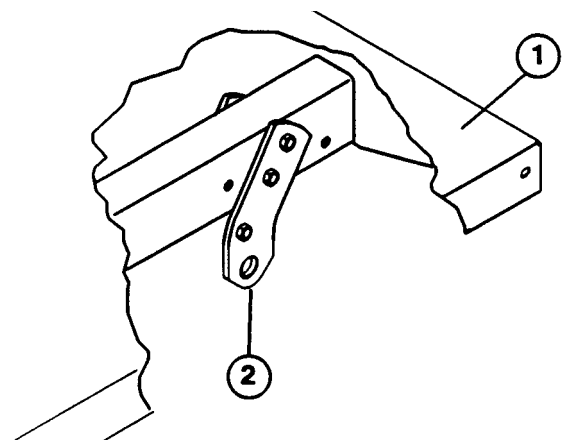

Figure 5

1. Left-rear corner of bed
2. Higher pivot bracket



WARNING



- Always have someone assist you when lifting the bed or use a hoist.
- Always install the safety support from the outside of the vehicle, never from under the bed.
- Never work under the raised bed without positioning the safety support on a fully installed cylinder rod.

3. Carefully set the bed onto the vehicle frame, aligning the rear bed pivot plate holes with the holes in the rear frame channel (Fig. 8).

Note: Loosen the capscrews securing the pivot plates to the bed channel to ease the alignment of holes, if required.

4. Secure each set of pivot plates to the frame channels with a clevis pin and (2) lynch pins (Fig. 8). Tighten the pivot plate mounting capscrews if they were previously loosened.

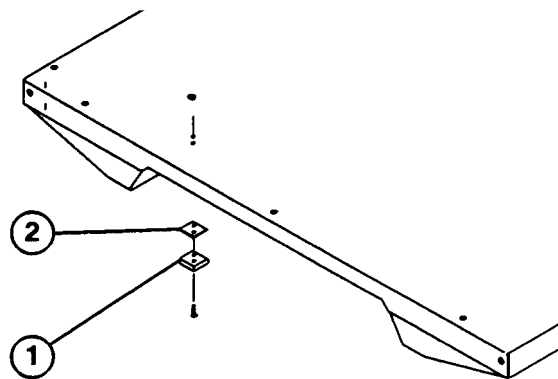

Figure 6

1. Spacer block
2. Shim

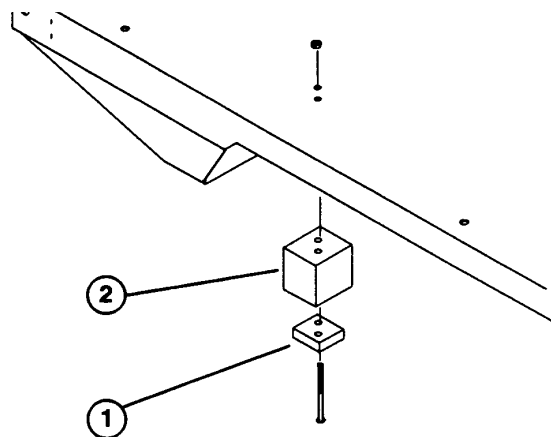

Figure 7

1. Spacer block
2. Box spacer

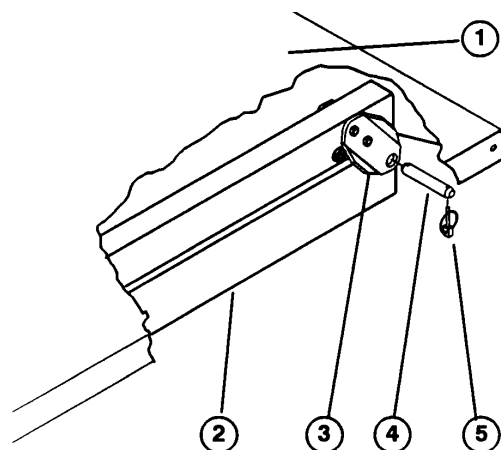

Figure 8

1. Left rear corner of bed
2. Vehicle frame channel
3. Pivot plate
4. Clevis pin
5. Lynch pin

5. With the bed lowered, secure each cylinder rod end to the appropriate slots in the bed mounting plates with a clevis pin and lynch pin. Insert the clevis pin from outside of the bed with the lynch pin toward the outside (Fig. 9). The rear slots are for full bed installation and front slots are for 2/3-bed installation.

NOTE: Engine may need to be started to extend or retract cylinders for alignment with holes. Keep fingers out!

NOTE: Plug the unused slot with a capscrew and nut to prevent assembly errors.

6. Start the engine and the engage hydraulic lift lever to raise the bed. Release the lift lever and turn off the engine. Secure the raised bed with a hoist or block it to prevent it from accidentally falling.

7. Install lynch pins to the inside ends of the clevis pins.

NOTE: If an automatic tail gate release has been installed on the bed, make sure the front dump link rod has been placed on the inside of the left side clevis pin before installing the lynch pin.

8. Once cylinder installation is completed, the bed safety support can be used to prevent accidental lowering of the bed.

9. To use the bed safety support:

- A. Raise the bed until the cylinders are fully extended.
- B. Remove the bed support from the storage stud on top of back rest support channel on the Workman (Fig. 10).
- C. Push the bed support onto the cylinder rod, making sure the support end tabs rest on end of the cylinder barrel and on the cylinder rod end (Fig. 11).
- D. To store the bed support, remove from the cylinder and insert on the stud on top of the back rest support channel.
- E. Always install or remove the bed support from outside of the bed.
- F. Do not try to lower the bed with the bed safety support on the cylinder.

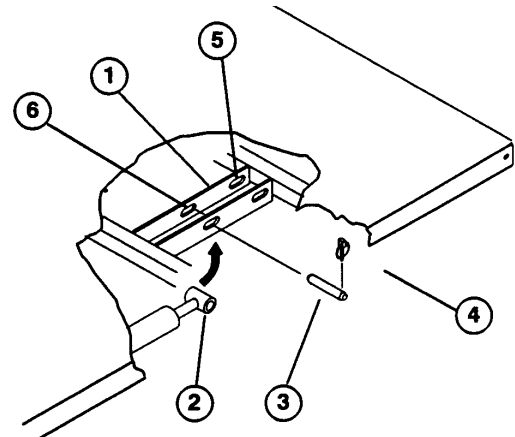

Figure 9

1. Bed mounting plate
2. Cylinder rod end
3. Clevis pin
4. Lynch pin
5. Rear slots (Full bed)
6. Front slots (2/3 bed)

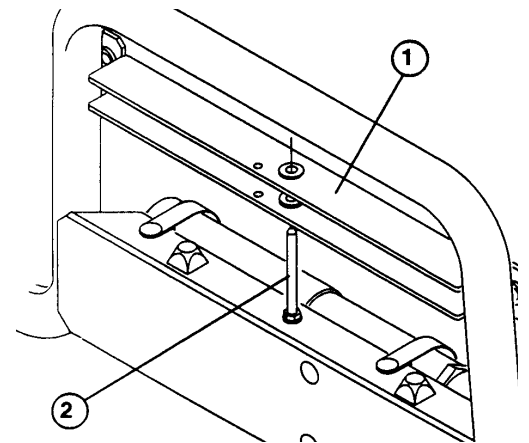

Figure 10

1. Bed support
2. Storage stud

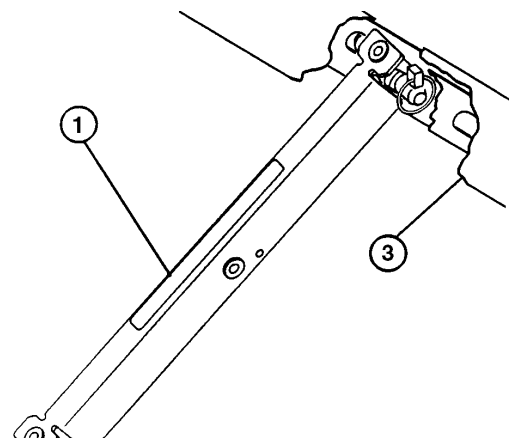

Figure 11

1. Bed support
2. Cylinder barrel
3. Bed

10. Remove the bed safety support from the cylinder and place it on the storage stud.
11. Start the engine and engage the hydraulic lift lever to lower the bed. Release the lift lever and turn off the engine.

INSTALLING THE 2/3-SIZE FLAT BED

Same as full bed installation except for the following:

1. Mount the rear pivots plates so the lower ends angle forward.
2. The rear slots are for full-bed installation and the front slots are for 2/3-bed installation.

WARNING: The 1/3 mid-area must be covered when the 2/3 bed is used on the Workman. This can be done by installing 1/3 bed, 1/3 tool box or 1/3 cover.

FULL & 2/3 BED REMOVAL

1. Start the engine. Engage the hydraulic lift lever and lower the bed until the cylinders are loose in the slots. Release the lift lever and turn off the engine.
2. Remove the lynch pins from the outer ends of the cylinder rod clevis pins.
3. Remove the clevis pins securing the cylinder rod ends to the bed mounting plates by pushing the pins toward the inside.
4. Remove the lynch pins and clevis pins securing the pivot brackets to the frame channels.
5. Lift the bed off the vehicle.

CAUTION: The full bed weighs approximately 78 kg, so do not try to install or remove it by yourself. Get two or three other people to help.

6. Store the cylinders in the storage clips. Engage the hydraulic lift lock lever on the vehicle to prevent accidental extension of the lift cylinders.

