



# Brake Replacement Kit

## Workman® HD or HDX Series Utility Vehicle

Model No. 136-6291

### Installation Instructions

#### ⚠ WARNING

##### CALIFORNIA Proposition 65 Warning

This product contains a chemical or chemicals known to the State of California to cause cancer, birth defects, or reproductive harm.

## Installation

### Loose Parts

Use the chart below to verify that all parts have been shipped.

Procedure	Description	Qty.	Use
<b>1</b>	No parts required	–	Prepare the machine.
<b>2</b>	No parts required	–	Remove the existing brake assembly.
<b>3</b>	Brake-caliper assembly Bleed screw Front brake-line assembly Rear brake-line assembly Banjo washer Banjo bolt	4 4 1 1 8 4	Install the new brake assembly.
<b>4</b>	No parts required	–	Bleed the brake calipers.
<b>5</b>	No parts required	–	Install the wheels.



# 1

## Preparing the Machine

### No Parts Required

### Procedure

1. Park the machine on a level surface.
2. Engage the parking brake.
3. Shut off the engine and remove the key from the key switch.

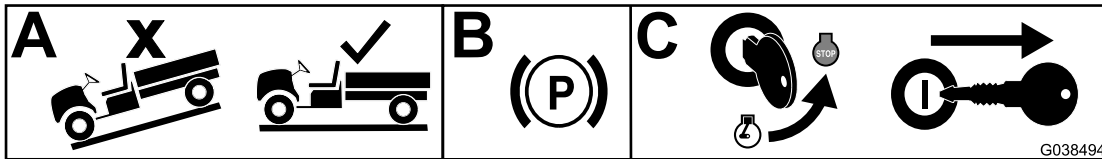

Figure 1

g038494

# 2

## Removing the Existing Brake Assembly

### No Parts Required

### Procedure

1. Lift the front and rear of the machine and support it with jack stands.
2. Remove the lug nuts that secure the wheel to the hub (Figure 2).

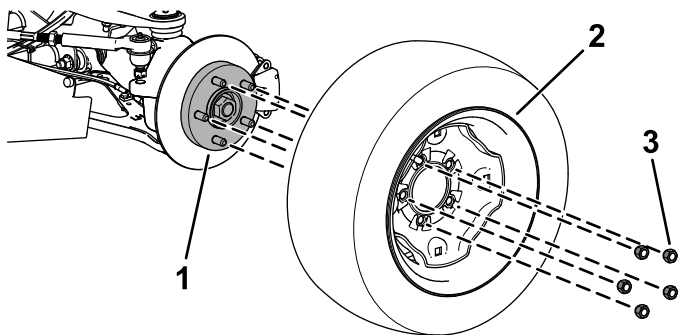

Figure 2

1. Hub
2. Wheel
3. Lug nut

3. Remove the front and rear brake lines from the brake-caliper assembly (Figure 3).

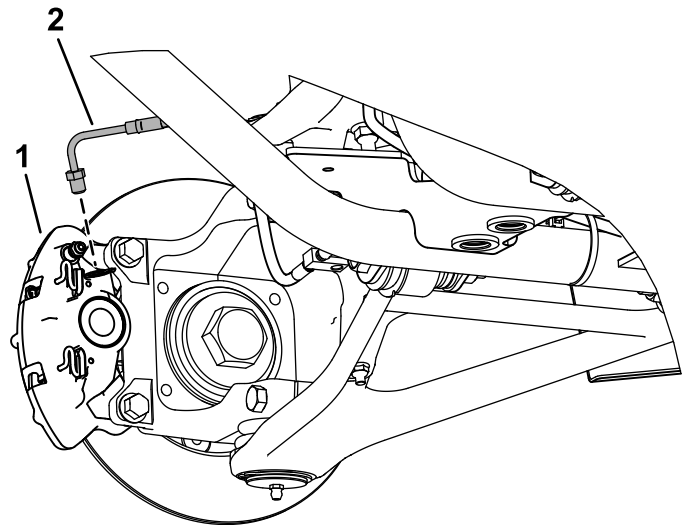

Figure 3

1. Brake-caliper assembly
2. Brake line

g189716

4. Remove the flange-head bolts (3/8 x 1 inch) that secure the brake-caliper assembly to the steering knuckle (front of the machine) and axle (rear of the machine), and remove the brake-caliper assembly (Figure 4).

**Note:** Retain the flange-head bolts (3/8 x 1 inch).

**Note:** Discard the brake-caliper assemblies.

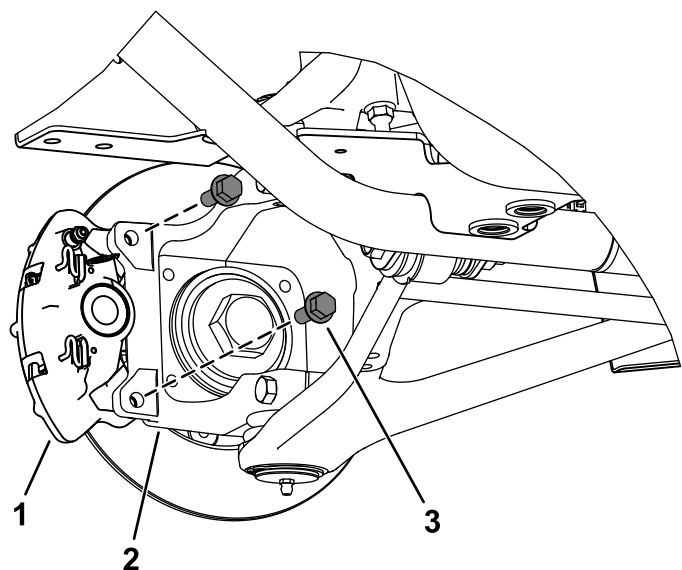
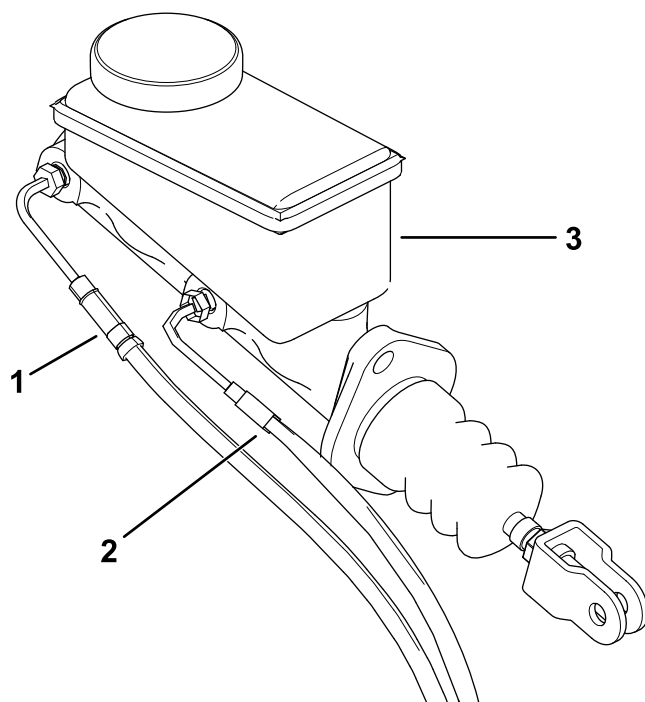

**Figure 4**

1. Caliper
2. Steering knuckle
3. Flange-head bolt (3/8 x 1 inch)

5. Remove the front and rear brake line from the master cylinder (Figure 5).

**Note:** Discard the brake lines, but retain the hardware for installing the new brake lines..

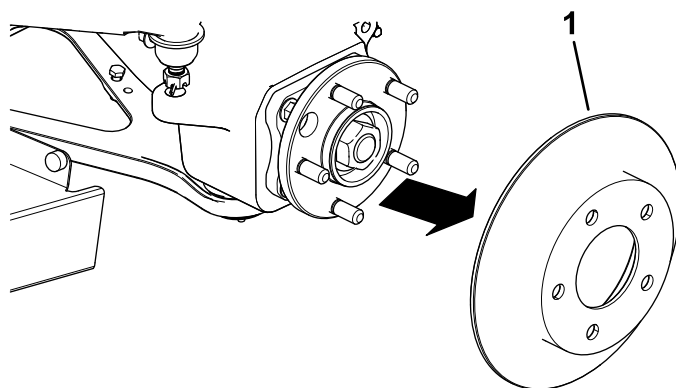

**Figure 5**

1. Front brake line
2. Rear brake line
3. Master cylinder

6. Remove the rotor (Figure 6).

**Note:** Retain the rotors.



**Figure 6**

1. Rotor

7. Repeat steps 2 through 6 on all sides of the machine.

# 3

## Installing the New Brake Assembly

Parts needed for this procedure:

4	Brake-caliper assembly
4	Bleed screw
1	Front brake-line assembly
1	Rear brake-line assembly
8	Banjo washer
4	Banjo bolt

### Procedure

1. Grind 1.78 mm (0.07 inches) relief into the right and left steering knuckles as shown in [Figure 7](#).

**Important:** Do not grind the surfaces shown in [Figure 7](#).

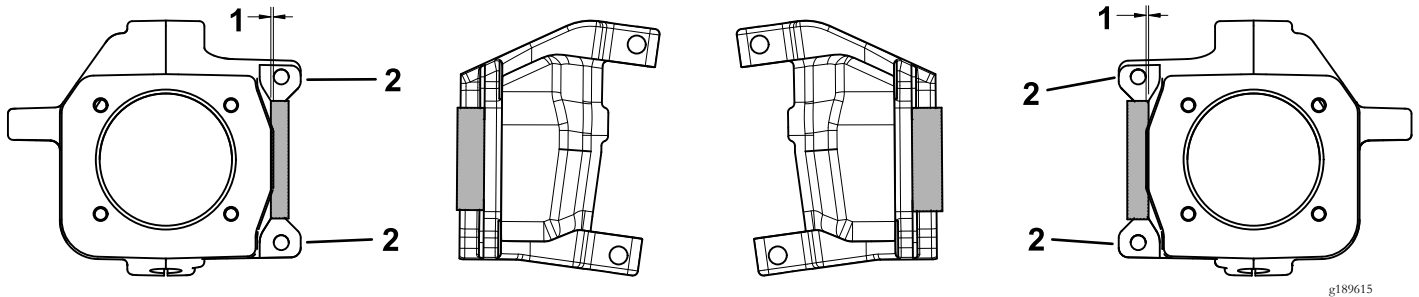

Figure 7

1. Grind 1.78 mm (0.07 inches) here.
2. Do not grind these surfaces.

2. Grind 0.76 mm (0.03 inches) relief into each side of the rear axle as shown in [Figure 7](#).

**Important:** Do not grind the surfaces shown in [Figure 8](#).

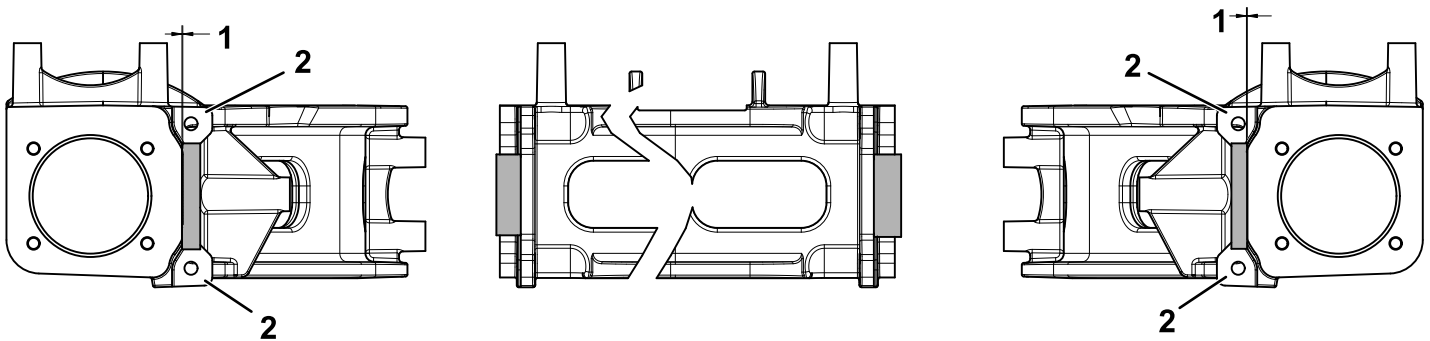
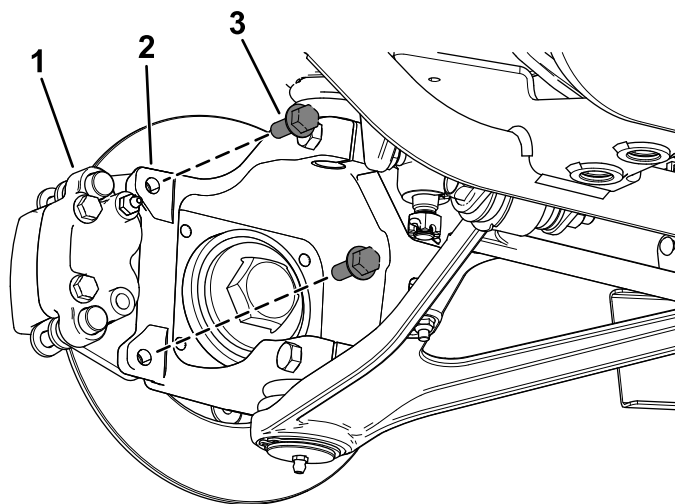

Figure 8

1. Grind 0.76 mm (0.03 inches) here.
2. Do not grind these surfaces.

3. Install the front and rear brake line to the master cylinder (Figure 5).
4. Install the rotor to the hub (Figure 6).
5. Install the new brake-caliper assembly to the steering knuckles and rear axles using the previously removed 2 flange-head bolts (3/8 x 1 inch) as shown in Figure 9.

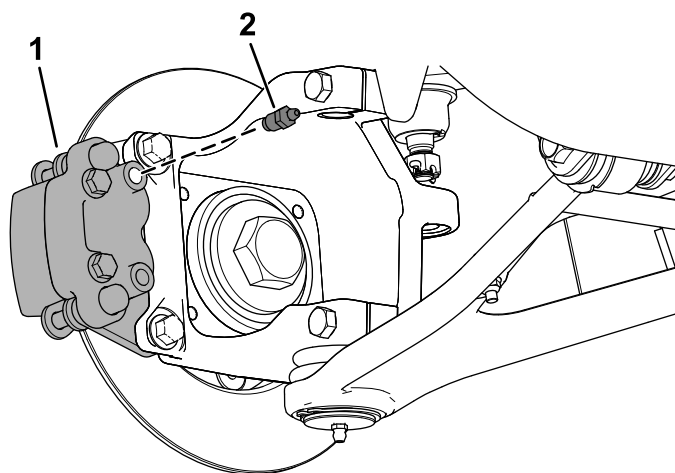

**Figure 9**

g189475

1. Caliper
2. Steering knuckle
3. Flange-head bolt (3/8 x 1 inch)

- 
6. Torque the 2 flange-head bolts (3/8 x 1 inch) to 47 to 54 N·m (35 to 40 ft-lb).
  7. Install the bleed screw into the top hole of the brake-caliper assembly (Figure 10).

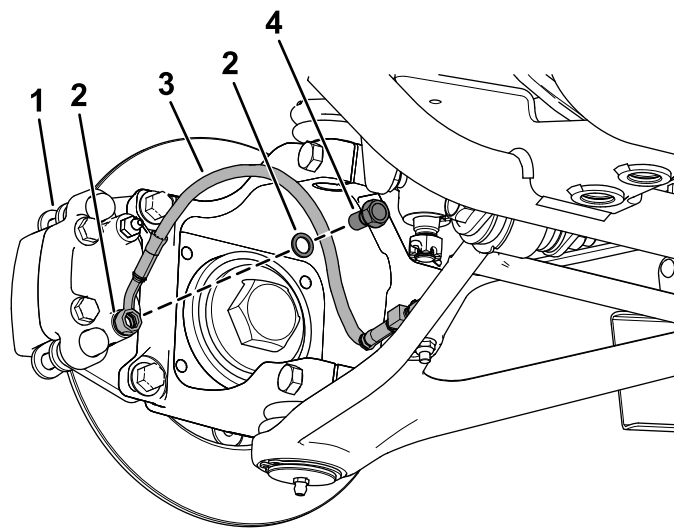

**Figure 10**

g189582

1. Brake-caliper assembly
2. Bleed screw

- 
8. Torque the bleed screw to 6 to 7.5 N·m (4.5 to 5.5 ft-lb).
  9. Install the brake lines to the brake-caliper assemblies using a banjo bolt and 2 banjo washers (Figure 11).



g189411

**Figure 11**

- |                           |               |
|---------------------------|---------------|
| 1. Brake-caliper assembly | 3. Brake line |
| 2. Banjo washers          | 4. Banjo bolt |

---

10. Torque the banjo bolt to 12 to 15 N·m (9 to 11 ft-lb).

# 4

## Bleeding the Brake Calipers

No Parts Required

### Procedure

**Important:** You will need 2 people to perform this procedure.

1. Fill the master cylinder with brake fluid; refer to your *Operator's Manual*.
2. Push down the brake pedal fully.
3. With brake pedal pushed down fully, loosen the bleed screw 1/4 turn (Figure 12).
4. With brake pedal pushed down fully, tighten the bleed screw 1/4 turn (Figure 12).

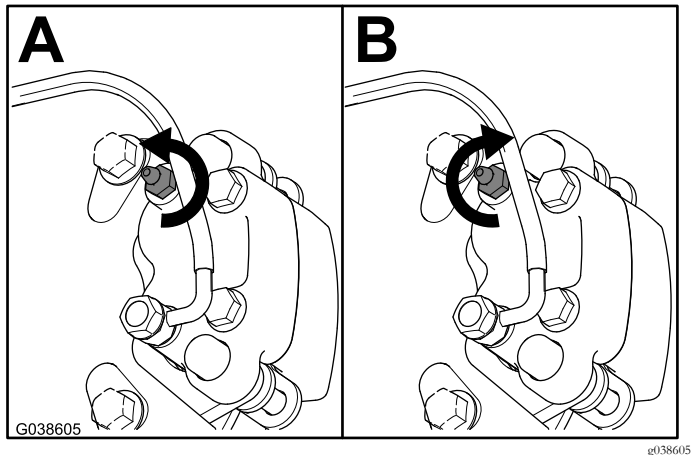

Figure 12

5. Repeat this process until air no longer releases from the calipers.

**Note:** When air no longer releases, you should not see any more air bubbles in the brake fluid.

6. Top off the master cylinder with brake fluid as needed; refer to your *Operator's Manual*.

# 5

## Installing the Wheels

No Parts Required

### Procedure

1. Install the wheel onto the hub using the previously removed lug nuts (Figure 2).
2. Torque the lug nuts in a star pattern to 108 to 122 N·m (80 to 90 ft-lb).



**Count on it.**