



BBC Arm Service Kit

76cm TurfMaster Walk-Behind Lawn Mower

Model No. 136-7054

Installation Instructions

⚠ WARNING

CALIFORNIA Proposition 65 Warning

This product contains a chemical or chemicals known to the State of California to cause cancer, birth defects, or reproductive harm.

Installation

Loose Parts

Use the chart below to verify that all parts have been shipped.

Procedure	Description	Qty.	Use
1	No parts required	–	Prepare the machine for installation.
2	No parts required	–	Remove the existing brake arm and brake cable.
3	Brake arm Brake cable Rubber spacer Cable tie	1 1 1 2	Install the brake arm and brake cable.

1

Preparing the Machine for Installation

No Parts Required

Procedure

Important: Refer to your machine *Operator's Manual* for maintenance safety information.

1. Move the machine to a level surface.
2. Release the blade-brake bail.
3. Disconnect the spark-plug wire from the spark plug.
4. Remove the blade-drive system cover from the machine.

5. Tip the machine onto its side, with the air filter facing upward, until the upper handle rests on the ground.

Important: Tipping the machine may cause the fuel to leak. Fuel is flammable and explosive, and can cause personal injury. Run the engine dry to remove the fuel with a hand pump; never siphon the fuel.



6. Use a block of wood to hold each blade steady (Figure 1).

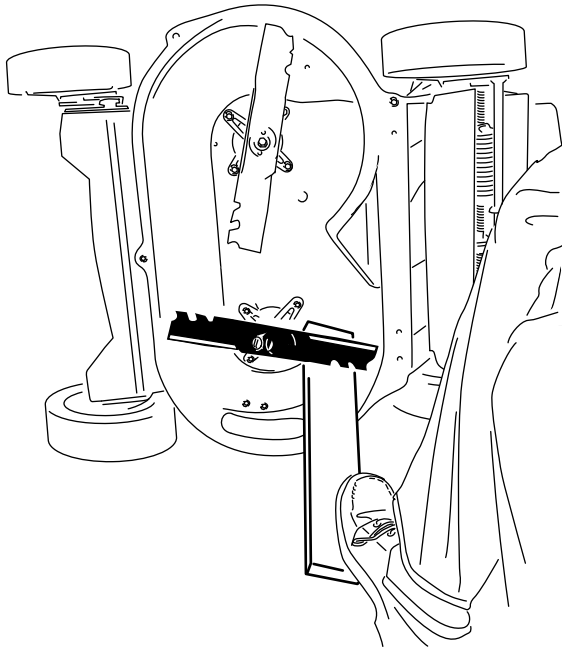
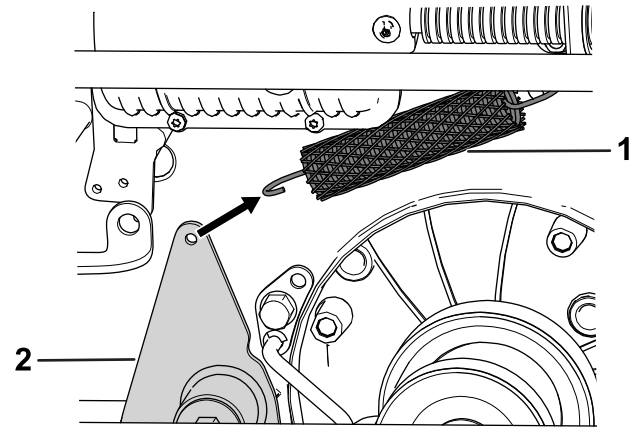

Figure 1

g196361

8. Remove the brake-extension spring from the brake arm (Figure 3).



g195305

Figure 3

1. Brake-extension spring 2. Brake arm

7. Remove the transmission belt and the transmission tension spring from the machine (Figure 2).

Note: Removing the transmission belt and the transmission tension spring allows access to the brake arm.

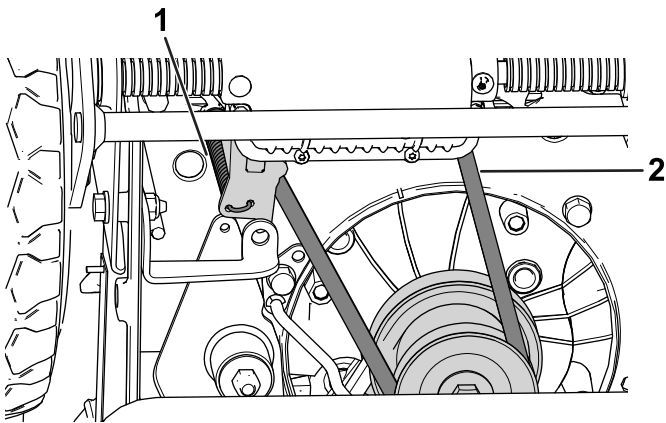

g195306

Figure 2

1. Transmission tension spring 2. Transmission belt

2

Removing the Existing Brake Arm and Brake Cable

No Parts Required

Procedure

1. Remove the brake cable from the brake-arm hook (Figure 4).

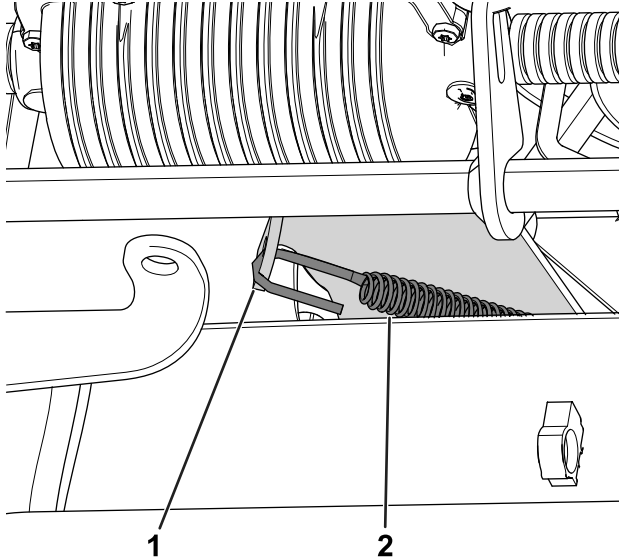
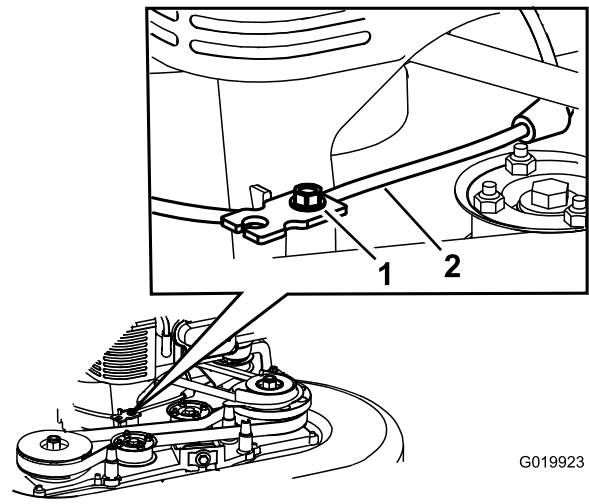

Figure 4

1. Brake-arm hook
2. Brake cable

2. Loosen the cable-clamp screw and slide the cable out from under the engine (Figure 5).



G019923

g019923

Figure 5

1. Cable-clamp screw
2. Brake cable

3. Remove the bolt and the nut that secures the brake arm onto the machine; retain and set the bolt and the nut aside (Figure 6 and Figure 7).

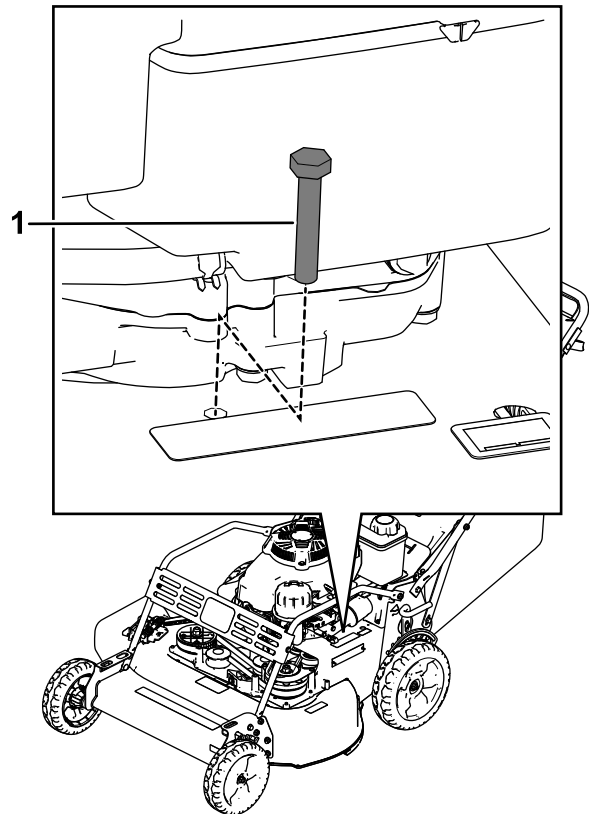

Figure 6

1. Bolt

g194786

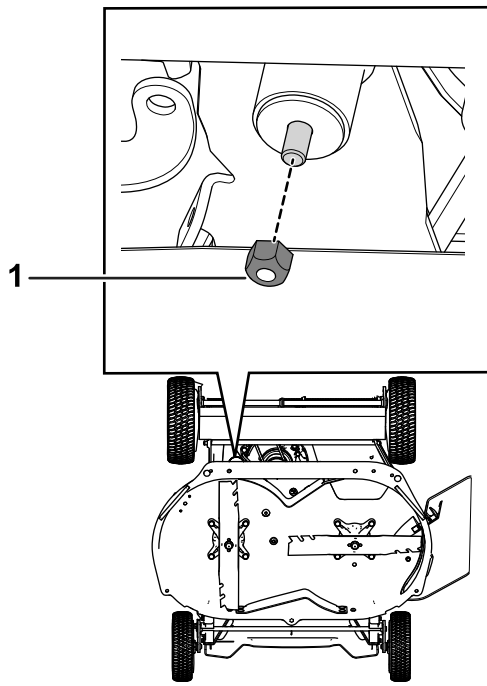

Figure 7

g195304

1. Nut

4. Remove the hardware from the brake arm (Figure 8).

Important: Retain all hardware for use in [3 Installing the Brake Arm and Brake Cable](#) (page 4).

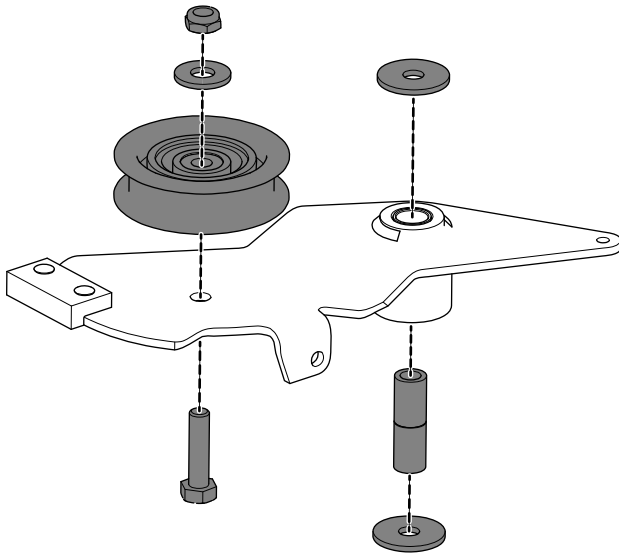

Figure 8

g195474

5. Cut and remove the existing cable ties.

6. Disconnect the brake cable from the handle bracket (Figure 9).

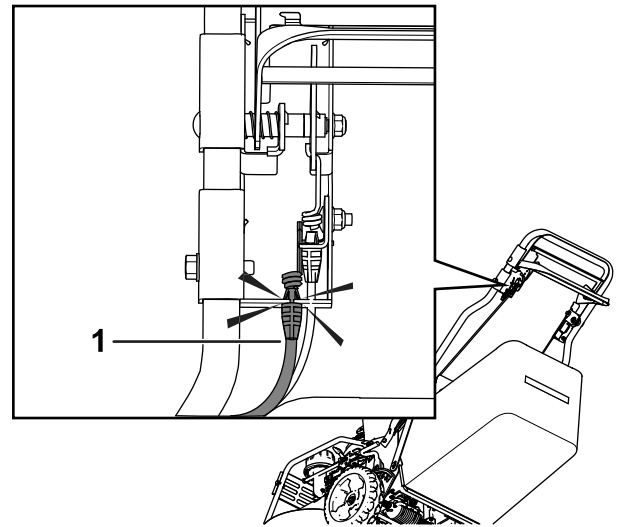

Figure 9

g194764

1. Brake cable

3

Installing the Brake Arm and Brake Cable

Parts needed for this procedure:

1	Brake arm
1	Brake cable
1	Rubber spacer
2	Cable tie

Procedure

1. Install the rubber spacer and the hardware from the old brake arm onto the new brake arm (Figure 10).

Important: Inspect the hardware for excessive wear. Replace the hardware if necessary.

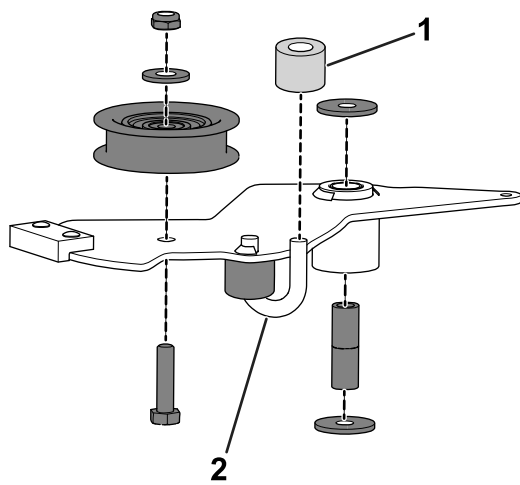

Figure 10

1. Rubber spacer
2. Hook

2. Guide the rubber spacer along the hook until it is flush with the plate (Figure 10).
3. Torque the bolt that you previously removed in step 4 to 10 to 13 N·m (85 to 115 in-lb).
4. Use the bolt and the nut that you previously removed in step 3 to install the brake arm onto the machine (Figure 11 and Figure 12).

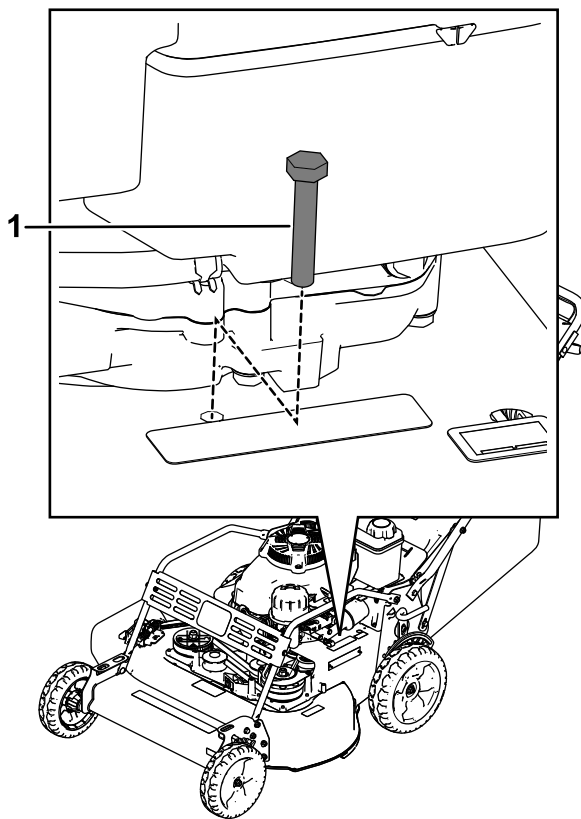

Figure 11

1. Bolt

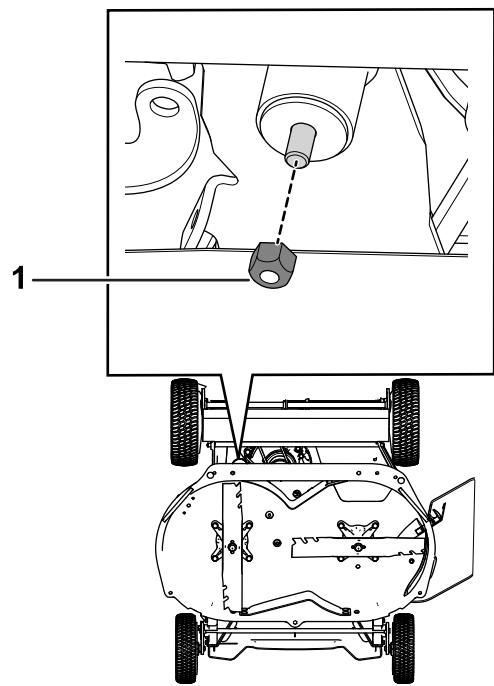

Figure 12

1. Nut

5. Torque the nut to 10 to 13 N·m (85 to 115 in-lb).

Note: The brake arm should have a full range of motion.

6. Attach the brake cable to the handle bracket (Figure 13).

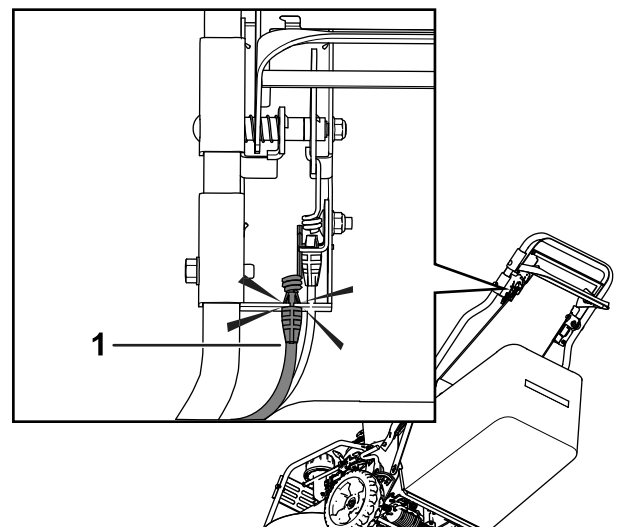

Figure 13

1. Brake cable

7. Route the brake cable through the insert below the cable clamp.
8. Attach the brake cable to the brake-arm hook (Figure 14).

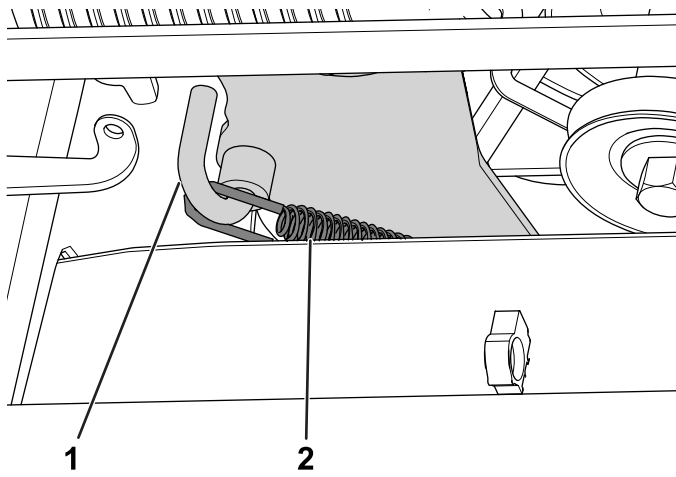

Figure 14

1. Brake-arm hook
2. Brake cable

9. Pull the cable jacket to remove slack (Figure 15).

Note: Do not put tension on the spring.

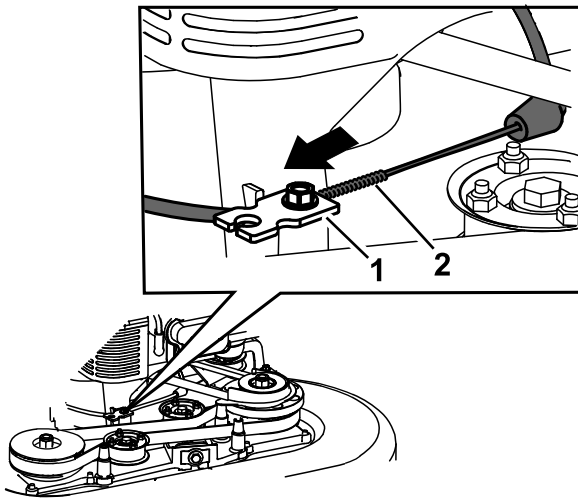

Figure 15

1. Cable clamp
2. Cable jacket

10. Mark the brake cable (Figure 16), then adjust the jacket until there is approximately 3 mm (1/8 inch) of slack (Figure 17).

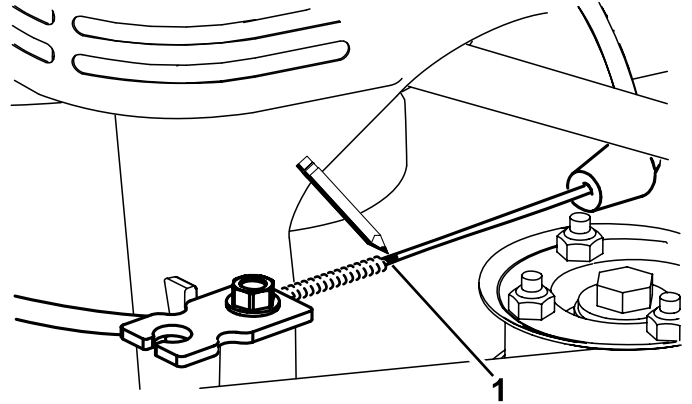

Figure 16

1. Mark the cable here

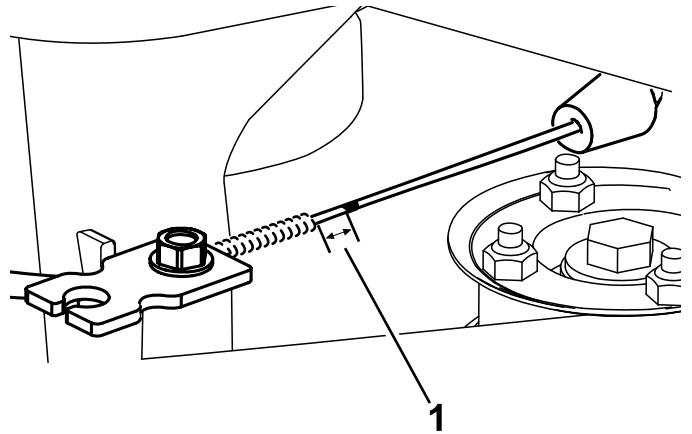

Figure 17

1. Slack—3 mm (1/8 inch)

11. Torque the cable-clamp screw to 11 to 14 N·m (99 to 121 in-lb) to lock the adjustment in place.

12. Attach 2 cable ties at the indicated locations shown in [Figure 18](#).

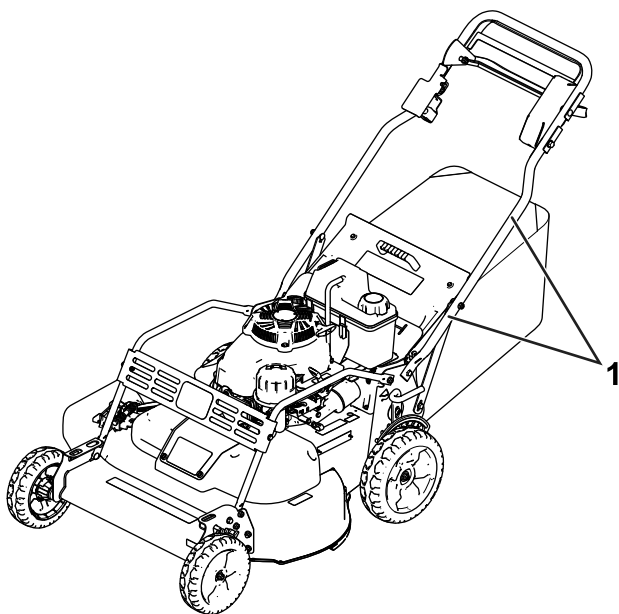

Figure 18

g194765

1. Cable tie locations

13. Attach the brake-extension arm to the brake arm ([Figure 19](#)).

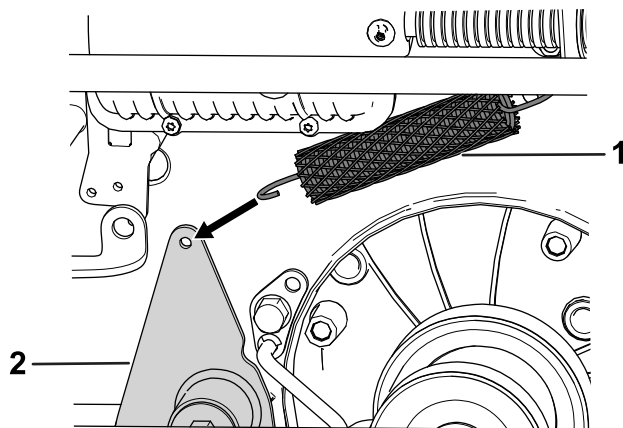

Figure 19

g195539

1. Brake-extension spring 2. Brake arm

14. Install the transmission belt and the transmission tension spring ([Figure 20](#)).

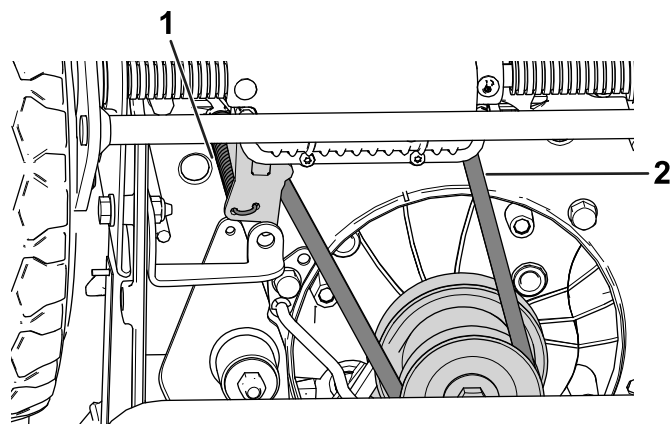

Figure 20

g195306

1. Transmission tension spring 2. Transmission belt

15. Install the blade-drive system cover.
16. Connect the spark-plug wire to the spark plug.



Count on it.