



Bench Seat Base Kit

Workman® GTX Series Utility Vehicles

Model No. 07047

Installation Instructions

⚠ WARNING

CALIFORNIA Proposition 65 Warning

This product contains a chemical or chemicals known to the State of California to cause cancer, birth defects, or reproductive harm.

Important: You must install the Seat Hinge Kit before installing the Bench Seat Base Kit.

Preparing the Machine

1. Park the machine on a level surface.
2. Engage the parking brake.
3. Shut off the engine and remove the key from the key switch.

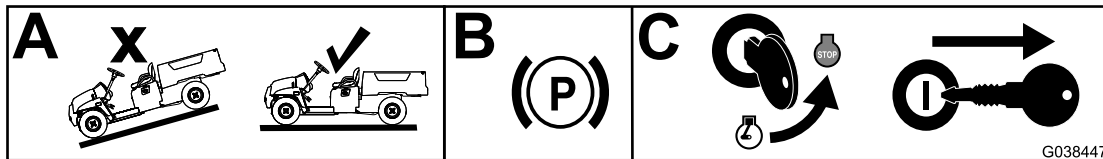
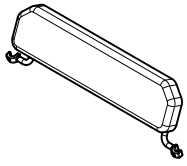

Figure 1

g038447



Installing the Seat Assembly



1x

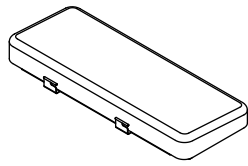

1x

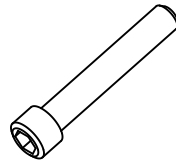

2x

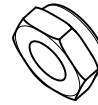

2x

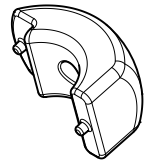

2x

1. Install the bottom cushion with the brackets into the pins on the seat base, and lower the bottom cushion (Figure 2).
2. Install the back rest frame and cushion assembly to the handholds using the 2 bench seat casting mounts, 2 screws ($\frac{3}{8}$ x 2-1/4 inches), and 2 locknuts ($\frac{3}{8}$ inch) as shown in Figure 2.

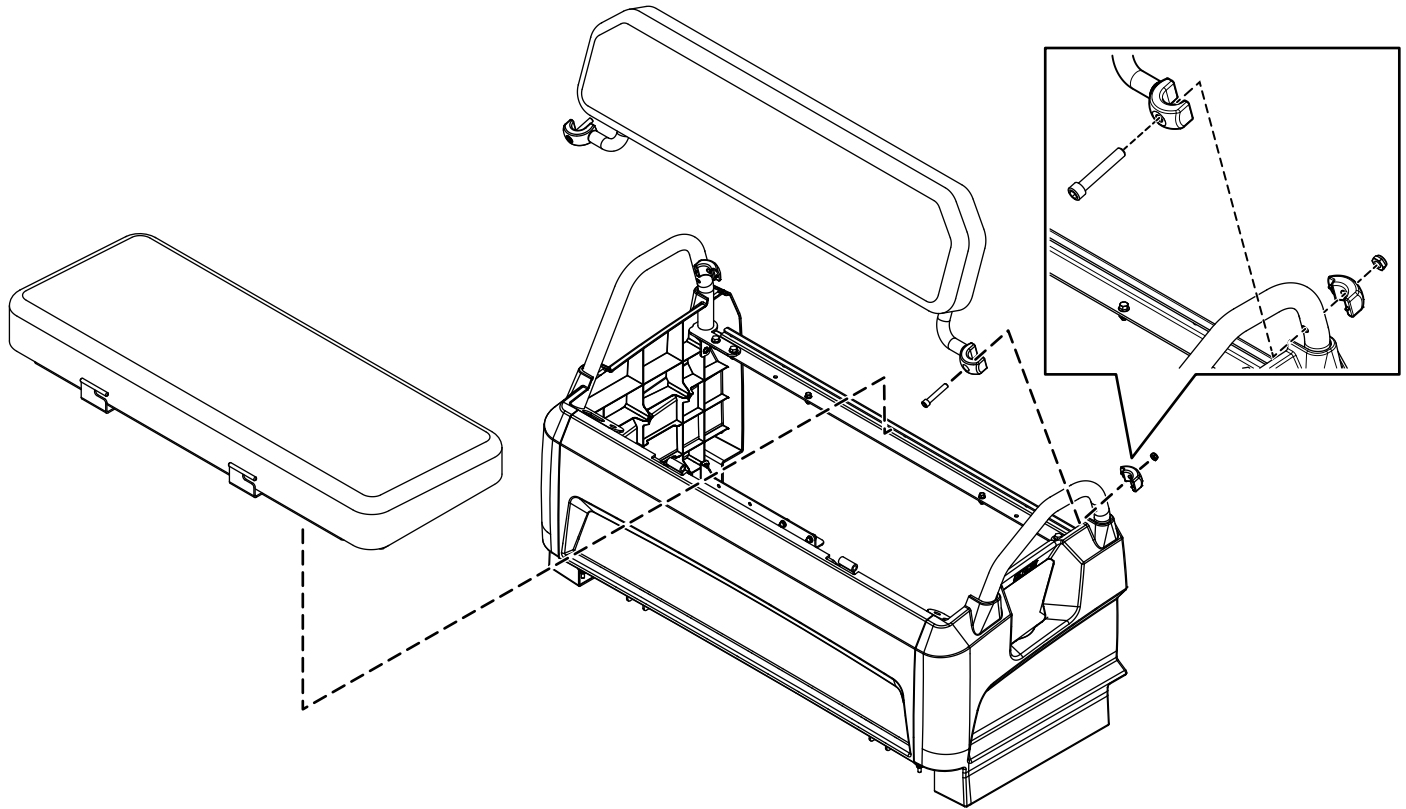
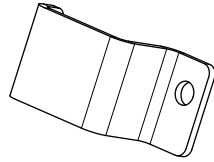

Figure 2

g196509

Installing the Radio Mount



1x

1. Remove the existing torx-head screw from the dash (Figure 3).

Note: Retain the torx-head screw.

2. Install the radio mount to the dash using the previously removed torx-head screw (Figure 3).
3. Torque the torx-head screw to 4.5 to 5 N·m (40 to 45 in-lb).

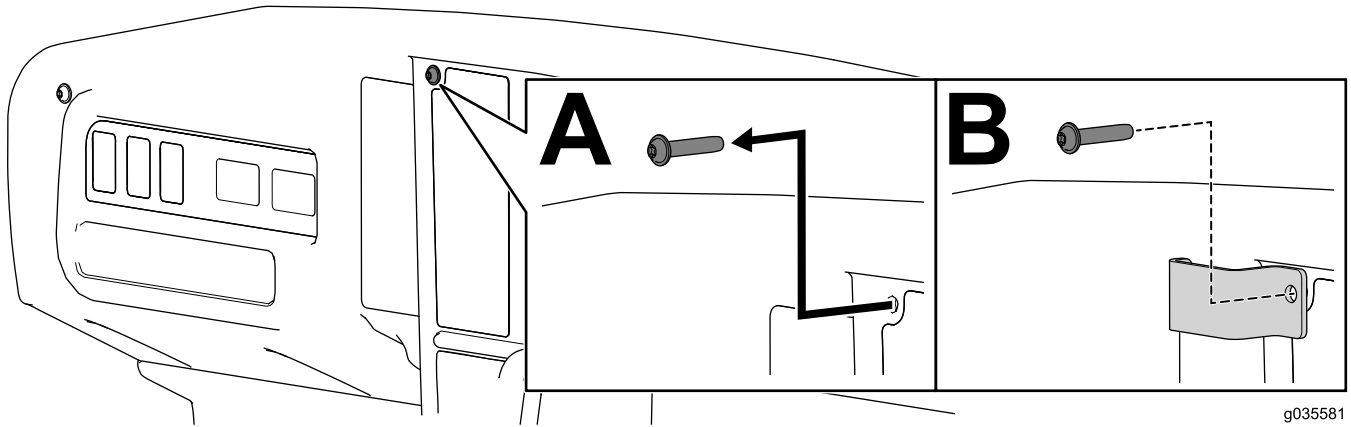

g035581

g035581

Figure 3

Drilling the Accessory Holes

⚠ CAUTION

When drilling holes into the seat base of the Workman GTX Electric Utility Vehicle, you could accidentally drill into the battery, spraying battery acid or resulting in electrical shock.

Be careful to drill into the seat base only.

Do not drill into the battery.

Drill the accessory holes as shown in [Figure 4](#).

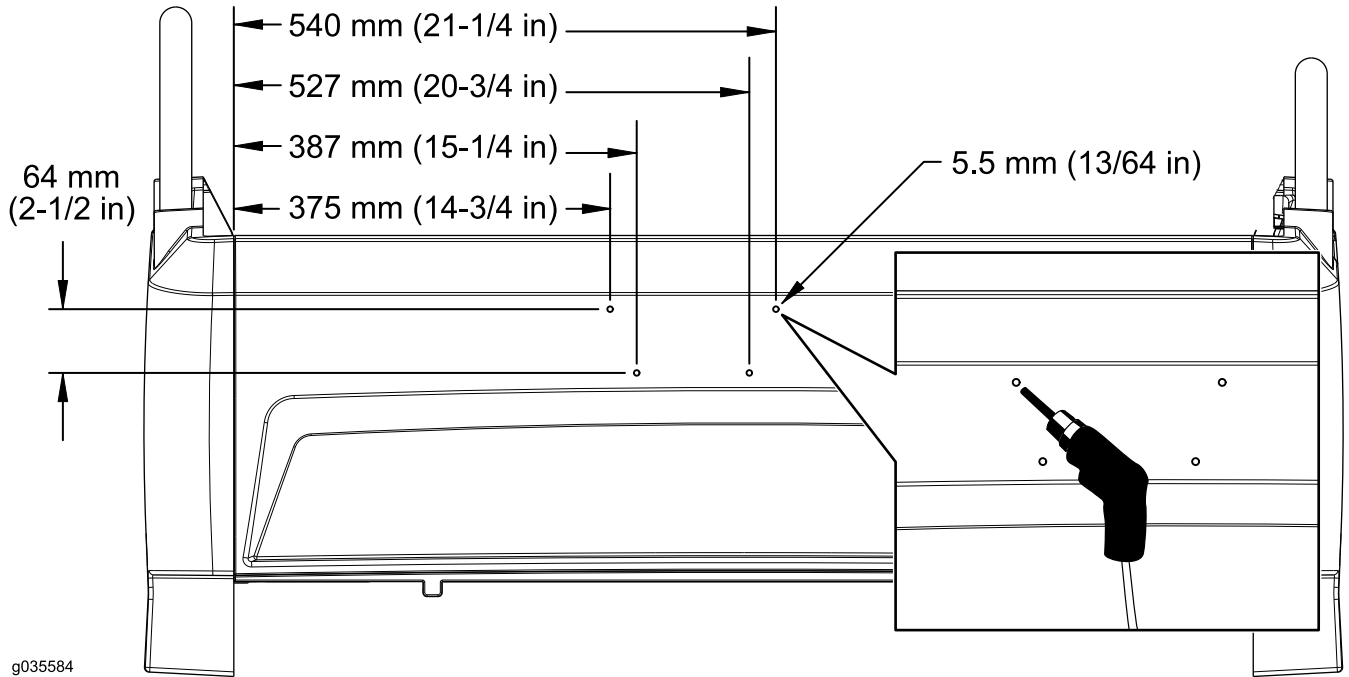
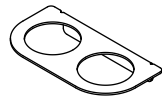
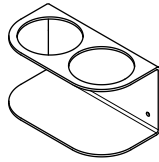

Figure 4

Mounting the Accessory



1x



1x

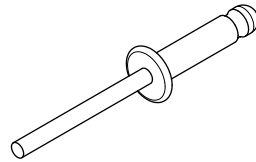

4x

Install the cup-holder bracket and cup-holder divider bracket into the holes in the seat-base panel using the 4 pop rivets (Figure 5).

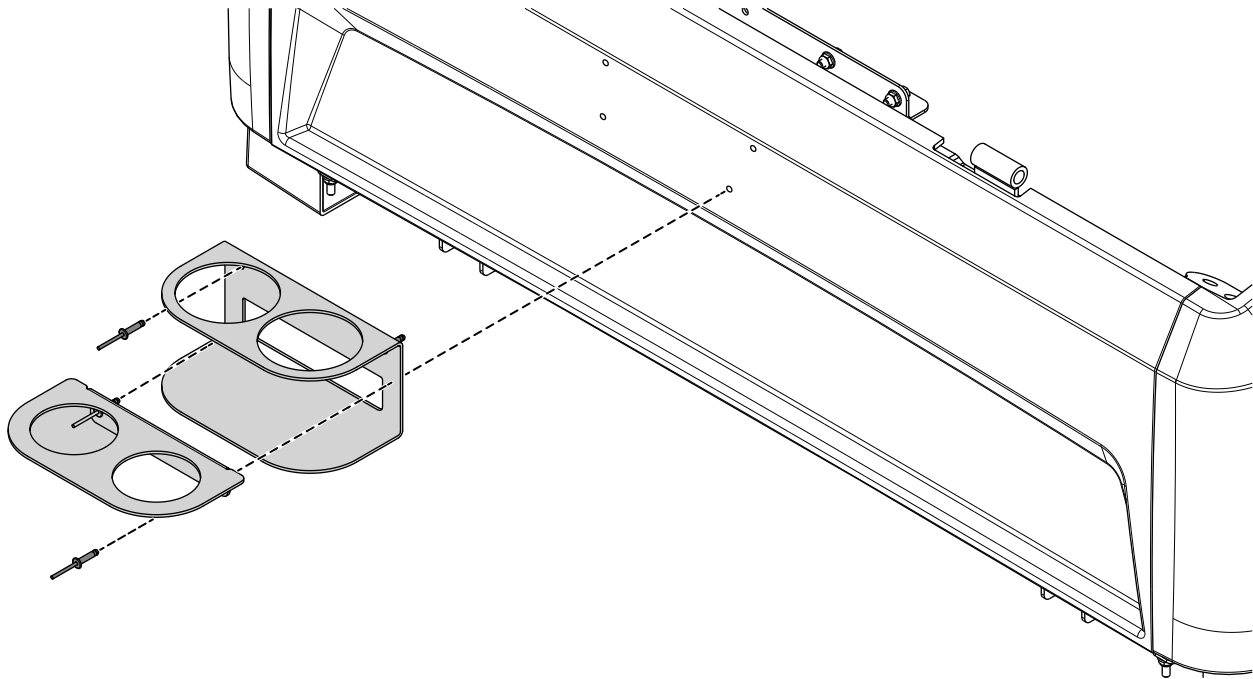

Figure 5

g196482

Notes:

Notes:



Count on it.