



Cab Mount Kit

Workman® GTX Utility Vehicle with Extended Flatbed

Model No. 133-7198

Installation Instructions

▲ WARNING

CALIFORNIA Proposition 65 Warning

This product contains a chemical or chemicals known to the State of California to cause cancer, birth defects, or reproductive harm.

Determine the left and right sides of the machine from the normal operating position.

Installation

Loose Parts

Use the chart below to verify that all parts have been shipped.

Procedure	Description	Qty.	Use
1	No parts required	–	Prepare the machine.
2	No parts required	–	Disconnect the battery.
3	No parts required	–	Remove the seat-base panel and supports.
4	Left bracket Right bracket Bolt (3/8 x 1 inch) Bolt (5/16 x 1 inch) Nut (3/8 inch) Washer	1 1 8 2 8 2	Install the brackets.
5	Cab kit (sold separately)	1	Install the cab kit.
6	Wire harness	1	Install the wire harness.
7	No parts required	–	Connect the battery.



1

Preparing the Machine

No Parts Required

Procedure

1. Park the machine on a level surface.
2. Engage the parking brake.
3. Shut off the engine and remove the key from the key switch.

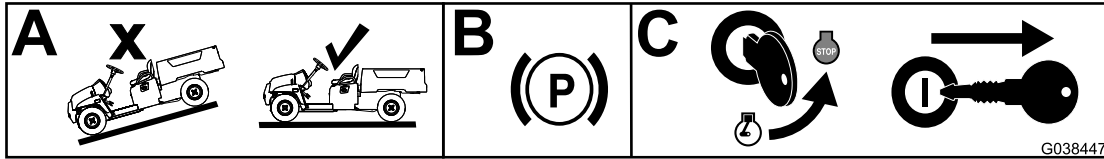

Figure 1

g038447

2

Disconnecting the Battery.

No Parts Required

Procedure

Disconnect the negative battery cable from the battery; refer to the *Operator's Manual* for the machine.

3

Removing the Rear Seat-Base Panel and Channels

No Parts Required

Procedure

1. Remove the seat assembly; refer to the *Operator's Manual* for the machine.
2. Remove the 5 bolts (#10 x 1/2 inch) and 2 washer-bolt assemblies (Figure 2).

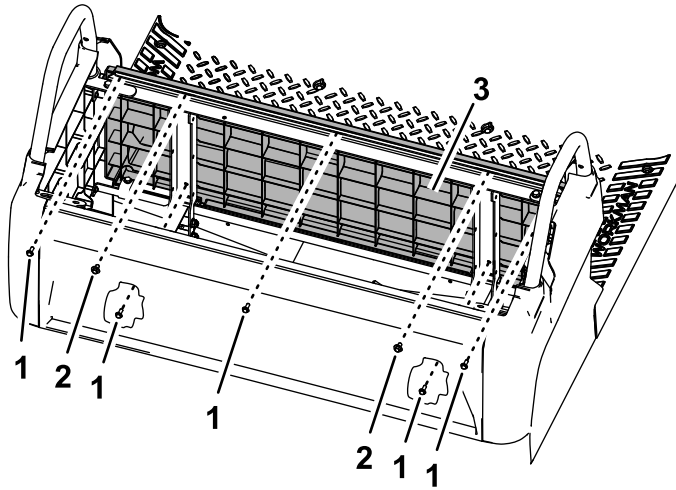

Figure 2

1. Bolt (#10 x 1/2 inch)
2. Washer-bolt assembly
3. Rear seat-base panel

3. Remove the inner bolt (5/16 x 3/4 inch) and nut (5/16 inch) from the left and right rear hip-restraint brackets (Figure 3).

Note: Retain the nuts.

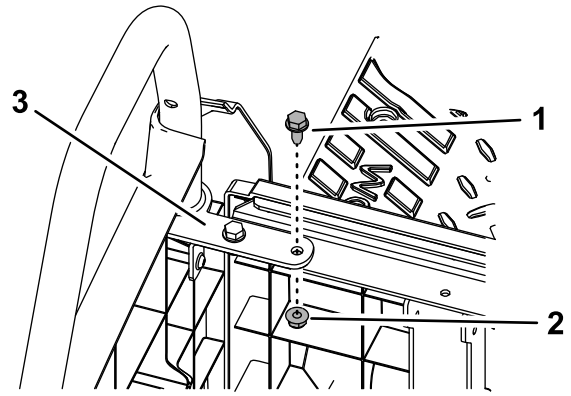

Figure 3

1. Bolt (5/16 x 3/4 inch)
2. Nut (5/16 inch)
3. Right rear hip-restraint bracket

4. Remove and retain the bolt, washer, and nut securing the rear seat-base panel to the floor plate on the left and right sides of the machine (Figure 4).

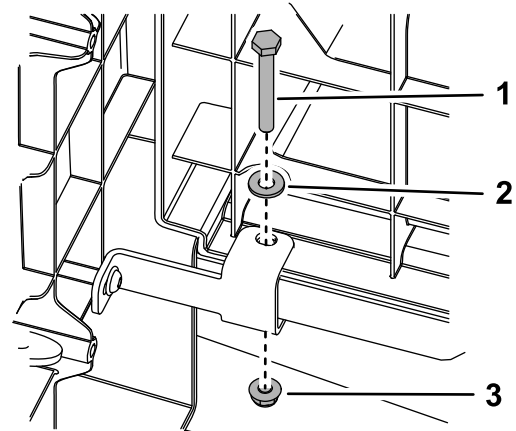

Figure 4

1. Bolt
2. Washer
3. Nut

5. Remove the rear seat-base panel (Figure 2).
6. Remove the 2 bolts (3/8 x 2-1/2 inch), 2 nuts (3/8 inch), and 2 spacers from both rear seat-support channels (Figure 5). Remove the channels.

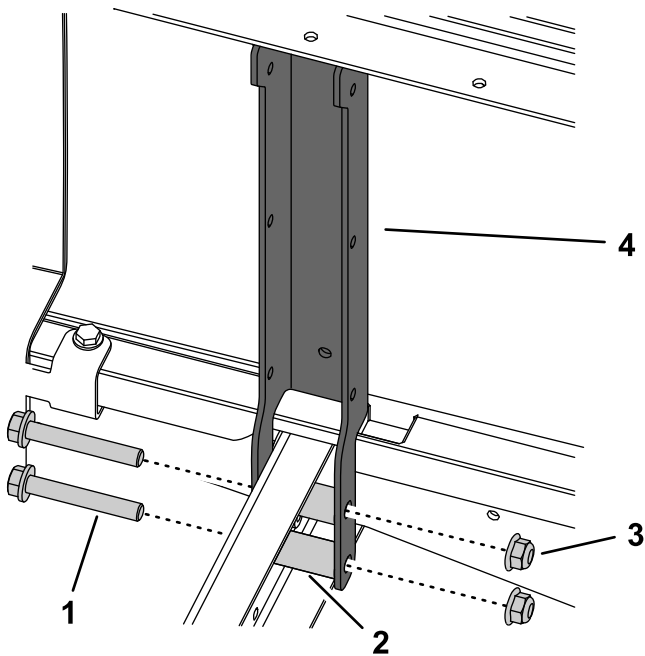

Figure 5

g190656

- | | |
|----------------------------|------------------------------|
| 1. Bolt (3/8 x 2-1/2 inch) | 3. Nut (3/8 inch) |
| 2. Spacer | 4. Rear seat-support channel |

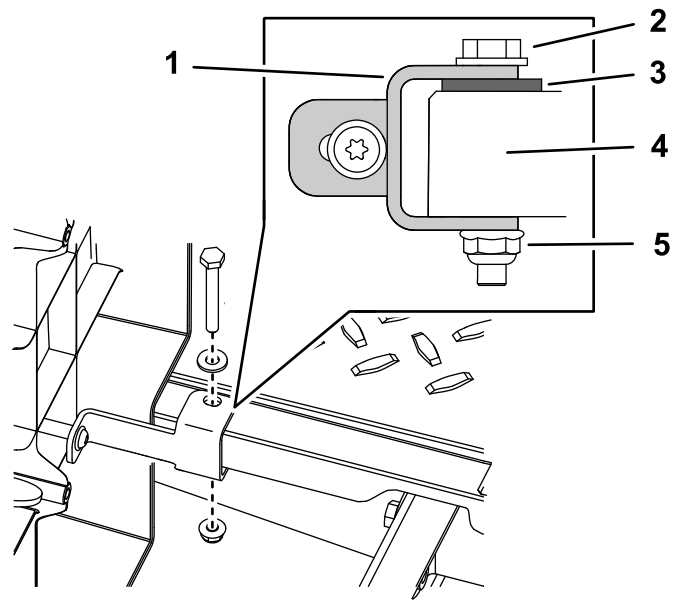

Figure 6

g190838

- | | |
|----------------------|----------------|
| 1. Floor-plate clamp | 4. Floor plate |
| 2. Bolt and washer | 5. Nut |
| 3. Kit washer | |

- Secure the right bracket to the lower frame rail using 2 bolts (3/8 x 1 inch) and 2 nuts (3/8 inch) in the lower, rear holes (Figure 7).

Note: Ensure that the bottom, left edge of the bracket aligns with the frame rail before tightening the bolts.

4

Installing the Brackets

Parts needed for this procedure:

1	Left bracket
1	Right bracket
8	Bolt (3/8 x 1 inch)
2	Bolt (5/16 x 1 inch)
8	Nut (3/8 inch)
2	Washer

Procedure

- Use the bolt, washer, and nut that you removed from the floor plate previously and use them to install the kit washer between the clamp and floor plate (Figure 6). Repeat for the left floor-plate clamp.

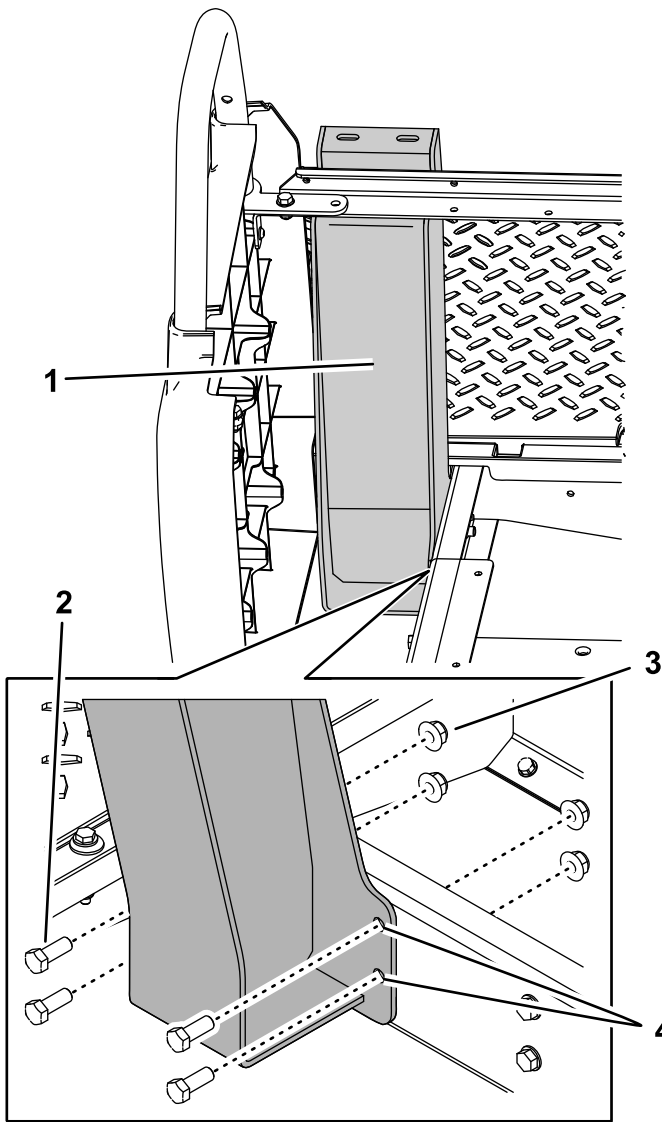

Figure 7

g190769

1. Right bracket
2. Bolt (4)—3/8 x 1 inch
3. Nut (4)—3/8 inch
4. Drill here.

3. Using the bracket as a template, drill 2 holes (25/64 inch diameter) into the lower frame.
4. Secure the bracket using 2 bolts (3/8 x 1 inch) and 2 nuts (3/8 inch) in those holes.
5. Secure the top of the bracket using a kit bolt (5/16 x 1 inch) and a nut (5/16 inch) you retained in step 3 of the previous procedure (Figure 8).

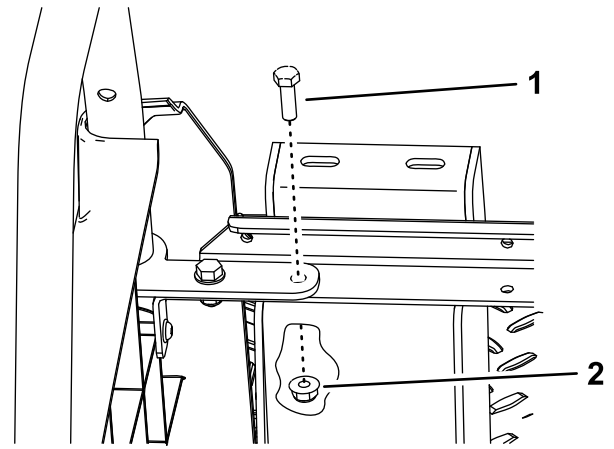

Figure 8

g190770

1. Bolt (5/16 x 1 inch)
2. Nut (5/16 inch)

6. Repeat steps 2 through 5 for the left bracket.
7. Install the seat assembly; refer to the *Operator's Manual* for the machine.

5

Installing the Cab Kit

Parts needed for this procedure:

1	Cab kit (sold separately)
---	---------------------------

Procedure

Refer to the *Installation Instructions* for the cab kit.

6

Installing the Wire Harness

Parts needed for this procedure:

1	Wire harness
---	--------------

For Gasoline Machines

Note: Follow this procedure only if the *Installation Instructions* for your Cab Kit did not include instructions to install a wire harness.

1. Route the wire harness behind the cab and under the seat, and secure the clip on the wire harness to the side panel (Figure 6).

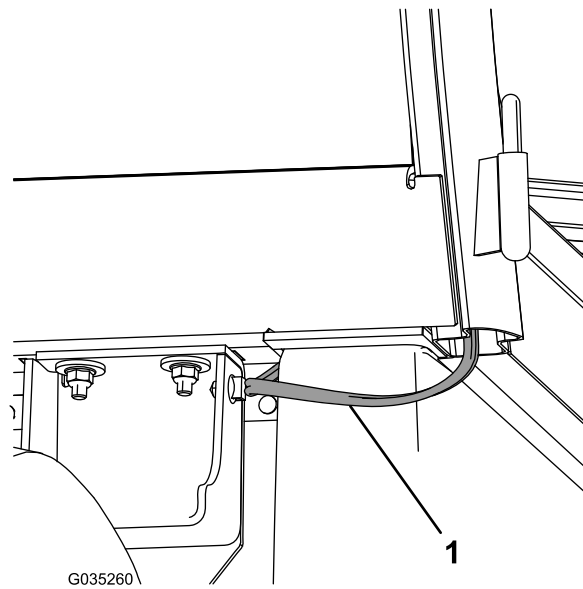

Figure 9

g035260

1. Wire harness

-
2. Install the jumper wire provided with the Cab Extension Kit (Figure 10).
 3. Install the black terminal ring to the ground block on the machine (Figure 10).

Note: The black ground wire is not used.

4. Install the red power wire into an empty slot on the machine fuse block (Figure 10).

Note: Install an additional fuse block if there are no remaining slots open in a fuse block.

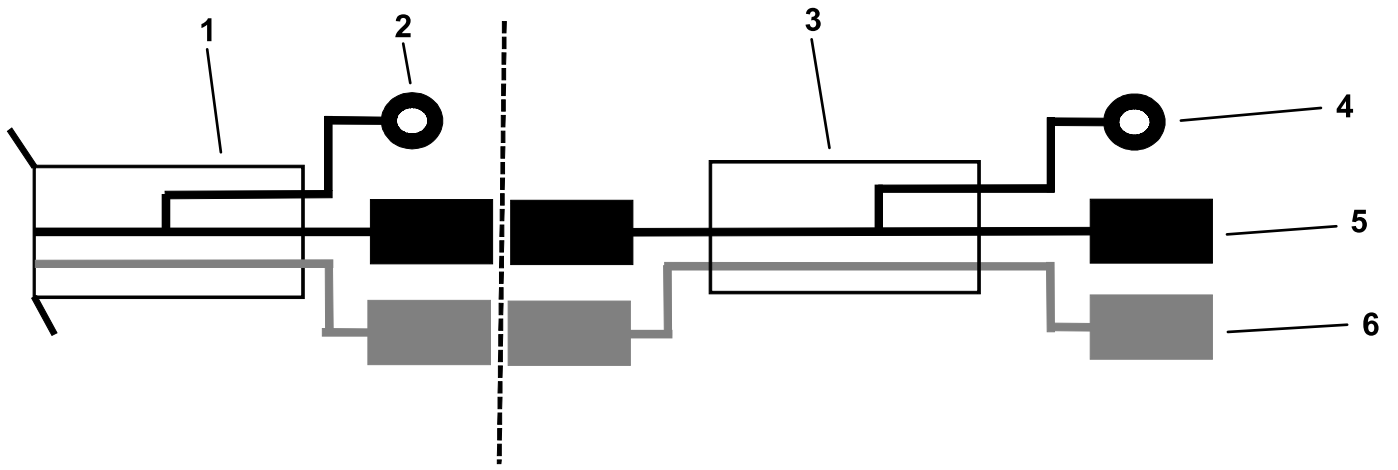

g196913

Figure 10

- | | |
|---|---|
| <ol style="list-style-type: none"> 1. Cab wire harness 2. Black ground wire with terminal ring (not used) 3. Jumper wire | <ol style="list-style-type: none"> 4. Black ground wire with terminal ring 5. Black ground wire with spade terminal (not used) 6. Red power wire with spade terminal |
|---|---|

For Electric Machines

Note: Follow this procedure only if the *Installation Instructions* for your Cab Kit did not include instructions to install a wire harness.

Important: The Power Converter Kit is required to use the cab on a Workman GTX Electric utility vehicle. Contact your authorized Toro dealer for more information.

1. Route the wire harness behind the cab and under the seat, and secure the clip on the wire harness to the side panel (Figure 8).

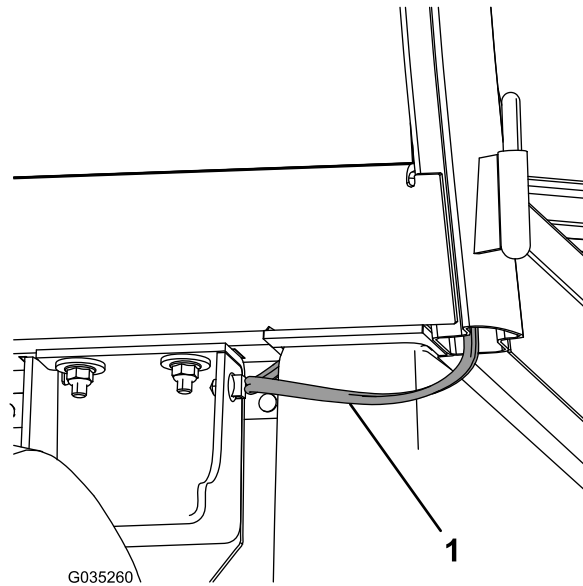

G035260

g035260

Figure 11

1. Wire harness
-
2. Install the jumper wire provided with the Cab Extension Kit (Figure 12).
 3. Install the black ground wire to the ground wire on the Power Converter Kit wire harness (Figure 12).
- Note:** The black terminal ring is not used.
4. Install the red power wire to the power wire on the Power Converter Kit wire harness (Figure 12).

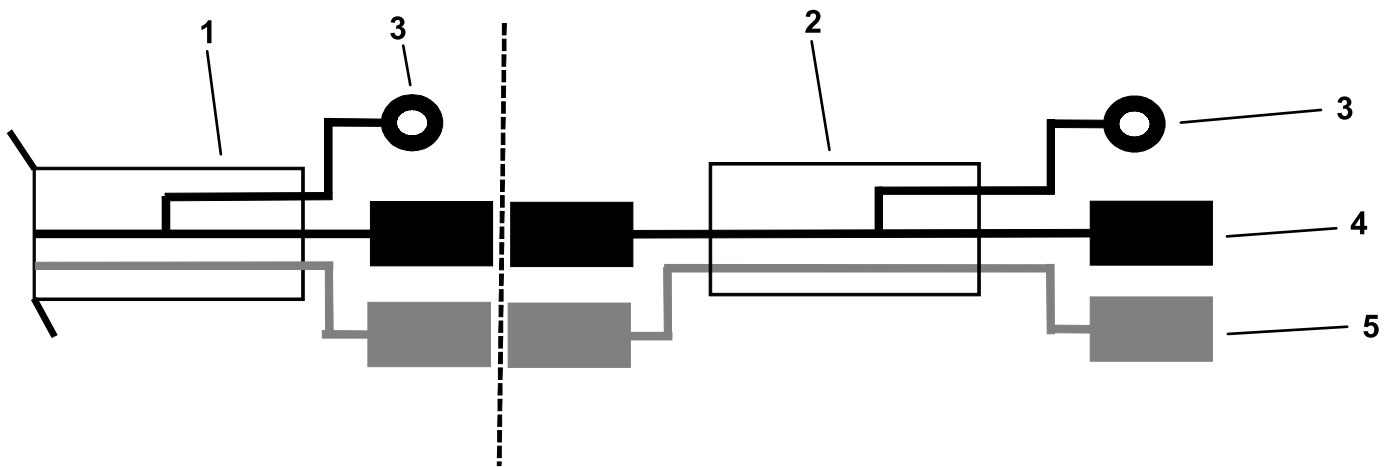

g196912

Figure 12

- | | |
|---|---|
| <ol style="list-style-type: none"> 1. Cab wire harness 2. Jumper wire 3. Black ground wire with terminal ring (not used) | <ol style="list-style-type: none"> 4. Black ground wire with spade terminal 5. Red power wire with spade terminal |
|---|---|

7

Connecting the Battery

No Parts Required

Procedure

Connect the negative battery cable to the battery; refer to the *Operator's Manual* for the machine.