



Handle Kit for 22in Recycler® Lawn Mower

Model No. 20337HD—Serial No. 400000000 and Up

Form No. 3415-227 Rev A

Installation Instructions

⚠ WARNING

CALIFORNIA Proposition 65 Warning

This product contains a chemical or chemicals known to the State of California to cause cancer, birth defects, or reproductive harm.

Installation

Loose Parts

Use the chart below to verify that all parts have been shipped.

Description	Qty.	Use
Bracket	2	Install the brackets.

Installing the Brackets

1. Shut off the engine and secure the machine from movement.
2. On the lower, left side of the handle, remove the shoulder bolt, nut, knob, and carriage bolt (Figure 1). Discard the shoulder bolt.

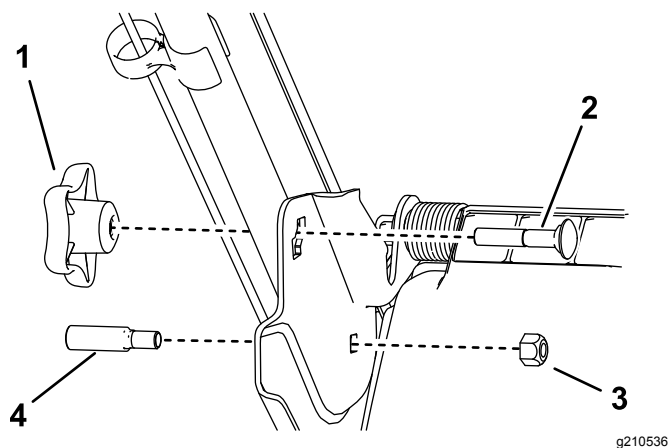

Figure 1

- | | |
|------------------|------------------|
| 1. Knob | 3. Nut |
| 2. Carriage bolt | 4. Shoulder bolt |

3. Place 1 bracket on the handle and secure the handle to the machine using the knob, carriage bolt, and nut (Figure 2).

Note: The welded post on the bracket replaces the shoulder bolt that you removed.

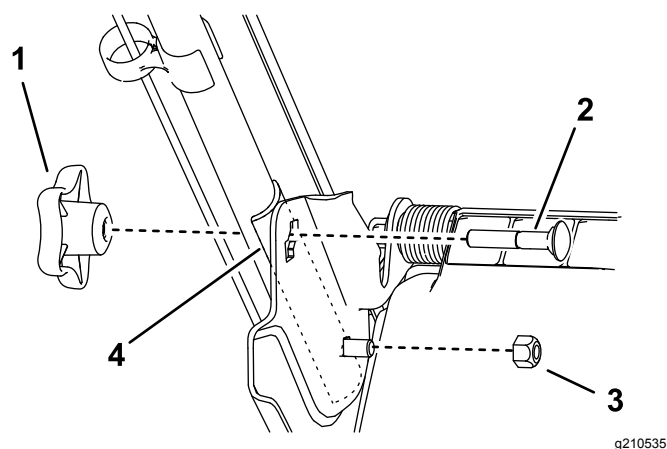

Figure 2

- | | |
|------------------|-----------------|
| 1. Knob | 3. Nut |
| 2. Carriage bolt | 4. Left bracket |

4. Repeat the procedure with the other bracket for the right side of the handle.

