

# Jack Mount Kit

## Zero-Turn Radius Riding Mower

Model No. 136-9200

### Installation Instructions

## Safety

### ⚠ WARNING

#### CALIFORNIA Proposition 65 Warning

This product contains a chemical or chemicals known to the State of California to cause cancer, birth defects, or reproductive harm.

### ⚠ WARNING

The machine could fall onto someone and cause serious injury or death.

- Read and understand the *Operator's Manual* before performing maintenance.
- Always park the machine on a level surface, engage the parking brake, shut off the engine, and remove the key before performing any maintenance to the machine.
- Do not keep the machine raised on the jack for extended periods of time.
- Always use a jack on a level surface.
- Ensure that the jack is secured properly to the mount.
- The jack mount and jack are intended for use with the machine as described in these instructions; other uses may cause unseen damage or failure of the jack.
- Do not rely solely on the jack for support. Use adequate jack stands or equivalent support.
- Do not mount or dismount the machine while the jack is raised.
- Prior to each use, inspect the jack and mount kit for proper working function and no visible signs of damage.

## Safety and Instructional Decals



Safety decals and instructions are easily visible to the operator and are located near any area of potential danger. Replace any decal that is damaged or missing.

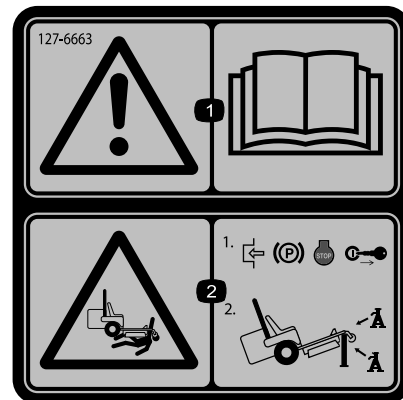

decal127-6663

127-6663

1. Warning—read the *Operator's Manual*.
2. Crushing hazard—1) Engage the parking brake, shut off the engine, and remove the key; 2) Jack the machine using a manufacturer-approved jack, and always use a jackstand.



# Installation

## 1

### Preparing the Machine

No Parts Required

#### Procedure

1. Park the machine on a level surface.
2. Disengage the blade-control switch, engage the parking brake, and move the motion-control levers outward to the NEUTRAL-LOCK position.
3. Shut off the engine and remove the key.

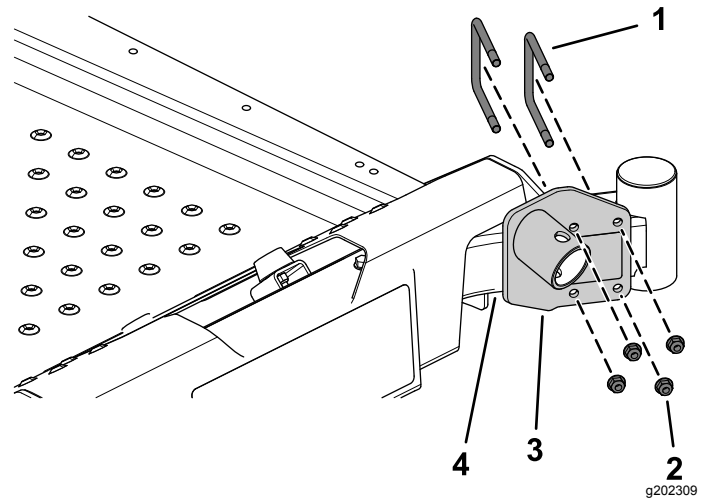

Figure 1

- |                           |                        |
|---------------------------|------------------------|
| 1. U bolt                 | 3. Jack mount assembly |
| 2. Flange nut (5/16 inch) | 4. Front axle tube     |

## 2

### Installing the Jack Mount

Parts needed for this procedure:

1	Jack mount assembly
2	U bolt
4	Flange nut (5/16 inch)

#### Procedure

Install the jack mount assembly to the front axle tube using the 2 U bolts and 4 flange nuts (5/16 inch) as shown in [Figure 1](#).

## Operation

### Using the Jack Mount

**Important:** Use only a manufacturer-approved jack(s) rated at 907 kg (2,000 lb) or higher lift capacity with the jack mount.

1. Park the machine on a level surface.
2. Disengage the blade-control switch, engage the parking brake, and move the motion-control levers outward to the NEUTRAL-LOCK position.
3. Shut off the engine and remove the key.
4. Raise the mower deck to the transport position.
5. Insert the jack tube into the jack mount, align the mounting holes, and secure the jack with the jack pin ([Figure 2](#)).

**Note:** The jack is not supplied with this kit.

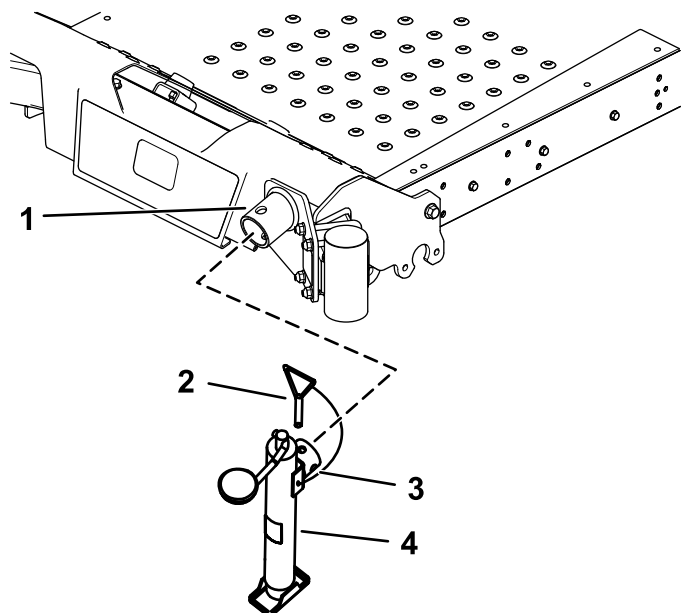

g202641

**Figure 2**

- |                    |                                     |
|--------------------|-------------------------------------|
| 1. Jack-mount tube | 3. Jack tube                        |
| 2. Jack pin        | 4. Jack (not supplied with the kit) |

6. Rotate the handle on the jack to raise the machine to the desired height.

**Note:** Do not over extend the jack.

### **⚠ WARNING**

**Raising the machine could cause fuel leakage.**

- **Check for any fuel leakage before performing maintenance.**
- **If leakage occurs, immediately lower the machine and drain the fuel to eliminate the hazard.**

7. Lower the machine onto jack stands or an equivalent support.
8. Perform the maintenance procedure.
9. When the maintenance is completed, remove the jack stands or equivalent support.
10. Rotate the handle on the jack to lower the machine.
11. Remove and store the jack.

**Note:** The machine is not designed to store the jack when it is not being used. Do not drive the machine with a jack installed.

