

TURF TRACER® X-SERIES

**To Fit Turf Tracer® X-Series "N0" Models
402,082,300 & Higher**
Part No. 4503-489 Rev. A

Operator's Manual

⚠ WARNING

**CALIFORNIA
Proposition 65 Warning**

**This product contains a chemical
or chemicals known to the State of
California to cause cancer, birth defects,
or reproductive harm.**

Exmark reserves the right to make changes or add improvements to its products at any time without incurring any obligation to make such changes to products manufactured previously. Exmark, or its distributors and dealers, accept no responsibility for variations which may be evident in the actual specifications of its products and the statements and descriptions contained in this publication.



If your Exmark dealer does not have the Exmark part in stock, Exmark will get the parts to the dealer the next business day or the part will be FREE Guaranteed!! (Some restrictions apply. See your participating Exmark Dealer for details.)

Introduction

CONGRATULATIONS on the purchase of your Exmark StandOn. This product has been carefully designed and manufactured to give you a maximum amount of dependability and years of trouble-free operation.

This manual contains operating, maintenance, adjustment, and safety instructions for your Exmark StandOn.

BEFORE OPERATING YOUR STANDON, CAREFULLY READ THIS MANUAL IN ITS ENTIRETY.

By following the operating, maintenance, and safety instructions, you will prolong the life of your StandOn, maintain its maximum efficiency, and promote safe operation.

Important: To maximize safety, performance, and proper operation of this machine, it is essential that all operators carefully read and fully understand the contents of the Operator's manual provided with the product. Safe operation of Exmark equipment is essential. Failure to comply with the operating instructions or receive proper training may result in injury.

Go to <http://www.Exmark.com> for additional safe operation information, such as safety tips, training materials, and Operator's manuals.

If additional information is needed, or should you require trained mechanic service, contact your authorized Exmark equipment dealer or distributor.

All Exmark equipment dealers and distributors are kept informed of the latest methods of servicing and are equipped to provide prompt and efficient service in the field or at their service stations. They carry ample stock of service parts or can secure them promptly for you from the factory.

All Exmark parts are thoroughly tested and inspected before leaving the factory, however, attention is required on your part if you are to obtain the fullest measure of satisfaction and performance.

Whenever you need service, genuine Exmark parts, or additional information, contact an Authorized Service Dealer or Exmark Customer Service and have the model and serial numbers of your product ready.

Contents

Introduction	3
Safety	5
Safety Alert Symbol.....	5
Safe Operating Practices	5
Safety and Instructional Decals	7
Specifications	8
Systems	8
Dimensions.....	8
Setup	9
Operation	11
Pre-Start.....	11
Operating Instructions	11
Transporting	11
Maintenance	13
Recommended Maintenance Schedule(s)	13
Periodic Maintenance	13
Inspect StandOn	13
Check StandOn for Buildup.....	13
Lubricate Grease Fittings.....	13
Lubricate Caster Wheel Hubs	13
Adjustments	15
Tire Adjustment	15

Safety

Safety Alert Symbol

This Safety Alert Symbol (Figure 1) is used both in this manual and on the machine to identify important safety messages which must be followed to avoid accidents.

This symbol means: **ATTENTION! BECOME ALERT! YOUR SAFETY IS INVOLVED!**



Figure 1
Safety Alert Symbol

g000502

The safety alert symbol appears above information which alerts you to unsafe actions or situations and will be followed by the word **DANGER**, **WARNING**, or **CAUTION**.

DANGER: Indicates an imminently hazardous situation which, if not avoided, **Will** result in death or serious injury.

WARNING: Indicates a potentially hazardous situation which, if not avoided, **Could** result in death or serious injury.

CAUTION: Indicates a potentially hazardous situation which, if not avoided, **May** result in minor or moderate injury.

This manual uses two other words to highlight information. **Important** calls attention to special mechanical information and **Note** emphasizes general information worthy of special attention.

Safe Operating Practices

Training

- Read the mower and StandOn Operator's Manuals and other training material. If the operator(s) or mechanic(s) can not read the manuals it is the owner's responsibility to explain this material to them; other languages may be available on our website.
- Become familiar with the safe operation of the equipment, operator controls, and safety signs.

- All operators and mechanics should be trained. The owner is responsible for training the users.
- Never let children or untrained people operate or service the equipment. Local regulations may restrict the age of the operator.
- Only adults and mature teenagers should operate the machine, and even mature teenagers should have adult supervision. Be sure a teenager:
 1. has read and understands the Operator's Manual and recognizes the risks involved;
 2. is sufficiently mature to use caution; and
 3. is of sufficient size and weight to operate the controls comfortably and to manage the unit without taking risks.
- The owner/user can prevent and is responsible for accidents or injuries occurring to himself or herself, other people or property.
- Only allow the machine operator on the StandOn.

Preparation

- Do Not modify the StandOn.
- Evaluate the terrain to determine what accessories and attachments are needed to properly and safely perform the job. Only use on machines approved by Exmark.
- Wear appropriate clothing including safety glasses, substantial footwear, and hearing protection.

▲ CAUTION

This machine that the StandOn attaches to produces sound levels in excess of 85 dBA at the operator's ear and can cause hearing loss through extended periods of exposure.

Wear hearing protection when operating this machine.

- Inspect the area where the equipment is to be used and remove all rocks, toys, sticks, wires, bones, and other foreign objects which can be thrown by the machine and may cause personal injury to the operator or bystanders.

Operation

- Operate only in daylight or good artificial light, keeping away from holes and hidden hazards.
- Park machine on level ground. Stop engine, wait for all moving parts to stop, remove key and

Safety

engage parking brake whenever you leave the mower.

Maintenance and Storage

- Disengage drives, set parking brake, stop engine and remove key or disconnect spark plug wire. Wait for all movement to stop before adjusting, cleaning or repairing.
- Keep all guards, shields and all safety devices in place and in safe working condition.
- Check all bolts frequently to maintain proper tightness.
- Frequently check for worn or deteriorating components that could create a hazard.

⚠ WARNING

Removal or modification of original equipment, parts and/or accessories may alter the warranty, controllability, and safety of the machine.

Unauthorized modifications to the original equipment or failure to use original Exmark parts could lead to serious injury or death.

Unauthorized changes to the machine, engine, fuel or venting system, may violate applicable safety standards such as: ANSI, OSHA and NFPA and/or government regulations such as EPA and CARB.

Safety and Instructional Decals

- Keep all safety signs legible. Remove all grease, dirt and debris from safety signs and instructional labels.
- Replace all worn, damaged, or missing safety signs.
- When replacement components are installed, be sure that current safety signs are affixed to the replaced components.
- If an attachment or accessory has been installed, make sure current safety signs are visible.
- New safety signs may be obtained from your authorized Exmark equipment dealer or distributor or from Exmark Mfg. Co. Inc.
- Safety signs may be affixed by peeling off the backing to expose the adhesive surface. Apply only to a clean, dry surface. Smooth to remove any air bubbles.
- Familiarize yourself with the following safety signs and instruction labels. They are critical to the safe operation of your Exmark commercial mower.

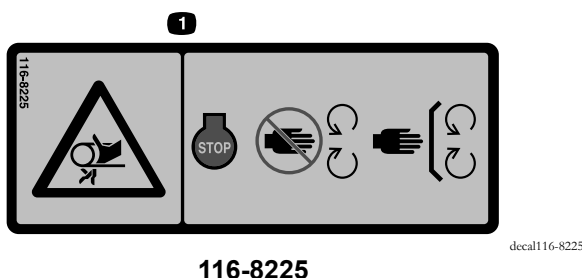

116-8225

1. Entanglement hazard—Stop the engine before reaching underneath; stay away from moving parts; keep all guards in place.

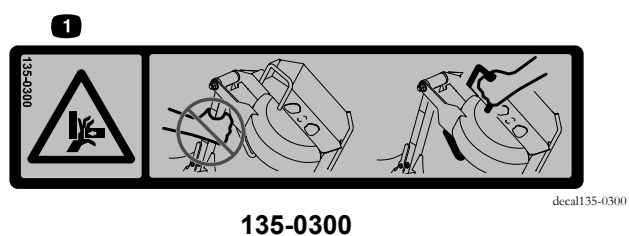

135-0300

1. Pinch point hazard—Do Not use drawbar to lift StandOn. Only use platform side handles to lift and rotate StandOn.

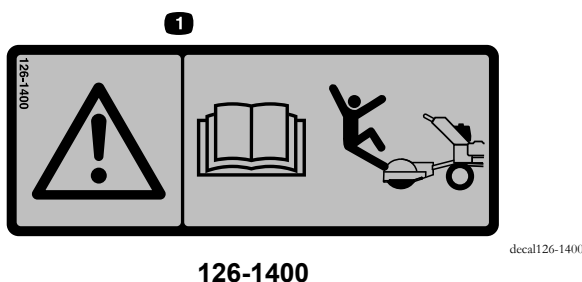

126-1400

1. Warning—Read the Operator's manual. Use only Exmark riding attachments. Use of other riding attachments may create a hazardous condition resulting in injury.

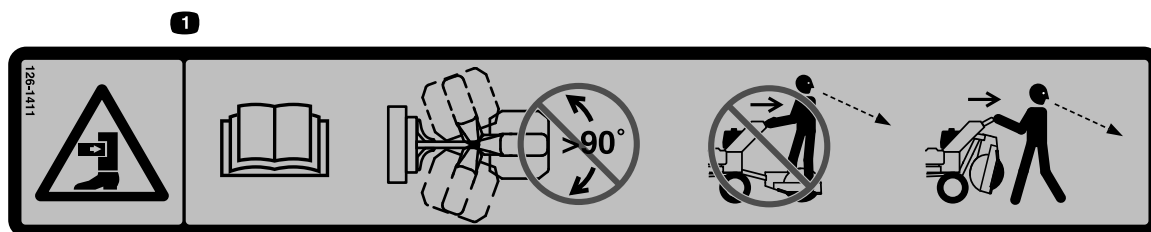

126-1411

1. Crushing hazard of sulky — read the Operator's manual; Do Not allow sulky to rotate beyond 90 degrees; dismount sulky and place in transport position, if available, before operating in reverse.

Specifications

Systems

Tire

	Tread	Size
Semi-Pneumatic	Smooth	11 x 4.00-5

For operators over 250 lb (113 kg), it is recommended to use pneumatic tire assembly P/N 103-3798.

Dimensions

Overall Width:

18.5 inches (47.0 cm)

Overall Length:

35.4 inches (89.9 cm)

Overall Height:

14.6 inches (37.1 cm)

Weight:

50 lb (23 kg)

Setup

Item	Quantity	Description
1	4	Nut, Nyloc 3/8-16 Flg
2	2	Plate, Back-Up
3	1	Pin-Lynch
4	4	Screw, HH 3/8-16 x 1 1/4
5	1	Asm-Mount Plate W/Decals
6	1	Asm-Drawbar W/Brgs and Decal
7	1	Cover-Dust

Item	Quantity	Description
8	1	Screw-HH 1/2-13 x 5
9	1	Nut-Nyloc 1/2-13
10	1	Asm-Sulky Frame W/Decals
11	1	Pin-Pivot
12	2	Washer-Spring Disc
13*	2	Decals-Replacement

*Not shown in illustration

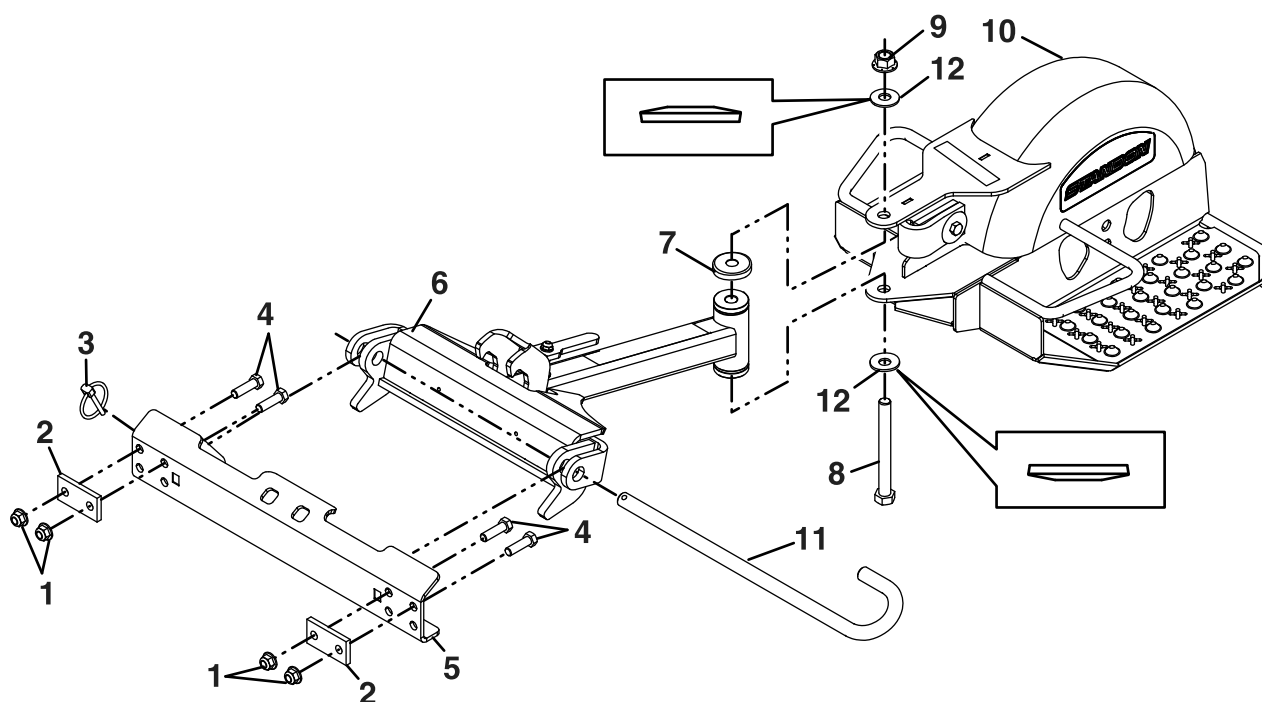

Figure 2

g192307

Setup

Installing the Mount Plate:

Align the mount plate to the rear surface of the engine deck.

Install the mount plate to the engine deck using four 3/8-16 x 1 1/4 inch hex screws, two backup plates, and four 3/8-16 inch nyloc nuts as shown in Figure 3.

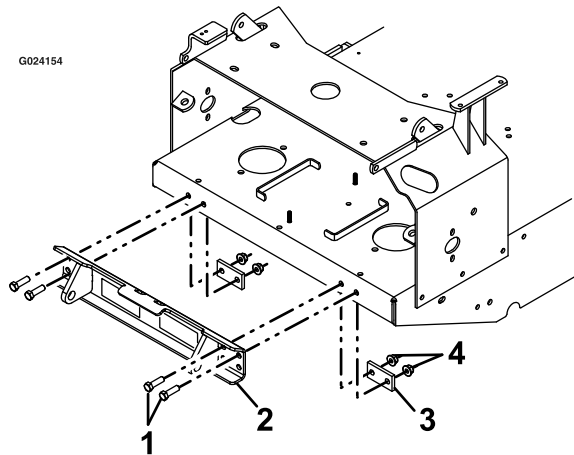

Figure 3

- | | |
|--------------------------------------|---------------------------|
| 1. 3/8-16 x 1 1/4 inch hex capscrews | 3. Backup plates |
| 2. Mount plate | 4. 3/8-16 inch nyloc nuts |

Mounting the Drawbar and Platform

1. Locate the drawbar assembly; remove and retain the 1/2-13 x 5 inch hex screw, spring disc washers, and 1/2 inch hex flanged nyloc nut from the pivot hub.
2. Align the sulky frame assembly with the drawbar assembly. Reinstall the 1/2-13 x 5 inch hex screw, spring disc washers, and 1/2 inch hex flange nyloc nut, removed in step 1, as shown in Figure 4. Torque nut to 90 ft-lb (122 N-m).

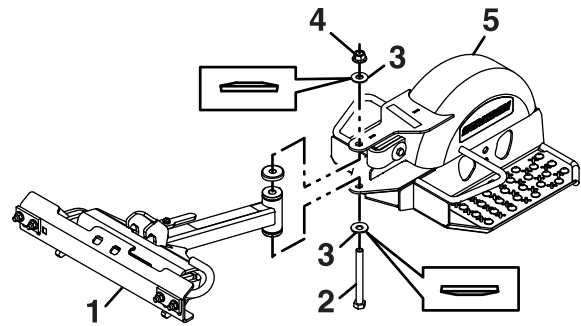

Figure 4

- | | |
|------------------------------|----------------------------------|
| 1. Drawbar assembly | 4. 1/2 inch hex flange nyloc nut |
| 2. 1/2-13 x 5 inch hex screw | 5. Sulky frame assembly |
| 3. Spring disc washers | |

3. Remove the lynch pin and pivot pin from the mount plate. Align the drawbar assembly with the mount plate as shown in Figure 5.

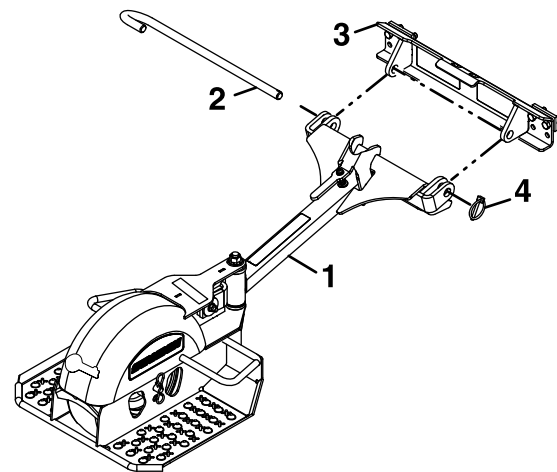

Figure 5

- | | |
|---------------------|----------------|
| 1. Drawbar assembly | 3. Mount plate |
| 2. Pivot pin | 4. Lynch pin |

4. Install the pivot pin through the holes in the drawbar and mount plate and retain with the lynch pin.

Operation

Note: Determine the left and right sides of the machine from the normal operating position.

Pre-Start

1. Make sure you understand the controls, their locations, their functions, and their safety requirements.
2. Practice operating the machine without the StandOn until familiar with the controls.
3. Practice operating the machine with the StandOn attached on large, open, level terrain with no obstacles present before use. The StandOn will affect the machine operation, especially on slopes, when turning, and when stopping.
4. Ensure the drawbar assembly is securely connected to the mount plate.
5. For operators over 250 lb (113 kg), it is recommended to use pneumatic tire assembly, P/N 103-3798.

Operating Instructions

Operating

⚠ DANGER

If the StandOn rotates beyond 90°, there is a potential crushing hazard. Rapid rotation beyond 90° can cause the StandOn to jackknife into the mower engine deck and cause serious injury.

- Dismount the StandOn and place in transport position before operating in reverse.
 - Reduce speed when making sharp turns and operating on slopes.
1. Use care when turning to ensure that you Do Not swing yourself and the sully into obstacles.
 2. When turning, lean forward and toward the direction of the turn to help in keeping balance.

Transporting

Transporting a Unit

Use the platform side handles to lift and rotate the StandOn into transport position when loading a unit on a trailer, unloading a unit from a trailer, or operating in reverse.

Important: Do Not use the drawbar to lift the StandOn.

⚠ CAUTION

Fingers may be pinched when lifting and rotating the platform.

Always use platform side handles to lift and rotate the StandOn.

• Placing into Transport Position:

1. Using one of the platform side handles, slightly lift the StandOn.

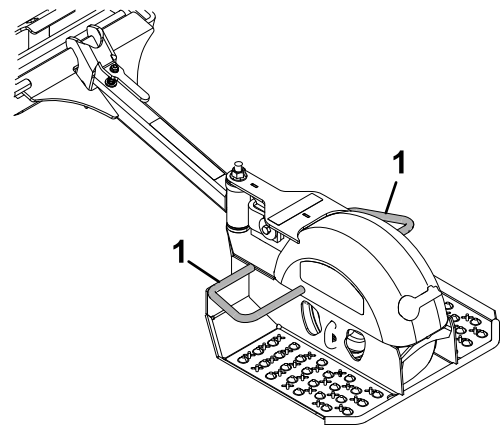

Figure 6

g192304

1. Platform side handles

2. Slowly and carefully rotate the StandOn until it contacts the drawbar (see Figure 7).

If holding the left platform side handle, rotate the StandOn counterclockwise; using the right platform side handle, rotate it clockwise.

Operation

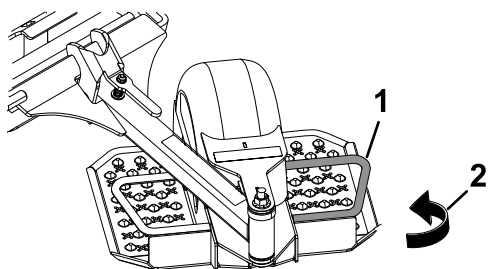

g192306

Figure 7

1. Left platform side handle 2. Rotate counterclockwise
3. Slowly and carefully lift the StandOn until the latch locks into place.

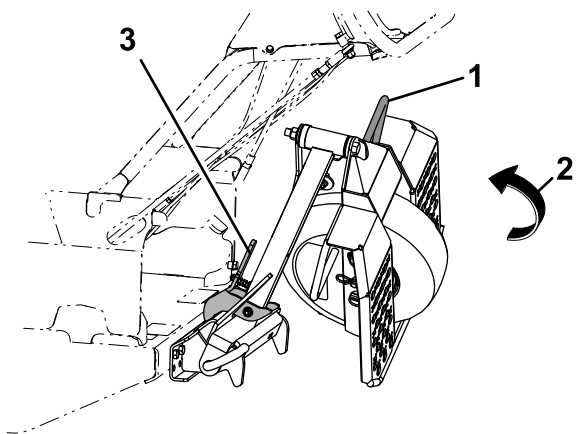

g192305

Figure 8

1. Left platform side handle 3. Latch
2. Lift up

- **Lowering the StandOn into Operating Position:**

1. Firmly hold the platform side handle and lift slightly (reference Figure 8).
2. Squeeze the latch to release the StandOn and slowly and carefully lower it to the ground.

Maintenance

Note: Determine the left and right sides of the machine from the normal operating position.

⚠ WARNING

While maintenance or adjustments are being made, someone could start the engine. Accidental starting of the engine could seriously injure you or other bystanders.

Remove the key from the ignition switch, engage parking brake, and pull the wire(s) off the spark plug(s) before you do any maintenance to the unit or StandOn. Also push the wire(s) aside so it does not accidentally contact the spark plug(s).

Recommended Maintenance Schedule(s)

Maintenance Service Interval	Maintenance Procedure
Before each use or daily	<ul style="list-style-type: none"> Inspect the StandOn. Check for dirt/mud buildup between tire and fender.
Yearly	<ul style="list-style-type: none"> Grease caster wheel hub. Lubricate the caster wheel hubs.

Periodic Maintenance

Inspect StandOn

Service Interval: Before each use or daily

- Stop engine, wait for all moving parts to stop, and remove key. Engage parking brake.
- Inspect for loose hardware. Tighten any loose hardware.
- Inspect for wear or damage daily. Replace or repair worn parts as needed before operating.

Check StandOn for Buildup

Service Interval: Before each use or daily

Check for dirt/mud buildup between tire and fender. Remove buildup before operating.

Lubricate Grease Fittings

Note: See chart for service intervals.

- Stop engine, wait for all moving parts to stop, and remove key. Engage parking brake.
- Lubricate fittings with NGLI grade #2 multi-purpose gun grease.

Refer to the following chart for fitting locations and lubrication schedule.

Lubrication Chart			
Fitting Locations	Initial Pumps	Number of Places	Service Interval
1. Caster Wheel Hub	0	1	Yearly

Lubricate Caster Wheel Hubs

Service Interval: Yearly

- Stop engine, wait for all moving parts to stop, and remove key. Engage parking brake.

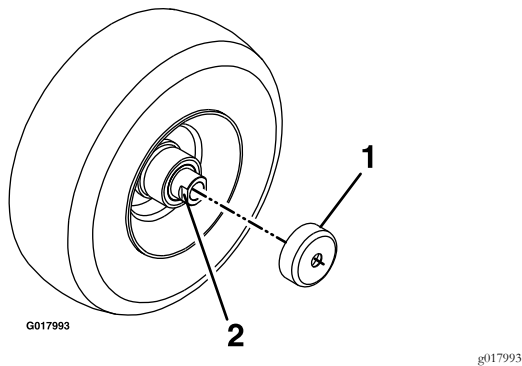

Figure 9

1. Seal guard
2. Spacer nut with wrench flats

13. Torque the nut to 75-80 in-lb (8-9 N-m), loosen, then re-torque to 20-25 in-lb (2-3 N-m). Make sure axle does not extend beyond either nut.
14. Reinstall the seal guards over the wheel hub and insert wheel into the sulky frame. Reinstall caster pin and bow tie cotter pin.

Important: To prevent seal and bearing damage, check the bearing adjustment often. Spin the caster tire. The tire should not spin freely (more than 1 or 2 revolutions) or have any side play. If the wheel spins freely, adjust torque on spacer nut until there is a slight amount of drag. Reapply thread locking adhesive.

2. Remove the caster wheel from the sulky frame.
 3. Remove seal guards from the wheel hub.
 4. Remove one of the spacer nuts from the axle assembly in the caster wheel. Note that thread locking adhesive has been applied to lock the spacer nuts to the axle. Remove the axle (with the other spacer nut still assembled to it) from the wheel assembly.
 5. Pry out seals, and inspect bearings for wear or damage and replace if necessary.
 6. Pack the bearings with a NGLI grade #1 multi-purpose grease.
 7. Insert one bearing, one new seal into the wheel.
- Note:** Seals (Exmark PN 103-0063) must be replaced.
8. If the axle assembly has had both spacer nuts removed (or broken loose), apply a thread locking adhesive to one spacer nut and thread onto the axle with the wrench flats facing outward. Do Not thread spacer nut all of the way onto the end of the axle. Leave approximately 1/8 inch (3 mm) from the outer surface of the spacer nut to the end of the axle inside the nut.
 9. Insert the assembled nut and axle into the wheel on the side of the wheel with the new seal and bearing.
 10. With the open end of the wheel facing up, fill the area inside the wheel around the axle full of NGLI grade #1 multi-purpose grease.
 11. Insert the second bearing and new seal into the wheel.
 12. Apply a thread locking adhesive to the second spacer nut and thread onto the axle with the wrench flats facing outward.

Adjustments

Tire Adjustment

To obtain additional ground clearance, the platform wheel can be repositioned (see Figure 10).

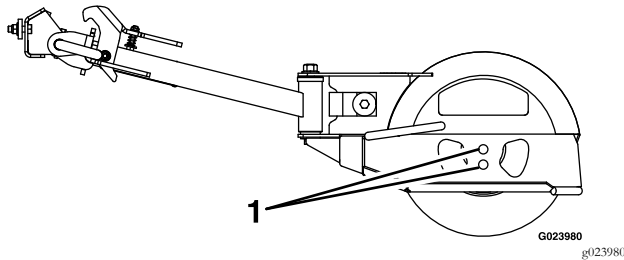

Figure 10

1. Wheel can be mounted in either hole for height adjustment

Note: To achieve more ground clearance for higher cutting heights, raise the platform by using the lower wheel adjustment hole.

EXMARK ACCESSORIES AND OPTIONS*

MID-MOUNT RIDING ACCESSORIES AND OPTIONS

CUSTOM RIDE SEAT SUSPENSION SYSTEM	OPERATOR CONTROLLED DISCHARGE
FULL SUSPENSION SEAT	SUN SHADE
DECK LIFT ASSIST KIT	TRASH CONTAINER
HITCH KIT	TURF STRIPER
LIGHT KIT	ULTRA VAC COLLECTION SYSTEM
12V POWER PORT	ULTRA VAC QUICK DISPOSAL SYSTEM
MICRO-MULCH SYSTEM	

OUT-FRONT RIDING ACCESSORIES AND OPTIONS

CUSTOM RIDE SEAT SUSPENSION SYSTEM	SNOW BLADE
DUAL-TAIL WHEEL	SNOWBLOWER
FLOOR PAN EXTENDER	SUN SHADE
HITCH KIT	TRASH CONTAINER
LIGHT KIT	ULTRA VAC COLLECTION SYSTEM
MICRO-MULCH SYSTEM	ULTRA VAC QUICK DISPOSAL SYSTEM
ROLL OVER PROTECTION SYSTEM (ROPS)	WEATHER CAB

WALK-BEHIND ACCESSORIES AND OPTIONS

GRASS CATCHER	TURF STRIPER
MICRO-MULCH SYSTEM	STANDON

*Some accessories and options not available for some models.

Place Model No. and Serial No.
Label Here (Included in the Literature
Pack) or Fill in Below

Model No. _____

Serial No. _____

Date Purchased _____

©2017 Exmark Mfg. Co., Inc.
Industrial Park Box 808
Beatrice, NE 68310
All Rights Reserved

Part No. 4503-489 Rev. A
(402) 223-6375
Fax (402) 223-5489
Printed in the USA



www.exmark.com