

44 " Snowthrower

MODEL NO. 79366
MODEL NO. 71505006

OPERATOR'S MANUAL ADDENDUM

This document contains additional assembly procedures for installing the snowthrower. Perform these procedures in place of step 1 under Assemble the Frame in the Installation chapter of your Operator's Manual.

Assembling the Frame

1. Slide the frame assembly over the auger housing (Fig. 1).
2. Secure the crank support bracket to the upper left holes in the auger housing and frame assembly, using (2) 3/8" x 1" bolts, (2) 3/8" lock washers, and (2) 3/8" flat washers (Fig.1).
3. Finish securing the union of the auger housing and the frame assembly, using (6) 3/8" x 3/4" bolts and (6) 3/8" lock washers (Fig. 1).

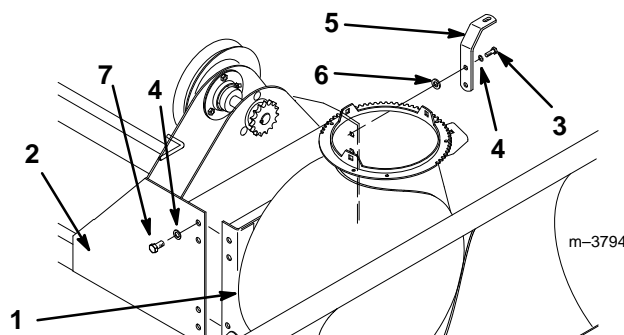

Figure 1

- | | |
|----------------------|--------------------------|
| 1. Auger housing | 5. Crank support bracket |
| 2. Frame assembly | 6. Flat washer, 3/8" |
| 3. Bolt, 3/8" x 1" | 7. Bolt, 3/8" x 3/4" |
| 4. Lock washer, 3/8" | |

Installing the Drive Chain

1. Loosen the bolt securing the idler sprocket (Fig. 2).

Note: Do not let the sprocket fall out of the adjustment slot.

2. Position the chain around the sprockets as shown in Figure 2.
3. Slide the idler sprocket in the adjustment slot until the chain is snug, but not tight (1/8" to 1/2" deflection of the chain in the area indicated in Figure 2) and torque the bolt securing the sprocket to 67 to 83 ft lbs (90.8 to 112.5 Nm).

IMPORTANT: Do not overtighten the chain or excessive wear will occur.

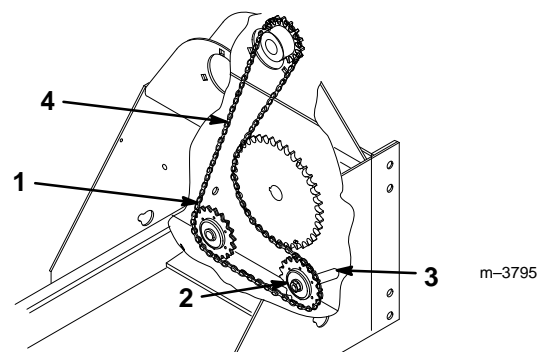

Figure 2

- | | |
|-------------------|-------------------------|
| 1. Drive chain | 3. Adjustment slot |
| 2. Idler sprocket | 4. Test deflection here |

Assembling Support Braces

1. Thread the adjusters into the (2) support braces (Fig. 3).



Figure 3

- | | |
|------------------|-------------|
| 1. Support brace | 2. Adjuster |
|------------------|-------------|