



Seat Hinge Kit

Workman® GTX Utility Vehicle

Model No. 133-7346

Installation Instructions

⚠ WARNING

CALIFORNIA Proposition 65 Warning

This product contains a chemical or chemicals known to the State of California to cause cancer, birth defects, or reproductive harm.

Installation

Loose Parts

Use the chart below to verify that all parts have been shipped.

Procedure	Description	Qty.	Use
1	No parts required	–	Prepare the machine.
2	No parts required	–	Remove the existing seat support.
3	No parts required	–	Remove the existing seat-retainer brackets.
4	No parts required	–	Cut the openings for the seat-hinge brackets.
5	Seat support	1	Install the new seat support.
6	Seat-hinge bracket Screw (1/4 x 1 inch)—for bench seats only	2 4	Install the seat-hinge brackets.
7	No parts required	–	Install the seat assembly.



1

Preparing the Machine

No Parts Required

Procedure

1. Park the machine on a level surface.
2. Engage the parking brake.
3. Shut off the engine and remove the key.

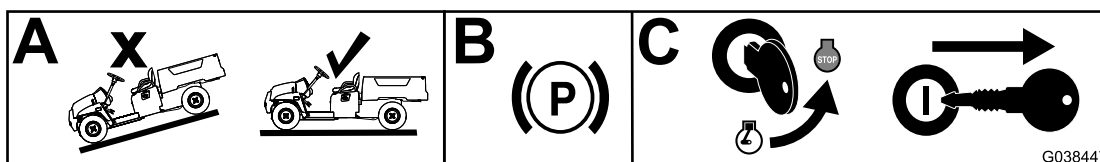

Figure 1

g038447

2

Removing the Existing Seat Support

No Parts Required

Procedure

1. Remove the 3 flange bolts (5/16 x 3/4 inch) and 3 flange nuts (5/16 inch) from the right handhold, and remove the right handhold (Figure 2).

Note: Retain the handhold and fasteners.

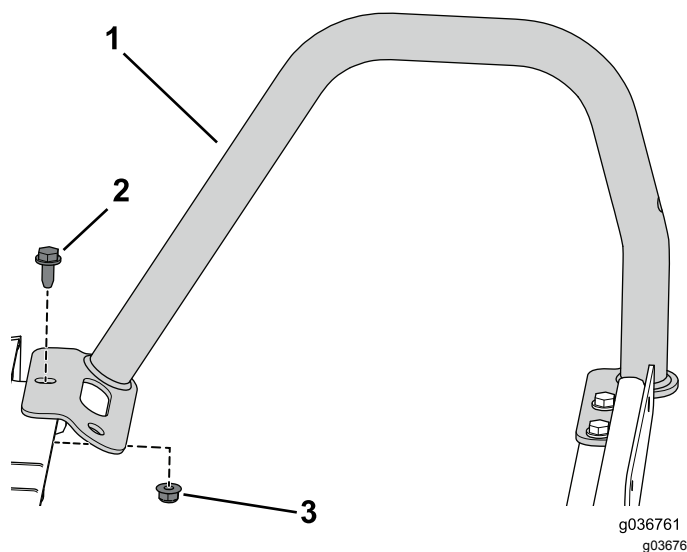

Figure 2

g036761
g036761

1. Right handhold
 2. Flange bolt (5/16 x 3/4 inch)
 3. Flange nut (5/16 inch)
2. Remove front flange bolt (5/16 x 3/4 inch) and flange nut (5/16 inch) from the left handhold, but do not remove the left handhold.

3. Remove the 3 screws (#10 x 1/2 inch), 2 bolts with washer assemblies (1/4 x 1/2 inch), and 2 torx-head screws securing the existing seat support (Figure 3).

Note: Retain the fasteners.

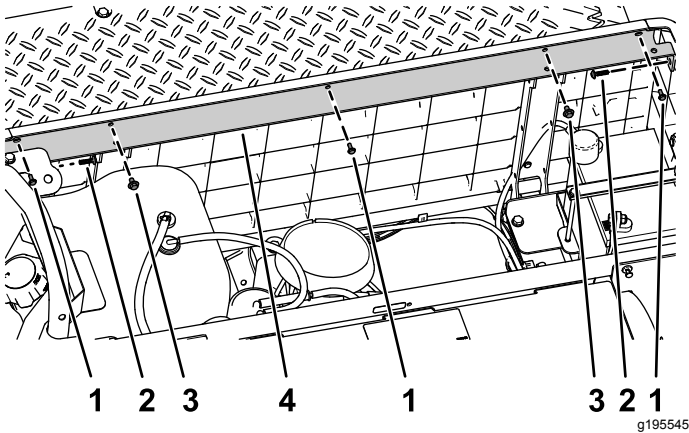

Figure 3

- | | |
|----------------------------|---|
| 1. Screws (#10 x 1/2 inch) | 3. Bolt with washer assemblies (1/4 x 1/2 inch) |
| 2. Torx-head screws | 4. Existing seat support |

4. Remove the existing seat support (Figure 3).

Note: Discard the seat support.

3

Removing the Existing Seat-Retainer Brackets

No Parts Required

Procedure

1. Remove the 4 torx-head screws from the seat-retainer brackets, and the 2 flange-head bolts and 2 washers closest to each bracket (Figure 4).

Note: Retain the fasteners.

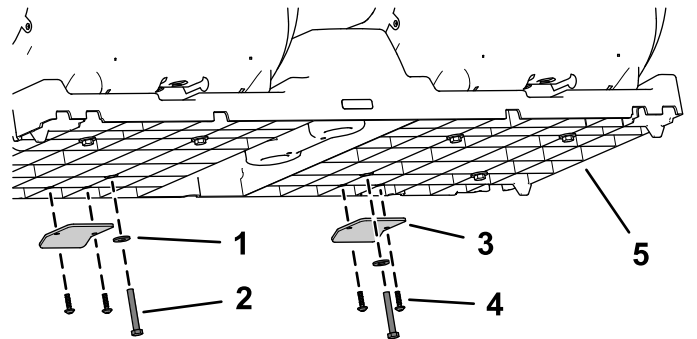

Figure 4

- | | |
|-----------------------------------|-----------------------|
| 1. Washer | 4. Torx-head screw |
| 2. Flange-head bolt | 5. Seat-base assembly |
| 3. Existing seat-retainer bracket | |

2. Remove the 2 seat-retainer brackets from the seat-base assembly (Figure 4).

Note: Discard the seat-retainer brackets.

4

Cutting the Openings for the Seat-Hinge Brackets

No Parts Required

Procedure

⚠ CAUTION

Using a utility knife improperly could cause personal injury.

- When cutting, keep your body away from the path of the blade.
 - Use a sharp blade.
1. Measuring left to right, measure 22.1 cm (8-11/16 inches) from the edge of the seat-base panel, and mark this spot (Figure 5).
 2. Measure 11.7 mm (7/16 inch) from the top edge of the seat-base panel (toward you), and mark this spot (Figure 5).
 3. Measure 8.9 cm (3-1/2 inches) from the marked spot, and mark this spot (Figure 5).
 4. Measure 11.7 mm (7/16 inch) from the top edge of the seat-base panel (toward you), and mark this spot (Figure 5).
 5. Cut out the opening for the first seat-hinge bracket.
 6. Measure 40.8 cm (16-1/16 inches) from the opening, and marking this spot (Figure 5).
 7. Measure 11.7 mm (7/16 inch) from the top edge of the seat-base panel (toward you), and mark this spot (Figure 5).
 8. Measure 8.25 cm (3-1/4 inches) from the marked spot, and mark this spot (Figure 5).
 9. Measure 11.7 mm (7/16 inch) from the top edge of the seat-base panel (toward you), and mark this spot (Figure 5).
 10. Cut out the opening for the second seat-hinge bracket.

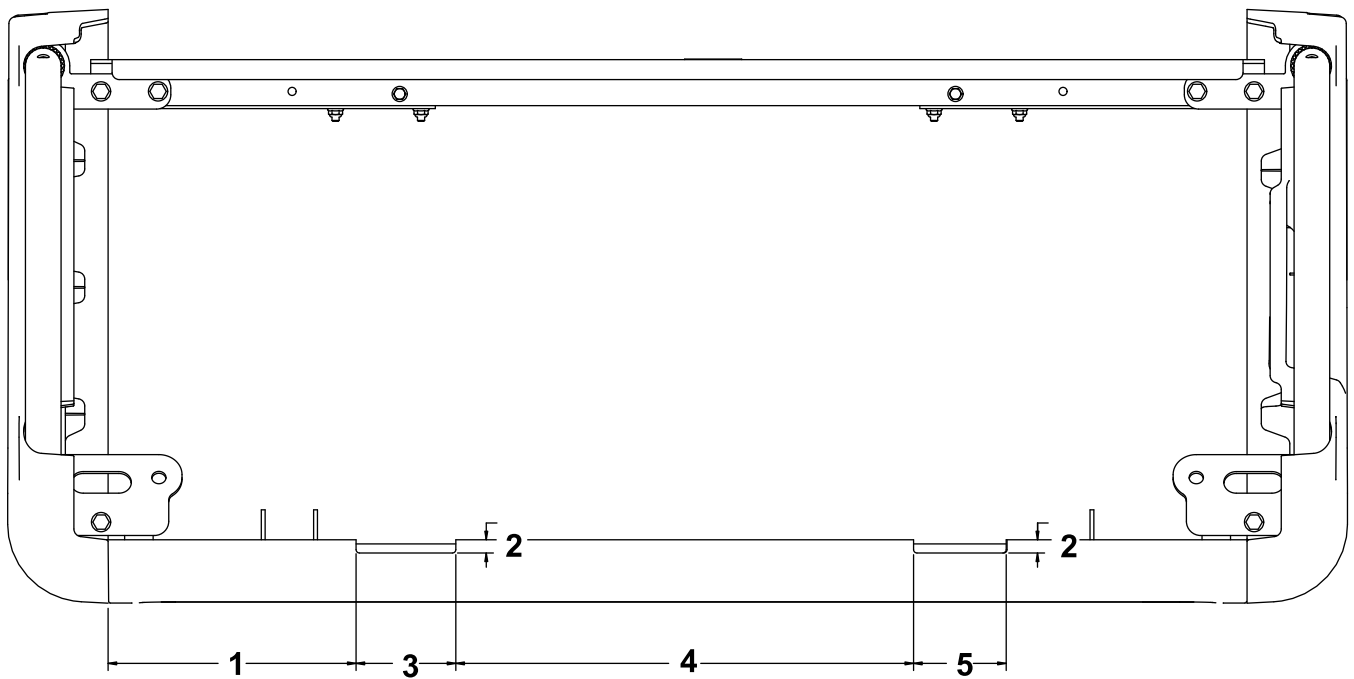

g195596

Figure 5

- | | |
|-----------------------------|-----------------------------|
| 1. 22.1 cm (8-11/16 inches) | 4. 40.8 cm (16-1/16 inches) |
| 2. 11.7 mm (7/16 inch) | 5. 8.25 cm (3-1/4 inches) |
| 3. 8.9 cm (3-1/2 inches) | |

5

Installing the New Seat Support

Parts needed for this procedure:

1	Seat support
---	--------------

Procedure

1. Install the new seat support using the previously removed 3 screws (#10 x 1/2 inch), 2 bolt with washer assemblies (1/4 x 1/2 inch), and 2 torx-head screws ([Figure 6](#)).

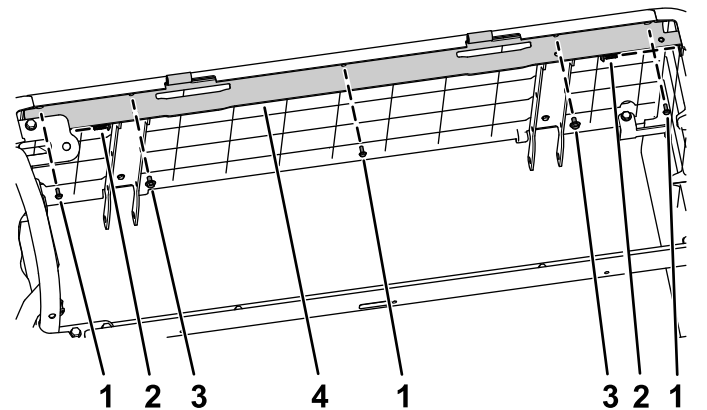

g195742

Figure 6

- | | |
|----------------------------|---|
| 1. Screws (#10 x 1/2 inch) | 3. Bolt with washer assemblies (1/4 x 1/2 inch) |
| 2. Torx-head screws | 4. New seat support |
2. Install the previously removed right handhold using the previously removed 3 flange bolts (5/16 x 3/4 inch) and 3 flange nuts (5/16 inch) as shown in [Figure 7](#).
Torque the 3 flange nuts (5/16 inch) to 23 to 26 N·m (200 to 230 in-lb).

6

Installing the Seat-Hinge Brackets

Parts needed for this procedure:

2	Seat-hinge bracket
4	Screw (1/4 x 1 inch)—for bench seats only

Procedure

Important: If necessary, use the supplied 4 screws (1/4 x 1 inch) on a bench seat only.

1. Install the 2 seat-hinge brackets onto the seat-base assembly using the previously removed 4 torx-head screws, 2 flange-head bolts, and 2 washers (Figure 8).

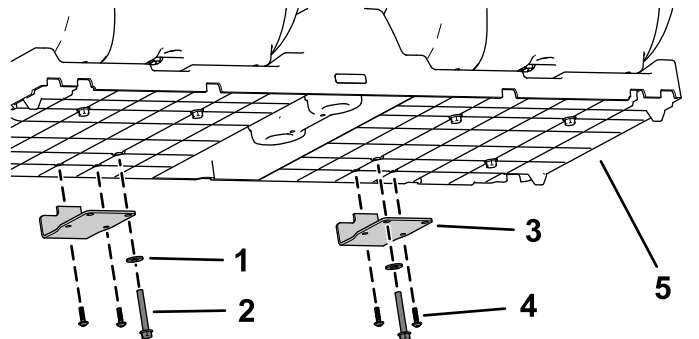

Figure 8

1. Washer
2. Flange-head bolt
3. New seat-hinge bracket
4. Torx-head screw
5. Seat-base assembly

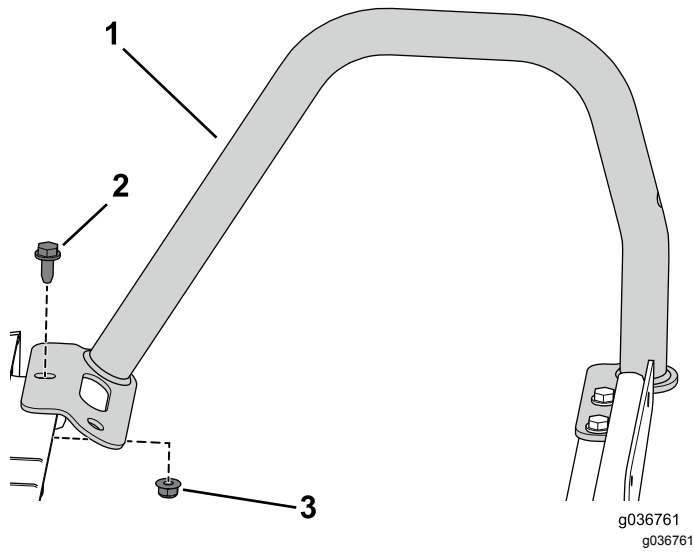

Figure 7

1. Right handhold
 2. Flange bolt (5/16 x 3/4 inch)
 3. Flange nut (5/16 inch)
3. Secure the front of the left handhold using the previously removed flange bolt (5/16 x 3/4 inch) and flange nut (5/16 inch).
- Torque the flange nut (5/16 inch) to 23 to 26 N·m (200 to 230 in-lb).

7

Installing the Seat Assembly

No Parts Required

Procedure

Slide the seat assembly onto the pins and lower the seat assembly ([Figure 9](#)).

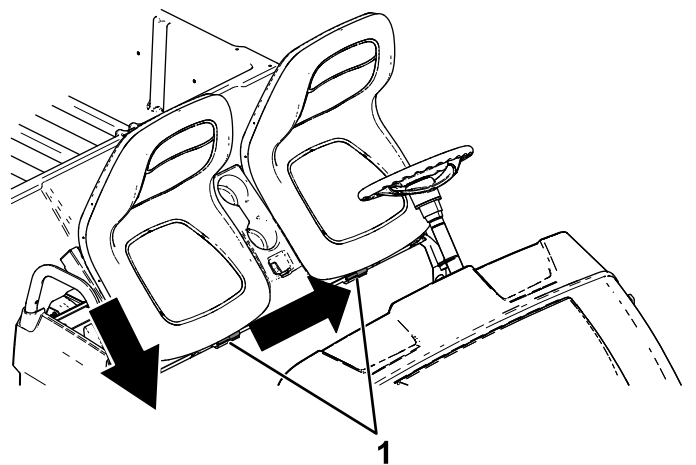

Figure 9

g190186

1. Pins



Count on it.