

TORO®

MODEL NO. 52202 39000001 & up

INSTALLATION GUIDE

Accent Lights™

The most important part of installing the fixtures is making sure their metal pins pierce the wire inside the cable:



Correct
Piercing
Points

Misaligned
Piercing
Points



You'll know they're well-aligned and the wire was pierced when the light comes on.

IMPORTANT: To ensure your power pack isn't overloaded, use a replacement bulb with the same wattage as the original bulb. Maximum wattage allowed for this fixture is 12 watts.



WARNING

! Possible Burns !

Do not attempt to remove any bulbs while the fixtures are on or you may be burned.

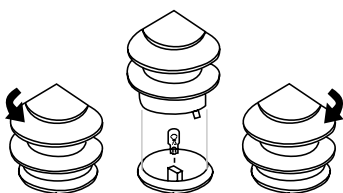

1. Install the light bulb.

Turn the fixture's ring and lens assembly counterclockwise while holding the base stationary. Lift the assembly off the base.

Install the new bulb by pushing it straight down into the socket.

Replace the ring and lens assembly and turn it clockwise to click it into place.

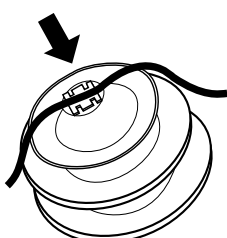

2. Attach the electrical cable to the fixture.

Make sure the brass piercing points in the cable channel at the base of the fixture **are straight**. Place the electrical cable over the piercing points and press the cable down **firmly**. (It may help to use something with a hard, flat surface to press the wire into the piercing points.) If you have done this correctly, the fixture will light. If it doesn't, make sure the power pack is on (and the photocell is covered to block light), the piercing points **are straight**, and try again. You can reposition the cable; the earlier holes created by the piercing points will self-seal and not cause a hazard.

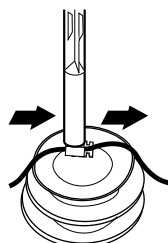

3. Attach the stake to the fixture.

Slide the closed stake onto the fixture base, locking the cable against the contacts (follow the arrow direction on the fixture).



4. Run the cable through the stake.

Open the stake by pinching the locking tabs together.

Fold the cable into each side of the stake. Align the cable with the notches at the bottom of the stake and snap the stake closed.

5. Put the stake into the ground.

Make a hole in the ground for the stake. Don't push the stake into the ground without making a hole first because the stake could be damaged. Insert the stake, fill around it with dirt. Do not hammer or press on the lamp fixture assembly.

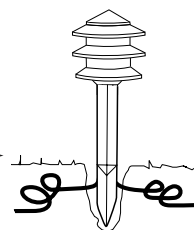

Removing Accent™ Light rings.

The Toro Accent™ Light fixture can provide additional light output if you remove the fixture's middle ring.

1. Turn the fixture ring and lens assembly counterclockwise while holding the base stationary. Lift the assembly off its base.
2. Remove the top cap and top ring.
3. Remove the middle ring by pressing very firmly at one point to lift the ring over the lip. Keep pushing the ring up until it is free.
4. Replace the top ring and top cap.

