



48" SNOW BLADE ADAPTER KIT

to mount 79251 blade to 260 series

PART NO. 92-6828

**INSTALLATION
INSTRUCTIONS**

This adapter kit contains parts and instructions to mount 48" snow blade (Model 79251) onto 260 series Yard Tractors.

Note: When using a previously installed 48" snow blade (Model 79251) the front hitch assembly, rear latch levers, front wheel spindle stops and mounting hardware must be removed from the previous tractor and re-used.

When 48" snow blade (Model 79251) is mounted onto 260 series Yard Tractors follow these instructions to install different rear mount onto the tractor and to replace the handle assembly and index plate on the blade, not those in the Installation Instructions. Follow the Snow Blade Installation Instructions for other assembly and mounting instructions.

Loose Parts

Note: Use the chart below to verify all parts have been shipped.

DESCRIPTION	QTY.	USE
Rear Mounting Plate	1	Rear hitch mounting.
Blade Bracket	1	
Bolt	5	
Nut	5	
Index Lever Assembly	1	Replace index lever.
Cable Assembly	1	
Index Plate	1	

Tractor Set-Up

1. Remove E-ring and all except one thick washer from tractor front axle pivot pin. Discard unused washers. (Fig. 1).
2. Install 3/8 x 1 carriage bolts into keyhole slots in axle bracket and place front hitch onto the tractor securing with lock nuts and previously removed E-ring (Fig. 1).

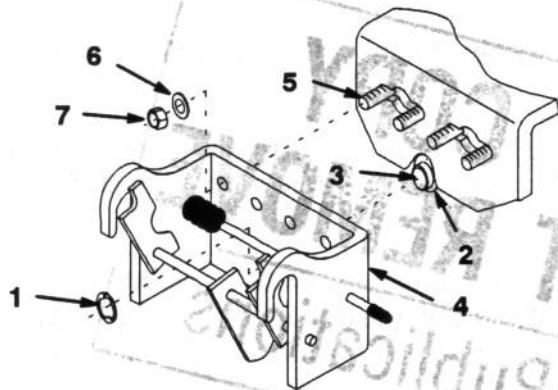

Figure 1

- | | |
|-----------------|------------------|
| 1. E-ring | 5. Carriage bolt |
| 2. Thick Washer | 6. Washer |
| 3. Axle pivot | 7. Lock nut |
| 4. Front hitch | |

3. Assemble rear mounting plate and blade bracket with bolts (heads toward the rear) and lock nuts through holes in vertical plates (Fig. 2).
4. For blade use latch levers must be installed onto the blade bracket (Fig. 2). Install latch levers on the blade bracket with previously removed hardware (Fig. 2).

IMPORTANT: Do not tighten nut and bolt excessively to cause binding of levers at bracket.

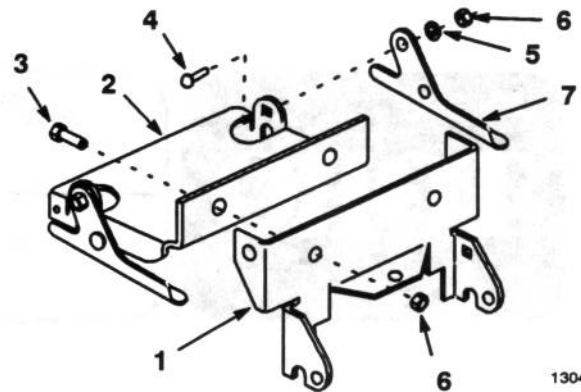

Figure 2

- | | |
|------------------------|----------------|
| 1. Rear mounting plate | 5. Washer |
| 2. Blade bracket | 6. Lock nut |
| 3. Bolt | 7. Latch lever |
| 4. Carriage bolt | |

5. Install rear mounting plate/blade bracket assembly under and inside rear frame member with short tongue rearward (Fig. 3). Secure with bolts and lock nuts at holes in frame side members and tongue forward hole (Fig. 3).

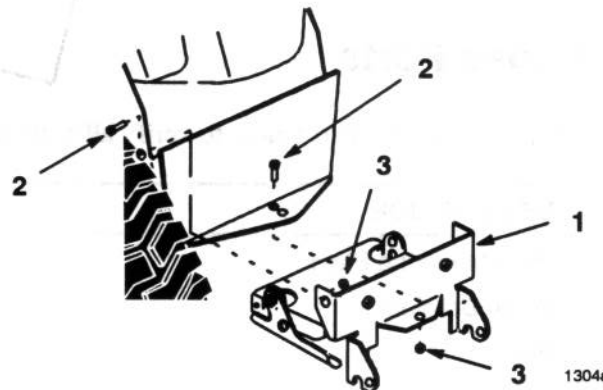

Figure 3

- | | |
|---------------------------------|-------------|
| 1. Plate/blade bracket assembly | 2. Bolt |
| | 3. Lock nut |

6. Install steering spindle stops in front of the rear tab on front wheel spindles (Fig. 4). Align so stops contact the axle during tight turns and wheels do not contact the frame. Secure with self tapping screw (Fig. 4).

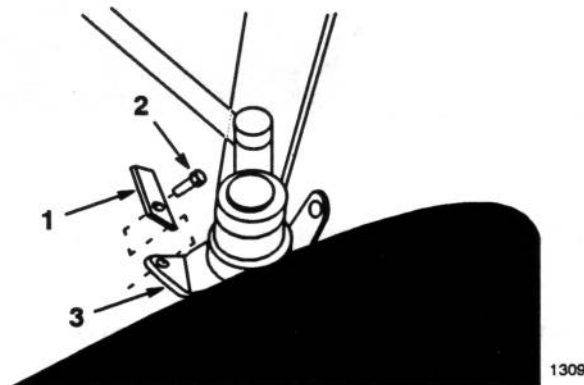

Figure 4

- | | |
|------------------------|-----------------|
| 1. Steering wheel stop | 3. Spindle stop |
| 2. Self tapping screw | |

Replace Index Lever and Plate

1. Remove existing index lever assembly and index plate from blade (Fig.).
2. Attach index lever from kit to frame bracket with previously removed bolt and nut (Fig. 5).

IMPORTANT: Do not tighten nut and bolt excessively to cause binding of lever at bracket.

3. Attach index plate from kit to frame with previously removed bolt and nut (Fig. 5).

IMPORTANT: Do not tighten nut and bolt excessively to cause binding of index plate.

4. Route cable through eyelets and attach "Z" ends to outer holes of index plate (Fig. 5) and release lever.
5. Adjust turnbuckle so the index pin is pulled out of channel when the release lever is squeezed, for easy side-to-side movement (Fig. 5). Tighten jam nut securely.
6. Attach control rod to index lever with washer and hairpin cotter. (Fig. 5).

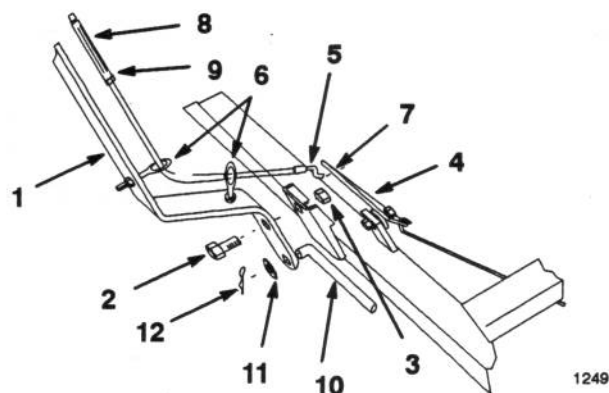

Figure 5

- | | |
|------------------|--------------------|
| 1. Index lever | 7. Outer hole |
| 2. Bolt | 8. Turnbuckle |
| 3. Nut | 9. Jam nut |
| 4. Index plate | 10. Control rod |
| 5. Cable "Z" end | 11. Washer |
| 6. Eyelet | 12. Hairpin cotter |

