



Wear Block Kit

TX 1000 Narrow Track Compact Tool Carrier

Model No. 136-5835

Installation Instructions

▲ WARNING

CALIFORNIA

Proposition 65 Warning

This product contains a chemical or chemicals known to the State of California to cause cancer, birth defects, or reproductive harm.

Preparing the Machine

▲ WARNING

Mechanical or hydraulic jacks may fail to support the machine and cause serious injury.

Use jack stands when supporting the machine.

1. Park the machine on a level surface.
2. Remove any attachments from the machine.
3. Engage the parking brake.
4. Lower the loader arms so that they are approximately 20 to 25 cm (8 to 10 inches) above the frame.
5. Shut off the engine and remove the key.
6. Raise the machine off the ground until you can access the inside of the track beneath the machine. Support the machine using jack stands.

Note: Use jack stands rated for your machine. Refer to the *Operator's Manual* for your machine to determine the weight.

Replacing the Wear Blocks

Complete the procedure for both tracks.

1. Remove the 2 existing bolts and outside, front wear block (Figure 1).

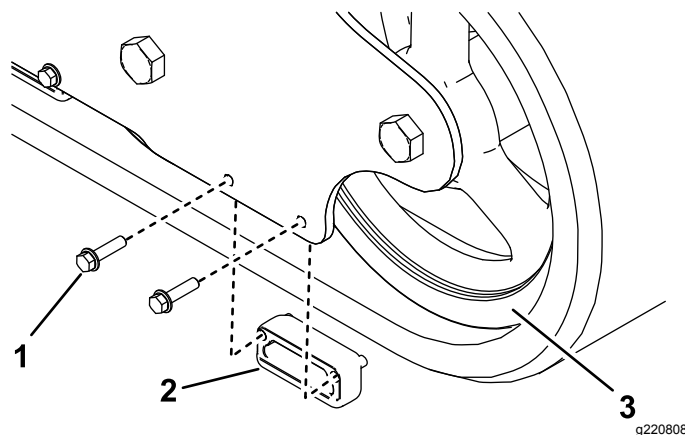

Figure 1

1. Bolt
2. Existing wear block
3. Front wheel

2. Apply thread-locking compound to the button-head bolts and use them to install the kit wear block (Figure 2).

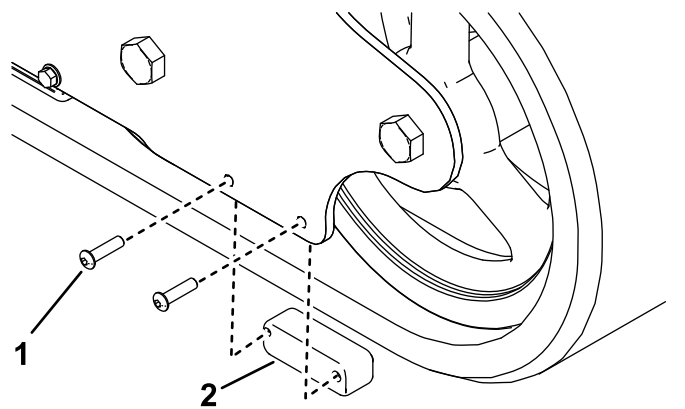

Figure 2

1. Button-head bolt
2. Kit wear block

3. Repeat the procedure for the inside of the track.

