



**Carefree<sup>®</sup> Cordless  
Walk Power Mower**

Model No. 21040-8900001 & Up

Model No. 21042-8900001 & Up

Model No. 21043-8900001 & Up

**Operator's Manual**

# Figures — Figuras

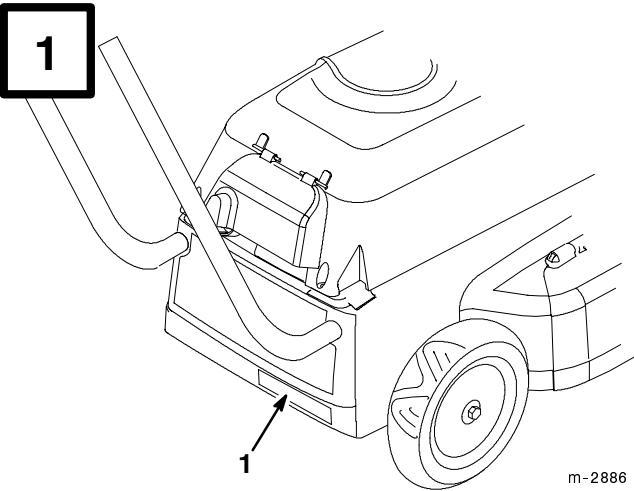

1. Model and serial number engraved in mower housing

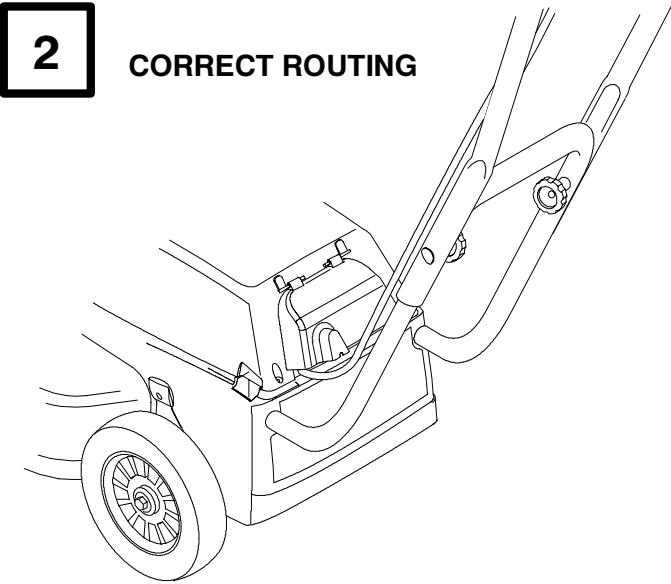

**INCORRECT ROUTING**

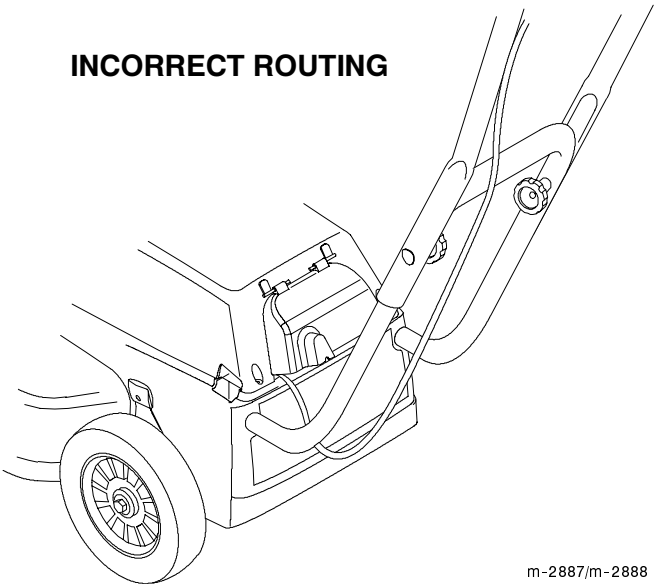

m-2887/m-2888

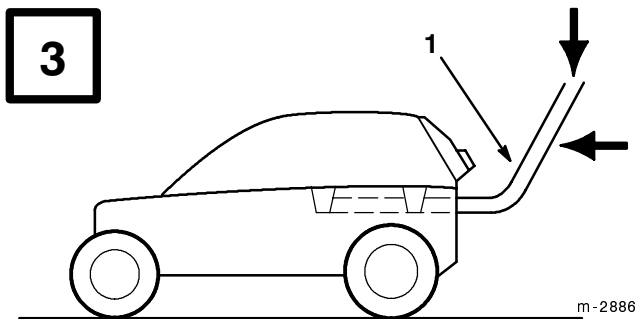

1. Lower handle

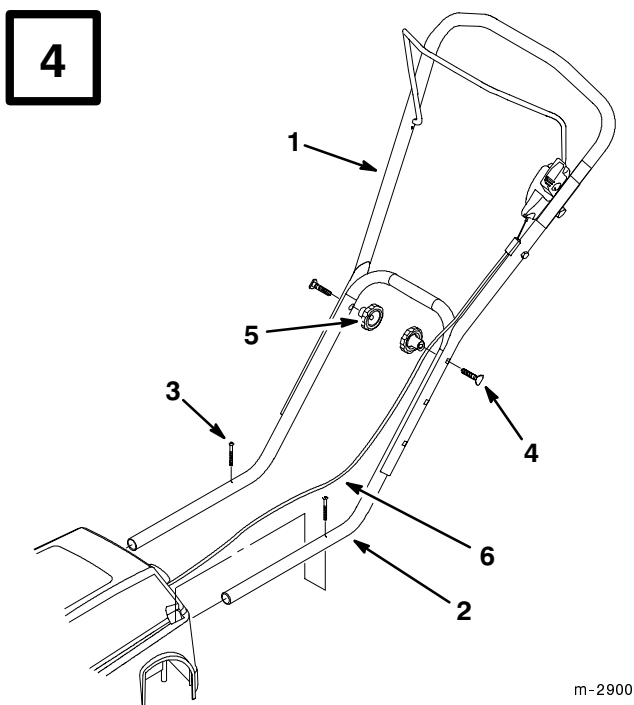

1. Upper handle  
2. Lower handle  
3. Screw (2)  
4. Bolt (2)  
5. Knob (2)  
6. Control cable

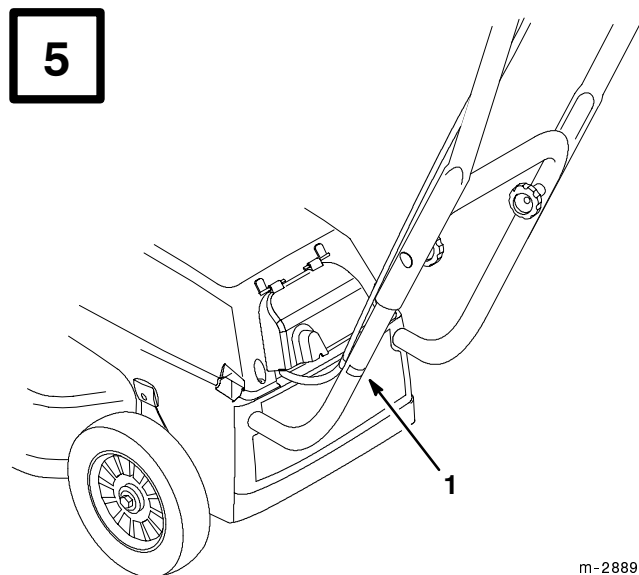

1. Clip

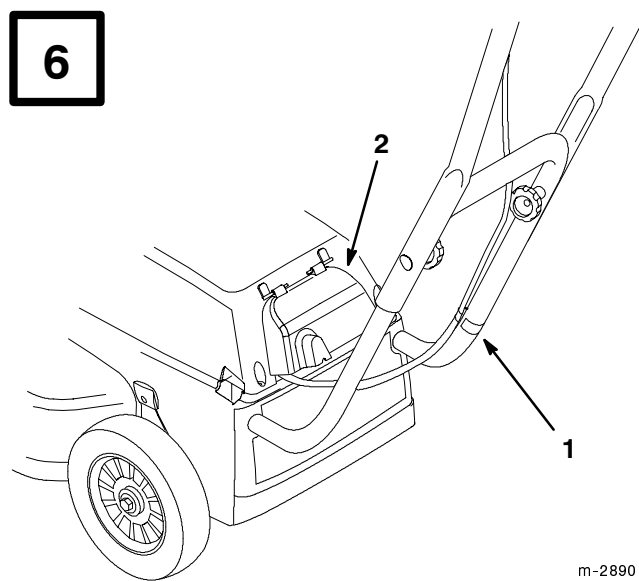

1. Clip  
2. Rain shield

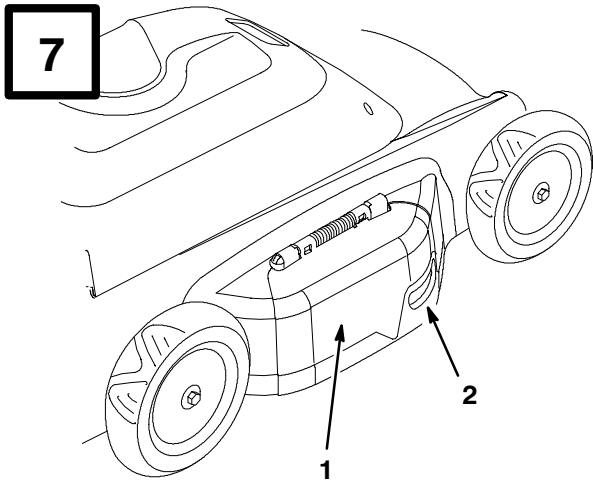

1. Mulch door      2. Handle

2225

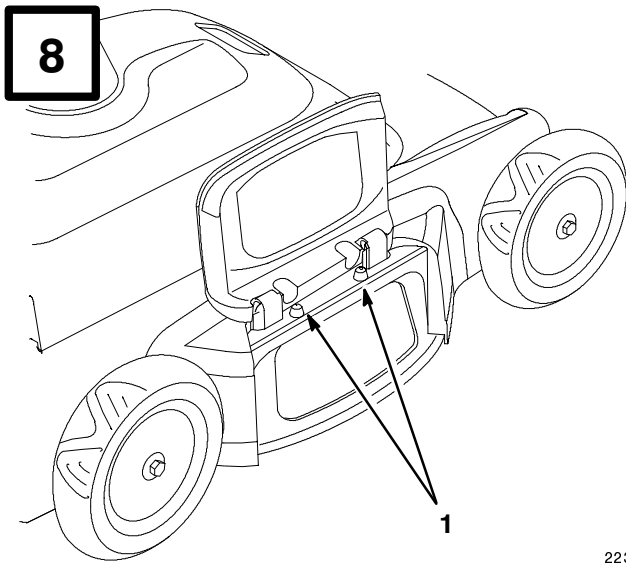

1. Peg (2)

2232

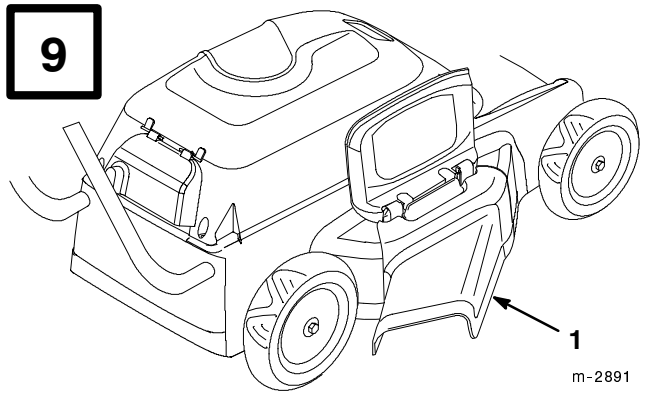

m-2891

1. Side discharge chute

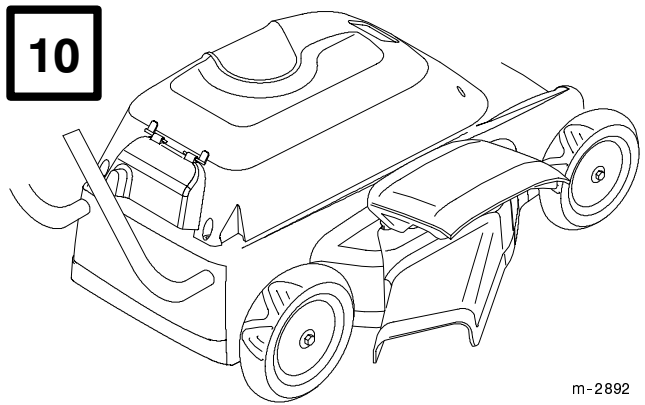

m-2892

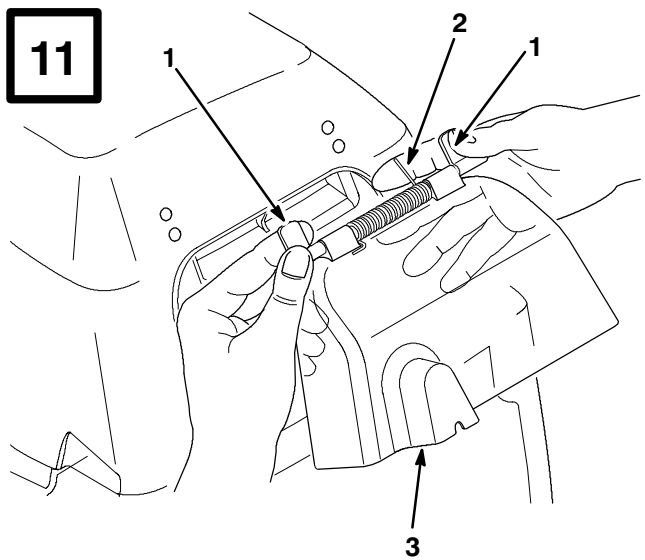

1. Mounting tab      2. Straight end of spring  
3. Rain shield

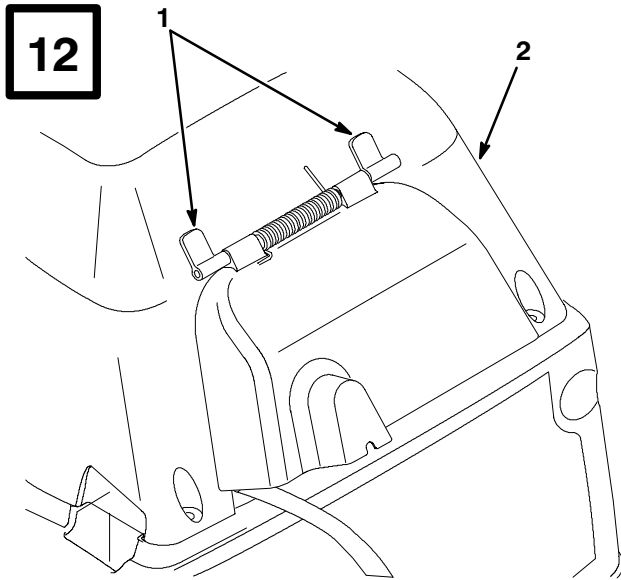

1. Mounting tab 2. Shroud

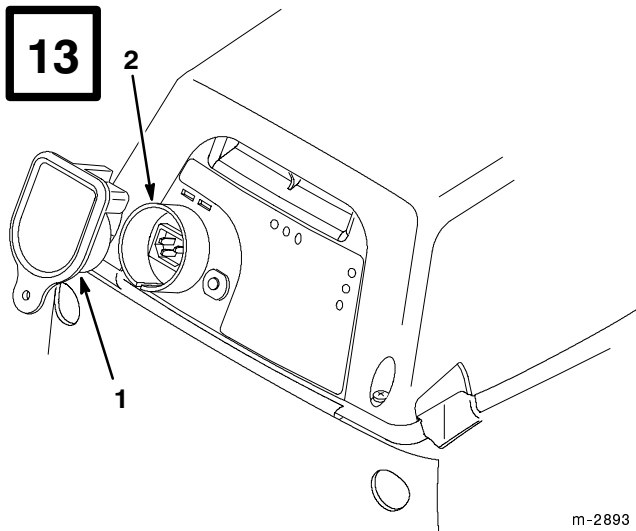

1. Key 2. Plug receptacle

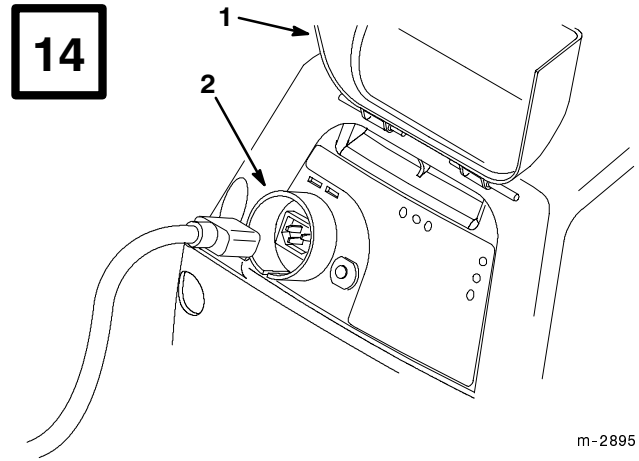

m-2895

1. Rain shield 2. Plug receptacle

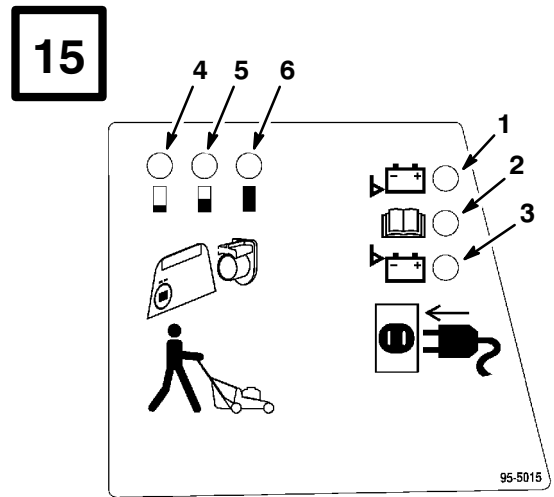

95-5015

95-5015

1. Red light 2. Yellow light 3. Green light 4. Quarter full box 5. Half full box 6. Full box

**16**

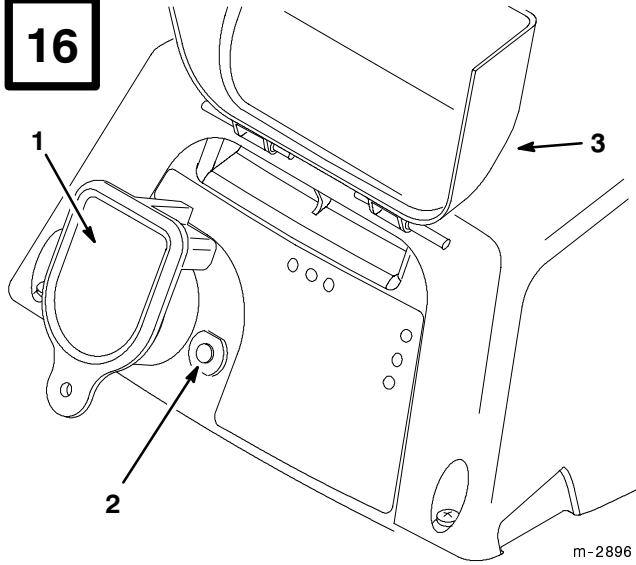

- 1. Key
- 2. Circuit breaker button

3. Rain shield

**17**

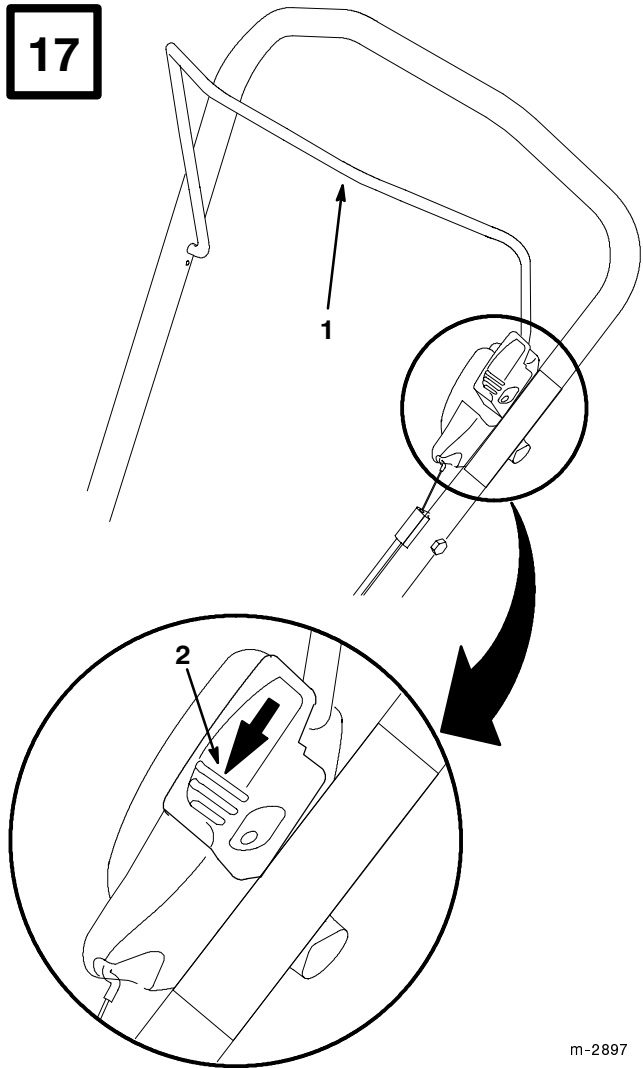

1. Control bar

2. Slide pushed down

**18**

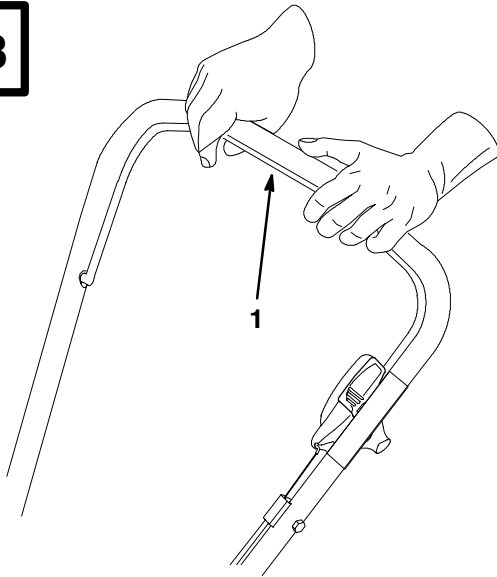

m-2898

1. Control bar

**19**

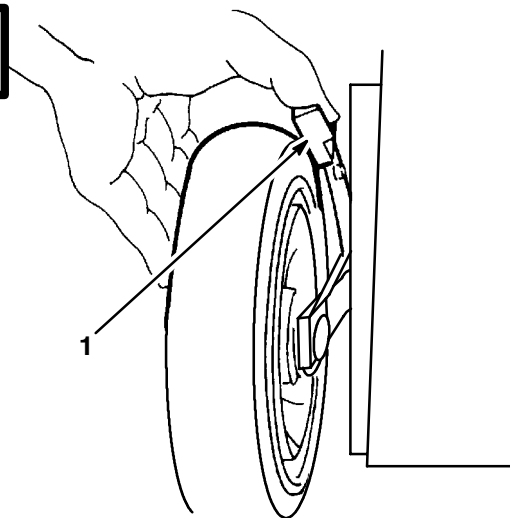

2215

1. Height-of-cut adjustment lever

**20**

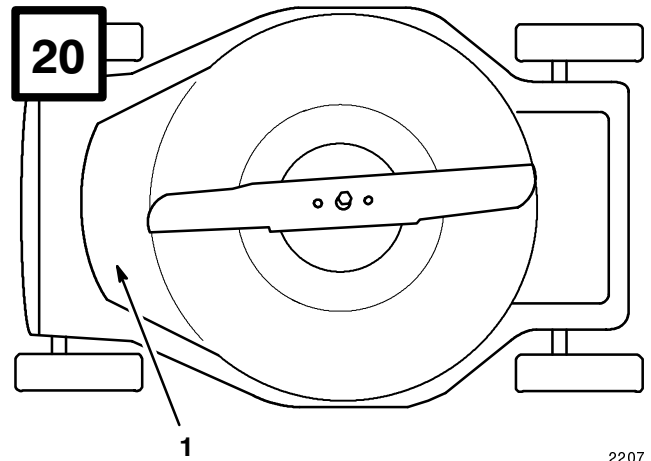

2207

1. Front cavity

**21**

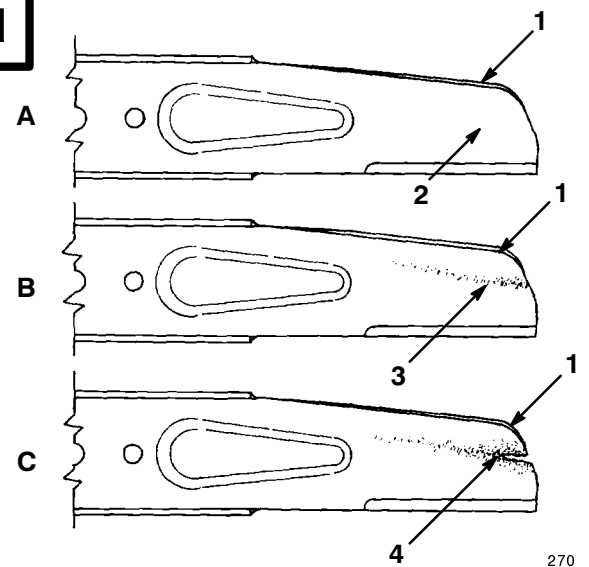

270

1. Sail	3. Wear
2. Flat part of blade	4. Slot formed

**22**

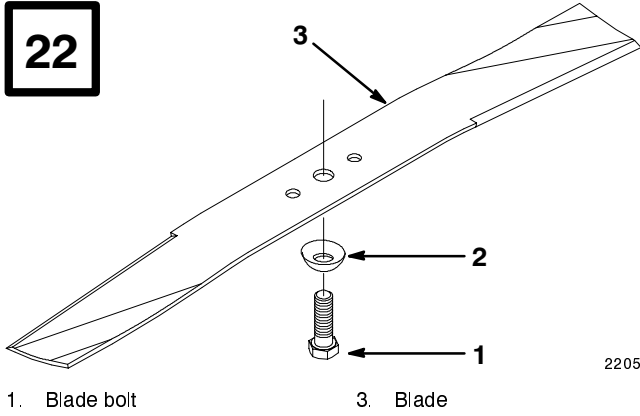

- 1. Blade bolt
- 2. Washer

3. Blade

2205

**23**

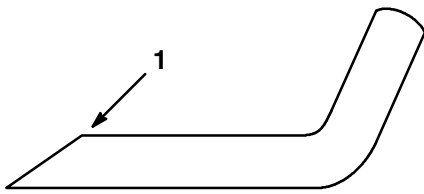

- 1. Sharpen at this angle only

153

**24**

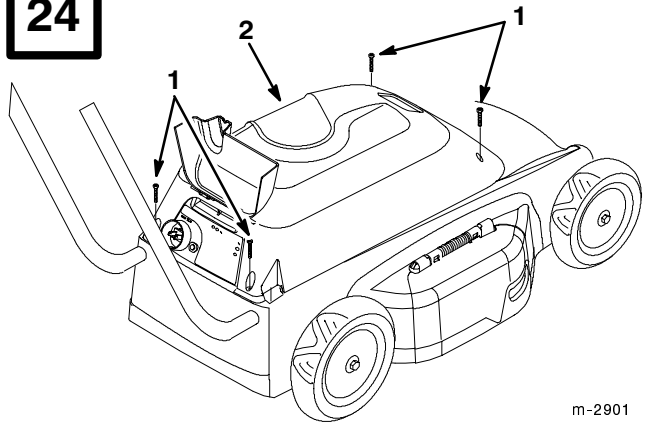

m-2901

- 1. Screw (4)

2. Shroud

**25**

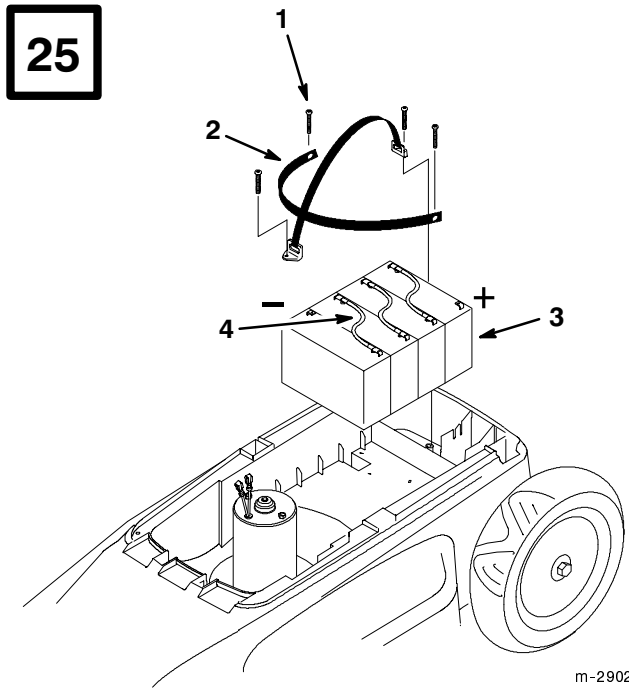

m-2902

- 1. Screw (4)

- 2. Battery hold-down strap

- 3. Battery pack

- 4. Jumper wire (3)



# Contents

	Page
Introduction .....	1
Safety .....	2
Safe Operating Practices .....	2
General Operation .....	2
While Operating .....	3
Maintenance And Storage .....	4
Sound Emissions .....	5
Vibration Level .....	5
Symbol Glossary .....	5
Assembly .....	7
Install Handle .....	7
Install Side Discharge Chute .....	7
Install Rain Shield .....	7
Before Starting .....	8
Charging Battery .....	8
Battery Power Status .....	9
Operation .....	9
Key .....	9
Starting/Stopping Instructions .....	9
Circuit Breaker .....	10
Mowing Tips .....	10
Adjusting Height-of-Cut .....	12
Maintenance .....	12
Cleaning .....	12
Blade .....	13
Battery Replacement .....	14
Servicing Double-insulated Mower .....	14
Storage .....	15

# Introduction

Thank you for purchasing a Toro product.

All of us at Toro want you to be completely satisfied with your new product, so feel free to contact your local Authorized Service Dealer for help with service, genuine Toro parts, or other information you may require.

Whenever you contact your Authorized Service Dealer or the factory, always know the model and serial numbers of your product. These numbers will help the Service Dealer or Service Representative provide exact information about your specific product. You will find the model and serial number decal located in a unique place on the product (Fig.1).

For your convenience, write the product model and serial numbers in the space below.

**Model No:** \_\_\_\_\_

**Serial No.** \_\_\_\_\_

Read this manual carefully to learn how to operate and maintain your product correctly. Reading this manual will help you and others avoid personal injury and damage to the product. Although Toro designs, produces and markets safe, state-of-the-art products, you are responsible for using the product properly and safely. You are also responsible for training persons who you allow to use the product about safe operation.

The Toro warning system in this manual identifies potential hazards and has special safety messages that help you and others avoid personal injury, even death. DANGER, WARNING and CAUTION are signal words used to identify the level of hazard. However, regardless of the hazard, be extremely careful.

**DANGER** signals an extreme hazard that will cause serious injury or death if the recommended precautions are not followed.

**WARNING** signals a hazard that may cause serious injury or death if the recommended precautions are not followed.

**CAUTION** signals a hazard that may cause minor or moderate injury if the recommended precautions are not followed.

Two other words are also used to highlight information. “Important” calls attention to special mechanical information and “Note” emphasizes general information worthy of special attention.

The left and right sides of the machine are determined by standing behind the handle in the normal operator’s position.

## Safety

### IMPORTANT SAFETY INSTRUCTIONS

Improper use or maintenance by the operator or owner can result in injury. To reduce the potential for injury, comply with these safety instructions and always pay attention to the safety alert  symbol which means CAUTION, WARNING or DANGER—“personal safety instruction.” Failure to comply with the instruction may result in personal injury.

### READ ALL INSTRUCTIONS BEFORE USING THIS MOWER

### SAVE THESE INSTRUCTIONS FOR FUTURE REFERENCE!

**WARNING:** To reduce the risk of personal injury while using battery lawn mower, always follow these basic safety instructions.

## Safe Operating Practices

This product is capable of amputating hands and feet and throwing objects. Always follow all safety instructions to avoid serious injury or death.

This mower is designed for cutting and mulching grass. Any use for purposes other than these could prove dangerous to user or bystanders.

## General Operation

1. Read this manual carefully before operating the mower. Become familiar with the controls and proper use of the mower. Never allow children under 16 years of age to operate the mower. Never allow adults to operate mower without proper instructions.
2. The operator of the mower is responsible for keeping everyone, especially children and pets, away from area of operation. The operator is responsible for accidents or hazards occurring to other people or their property.
3. Thoroughly inspect area where mower will be used and remove sticks, stones, wire, and debris that could be picked up and thrown by mower. Watch for foreign objects while mowing.
4. Wear long pants and substantial non-skid rubber soled shoes. Do not operate mower while wearing open-toed shoes, jewelry, loose clothing or when barefoot.
5. Keep all guards, shields, safety devices, side discharge chute or optional grass catcher in place. Repair or replace damaged parts, including decals. Check all safety devices before each use.
6. Motor and blade are designed to stop when control bail is released. Ensure control bail functions properly before each use of mower.
7. Before using, always visually inspect to see that the blades, blade fasteners and cutter assembly are not worn or damaged. Replace worn or damaged blades and fasteners in sets to preserve balance.

8. Only use those accessories and attachments designed to be used with this product. Use of any accessory or attachment not designed for this product may increase the risk of injury.

## While Operating

1. Do not insert key into plug receptacle until you are ready to mow.
2. Do not operate mower in gaseous, explosive atmospheres. Normal sparking of motor could ignite fumes.
3. Start the motor carefully according to instructions and with feet well away from the blade.
4. Use Right Appliance - Do not use lawn mower for any job except that for which it is intended.
5. Stay Alert - Watch what you are doing. Do not operate mower when tired or under the influence of drugs, alcohol or medication.
6. Avoid dangerous environments. Never operate mower in wet grass or damp locations. Do not use mower in the rain.
7. Always maintain secure footing. Keep a firm grip on the handle and walk; never run. Mow only in daylight or in good artificial light.
8. Mow across the face of slopes; never up and down. Use extreme caution when changing direction on slopes. Do not mow excessively steep slopes. Wear skid resistant shoes on slopes.
9. Don't Overreach - Keep proper footing and balance at all times.
10. Do not force the mower. It operates best and safest at the rate for which it was designed.
11. Always wear safety glasses or eye shields during operation to protect eyes from foreign objects that may be thrown from the machine. (Regular eyeglasses are **not** safety glasses.)
12. Always wear an approved dust mask when using unit in dusty conditions.
13. Keep face, hands, and feet away from the mower housing and cutter blade when the motor is running. Blade can cause injury to hands and feet. Stay behind the handle until the motor stops.
14. Use extreme caution when reversing or pulling the mower toward you.
15. Since the blade rotates for a few seconds after the control bar is released, stay behind the handle until all moving parts stop.
16. After striking a foreign object or if mower vibrates abnormally, stop motor and remove key from plug. Check mower for damage and make all repairs before using mower again. If major repairs are ever needed or if assistance is desired, contact your local Authorized TORO Service Dealer.
17. Do not operate mower if it has been dropped or damaged in any way. Repair any damage before operating mower.
18. Stop the motor, wait for all moving parts to stop, and remove the key from plug before adjusting the height-of-cut.
19. Stop the motor when pushing the mower outside the lawn area.
20. Stop the motor and remove the key from plug before removing side discharge chute or optional grass catcher.
21. Stop motor before leaving the operator's position—behind the handle. Remove key from plug receptacle if mower will be unattended.
22. If mower must be lifted to be transported, stop motor, stay behind the handle until all moving parts stop and remove the key from the plug receptacle.

## Maintenance And Storage

1. Perform only those maintenance instructions described in this manual. If major repairs are ever needed or if assistance is desired, contact your local Authorized TORO Service Dealer.
2. Before mower is cleaned, inspected, serviced, or adjusted, stop motor and wait for all moving parts to stop. Remove key from plug.
3. Do not charge lawn mower in rain or in wet locations.
4. To prevent electric shock while charging, repair or replace any damaged electrical cords immediately.

**Note:** The extension cord is only needed to recharge the battery. It is not used for mowing with the mower.

5. Don't abuse extension cord while charging. Do not yank cord to remove it from plug receptacle. Keep cord away from heat, oil and sharp edges.
6. When replacing batteries, all batteries should be replaced at the same time. Mixing fresh and discharged batteries could increase internal cell pressure and rupture the battery(ies).
7. When inserting the batteries into this product, the proper polarity or direction must be observed. Reverse insertion of batteries can result in burned wires, sparks, leakage or explosion of batteries.
8. Remove key before servicing, cleaning, or removing material from the lawn mower.
9. Use only the following type and size battery(ies): YUASA Maintenance-free Rechargeable Battery, six-volt, 12.5 amp, NPX50-6.
10. Do not dispose of the battery(ies) in a fire; the cell may explode. Check with local codes for special disposal instructions.
11. Do not open or mutilate the battery(ies). Released electrolyte is corrosive and may cause damage to the eyes or skin. It may be toxic if swallowed.
12. Exercise care in handling batteries in order not to short the battery (contact both positive and negative battery posts) with conducting materials such as rings, bracelets, and keys. The battery or conductor may overheat and cause burns.
13. To ensure the mower is in safe operating condition, frequently check and keep all nuts, bolts and screws tight. Ensure blade bolt is tightened to 35-40 ft-lb (48-54 N-m).
14. Always keep a sharp blade on your mower. When servicing blade, refer to blade maintenance section for correct installation and servicing procedures. Use identical replacement blades only.
15. To reduce fire hazard, keep motor free of excessive grass, leaves, and accumulations of dirt.
16. Check optional grass catcher bag frequently for wear or deterioration. Replace with a new bag when worn or damaged for your protection.
17. When not in use, remove key and store mower indoors in a dry, locked-up place out of the reach of children. Allow motor to cool before storing in an enclosure.
18. At the time of manufacture, the mower conformed to the safety standards in effect for rotary mowers. To assure best performance and continued safety certification of the mower, use genuine TORO replacement parts and accessories. Replacement parts and accessories made by other manufacturers may result in non-conformance with the safety standards, and that could be dangerous.

**SAVE THESE INSTRUCTIONS  
FOR FUTURE REFERENCE!**

## Sound Emissions

This unit has a maximum airborne noise emission, based on measurement of identical machines:

Sound Pressure Level - 76dB(A)\*

Sound Power Level - 88 LwA\*

\* Unit tested under no load condition.

## Vibration Level

This unit has a maximum vibration level of 2.5 m/s<sup>2</sup>, based on measurement of identical machines\*.

\* Unit tested under no load condition.

## Symbol Glossary

Safety alert triangle



General safety alert symbol



Read operator's manual

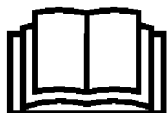

Severing of toes or fingers, rotary mower blade



Severing of fingers, rotary mower blade



Severing of toes, rotary mower blade



Switch off: Remove plug from mains before adjusting, cleaning, if cable is entangled, or before leaving the lawn mower unattended for any period

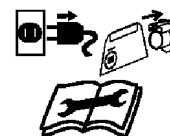

Shut off engine & remove key before leaving operator position, walk power mower



Thrown or flying objects, whole body exposure



Thrown or flying objects, keep safety shields in place, rotary mower



Do not open or remove safety shields while engine is running

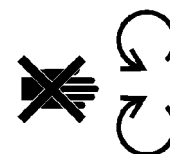

Wait until all machine components have completely stopped before touching them (blades continue to rotate after machine is switched off)



Keep dry



Low



Electrical shock,  
electrocution



High



Cutting element -  
height of cut



Splash-proof  
construction



C.E. Mark



Negative



Double Insulated

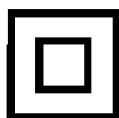

Positive

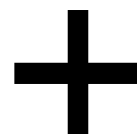

Battery charge level -  
low

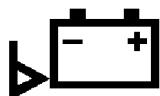

Alternating  
current/sine wave



Battery charge level -  
high

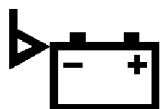

Insert plug to operate  
mower

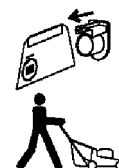

Push gray button  
forward, rotate bail to  
handle to run mower



Stay a safe distance  
from the machine,  
walk power mower

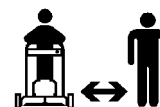

Avoid serious injury,  
operate only with  
deflector, mulch plug  
or entire catcher in  
place

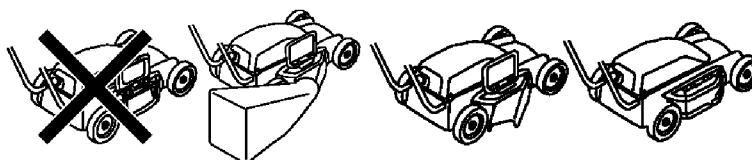

# Assembly

**IMPORTANT:** Do not insert the key into the plug receptacle until mower is fully assembled.

## Install Handle

**IMPORTANT:** Control cable must be over, not under, handles (Fig. 2).

### WARNING

#### POTENTIAL HAZARD

- Excessive pulling on control cable may cause mower to start. When mower is operating, blade is rotating.

#### WHAT CAN HAPPEN

- Contact with rotating mower blade could cause serious personal injury.

#### HOW TO AVOID THE HAZARD

- Do not lift mower by control cable or pull excessively on cable.

1. Lift control cable above holes in rear of shroud.
2. Lower Handle - Slide ends of lower handle into holes in shroud.

If handle stops before screw holes are aligned in center of shroud openings, push down on lower handle section while pushing tubes into holes in shroud (Fig. 3). Push tubes in until screw holes are centered in shroud openings.

Secure ends of lower handle with two screws.

3. Upper Handle (Fig. 4) - Handle height is adjustable to three different heights for operator comfort. Stand behind mower to gauge height.

Position ends of upper handle on outside of lower handle. Select one set of upper handle holes and align with lower handle holes. Secure handles in place with bolts and knobs.

4. If handles are in highest height position, use clip to attach cable to left side of lower handle tube (Fig. 5).

If handles are in lowest height position, use clip to attach cable to right side of lower handle tube (Fig. 6).

## Install Side Discharge Chute

1. Use handle on mulch door to raise door (Fig. 7).
2. Hook side discharge chute onto pegs (Figs. 8 and 9).
3. Lower mulch door on top of side discharge chute (Fig. 10).

## Install Rain Shield

The clear plastic rain shield can become detached from the mower due to rough handling during shipping. If the rain shield is not attached to the mower when the carton is opened, reinstall the rain shield onto the shroud as follows:

1. Reinstall the mounting tabs onto the rain shield mounting pins (Fig. 11).
2. Rotate the straight end of the spring and hold it up in the vertical position (Fig. 11).
3. Snap the mounting tabs into the matching holes in the shroud (Fig. 12).

# Before Starting

## Charging Battery

### WARNING

#### POTENTIAL HAZARD

- Contact with water while operating unit could cause electric shock.

#### WHAT CAN HAPPEN

- Electric shock can cause injury or death.

#### HOW TO AVOID THE HAZARD

- Don't handle plug or mower with wet hands or while standing in water.
- Use only a CE listed extension cord.

It takes approximately 12-16 hours to charge a fully discharged battery. **Charge the battery after every use. If the battery is not recharged after every use, the battery life will be shortened. Recharge even if mower is only run for a few minutes. This battery does not have a "memory."**

**Note:** The battery is charged at the factory. However, before using mower the first time, it is necessary to recharge battery and ensure it has a full charge before operating.

To charge battery:

1. Always charge mower in a dry area protected from the weather. Also, keep mower away from water and any flammable substances.
2. If key is in plug receptacle, remove it (Fig. 13).

### WARNING

#### POTENTIAL HAZARD

- The electrical cord could be damaged.

#### WHAT CAN HAPPEN

- A damaged electrical cord could cause a shock or fire.

#### HOW TO AVOID THE HAZARD

- Thoroughly inspect electrical cord before charging unit. If cord is damaged, do not charge unit. Replace or repair damaged cord immediately. Contact your TORO service dealer for assistance.

3. Lift the rain shield, insert the extension cord into the plug receptacle, then connect other end of extension cord to a normal 230 volt household outlet (Fig. 14). Use only a CE listed extension cord (included with mower).
4. The three vertical LED lights on the control panel will indicate the charging status (Fig. 15). Refer to the LED Charging Lights Chart, page 9, for a summary of the LED lights.

The red light on the control panel will begin to flash to indicate battery is present and is ready to charge.

5. After a few minutes, the red light will stop flashing and become a steady red. This indicates the battery is charging.
6. When the battery is almost fully charged, the red light will go out and the green light will go on. The red and green light will alternately turn on and off. When the green light is on more than the red light, the battery is fully charged.

**Note:** Do not unplug extension cord by pulling on cord. To unplug, grasp the plug, not the cord.

**IMPORTANT:** Your mower has been designed to be safe if left continually on charge for extended periods of time. It is recommended that the battery be left continually on charge when it is not in use



**during the mowing season. During the non-mowing season, the mower can be unplugged and stored (for up to six months maximum) if the battery is fully charged, and the mower is stored in a cool, dry place.**

**Note:** When the mower is left on charge, it is normal for the red and green lights to alternately turn on and off.

LED CHARGING LIGHTS CHART			
Charging Status	Red	Green	Yellow
Pre-charge qualification - charger testing battery condition/trickle charging battery. Trickle charge can last from minutes to hours.	blinking	off	off
Battery charging	on	off	off
Battery charged	off	on	off
Battery absent or defective	off	off	on
Charging fault - charger malfunctioning	not applicable	not applicable	on
Charge pending - temperature too hot or cold to charge	not applicable	not applicable	blinking

## Battery Power Status

The three horizontal LED lights at the top of the control panel indicate approximately how much charge is left in the battery while the mower is in operation (Fig. 15). The lights are only accurate when the mower is operating and cutting grass. The following is an explanation of the symbols under the battery power status LED lights:

- Full Box - Battery is between 50% and 100% charged.
- Half Full Box - Battery is between 25% and 50% charged.
- Quarter Full Box - Battery is between 5% and 25% charged.
- If all LED lights are off, the battery has less than 5% charge left and should be recharged.

**IMPORTANT: The battery's life will be shortened if mower is run after battery lights have turned off. Do not continue to mow. Recharge battery.**

## Operation

This mower is intended for residential use only.

### Key

The mower will only operate when key is fully seated in plug receptacle (Fig. 16). To prevent accidental starting or unauthorized use of mower, always remove key from plug receptacle when leaving mower unattended. The key has a tab with a hole in it to allow key to be hung from a nail, out of the reach of children. Read warning label on key.

## Starting/Stopping Instructions

### To Start Motor

1. Push mower onto a flat concrete or asphalt surface.

**Note:** Starting mower in thick grass could cause mower to clog.

2. Lift the rain shield and insert the key fully into the plug receptacle (Fig. 16).

3. Pull control bar toward handle while pushing down slide on control (Fig. 17).
4. Squeeze control bar to handle (Fig. 18).

**Note:** Keep mower running when turning mower. Turning mower off when making a turn does not save battery energy.

## To Stop Motor

1. Release control bar.



### WARNING

#### POTENTIAL HAZARD

- When key is in plug receptacle, mower is operational. Someone could accidentally start the mower.

#### WHAT CAN HAPPEN

- Accidental starting of mower could seriously injure you or other bystanders.

#### HOW TO AVOID THE HAZARD

- Always remove key from plug receptacle when leaving mower unattended, even for a short period of time.

2. Remove key from plug receptacle if mower will be unattended for any period of time. Hang key in a high place out of reach of children.
3. **Always charge battery immediately after each use of mower. If battery is not charged after each use, battery life will be shortened.** See Charging Battery in Before Starting section.

**IMPORTANT:** Your mower has been designed to be safe if left continually on charge for extended periods of time. It is recommended that the battery be left continually on charge when it is not in use during the mowing season. During the non-mowing season, the mower can be

**unplugged and stored (for up to six months maximum) if the battery is fully charged, and the mower is stored in a cool, dry place.**

## Circuit Breaker

If mower is run under too much load, the circuit breaker will trip. Follow these instructions to reset circuit breaker.

**IMPORTANT:** Never reset circuit breaker when key is in receptacle and control bar is squeezed to handle.

1. Remove key from plug receptacle (Fig. 16).
2. Wait 30 seconds to 1 minute before pushing in circuit breaker button (Fig. 16).
3. Reinstall key in plug receptacle.
4. Resume cutting under less load.

If circuit breaker repeatedly trips, raise the height-of-cut or use the side discharge chute.

## Mowing Tips

### Battery Run Time

With a battery powered lawn mower, the condition of the grass and the way that you mow the grass will affect the how long the battery will run on a single charge at each mowing.

The following are some things that will affect battery run time:

- Moisture content of grass - The more moisture there is in the grass, the faster the battery will run down.
- Walking/mowing speed - The faster you walk, the faster the battery will run down.
- Mode of operation - Mulching grass requires the most battery energy. Bagging requires the second highest amount of battery energy and side discharging uses the least.

- Height-of-cut setting – If you are experiencing problems with the battery running down too fast, try raising the height-of-cut setting one notch.

## General Mulching Tips

Your mower is designed to mulch grass when the mulch door is completely closed (Fig. 7). Follow these instructions whether cutting grass or leaves for the best cutting results and lawn appearance:

- Maintain a **sharp blade** throughout the cutting season. Periodically file down nicks on blade.
- **Only mow dry grass or leaves.** Wet grass and leaves tend to clump on yard and may cause mower to plug or motor to stall. They may also be slippery to walk on and could cause you to slip and fall.



### WARNING

#### POTENTIAL HAZARD

- Wet grass or leaves can cause you to slip and contact blade.

#### WHAT CAN HAPPEN

- Blade contact can seriously injure you.

#### HOW TO AVOID THE HAZARD

- Mow only in dry conditions.

- Remove key from receptacle and clean clippings or leaves from underside of mower deck after each mowing. Use a wooden tool, not metal.
- Grass grows at different rates at different times of the year. In the heat of summer, it is generally best to cut grass at the 6.4 cm, 7.6 cm or 8.9 cm height-of-cut settings. Only about 1/3 of the grass blade should be cut off. Cutting below the 6.4 cm setting is not recommended unless grass is sparse, or it is late fall when grass growth begins to slow down.

- When changing height-of-cut from the established setting (6.4, 7.6 or 8.9 cm) to a lower height, the grass may appear ragged or uneven until the grass adjusts to the new established height-of-cut and regains its normal appearance.
- When cutting grass over 15 cm tall, you may want to first mow using the side discharge chute or try the highest height-of-cut setting and a slower walking speed; then mow again at a lower setting for best lawn appearance. If grass is too long and leaves clumps on top of lawn, mower may plug and cause motor to stall.
- Alternate mowing direction. This helps disperse clippings over lawn for even fertilization.

If the finished cut lawn appearance is unsatisfactory, try one or more of the following:

- Sharpen the blade.
- Walk at a slower pace while mowing.
- Raise the height-of-cut setting on your mower.
- Cut grass more frequently.
- Overlap cutting swaths instead of cutting a full swath with each pass.
- Set height-of-cut on front wheels one notch higher than rear wheels. (For example, set the front wheels at the 6.4 cm setting and the rear wheels at the 5.1 cm setting.)

## Cutting Leaves

- When cutting is complete, always be sure that 50% of the lawn shows through the cut leaf cover. This may require one or more passes over the leaves.
- For light leaf coverage, position all wheels at the same height-of-cut setting.
- Walk at a slower mowing speed if leaves are not being cut up finely enough to be hidden down in the grass.
- If you cut up a lot of oak leaves, you might want to add lime to your grass in the spring. Lime reduces the acidity of oak leaves.

## Adjusting Height-of-Cut

The mower has five height-of-cut adjustments: 3.8 cm, 5.1 cm, 6.4 cm, 7.6 cm and 8.9 cm. The rear adjustment lever adjusts the height-of-cut for both rear wheels, and the front adjustment lever adjusts both front wheels.

### DANGER

#### POTENTIAL HAZARD

- Adjusting height-of-cut levers could bring hands into contact with moving blade.

#### WHAT CAN HAPPEN

- Contact with blade could cause serious personal injury.

#### HOW TO AVOID THE HAZARD

- Stop motor, wait for all moving parts to stop and remove key from plug receptacle before changing the height-of-cut.
- Do not put fingers under housing to lift mower when adjusting height-of-cut levers.

1. Stop motor and wait for all moving parts to stop. Remove key from plug receptacle.
2. For easier adjustment, lift housing up so wheels are off ground. **Do not place hands under deck to lift housing.** Squeeze adjustment lever toward wheel and move lever to desired setting (Fig. 19). Ensure pin on adjustment lever engages notch in mower housing. Adjust all wheels to the same setting.

**Note:** For easier adjustment of rear wheels, grasp lower handle with one hand and lift up mower slightly so wheel is off ground. Then squeeze adjustment handle toward wheel.

## Maintenance

### WARNING

#### POTENTIAL HAZARD

- When key is in plug receptacle, mower is operational. Someone could accidentally start the mower.

#### WHAT CAN HAPPEN

- Accidental starting of mower could seriously injure you or other bystanders.

#### HOW TO AVOID THE HAZARD

- Always remove key from plug receptacle when leaving mower unattended, even for a short period of time.

## Cleaning

Before cleaning mower, stop motor, wait for all moving parts to stop, and remove key from plug receptacle.

**IMPORTANT:** Do not spray or pour water on mower when cleaning. Moisture can be trapped in mower and may cause corrosion of internal parts.

### After Every Use

- Clean the underside of the mower housing. Be particularly careful to keep the front cavity clear of all debris (Fig. 20). Remove dirt and grass clippings with a hardwood scraper. Avoid burrs and sharp edges.
- Brush all debris off top of mower housing.

### Once A Year

- Remove top shroud (Fig. 24) and clean out any debris from underneath it and around battery with compressed air, a vacuum cleaner or a brush.

**IMPORTANT:** Do not use metal objects to clean around battery. If metal objects contact the positive and negative posts at the same time, this could short the battery. The battery or conductor may overheat and cause burns.

- Check for any discolored or charred wires and battery and switch contacts. If any are damaged, see your Authorized Toro Service Dealer for repairs.

## Blade

Always mow with a sharp blade. A sharp blade cuts cleanly and without tearing or shredding the grass blades like a dull blade.

### CAUTION

#### POTENTIAL HAZARD

- Motor could be started by someone accidentally.

#### WHAT CAN HAPPEN

- Accidental starting of motor could cause serious injury to operator or bystanders.

#### HOW TO AVOID THE HAZARD

- Do not attempt to inspect, remove or replace blade without first removing the key from the plug receptacle.

1. Stop motor and wait for all moving parts to stop. Remove key from plug receptacle.
2. Tip mower on its side (Fig. 20).
3. EXAMINING BLADE - Carefully examine blade for sharpness and wear, especially where flat and curved parts meet (Fig. 21A). Since sand and abrasive material can wear away the metal that connects the flat and curved parts of the blade, check blade before using the mower. If a slot or wear is noticed (Fig. 21B & 21C), replace blade. Refer to step 4.

**Note:** For best performance, install new blade before cutting season begins. During the year, file down small nicks to maintain the cutting edge.



### DANGER

#### POTENTIAL HAZARD

- A worn or damaged blade could break and a piece of blade could be thrown in operator's or bystander's direction.

#### WHAT CAN HAPPEN

- A thrown piece of blade could cause serious personal injury or death to operator or bystanders.

#### HOW TO AVOID THE HAZARD

- Inspect blade periodically for wear or damage.
- Replace a worn or damaged blade.

4. REMOVING BLADE-Grasp end of blade using a rag or thickly padded glove. Remove blade bolt, washer and blade (Fig. 22).
5. SHARPENING BLADE - Using a file, sharpen top side of blade and maintain original cutting angle (Fig. 23). The blade will remain balanced if same amount of material is removed from both cutting edges.

**IMPORTANT:** Check balance of blade by putting it on a blade balancer. An inexpensive balancer can be purchased at a hardware store. A balanced blade stays in a horizontal position and an unbalanced blade settles to the heavy side. If blade is not balanced, file more metal off cutting edge on heavy end of blade.

6. Reinstall sharp, balanced blade, washer and blade bolt. Sail part of blade must point toward top of mower housing to ensure correct installation. Washer is curved and must be reinstalled with curve side down as shown in Figure 22. Tighten blade bolt to 35-40 ft-lb (48-54 N·m).

# Battery Replacement

## Battery Removal

1. Stop the motor and remove the key from the plug receptacle.
2. Remove the four screws from the shroud and remove the shroud (Fig. 24).
3. Move control panel out of the way.
4. Remove screws from battery hold-down strap (Fig. 25).
5. Disconnect positive and negative wires from battery terminals (Fig. 25).
6. Remove the three jumper wires from battery and discard in household trash (Fig. 25).
7. The bottom of the battery pack is secured with tape to mower housing. Rock battery pack to free batteries from tape, then remove from mower.

## New Battery Installation

**Note:** Use only the following type and size battery(ies): YUASA Maintenance-free Rechargeable Battery, six-volt, 12.5 amp, NPX50-6.

1. Scrape the old tape off the bottom of the mower with a putty knife.
2. Peel protective paper off double-backed tape on bottom of new battery.
3. Position new battery in mower so the negative leads are on the right-hand side, and the positive leads are on the left-hand side of the mower (Fig. 25).

**Note:** The left and right sides of the machine are determined by standing behind the handle in the normal operator's position.

4. Reconnect the positive and negative wires to the battery terminals (Fig. 25).
5. Reinstall battery hold-down strap (Fig. 25).
6. Reinstall shroud with four screws (Fig. 24).

## Old Battery Disposal

**DO NOT PLACE USED BATTERIES IN YOUR REGULAR TRASH!**

**THIS SEALED LEAD (ACID) BATTERY MUST BE COLLECTED, RECYCLED OR DISPOSED OF IN AN ENVIRONMENTALLY SOUND MANNER.**

The incineration, landfilling or mixing of sealed lead (acid) batteries with the municipal solid waste stream is **PROHIBITED BY LAW** in some areas.

Return this battery to an approved sealed lead (acid) battery recycler. This may be where you purchased the battery.

Contact your local waste management officials for other information regarding the environmentally sound collection, recycling and disposal of this battery.

## Servicing Double-insulated Mower

In a double-insulated mower, two systems of insulation are provided instead of grounding. No grounding means is provided on a double-insulated mower, nor should a means for grounding be added to the mower. Servicing a double-insulated mower requires extreme care and knowledge of the system, and should be done only by qualified service personnel. Replacement parts for a double-insulated mower must be identical to the parts they replace. A double-insulated mower is marked with the words "DOUBLE INSULATION" or "DOUBLE INSULATED." The symbol (square within a square)  may also be marked on the mower.

# Storage

Store mower in a cool, clean, dry place. Do not store mower if it contains a battery in a warm basement. Cover mower to keep it clean and protected.

1. Clean mower housing. See Cleaning section in Maintenance chapter.
2. Remove grass clippings, dirt and grime from external parts of the shrouding and top of mower housing.
3. Check condition of blade. See Blade section in Maintenance chapter.
4. Tighten all nuts, bolts, and screws.
5. Your mower has been designed to be safe if left continually on charge for extended periods of time. It is recommended that the battery be left continually on charge when it is not in use during the mowing season. During the non-mowing season, the mower can be unplugged and stored (for up to six months maximum) if the battery is fully charged, and the mower is stored in a cool, dry place.







