



# VP and VP<sub>E</sub> Bracket Retrofit Kits Installation Instructions

## Introduction

The VP and VP<sub>E</sub> satellites can be retrofitted with the newly designed distribution board bracket that allows for the distribution board to be vertically installed. With the distribution board vertically installed, the risk of equipment damage from moisture and debris accumulation over the distribution board is reduced.

## Removal and Installation of the Distribution

**Figure 1** Remove Distribution Board (Bracket Only Kit)

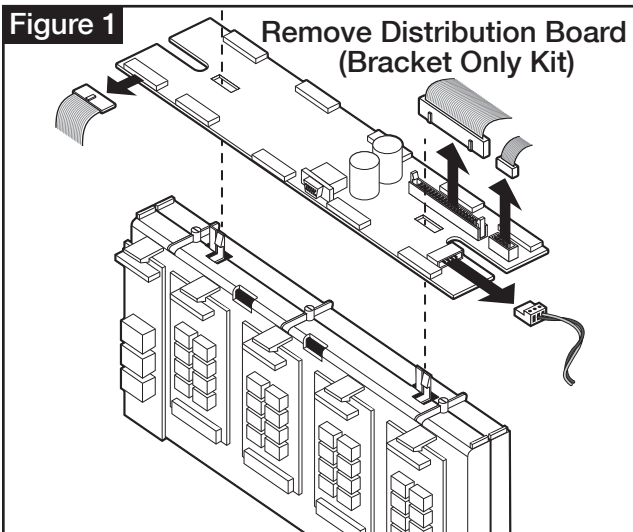

**Figure 2** Install Distribution Board to the Bracket (Bracket Only Kit)

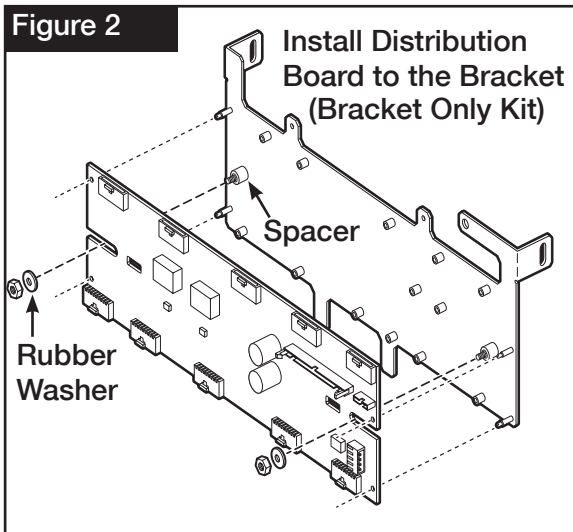

**Figure 3** Install the Distribution Board Assembly Inside the Satellite

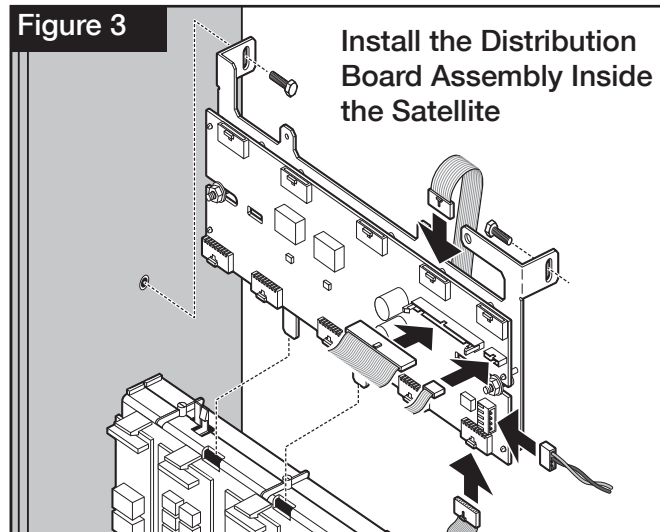

- Step 1 – Remove the satellite's front and rear door to access the distribution board.
- Step 2 – Turn the satellite's power off.
- Step 3 – If the satellite is equipped, remove the Maxon radio assembly and/or Turf Guard repeater.
- Step 4 – Locate the distribution board and remove by pressing the retaining tabs to release the board.
- Step 5 – Unplug all cables from it. Note the location of the cables for reassembly. See **Figure 1**.
- Step 6 – (For Bracket Only Kit) Install the distribution board onto the bracket as shown on **Figure 2**. Place rubber washer between the distribution board and the screw nut. Place spacers on the threaded post between the distribution board and the bracket.
- Step 7 – Install the bracket and board assembly inside the satellite using the provided screw holes above the center back plate. Make sure to align and insert the bracket's bottom tabs into the center back plate. See **Figure 3**.
- Step 8 – Reinstall the cables to the distribution board.
- Step 9 – Return power to the satellite and check for proper function.

## Maxon Radio and Turf Guard Receiver Installation

Figure 4

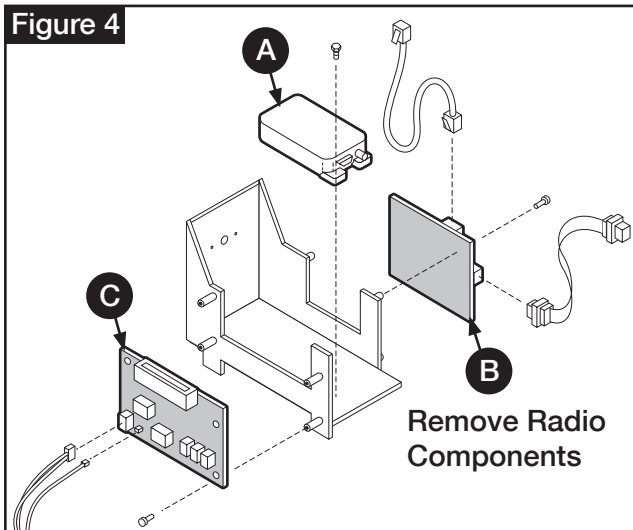

Figure 5

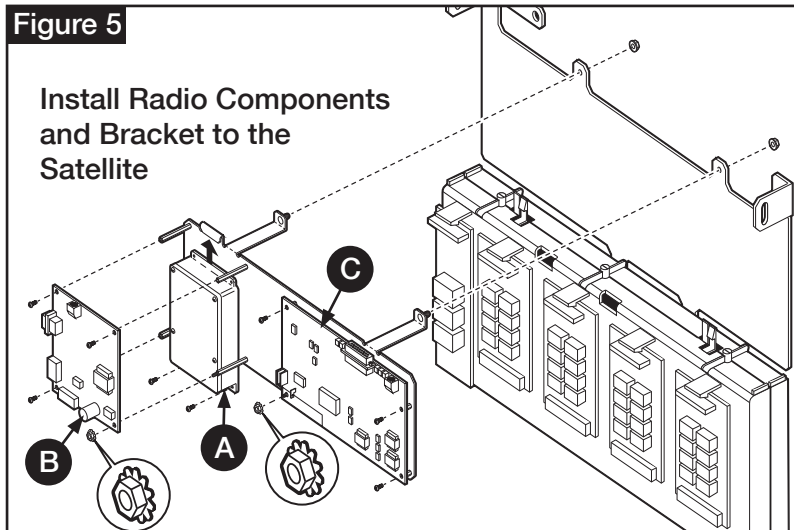
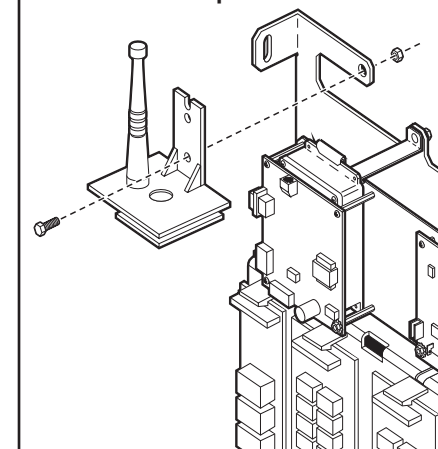

Figure 6

Install Turf Guard Repeater



### Maxon Radio Install

- Step 1 – Disconnect all cables attached to the radio assembly.
- Step 2 – Remove the radio components from the old bracket marked A, B and C.
- Step 3 – Install the radio components A, B and C on the new radio bracket. Note the two locations where a lock nut is used instead of a screw. See **Figure 5**.
- Step 4 – Position the bracket's lower tab into the center back plate's access hole and align the top tabs into the distribution board's top mounting tabs. Secure with the provided screw nuts.
- Step 5 – Reconnect the cables to the radio assembly and check for proper function.

### Turf Guard Radio Install

- Step 1 – Disconnect the cable from the Turf Guard Repeater assembly and position it on the distribution bracket tab as indicated in **Figure 6**. Secure the assembly with the bolt and provided bolt nut. It might be necessary to drill a 1/4" hole in the Turf Guard Repeater bracket to accommodate the mounting bolt.
- Step 2 – Reconnect the cable to the Turf Guard Repeater assembly and check for proper function.