



Ignition Timer Kit

Workman® MDX Utility Vehicle

Model No. 137-9982

Installation Instructions

⚠ WARNING

CALIFORNIA Proposition 65 Warning

This product contains a chemical or chemicals known to the State of California to cause cancer, birth defects, or reproductive harm.

Installation

Loose Parts

Use the chart below to verify that all parts have been shipped.

Procedure	Description	Qty.	Use
1	No parts required	–	Prepare the machine for installation.
2	Wire harness Timer module Relay Screw	1 1 1 2	Install the wire harness, relay, and timer.
3	Cable tie	3	Complete the installation.

1

Preparing the Machine

No Parts Required

Procedure

Note: Determine the left and right sides of the machine from the normal operating position.

1. Park the machine on a level surface.
2. Engage the parking brake.
3. Shut off the engine and remove the key.
4. Raise the cargo bed; refer to your machine *Operator's Manual*.
5. Disconnect the battery; refer to your machine *Operator's Manual*.



2

Installing the Wire Harness, Relay, and Timer Module

Parts needed for this procedure:

1	Wire harness
1	Timer module
1	Relay
2	Screw

Use the following instructions and illustrations to route and connect the wire harness. Refer to [Figure 1](#) for an overview of the wire-harness position.

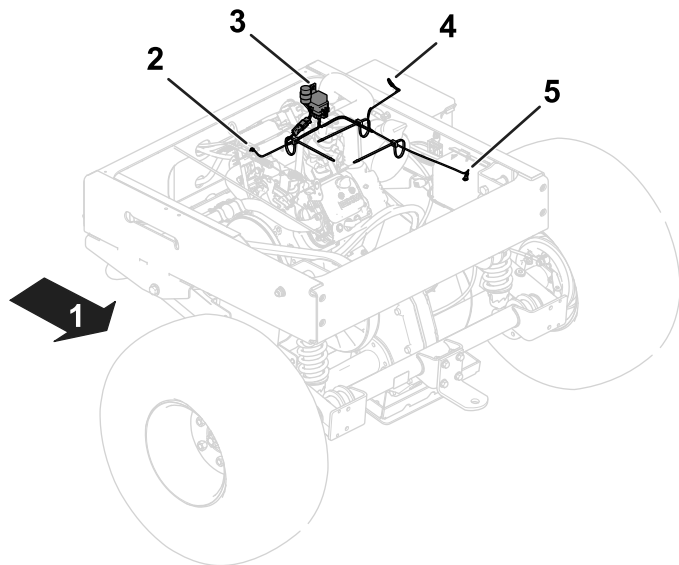

Figure 1

Cargo bed removed for clarity

1. Rear of the machine
2. Ring terminal—engine magneto
3. Timer module and relay
4. Ring terminal—negative battery terminal
5. Ring terminal—solenoid

Installing the Timer Module and Relay

1. Measure and drill 2 holes (1/8 inch) into the right side of the rear-frame front plate. Refer to [Figure 2](#) for the appropriate hole location on the front plate.

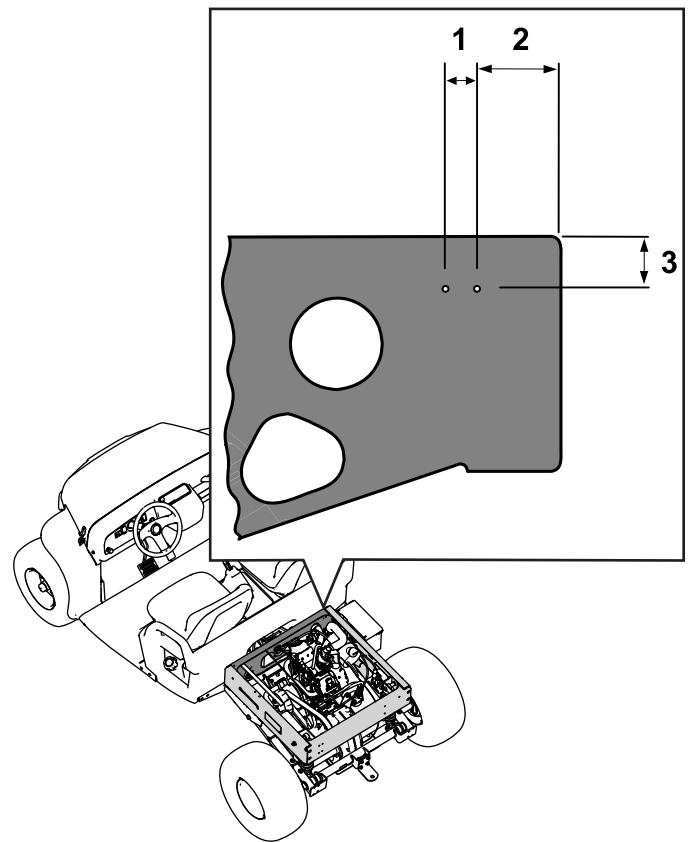

Figure 2

Cargo bed removed for clarity

1. 1.9 cm (3/4 inch)
2. 5.2 cm (2 inches)
3. 3.25 cm (1-1/4 inches)

2. Use 2 screws to install the timer module and relay to the holes in the front plate ([Figure 3](#)).

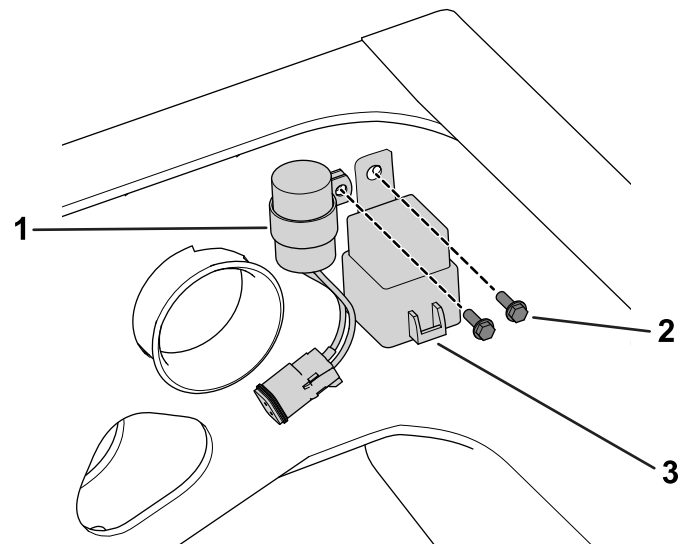

Figure 3

1. Timer module
2. Screw
3. Relay

Installing the Wire Harness to the Solenoid and Engine

1. Remove the cover from start/run solenoid ([Figure 4](#)).

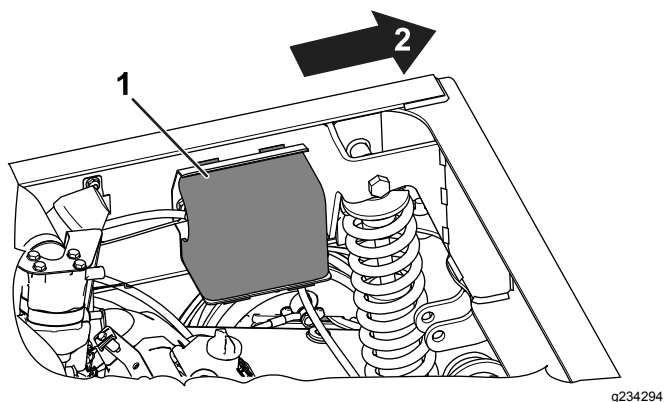

Figure 4

1. Solenoid cover
2. Rear of the machine

2. Use the solenoid nut and lock washer to secure the ring terminal to the solenoid ([Figure 5](#)).

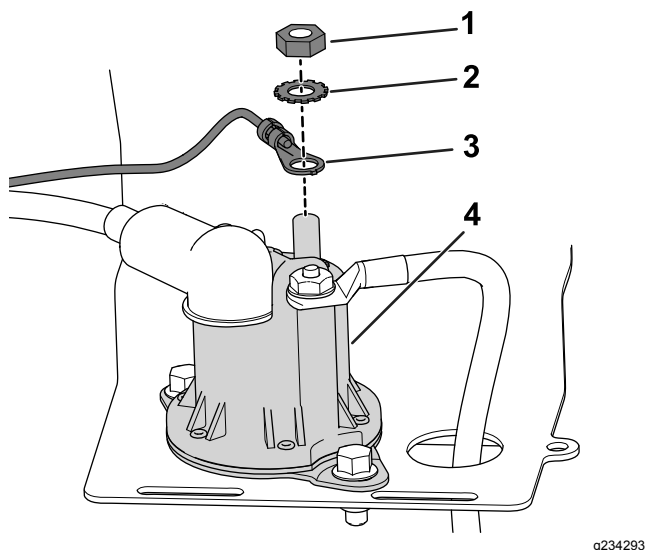

Figure 5

1. Nut
2. Lock washer
3. Ring terminal
4. Solenoid

3. Install the cover over the solenoid.
4. Connect the wire harness to the timer module and the relay ([Figure 6](#)).

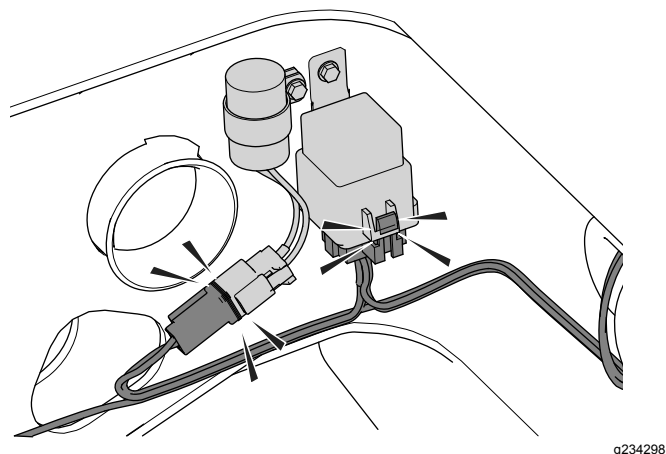

Figure 6

5. Install the ring terminal to the engine magneto; refer to [Figure 1](#) for the wire-harness position.

3

Completing the Installation

Parts needed for this procedure:

3	Cable tie
---	-----------

Procedure

1. Connect the positive battery cable to the positive battery terminal; refer to your machine *Operator's Manual*.
2. Connect the ring terminal of the wire harness to the negative battery terminal; refer to [Figure 1](#) for the wire-harness position.
3. Connect the negative battery cable to the negative battery terminal; refer to your machine *Operator's Manual*.
4. Use 3 cable ties to secure the kit wire harness to the existing wire harness; refer to [Figure 7](#) for the position of the cable ties.

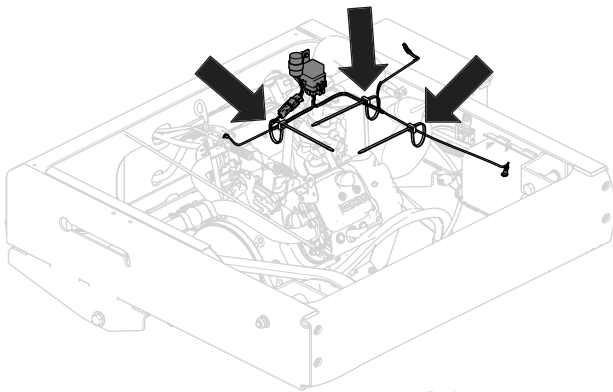

g234304

Figure 7
Cargo bed removed for clarity