

TORO®

PART NO. 98-5413

INSTALLATION INSTRUCTIONS

LARGE PULLEY KIT For Grounds Pro 2000



CAUTION

Before servicing or making adjustments to the machine, stop engine and remove key from the switch.

Note: Right and left hand sides are determined from the operator's seat position.

1. On pulley end of each cutting unit, loosen jam nut on end of belt tension rod. Rotate rod to release cutting unit belt tension (Fig. 1).

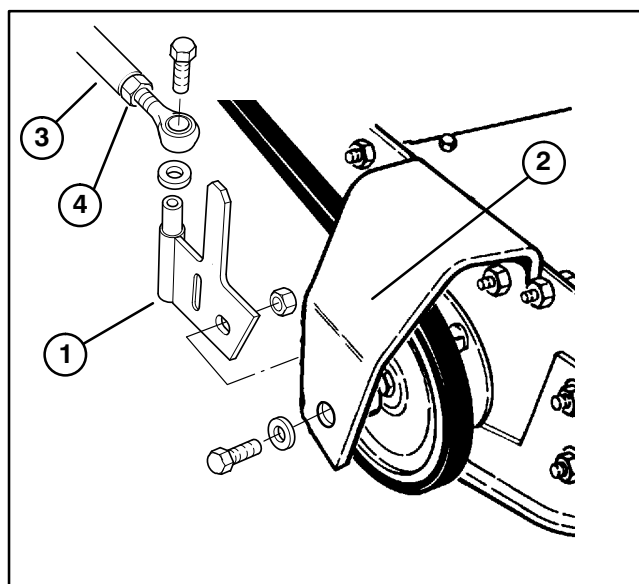

Figure 1

1. Belt tension bracket
2. Tensioner bracket
3. Belt tensioner rod
4. Jam nut

2. Remove capscrew and washer securing tension rod ball joint to tension bracket pin (Fig. 1). Remove ball joint from tension rod pin.

3. Remove capscrew and washer securing belt tension bracket to inside of tensioner bracket. Remove belt tension bracket (Fig. 1).

4. Remove capscrew and washer securing cutting unit drive pulley to reel shafts.

5. Loosen wing screw securing plastic coupler to jack shaft (Fig. 2).

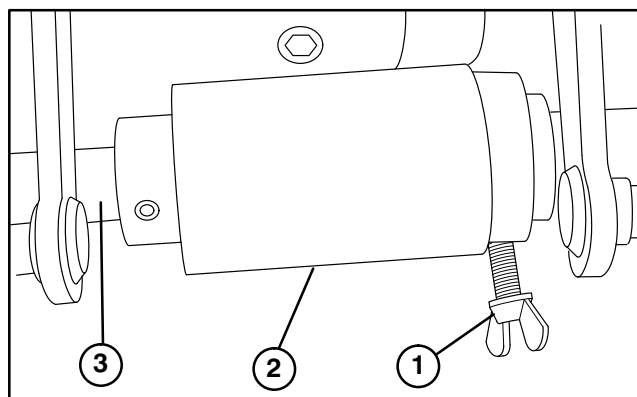

Figure 2

1. Wing screw
2. Coupler
3. Jackshaft

6. Move coupler to the left on shaft.
7. Remove cutting unit drive belts from jackshaft pulleys and cutting unit drive pulleys.
8. Install new cutting unit drive pulleys to reel shafts and secure with capscrews and washers previously removed (Fig. 3). Tighten socket head set screw and jam nut on each pulley.

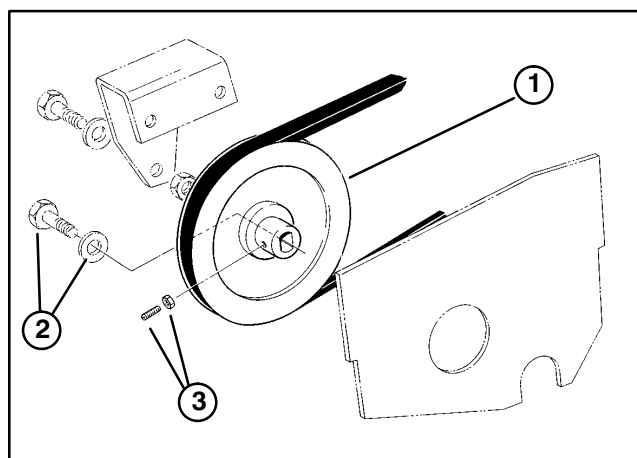

Figure 3

1. Pulley
2. Capscrew & flatwasher
3. Socket head set screw & jam nut

9. Install new belts onto jackshaft pulleys and cutting unit drive pulleys (Fig. 3).

10. Slide coupler to the right, aligning with hole in shaft for wing screw and tighten screw.

11. Reinstall tension bracket to inside of tensioner bracket with a capscrew, washer and nut.

12. Insert tension rod ball joint onto tension bracket pin and secure with a washer and capscrew.

13. The cutting unit drive belts should have a deflection of 1/2 inch with a 10 pound load applied.

14. Loosen jam nut on end of belt tension rod. Rotate rod to lengthen or shorten rod to desired length. Tighten jam nut.

15. If cutting units are equipped with pulley cleaners or pulley cleaners are to be installed, proceed as follows:

A. Loosely mount a pulley debris cleaner bracket to the underside of a pulley debris cleaner support with a carriage bolt and flange locknut as shown in figure 4. Position bracket so bend in bracket faces downward.

B. Remove locknut from capscrew securing bottom of skid to left side of cutting unit.

C. Loosely secure pulley debris cleaner support onto skid mounting capscrew with external tooth lockwasher and locknut as shown in figure 4.

D. Adjust cleaner bracket so it is centered in groove of pulley and tighten carriage bolt and locknut.

E. Adjust cleaner bracket so there is approximately .030 – .060" clearance between bracket and pulley, then tighten capscrew and locknut.

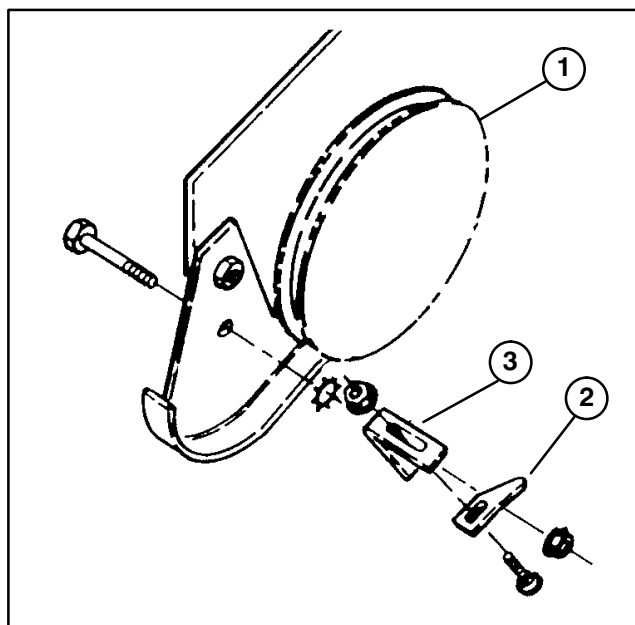

Figure 4

- 1. Pulley
- 2. Pulley debris cleaner bracket
- 3. Pulley debris cleaner support