



Canopy Kit

4-passenger Workman® GTX Utility Vehicle

Model No. 07141—Serial No. 400000000 and Up

Installation Instructions

⚠ WARNING

CALIFORNIA Proposition 65 Warning

This product contains a chemical or chemicals known to the State of California to cause cancer, birth defects, or reproductive harm.

Installation

1

Preparing the Machine

No Parts Required

Procedure

1. Park the machine on a level surface.
2. Engage the parking brake.
3. Shut off the engine and remove the key.
4. Remove the seats.
5. Disconnect the battery; refer to your *Operator's Manual*.
6. Raise the cargo bed to the dump position and secure it with the prop rod.



2

Installing the Kit

Parts needed for this procedure:

1	Left loop bracket
1	Right loop bracket
2	Tube
1	Left windshield support
1	Right windshield support
1	Left, rear plate
1	Right, rear plate
1	Left, front plate
1	Right, front plate
1	Left corner gusset
1	Right corner gusset
1	Rear crosslink
1	Front crosslink
2	Backing plate
2	Crosslink tube
38	Flange nut (5/16 inch)
4	Flange nut (1/4 inch)
20	Carriage bolt (5/16 x 1-3/4 inches)
4	Hex-flange bolt (3/8 x 1 inch)
4	Flange nut (3/8 inch)
2	Hex-flange bolt (5/16 x 1 inch)
4	Carriage bolt (5/16 x 1 inch)
4	Clip
1	Sunshade
6	Sealing washer
6	Hex-flange bolt (1/4 x 1 inch)
2	Spacer (9/32 x 5/8 inch)
2	Flat washer
2	Hex-head bolt (1/4 x 2-1/2 inches)
2	Mounting plate
8	Carriage bolt (5/16 x 2 inches)
4	Plastic washer
2	Flange bushing
2	Friction washer
4	Carriage bolt (5/16 x 3/4 inch)
2	Roof-support bracket
2	Self-tapping screw (1/4 x 1/2 inch)
1	Front support
2	Hex-flange bolt (1/4 x 1-1/2 inches)

Procedure

Note: Do not tighten any fasteners except when instructed.

1. Install the left loop bracket as follows:
 - A. Remove the rivet from left panel behind the rear seat base (Figure 1).
 - B. Install the left loop bracket using 2 hex-flange bolts ($3/8 \times 1$ inch) and 2 nuts ($3/8$ inch) as shown in Figure 1.

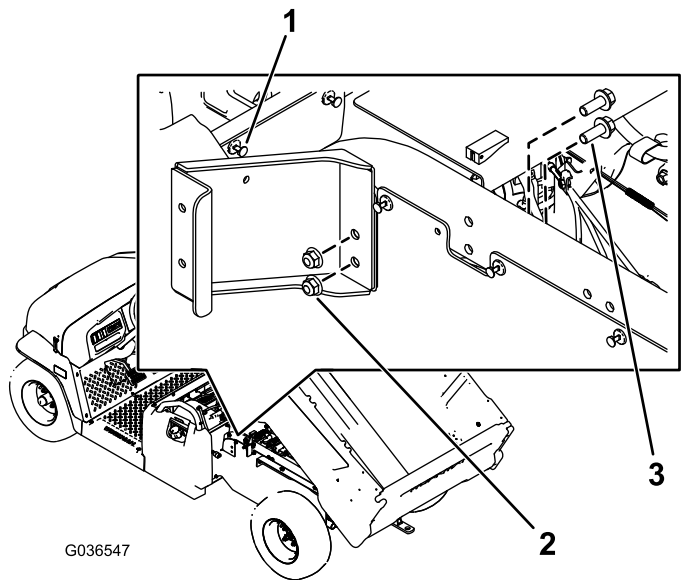

Figure 1

1. Rivet
2. Nut ($3/8$ inch)
3. Bolt ($3/8 \times 1$ inch)

- C. Secure the bracket behind the rear seat base using 1 hex-head bolt ($1/4 \times 2-1/2$ inches), 1 flat washer ($5/16$ inch), 1 spacer ($9/32 \times 5/8$ inch), and 1 flange nut ($1/4$ inch) as shown in Figure 2.

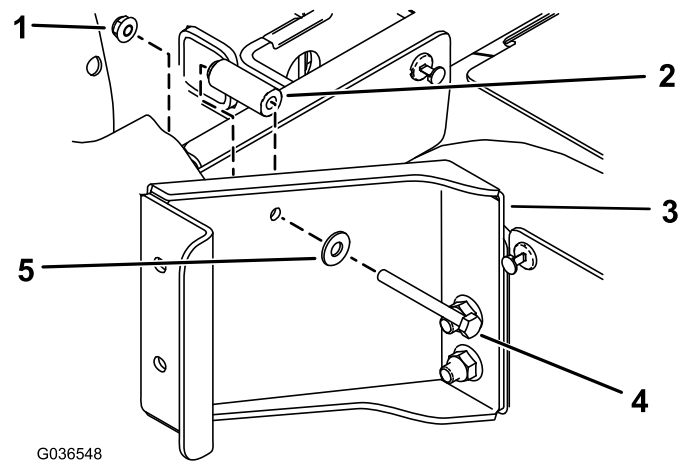

Figure 2

1. Flange nut ($1/4$ inch)
2. Spacer ($9/32 \times 5/8$ inch)
3. Left loop bracket
4. Hex-head bolt ($1/4 \times 2-1/2$ inches)
5. Flat washer ($5/16$ inch)

- D. Repeat this step to install the right loop bracket on the right side of the machine.
2. Using the dimensions shown in Figure 3, drill 2 holes ($5/16$ inch) into the outside of the floor plate on the left and right sides of the machine.

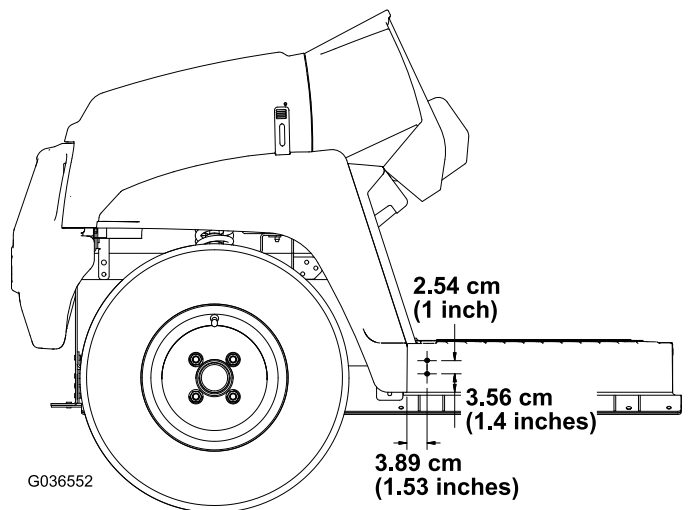

Figure 3

- Using the dimensions shown in [Figure 4](#), drill 1 hole (5/16 inch) into the outside of the footboard on the left and right sides of the machine.

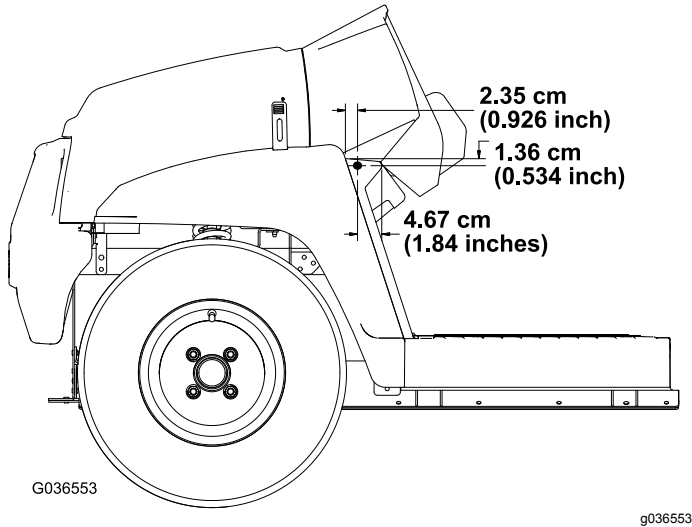

Figure 4

- Secure the middle bracket of the windshield support to the machine using 2 hex-flange bolts (5/16 x 1 inch) and 2 nuts (5/16 inch) in the holes you drilled ([Figure 5](#)).

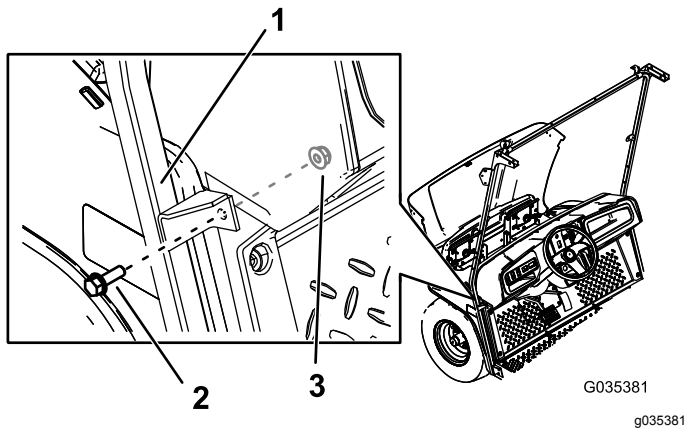

Figure 5

- Windshield support
- Hex-flange bolt
- Nut (inside dash frame)

- Secure the lower bracket of the windshield support to the left side of the machine using 4 carriage bolts (5/16 x 1 inch) and 4 flange nuts (5/16 inch) in the holes you drilled in step 2 ([Figure 6](#)).

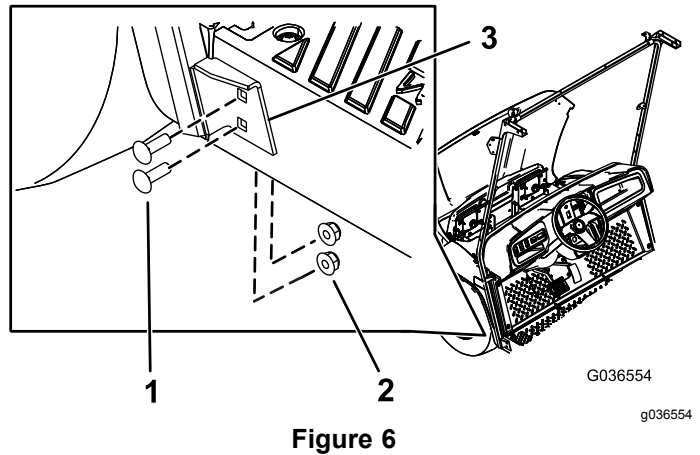

Figure 6

- Carriage bolt (5/16 x 1 inch)
- Flange nut (5/16 inch)
- Lower bracket of windshield support

- Loosely install the rear tubes to the rear loop brackets using 8 carriage bolts (5/16 x 2 inches), 2 mounting plates, and 8 nuts (5/16 inch) as shown in [Figure 7](#).

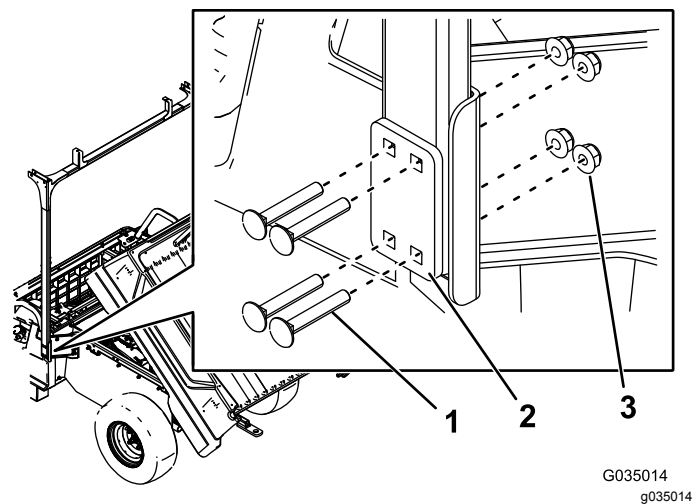

Figure 7

- Carriage bolt (5/16 x 2 inches)
- Mounting plate
- Nut (5/16 inch)

7. Loosely install the left and right rear plates to the tubes using 4 carriage bolts (5/16 x 1-3/4 inches), 2 backing plates, and 4 flange nuts (5/16 inch) as shown in [Figure 8](#).

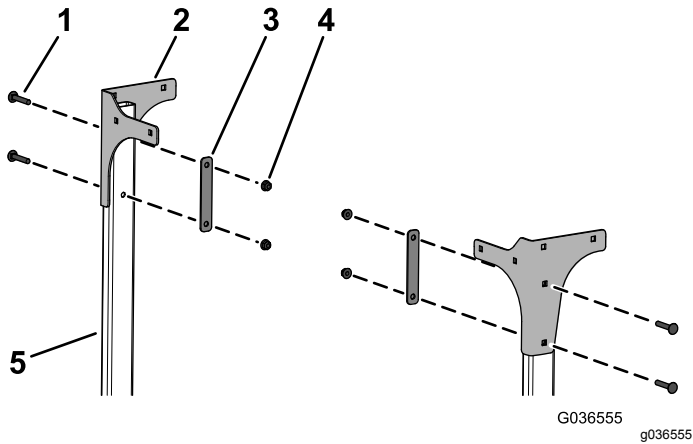

Figure 8

- | | |
|--|---------------------------|
| 1. Carriage bolt (5/16 x 1-3/4 inches) | 4. Flange nut (5/16 inch) |
| 2. Rear plate | 5. Tube |
| 3. Backing plate | |

8. Loosely install the left and right front plates and corner gussets to the crosslink tubes and the left and right windshield supports using 8 carriage bolts (5/16 x 1-3/4 inches) and 8 flange nuts (5/16 inch) as shown in [Figure 9](#).

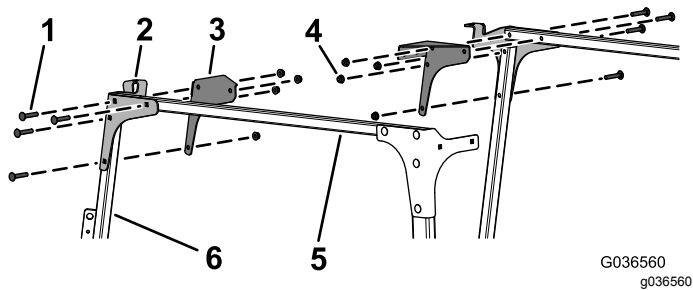

Figure 9

- | | |
|--|---------------------------|
| 1. Carriage bolt (5/16 x 1-3/4 inches) | 4. Flange nut (5/16 inch) |
| 2. Front plate | 5. Crosslink tube |
| 3. Corner gusset | 6. Windshield support |

9. Loosely install the rear crosslink to the crosslink tubes and rear plates using 4 carriage bolts (5/16 x 1-3/4 inches), 4 carriage bolts (5/16 x 3/4 inch), and 8 flange nuts (5/16 inch) as shown in [Figure 10](#).

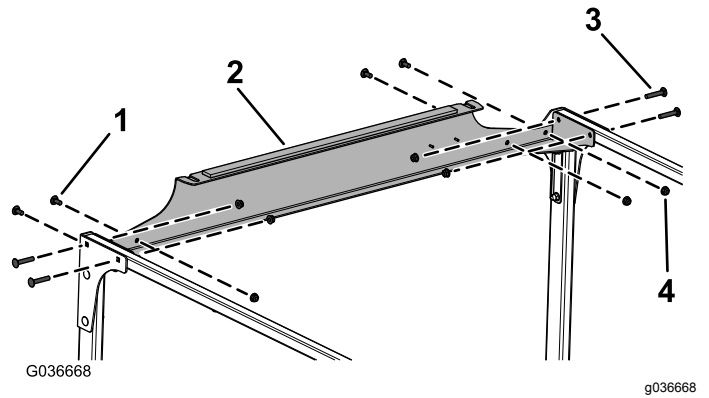

Figure 10

- | | |
|------------------------------------|--------------------------------------|
| 1. Carriage bolt (5/16 x 3/4 inch) | 3. Carriage bolt (5/16 x 1-3/4 inch) |
| 2. Rear crosslink | 4. Flange nut (5/16 inch) |

10. Loosely install the front crosslink to the front plates and corner gussets using 4 carriage bolts (5/16 x 1-3/4 inch) and 4 flange nuts (5/16 inch) as shown in [Figure 11](#).

11. Install the front support to the front crosslink using 2 hex-flange bolts (1/4 x 1-1/2 inches) and 2 flange nuts (1/4 inch) as shown in [Figure 11](#).

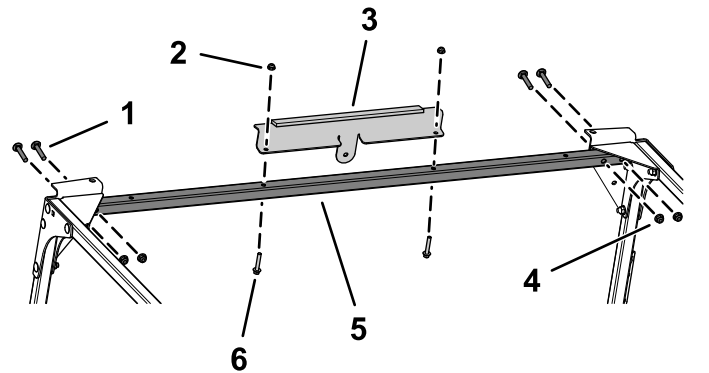

Figure 11

- | | |
|--------------------------------------|--|
| 1. Carriage bolt (5/16 x 1-3/4 inch) | 4. Flange nut (5/16 inch) |
| 2. Flange nut (1/4 inch) | 5. Front crosslink |
| 3. Front support | 6. Hex-flange bolts (1/4 x 1-1/2 inches) |

12. Tighten all loose fasteners.
13. Install the 2 roof-support brackets to the crosslink tubes using 2 self-tapping screws (1/4 x 1/2 inch) as shown in [Figure 12](#).

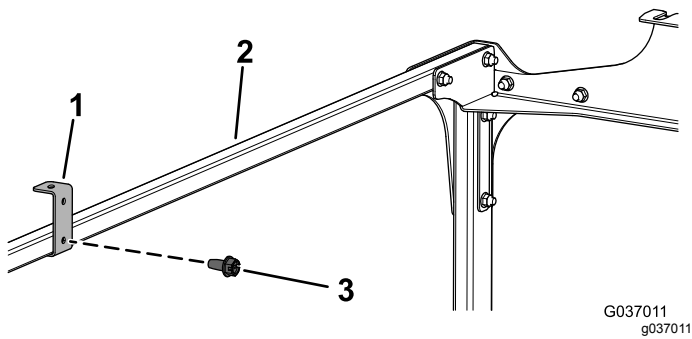

Figure 12

- | | |
|-------------------------|--|
| 1. Roof-support bracket | 3. Self-tapping screw (1/4 x 1/2 inch) |
| 2. Crosslink tube | |

14. Set the sunshade down.
15. Using the hole in the top of the roof-support bracket as the template, drill a 7.9 mm (5/16 inch) hole on each side of the sunshade ([Figure 13](#)).

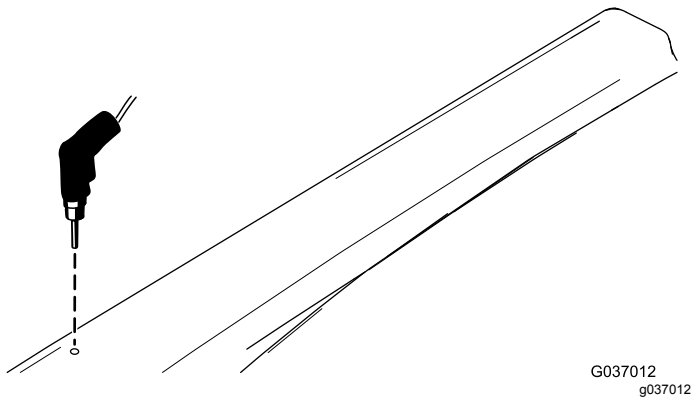

Figure 13

16. Install the sunshade to the roof-support bracket using 2 clips, 2 sealing washers, and 2 hex-flange bolts (1/4 x 1 inch) as shown in [Figure 14](#).

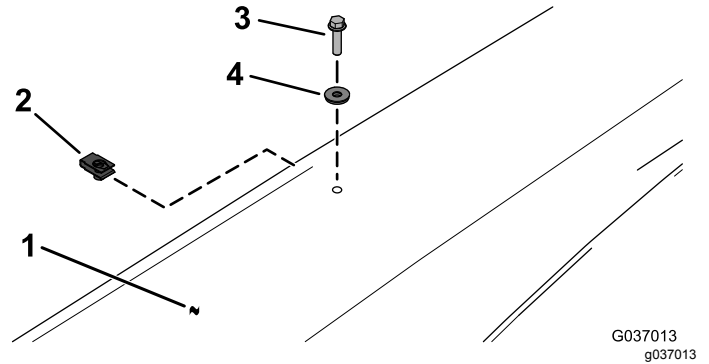

Figure 14

- | | |
|-------------|-----------------------------------|
| 1. Sunshade | 3. Hex-flange bolt (1/4 x 1 inch) |
| 2. Clip | 4. Sealing washer |

17. Install the sunshade to the front plates using 2 clips, 2 sealing washers, and 2 hex-flange bolts (1/4 x 1 inch) as shown in [Figure 15](#).

Important: Apply thread-locking compound to the hex-flange bolts (1/4 x 1 inch) before installing.

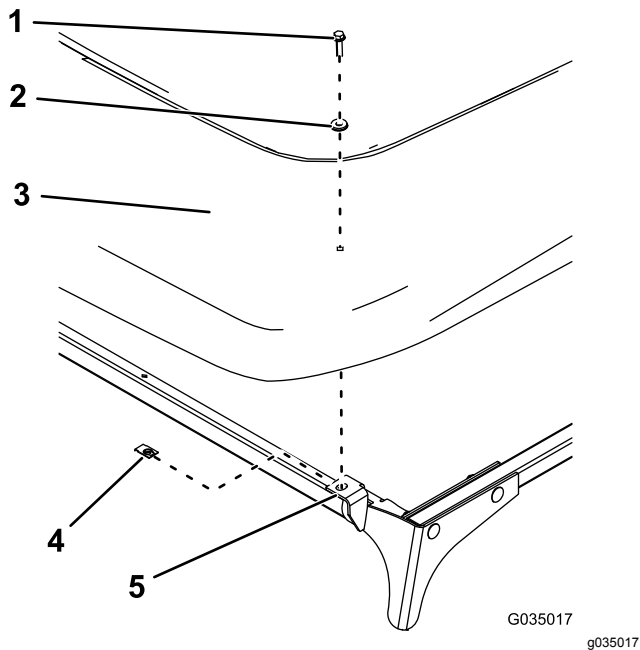

Figure 15

- | | |
|-----------------------------------|----------------|
| 1. Hex-flange bolt (1/4 x 1 inch) | 4. Clip |
| 2. Sealing washer | 5. Front plate |
| 3. Sunshade | |

18. Install the sunshade to the rear crosslink using 2 hex-flange bolts (1/4 x 1 inch), 2 sealing washers, 2 friction washers, 4 plastic washers, and 2 flange bushings ([Figure 16](#)).

Important: Apply thread-locking compound to the hex-flange bolts (1/4 x 1 inch) before installing.

Important: Ensure that the plastic washers are installed onto the top and bottom of the sunshade, as this prevents damaging the sunshade.

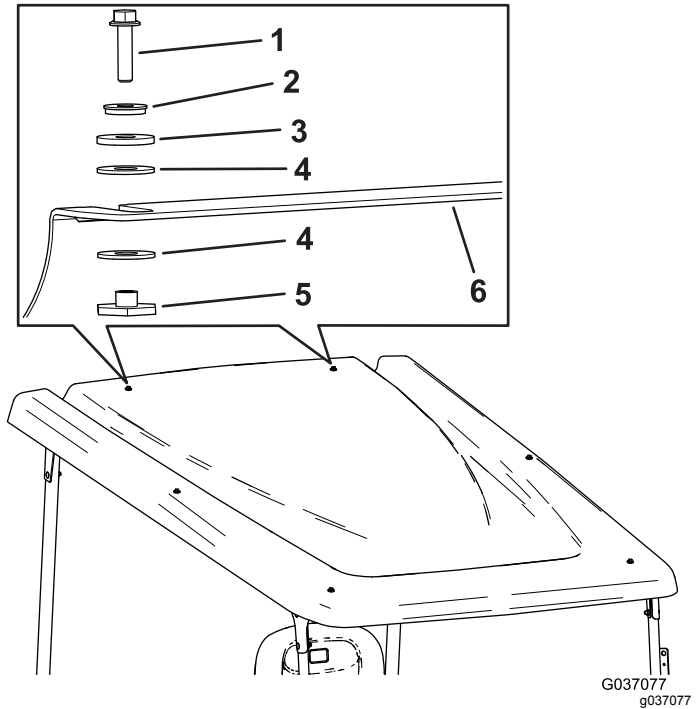

Figure 16

- | | |
|-----------------------------------|-------------------|
| 1. Hex-flange bolt (1/4 x 1 inch) | 4. Plastic washer |
| 2. Sealing washer | 5. Flange bushing |
| 3. Friction washer | 6. Rear crosslink |

19. Connect the battery; refer to your *Operator's Manual*.



The Toro Warranty

A Two-Year Limited Warranty

Conditions and Products Covered

The Toro Company and its affiliate, Toro Warranty Company, pursuant to an agreement between them, jointly warrant your Toro Commercial product ("Product") to be free from defects in materials or workmanship for two years or 1500 operational hours*, whichever occurs first. This warranty is applicable to all products with the exception of Aerators (refer to separate warranty statements for these products). Where a warrantable condition exists, we will repair the Product at no cost to you including diagnostics, labor, parts, and transportation. This warranty begins on the date the Product is delivered to the original retail purchaser.

* Product equipped with an hour meter.

Instructions for Obtaining Warranty Service

You are responsible for notifying the Commercial Products Distributor or Authorized Commercial Products Dealer from whom you purchased the Product as soon as you believe a warrantable condition exists. If you need help locating a Commercial Products Distributor or Authorized Dealer, or if you have questions regarding your warranty rights or responsibilities, you may contact us at:

Toro Commercial Products Service Department
Toro Warranty Company
8111 Lyndale Avenue South
Bloomington, MN 55420-1196

952-888-8801 or 800-952-2740
E-mail: commercial.warranty@toro.com

Owner Responsibilities

As the Product owner, you are responsible for required maintenance and adjustments stated in your *Operator's Manual*. Failure to perform required maintenance and adjustments can be grounds for disallowing a warranty claim.

Items and Conditions Not Covered

Not all product failures or malfunctions that occur during the warranty period are defects in materials or workmanship. This warranty does not cover the following:

- Product failures which result from the use of non-Toro replacement parts, or from installation and use of add-on, or modified non-Toro branded accessories and products. A separate warranty may be provided by the manufacturer of these items.
- Product failures which result from failure to perform recommended maintenance and/or adjustments. Failure to properly maintain your Toro product per the Recommended Maintenance listed in the *Operator's Manual* can result in claims for warranty being denied.
- Product failures which result from operating the Product in an abusive, negligent, or reckless manner.
- Parts subject to consumption through use unless found to be defective. Examples of parts which are consumed, or used up, during normal Product operation include, but are not limited to, brake pads and linings, clutch linings, blades, reels, rollers and bearings (sealed or greasable), bed knives, spark plugs, castor wheels and bearings, tires, filters, belts, and certain sprayer components such as diaphragms, nozzles, and check valves, etc.
- Failures caused by outside influence. Conditions considered to be outside influence include, but are not limited to, weather, storage practices, contamination, use of unapproved fuels, coolants, lubricants, additives, fertilizers, water, or chemicals, etc.
- Failure or performance issues due to the use of fuels (e.g. gasoline, diesel, or biodiesel) that do not conform to their respective industry standards.

- Normal noise, vibration, wear and tear, and deterioration.
- Normal "wear and tear" includes, but is not limited to, damage to seats due to wear or abrasion, worn painted surfaces, scratched decals or windows, etc.

Parts

Parts scheduled for replacement as required maintenance are warranted for the period of time up to the scheduled replacement time for that part. Parts replaced under this warranty are covered for the duration of the original product warranty and become the property of Toro. Toro will make the final decision whether to repair any existing part or assembly or replace it. Toro may use remanufactured parts for warranty repairs.

Deep Cycle and Lithium-Ion Battery Warranty:

Deep cycle and Lithium-Ion batteries have a specified total number of kilowatt-hours they can deliver during their lifetime. Operating, recharging, and maintenance techniques can extend or reduce total battery life. As the batteries in this product are consumed, the amount of useful work between charging intervals will slowly decrease until the battery is completely worn out. Replacement of worn out batteries, due to normal consumption, is the responsibility of the product owner. Battery replacement may be required during the normal product warranty period at owner's expense. Note: (Lithium-Ion battery only): A Lithium-Ion battery has a part only prorated warranty beginning year 3 through year 5 based on the time in service and kilowatt hours used. Refer to the *Operator's Manual* for additional information.

Maintenance is at Owner's Expense

Engine tune-up, lubrication, cleaning and polishing, replacement of filters, coolant, and completing recommended maintenance are some of the normal services Toro products require that are at the owner's expense.

General Conditions

Repair by an Authorized Toro Distributor or Dealer is your sole remedy under this warranty.

Neither The Toro Company nor Toro Warranty Company is liable for indirect, incidental or consequential damages in connection with the use of the Toro Products covered by this warranty, including any cost or expense of providing substitute equipment or service during reasonable periods of malfunction or non-use pending completion of repairs under this warranty. Except for the Emissions warranty referenced below, if applicable, there is no other express warranty. All implied warranties of merchantability and fitness for use are limited to the duration of this express warranty.

Some states do not allow exclusions of incidental or consequential damages, or limitations on how long an implied warranty lasts, so the above exclusions and limitations may not apply to you. This warranty gives you specific legal rights, and you may also have other rights which vary from state to state.

Note regarding engine warranty:

The Emissions Control System on your Product may be covered by a separate warranty meeting requirements established by the U.S. Environmental Protection Agency (EPA) and/or the California Air Resources Board (CARB). The hour limitations set forth above do not apply to the Emissions Control System Warranty. Refer to the Engine Emission Control Warranty Statement supplied with your product or contained in the engine manufacturer's documentation for details.

Countries Other than the United States or Canada

Customers who have purchased Toro products exported from the United States or Canada should contact their Toro Distributor (Dealer) to obtain guarantee policies for your country, province, or state. If for any reason you are dissatisfied with your Distributor's service or have difficulty obtaining guarantee information, contact the Toro importer.