



# High Height-of-Cut Kit

## Reelmaster® 5010 and 3100 Series Cutting Units

Model No. 110-9600

### Installation Instructions

# Installation

## Loose Parts

Use the chart below to verify that all parts have been shipped.

Description	Qty.	Use
Right height-of-cut bracket	1	Install the kit.
Left height-of-cut bracket	1	
Adjuster bolt (3/8 x 2-3/4 inches)	2	
Washer	4	
Flange nut (3/8 inch)	2	
Flange nut	2	
Bolt	2	
Flange nut	2	
Spacer	8	
Carriage bolt (5/16 x 4 inches)	4	
Flange nut (5/16 inch)	4	

## Installing the Kit

1. Park the traction unit on a level surface, lower the cutting units, engage the parking brake, shut off the engine and remove the key.
2. Remove the carriage bolts and nuts securing the height-of-cut brackets to the cutting-unit side plates ([Figure 1](#)).
3. Remove the height-of-cut brackets and the front roller from the cutting-unit side plates ([Figure 1](#)).
4. Loosen the jam nuts and screws securing the height-of-cut brackets to the front roller shaft and remove the brackets from the roller ([Figure 1](#)).
5. Install the 2 washers and a flange nut (3/8 inch) onto each kit height-of-cut adjuster bolt as shown in [Figure 2](#).

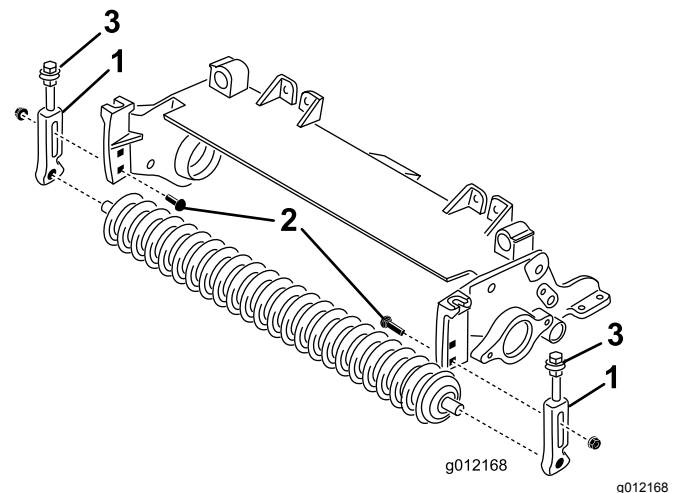

**Figure 1**

1. Height-of-cut bracket
  2. Carriage bolt
  3. Height-of-cut adjuster bolt
6. Thread a kit height-of-cut adjuster bolt into each kit height-of-cut bracket ([Figure 2](#)).



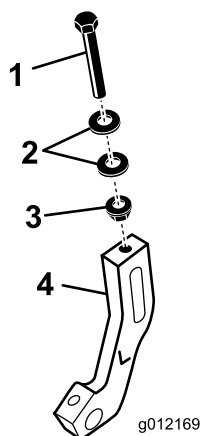

**Figure 2**

- |                                |                          |
|--------------------------------|--------------------------|
| 1. Height-of-cut adjuster bolt | 3. Flange nut (3/8 inch) |
| 2. Washer (2)                  | 4. Height-of-cut bracket |

7. Loosely install the kit height-of-cut brackets to the existing front roller with the bolts (5/16 x 1-1/8 inches) and flange-head locknuts (5/16 inch). Position the height-of-cut brackets as shown in [Figure 3](#) and [Figure 4](#).

**Note:** The left height-of-cut bracket is marked with an L and the right bracket is marked with an R.

8. Using the lower square hole in each side plate, loosely mount the height-of-cut brackets to the cutting-unit side plates with the carriage bolts previously removed in step 2 and the 2 kit flange nuts (3/8 inch) as shown in [Figure 4](#).
9. Tighten the locknut on the height-of-cut adjuster bolt until the washers contact the side plate flange, then back-off the nut 1/2 turn ([Figure 3](#)).

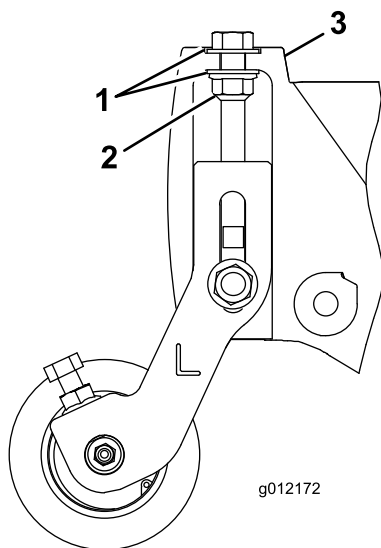

**Figure 3**

- |            |                      |
|------------|----------------------|
| 1. Washer  | 3. Side plate flange |
| 2. Locknut |                      |

10. Center the roller between the height-of-cut brackets and lock it in place with the bolts and locknuts on the brackets ([Figure 4](#)).

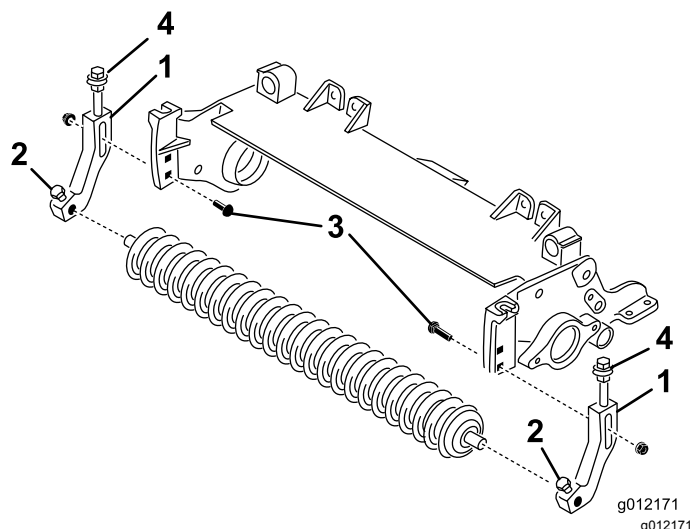
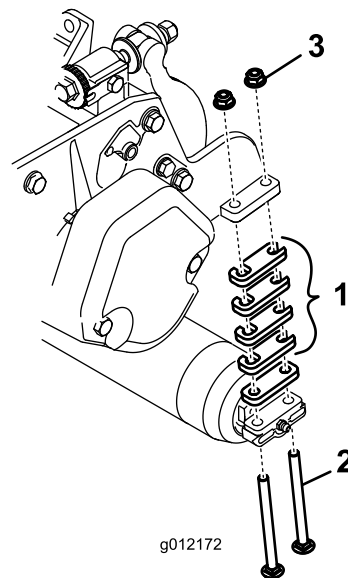

**Figure 4**

- |                          |                                |
|--------------------------|--------------------------------|
| 1. Height-of-cut bracket | 3. Carriage bolt               |
| 2. Bolts and locknut     | 4. Height-of-cut adjuster bolt |

11. Adjust the height and aggressiveness of cut according to the instructions in the cutting unit *Operator's Manual*.

**Note:** Use the spacers, carriage bolts, and nuts included in the kit to attain a height of cut above 1 inch ([Figure 5](#)).



**Figure 5**

- |                   |         |
|-------------------|---------|
| 1. Spacers        | 3. Nuts |
| 2. Carriage bolts |         |

**Note:** You can order parts to attain higher heights-of-cut listed in the cutting unit *Operator's Manual*; contact your authorized Toro distributor.