



Power Harness Kit

Multi Pro® 1750 Turf Sprayer

Model No. 138-2999

Installation Instructions

Installation

Loose Parts

Use the chart below to verify that all parts have been shipped.

Procedure	Description	Qty.	Use
1	No parts required	—	Prepare the machine.
2	No parts required	—	Disconnect the battery.
3	Power harness Relay	1 1	Assemble the relay and fuse to the power harness.
4	Cable tie	5	Route the power harness.
5	No parts required	—	Assemble the ring terminals to the battery cables.
6	Cable tie	1	Connect the power harness to the sunshade wire harness.
7	No parts required	—	Connect the battery.

1

Preparing the Machine

No Parts Required

Procedure

1. Park the machine on a level surface.
2. Engage the parking brake.
3. Shut off the engine and remove the key.



2

Disconnecting the Battery

No Parts Required

Procedure

⚠ WARNING

Electrical sparks can cause the battery gasses to explode, resulting in personal injury.

Incorrect battery cable routing could damage the machine and cables, causing sparks.

- Always disconnect the negative (black) battery cable before disconnecting the positive (red) cable.
- Always connect the positive (red) battery cable before connecting the negative (black) cable.

⚠ WARNING

Battery terminals or metal tools could short against metal components, causing sparks.

- When removing or installing the battery, do not allow the battery terminals to touch any metal parts of the machine.
- Do not allow metal tools to short between the battery terminals and metal parts of the machine.
- Always keep the battery strap in place to protect and secure the battery.

1. Unlatch the seat by pushing the seat-latch handle rearward (Figure 1).

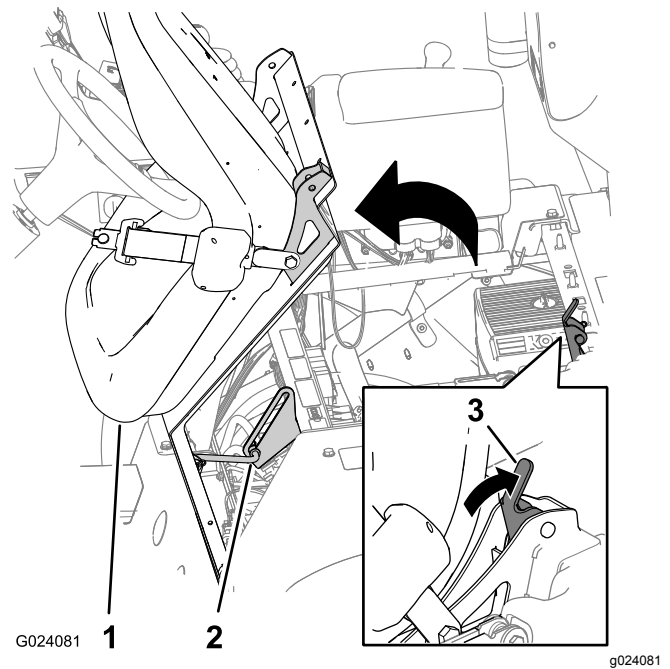

Figure 1

- | | |
|-------------|----------------------|
| 1. Seat | 3. Seat-latch handle |
| 2. Prop rod | |

2. Rotate the seat and seat plate forward until the end of the prop rod, at the prop-rod bracket, is at the bottom of the slot in the bracket (Figure 1).
3. Remove the bolt and nut that secures the terminal of the negative battery cable to the negative post of the battery.
4. Slide back the insulator cover and remove the bolt and nut that secures the terminal of the positive battery cable to the positive post of the battery (Figure 2).

Note: Ensure that the terminals of the battery cables do not touch the battery posts.

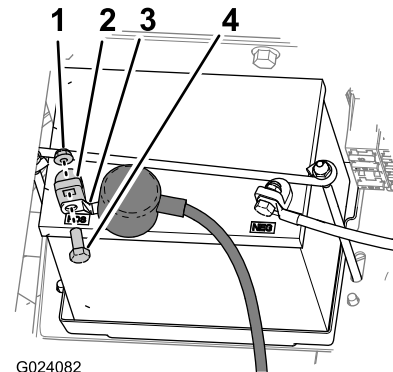

Figure 2

- | | |
|-----------------|--------------------------------------|
| 1. Nut | 3. Terminal (positive battery cable) |
| 2. Battery post | 4. Bolt |

Note: Keep the seat in the forward position.

3

Assembling the Relay and Fuse to the Power Harness

Parts needed for this procedure:

1	Power harness
1	Relay

Procedure

1. Assemble the relay into the 4-contact connector of the power harness (Figure 3).
2. Insert the fuse (60 A) into the socket of the fuse-holder for the power harness (Figure 3).

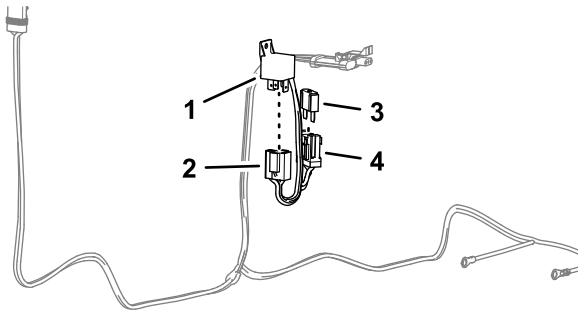

Figure 3

g251880

- | | |
|--|--------------------------------|
| 1. Relay | 3. Fuse (60 A) |
| 2. 4-contact connector (power harness) | 4. Fuse holder (power harness) |

4

Routing the Power Harness

Parts needed for this procedure:

5	Cable tie
---	-----------

Procedure

1. Starting from the battery, route the power harness under and along the shock-support tube (Figure 4).

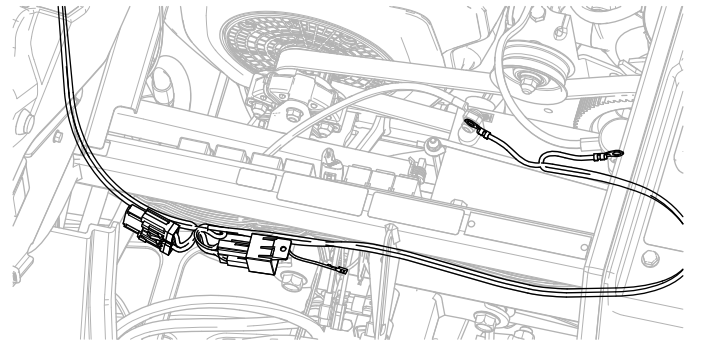

g252322

Figure 4

2. Route the power harness under the right side of the shock-support tube and under the bottom console cover (Figure 5).

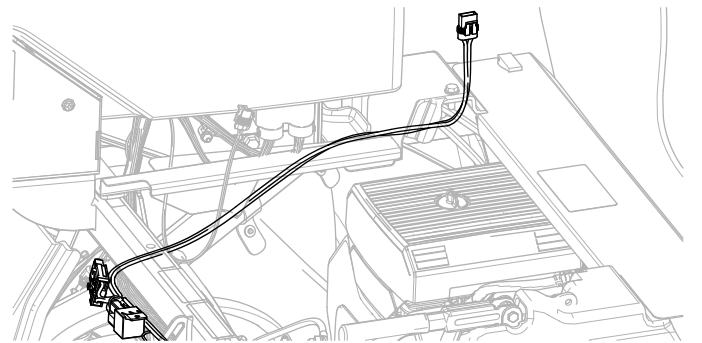

g252323

Figure 5

3. Secure the power harness to the machine using 5 cable ties.

5

Assembling the Ring Terminals to the Battery Cables

No Parts Required

Procedure

1. At the positive and negative battery cables, remove the battery-clamp nuts from the short side of the battery clamp bolts.
2. Assemble the ring terminal of the power harness for the wire labeled BATTERY (-) onto the battery clamp bolt for the negative battery cable with a battery-clamp nut (Figure 6).

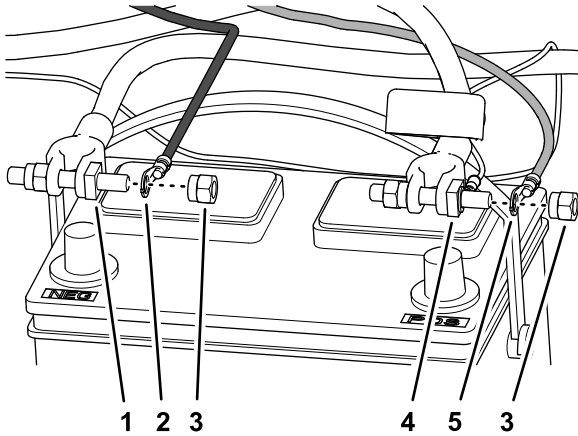

Figure 6

- | | |
|--|--|
| 1. Battery clamp bolt (negative battery cable) | 4. Battery clamp bolt (positive battery cable) |
| 2. Ring terminal—power harness BATTERY (-) | 5. Ring terminal—power harness BATTERY (+) |
| 3. Battery-clamp nuts | |

3. Assemble the ring terminal of the power harness for the wire labeled BATTERY (+) onto the battery clamp bolt for the positive battery cable with a battery-clamp nut (Figure 6).

Note: Do not assemble the battery cables to the machine. You will connect the battery in a later step.

6

Connecting the Power Harness to the Sunshade Wire Harness

Parts needed for this procedure:

- | | |
|---|-----------|
| 1 | Cable tie |
|---|-----------|

Procedure

1. Plug the 2-socket connector of the power harness into the 2-pin connector for the sunshade wire harness (Figure 7).
2. Secure the power harness to the roll-bar tube with a cable tie (Figure 7).

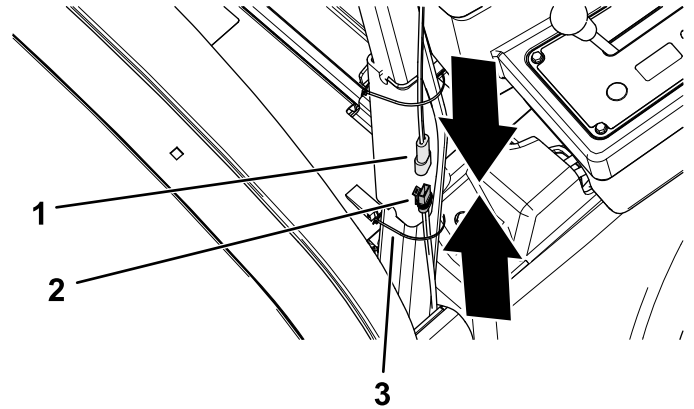

Figure 7

- | | |
|--|--------------|
| 1. 2-pin connector (sunshade wire harness) | 3. Cable tie |
| 2. 2-socket (power harness) | |

7

Connecting the Battery

No Parts Required

Procedure

⚠ WARNING

Electrical sparks can cause the battery gasses to explode, resulting in personal injury.

Incorrect battery cable routing could damage the machine and cables, causing sparks.

- Always disconnect the negative (black) battery cable before disconnecting the positive (red) cable.
 - Always connect the positive (red) battery cable before connecting the negative (black) cable.
1. Connect the positive cable to the battery and tighten the battery-clamp nut (Figure 8).
 2. Connect the negative cable to the battery and tighten the battery-clamp nut (Figure 8).
 3. Assemble the insulator over the positive battery terminal (Figure 8).

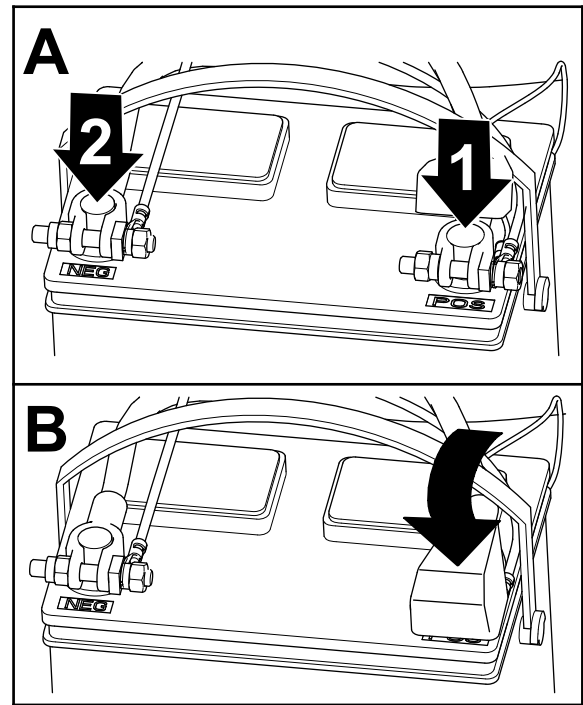

g252090

Figure 8

1. Positive battery cable
2. Negative battery cable

Notes:

Notes:



Count on it.