

Washout Port Cover Kit

PART NO. 99-8576
PART NO. TR99D8576

INSTALLATION INSTRUCTIONS

Loose Parts

Note: Use the chart below to identify parts used for assembly.

DESCRIPTION	QTY.	USE
Cover-plate	1	Installation of kit
Installation Instructions	1	Read before installing

Description

This kit is designed for use with a 44" Vac-Bagger, Model No.79305 and Model No. 716503006, used on Garden Tractor 44" decks with a washout port (Serial No. 9900001 and T9BB0001).

The washout port must be removed to install the vac-bagger counterweight. This removal leaves open holes in the top of the mower deck.

The cover plate included in this kit prevents debris from being thrown out of the open holes in the mower deck.

Installation

1. Remove the two bolts, flat washers and nuts holding the washout port to the deck and remove the washout port (Fig. 1). Save the washout port and the bolts, nuts and washers for reinstallation when removing the counterweight.

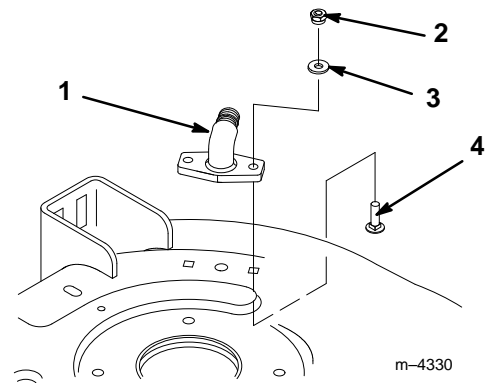

Figure 1

- | | |
|-------------------------|-----------------------------------|
| 1. Washout port | 4. 1/4-20 x 3/4" (19 mm) bolt (2) |
| 2. 1/4-20 nut (2) | |
| 3. 1/4" flat washer (2) | |

DANGER

POTENTIAL HAZARD

- Open holes in the mower expose you and others to thrown debris.

WHAT CAN HAPPEN

- Debris thrown out of holes in the mower can cause injury.

HOW TO AVOID THE HAZARD

- Never operate mower without hardware mounted in all holes in mower.
- Install hardware in mounting holes when the washout port is removed.

2. Using one of the two bolts, washers and nuts from the washout port, install the cover plate to the deck (Fig. 2). Place the bolt up through the deck (head to underside of deck) in the hole closest to the rear of the deck. Install one end of the cover to the bolt and secure loosely with the nut and flat washer.

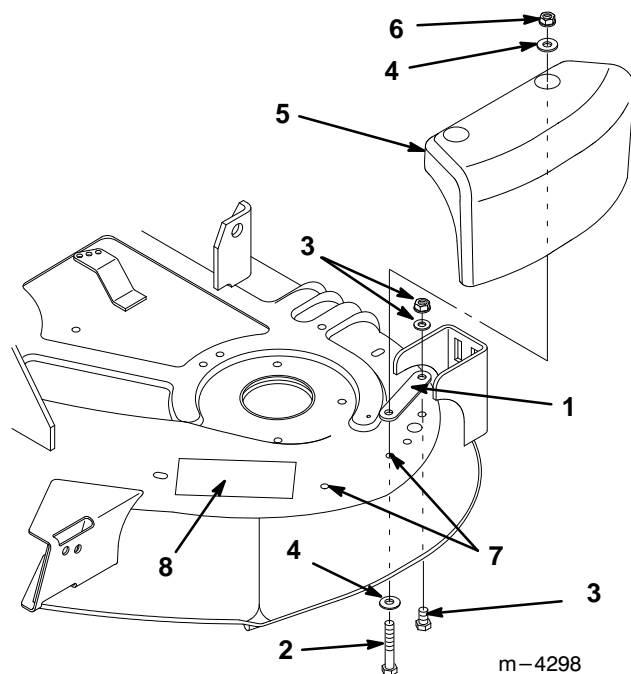

Figure 2

- | | |
|--|-----------------------|
| 1. Cover plate | 5. Counterweight |
| 2. Bolt, 3/8 x 2 1/4" (57 mm) | 6. Locknut, 3/8" |
| 3. Existing hardware from washout port | 7. Drill 13/32" holes |
| 4. Flat washer, 3/8" (10 mm) | 8. Decal |
3. Position the mower deck counterweight on the left-hand side of the mower so that it fits snugly against the side of the mower (Fig. 2).
 4. Align the rear hole in the counterweight with the front hole in the cover plate (pivot the cover plate to align) (Fig. 2).
 5. Using a punch in the holes of the counterweight, mark the locations for drilling (2) 13/32" holes. Remove the counterweight and drill the holes.
 6. Secure the counterweight to the top of the mower deck with (2) 3/8 x 2 1/4" (57 mm) bolts, (4) 3/8" (10 mm) flat washers, and (2) 3/8" locknuts.

IMPORTANT: Make certain to use washers under the heads of the two bolts, under the mower deck.

7. Tighten the rear bolt of the cover plate.
8. An extra decal is included with the bagger because the counterweight covers the original decal. Clean the mower deck surface and place this decal on the mower deck near, but not under the counterweight (Fig. 2).
9. Make certain to reinstall the washout port and (2) 3/8-16 x 3/4" (19 mm) bolts and (2) 3/8" nuts (furnished with vac bagger) in the two counterweight holes when the counterweight is removed.