



Fork Tension Kit

Out Front Z

Part No. 99-0285

INSTALLATION INSTRUCTIONS

Loose Parts

Note: Use the chart below to identify parts for assembly.

DESCRIPTION	QTY.	USE
Fork	2	Install Caster Wheel
Nut (from existing assembly)	2	
Wheel (from existing assembly)	2	
Washers (from existing assembly)	8	
Bolt (from existing assembly)	2	
Spacer (from existing assembly)	2	
Cap	2	Install Caster Wheel Assembly
Washers (from existing assembly)	6	
1/2" Spacer	2	
1" Spacer (from existing assembly)	2	
Caster Wheel Assembly	2	

Remove Existing Caster Wheel Assembly

1. Disengage the power take off (PTO), set the parking brake, and turn the ignition key to "OFF" to stop the engine. Remove the key.
2. Flip up deck and lock into vertical position.
3. Remove existing hardware and caster wheel assembly from deck frame.

Note: Keep three washers and the 1" spacer. These parts are to be used with new assembly.

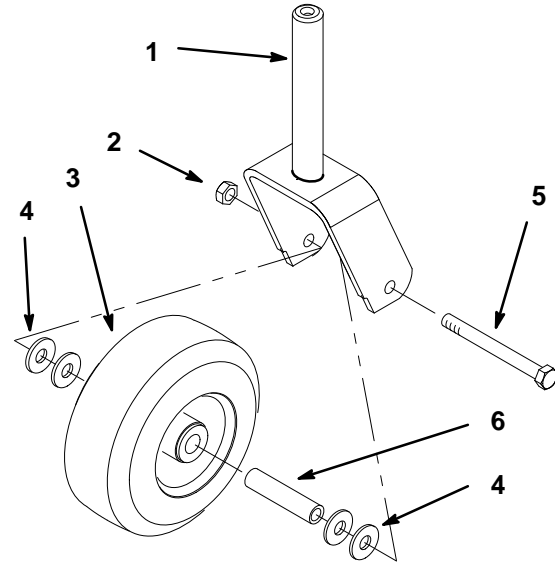

Figure 1

- | | |
|-----------------|-----------|
| 1. Fork (New) | 4. Washer |
| 2. Nut | 5. Bolt |
| 3. Caster Wheel | 6. Spacer |

Remove and install Caster Wheel

1. Remove hardware and caster wheel from existing fork assembly. Discard fork.
2. Install caster wheel into new fork. Use existing hardware to assemble (Fig. 1).

Install new Caster Wheel Assembly

1. Install fork assembly, spacers and washers as shown in figure 2. Use new and existing hardware to assemble.

Note: There must be a washer installed between cap and new spacer located on the top of the assembly (Fig. 2).

2. Screw new cap onto assembly. Tighten until the cap causes caster wheel assembly to turn (Fig.2).
3. During operation, periodically check cap and tighten if necessary to maintain tension (Fig.2).
4. Repeat all procedures for other caster wheel.

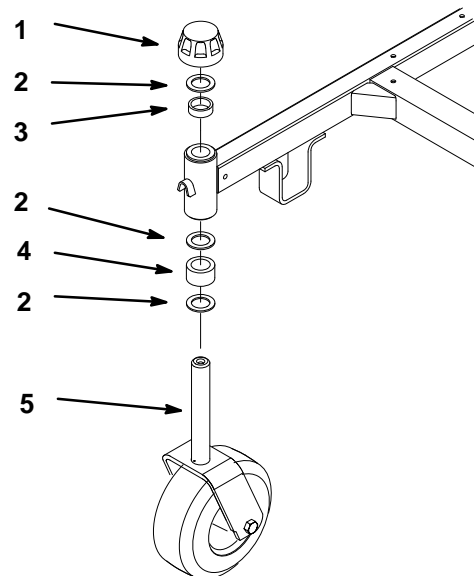

Figure 2

- | | |
|-----------------------------|--|
| 1. Cap (New) | 4. 1" (26mm) Spacer |
| 2. Washer | 5. Caster Wheel Assembly (with new fork) |
| 3. 1/2" (13mm) Spacer (New) | |