



SUPER RECYCLER® MOWER BAGGING KIT

MODEL NO. 59193
MODEL NO. 59194

INSTALLATION INSTRUCTIONS

Para obtener una versión gratis de este manual en español, escriba a la dirección indicada más abajo. Asegúrese de indicar el modelo y el número de serie de su producto.

Pour obtenir gratuitement une version en français de ce manuel, écrivez à l'adresse ci-dessous. N'oubliez pas d'indiquer les numéros de modèle et de série de votre produit.

The Toro Company, Attn: Parts Dept., 8111 Lyndale Ave S, Bloomington, MN 55420-1196

Keep this material with your Operator's Manual and refer to both documents for instructions concerning safe operation and proper maintenance procedures.

IMPORTANT: Your Recycler® mower has been updated to permit bagging. Make sure that your dealer is aware of this whenever parts are ordered or servicing is required.

Safety and Instruction Decals



Safety decals and instructions are easily visible to the operator and are located near any area of potential danger. Replace any decal that is damaged or lost.



ON REAR OF MOWER
(Part No. 100-1175)



BY DISCHARGE TUNNEL
(Part No. 99-6018)

Kit Contents

DESCRIPTION	QTY.
Discharge Tunnel Assembly	1
Spring	1
Spring Bracket	1
Grass Bag Assembly	1
Decal	2

Assembly

Installing the Discharge Tunnel

Note: Determine the left and right sides of the mower by standing behind the handles.

1. Disconnect the spark plug wire.
2. Remove and save the four bolts securing the Recycler® cover and deflector assembly to the mower (Fig. 1). Save the parts for future use.

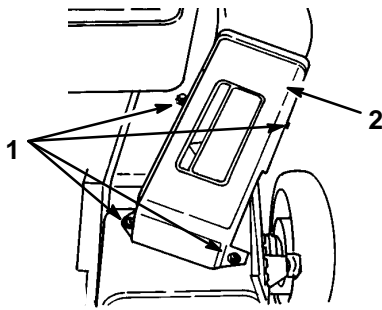

503

Figure 1

1. Bolt (4)
2. Cover and deflector assembly

3. Position the discharge tunnel and door assembly on the mower, aligning the holes in the discharge tunnel with holes in the mower (Fig. 2).

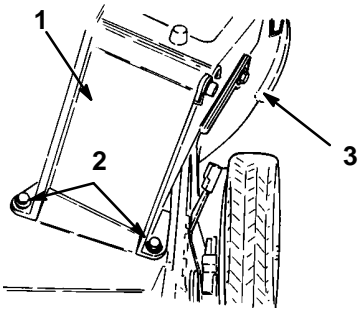

420

Figure 2

1. Discharge tunnel
2. Vertical bolts
3. Horizontal bolt

4. Fasten the front right, rear right, and rear left corners of the discharge tunnel to the mower, using the bolts saved from step 2. Ensure that the shorter horizontal bolt is installed in the front right location.
5. Secure the spring bracket and discharge tunnel to the mower with the left front bolt (Fig. 3). A socket set extension may be necessary (Fig. 4).

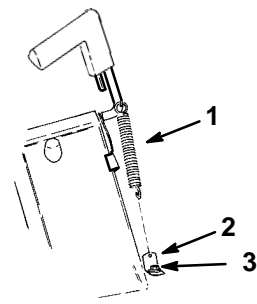

1911

Figure 3

1. Spring
2. Spring bracket
3. Left front bolt

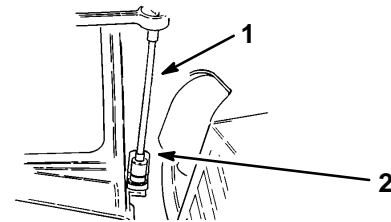

505

Figure 4

1. Socket set extension
2. Spring bracket

6. Hook the end of the spring through the small hole on the spring bracket (Fig. 3).
7. Open and close the discharge door to ensure that the spring is not contacting any part of the engine and that the door closes when the handle is released.



WARNING



POTENTIAL HAZARD

- Ensure that the spring does not contact the gas tank or any other part of the engine.

WHAT CAN HAPPEN

- Wear between the spring and engine parts may result in an unsafe operating condition.

HOW TO AVOID THE HAZARD

- If the spring contacts any part of engine, do not install the bagger kit on the mower and contact an Authorized Toro Service Dealer before proceeding.

Installing the Bagging Decal

1. Thoroughly clean the flat area of the mower behind the discharge tunnel and to the left of the tunnel with soap and water, then dry thoroughly.

2. Install the decals in the area shown in Figure 5. **Do not place the decals over the model/serial number decal.**

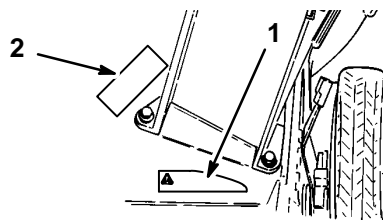

420

Figure 5

1. Location of decal number 100–1175
2. Location of decal number 99–6018

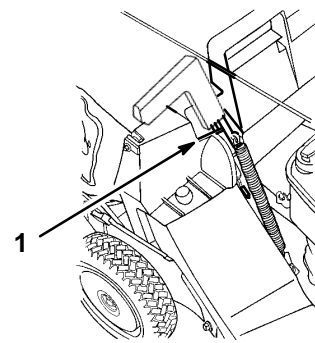

1913

Figure 7

1. Pin in bag notch

Operation

Using the Grass Bag

1. Stop the engine and wait for all moving parts to stop.
2. Ensure that the discharge door handle is fully forward and the pin is engaged in the catch (Fig. 6).

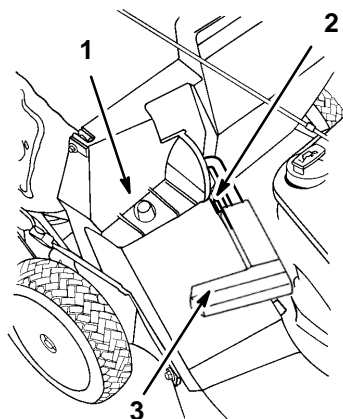

1912

Figure 6

1. Bag frame on retaining post
2. Pin contacting latch plate
3. Handle fully forward—discharge door closed

3. Slide the hole in the bag frame onto the retaining post on the discharge tunnel (Fig. 6).
4. Set the rear of the bag frame onto the lower handle.
5. Open the discharge door by, pulling the discharge door handle forward until the pin clears the ramp on the bag door and moving the handle rearward until the pin locks in the bag notch (Fig. 7).

! DANGER !

POTENTIAL HAZARD

- A worn grass bag could allow small stones and other similar debris to be thrown in operator's or bystanders direction.

WHAT CAN HAPPEN

- Thrown objects can cause serious personal injury or death to the operator or bystanders.

HOW TO AVOID THE HAZARD

- Check the grass bag frequently. If it is damaged, install a new Toro replacement bag.

! DANGER !

POTENTIAL HAZARD

- Thrown objects may result if the discharge door does not close completely.

WHAT CAN HAPPEN

- Thrown objects can cause serious personal injury or death.

HOW TO AVOID THE HAZARD

- If the discharge door cannot be closed because grass clippings clog discharge area, stop the engine and gently move the discharge door handle back and forth until the door can be closed completely. If the door still cannot be closed, remove the obstruction with a stick; not your hand.

6. Cut grass until the bag is full.

IMPORTANT: Do not overfill the bag.

7. Stop the engine and wait for all moving parts to stop.
8. Pull the discharge door handle up and out of the bag notch (Fig. 7) and pull it forward until it engages the catch (Fig. 6).

9. Remove the bag from the mower and empty the grass.

Checking the Blade Brake Clutch System

If your mower has a BBC (Blade Brake Clutch) safety system, the grass bag can be used to check for BBC system deterioration. (For additional BBC tests, refer to your operator's manual.)

1. Install the empty grass bag on the discharge tunnel.
2. Push the control bar down to the lowest position (Fig. 8).

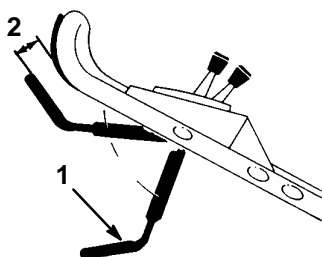

147

Figure 8

1. Control bar 2. Two inches

3. Lift the control bar to the normal "blade engaged position, about 2" below the handle. The bag should begin to inflate which indicates the blade is engaged and rotating.
4. Release the control bar. If the bag does not immediately deflate, it indicates that the blade is still rotating and deterioration of the Blade Brake Clutch mechanism may have occurred, which could result in an unsafe operating condition. Have mower inspected by an Authorized Toro Service Dealer.

Maintenance

Cleaning

Always ensure that the discharge tunnel door closes when the handle is released. If debris prevents the discharge door from closing, clean the inside of the discharge tunnel and door thoroughly. Perform all cleaning procedures described in the Operator's Manual.



DANGER



POTENTIAL HAZARD

- Thrown objects may result if the discharge door does not close completely.

WHAT CAN HAPPEN

- Thrown objects can cause serious personal injury or death.

HOW TO AVOID THE HAZARD

- If the discharge door cannot be closed because grass clippings clog the discharge area, stop the engine and gently move the discharge door handle back and forth until the door can be closed completely. If door still cannot be closed, remove the obstruction with a stick; not your hand.



DANGER



POTENTIAL HAZARD

- Grass clippings and other objects can be thrown from an open discharge tunnel.

WHAT CAN HAPPEN

- Objects thrown with enough force could cause serious personal injury or death to the operator or bystander.

HOW TO AVOID THE HAZARD

- Never open the door on the discharge tunnel when the engine is running.