



RECYCLER[®] MOWER BAGGING KIT

MODEL NO. 59299

INSTALLATION INSTRUCTIONS

Para obtener una versión gratis de este manual en español, escriba a la dirección indicada más abajo. Asegúrese de indicar el modelo y el número de serie de su producto.

Pour obtenir gratuitement une version en français de ce manuel, écrivez à l'adresse ci-dessous. N'oubliez pas d'indiquer les numéros de modèle et de série de votre produit.

The Toro Company, Attn: Parts Dept., 8111 Lyndale Ave S, Bloomington, MN 55420-1196

Keep this material with your Operator's Manual and refer to both documents for instructions concerning safe operation and proper maintenance procedures.

IMPORTANT: Your Recycler[®] mower has been updated to permit bagging. Make sure that your dealer is aware of this whenever parts are ordered or servicing is required.

Safety and Instruction Decals



Safety decals and instructions are easily visible to the operator and are located near any area of potential danger. Replace any decal that is damaged or lost.



**ON GRASS BAG
(Part No. 84-7810)**



**ON DISCHARGE TUNNEL
(Part No. 88-3360)**

Kit Contents

DESCRIPTION	QTY.
Discharge Tunnel Assembly	1
Screw, hex washer head	4
Screw, self-tapping	1
Grommet	4
Knob	1
Grass Bag Assembly	1
Installation Instruction Sheet	1

Assembly

Installing the Discharge Tunnel

1. Stop the engine and disconnect the spark plug wire.
2. Remove the knob and side cover clamp (Fig. 1).

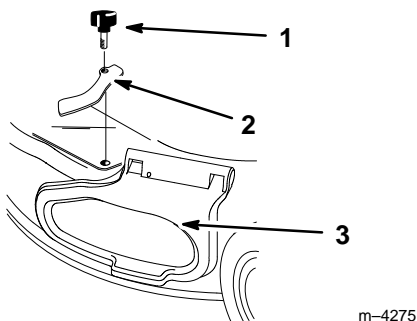

Figure 1

1. Knob
2. Side cover clamp
3. Side opening cover

3. Remove and save the three bolts securing the discharge cover to the mower (Fig. 2). Save the cover and bolts for future use.

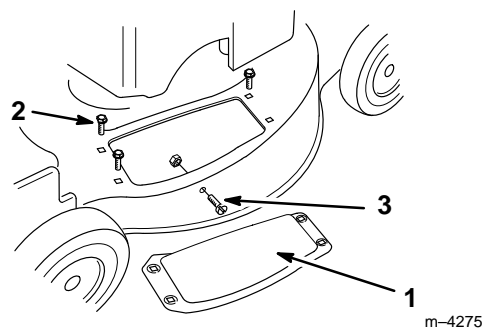

Figure 2

1. Discharge cover
2. Bolt (3)
3. Screw and nut

4. Remove the screw and nut from side of the mower (Fig. 2). Save them for future use.
5. Install four grommets supplied with the grass catcher into the four square holes in the mower (Fig. 3).

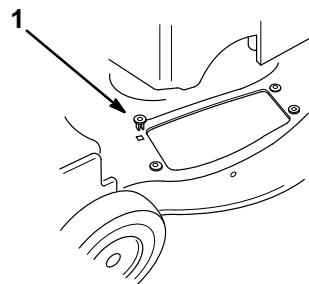

Figure 3

1. Grommet (4)

6. Insert the tongue of the discharge tunnel into the mower (Fig. 4).
7. Align the holes in the tunnel with the grommets in the mower (Fig. 4).
8. Ensure that the hole in the tongue aligns with the hole in the side of the mower (Fig. 4).

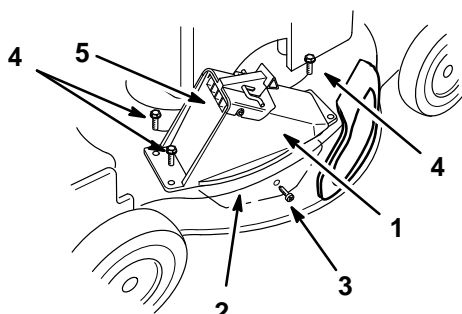

Figure 4

- | | |
|-----------------------|--------------------------|
| 1. Discharge tunnel | 4. Bolt (3) |
| 2. Tongue | 5. Discharge tunnel door |
| 3. Self-tapping screw | |

9. Install the self-tapping plastite screw supplied with the grass catcher into the side hole and tongue, and partially tighten the screw (Fig. 4).
10. Using three screws supplied with the grass catcher, fasten the discharge tunnel to the mower (Fig. 4).
11. Secure the front, right corner of the discharge tunnel and the side opening cover with the side cover clamp removed previously and the long knob supplied with the grass catcher (Fig. 5)

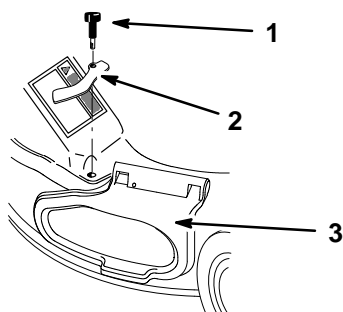

Figure 5

- | | |
|---------------------|-----------------------|
| 1. Long knob | 3. Side opening cover |
| 2. Side cover clamp | |



DANGER



POTENTIAL HAZARD

- If the side opening cover is not securely clamped in place, debris could be thrown out of the side opening.

WHAT CAN HAPPEN

- Thrown debris can cause serious personal injury or death to the operator or bystanders.

HOW TO AVOID THE HAZARD

- Always ensure that either the side opening cover is closed and locked in place by the side cover clamp or that the side discharge chute is securely seated in place before starting the lawn mower.

12. Tighten all four screws and the long knob.

13. Open and close the tunnel door to ensure that it moves freely (Fig. 4).

Installing the Grass Bag

1. Stop the engine and wait for all moving parts to stop.
2. Ensure that the discharge door handle is fully forward (door closed) (Fig. 6).



DANGER



POTENTIAL HAZARD

- Thrown objects may result if the discharge door does not close completely.

WHAT CAN HAPPEN

- Thrown objects can cause serious personal injury or death.

HOW TO AVOID THE HAZARD

- If the discharge door cannot be closed because grass clippings clog the discharge area, stop the engine and gently move the discharge door handle back and forth until the door can be closed completely. If door still cannot be closed, remove the obstruction with a stick; not your hand.

3. Fit the bag door opening over the discharge tunnel opening as shown in Figure 6.

The bag door latches should straddle the door handle, and the bag rod hook should be in front of the handle bracket.

4. Set the rear of the bag frame onto the lower handle.

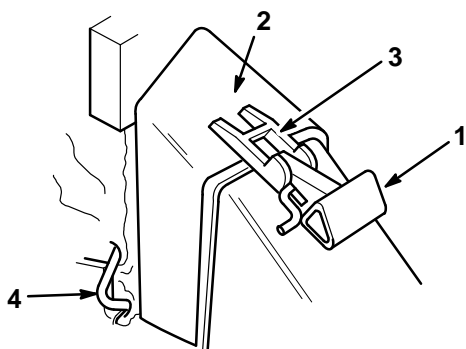

2022

Figure 6

1. Handle fully forward
2. Bag door
3. Bag door latch
4. Bag rod hook in front of handle bracket

5. Pull the handle rearward until the handle latch locks in the notch in the bag door latch (Fig. 7).

The discharge door in the mower housing is now open and the bag is locked into position. The latch should seat in bottom of the notch.

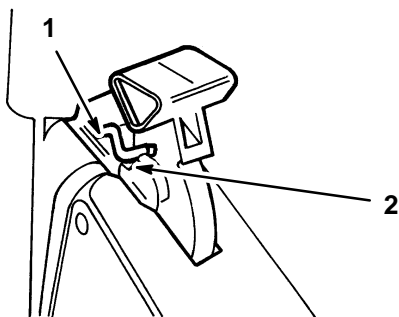

548

Figure 7

1. Handle latch locked in bag notch
2. Notch in bag door latch



DANGER



POTENTIAL HAZARD

- Grass clippings and other objects can be thrown from an open discharge tunnel.

WHAT CAN HAPPEN

- Objects thrown with enough force could cause serious personal injury or death to the operator or bystander.

HOW TO AVOID THE HAZARD

- Never open the door on the discharge tunnel when the engine is running.



DANGER



POTENTIAL HAZARD

- A worn grass bag could allow small stones and other similar debris to be thrown in operator's or bystander's direction.

WHAT CAN HAPPEN

- Thrown objects can cause serious personal injury or death to the operator or bystanders.

HOW TO AVOID THE HAZARD

- Check the grass bag frequently. If it is damaged, install a new genuine Toro replacement bag that has this or a similar warning.

Emptying the Grass Bag

1. Stop the engine and wait for all moving parts to stop.
2. Lift the door latch until it clears the bag notch and move the discharge door handle forward (Fig. 6).
3. Grasp the bag frame handle and the rear of the grass bag and lift the bag off of the mower.
4. Gradually tip bag forward to empty clippings.

Maintenance

Cleaning

Always be sure that discharge tunnel door locks closed when handle is released. If debris prevents discharge door from locking closed, clean inside of discharge tunnel and door thoroughly.

1. Stop engine and pull wire off spark plug. Remove key from switch (key start models).
2. Remove fuel tank cap. Use a pump-type syphon to drain fuel into a clean gas can.

Note: This is the only procedure recommended for draining fuel.

3. Tip mower on side; refer to mower's Operator's Manual for proper side to use. Avoid rotating blade because starting problems may result.
4. Remove dirt and grass clippings that stick to housing with a hardwood scraper. Avoid burrs and sharp edges.
5. Turn mower upright.
6. Remove debris from inside of discharge tunnel.
7. Refill fuel tank.