



Exterior Mirror Kit

Workman® Utility Vehicle

Model No. 130-5448

Form No. 3424-476 Rev A

Installation Instructions

Installation

Loose Parts

Use the chart below to verify that all parts have been shipped.

Description	Qty.	Use
No parts required	—	Prepare the machine.
Support arm	1	Install the support arm (for GTX models with a canopy—Model 07921 or 07922).
Flange-head bolt (M6 x 35 mm)	4	
Support arm	1	Install the support arm (for GTX models with a cab—Model 07142, 2-person canopy—Model 07140, or 4-person canopy—Model 07141).
Flange-head bolt (M6 x 16 mm)	4	
Extension bracket	1	
Locknut (M6)	2	
Support arm	1	Install the support arm (for MD/MDE/MDX/HDX models).
Flange-head bolt (M6 x 16 mm)	4	
Mirror	1	Install the mirror.

Preparing the Machine

1. Park the machine on a level surface.
2. Engage the parking brake.
3. Shut off the engine and remove the key.

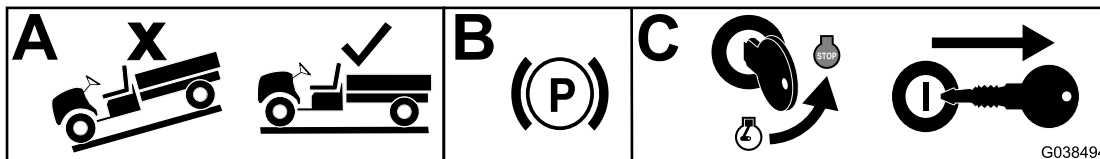

Figure 1

g038494



Installing the Support Arm

For GTX Models with Canopy Model 07921 or 07922

1. Apply medium-grade thread-locking compound to the threads of the 2 flange-head bolts (M6 x 35 mm).
2. Secure the support arm to the front mount tube using the 2 flange-head bolts (M6 x 35 mm) as shown in [Figure 2](#).

Note: You can install the support arm in the upper or lower set of holes.

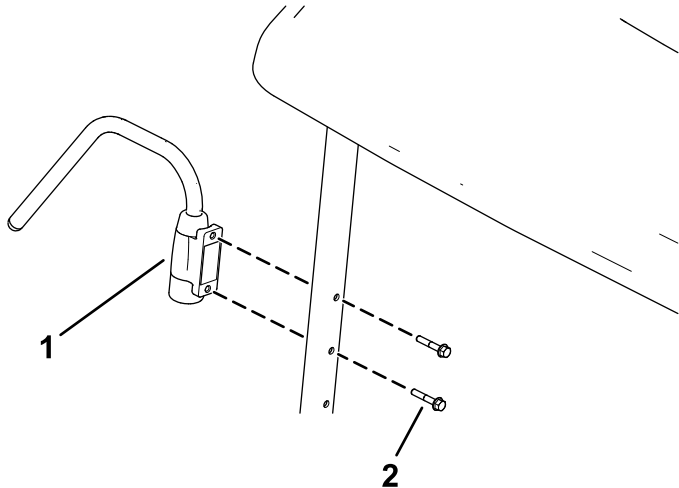

Figure 2

1. Support arm
2. Flange-head bolt (M6 x 35 mm)

Installing the Support Arm

For GTX Models with Cab (Model 07142), 2-Person Canopy (Model 07140), or 4-Person Canopy (Model 07141)

1. Apply medium-grade thread-locking compound to the threads of the 2 flange-head bolts (M6 x 16 mm).
2. Align the mounting bracket of the support arm to the extension bracket and the mirror bracket at pillar A of the cab ([Figure 3](#)).
3. Secure the extension bracket to the mirror bracket with 2 flange-head bolts (M6 x 16 mm) and 2 locknuts (M6) as shown in [Figure 3](#).
4. Secure the support arm to the pillar with the 2 flange-head bolts (M6 x 16 mm) as shown in [Figure 3](#).
5. Torque the bolts to 972 to 1,198 N·cm (86 to 106 in-lb).

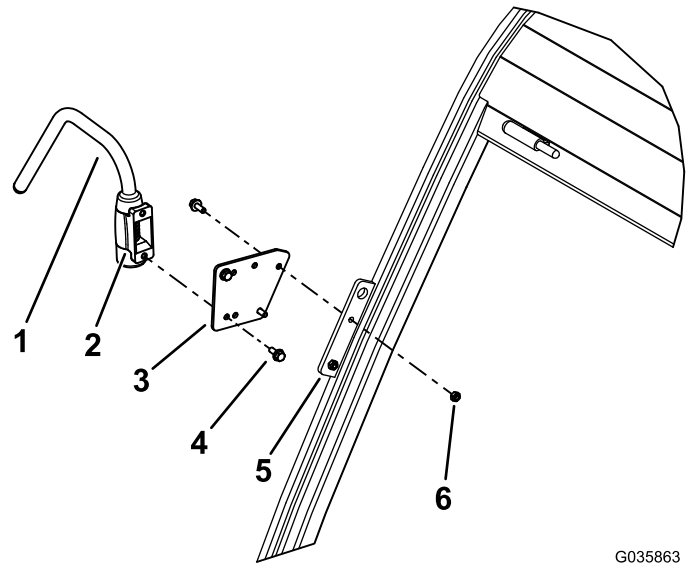

Figure 3

1. Support arm
2. Mounting bracket
3. Extension bracket
4. Flange-head bolts (M6 x 16 mm)
5. Mirror bracket (pillar A)
6. Locknut (M6)

Installing the Support Arm

For MD/MDE/MDX/HDX Models

1. Apply medium-grade thread-locking compound to the threads of the 2 flange-head bolts (M6 x 16 mm).
2. Align the mounting bracket of the support arm to the mirror bracket at pillar A of the cab (Figure 4).
3. Secure the support arm to the pillar with the 2 flange-head bolts (M6 x 16 mm) as shown in Figure 4.
4. Torque the bolts to 972 to 1198 N·cm (86 to 106 in-lb).

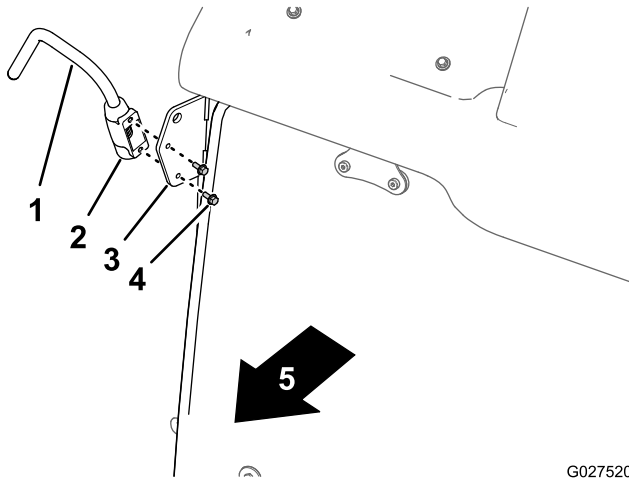

Figure 4

- | | |
|------------------------------|-----------------------------------|
| 1. Support arm | 4. Flange-head bolts (M6 x 16 mm) |
| 2. Mounting bracket | 5. Front of the machine |
| 3. Mirror bracket (pillar A) | |

Installing the Mirror

1. Align the mounting clamp of the mirror with the support arm (A of Figure 5).

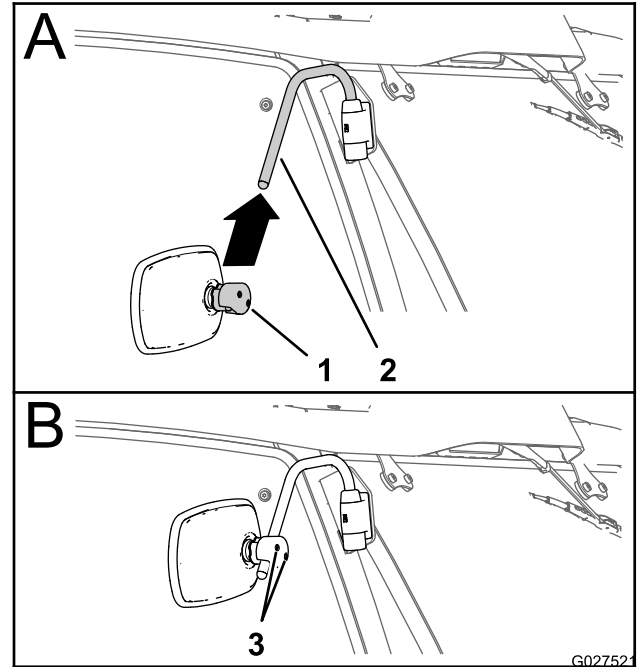

Figure 5

- | | |
|-------------------|---------------------|
| 1. Mounting clamp | 3. Capscrews (5 mm) |
| 2. Support arm | |

2. Slip the mirror onto the support arm (A of Figure 5).

Note: Ensure that the support arm extends 13 mm (1/2 inch) beyond the mounting clamp.

3. Tighten the 2 capscrews (5 mm) for the mounting clamp (B of Figure 5) to a **maximum torque** of 300 N·cm (26 in-lb).

Operation

Adjusting the Mirror

Important: Adjust the viewing angle of the mirror before you drive the machine.

1. Use 2 hands to rotate the mirror clockwise or counterclockwise on its ball mount (Figure 6).

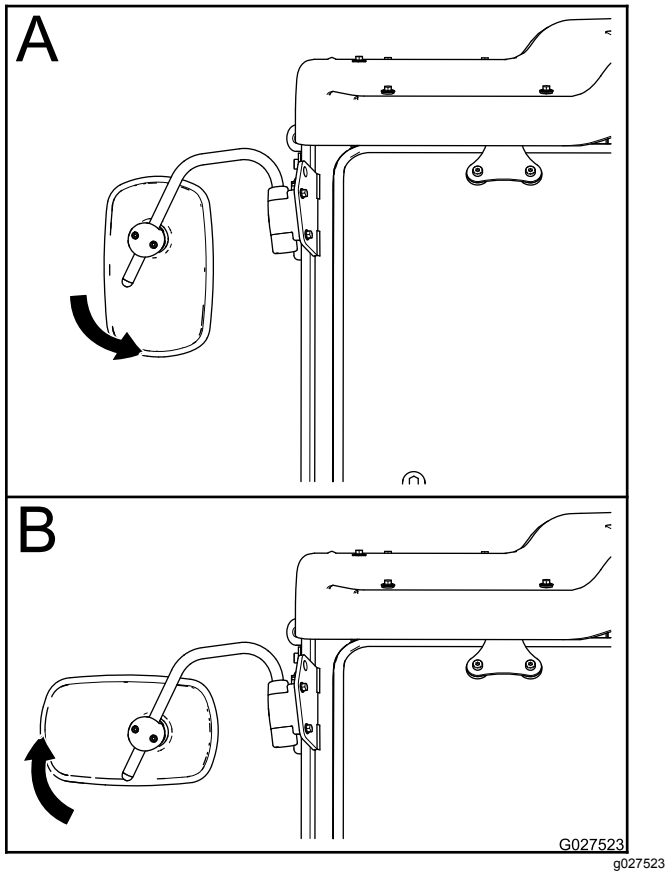

Figure 6

2. To adjust the position of the mirror and support arm, swing the support arm toward the cab or away from it (Figure 7).

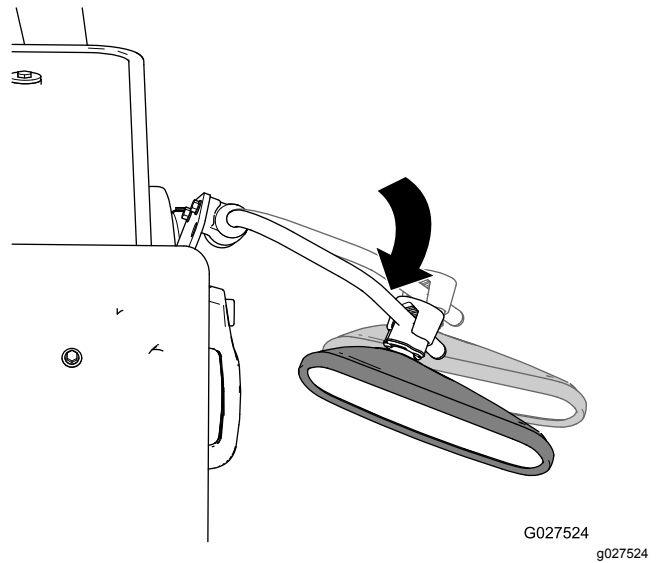

Figure 7

3. Use 2 hands to rotate the mirror up or down on its ball mount (A in Figure 8).

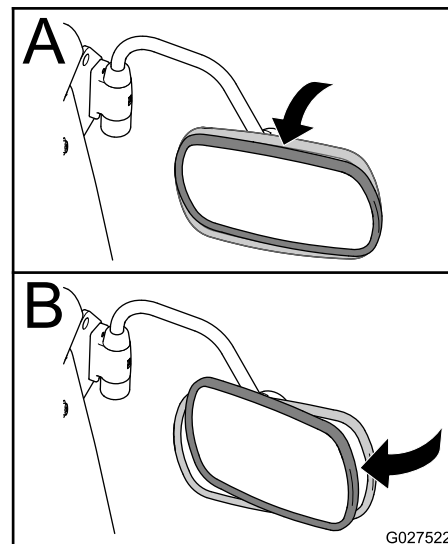

Figure 8

4. Use 2 hands to rotate the mirror left or right on its ball mount (B in Figure 8).