



Fold-Down Rear Facing Seat

Workman® GTX Utility Vehicle

Model No. 07123

Form No. 3424-532 Rev A

Installation Instructions

Safety

Safety and Instructional Decals



Safety decals and instructions are easily visible to the operator and are located near any area of potential danger. Replace any decal that is damaged or missing.

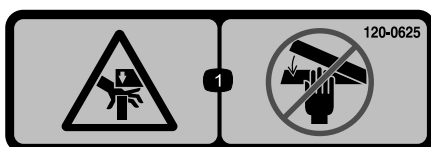

decal120-0625

120-0625

1. Pinch point, hand—keep hands away.

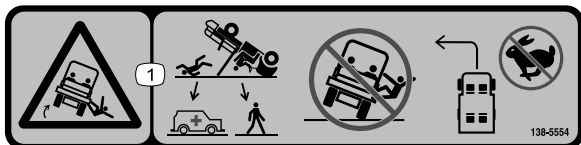

decal138-5554

138-5554

For machines with a ROPS installed only

1. Tipping hazard—there is no ROPS protection for rear passengers; avoid tipping the machine; do not turn corners quickly.



decal138-9231

138-9231

1. Read the *Operator's Manual*.
2. Max gross vehicle weight must be less than 1,403 kg (3,095 lb).



Installation

Loose Parts

Use the chart below to verify that all parts have been shipped.

Description	Qty.	Use
No parts required	—	Prepare the machine for installation.
No parts required	—	Remove the plastic cargo bed.
Flatbed	1	Install the rear-facing seat.
Footrest	1	
Carriage bolt (3/8 x 3 inches)	10	
Hex nut (3/8 inch)	17	
Button-head screw (3/8 x 1 inch)	7	
Rear-seat handle	1	
Hold-down strap	1	
Countersunk screw (1/4 inch)	2	
Locknut (1/4 inch)	2	
Side rail	2	
Rivet	10	Fold the rear-facing seat (when desired).
Rubber grommet	8	
No parts required	—	
Decal 120-0625	2	Apply the decals.
Decal 138-5554	2	

Preparing the Machine

1. Park the machine on a level surface.
2. Engage the parking brake.
3. Shut off the engine and remove the key.

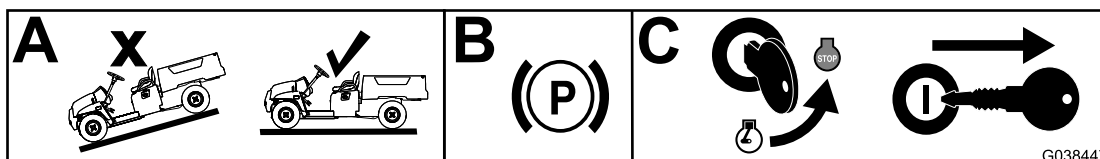

Figure 1

g038447

Removing the Plastic Cargo Bed

1. Using an overhead hoist, raise the plastic cargo bed.
2. Remove the 3 flange-head screws (5/16 x 3/4 inch) and U-bracket from the prop rod (Figure 2).

Note: Retain the hardware to install the plastic cargo bed in the future.

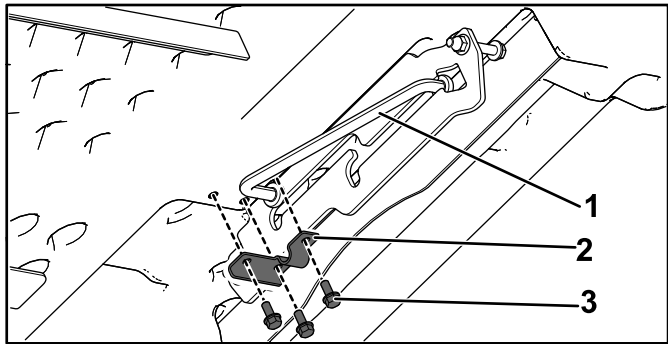
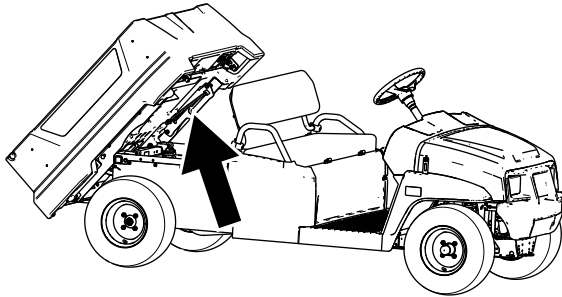

Figure 2

1. Prop rod
2. U-bracket
3. Flange-head screw (5/16 x 3/4 inch)

3. Slide the prop rod forward out of the detent slot and remove the prop rod (Figure 3).

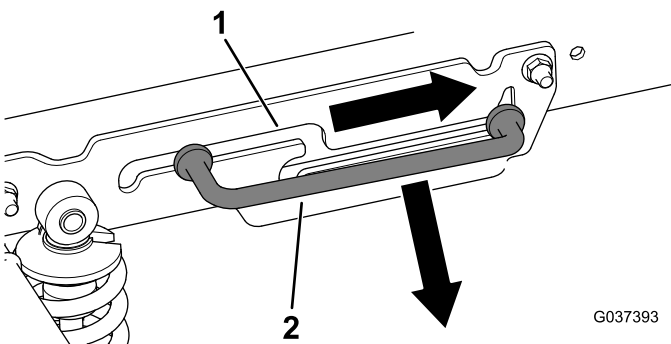

Figure 3

1. Detent slot
2. Prop rod

4. Using an overhead hoist, lower the cargo bed.
5. Remove the 2 pivot bolts (1/2 x 4-1/2 inches) and 2 locknuts (1/2 inch) from the pivot bracket located at the rear of the machine (Figure 4).

Note: Retain the hardware for installation of the flatbed assembly in 1 in [Installing the Rear-Facing Seat](#) (page 4).

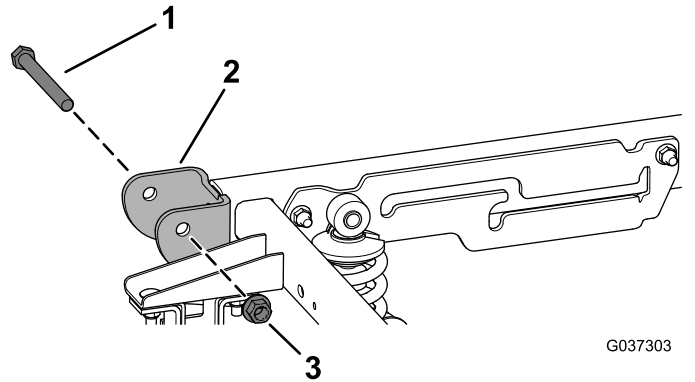

Figure 4

1. Pivot bolt (1/2 x 4-1/2 inches)
2. Pivot bracket
3. Locknut (1/2 inch)

6. Release the cargo-bed lever, then raise and remove the cargo bed using an overhead hoist.
7. Remove the 2 bed latches from the frame of the machine by removing the 4 flange-head screws (3/8 x 2-1/2 inches) and 4 nuts (3/8 inch) as shown in Figure 5.

Note: Retain 2 flange-head screws (3/8 x 2-1/2 inches) and 2 nuts (3/8 inch) for installation of the flatbed assembly in step 1 in [Installing the Rear-Facing Seat](#) (page 4). Retain the remaining hardware to install the plastic cargo bed in the future.

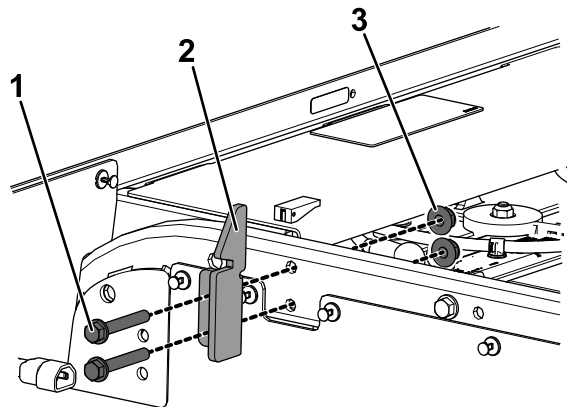
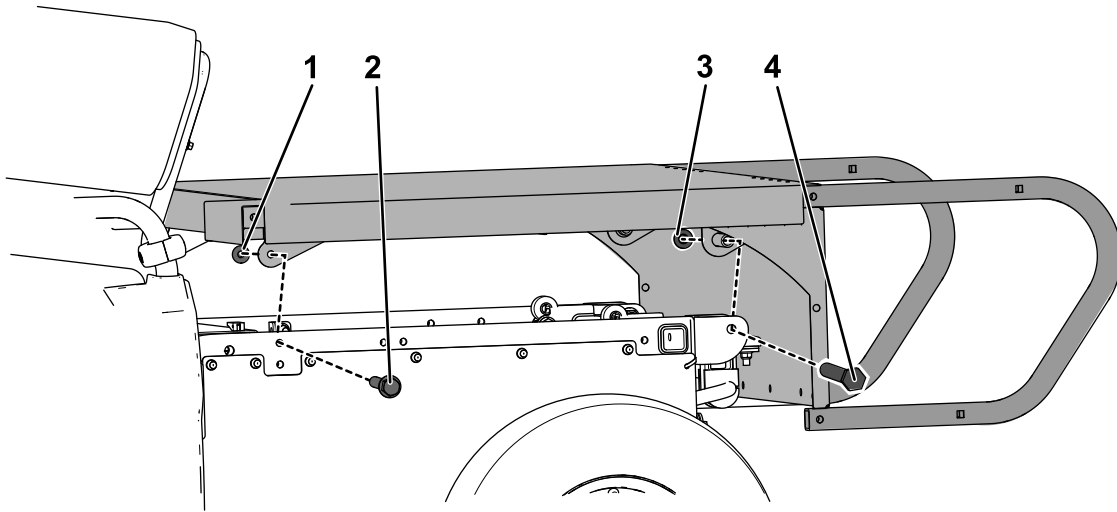

Figure 5

1. Flange-head screw (3/8 x 2-1/2 inches)
2. Bed latch
3. Nut (3/8 inch)

Installing the Rear-Facing Seat

1. Install the flatbed onto the frame of the machine using the 2 pivot bolts (1/2 x 4-1/2 inches), 2 locknuts (1/2 inch), 2 flange-head screws (3/8 x 2-1/2 inches), and 2 nuts (3/8 inch) previously removed in steps 5 and 7 of [Removing the Plastic Cargo Bed \(page 3\)](#). Refer to [Figure 6](#).



g243601

Figure 6

- | | |
|---|------------------------------------|
| 1. Nut (3/8 inch) | 3. Locknut (1/2 inch) |
| 2. Flange-head screw (3/8 x 2-1/2 inches) | 4. Pivot bolt (1/2 x 4-1/2 inches) |

2. Attach the footrest onto the flatbed using 2 carriage bolts (3/8 x 3 inches), 7 button-head screws (3/8 x 1 inch), and 9 hex nuts (3/8 inch) as shown in [Figure 7](#).

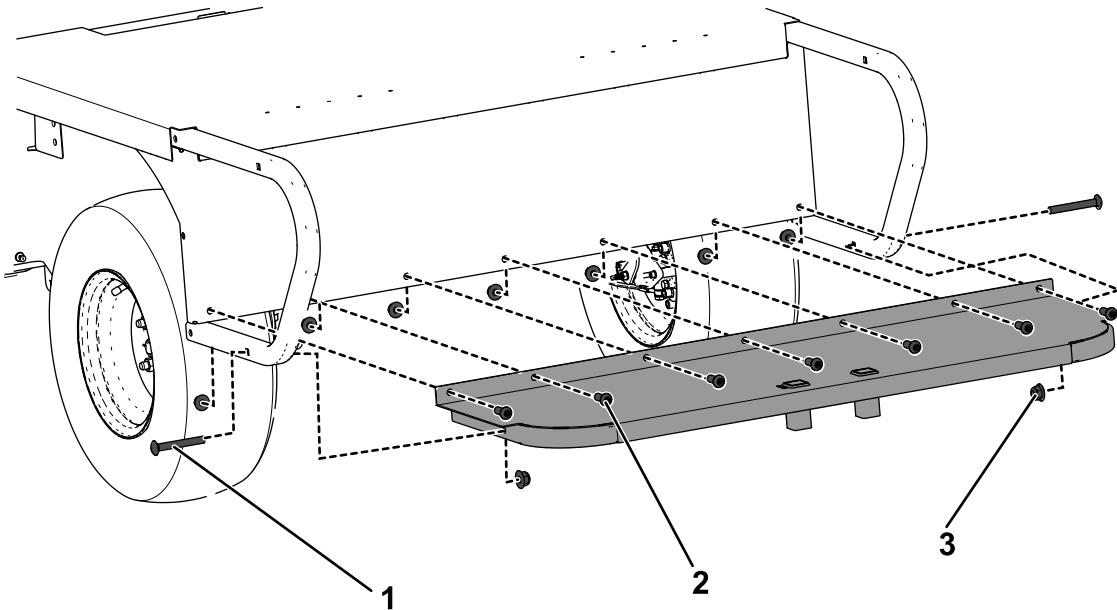

g243647

Figure 7

- | | |
|-------------------------------------|-----------------------|
| 1. Carriage bolts (3/8 x 3 inches) | 3. Hex nut (3/8 inch) |
| 2. Button-head screw (3/8 x 1 inch) | |

3. Install 4 rubber grommets onto the rear-seat handle (A of [Figure 8](#)).
4. Install 2 countersunk screws (1/4 inch) and 2 locknuts (1/4 inch) onto the rear-seat handle (B of [Figure 8](#)).
5. Feed the hold-down strap through the bottom of the footrest (C of [Figure 8](#)).
6. Install the rear-seat handle onto the footrest (D of [Figure 8](#)).
7. Secure the rear-seat handle to the footrest by pulling the hold-down strap up and around the countersunk screw (E of [Figure 8](#)).

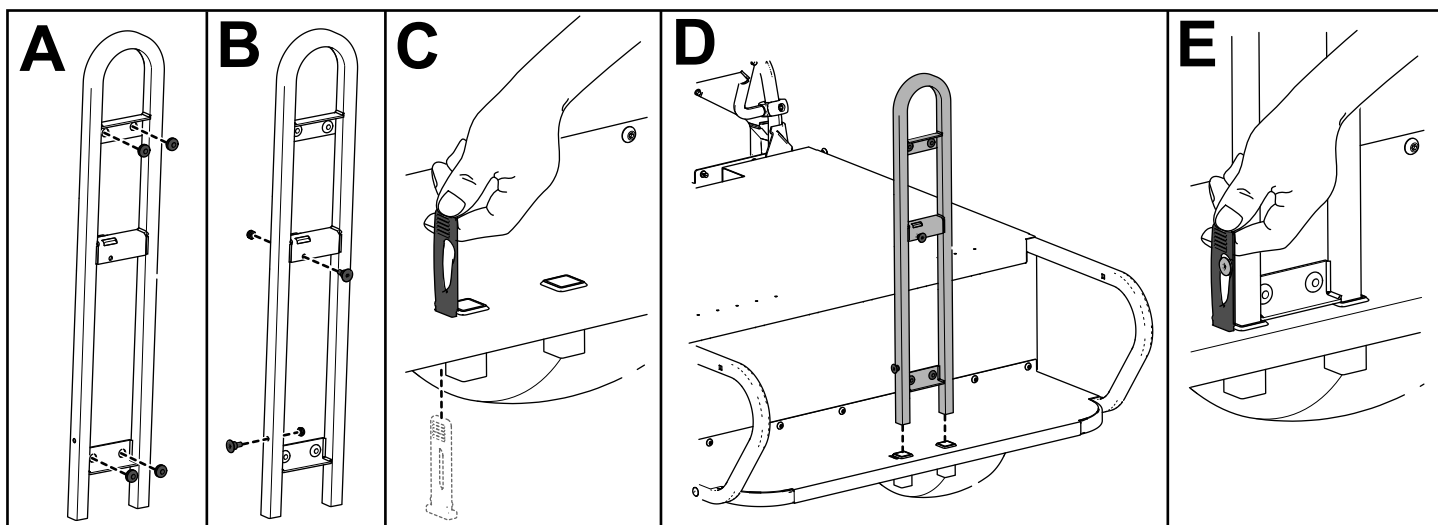

g243744

Figure 8

8. Install the side rails to the flatbed assembly with 8 carriage bolts (3/8 x 3 inches) and 8 hex nuts (3/8 inch) as shown in [Figure 9](#).

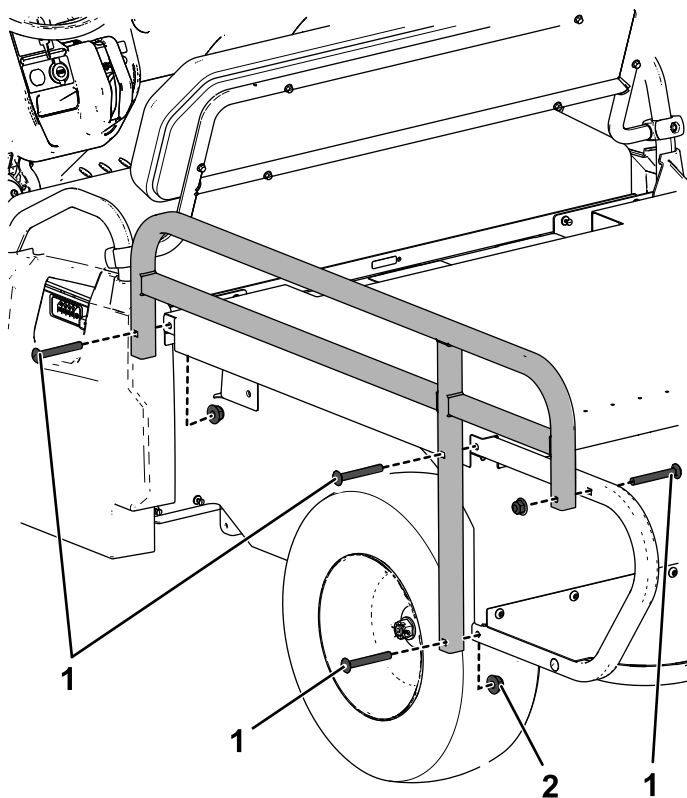

g258079

Figure 9

1. Carriage bolt (3/8 x 3 inches)
2. Hex nut (3/8 inch)

9. Install 4 rubber grommets on the edges of the seat base as shown in [Figure 10](#).

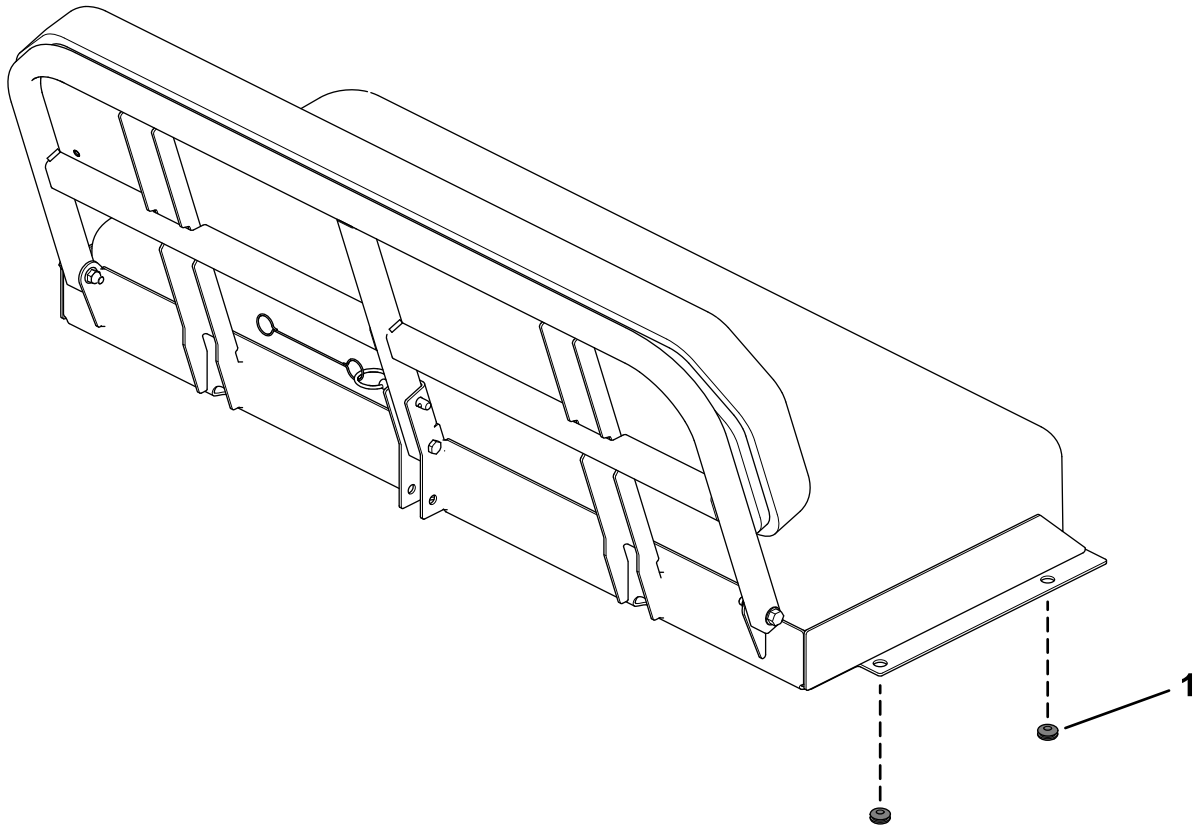

g258080

Figure 10

1. Rubber grommet

10. Install the seat assembly onto the flatbed, lining up the holes on the flatbed with the holes on the hinges, and secure the rivet seat assembly to the flatbed ([Figure 11](#)).

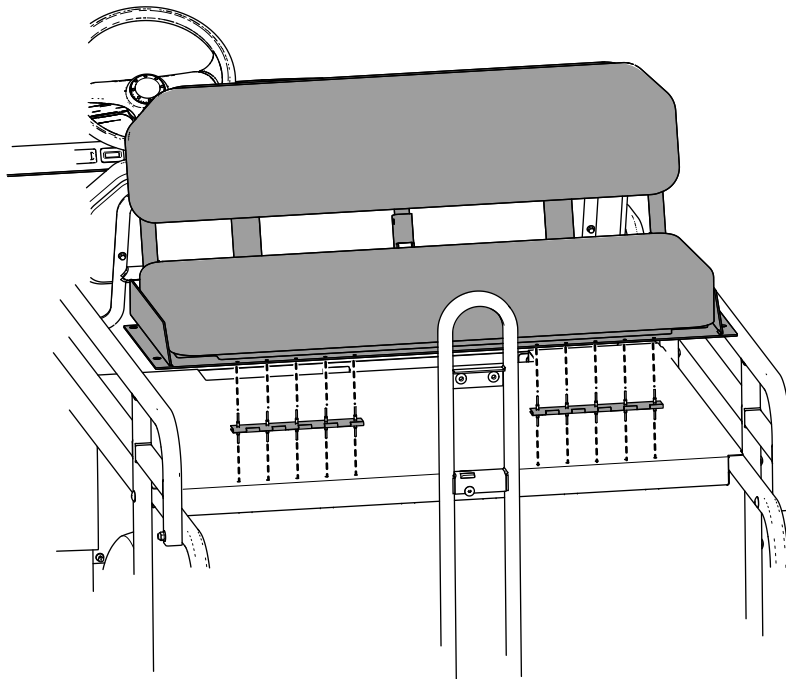

g243870

Figure 11

Folding the Rear-Facing Seat

1. Remove the rear-seat handle and lay it flat on the footrest lining up the tab on the handle with the handle hole on the footrest ([Figure 12](#)).
2. Secure the handle to the footrest using the hold-down strap and countersunk screw on the rear-seat handle ([Figure 12](#)).

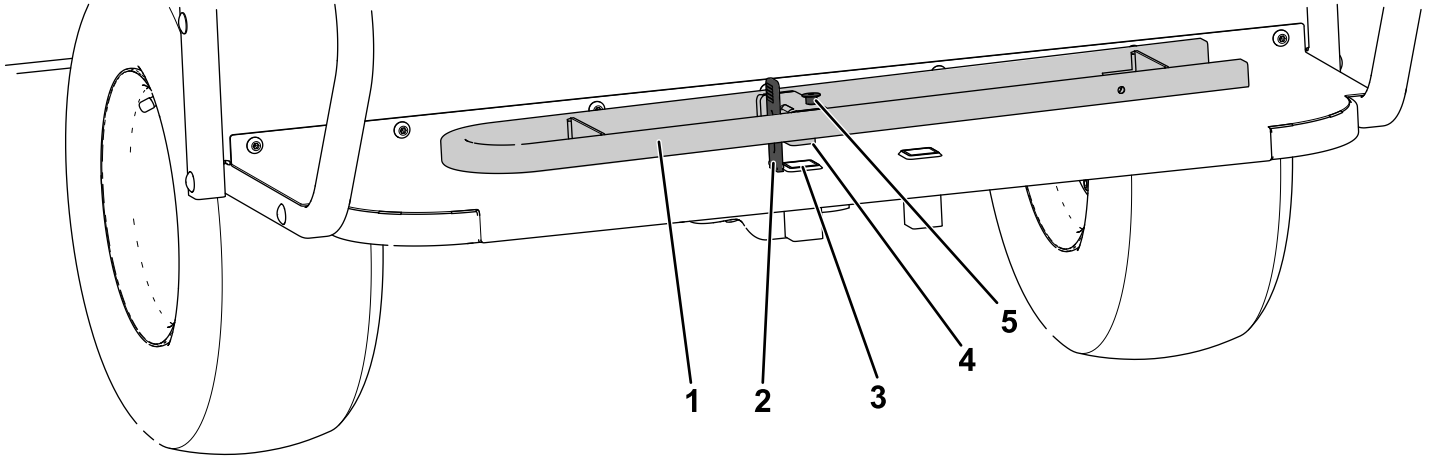

g244241

Figure 12

- | | |
|---------------------|----------------------|
| 1. Rear-seat handle | 4. Notch |
| 2. Hold-down strap | 5. Countersunk screw |
| 3. Handle hole | |

-
3. Rotate the seat forward and remove the quick pin ([Figure 13](#)).

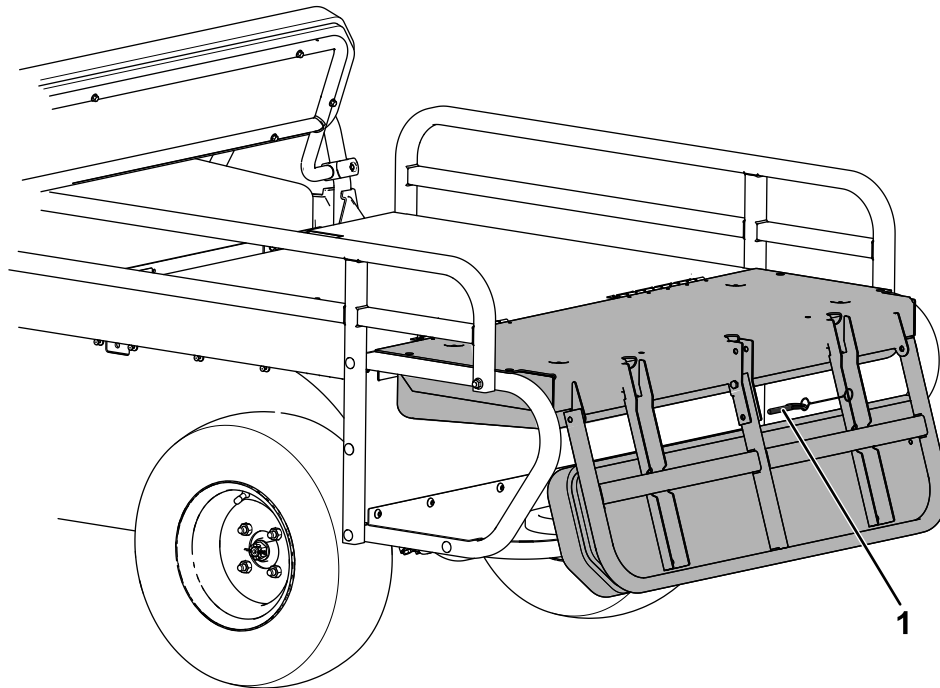

g244252

Figure 13

1. Quick pin

4. Fold the back rest support up and replace the quick pin as shown in [Figure 14](#).

Note: The back rest support acts as a back tailgate.

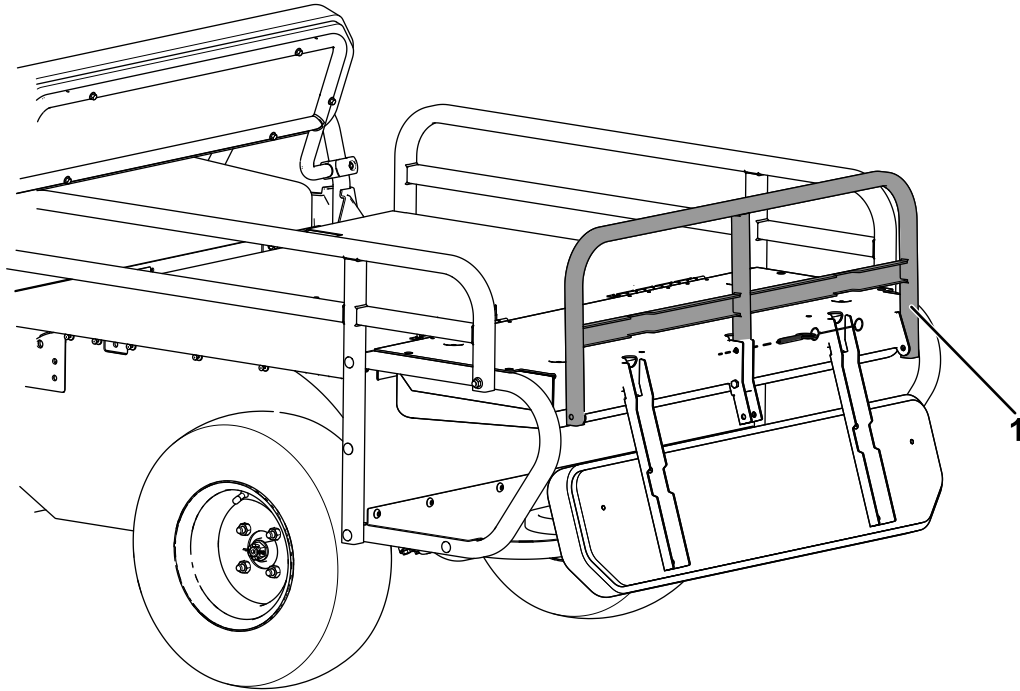

Figure 14

g244254

1. Back rest support

Applying the Decals

Apply the 2 pinch-point warning decals (120-0625) and 2 tipping hazard decals (138-5554) to the rear-facing seat frame using the measurements shown in [Figure 15](#).

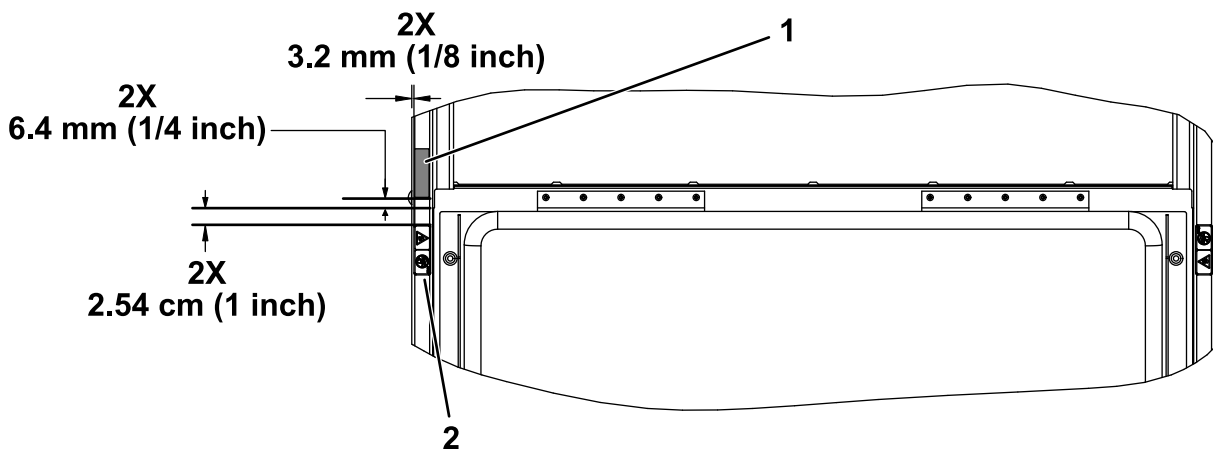

Figure 15

g258505

1. Tipping hazard decal (138-5554)
2. Pinch-point warning decal (120-0625)