



Flex™ Groomer Kit

QAS Nail Drag for Sand Pro®/Infield Pro® 3040 or 5040 Traction Unit

Model No. 08762—Serial No. 314000001 and Up

Form No. 3394-565 Rev B

Installation Instructions

Introduction

This product complies with all relevant European directives. For details, please see the separate product specific Declaration of Conformity (DOC) sheet.

You may contact Toro directly at www.Toro.com for product safety and operation training materials, accessory information, help finding a dealer, or to register your product.

Whenever you need service, genuine Toro parts, or additional information, contact an Authorized Service Dealer or Toro Customer Service and have the model and serial numbers of your product ready. [Figure 1](#) illustrates the location of the model and serial numbers on the product. Write the numbers in the space provided.

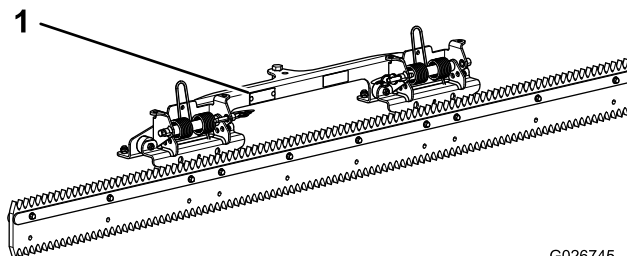

G026745
g026745

Figure 1

1. Location of the model and serial numbers

Model No. _____

Serial No. _____

Installation

Loose Parts

Use the chart below to verify that all parts have been shipped.

Description	Qty.	Use
Nail-drag bracket	1	Install the groomer onto the nail drag.
Spring bracket assembly	2	
Carriage bolt (3/8 inch)	12	
Locknut (3/8 inch)	12	
Bolt (1/2 x 1 inch)	1	
Locknut (1/2 inch)	1	
Groomer	1	
Side guard	2	
Screw (1/4 x 1-3/4 inches)	4	
Locknut (1/4 inch)	4	



Installing the Groomer onto the Nail Drag

Attaching the Spring Bracket Assemblies to the Nail-drag Bracket

Note: The traction unit must be equipped with the Front Weight Kit.

1. Align the holes in each of the spring bracket assemblies with the holes in the nail-drag bracket as shown in [Figure 2](#).

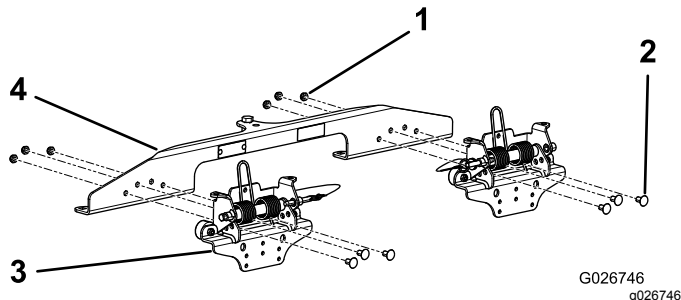

Figure 2

- | | |
|----------------|--------------------------------|
| 1. Locknut (6) | 3. Spring bracket assembly (2) |
| 2. Bolt (6) | 4. Nail-drag bracket |

2. Using 6 bolts and 6 locknuts, secure the spring bracket assemblies to the nail-drag bracket ([Figure 2](#)).

Removing the Nails and the Plates

1. Start the machine and raise the attachment lift so that the nail drag is up off the ground.
2. Remove the lynch pins ([Figure 3](#)).

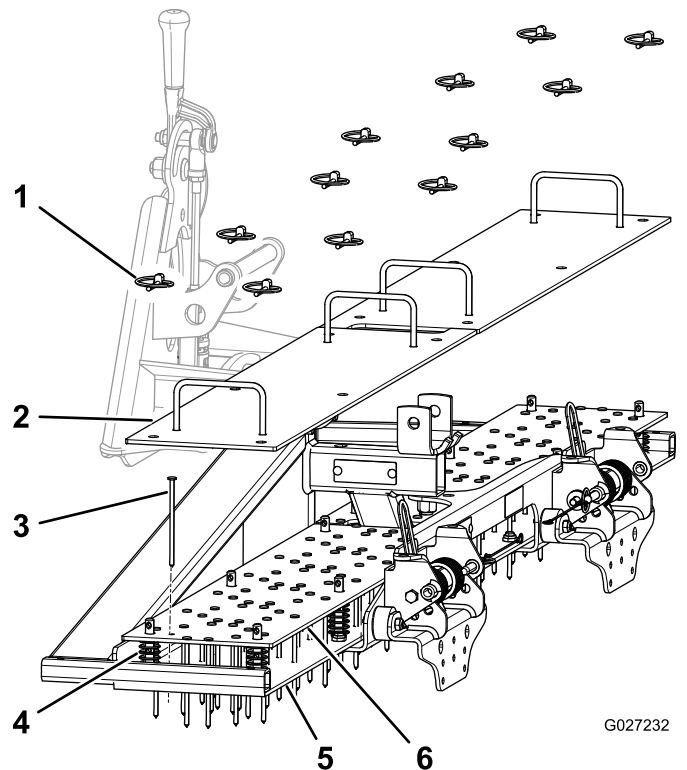

Figure 3

- | | |
|-------------------|---------------------|
| 1. Lynch pin (12) | 4. Coil spring (12) |
| 2. Top plate (2) | 5. Bottom plate |
| 3. Nail (130) | 6. Nail plate (2) |

3. Remove the top plates ([Figure 3](#)).
4. Remove the nails ([Figure 3](#)).

Note: Look to see if any nails are damaged, bent, or missing, so that you can get replacements for when you install the nails later.

5. Remove the nail plates ([Figure 3](#)).

Note: Retain all the parts for future installation.

Mounting the Nail-drag Bracket to the Nail Drag

1. Align the **front** hole in the center tab on the nail-drag bracket to the hole in the rectangular tube on the nail drag (Figure 4 and Figure 5).

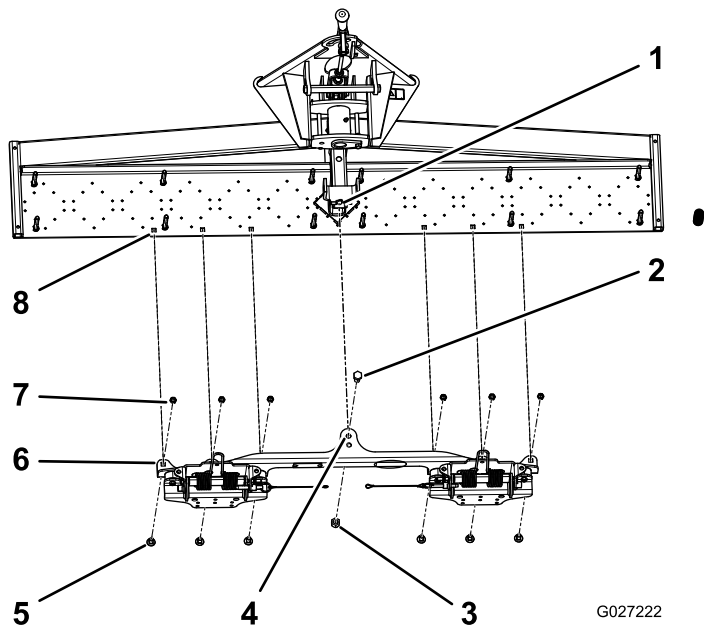

Figure 4

- | | |
|-----------------------------------|---|
| 1. Rectangular tube | 5. Carriage bolt (6), 3/8 x 3/4 inch |
| 2. Bolt (1/2 x 1 inch) | 6. Tab (spring bracket assembly), 6 total |
| 3. Locknut (1/2 inch) | 7. Locknut (6), 3/8 inch |
| 4. Center tab (nail-drag bracket) | 8. Bottom plate |

2. Install the bolt (1/2 x 1 inch) through both holes, and secure the bolt with the nut (1/2 inch); refer to Figure 5.

Note: Install the nut on the bolt until it is finger-tight and wait to tighten it until after you install the other hardware in step 4.

3. Align the 6 holes in the tabs on the nail-drag bracket with the 6 holes in the bottom plate of the nail drag (Figure 4 and Figure 6).

Note: Machines with serial numbers 314999999 and lower may not have existing holes. If there are not holes in the bottom plate of the nail drag, mark and drill six 10 mm (3/8 inch) holes as necessary. First install the center bolt and nut (Figure 5), and position the nail-drag bracket so that the **center** of each hole is 17 mm (0.67 inch) from the edge of the bottom plate (Figure 7).

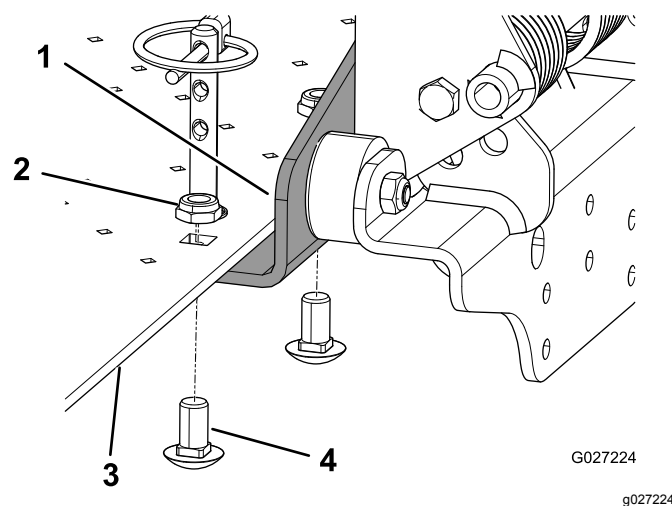

Figure 6

- | | |
|--------------------------|--------------------------------------|
| 1. Nail-drag bracket | 3. Bottom plate (nail drag) |
| 2. Locknut (6), 3/8 inch | 4. Carriage bolt (6), 3/8 x 3/4 inch |

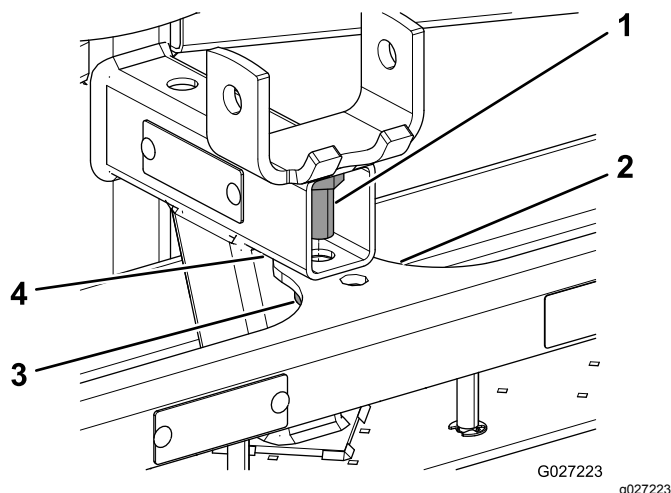

Figure 5

- | | |
|------------------------|-------------------|
| 1. Bolt (1/2 x 1 inch) | 3. Nut (1/2 inch) |
| 2. Nail-drag bracket | 4. Nail drag |

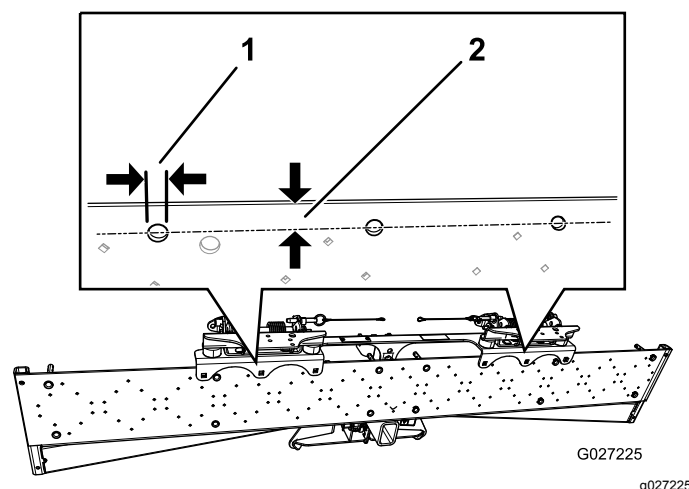

Figure 7

- | | |
|------------------------------|----------------------|
| 1. 10 mm (3/8 inch) hole (6) | 2. 17 mm (0.67 inch) |
|------------------------------|----------------------|

4. Install a carriage bolt (3/8 x 3/4 inch) up through the bottom of each hole, and secure each carriage bolt with a nut (3/8 inch); refer to [Figure 6](#).

Note: Install all the nuts and bolts until they are finger-tight, then tighten all of them until they are snug.

5. Tighten the nut and bolt that you install in step 2 ([Figure 5](#)).

Installing the Nails and the Plates

Replace any damaged, bent, or missing nails.

1. Install the nail plates ([Figure 8](#)).

Note: Ensure that the coil springs are in place between the nail plate and the bottom plate.

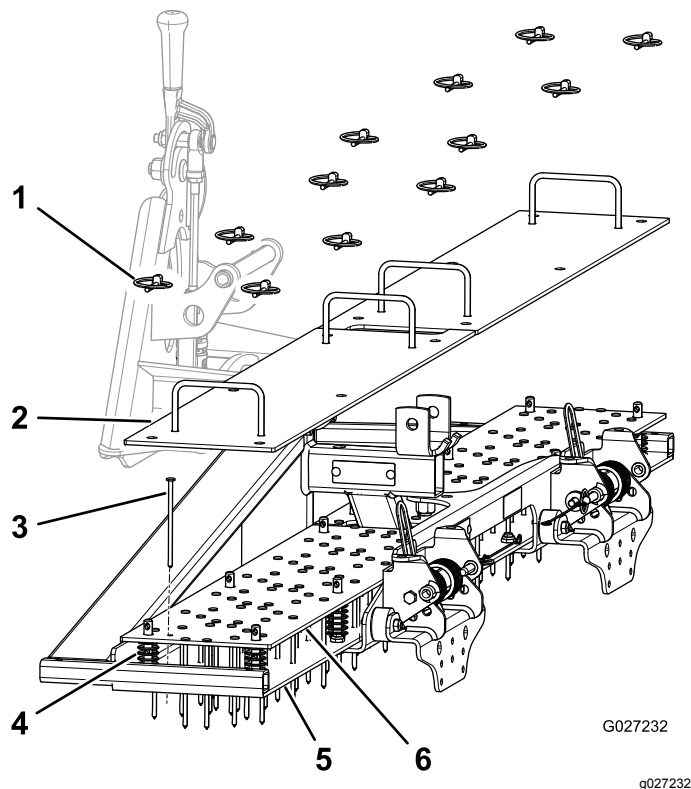

Figure 8

- | | |
|-------------------|---------------------|
| 1. Lynch pin (12) | 4. Coil spring (12) |
| 2. Top plate (2) | 5. Bottom plate |
| 3. Nail (130) | 6. Nail plate (2) |

2. Install the nails ([Figure 8](#)).
3. Install the top plates ([Figure 8](#)).
4. Move the top plates to the preferred position, and install the lynch pins ([Figure 8](#)).

Installing the Groomer onto the Spring Bracket Assemblies

1. Remove 4 screws and nuts as shown in [Figure 9](#).

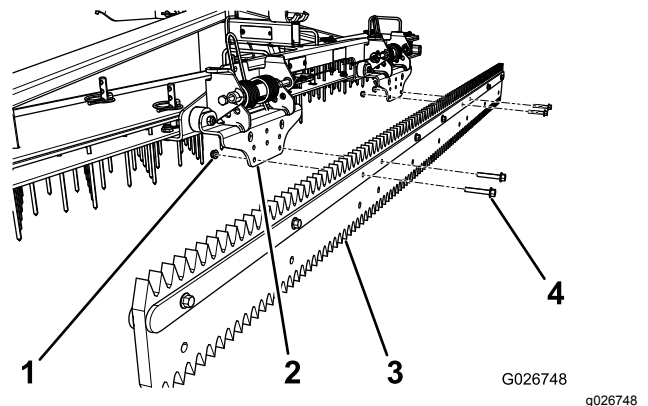

Figure 9

- | | |
|----------------------------|--------------|
| 1. Nut (4) | 3. Groomer |
| 2. Spring bracket assembly | 4. Screw (4) |

2. Align the holes in the groomer to the lower holes in the spring bracket assemblies ([Figure 9](#)).
3. Use the previously removed 4 screws and nuts to secure the groomer to the spring bracket assemblies ([Figure 9](#)).

Installing the Side Guards onto the Nail Drag

1. Align the holes in a side guard with the holes in the side of the frame of the nail drag as shown in [Figure 10](#).

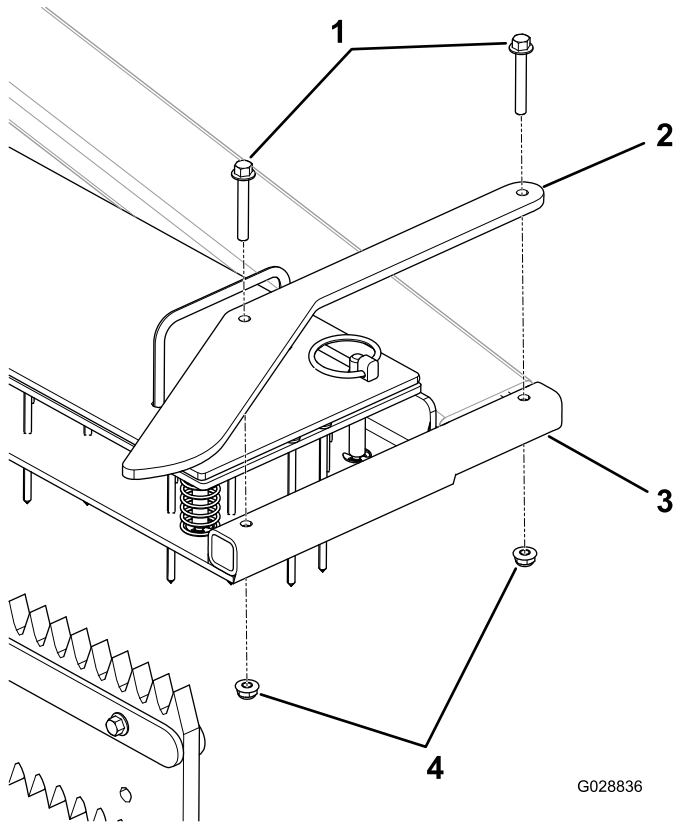

Figure 10

- | | |
|--------------------------------|------------------------|
| 1. Screws (1/4 x 1-3/4 inches) | 3. Nail drag |
| 2. Side bracket | 4. Locknuts (1/4 inch) |

-
2. Secure the side guard with 2 screws and 2 locknuts ([Figure 10](#)).
 3. Repeat the procedure for the other side of the nail drag.

Operation

Stowing the Groomer

1. Remove the 2 clevis pins ([Figure 11](#)).

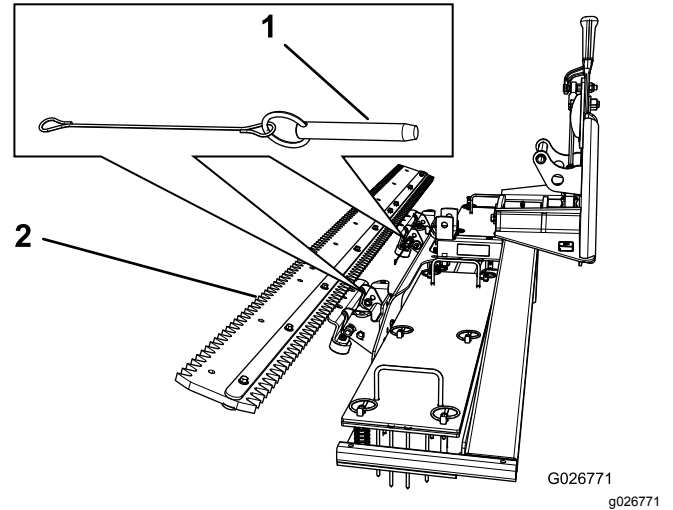

Figure 11

1. Clevis pin (2)
 2. Groomer in the stowed position
-
2. Tilt the groomer upward, and insert the clevis pins to secure it into that position ([Figure 11](#)).

Operating Tips

To increase the usable life of the groomer, you can remove the rubber trowel, flip it over, and install it again.

1. Remove the 10 nuts and the 10 bolts securing the 2 support straps to the rubber trowel (Figure 12).

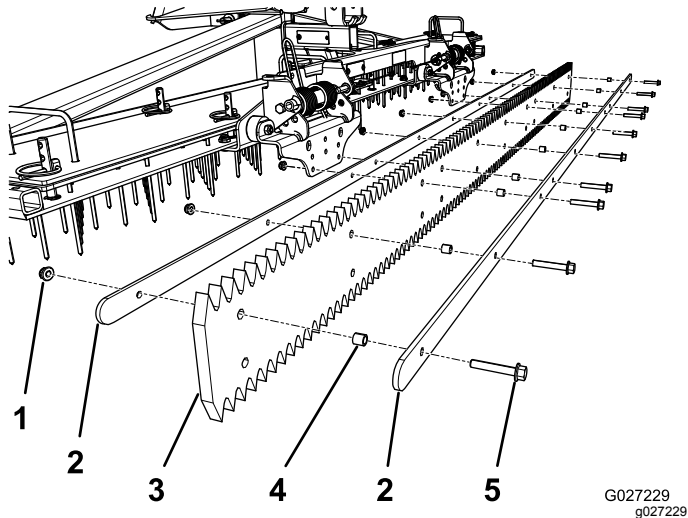

Figure 12

- | | |
|------------------|----------------|
| 1. Nut (10) | 4. Spacer (10) |
| 2. Support strap | 5. Bolt (10) |
| 3. Rubber trowel | |

-
2. Flip the trowel over.

Note: There is a spacer installed in every bolt hole of the trowel. Do not lose the spacers.

3. Assemble the trowel and the support straps with the hardware previously removed.

Notes:



Toro General Commercial Product Warranty

A Two-Year Limited Warranty

Conditions and Products Covered

The Toro Company and its affiliate, Toro Warranty Company, pursuant to an agreement between them, jointly warrant your Toro Commercial product ("Product") to be free from defects in materials or workmanship for two years or 1500 operational hours*, whichever occurs first. This warranty is applicable to all products with the exception of Aerators (refer to separate warranty statements for these products). Where a warrantable condition exists, we will repair the Product at no cost to you including diagnostics, labor, parts, and transportation. This warranty begins on the date the Product is delivered to the original retail purchaser.

* Product equipped with an hour meter.

Instructions for Obtaining Warranty Service

You are responsible for notifying the Commercial Products Distributor or Authorized Commercial Products Dealer from whom you purchased the Product as soon as you believe a warrantable condition exists. If you need help locating a Commercial Products Distributor or Authorized Dealer, or if you have questions regarding your warranty rights or responsibilities, you may contact us at:

Toro Commercial Products Service Department
Toro Warranty Company
8111 Lyndale Avenue South
Bloomington, MN 55420-1196

952-888-8801 or 800-952-2740
E-mail: commercial.warranty@toro.com

Owner Responsibilities

As the Product owner, you are responsible for required maintenance and adjustments stated in your *Operator's Manual*. Failure to perform required maintenance and adjustments can be grounds for disallowing a warranty claim.

Items and Conditions Not Covered

Not all product failures or malfunctions that occur during the warranty period are defects in materials or workmanship. This warranty does not cover the following:

- Product failures which result from the use of non-Toro replacement parts, or from installation and use of add-on, or modified non-Toro branded accessories and products. A separate warranty may be provided by the manufacturer of these items.
- Product failures which result from failure to perform recommended maintenance and/or adjustments. Failure to properly maintain your Toro product per the Recommended Maintenance listed in the *Operator's Manual* can result in claims for warranty being denied.
- Product failures which result from operating the Product in an abusive, negligent, or reckless manner.
- Parts subject to consumption through use unless found to be defective. Examples of parts which are consumed, or used up, during normal Product operation include, but are not limited to, brake pads and linings, clutch linings, blades, reels, rollers and bearings (sealed or greasable), bed knives, spark plugs, castor wheels and bearings, tires, filters, belts, and certain sprayer components such as diaphragms, nozzles, and check valves, etc.
- Failures caused by outside influence. Conditions considered to be outside influence include, but are not limited to, weather, storage practices, contamination, use of unapproved fuels, coolants, lubricants, additives, fertilizers, water, or chemicals, etc.
- Failure or performance issues due to the use of fuels (e.g. gasoline, diesel, or biodiesel) that do not conform to their respective industry standards.

- Normal noise, vibration, wear and tear, and deterioration.
- Normal "wear and tear" includes, but is not limited to, damage to seats due to wear or abrasion, worn painted surfaces, scratched decals or windows, etc.

Parts

Parts scheduled for replacement as required maintenance are warranted for the period of time up to the scheduled replacement time for that part. Parts replaced under this warranty are covered for the duration of the original product warranty and become the property of Toro. Toro will make the final decision whether to repair any existing part or assembly or replace it. Toro may use remanufactured parts for warranty repairs.

Deep Cycle and Lithium-Ion Battery Warranty:

Deep cycle and Lithium-Ion batteries have a specified total number of kilowatt-hours they can deliver during their lifetime. Operating, recharging, and maintenance techniques can extend or reduce total battery life. As the batteries in this product are consumed, the amount of useful work between charging intervals will slowly decrease until the battery is completely worn out. Replacement of worn out batteries, due to normal consumption, is the responsibility of the product owner. Battery replacement may be required during the normal product warranty period at owner's expense. Note: (Lithium-Ion battery only): A Lithium-Ion battery has a part only prorated warranty beginning year 3 through year 5 based on the time in service and kilowatt hours used. Refer to the *Operator's Manual* for additional information.

Maintenance is at Owner's Expense

Engine tune-up, lubrication, cleaning and polishing, replacement of filters, coolant, and completing recommended maintenance are some of the normal services Toro products require that are at the owner's expense.

General Conditions

Repair by an Authorized Toro Distributor or Dealer is your sole remedy under this warranty.

Neither The Toro Company nor Toro Warranty Company is liable for indirect, incidental or consequential damages in connection with the use of the Toro Products covered by this warranty, including any cost or expense of providing substitute equipment or service during reasonable periods of malfunction or non-use pending completion of repairs under this warranty. Except for the Emissions warranty referenced below, if applicable, there is no other express warranty. All implied warranties of merchantability and fitness for use are limited to the duration of this express warranty.

Some states do not allow exclusions of incidental or consequential damages, or limitations on how long an implied warranty lasts, so the above exclusions and limitations may not apply to you. This warranty gives you specific legal rights, and you may also have other rights which vary from state to state.

Note regarding engine warranty:

The Emissions Control System on your Product may be covered by a separate warranty meeting requirements established by the U.S. Environmental Protection Agency (EPA) and/or the California Air Resources Board (CARB). The hour limitations set forth above do not apply to the Emissions Control System Warranty. Refer to the Engine Emission Control Warranty Statement supplied with your product or contained in the engine manufacturer's documentation for details.

Countries Other than the United States or Canada

Customers who have purchased Toro products exported from the United States or Canada should contact their Toro Distributor (Dealer) to obtain guarantee policies for your country, province, or state. If for any reason you are dissatisfied with your Distributor's service or have difficulty obtaining guarantee information, contact the Toro importer.