



Transmission Filter for the RT1200 Traction Unit

Model No. 136-5456

Form No. 3424-803 Rev A

Installation Instructions

Transmission-oil specification: Mobilfluid 424

Checking the Transmission-Oil Level

Important: If you operate the machine while the level of the transmission oil is below the recommended level, you may damage the transmission and the parking brake.

1. Park the machine on a level surface.
2. Start the engine and run it for 10 minutes.
3. Stop the engine and remove the ignition key.
4. After 5 minutes, check the transmission oil level in the sight gauge (Figure 1).

Note: The oil level should cover 1/2 to 3/4 of the sight-gauge window.

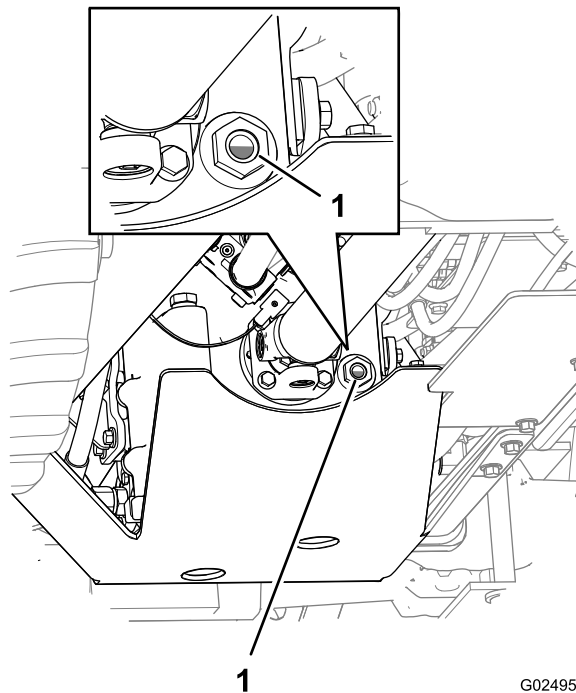

1

G024954

g024954

Figure 1

1. Sight gauge

5. If the oil level is low, add the specified oil into the transmission; refer to [Filling the Transmission with Oil \(page 2\)](#).
6. Repeat steps 2 through 5 until the oil level covers 1/2 to 3/4 of the sight-gauge window (Figure 1).

Note: As you add oil to the transmission, perform steps 2 through 4 to determine the corrected oil level.



Changing the Transmission Oil

Draining the Transmission Oil

Note: If possible, drain the oil when it is warm.

1. Park the machine on a level surface, stop the engine, and remove the key.
2. Place a drain pan under the forward hole in the transmission shield (Figure 2).

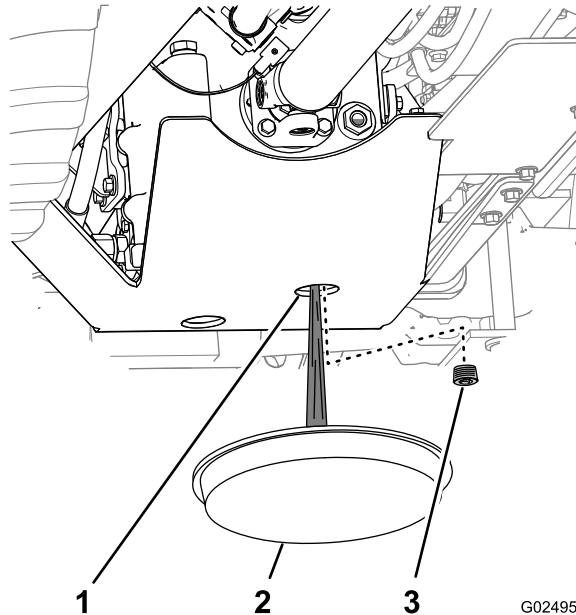

Figure 2

1. Transmission shield
2. Drain pan
3. Drain plug

3. Through the transmission shield, clean the area around the transmission drain plug (Figure 2).
4. Remove the drain plug and allow the transmission to drain completely.
5. Clean the threads of the plug.
6. Apply PTFE thread sealing tape to the threads of the plug.
7. Through the transmission shield, securely install the drain plug into the drain port of the transmission.

Filling the Transmission with Oil

Transmission oil capacity: approximately 10 L (10.6 US qt)—with filter change

Important: If you operate the machine while the level of the transmission oil is below the recommended level, you may damage the transmission and the parking brake.

1. Remove the fill plug from the fill port of the transmission.
2. Clean the threads of the plug.
3. Apply PTFE thread sealing tape to the threads of the plug.
4. Fill the transmission with the specified oil through the fill port (Figure 3).

Important: When you fill the transmission with oil, slowly add the oil into the transmission to avoid entraining air with the oil.

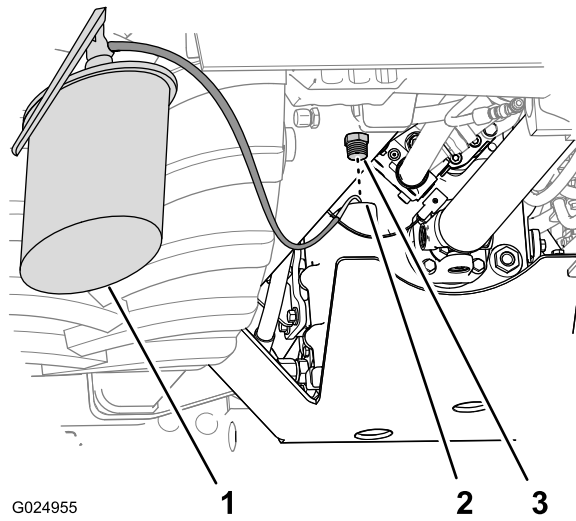

G024955

g024955

Figure 3

1. Oil-servicing equipment
2. Fill port
3. Fill plug

-
5. Install the fill plug into the fill port securely
 6. Start the engine and run it for 10 minutes.
 7. Stop the engine and remove the key.
 8. After 5 minutes, check the oil level in the sight gauge.

Note: The oil level should cover 1/2 to 3/4 of the sight-gauge window ([Figure 1](#)).

Note: As you add oil to the transmission, perform steps [6](#) through [8](#) to determine corrected oil level.

Changing the Transmission Filter

Note: You can access the transmission filter from underneath the right side of the machine, inboard of the hydraulic tank.

1. Place a drain pan under the transmission-oil filter ([Figure 4](#)).

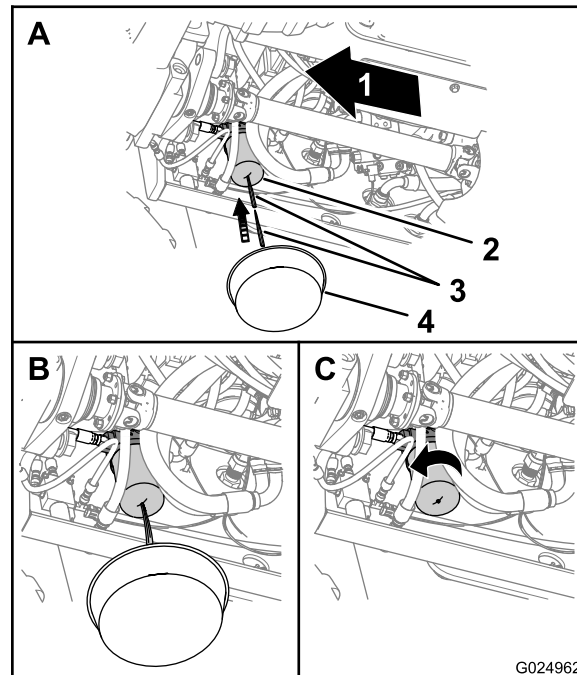

Figure 4

g024962

1. Forward
2. Transmission-oil filter
3. Sharp object
4. Drain pan

2. Puncture the bottom of the transmission filter, and allow the residual hydraulic fluid to drain into the drain pan ([Figure 4](#)).

Note: Use a tapered-center punch or awl to puncture the filter case

3. Remove the transmission filter with a filter wrench and discard the filter ([Figure 4](#)).
4. Wipe clean the oil filter adapter at the seating surface for the filter.
5. Fill the filter with hydraulic oil.
6. Apply a thin layer of clean grease or oil onto the O-ring of the new filter.
7. Install the new filter by hand and tight the filter 1/2 to 3/4 turn after it makes contact with the filter head ([Figure 4](#)).

Important: Do not use a filter strap wrench to tighten the filter. A strap wrench can dent the filter, causing it to leak.

8. Start the engine and run it at idle for 1 minute, and check for leaks.
9. Stop the engine and remove the key.
10. Check the transmission oil level; if the level is low, add the specified oil to the transmission; refer to [Filling the Transmission with Oil \(page 2\)](#).

Important: When you fill the transmission with oil, slowly add the oil into the transmission to avoid entraining air with the oil.