



Quick Attach Front Frame

Groundsmaster® 360 Multi-Purpose Machine

Model No. 30509—Serial No. 402800001 and Up

Installation Instructions

Important: The Groundsmaster 360 must be equipped with the Electrical Accessory Kit, Part 115-0019, to operate the Quick Attach Front Frame Kit.

This product complies with all relevant European directives. For details, please see the Declaration of Incorporation (DOI) at the back of this publication.

Safety

Safety and Instructional Decals



Safety decals and instructions are easily visible to the operator and are located near any area of potential danger. Replace any decal that is damaged or missing.

⚠ WARNING: Cancer and Reproductive Harm - www.P65Warnings.ca.gov.
For more information, please visit www.ttcoCAProp65.com

133-8061

decal133-8061

133-8061



Installation

Loose Parts

Use the chart below to verify that all parts have been shipped.

Procedure	Description	Qty.	Use
1	No parts required	–	Remove the cutting deck.
2	Front attachment frame Hydraulic tube, shorter Hydraulic tube, longer	1 1 1	Mount the hydraulic tubes to the front attachment frame.
3	Screw (1/2 x 1-1/4 inches) Flange nut (1/2 inch) Screw (1/2 x 4-1/2 inches) Spacer Screw (1/2 x 3-1/4 inch) Support washer Spacer	4 11 6 4 1 2 1	Mount the front attachment frame.
4	Tube clamp Plate Tube clamp Plate Carriage screw Flange nut	1 1 1 1 2 2	Install the hydraulic tube assemblies.
5	No parts required	–	Mount the driveshaft.
6	Switch Decal	2 1	Install the switches.
7	No parts required	–	Test the attachment.

Media and Additional Parts

Description	Qty.	Use
Installation instructions	1	Use to install kit
Lock pin	1	Use to secure the attachment to the lift frame
Hair pin cotter	1	Use to secure the attachment to the lift frame

1

Removing the Cutting Deck

No Parts Required

Procedure

1. Park machine on a level surface with the cutting deck in the fully raised position. Shut off the engine, engage the parking brake and remove the key.

Note: When the cutting deck is in the raised position, the pull link torsion spring tension is reduced making it much easier to disconnect the pull links from the machine.

2. Disconnect the pull link from each side of the machine as follows:

⚠ CAUTION

Be careful when disconnecting the pull links. The pull link torsion springs may cause some rotation of pull links during the removal process.

- Remove the shoulder screw that secures the retainer pin to the carrier frame (Figure 1).

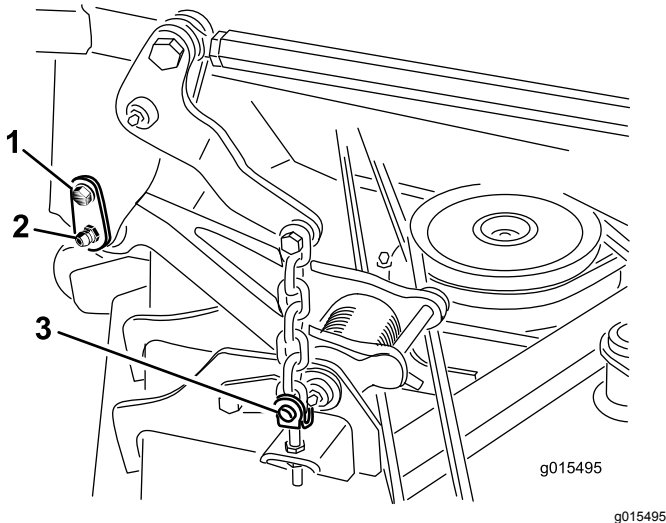

Figure 1

1. Shoulder screw
2. Retainer pin
3. Ring pins and clevis pins

- Carefully slide the retainer pin from carrier frame and the pull link.

3. Note the location of the height-of-cut pin in the height-of-cut bracket for re-assembly purposes (Figure 2). Remove the height-of-cut pin from the height-of-cut bracket.

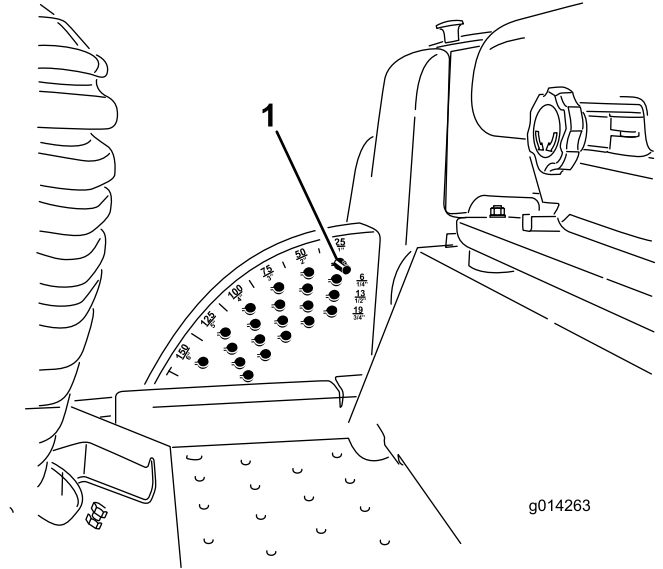

Figure 2

1. Height-of-cut pin

4. Position suitable furniture dollies under the cutting deck.
5. Start the engine and fully lower the cutting deck onto the furniture dollies. Shut off the engine and remove the key from the ignition switch.

⚠ WARNING

Do not start the engine and engage the PTO switch when the PTO shaft is disconnected from the cutting deck. If the engine is started and the PTO shaft is allowed to rotate, serious personal injury and machine damage could result. Remove the PTO fuse from fuse block to prevent unintentional engagement of the PTO clutch.

6. Lift the floor plate, exposing the top of the cutting deck.

7. Disconnect the end yoke of the PTO shaft from cutting deck gearbox shaft as follows.
 - Remove the roll pin from the end yoke and the gearbox shaft (Figure 3). Retain the roll pin for re-use.

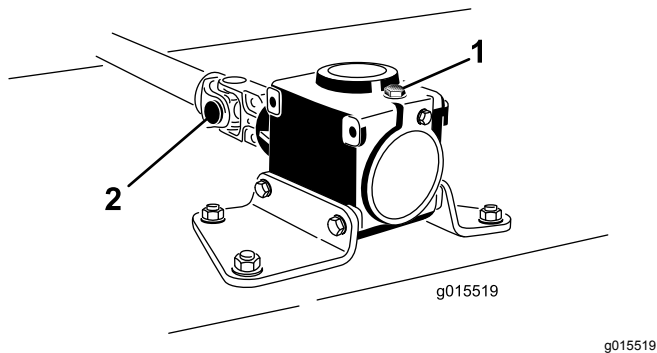

Figure 3

1. Gearbox
2. PTO shaft end yoke

- Loosen the 2 capscrews and locknuts (Figure 3).
 - Slide the driveshaft end yoke from gearbox shaft and tie them up to the frame for support.
8. Remove the 4 ring pins and clevis pins that secure the deck lift chains to the adjustment clevises on the cutting deck (Figure 1).
9. Roll the cutting deck away from the machine.

2

Mounting the Hydraulic Tubes to the Front Attachment Frame

Parts needed for this procedure:

1	Front attachment frame
1	Hydraulic tube, shorter
1	Hydraulic tube, longer

Procedure

1. Loosely install the shorter hydraulic tube to the straight fitting on the valve (Figure 4).
2. Loosely install the longer hydraulic tube to the straight fitting on the manifold (Figure 4).

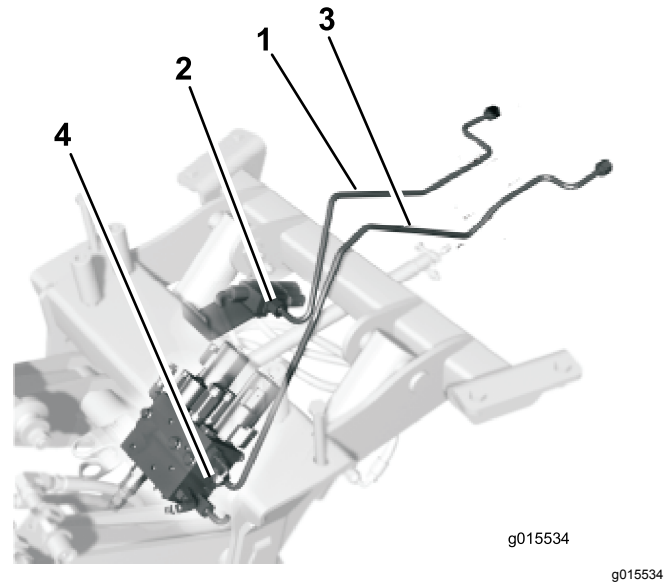

Figure 4

1. Shorter hydraulic tube
2. Valve
3. Longer hydraulic tube
4. Manifold

3

Mounting the Front Attachment Frame

Parts needed for this procedure:

4	Screw (1/2 x 1-1/4 inches)
11	Flange nut (1/2 inch)
6	Screw (1/2 x 4-1/2 inches)
4	Spacer
1	Screw (1/2 x 3-1/4 inch)
2	Support washer
1	Spacer

Procedure

1. **Figure 5** shows the top view of the location, positioning, and size of the fasteners used to secure the front attachment frame to the underside of the traction unit frame.

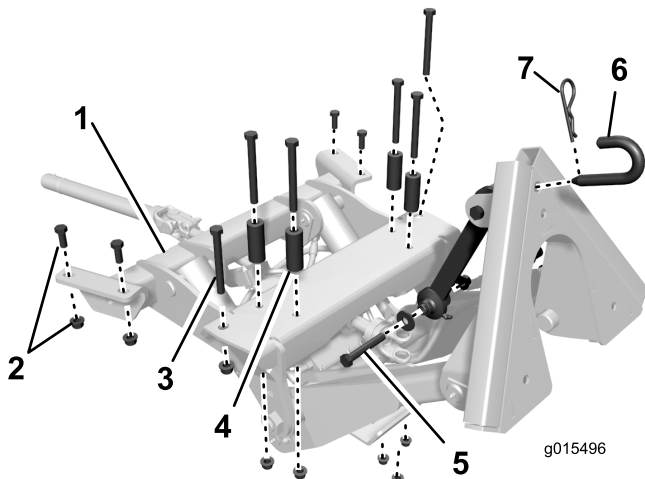

Figure 5

1. Front attachment frame
2. Screw (1/2 x 1-1/4 inches) and flange nut (1/2 inch)
3. Screw (1/2 x 4-1/2 inches)
4. Spacer
5. Screw (1/2 x 3-1/4 inches), support washers, and locknut (1/2 inch)
6. Lock pin
7. Hair pin cotter

2. Guide the shorter hydraulic tube assembly (**Figure 4**) around and above the traction control rod.

3. Position the front attachment frame under the front of the machine (**Figure 6**).
4. Raise the front attachment frame while aligning the mounting holes with the mounting holes in the frame channels and the front frame cross plate (**Figure 6**).

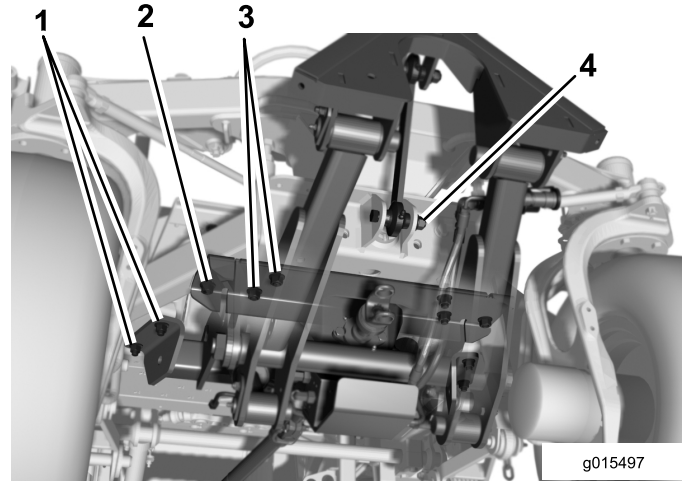

Figure 6

1. Screw (1/2 x 1-1/4 inches) and flange nut (1/2 inch)
2. Screw (1/2 x 4-1/2 inches) and flange nut (1/2 inch)
3. Screw (1/2 x 4-1/2 inches), spacer, and flange nut (1/2 inch)
4. Screw (1/2 x 3-1/4 inches), support washers, and locknut (1/2 inch)

5. On the front of the attachment, secure the outer hole, on each side, to the frame channels with a screw (1/2 x 4-1/2 inches) and a flange nut (1/2 inch) as shown in **Figure 6**.
6. On the rear of the attachment, loosely install each side to the frame channels with 2 screws (1/2 x 1-1/4 inches) and flange nuts (1/2 inch) as shown in **Figure 6**.
7. Using the remaining 4 mounting holes, secure the attachment to the frame cross plate with screws (1/2 x 4-1/2 inches), spacers, and flange nuts (1/2 inch) as shown in **Figure 6**. Position the spacers between the screw head and the cross plate.
8. Tighten the fasteners to 91 to 113 N·m (67 to 83 ft-lb).

9. Secure the top link assembly to the axle support with a screw (1/2 x 3-1/4 inches), 2 support washers, spacer, and a locknut (1/2 inch) as shown in [Figure 5](#) and [Figure 6](#).

Note: The washers are to be positioned on the outside of the ears on the axle support. [Figure 7](#)).

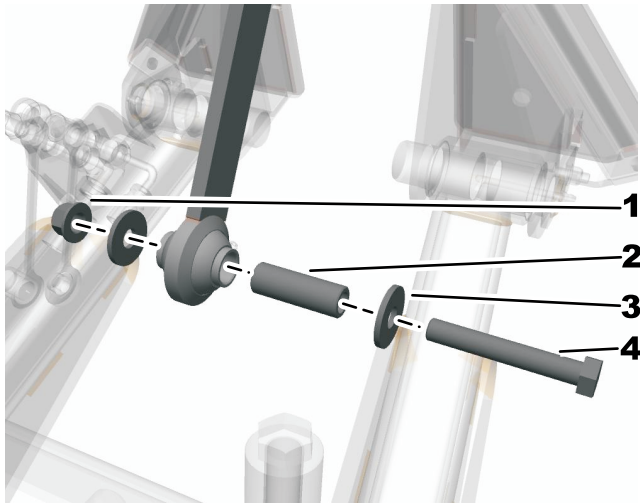

Figure 7

g015950

1. Locknut (1/2 inch)
2. Spacer
3. Support washer
4. Screw (1/2 x 3-1/4 inches)

10. Torque the screw to 91 to 113 N·m (67 to 83 ft-lb).

4

Installing the Hydraulic Tube Assemblies

Parts needed for this procedure:

1	Tube clamp
1	Plate
1	Tube clamp
1	Plate
2	Carriage screw
2	Flange nut

Procedure

1. Place a drain pan under the caps on the hydraulic tubes ([Figure 8](#)).
2. Remove the caps from the hydraulic tubes on the machine ([Figure 8](#)). Remove the caps one at a time as installing the tubes to prevent excess hydraulic fluid loss.

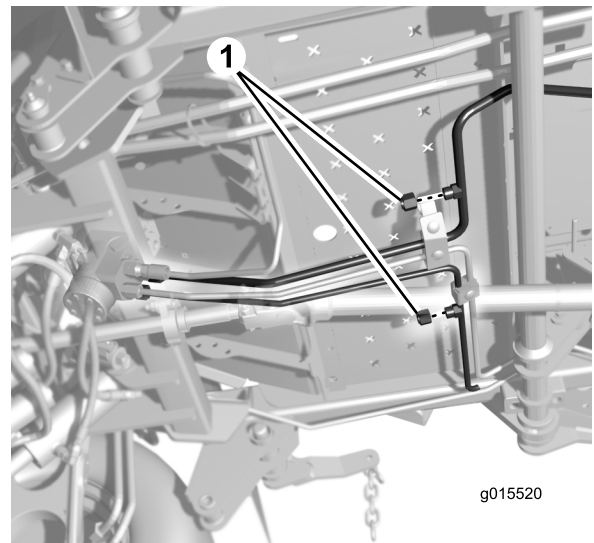

g015520

g015520

Figure 8

1. Hydraulic tube caps

3. Connect the rear end of the shorter hydraulic tube to the tube on the machine (Figure 9).

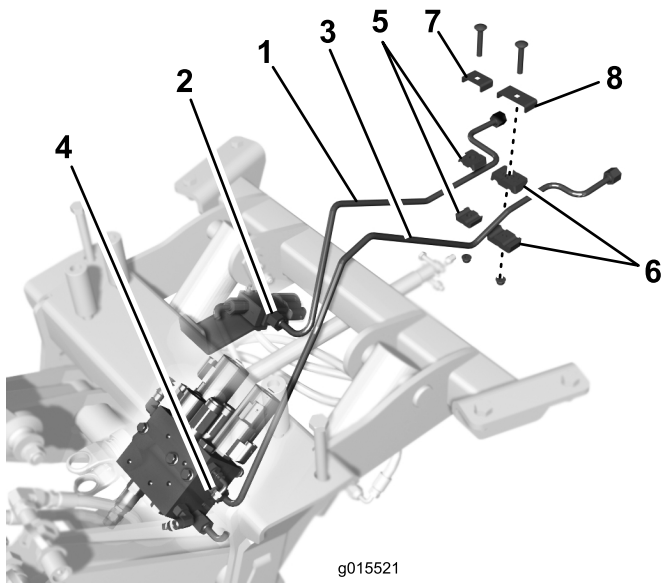

Figure 9

- | | |
|---------------------------|----------------------|
| 1. Shorter hydraulic tube | 5. Tube clamp, small |
| 2. Valve | 6. Tube clamp, large |
| 3. Longer hydraulic tube | 7. Plate, small |
| 4. Manifold | 8. Plate, large |
-
4. Connect the rear end of the longer hydraulic tube to the tube on the machine (Figure 9).
 5. Tighten connections.
 6. Loosely secure the shorter hydraulic tube to the adjacent tube, on the machine, with the smaller tube clamp, plate, carriage screw, and flange nut, as shown in Figure 9.
 7. Loosely secure the longer hydraulic tube to the adjacent tube, on the machine, with the larger tube clamp, plate, carriage screw, and flange nut, as shown in Figure 9.
 8. Tighten the carriage screws and nuts.

5

Mounting the Driveshaft

No Parts Required

Procedure

1. While aligning the driveshaft mounting holes with the jack shaft hole, slide the driveshaft onto the attachment jack shaft (Figure 10).

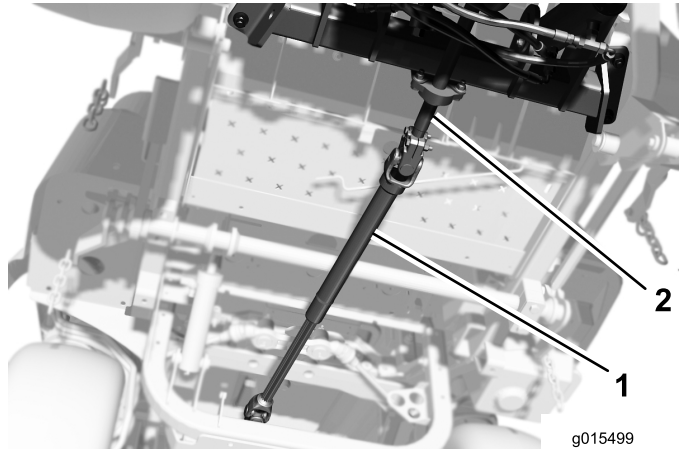

Figure 10

- | | |
|---------------|---------------|
| 1. Driveshaft | 2. Jack shaft |
|---------------|---------------|
-
2. Secure the driveshaft to the jack shaft with the roll pin previously removed.
 3. Tighten the 2 driveshaft cap screws and locknuts.

6

Installing the Switches

Parts needed for this procedure:

2	Switch
1	Decal

Procedure

1. Use a knife to cut out the provided decal.
2. Remove the knock-out by pressing on it from inside the console.
3. Install the decal between the switch holes.

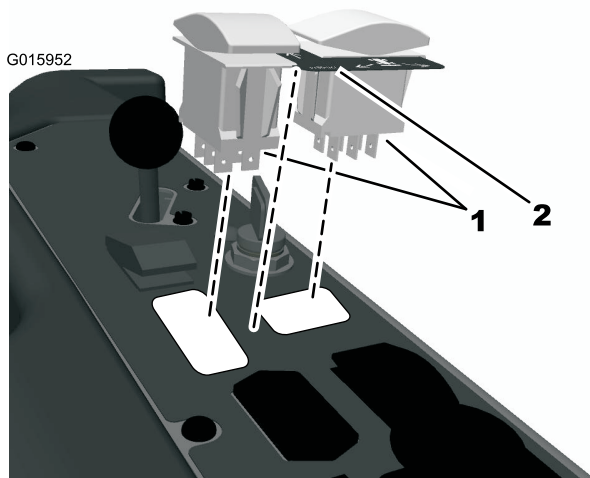

Figure 11

1. Switches.
2. Decal

4. Install the switches by pressing them into the holes.
5. Connect the wire harness to the switches.

7

Testing the Quick Attach Front Frame

No Parts Required

Procedure

Test the machine to ensure that all controls and parts are working as expected.

1. Start the engine.
2. Raise and lower the quick attach front frame to ensure that all functions are working as expected.
3. Shut off the engine, engage the parking brake, and remove the key from the ignition switch.
4. Check for any leaks.

Note: If there are any leaks or if the machine is not performing properly, please review and repeat the steps in this manual to ensure that everything is connected properly.

Operation

Note: Determine the left and right sides of the machine from the normal operating position.

Think Safety First

Please read all safety instructions and symbols in the safety section. Knowing this information could help you or bystanders avoid injury.

⚠ DANGER

Operating on wet grass, ice or slippery steep slopes can cause sliding and loss of control.

Wheels dropping over edges can cause roll overs, which may result in serious injury, death or drowning.

Read and follow the rollover protection instructions and warnings.

To avoid loss of control and possibility of rollover:

- Do not operate near drop-offs or near water.
- Reduce speed and use extreme caution on slopes.
- Avoid sudden turns or rapid speed changes. Always use seat belts

⚠ CAUTION

This machine produces sound levels in excess of 85 dBA at the operators ear and can cause hearing loss through extended periods of exposure.

Wear hearing protection when operating this machine.

The use of protective equipment for eyes, ears, feet and head is recommended.

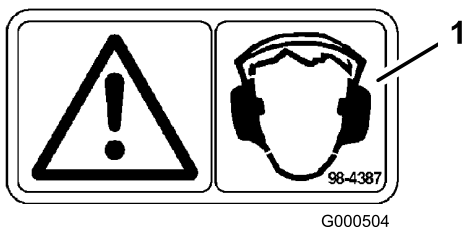

Figure 12

1. Warning— wear hearing protection

Operating the Front Attachment

To operate the front attachment, use the rocker switches as indicated in [Figure 13](#).

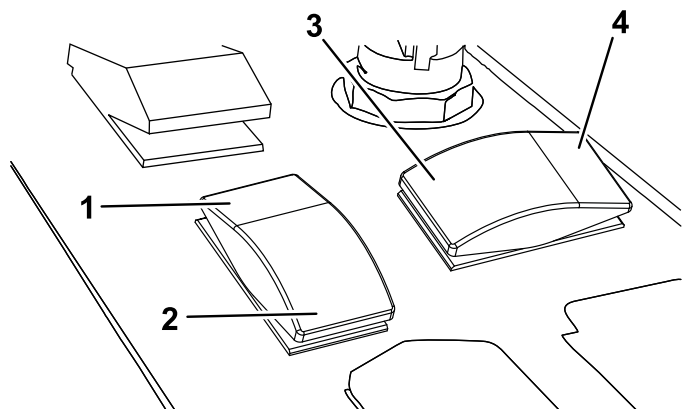

Figure 13

1. Front attach raise and hold
2. Tap to float front attach down. Hold to power down.
3. Swing front attachment right
4. Swing front attachment left

Important: Do not hold down the power down switch once the attachment has been fully lowered; this can cause significant hydraulic system damage and result in front attachment damage.

To use front attachments:

Remove the mower deck as shown in [1 Removing the Cutting Deck \(page 3\)](#), then mount the driveshaft as shown in [5 Mounting the Driveshaft \(page 7\)](#).

Important: The driveshaft cannot be mounted to the front attachment with the deck installed, or else the machine will be damaged.

⚠ WARNING

Using non-powered front attachments with the front deck installed could injure someone or damage the machine.

Do not use non-powered front attachments with the front deck installed.

To use the mower:

1. Clean and grease all front attachments.
2. Remove the driveshaft.
3. Install the front deck.

Attachments

Read the *Operator's Manual* supplied with the attachment before operating.

Ensure that the hydraulic quick couplers are free of any contaminants before connecting.

Keep the output shaft oiled to prevent rust.

Do not operate the PTO with the attachment in the raised position. Noise from the PTO drive line will be evident.

Install the attachment as follows:

- Remove any attachment from the machine. Follow attachment supplier's recommendation for safe blocking and storage.
- Drive the machine into position behind the attachment adapter. Raise the machine adapter into the attachment adapter.
- Secure the adapters together with the attachment pin and hairpin cotter as shown in [Figure 14](#). For more abusive loading a nut and bolt may be substituted.

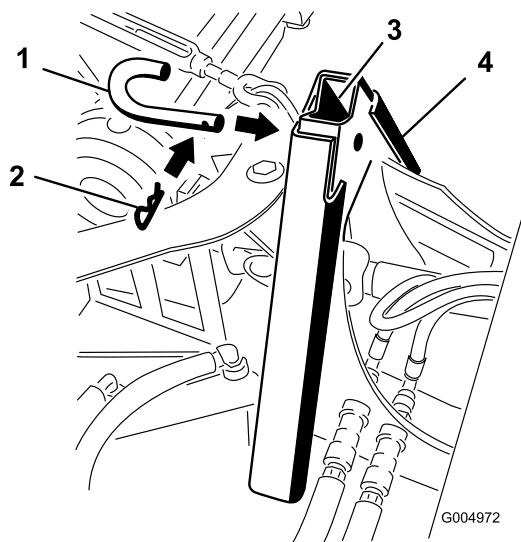

Figure 14

- | | |
|-------------------|-----------------------|
| 1. Attachment pin | 3. Machine adapter |
| 2. Cotter pin | 4. Attachment adapter |

Front Attach to Mower Deck Conversion

Removing the deck

1. On a flat level surface raise deck to highest position.
2. Place 2 furniture dollies under each end of the deck and lower it so it rests on the dollies.
3. Remove the bolts (5/16 inch) and remove the pins from the drag-links on each side of the deck.
4. Remove the four retainer clips and clevis pins from the chains suspending the deck.
5. Remove the roll pin and loosen the bolts securing the driveshaft to the deck.
6. Slide the driveshaft off of the deck gearbox and secure it to the frame of the machine with a bungee cord or strap.
7. The deck can now be rolled out from under the machine.
8. If preparing the machine for winter work, it would be advisable to remove the deck hanging chains.

Attaching the deck

1. If the deck chains were removed from the lift arms, reinstall them.
2. Raise the drag-links on the deck with a pry bar and place a block (6 x 2 x 4 inch) under each one to lift the arm up. **Use caution, as there will be energy stored in the torsion spring.**
3. Raise the front of the machine so there is enough clearance to slide the deck underneath, and line up slots with the drag-link.
4. Slowly lower the machine over the drag links until the holes line up in the frame. Insert the pins and secure it with bolts (5/16 inch).
5. Raise the machine slightly until the block can be easily removed from underneath the drag-links.
6. Lower the machine until the chains can be attached with clevis pins and retainer clips. The machine may need to be started and the lift arms lowered to the lowest position so the chains will reach the deck.
7. After the deck is attached, slide the driveshaft over the gear box spline until the holes are aligned. Insert the roll-pins and tighten the two bolts on the driveshaft.
8. Start the machine and raise the deck high enough to remove the furniture dollies.
9. To adjust and verify the height of cut, consult the *Owner's Manual*.

Maintenance

Recommended Maintenance Schedule(s)

Maintenance Service Interval	Maintenance Procedure
After the first 10 hours	<ul style="list-style-type: none">• Torque the frame mounting bolts.• Torque wheel lug nuts.
Every 50 hours	<ul style="list-style-type: none">• Lubricate grease fittings
Every 200 hours	<ul style="list-style-type: none">• Torque wheel lug nuts.

⚠ CAUTION

If you leave the key in the ignition switch, someone could accidentally start the engine and seriously injure you or other bystanders.

Remove the key from the ignition before you do any maintenance.

Greasing and Lubrication

Lubricate the machine every 50 hours. Grease more frequently when operating conditions are extremely dusty or sandy.

Grease Type: General-purpose grease

How to Grease

Service Interval: Every 50 hours

1. Disengage the PTO and engage the parking brake.
2. Shut off the engine, remove the key, and wait for all moving parts to stop before leaving the operating position.
3. Clean the grease fittings with a rag. Make sure to scrape any paint off the front of the fitting(s).
4. Connect a grease gun to the fitting. Pump grease into the fittings until grease begins to ooze out of the bearings.
5. Wipe up any excess grease.

Where to Add Grease

Grease the locations indicated in [Figure 15](#).

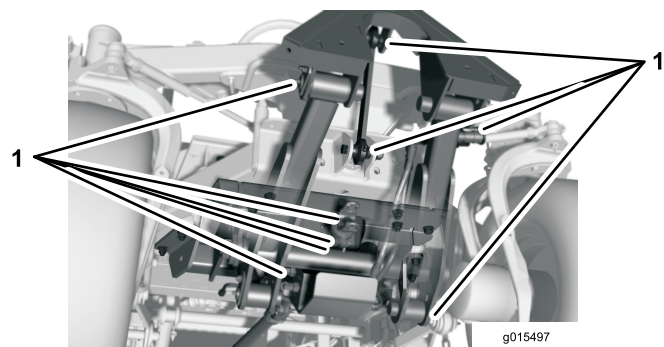

Figure 15

1. Grease locations

Grease the PTO shaft ([Figure 16](#)).

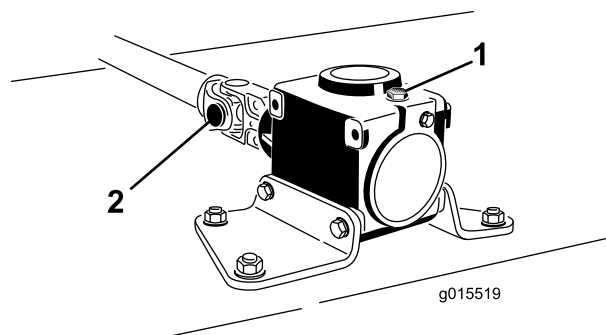

Figure 16

1. Gearbox
2. PTO shaft end yoke

Electrical System Maintenance

- Disconnect the battery before repairing the machine. Disconnect the negative terminal first and the positive last. Connect the positive terminal first and the negative last.
- Charge the battery in an open, well-ventilated area, away from sparks and flames. Unplug the charger before connecting or disconnecting the battery.
- Wear protective clothing and use insulated tools.

Checking the Fuses

Refer to the *Operator's Manual* supplied with the cab for instructions on fuses.

If the machine has any electrical system issues, check the fuses. Grasp each fuse and remove them one at a time, checking to see if any are blown. If you need to replace a fuse, always use the **same type and amperage rated fuse** as the one you are replacing, **otherwise you could damage the electrical system.**

Note: If a fuse blows frequently, you probably have a short in the electrical system and should have it serviced by a qualified service technician.

Storage

Machine

1. Thoroughly clean the machine and cab, paying special attention to the following areas:
 - PTO shaft assembly
 - All grease fittings and pivot points
 - Oil the spline on the PTO output shaft to prevent rusting
2. Check all fasteners for looseness and tighten them as necessary. Torque the 5 bolts securing the winter frame to the traction unit to 359 N·m (265 ft-lb).
3. Grease or oil all grease fittings and pivot points. Wipe off any excess lubricant.
4. Lightly sand and use touch up paint on painted areas that are scratched, chipped or rusted. Repair any dents in the metal body.

Notes:

Declaration of Incorporation

Model No.	Serial No.	Product Description	Invoice Description	General Description	Directive
30509	315000001 and Up	Quick Attach Front Frame, Groundsmaster 360 Multi-Purpose Machine	FRONT FRAME, QAS-4WD GM360	Quick Attach Front Frame	2006/42/EC, 2000/14/EC

Relevant technical documentation has been compiled as required per Part B of Annex VII of 2006/42/EC.

We will undertake to transmit, in response to requests by national authorities, relevant information on this partly completed machinery. The method of transmission shall be electronic transmittal.

This machinery shall not be put into service until incorporated into approved Toro models as indicated on the associated Declaration of Conformity and in accordance with all instructions, whereby it can be declared in conformity with all relevant Directives.

Certified:



John Heckel
Sr. Engineering Manager
8111 Lyndale Ave. South
Bloomington, MN 55420, USA
August 27, 2018

Authorized Representative:

Marcel Dutrieux
Manager European Product Integrity
Toro Europe NV
Nijverheidsstraat 5
2260 Oevel
Belgium

Tel. +32 16 386 659

EEA/UK Privacy Notice

Toro's Use of Your Personal Information

The Toro Company ("Toro") respects your privacy. When you purchase our products, we may collect certain personal information about you, either directly from you or through your local Toro company or dealer. Toro uses this information to fulfil contractual obligations - such as to register your warranty, process your warranty claim or to contact you in the event of a product recall - and for legitimate business purposes - such as to gauge customer satisfaction, improve our products or provide you with product information which may be of interest. Toro may share your information with our subsidiaries, affiliates, dealers or other business partners in connection these activities. We may also disclose personal information when required by law or in connection with the sale, purchase or merger of a business. We will never sell your personal information to any other company for marketing purposes.

Retention of your Personal Information

Toro will keep your personal information as long as it is relevant for the above purposes and in accordance with legal requirements. For more information about applicable retention periods please contact legal@toro.com.

Toro's Commitment to Security

Your personal information may be processed in the US or another country which may have less strict data protection laws than your country of residence. Whenever we transfer your information outside of your country of residence, we will take legally required steps to ensure that appropriate safeguards are in place to protect your information and to make sure it is treated securely.

Access and Correction

You may have the right to correct or review your personal data, or object to or restrict the processing of your data. To do so, please contact us by email at legal@toro.com. If you have concerns about the way in which Toro has handled your information, we encourage you to raise this directly with us. Please note that European residents have the right to complain to your Data Protection Authority.



The Toro Warranty

A Two-Year Limited Warranty

Conditions and Products Covered

The Toro Company and its affiliate, Toro Warranty Company, pursuant to an agreement between them, jointly warrant your Toro Commercial product ("Product") to be free from defects in materials or workmanship for two years or 1500 operational hours*, whichever occurs first. This warranty is applicable to all products with the exception of Aerators (refer to separate warranty statements for these products). Where a warrantable condition exists, we will repair the Product at no cost to you including diagnostics, labor, parts, and transportation. This warranty begins on the date the Product is delivered to the original retail purchaser.

* Product equipped with an hour meter.

Instructions for Obtaining Warranty Service

You are responsible for notifying the Commercial Products Distributor or Authorized Commercial Products Dealer from whom you purchased the Product as soon as you believe a warrantable condition exists. If you need help locating a Commercial Products Distributor or Authorized Dealer, or if you have questions regarding your warranty rights or responsibilities, you may contact us at:

Toro Commercial Products Service Department
Toro Warranty Company
8111 Lyndale Avenue South
Bloomington, MN 55420-1196

952-888-8801 or 800-952-2740
E-mail: commercial.warranty@toro.com

Owner Responsibilities

As the Product owner, you are responsible for required maintenance and adjustments stated in your *Operator's Manual*. Failure to perform required maintenance and adjustments can be grounds for disallowing a warranty claim.

Items and Conditions Not Covered

Not all product failures or malfunctions that occur during the warranty period are defects in materials or workmanship. This warranty does not cover the following:

- Product failures which result from the use of non-Toro replacement parts, or from installation and use of add-on, or modified non-Toro branded accessories and products. A separate warranty may be provided by the manufacturer of these items.
- Product failures which result from failure to perform recommended maintenance and/or adjustments. Failure to properly maintain your Toro product per the Recommended Maintenance listed in the *Operator's Manual* can result in claims for warranty being denied.
- Product failures which result from operating the Product in an abusive, negligent, or reckless manner.
- Parts subject to consumption through use unless found to be defective. Examples of parts which are consumed, or used up, during normal Product operation include, but are not limited to, brake pads and linings, clutch linings, blades, reels, rollers and bearings (sealed or greasable), bed knives, spark plugs, castor wheels and bearings, tires, filters, belts, and certain sprayer components such as diaphragms, nozzles, and check valves, etc.
- Failures caused by outside influence. Conditions considered to be outside influence include, but are not limited to, weather, storage practices, contamination, use of unapproved fuels, coolants, lubricants, additives, fertilizers, water, or chemicals, etc.
- Failure or performance issues due to the use of fuels (e.g. gasoline, diesel, or biodiesel) that do not conform to their respective industry standards.

- Normal noise, vibration, wear and tear, and deterioration.
- Normal "wear and tear" includes, but is not limited to, damage to seats due to wear or abrasion, worn painted surfaces, scratched decals or windows, etc.

Parts

Parts scheduled for replacement as required maintenance are warranted for the period of time up to the scheduled replacement time for that part. Parts replaced under this warranty are covered for the duration of the original product warranty and become the property of Toro. Toro will make the final decision whether to repair any existing part or assembly or replace it. Toro may use remanufactured parts for warranty repairs.

Deep Cycle and Lithium-Ion Battery Warranty:

Deep cycle and Lithium-Ion batteries have a specified total number of kilowatt-hours they can deliver during their lifetime. Operating, recharging, and maintenance techniques can extend or reduce total battery life. As the batteries in this product are consumed, the amount of useful work between charging intervals will slowly decrease until the battery is completely worn out. Replacement of worn out batteries, due to normal consumption, is the responsibility of the product owner. Battery replacement may be required during the normal product warranty period at owner's expense. Note: (Lithium-Ion battery only): A Lithium-Ion battery has a part only prorated warranty beginning year 3 through year 5 based on the time in service and kilowatt hours used. Refer to the *Operator's Manual* for additional information.

Maintenance is at Owner's Expense

Engine tune-up, lubrication, cleaning and polishing, replacement of filters, coolant, and completing recommended maintenance are some of the normal services Toro products require that are at the owner's expense.

General Conditions

Repair by an Authorized Toro Distributor or Dealer is your sole remedy under this warranty.

Neither The Toro Company nor Toro Warranty Company is liable for indirect, incidental or consequential damages in connection with the use of the Toro Products covered by this warranty, including any cost or expense of providing substitute equipment or service during reasonable periods of malfunction or non-use pending completion of repairs under this warranty. Except for the Emissions warranty referenced below, if applicable, there is no other express warranty. All implied warranties of merchantability and fitness for use are limited to the duration of this express warranty.

Some states do not allow exclusions of incidental or consequential damages, or limitations on how long an implied warranty lasts, so the above exclusions and limitations may not apply to you. This warranty gives you specific legal rights, and you may also have other rights which vary from state to state.

Note regarding engine warranty:

The Emissions Control System on your Product may be covered by a separate warranty meeting requirements established by the U.S. Environmental Protection Agency (EPA) and/or the California Air Resources Board (CARB). The hour limitations set forth above do not apply to the Emissions Control System Warranty. Refer to the Engine Emission Control Warranty Statement supplied with your product or contained in the engine manufacturer's documentation for details.

Countries Other than the United States or Canada

Customers who have purchased Toro products exported from the United States or Canada should contact their Toro Distributor (Dealer) to obtain guarantee policies for your country, province, or state. If for any reason you are dissatisfied with your Distributor's service or have difficulty obtaining guarantee information, contact the Toro importer.