



2-Person or 4-Person Canopy Kit

Workman® GTX Utility Vehicle

Model No. 07921—Serial No. 400000000 and Up

Model No. 07922—Serial No. 400000000 and Up

Form No. 3421-992 Rev B

Installation Instructions

Installation

1

Preparing the Machine

No Parts Required

Procedure

1. Park the machine on a level surface.
2. Engage the parking brake.
3. Shut off the engine and remove the key.
4. Disconnect the battery; refer to your *Operator's Manual*.
5. Raise the cargo bed to the dump position and secure it with the prop rod.

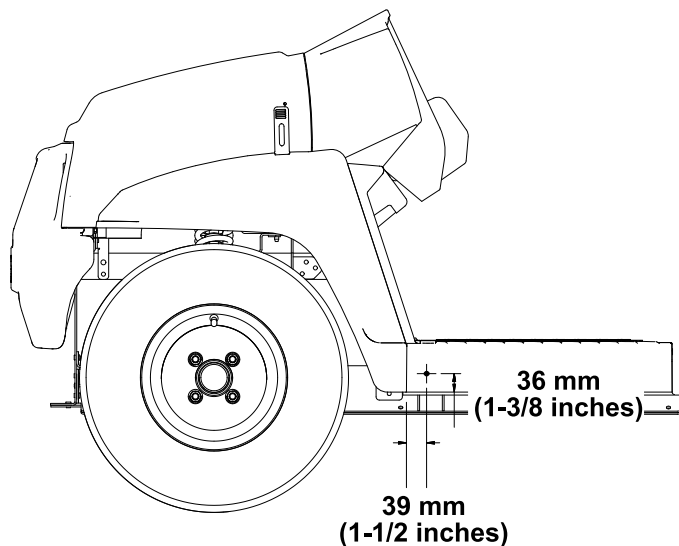

Figure 1

g259750

2. Using the dimensions shown in Figure 2, drill 1 hole (5/16 inch) into the outside of the footboard on the left and right sides of the machine.

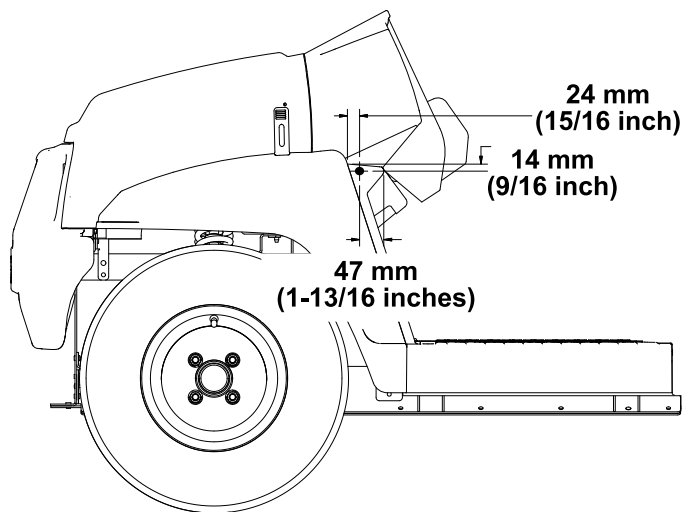

Figure 2

g259751

2

Drilling the Holes for the Mounting Tubes

No Parts Required

Procedure

1. Using the dimensions shown in Figure 1, drill 1 hole (5/16 inch) into the outside of the floor plate on both sides of the machine.



3

Installing the Front Mounting Tubes

Parts needed for this procedure:

| | |
|---|------------------------------------|
| 2 | Front mounting tube |
| 2 | Flange-head bolt (5/16 x 3 inches) |
| 2 | Spacer (5/8 x 1 inch) |
| 4 | Flange nut (5/16 inch) |
| 2 | Carriage bolt (5/16 x 2 inches) |

Procedure

Loosely install the 2 front mounting tubes using 2 flange-head bolts (5/16 x 3 inches), 2 spacers (5/8 x 1 inch), 4 flange nuts (5/16 inch), and 2 carriage bolts (5/16 x 2 inches) as shown in [Figure 3](#).

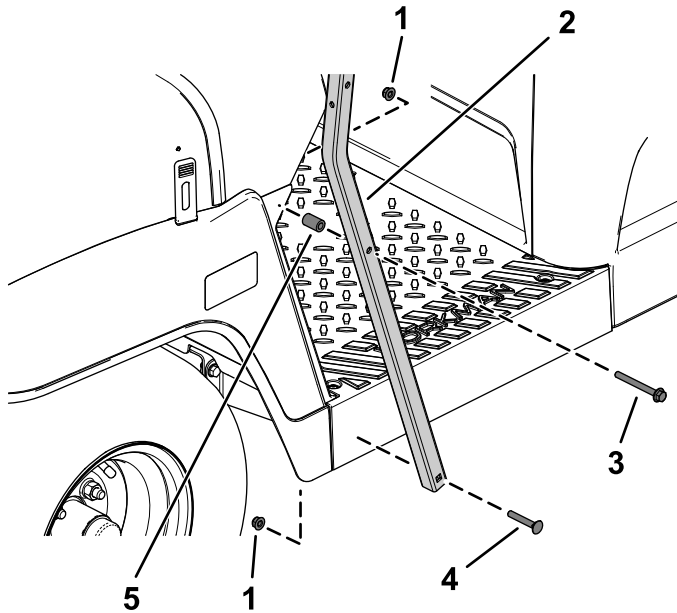

Figure 3

Left side shown

1. Flange nut (5/16 inch)
2. Front mounting tube
3. Flange-head bolt (5/16 x 3 inches)
4. Carriage bolt (5/16 x 2 inches)
5. Spacer (5/8 x 1 inch)

4

Removing the Side Panels

No Parts Required

For Gasoline Machines

Important: Before performing this procedure, check your machine to see if the holes for installation already exist. If not, proceed with this procedure.

Note: Retain all the hardware that you remove in this procedure.

1. Remove the flange-head bolt securing the fuel tank to the tank tray ([Figure 4](#)).

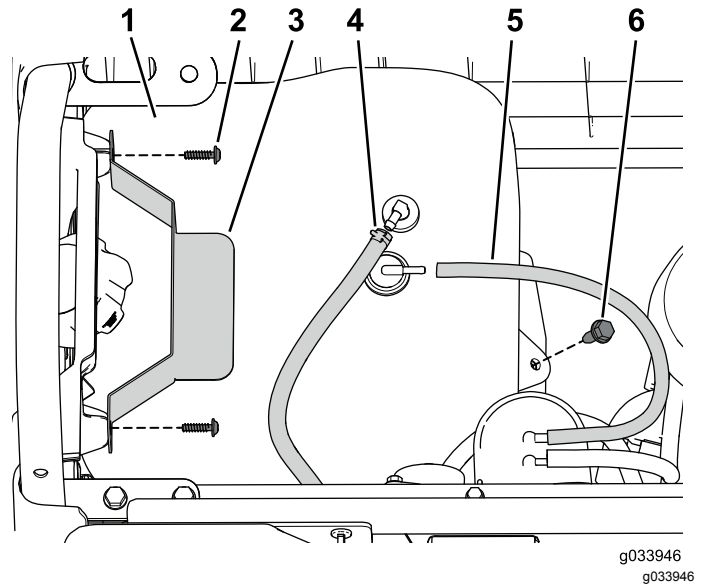

Figure 4

1. Fuel tank
2. Screw
3. Hold-down
4. Fuel line
5. Vent hose
6. Flange-head bolt

2. Remove the screws securing the hold-down ([Figure 4](#)).

3. Disconnect the vent tube and fuel line from the tank (Figure 4).

Note: Prepare to capture and clean up any fuel that spills when you disconnect the fuel line from the tank.

⚠ DANGER

In certain conditions, fuel is extremely flammable and highly explosive. A fire or explosion from fuel can burn you and others and can damage property.

- Drain the fuel from the fuel tank when the engine is cold. Do this outdoors and in an open area. Wipe up any fuel that spills.
- Never smoke when handling fuel, and stay away from an open flame or where a spark may ignite fuel fumes.

4. Remove the fuel tank from the tray.
5. Remove the 2 flange-head bolts securing the tank tray to the frame (Figure 5).

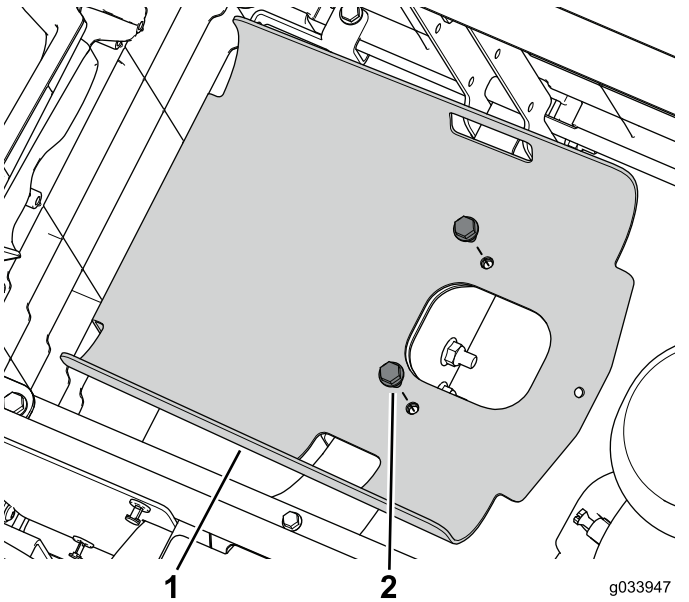

Figure 5

1. Tank tray
2. Flange-head bolt

6. Remove the 4 screws securing the left side panel to the lower seat assembly (Figure 6).

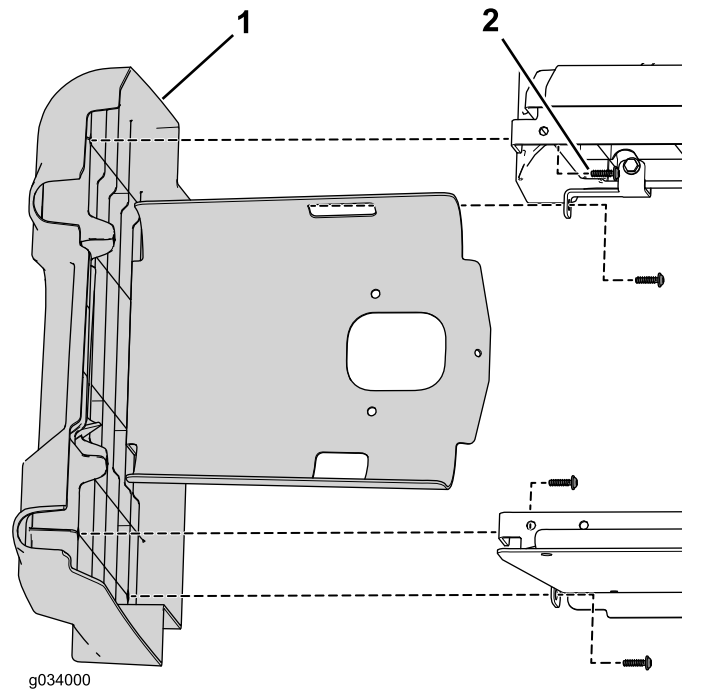

Figure 6

1. Left side panel
2. Screw

7. Remove the negative (–) cable from the battery and then the positive (+) cable (Figure 7).

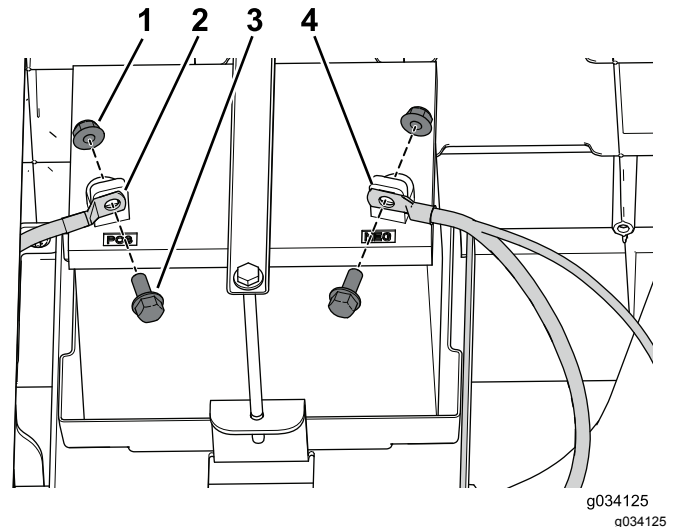

Figure 7

1. Nut
2. Positive cable (+)
3. Bolt
4. Negative cable (–)

8. Remove the 2 flange-head bolts securing the battery tray to the frame (Figure 8).

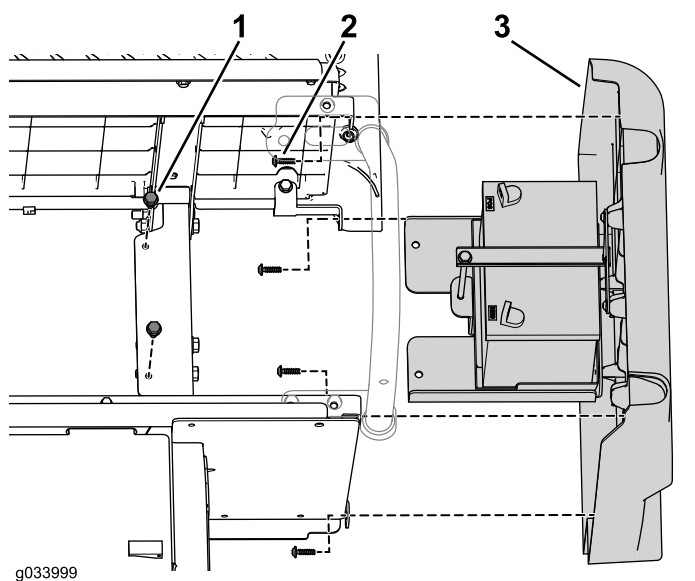

Figure 8

1. Flange-head bolt
2. Self-tapping screw
3. Right side panel

9. Remove the 4 screws securing the right side panel to the lower seat assembly (Figure 9).

For Electric Machines

Important: Before performing this procedure, check your machine to see if the holes for installation already exist. If not, proceed with this procedure.

Note: Retain all the hardware that you remove in this procedure.

1. Remove the 4 self-tapping screws securing the right side panel to the machine (Figure 9).

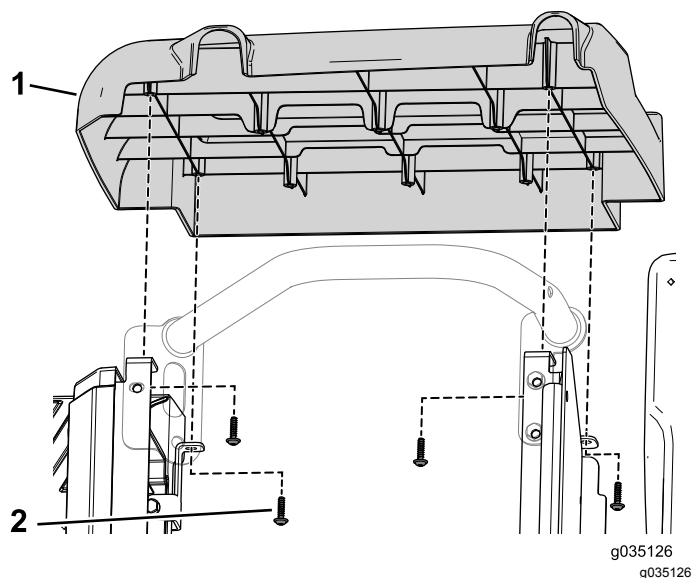

Figure 9

1. Right side panel
2. Self-tapping screw

2. Remove the 2 bolts securing the charger bracket to the battery tray (Figure 10).

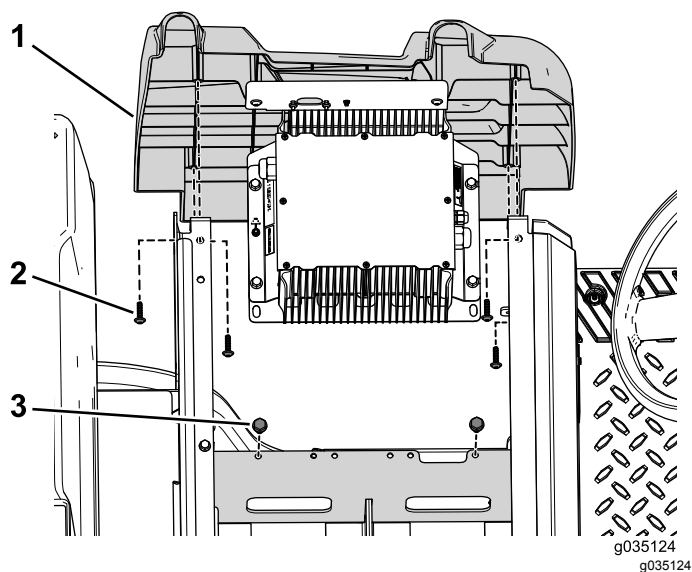

Figure 10

1. Left side panel
2. Self-tapping screw
3. Bolt

3. Remove the 4 self-tapping screws securing the left side panel to the machine (Figure 10).

5

Drilling the Support Bracket

No Parts Required

Procedure

Drill the support bracket using the measurements shown in [Figure 11](#).

When you drill the highest upper hole, ensure that you drill all the way through the outer bracket, frame tube, and firewall.

⚠ CAUTION

Use caution when drilling the holes into the right side of the frame on an electric machine.

If you drill too far, you could damage the batteries or other components.

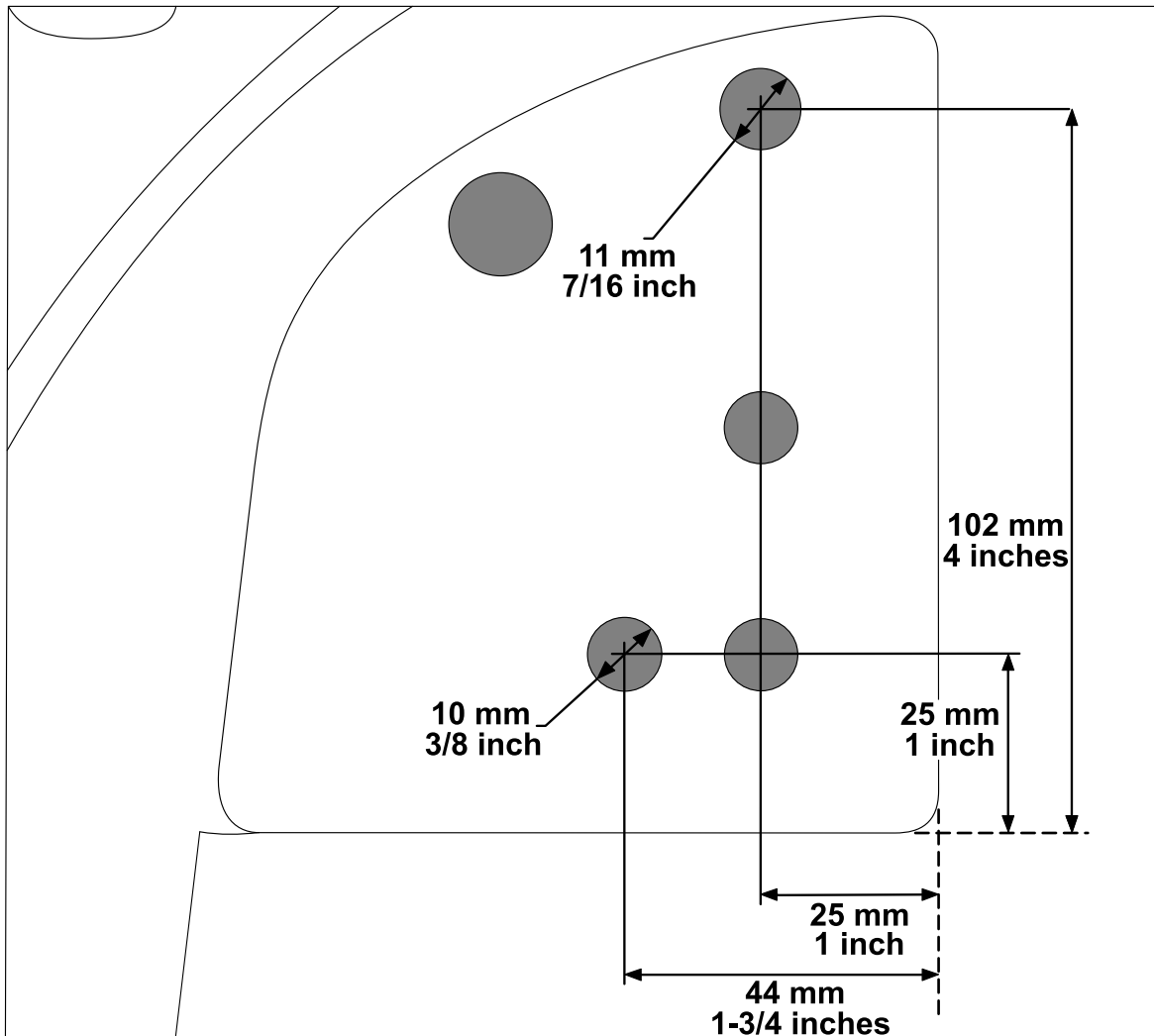

Figure 11

g260925

6

Installing the Side Panels

No Parts Required

For Gasoline Machines

1. Secure the right side panel using the previously removed 4 screws ([Figure 8](#)).
2. Secure the battery tray to the frame using the previously removed 2 flange-head bolts ([Figure 8](#)).
3. Secure the battery cables using the previously removed 2 bolts and 2 nuts and connect the battery terminals ([Figure 7](#)).
4. Secure the left side panel using the previously removed 4 screws ([Figure 6](#)).
5. Secure the tank tray to the frame using the previously removed 2 flange-head bolts ([Figure 5](#)).
6. Place the fuel tank in the tank tray.
7. Connect the fuel line and vent tube to the fuel tank ([Figure 4](#)).
8. Secure the hold-down using the previously removed screws ([Figure 4](#)).
9. Secure the fuel tank to the tank tray using the previously removed flange-head bolt ([Figure 4](#)).
10. Fill the fuel tank; refer to the *Operator's Manual*.

For Electric Machines

1. Secure the left side panel using the previously removed 4 self-tapping screws ([Figure 10](#)).
2. Secure the charger bracket to the battery tray using the previously removed 2 bolts ([Figure 10](#)).
3. Secure the right side panel using the previously removed 4 self-tapping screws ([Figure 9](#)).

7

Installing the Rear Mounting Tubes and Tube-Mounting Bracket

Parts needed for this procedure:

| | |
|---|---------------------------------------|
| 2 | Rear mounting tube |
| 1 | Tube-mounting bracket |
| 2 | Flange-head bolt (5/16 x 3 inches) |
| 2 | Flange nut (5/16 inch) |
| 2 | Flange-head bolt (3/8 x 1-3/4 inches) |
| 2 | Flange-head bolt (3/8 x 3-1/2 inches) |
| 4 | Locknut (3/8 inch) |
| 1 | Trim seal |

Procedure

- Loosely install the 2 rear mounting tubes using 2 flange-head bolts (3/8 x 3-1/2 inches), 2 flange-head bolts (3/8 x 1-3/4 inches), and 4 locknuts (3/8 inch) as shown in [Figure 12](#).

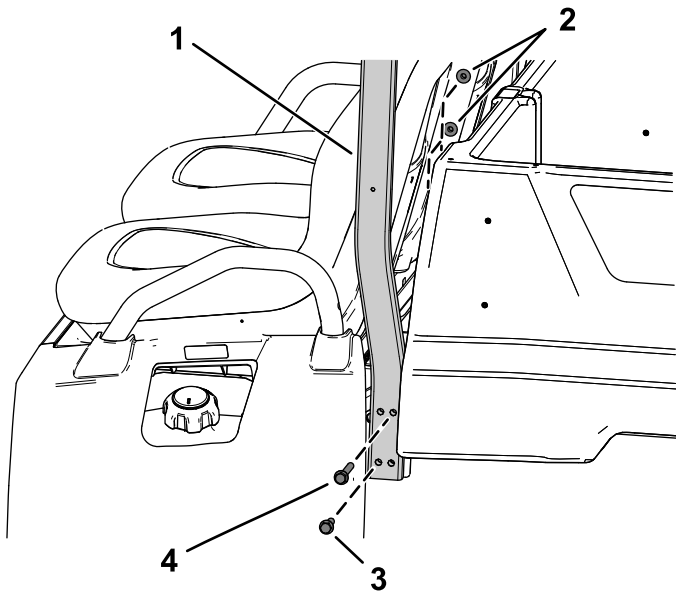

Figure 12

Left side shown

- | | |
|-----------------------|--|
| 1. Rear mounting tube | 3. Flange-head bolt (3/8 x 1-3/4 inches) |
| 2. Locknut (3/8 inch) | 4. Flange-head bolt (3/8 x 3-1/2 inches) |

- Secure the tube-mounting bracket to the rear mounting tubes using 2 flange-head bolts (5/16 x 3 inches) and 2 flange nuts (5/16 inch) as shown in [Figure 13](#).
- Install the trim seal onto the tube-mounting bracket ([Figure 13](#)).

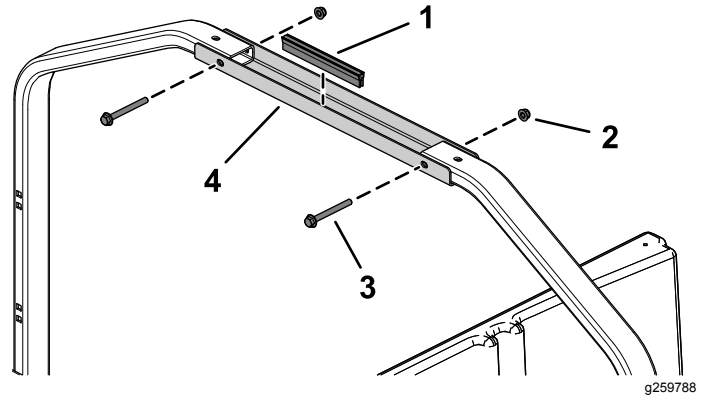

Figure 13

- | | |
|---------------------------|---------------------------------------|
| 1. Trim seal | 3. Flange-head bolt (5/16 x 3 inches) |
| 2. Flange nut (5/16 inch) | 4. Tube-mounting bracket |

- Tighten the fasteners installed in step 1.

Torque the 5/16-inch fasteners to 20 to 25 N·m (175 to 225 in-lb).

Torque the 3/8-inch fasteners to 37 to 45 N·m (27 to 33 ft-lb).

Installing the Long Canopy Support Brackets

For a 4-Person Canopy Only

Parts needed for this procedure:

| | |
|---|--|
| 2 | Long canopy support bracket |
| 8 | Hex-washer head bolt (5/16 x 3/4 inch) |
| 2 | Trim seal |

Procedure

1. Secure the 2 long canopy support brackets to the front and rear mounting tubes using 8 hex-washer head bolts (5/16 x 3/4 inch) as shown in [Figure 14](#).
2. Install the 2 trim seals onto the 2 long canopy support brackets ([Figure 14](#)).

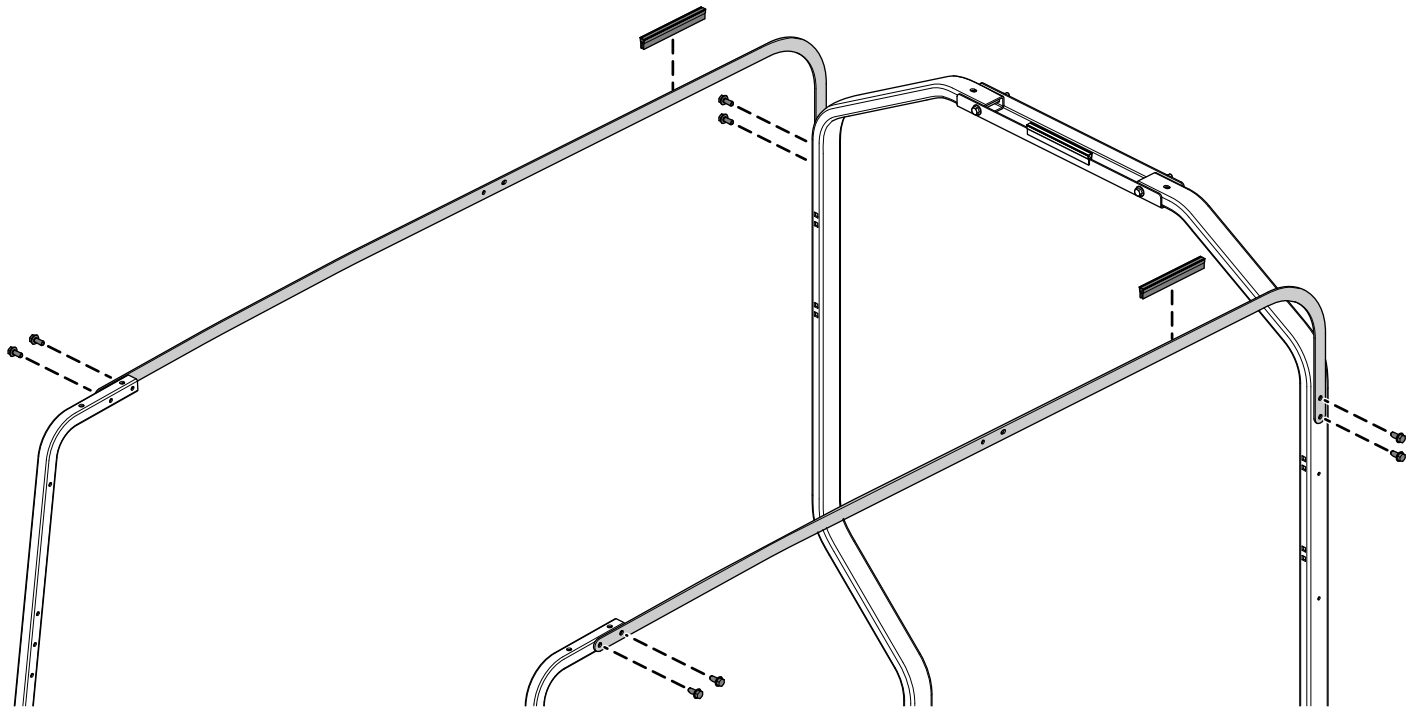

Figure 14

g261122

9

Installing the Canopy

Parts needed for this procedure:

| | |
|---|---------------------------------------|
| 1 | Canopy |
| 4 | Flange-head bolt (1/4 x 1-3/4 inches) |
| 4 | Sealing washer |
| 4 | Locknut (1/4 inch) |

Procedure

Important: If you are installing a mirror kit, install it before installing the canopy.

Secure the canopy to the front and rear mounting tubes using 4 flange-head bolts (1/4 x 1-3/4 inches), 4 sealing washers, and 4 locknuts (1/4 inch) as shown in [Figure 15](#).

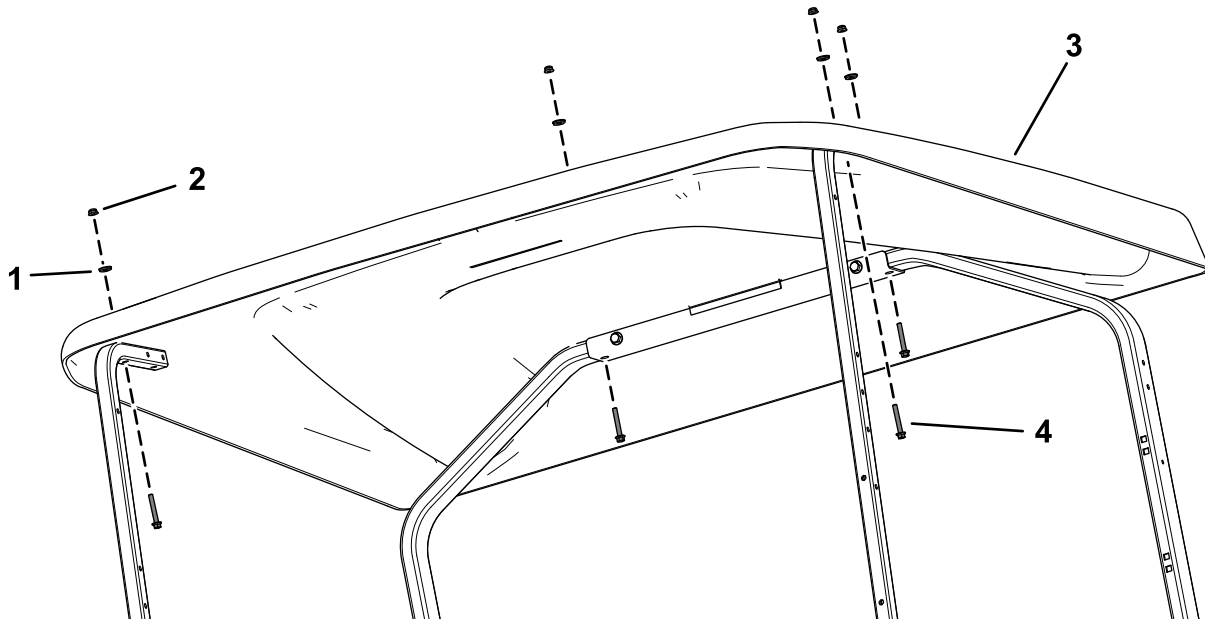

g259844

Figure 15
2-person canopy shown

- | | |
|-----------------------|--|
| 1. Sealing washer | 3. Canopy |
| 2. Locknut (1/4 inch) | 4. Flange-head bolt (1/4 x 1-3/4 inches) |

10

Installing the Canopy Support Bracket

Parts needed for this procedure:

| | |
|---|---------------------------------------|
| 1 | Canopy support bracket |
| 2 | Flange-head bolt (1/4 x 2-1/4 inches) |
| 2 | Locknut (1/4 inch) |
| 2 | Sealing washer |
| 1 | Trim seal |
| 2 | Spacer (1/4 inch) |

Procedure

- 1. Install the trim seal onto the tube-mounting bracket (Figure 16).

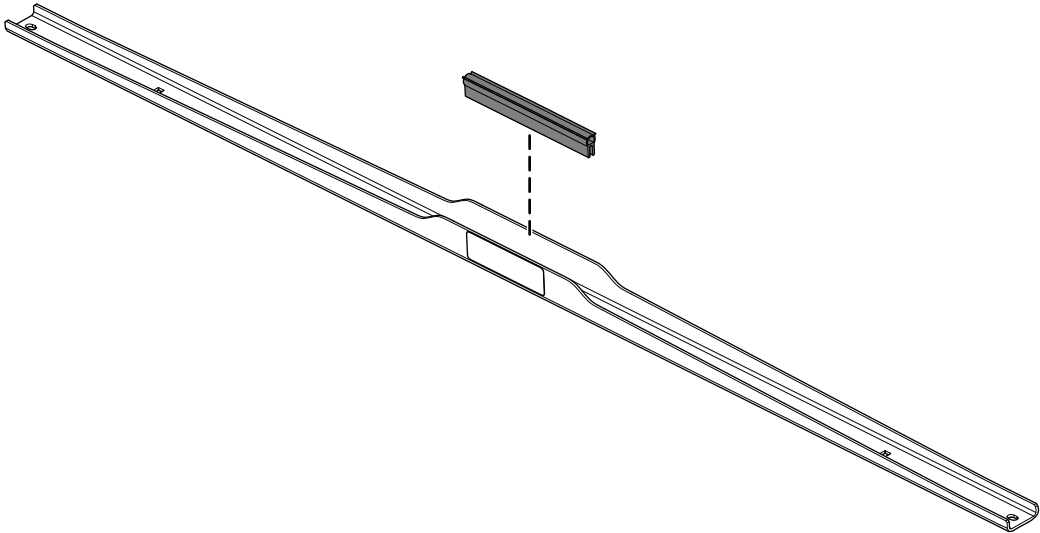
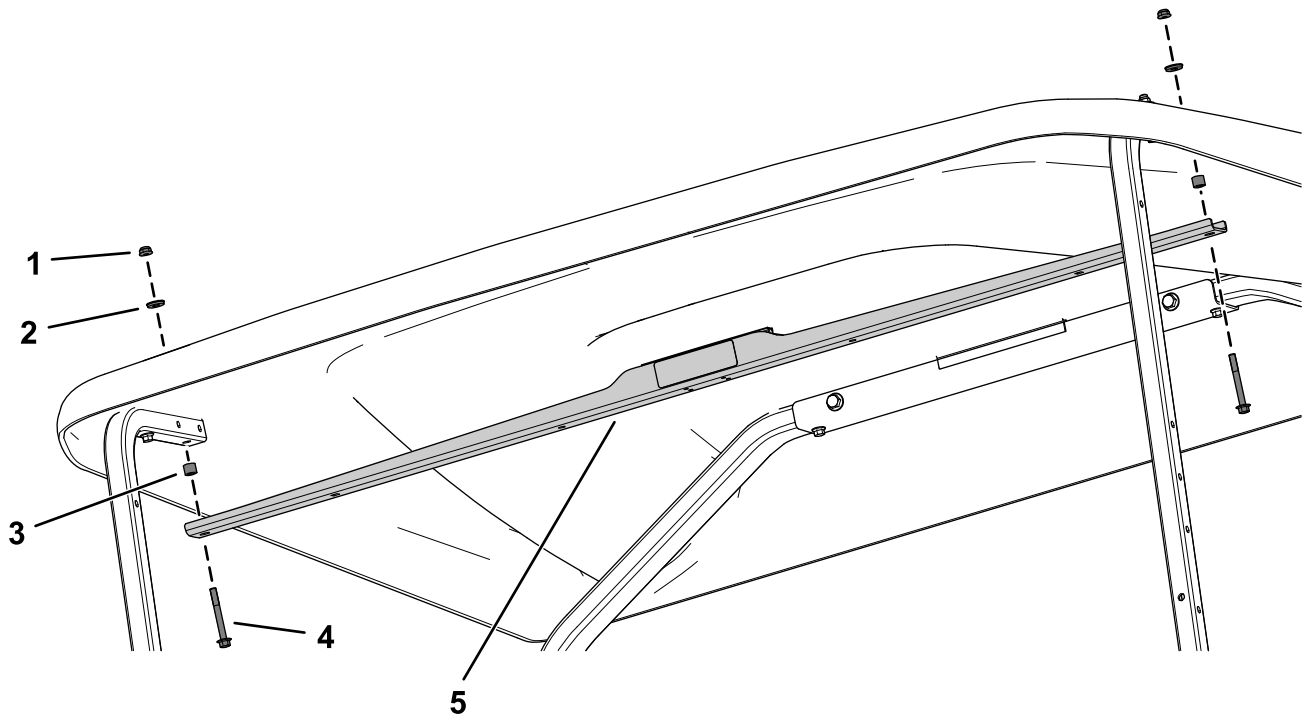

Figure 16

g259845

2. Secure the canopy support bracket to the front support tubes and canopy using the 2 flange-head bolts (1/4 x 2-1/4 inches), 2 spacers (1/4 inch), 2 sealing washers, and 2 locknuts (1/4 inch) as shown in [Figure 17](#).



g259846

Figure 17
2-person canopy shown

- | | |
|-----------------------|--|
| 1. Locknut (1/4 inch) | 4. Flange-head bolt (1/4 x 2-1/4 inches) |
| 2. Sealing washer | 5. Canopy support bracket |
| 3. Spacer (1/4 inch) | |

11

Installing the Canopy Support Tube For a 4-Person Canopy Only

Parts needed for this procedure:

| | |
|---|---------------------------------------|
| 1 | Canopy support tube |
| 6 | Locknut (1/4 inch) |
| 2 | Sealing washer |
| 2 | Flange-head bolt (1/4 x 1-1/2 inches) |
| 1 | Foam pad |
| 4 | Flange-head bolt (1/4 x 1-1/4 inches) |

Procedure

1. Apply the foam pad to the canopy support tube ([Figure 18](#)).

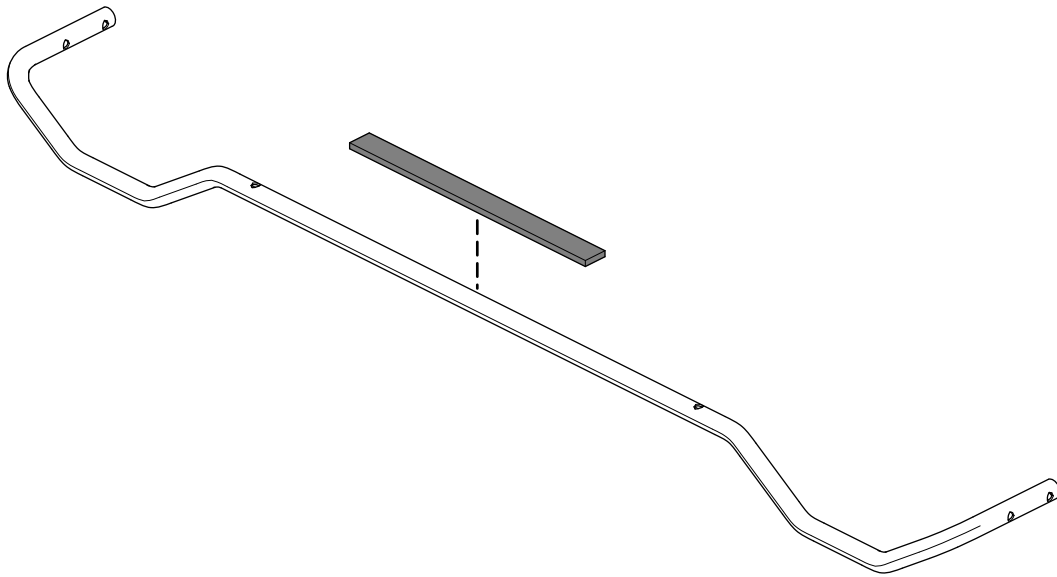
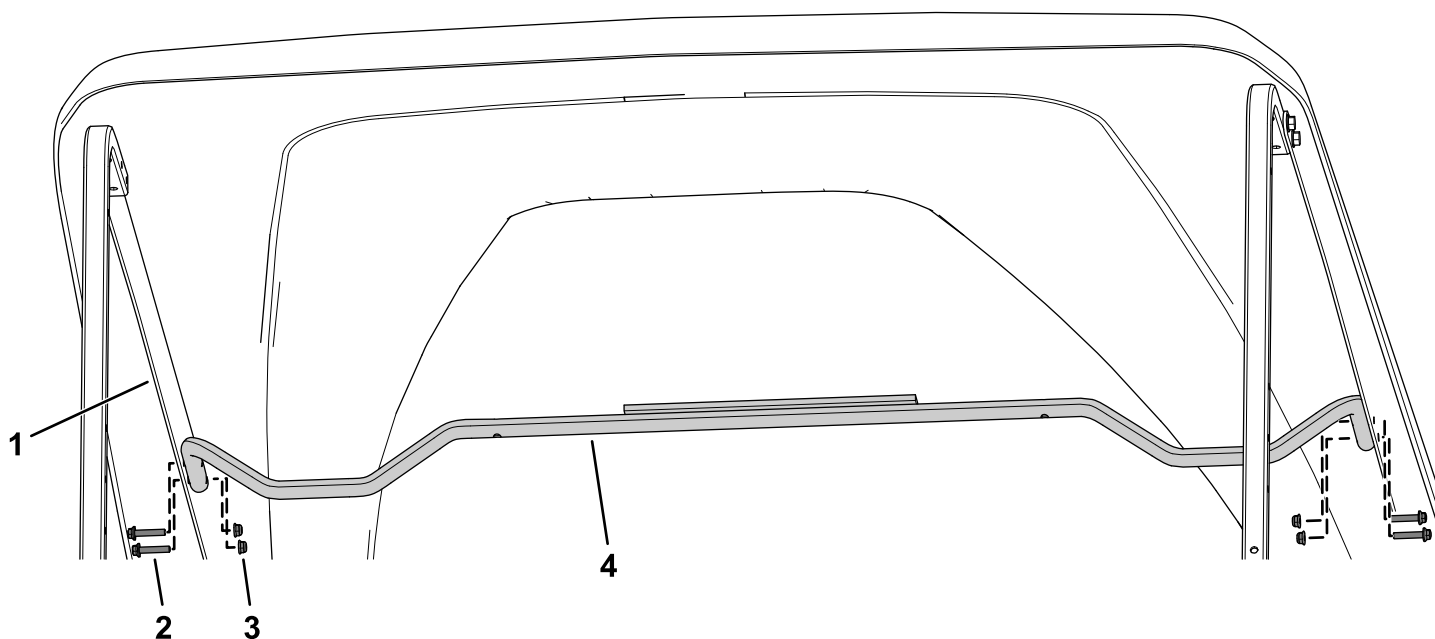

Figure 18

g261160

2. Secure the canopy support tube to the long canopy support brackets using 4 flange-head bolts (1/4 x 1-1/4 inches) and 4 locknuts (1/4 inch) as shown in [Figure 19](#).



g262068

Figure 19

- | | |
|--|------------------------|
| 1. Long canopy support bracket | 3. Locknut (1/4 inch) |
| 2. Flange-head bolt (1/4 x 1-1/4 inches) | 4. Canopy support tube |

3. Using the canopy support tube as the template, drill 2 holes (6 mm or 1/4 inch) into the canopy.
4. Secure the canopy support tube to the canopy using 2 flange-head bolts (1/4 x 1-1/2 inches), 2 sealing washers, and 2 locknuts (1/4 inch) as shown in [Figure 20](#).

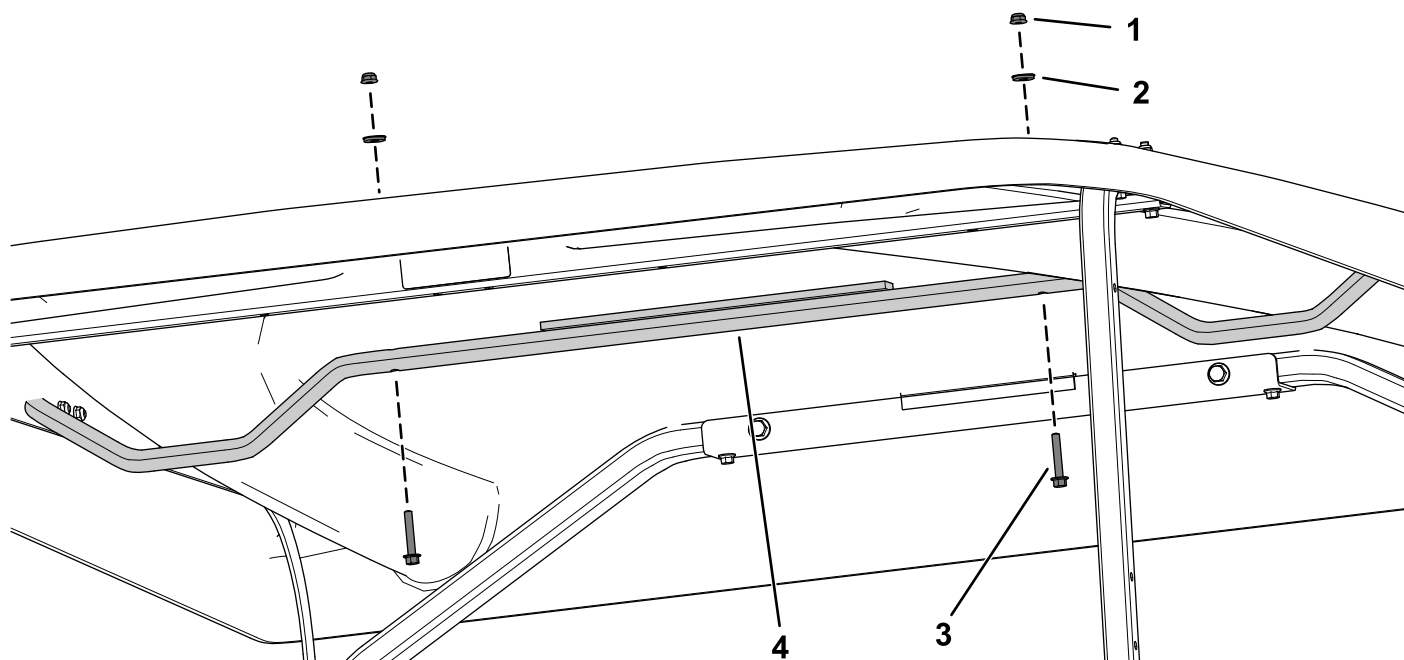

g261161

Figure 20

- | | |
|-----------------------|--|
| 1. Locknut (1/4 inch) | 3. Flange-head bolt (1/4 x 1-1/2 inches) |
| 2. Sealing washer | 4. Canopy support tube |

Notes:

Notes:



The Toro Warranty

A Two-Year Limited Warranty

Conditions and Products Covered

The Toro Company and its affiliate, Toro Warranty Company, pursuant to an agreement between them, jointly warrant your Toro Commercial product ("Product") to be free from defects in materials or workmanship for two years or 1500 operational hours*, whichever occurs first. This warranty is applicable to all products with the exception of Aerators (refer to separate warranty statements for these products). Where a warrantable condition exists, we will repair the Product at no cost to you including diagnostics, labor, parts, and transportation. This warranty begins on the date the Product is delivered to the original retail purchaser.

* Product equipped with an hour meter.

Instructions for Obtaining Warranty Service

You are responsible for notifying the Commercial Products Distributor or Authorized Commercial Products Dealer from whom you purchased the Product as soon as you believe a warrantable condition exists. If you need help locating a Commercial Products Distributor or Authorized Dealer, or if you have questions regarding your warranty rights or responsibilities, you may contact us at:

Toro Commercial Products Service Department
Toro Warranty Company
8111 Lyndale Avenue South
Bloomington, MN 55420-1196

952-888-8801 or 800-952-2740
E-mail: commercial.warranty@toro.com

Owner Responsibilities

As the Product owner, you are responsible for required maintenance and adjustments stated in your *Operator's Manual*. Failure to perform required maintenance and adjustments can be grounds for disallowing a warranty claim.

Items and Conditions Not Covered

Not all product failures or malfunctions that occur during the warranty period are defects in materials or workmanship. This warranty does not cover the following:

- Product failures which result from the use of non-Toro replacement parts, or from installation and use of add-on, or modified non-Toro branded accessories and products. A separate warranty may be provided by the manufacturer of these items.
- Product failures which result from failure to perform recommended maintenance and/or adjustments. Failure to properly maintain your Toro product per the Recommended Maintenance listed in the *Operator's Manual* can result in claims for warranty being denied.
- Product failures which result from operating the Product in an abusive, negligent, or reckless manner.
- Parts subject to consumption through use unless found to be defective. Examples of parts which are consumed, or used up, during normal Product operation include, but are not limited to, brake pads and linings, clutch linings, blades, reels, rollers and bearings (sealed or greasable), bed knives, spark plugs, castor wheels and bearings, tires, filters, belts, and certain sprayer components such as diaphragms, nozzles, and check valves, etc.
- Failures caused by outside influence. Conditions considered to be outside influence include, but are not limited to, weather, storage practices, contamination, use of unapproved fuels, coolants, lubricants, additives, fertilizers, water, or chemicals, etc.
- Failure or performance issues due to the use of fuels (e.g. gasoline, diesel, or biodiesel) that do not conform to their respective industry standards.

- Normal noise, vibration, wear and tear, and deterioration.
- Normal "wear and tear" includes, but is not limited to, damage to seats due to wear or abrasion, worn painted surfaces, scratched decals or windows, etc.

Parts

Parts scheduled for replacement as required maintenance are warranted for the period of time up to the scheduled replacement time for that part. Parts replaced under this warranty are covered for the duration of the original product warranty and become the property of Toro. Toro will make the final decision whether to repair any existing part or assembly or replace it. Toro may use remanufactured parts for warranty repairs.

Deep Cycle and Lithium-Ion Battery Warranty:

Deep cycle and Lithium-Ion batteries have a specified total number of kilowatt-hours they can deliver during their lifetime. Operating, recharging, and maintenance techniques can extend or reduce total battery life. As the batteries in this product are consumed, the amount of useful work between charging intervals will slowly decrease until the battery is completely worn out. Replacement of worn out batteries, due to normal consumption, is the responsibility of the product owner. Battery replacement may be required during the normal product warranty period at owner's expense. Note: (Lithium-Ion battery only): A Lithium-Ion battery has a part only prorated warranty beginning year 3 through year 5 based on the time in service and kilowatt hours used. Refer to the *Operator's Manual* for additional information.

Maintenance is at Owner's Expense

Engine tune-up, lubrication, cleaning and polishing, replacement of filters, coolant, and completing recommended maintenance are some of the normal services Toro products require that are at the owner's expense.

General Conditions

Repair by an Authorized Toro Distributor or Dealer is your sole remedy under this warranty.

Neither The Toro Company nor Toro Warranty Company is liable for indirect, incidental or consequential damages in connection with the use of the Toro Products covered by this warranty, including any cost or expense of providing substitute equipment or service during reasonable periods of malfunction or non-use pending completion of repairs under this warranty. Except for the Emissions warranty referenced below, if applicable, there is no other express warranty. All implied warranties of merchantability and fitness for use are limited to the duration of this express warranty.

Some states do not allow exclusions of incidental or consequential damages, or limitations on how long an implied warranty lasts, so the above exclusions and limitations may not apply to you. This warranty gives you specific legal rights, and you may also have other rights which vary from state to state.

Note regarding engine warranty:

The Emissions Control System on your Product may be covered by a separate warranty meeting requirements established by the U.S. Environmental Protection Agency (EPA) and/or the California Air Resources Board (CARB). The hour limitations set forth above do not apply to the Emissions Control System Warranty. Refer to the Engine Emission Control Warranty Statement supplied with your product or contained in the engine manufacturer's documentation for details.

Countries Other than the United States or Canada

Customers who have purchased Toro products exported from the United States or Canada should contact their Toro Distributor (Dealer) to obtain guarantee policies for your country, province, or state. If for any reason you are dissatisfied with your Distributor's service or have difficulty obtaining guarantee information, contact the Toro importer.